



PO BOX 3222,
REDFERN NSW 2016
Ph: 02 8065 1156
Fax: 02 8065 1297
Email: survey@daw-walton.com.au

REVISION: 8
DATED: 24-01-2025

DRAFT SUBDIVISION PLAN PREPARED FROM
ARCHITECTURAL PLANS BY URBANACORP,
DATED: Oct 2024

LOCATION PLAN

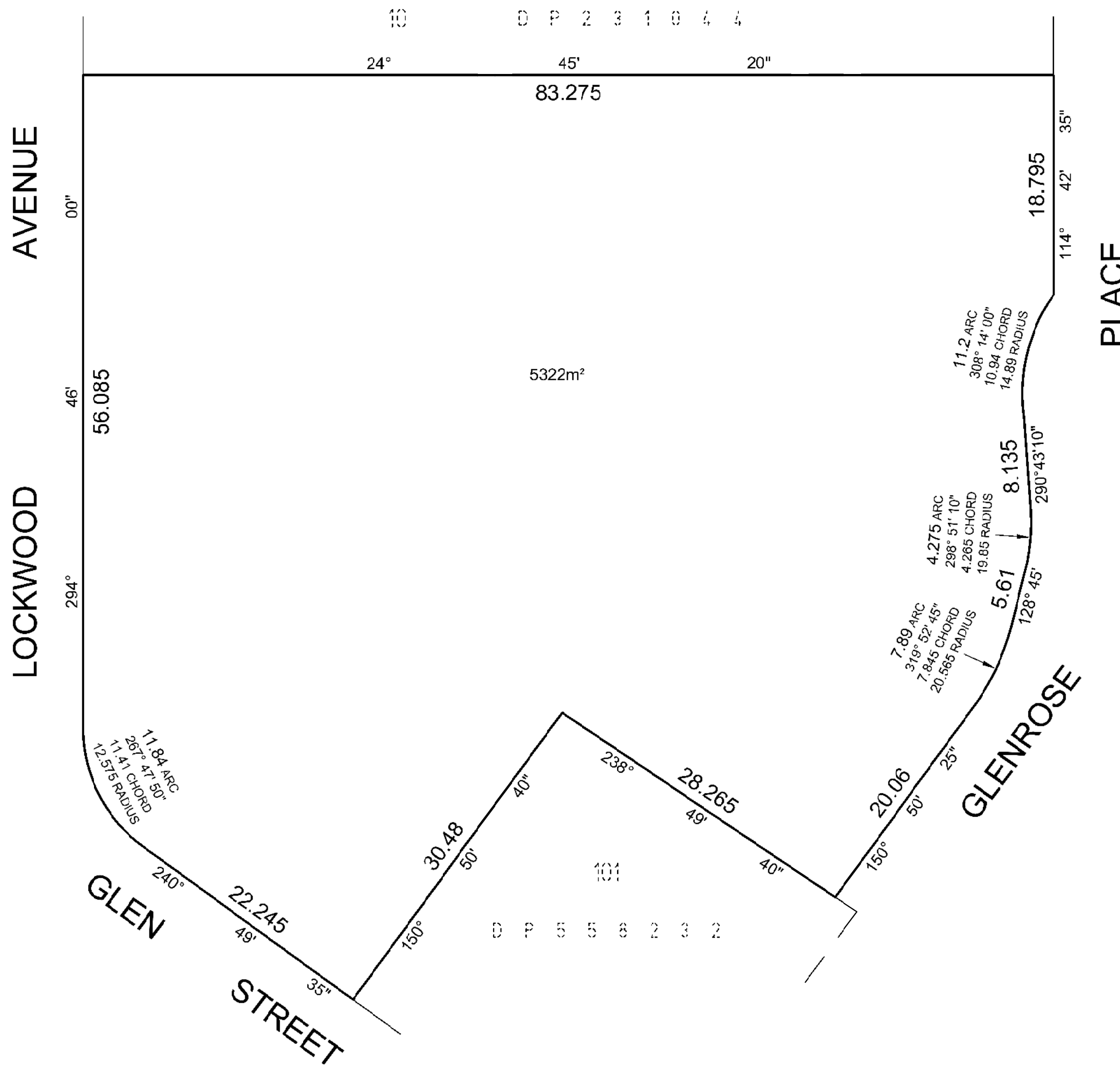
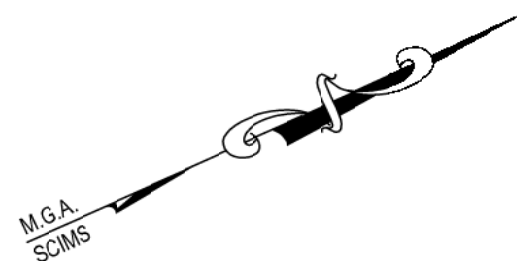

SURVEYOR
NAME: JOHN WALTON
DATE OF SURVEY:
REFERENCE: 5597-22DP

PLAN OF: SUBDIVISION OF
LOT 1 IN DP1199795

LGA: NORTHERN BEACHES
LOCALITY: BELROSE
Reduction Ratio: 1 : 300
Lengths are in metres

REGISTERED:

DRAFT DP



PO BOX 3222,
REDFERN NSW 2016
Ph: 02 8065 1156
Fax: 02 8065 1297
Email: survey@daw-walton.com.au

REVISION: 8
DATED: 24-01-2025

DRAFT SUBDIVISION PLAN PREPARED FROM
ARCHITECTURAL PLANS BY URBANACORP,
ISSUE: 5, DATED: Dec 2024

BASEMENT 4 AND
BELOW

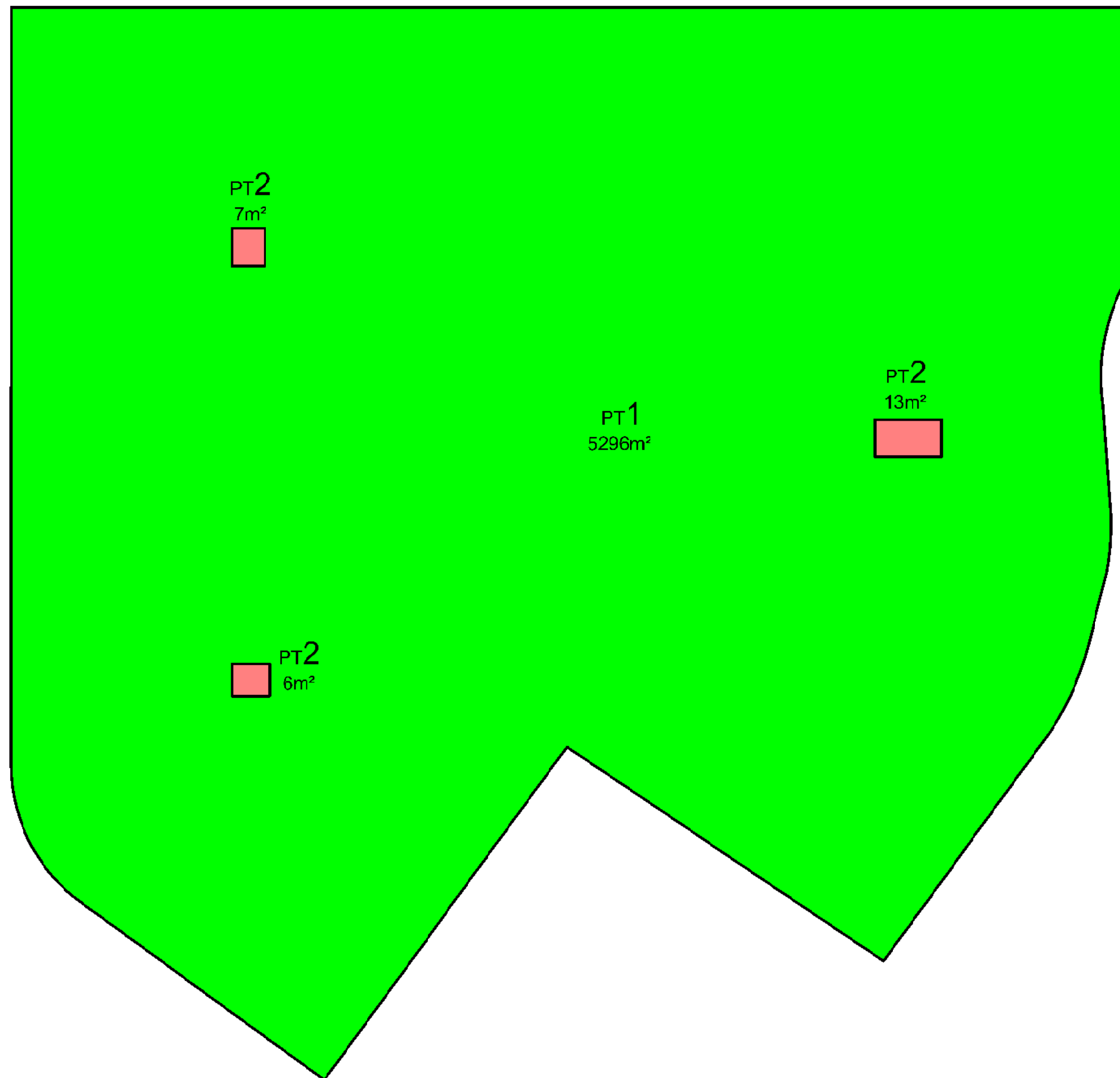
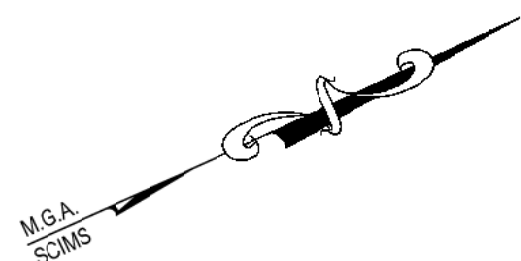

- DENOTES RETAIL LOT 1
- DENOTES RESIDENTIAL LOT 2

- 'A' DENOTES EASEMENT FOR ACCESS, VW & LIS
- 'C' DENOTES RIGHT OF CARRIAGEWAY, VW & LIS
- 'E' DENOTES EASEMENT FOR EMERGENCY EGRESS, VW & LIS
- VW DENOTES VARIABLE WIDTH
- LIS DENOTES LIMITED IN STRATUM

SURVEYOR
NAME: JOHN WALTON
DATE OF SURVEY:
REFERENCE: 5597-22DP

PLAN OF: SUBDIVISION OF
LOT 1 IN DP1199795

LGA: NORTHERN BEACHES
LOCALITY: BELROSE
Reduction Ratio: 1 : 300
Lengths are in metres

REGISTERED:

DRAFT DP



PO BOX 3222,
REDFERN NSW 2016
Ph: 02 8065 1156
Fax: 02 8065 1297
Email: survey@daw-walton.com.au

REVISION: 8
DATED: 24-01-2025

DRAFT SUBDIVISION PLAN PREPARED FROM
ARCHITECTURAL PLANS BY URBANACORP,
ISSUE: 5, DATED: Dec 2024

BASEMENT 4 AND
BELOW

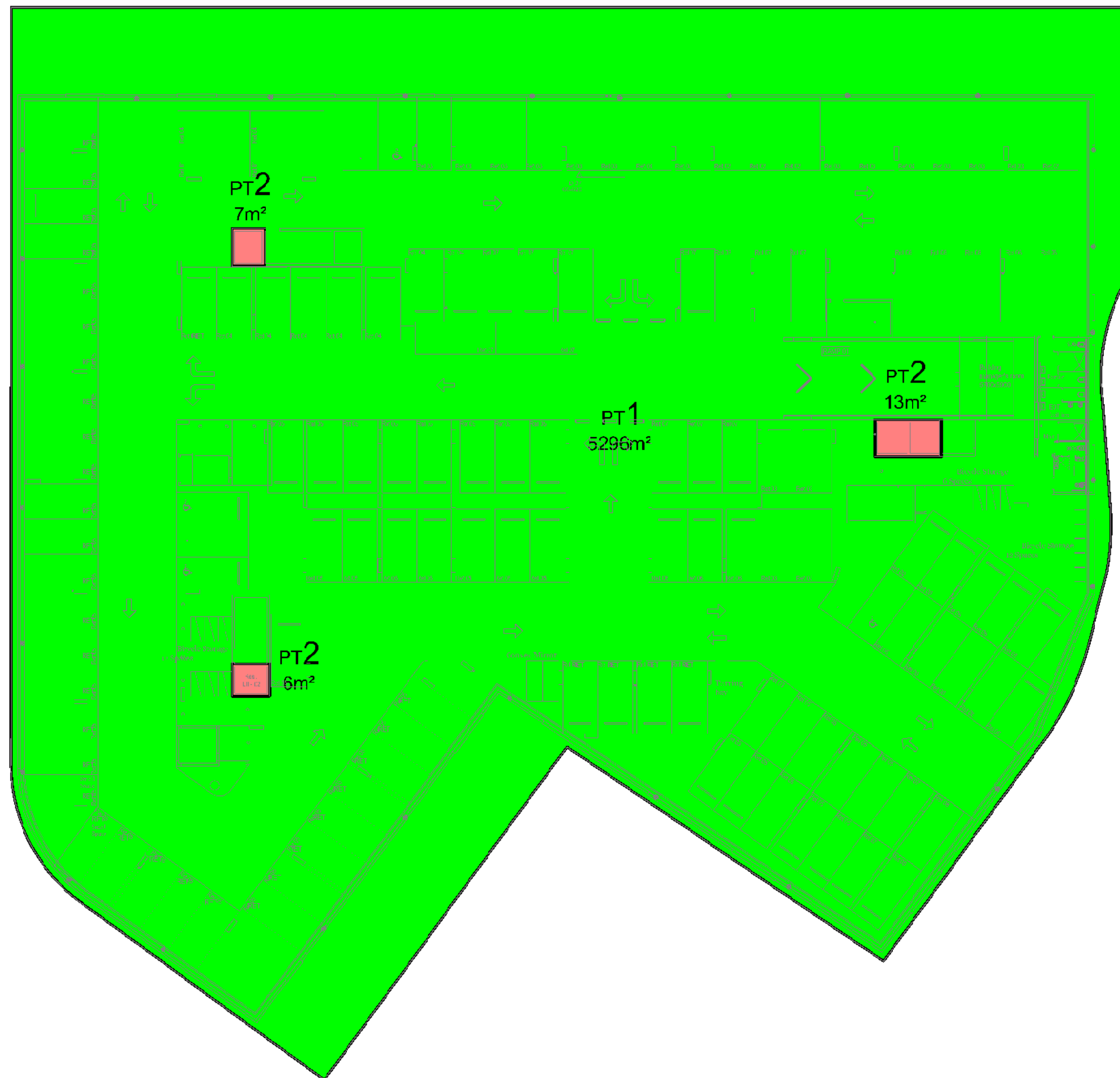
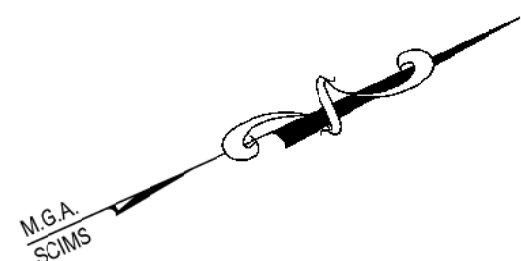

- DENOTES RETAIL LOT 1
- DENOTES RESIDENTIAL LOT 2

- 'A' DENOTES EASEMENT FOR ACCESS, VW & LIS
- 'C' DENOTES RIGHT OF CARRIAGEWAY, VW & LIS
- 'E' DENOTES EASEMENT FOR EMERGENCY EGRESS, VW & LIS
- VW DENOTES VARIABLE WIDTH
- LIS DENOTES LIMITED IN STRATUM

SURVEYOR
NAME: JOHN WALTON
DATE OF SURVEY:
REFERENCE: 5597-22DP

PLAN OF: SUBDIVISION OF
LOT 1 IN DP1199795

LGA: NORTHERN BEACHES
LOCALITY: BELROSE
Reduction Ratio: 1 : 300
Lengths are in metres

REGISTERED:

DRAFT DP



PO BOX 3222,
REDFERN NSW 2016
Ph: 02 8065 1156
Fax: 02 8065 1297
Email: survey@daw-walton.com.au

REVISION: 8
DATED:24-01-2025

DRAFT SUBDIVISION PLAN PREPARED FROM
ARCHITECTURAL PLANS BY URBANACORP,
ISSUE: 5, DATED: Dec 2024

BASEMENT 3

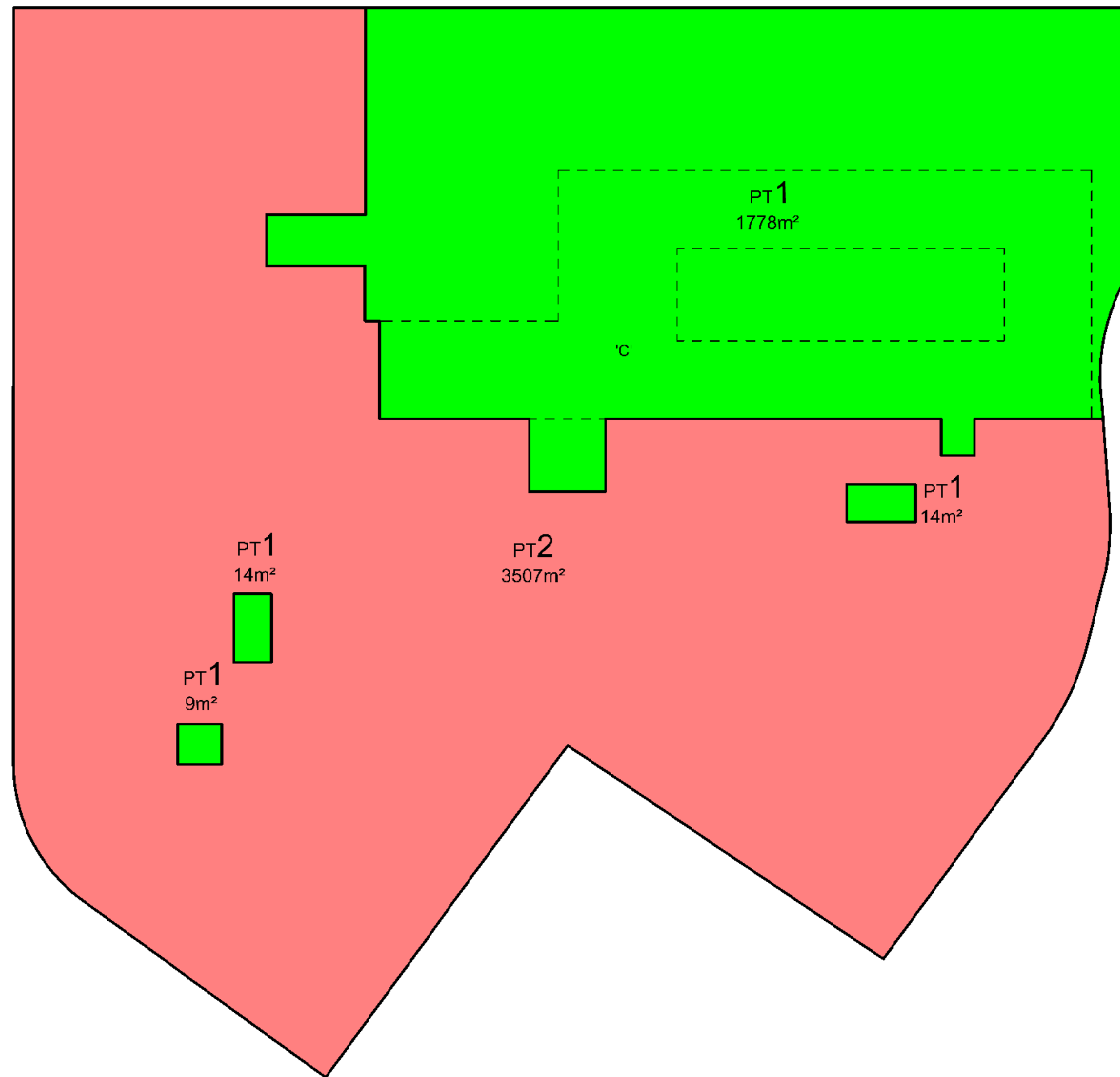
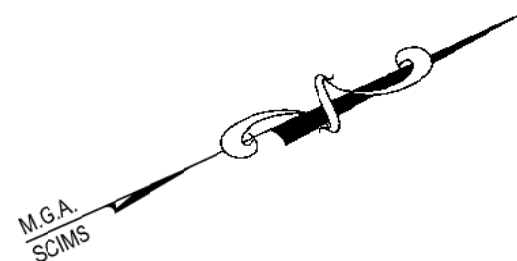

- DENOTES RETAIL LOT 1
- DENOTES RESIDENTIAL LOT 2

- 'A' DENOTES EASEMENT FOR ACCESS, VW & LIS
- 'C' DENOTES RIGHT OF CARRIAGEWAY, VW & LIS
- 'E' DENOTES EASEMENT FOR EMERGENCY EGRESS, VW & LIS
- VW DENOTES VARIABLE WIDTH
- LIS DENOTES LIMITED IN STRATUM

SURVEYOR
NAME: JOHN WALTON
DATE OF SURVEY:
REFERENCE: 5597-22DP

PLAN OF: SUBDIVISION OF
LOT 1 IN DP1199795

LGA: NORTHERN BEACHES
LOCALITY: BELROSE
Reduction Ratio: 1 : 300
Lengths are in metres

REGISTERED:

DRAFT DP



PO BOX 3222,
REDFERN NSW 2016
Ph: 02 8065 1156
Fax: 02 8065 1297
Email: survey@daw-walton.com.au

REVISION: 8
DATED:24-01-2025

DRAFT SUBDIVISION PLAN PREPARED FROM
ARCHITECTURAL PLANS BY URBANACORP,
ISSUE: 5, DATED: Dec 2024

BASEMENT 3

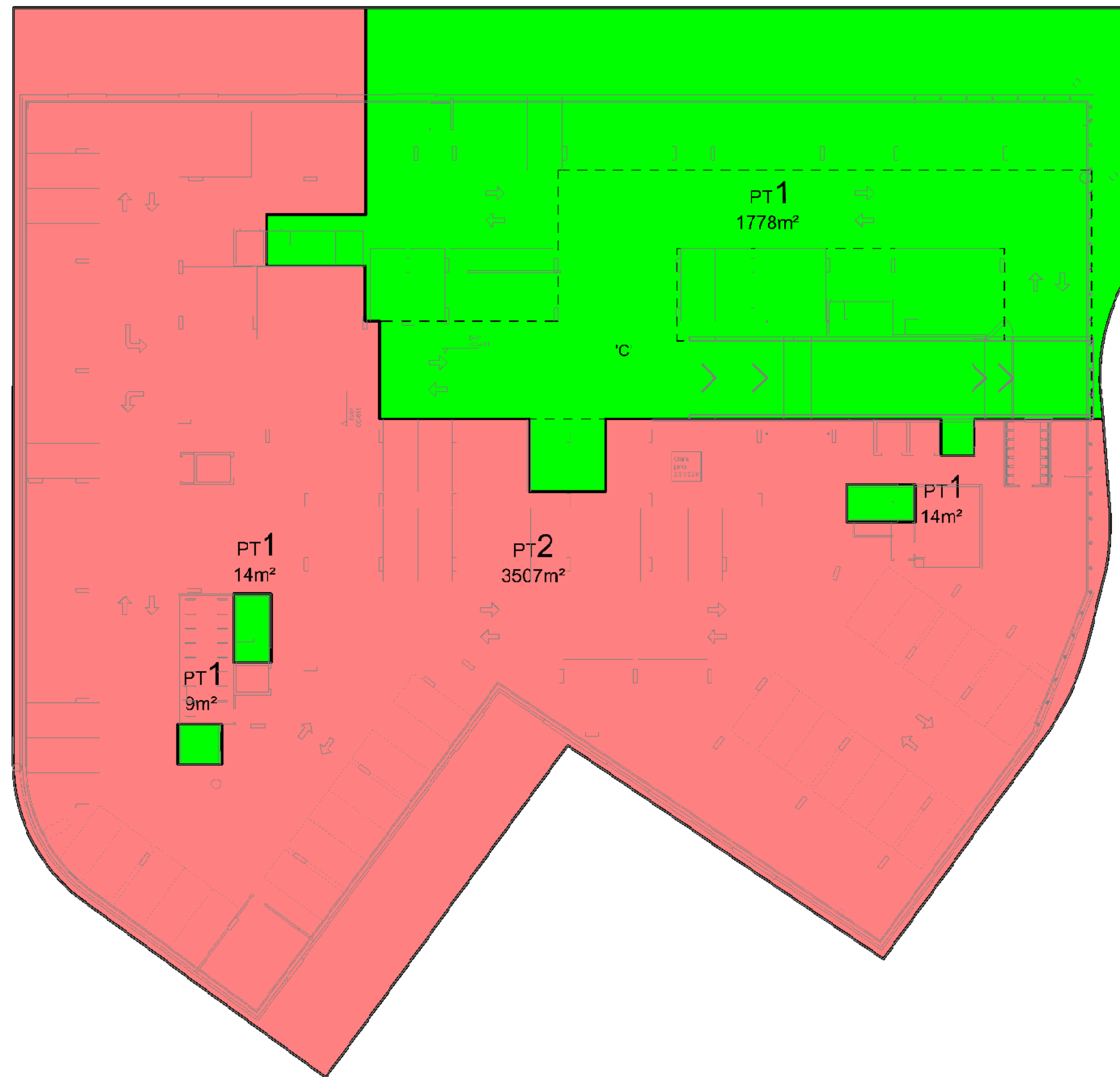
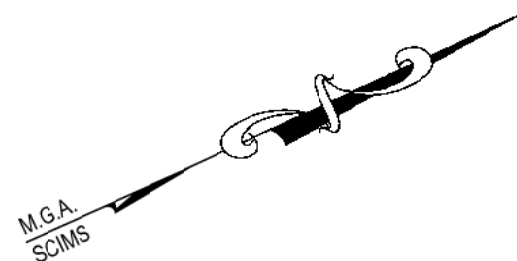

- DENOTES RETAIL LOT 1
- DENOTES RESIDENTIAL LOT 2

- 'A' DENOTES EASEMENT FOR ACCESS, VW & LIS
- 'C' DENOTES RIGHT OF CARRIAGEWAY, VW & LIS
- 'E' DENOTES EASEMENT FOR EMERGENCY EGRESS, VW & LIS
- VW DENOTES VARIABLE WIDTH
- LIS DENOTES LIMITED IN STRATUM

SURVEYOR
NAME: JOHN WALTON
DATE OF SURVEY:
REFERENCE: 5597-22DP

PLAN OF: SUBDIVISION OF
LOT 1 IN DP1199795

LGA: NORTHERN BEACHES
LOCALITY: BELROSE
Reduction Ratio: 1 : 300
Lengths are in metres

REGISTERED:

DRAFT DP



PO BOX 3222,
REDFERN NSW 2016
Ph: 02 8065 1156
Fax: 02 8065 1297
Email: survey@daw-walton.com.au

REVISION: 8
DATED: 24-01-2025

DRAFT SUBDIVISION PLAN PREPARED FROM
ARCHITECTURAL PLANS BY URBANACORP,
ISSUE: 5, DATED: Dec 2024

BASEMENT 2

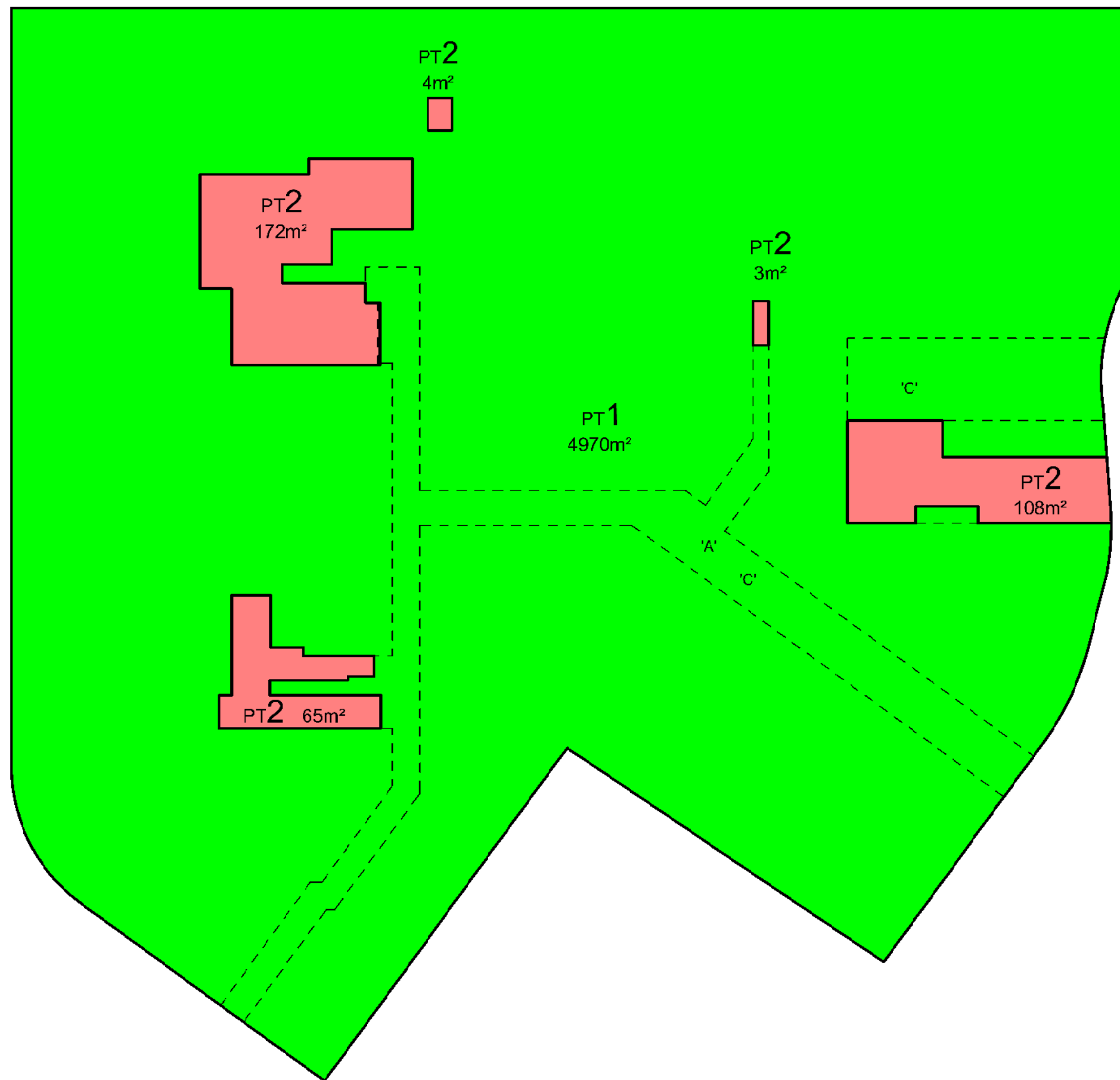
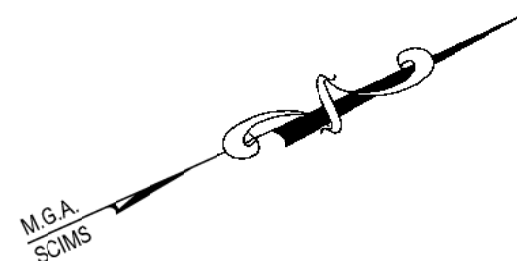

- DENOTES RETAIL LOT 1
- DENOTES RESIDENTAL LOT 2

- 'A' DENOTES EASEMENT FOR ACCESS, VW & LIS
- 'C' DENOTES RIGHT OF CARRIAGEWAY, VW & LIS
- 'E' DENOTES EASEMENT FOR EMERGENCY EGRESS, VW & LIS
- VW DENOTES VARIABLE WIDTH
- LIS DENOTES LIMITED IN STRATUM

SURVEYOR
NAME: JOHN WALTON
DATE OF SURVEY:
REFERENCE: 5597-22DP

PLAN OF: SUBDIVISION OF
LOT 1 IN DP1199795

LGA: NORTHERN BEACHES
LOCALITY: BELROSE
Reduction Ratio: 1 : 300
Lengths are in metres

REGISTERED:

DRAFT DP



PO BOX 3222,
REDFERN NSW 2016
Ph: 02 8065 1156
Fax: 02 8065 1297
Email: survey@daw-walton.com.au

REVISION: 8
DATED: 24-01-2025

DRAFT SUBDIVISION PLAN PREPARED FROM
ARCHITECTURAL PLANS BY URBANACORP,
ISSUE: 5, DATED: Dec 2024

BASEMENT 2

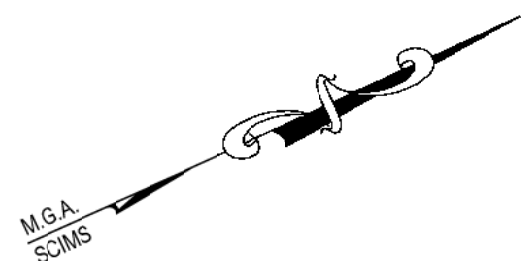

- DENOTES RETAIL LOT 1
- DENOTES RESIDENTAL LOT 2

- 'A' DENOTES EASEMENT FOR ACCESS, VW & LIS
- 'C' DENOTES RIGHT OF CARRIAGEWAY, VW & LIS
- 'E' DENOTES EASEMENT FOR EMERGENCY EGRESS, VW & LIS
- VW DENOTES VARIABLE WIDTH
- LIS DENOTES LIMITED IN STRATUM

SURVEYOR
NAME: JOHN WALTON
DATE OF SURVEY:
REFERENCE: 5597-22DP

PLAN OF: SUBDIVISION OF
LOT 1 IN DP1199795

LGA: NORTHERN BEACHES
LOCALITY: BELROSE
Reduction Ratio: 1 : 300
Lengths are in metres

REGISTERED:

DRAFT DP



PO BOX 3222,
REDFERN NSW 2016
Ph: 02 8065 1156
Fax: 02 8065 1297
Email: survey@daw-walton.com.au

REVISION: 8
DATED: 24-01-2025

DRAFT SUBDIVISION PLAN PREPARED FROM
ARCHITECTURAL PLANS BY URBANACORP,
ISSUE: 5, DATED: Dec 2024

LOWER GROUND

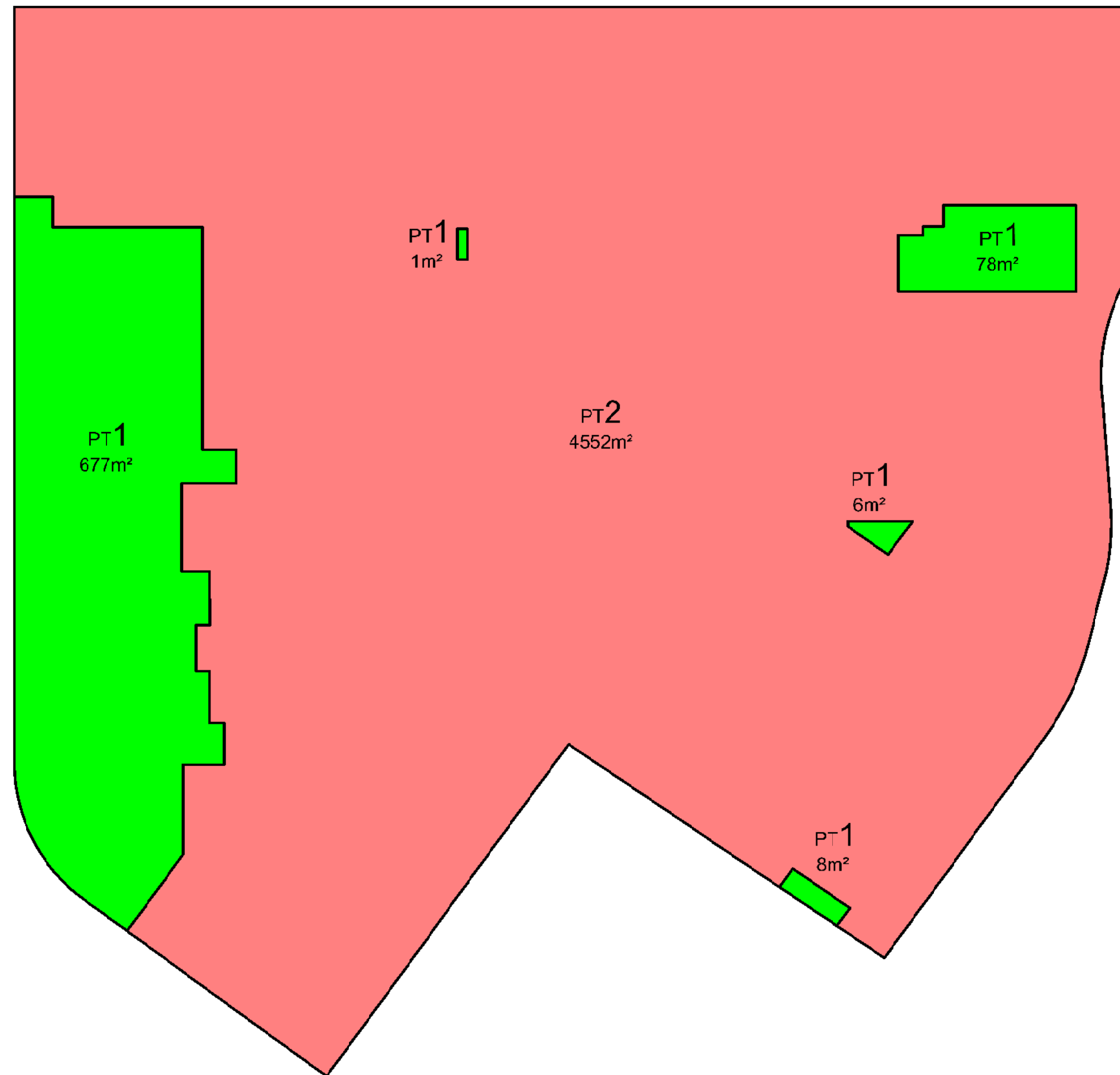
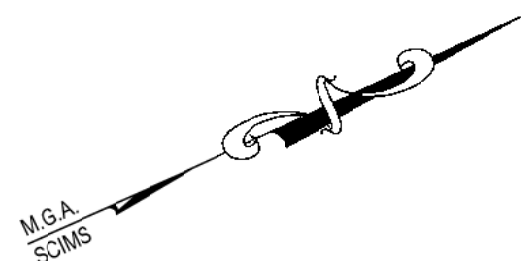

- DENOTES RETAIL LOT 1
- DENOTES RESIDENTIAL LOT 2

- 'A' DENOTES EASEMENT FOR ACCESS, VW & LIS
- 'C' DENOTES RIGHT OF CARRIAGEWAY, VW & LIS
- 'E' DENOTES EASEMENT FOR EMERGENCY EGRESS, VW & LIS
- VW DENOTES VARIABLE WIDTH
- LIS DENOTES LIMITED IN STRATUM

SURVEYOR
NAME: JOHN WALTON
DATE OF SURVEY:
REFERENCE: 5597-22DP

PLAN OF: SUBDIVISION OF
LOT 1 IN DP1199795

LGA: NORTHERN BEACHES
LOCALITY: BELROSE
Reduction Ratio: 1 : 300
Lengths are in metres

REGISTERED:

DRAFT DP



PO BOX 3222,
REDFERN NSW 2016
Ph: 02 8065 1156
Fax: 02 8065 1297
Email: survey@daw-walton.com.au

REVISION: 8
DATED: 24-01-2025

DRAFT SUBDIVISION PLAN PREPARED FROM
ARCHITECTURAL PLANS BY URBANACORP,
ISSUE: 5, DATED: Dec 2024

LOWER GROUND

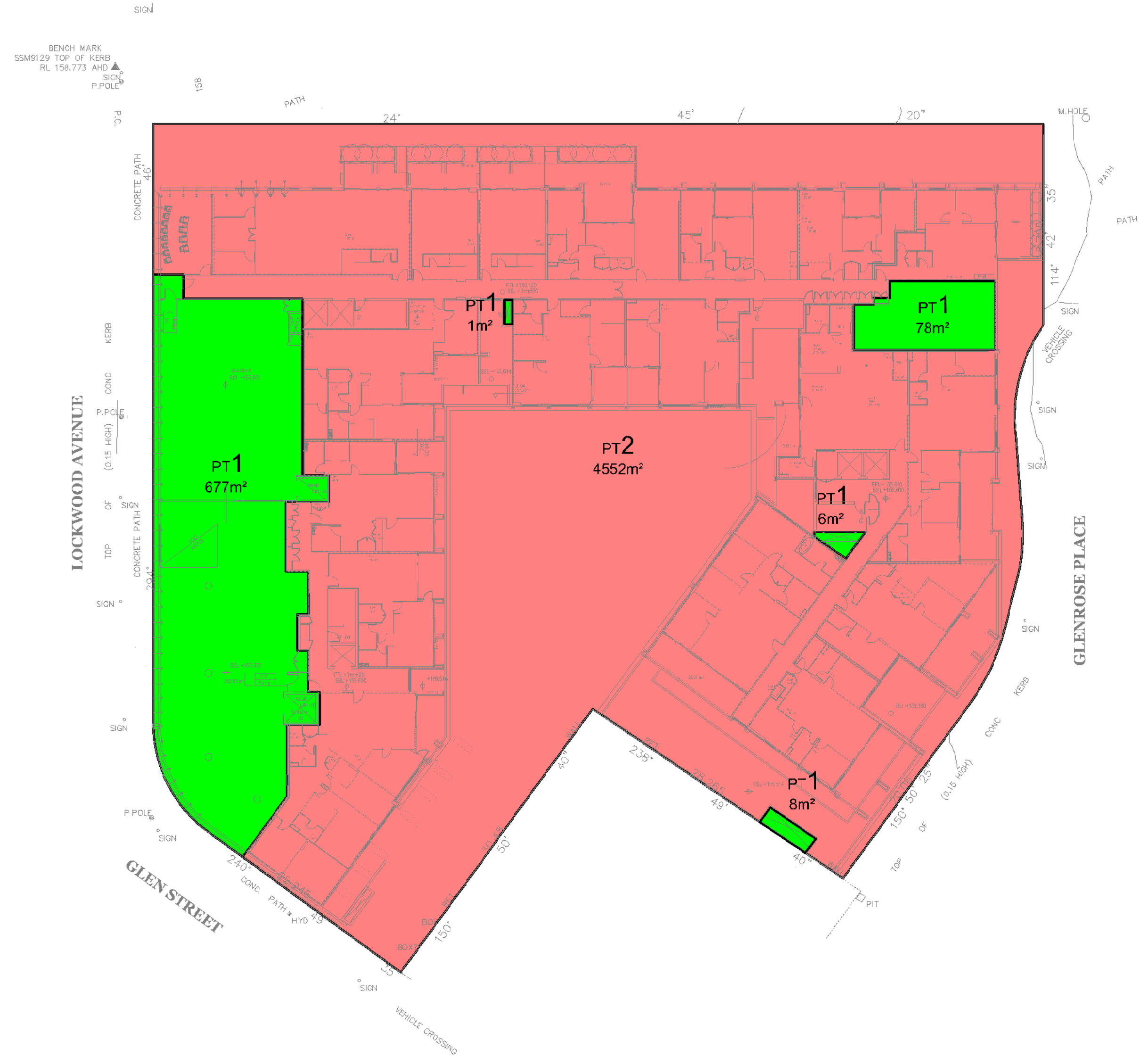
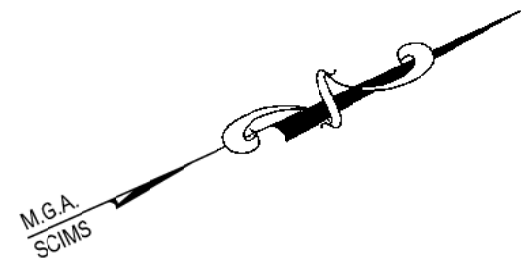

- DENOTES RETAIL LOT 1
- DENOTES RESIDENTIAL LOT 2

- 'A' DENOTES EASEMENT FOR ACCESS, VW & LIS
- 'C' DENOTES RIGHT OF CARRIAGEWAY, VW & LIS
- 'E' DENOTES EASEMENT FOR EMERGENCY EGRESS, VW & LIS
- VW DENOTES VARIABLE WIDTH
- LIS DENOTES LIMITED IN STRATUM

SURVEYOR
NAME: JOHN WALTON
DATE OF SURVEY:
REFERENCE: 5597-22DP

PLAN OF: SUBDIVISION OF
LOT 1 IN DP1199795

LGA: NORTHERN BEACHES
LOCALITY: BELROSE
Reduction Ratio: 1 : 300
Lengths are in metres

REGISTERED:

DRAFT DP



PO BOX 3222,
REDFERN NSW 2016
Ph: 02 8065 1156
Fax: 02 8065 1297
Email: survey@daw-walton.com.au

REVISION: 8
DATED: 24-01-2025

DRAFT SUBDIVISION PLAN PREPARED FROM
ARCHITECTURAL PLANS BY URBANACORP,
ISSUE: 5, DATED: Dec 2024

GROUND FLOOR

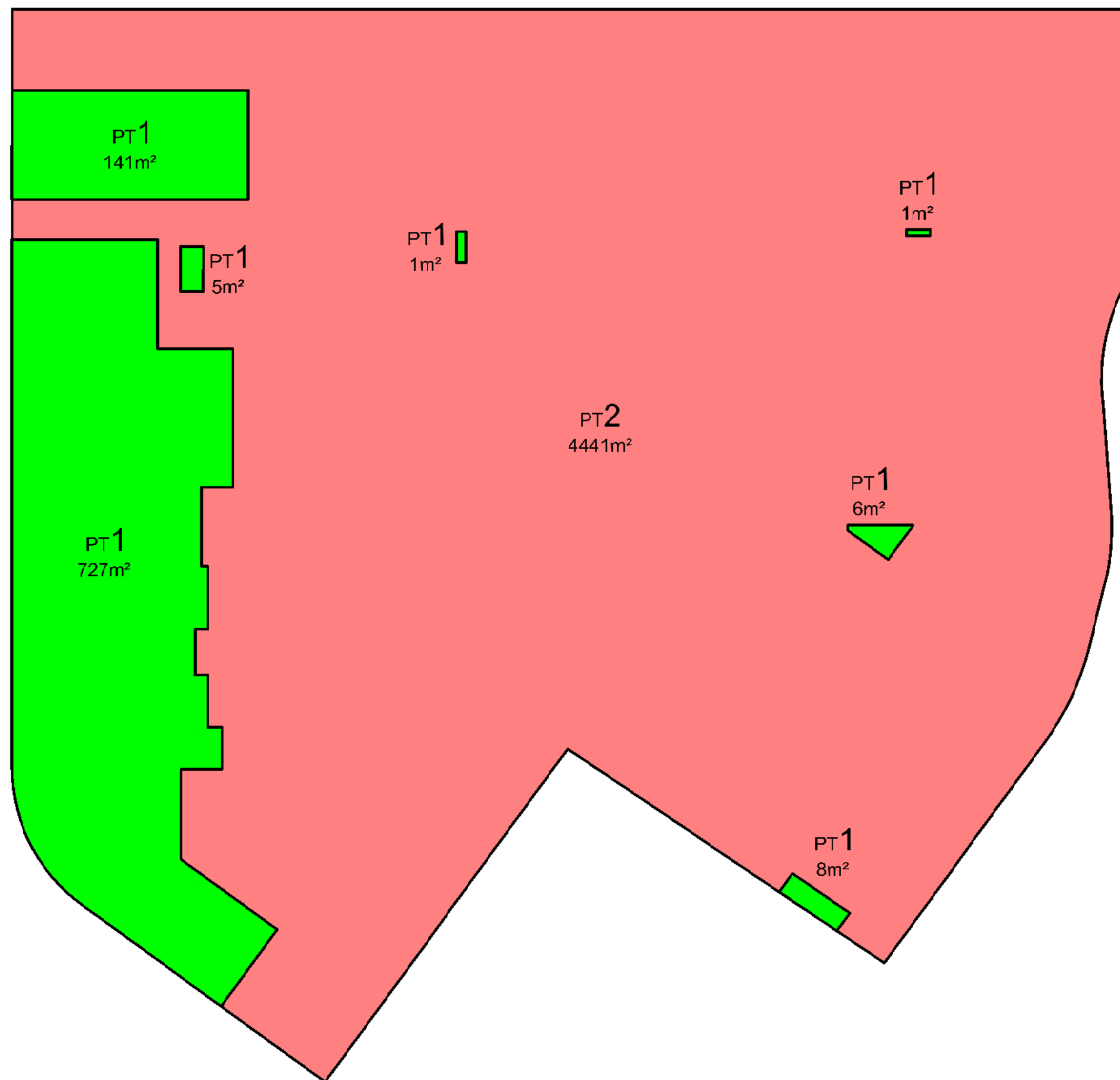
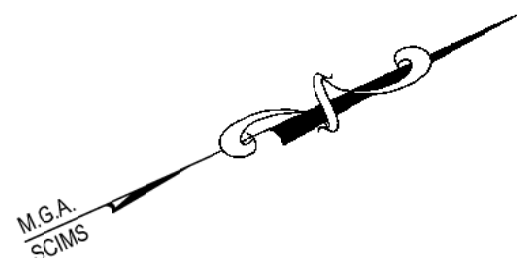

- DENOTES RETAIL LOT 1
- DENOTES RESIDENTIAL LOT 2

- 'A' DENOTES EASEMENT FOR ACCESS, VW & LIS
- 'C' DENOTES RIGHT OF CARRIAGEWAY, VW & LIS
- 'E' DENOTES EASEMENT FOR EMERGENCY EGRESS, VW & LIS
- VW DENOTES VARIABLE WIDTH
- LIS DENOTES LIMITED IN STRATUM

<p>SURVEYOR NAME: JOHN WALTON DATE OF SURVEY: REFERENCE: 5597-22DP</p>	<p>PLAN OF: SUBDIVISION OF LOT 1 IN DP1199795</p>	<p>LGA: NORTHERN BEACHES LOCALITY: BELROSE Reduction Ratio: 1 : 300 Lengths are in metres</p>	<p>REGISTERED:</p>
DRAFT DP			



PO BOX 3222,
REDFERN NSW 2016
Ph: 02 8065 1156
Fax: 02 8065 1297
Email: survey@daw-walton.com.au

REVISION: 8
DATED:24-01-2025

DRAFT SUBDIVISION PLAN PREPARED FROM
ARCHITECTURAL PLANS BY URBANACORP,
ISSUE: 5, DATED: Dec 2024

GROUND FLOOR

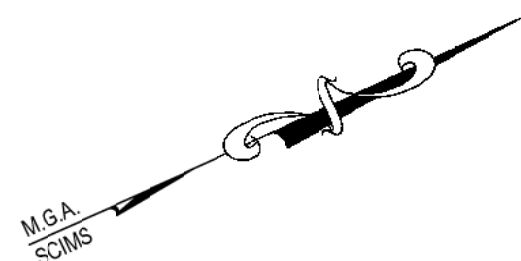

LOCKWOOD AVENUE

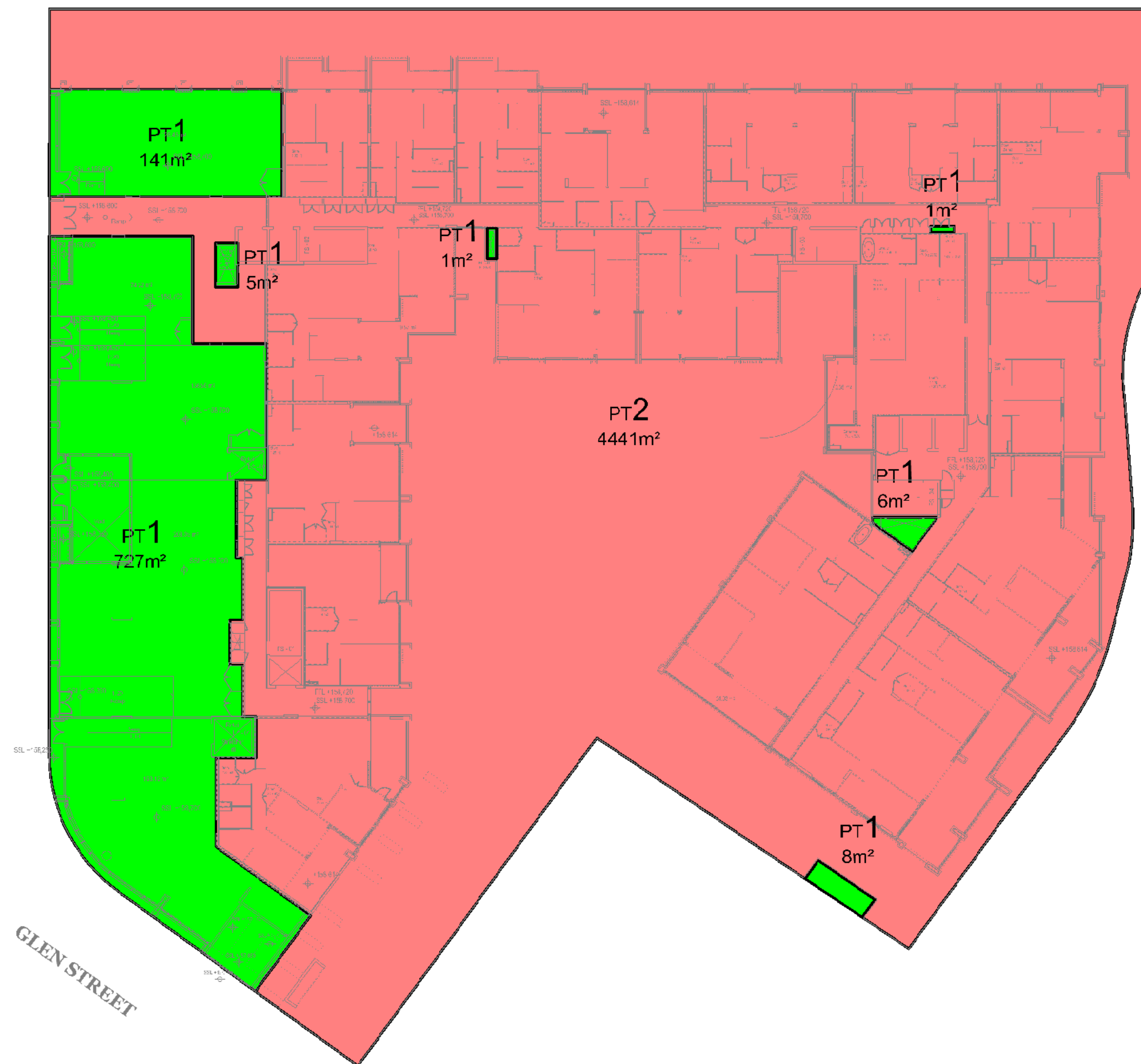

GLENROSE PLACE

GLEN STREET

- DENOTES RETAIL LOT 1
- DENOTES RESIDENTIAL LOT 2

- 'A' DENOTES EASEMENT FOR ACCESS, VW & LIS
- 'C' DENOTES RIGHT OF CARRIAGEWAY, VW & LIS
- 'E' DENOTES EASEMENT FOR EMERGENCY EGRESS, VW & LIS
- VW DENOTES VARIABLE WIDTH
- LIS DENOTES LIMITED IN STRATUM

SURVEYOR
NAME: JOHN WALTON
DATE OF SURVEY:
REFERENCE: 5597-22DP

PLAN OF: SUBDIVISION OF
LOT 1 IN DP1199795

LGA: NORTHERN BEACHES
LOCALITY: BELROSE
Reduction Ratio: 1 : 300
Lengths are in metres

REGISTERED:

DRAFT DP



PO BOX 3222,
REDFERN NSW 2016
Ph: 02 8065 1156
Fax: 02 8065 1297
Email: survey@daw-walton.com.au

REVISION: 8
DATED: 24-01-2025

DRAFT SUBDIVISION PLAN PREPARED FROM
ARCHITECTURAL PLANS BY URBANACORP,
ISSUE: 5, DATED: Dec 2024

LEVEL 1

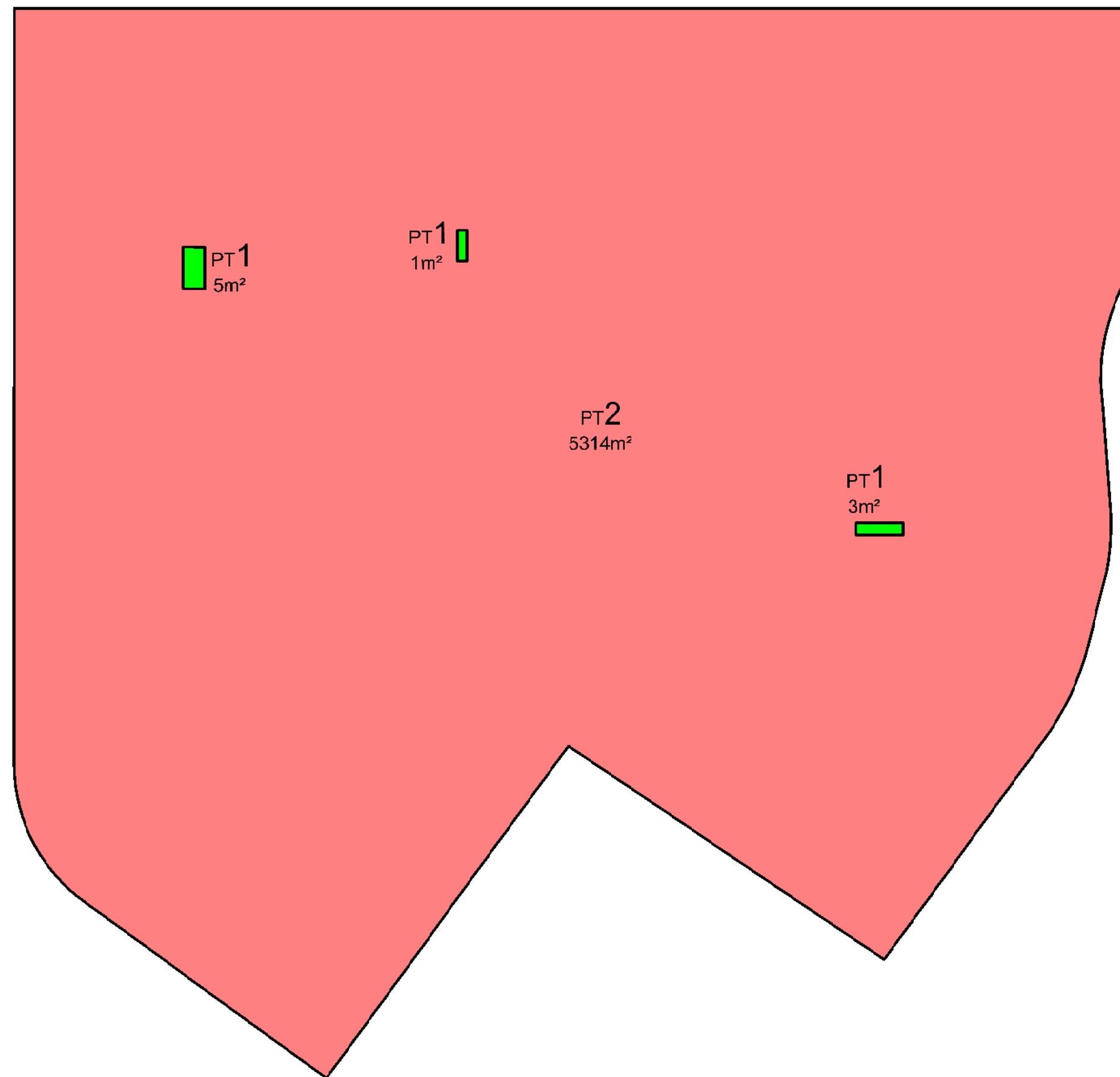
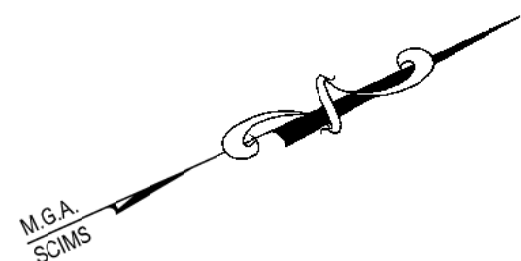

- DENOTES RETAIL LOT 1
- DENOTES RESIDENTIAL LOT 2

- 'A' DENOTES EASEMENT FOR ACCESS, VW & LIS
- 'C' DENOTES RIGHT OF CARRIAGEWAY, VW & LIS
- 'E' DENOTES EASEMENT FOR EMERGENCY EGRESS, VW & LIS
- VW DENOTES VARIABLE WIDTH
- LIS DENOTES LIMITED IN STRATUM

SURVEYOR
NAME: JOHN WALTON
DATE OF SURVEY:
REFERENCE: 5597-22DP

PLAN OF: SUBDIVISION OF
LOT 1 IN DP1199795

LGA: NORTHERN BEACHES
LOCALITY: BELROSE
Reduction Ratio: 1 : 300
Lengths are in metres

REGISTERED:

DRAFT DP



PO BOX 3222,
REDFERN NSW 2016
Ph: 02 8065 1156
Fax: 02 8065 1297
Email: survey@daw-walton.com.au

REVISION: 8
DATED: 24-01-2025

DRAFT SUBDIVISION PLAN PREPARED FROM
ARCHITECTURAL PLANS BY URBANACORP,
ISSUE: 5, DATED: Dec 2024

LEVEL 1

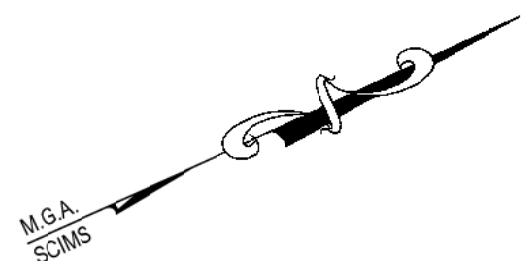

LOCKWOOD AVENUE



GLENROSE PLACE

GLEN STREET

- DENOTES RETAIL LOT 1
- DENOTES RESIDENTIAL LOT 2

- 'A' DENOTES EASEMENT FOR ACCESS, VW & LIS
- 'C' DENOTES RIGHT OF CARRIAGEWAY, VW & LIS
- 'E' DENOTES EASEMENT FOR EMERGENCY EGRESS, VW & LIS
- VW DENOTES VARIABLE WIDTH
- LIS DENOTES LIMITED IN STRATUM

SURVEYOR
NAME: JOHN WALTON
DATE OF SURVEY:
REFERENCE: 5597-22DP

PLAN OF: SUBDIVISION OF
LOT 1 IN DP1199795

LGA: NORTHERN BEACHES
LOCALITY: BELROSE
Reduction Ratio: 1 : 300
Lengths are in metres

REGISTERED:

DRAFT DP



PO BOX 3222,
REDFERN NSW 2016
Ph: 02 8065 1156
Fax: 02 8065 1297
Email: survey@daw-walton.com.au

REVISION: 8
DATED: 24-01-2025

DRAFT SUBDIVISION PLAN PREPARED FROM
ARCHITECTURAL PLANS BY URBANACORP,
ISSUE: 5, DATED: Dec 2024

ROOF AND ABOVE

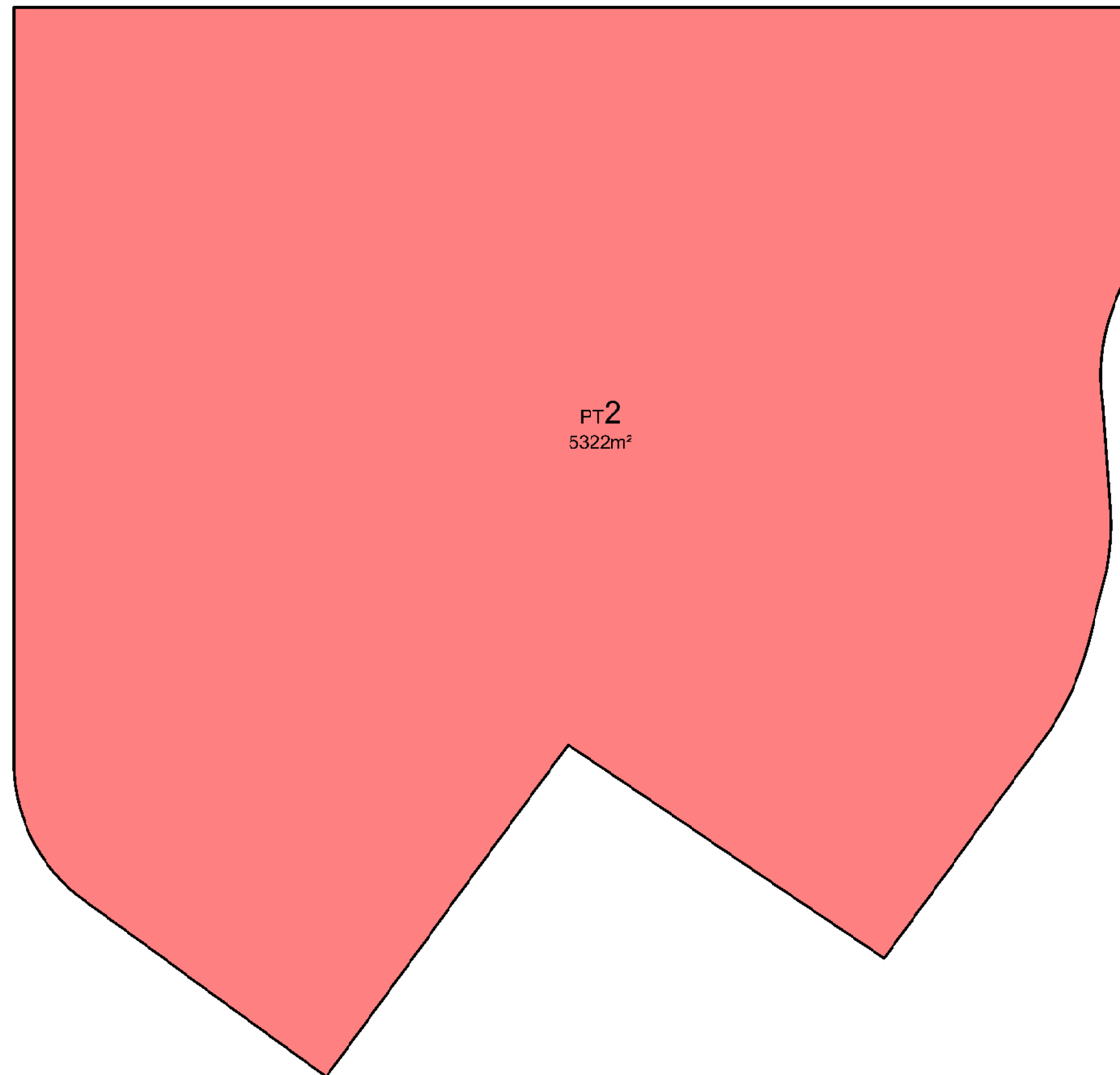
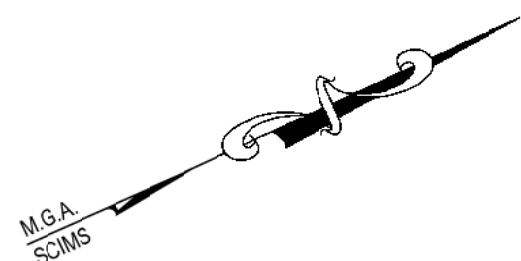

- DENOTES RETAIL LOT 1
- DENOTES RESIDENTAL LOT 2

- 'A' DENOTES EASEMENT FOR ACCESS, VW & LIS
- 'C' DENOTES RIGHT OF CARRIAGEWAY, VW & LIS
- 'E' DENOTES EASEMENT FOR EMERGENCY EGRESS, VW & LIS
- VW DENOTES VARIABLE WIDTH
- LIS DENOTES LIMITED IN STRATUM

SURVEYOR
NAME: JOHN WALTON
DATE OF SURVEY:
REFERENCE: 5597-22DP

PLAN OF: SUBDIVISION OF
LOT 1 IN DP1199795

LGA: NORTHERN BEACHES
LOCALITY: BELROSE
Reduction Ratio: 1 : 300
Lengths are in metres

REGISTERED:

DRAFT DP



PO BOX 3222,
REDFERN NSW 2016
Ph: 02 8065 1156
Fax: 02 8065 1297
Email: survey@daw-walton.com.au

REVISION: 8
DATED: 24-01-2025

DRAFT SUBDIVISION PLAN PREPARED FROM
ARCHITECTURAL PLANS BY URBANACORP,
ISSUE: 5, DATED: Dec 2024

ROOF AND ABOVE

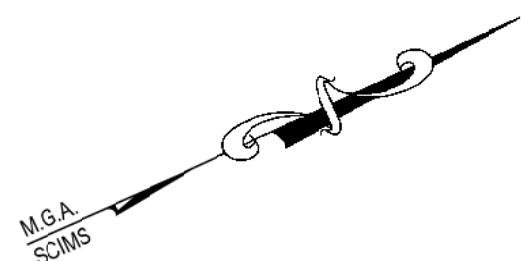

LOCKWOOD AVENUE

GLEN STREET

GLENROSE PLACE

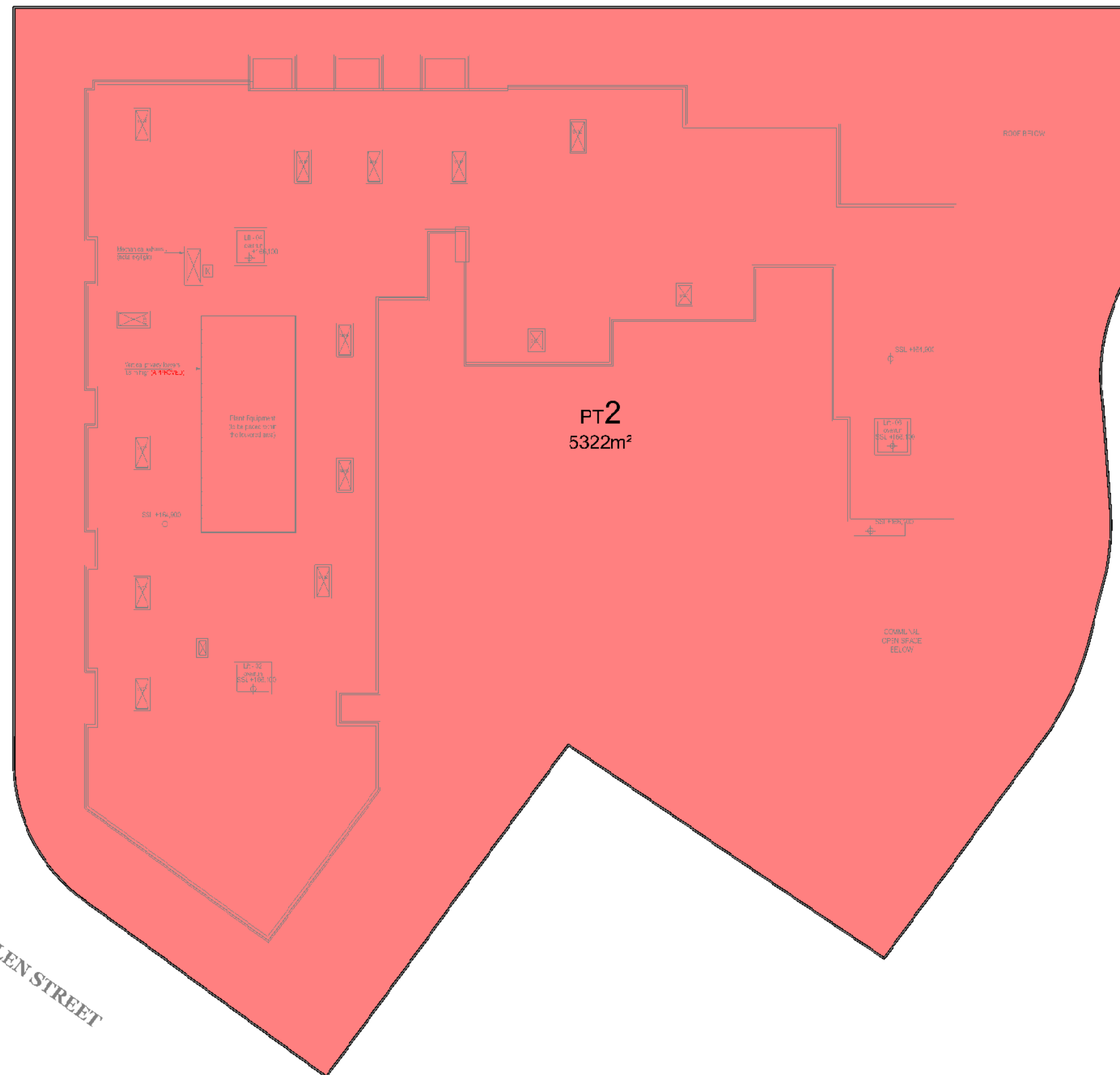

- DENOTES RETAIL LOT 1
- DENOTES RESIDENTIAL LOT 2

- 'A' DENOTES EASEMENT FOR ACCESS, VW & LIS
- 'C' DENOTES RIGHT OF CARRIAGEWAY, VW & LIS
- 'E' DENOTES EASEMENT FOR EMERGENCY EGRESS, VW & LIS
- VW DENOTES VARIABLE WIDTH
- LIS DENOTES LIMITED IN STRATUM

SURVEYOR
NAME: JOHN WALTON
DATE OF SURVEY:
REFERENCE: 5597-22DP

PLAN OF: **SUBDIVISION OF**
LOT 1 IN DP1199795

LGA: **NORTHERN BEACHES**
LOCALITY: **BELROSE**
Reduction Ratio: **1 : 300**
Lengths are in metres

REGISTERED:

DRAFT DP