

LEGEND

BENCH MARK	▲
TELSTRA PIT	■
POWER POLE	●
WATER METER	WM
SEWER MANHOLE	○
GAS METER	⊗



Samuel J Dewing No 8849
Registered Surveyor

All Correspondence to:
Suite 202, 2 Pembroke Street Epping 2121
P.O. Box 1150, Epping 1710
Tel: (02) 9668-4660
Email: epping.reception@burtonandfield.com.au

343 Hume Highway, Liverpool 2170
P.O. Box 242 Liverpool BC 1871
Tel: (02) 9602-1199
Email: survey@burtonandfield.com.au
Web: www.burtonandfield.com.au

CAUTION:
INFORMATION CONTAINED IN THIS PLAN IS THE COPYRIGHT OF BURTON AND FIELD PTY LIMITED. THE USE, DUPLICATION (WHETHER IN PART OR FULL) WITHOUT WRITTEN CONSENT OF BURTON AND FIELD PTY LIMITED CONSTITUTES AN INFRINGEMENT OF COPYRIGHT.

CLIENT: BUNGALOW HOMES

PROJECT: PLAN SHOWING DETAIL AND LEVELS OVER LOT 2 IN DP734942
No.11 COOLAWIN ROAD, AVALON BEACH, 2107

LGA: NORTHERN BEACHES

DATUM: AHD

SCALE: 1:200

COMP REF: J:\83447_C

REVISION

DRAWN: SD
CHECKED: BD

DATE: 22/09/21

SIZE: A2

REF: E6553-83447

SHEET 1 OF 1

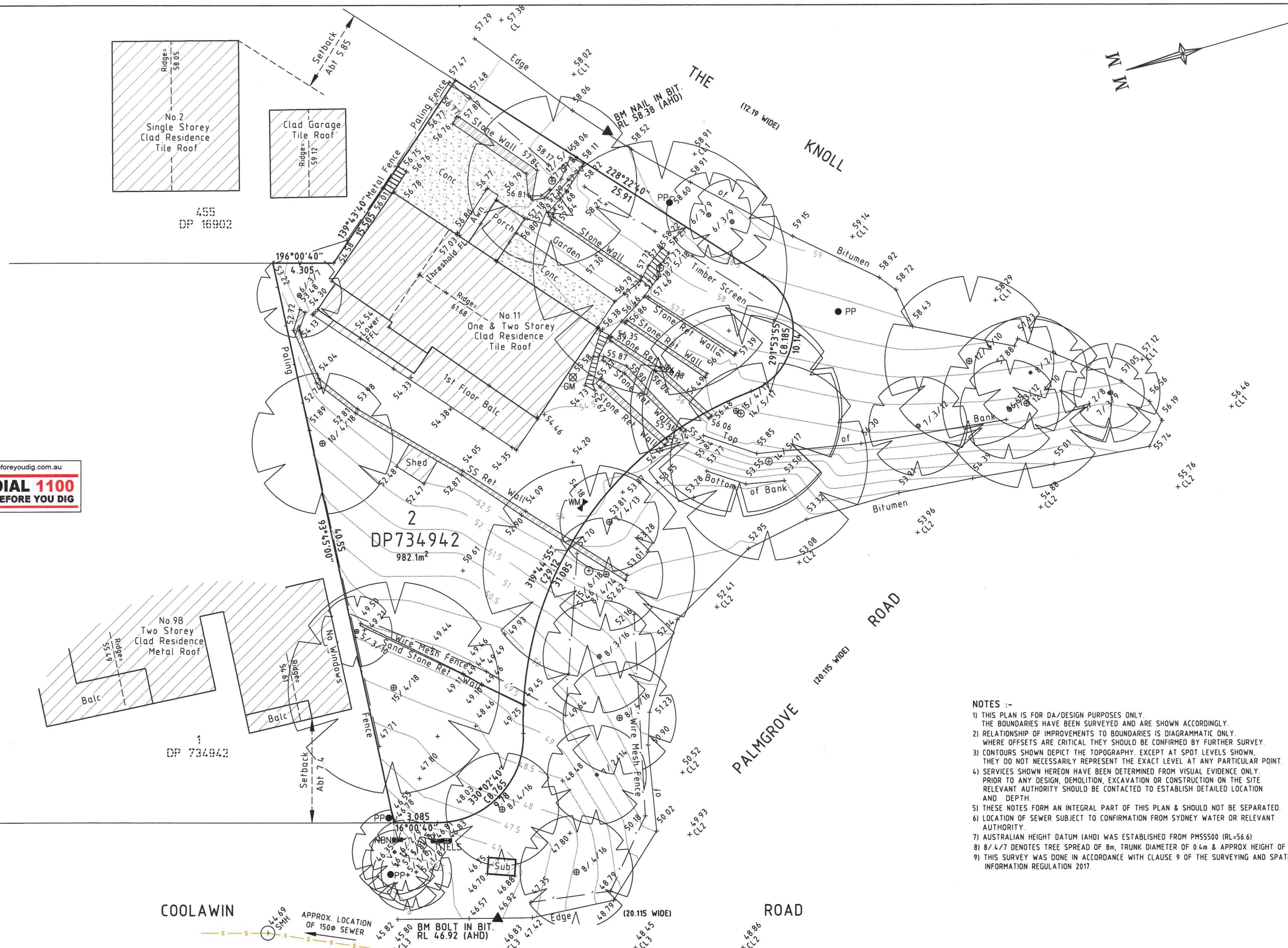

- NOTES :-**
- 1) THIS PLAN IS FOR DA/DESIGN PURPOSES ONLY. THE BOUNDARIES HAVE BEEN SURVEYED AND ARE SHOWN ACCORDINGLY.
 - 2) RELATIONSHIP OF IMPROVEMENTS TO BOUNDARIES IS DIAGRAMMATIC ONLY. WHERE OFFSETS ARE CRITICAL THEY SHOULD BE CONFIRMED BY FURTHER SURVEY.
 - 3) CONTOURS SHOWN DEPICT THE TOPOGRAPHY, EXCEPT AT SPOT LEVELS SHOWN. THEY DO NOT NECESSARILY REPRESENT THE EXACT LEVEL AT ANY PARTICULAR POINT.
 - 4) SERVICES SHOWN HEREON HAVE BEEN DETERMINED FROM VISUAL EVIDENCE ONLY. PRIOR TO ANY DESIGN, DEMOLITION, EXCAVATION OR CONSTRUCTION ON THE SITE RELEVANT AUTHORITY SHOULD BE CONTACTED TO ESTABLISH DETAILED LOCATION AND DEPTH.
 - 5) THESE NOTES FORM AN INTEGRAL PART OF THIS PLAN & SHOULD NOT BE SEPARATED.
 - 6) LOCATION OF SEWER SUBJECT TO CONFIRMATION FROM SYDNEY WATER OR RELEVANT AUTHORITY.
 - 7) AUSTRALIAN HEIGHT DATUM (AHD) WAS ESTABLISHED FROM PM55500 (RL=56.6)
 - 8) 8/4/7 DENOTES TREE SPREAD OF 8m, TRUNK DIAMETER OF 0.4m & APPROX HEIGHT OF 7m
 - 9) THIS SURVEY WAS DONE IN ACCORDANCE WITH CLAUSE 9 OF THE SURVEYING AND SPATIAL INFORMATION REGULATION 2017.