

Datum: Paved area at u/s of timber balcony Deck (●) R.L.133.80

Top of finished pool coping R.L.133.80 (or level with datum).

Proposed location of replacement tree as required under permit TA2019/0272.

Pool equipment to be located under timber balcony. Equipment to be housed in soundproof enclosure.

Proposed 1800H. privacy screen, to be in accordance with A.S 1926.1 - 2012 & the Swimming Pools Act, 1992.

Proposed in-ground reinforced concrete swimming pool with integral walkway surrounds.

Proposed 1200H. childproof safety fence with sc/sl gate, to be in accordance with A.S 1926.1 - 2012 & the Swimming Pools Act, 1992.

Approx. line of boards sewer.

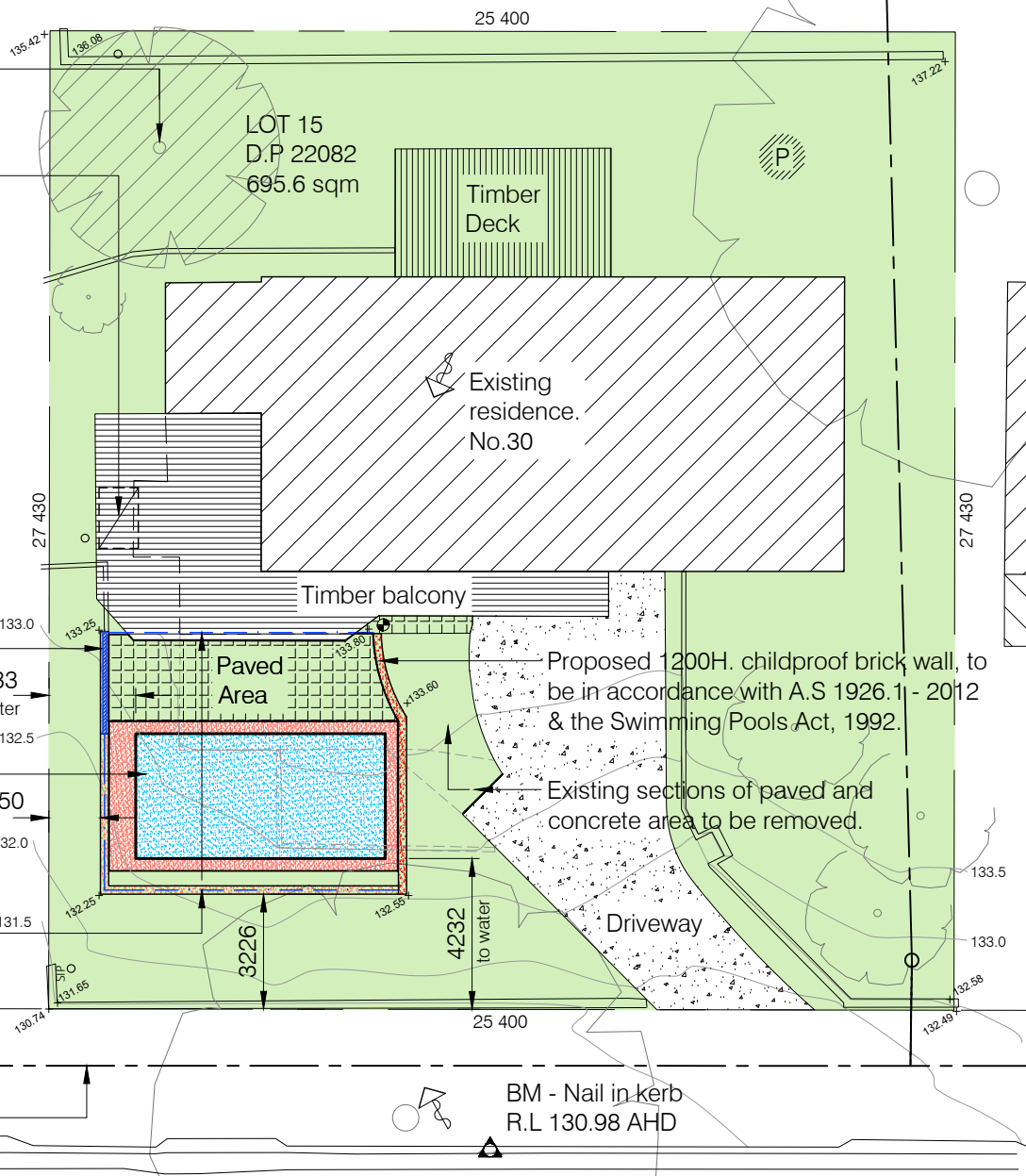

LANDSCAPED AREA CALCULATIONS

SITE AREA

Total Site Area..... 695.6 sqm

EXISTING HARD SURFACE AREA

Residence..... 145.0 sqm
 Timber balcony (>1.0m above n.g.l)..... 43.0 sqm
 Driveway..... 56.5 sqm

PROPOSED HARD SURFACE AREA

Proposed pool & surrounds..... 34.0 sqm
 Total hard surface area..... 278.5 sqm
 % of hard surface area is 278.4 / 695.6..... 39.9%

EXISTING HARD SURFACE AREA - VARIATIONS

Timber deck (<1.0m above n.g.l)..... 21.8 sqm
 Paved area..... 19.1 sqm
 Total hard surface area variation..... 40.9 sqm
 % of hard surface area variation is 40.9 / 695.6... 5.9%

PROPOSED LANDSCAPED AREA

Pervious / landscaped area..... 377.0 sqm
 Hard surface area variations..... 40.9 sqm
 Total landscaped area..... 417.9 sqm
 % of landscaped area is 417.9 / 695.6..... 60.1%
 Minimum required LANDSCAPED AREA = 60%

**TOTAL POOL VOLUME = 27,000 LT
 POOL VOLUME LESS THAN 40,000 LT THEREFORE
 EXEMPT FROM BASIX REQUIREMENTS**

Plan prepared by:

POOL PLANS BY DESIGN

A.B.N 86375033089 P.O Box 585, Ryde NSW 1680 PH:0405 255 779

TERAMA STREET

SITE PLAN / SITE ANALYSIS PLAN

SYMBOL LEGEND

- Private open space
- Prevailing winds
- Noise source
- Existing ground spot levels

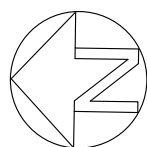

REVISION	DESCRIPTION	DATE		
SITE PLAN & SITE ANALYSIS PLAN				
PROPOSED SWIMMING POOL WOODLINE CONSTRUCTIONS LOT 15 DP 222082 No.30 TERAMA STREET, BILGOLA PLATEAU				
DRAWN BY	DATE	SCALE	DWG. No.	JOB No.
G.P	25-07-19	1:200 @ A3	DA-01	P06-19

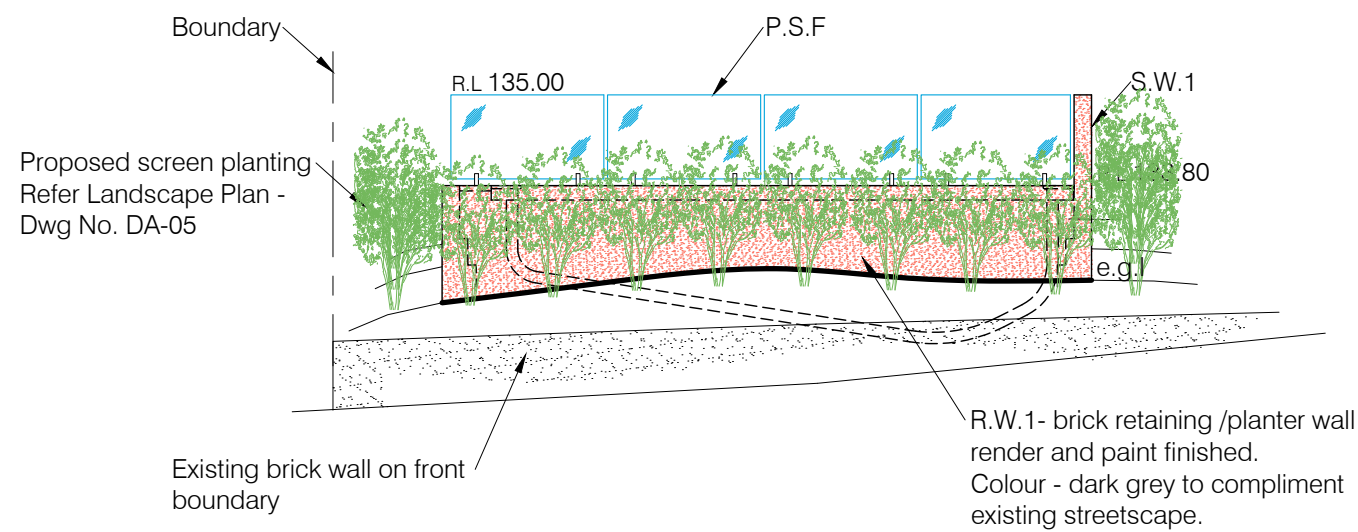

WESTERN ELEVATION

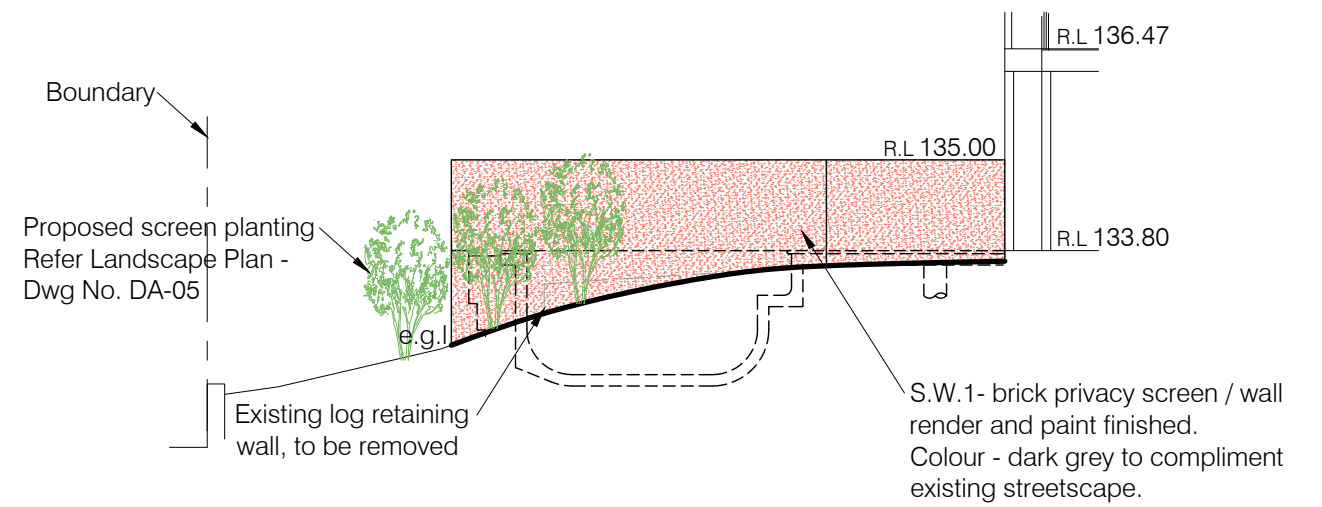

SOUTHERN ELEVATION

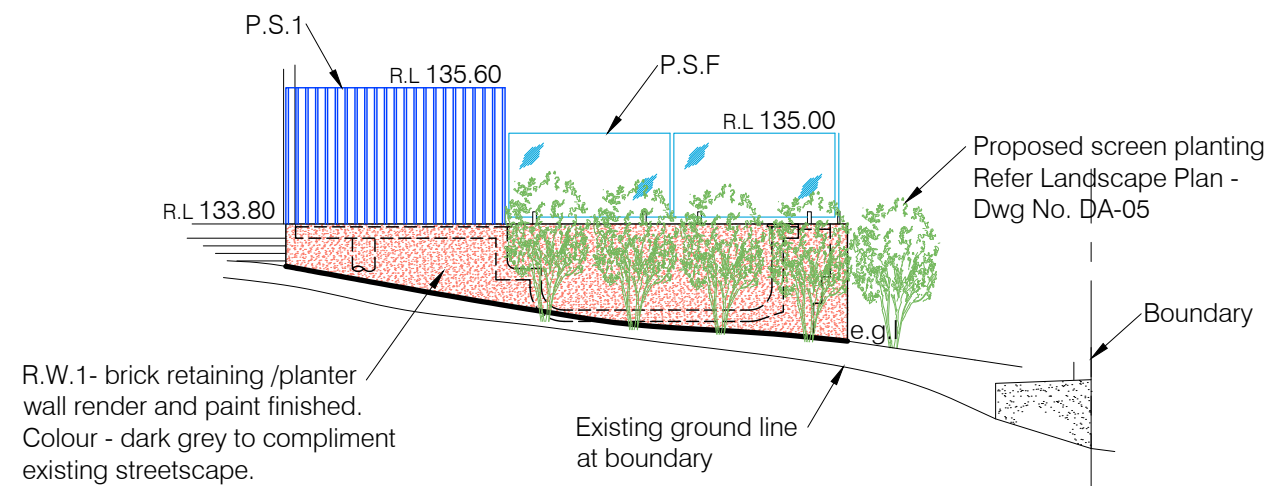

NORTHERN ELEVATION

Plan prepared by:

POOL PLANS BY DESIGN

A.B.N 86375033089 P.O Box 585, Ryde NSW 1680 PH:0405 255 779

REVISION	DESCRIPTION	DATE		
ELEVATIONS				
PROPOSED SWIMMING POOL WOODLINE CONSTRUCTIONS LOT 15 DP 222082 No.30 TERAMA STREET, BILGOLA PLATEAU				
DRAWN BY	DATE	SCALE	DWG. No.	JOB No.
G.P	01-08-19	1:100 @ A3	DA-03	P06-19

Datum: Paved area at u/s of timber balcony Deck (●) R.L.133.80

Top of finished pool coping R.L.133.80 (or level with datum).

Proposed location of replacement tree as required under permit TA2019/0272.

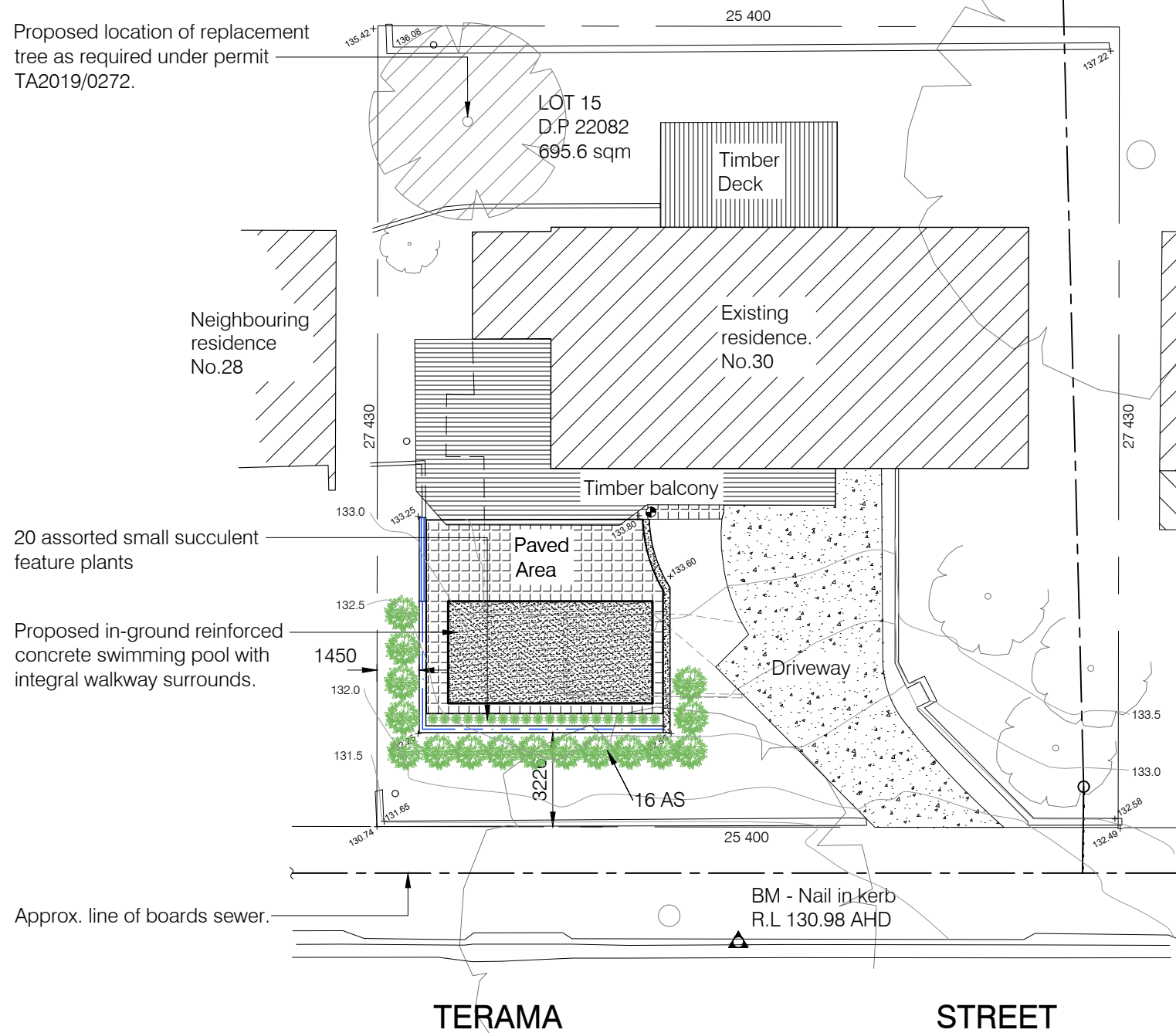

LANDSCAPE PLAN

SYMBOL LEGEND

130.00+ Existing ground spot levels

PLANTING SCHEDULE

CODE	SPECIES	COMMON NAME	POT SIZE	HEIGHT	NUMBER
VT	<i>Viburnum tinus</i>	Laurustinus	300mm	2 - 3m	16

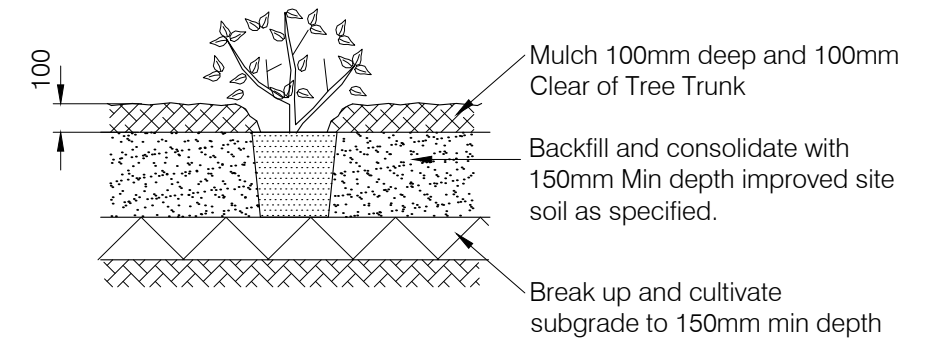
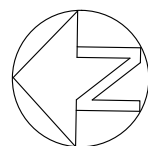

TYPICAL PLANTING DETAIL

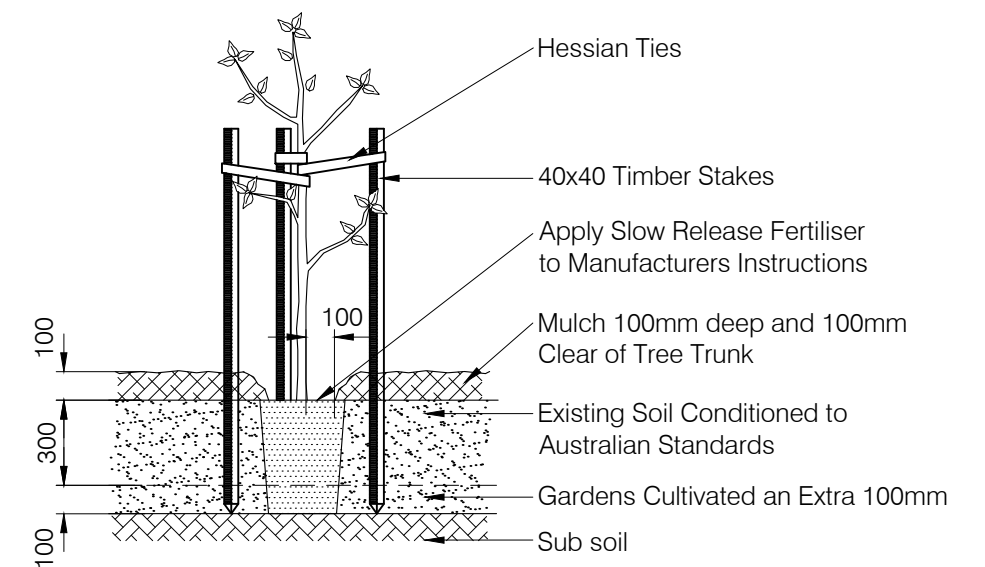

TYPICAL PLANTING DETAIL

Plan prepared by:

POOL PLANS BY DESIGN

A.B.N 86375033089 P.O Box 585, Ryde NSW 1680 PH:0405 255 779

REVISION	DESCRIPTION	DATE		
LANDSCAPE PLAN				
PROPOSED SWIMMING POOL				
WOODLINE CONSTRUCTIONS				
LOT 15 DP 222082				
No.30 TERAMA STREET, BILGOLA PLATEAU				
DRAWN BY	DATE	SCALE	DWG. No.	JOB No.
G.P	01-08-19	1:200 @ A3	DA-05	P06-19