

# Capella

307 Sydney Road & 12 Boyle Street, Balgowlah

**LANDSCAPE ARCHITECTURE - S4.56 PACKAGE**

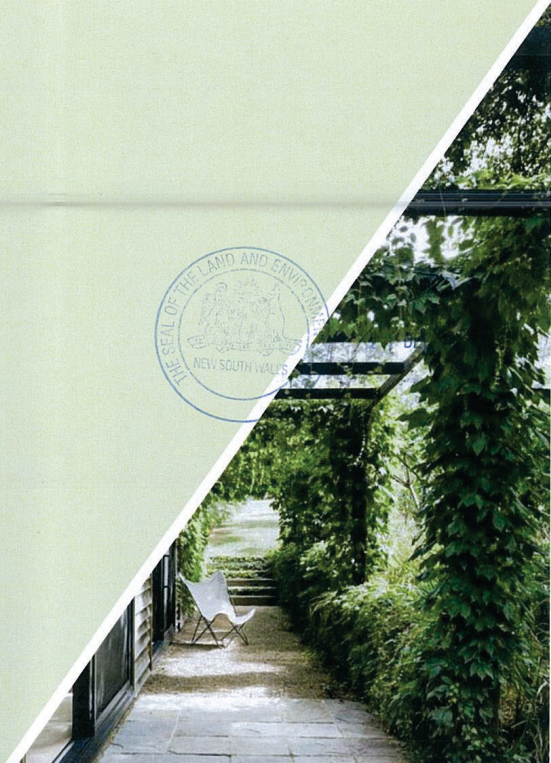

**DR**

# BOYLE STREET

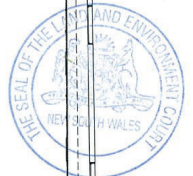
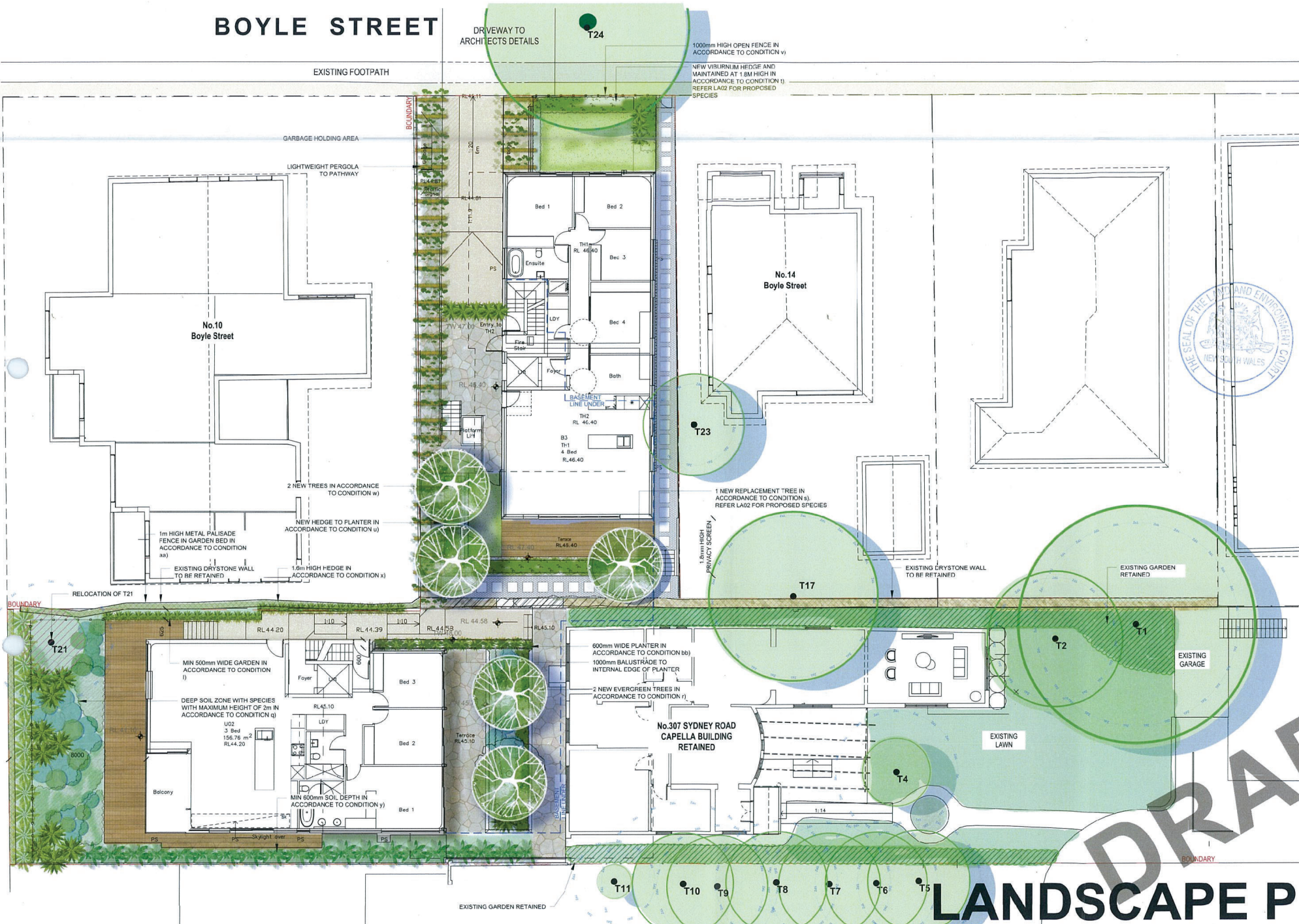

FILED ON  
21 DEC 2022

DRAFT

# LANDSCAPE PLAN

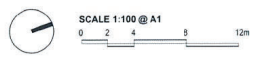

**LEGEND**

SITE BOUNDARY	PROPOSED TURF	PROPOSED CHAZY PAVING	PROPOSED TREE	PROPOSED SHRUBS	PROPOSED GROUNDCOVERS
EXISTING TREE RETAINED (T24 SHOWN IN BLUE)	TERRACE DECK	STONE STEPPERS IN GRAVEL	EXISTING TREE	EXISTING SHRUBS	

project: Capella 307 Sydney Rd, 12 Boyle St, Eastgawah  
 client: Sun Property Group  
 date: 23.06.2022  
 revision: C  
 drawn: CS  
 checked: DMT

**TaylorBrammer**  
 TAYLOR BRAMMER LANDSCAPE ARCHITECTS PTY LTD  
 SYDNEY STUDIO  
 2/15 Market Street, Sydney, NSW 2000  
 t: 61 2 9247 8800  
 e: info@taylorbrammer.com.au  
 www.taylorbrammer.com.au

LA01

# BOYLE STREET

DRIVEWAY TO ARCHITECTS DETAILS

T24

1000mm HIGH OPEN FENCE IN ACCORDANCE TO CONDITION v)

NEW VIRBURNUM HEDGE AND MAINTAINED AT 1.8M HIGH IN ACCORDANCE TO CONDITION t), REFER LA02 FOR PROPOSED SPECIES

EXISTING FOOTPATH

GARBAGE HOLDING AREA

LIGHTWEIGHT PERGOLA TO PATHWAY

BOUNDARY

30 Popsa

12 Popsa

12 Popsa

12 Popsa

12 Popsa

12 Popsa

12 Popsa

12 Popsa

12 Popsa

12 Popsa

12 Popsa

12 Popsa

12 Popsa

12 Popsa

12 Popsa

12 Popsa

12 Popsa

12 Popsa

12 Popsa

12 Popsa

12 Popsa

12 Popsa

12 Popsa

12 Popsa

12 Popsa

12 Popsa

12 Popsa

12 Popsa

12 Popsa

12 Popsa

12 Popsa

12 Popsa

12 Popsa

12 Popsa

12 Popsa

12 Popsa

12 Popsa

12 Popsa

12 Popsa

12 Popsa

12 Popsa

12 Popsa

12 Popsa

12 Popsa

12 Popsa

12 Popsa

12 Popsa

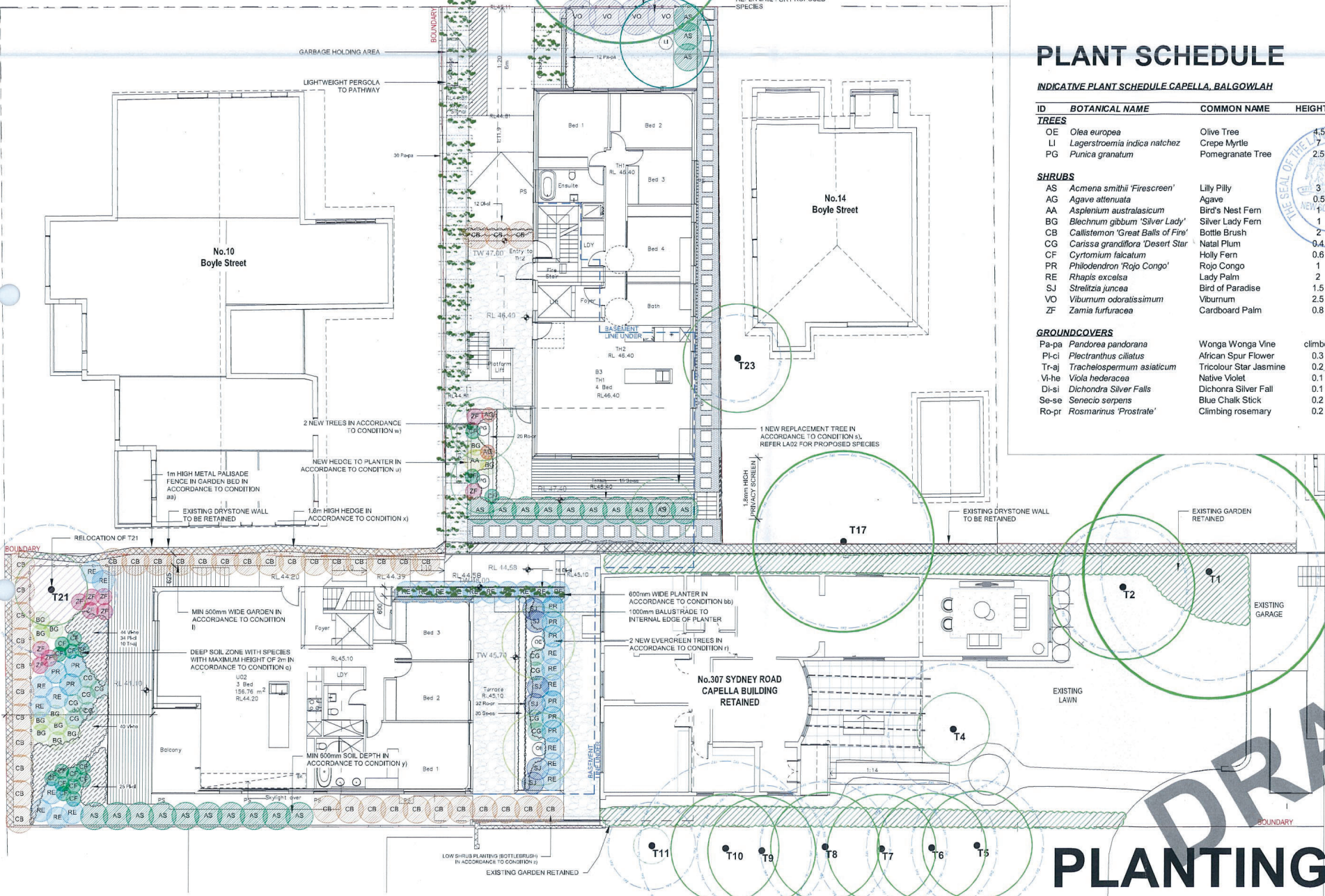

## PLANT SCHEDULE

INDICATIVE PLANT SCHEDULE CAPELLA, BALGOWLAH

ID	BOTANICAL NAME	COMMON NAME	HEIGHT (m)	SIZE	QUANTITY
<b>TREES</b>					
OE	<i>Olea europaea</i>	Olive Tree	4.5	100L	2
LI	<i>Lagerstroemia indica natchez</i>	Crepe Myrtle	7	100L	1
PG	<i>Punica granatum</i>	Pomegranate Tree	2.5	75L	3
<b>SHRUBS</b>					
AS	<i>Acmena smithii 'Firescreen'</i>	Lilly Pilly	3	45L	24
AG	<i>Agave attenuata</i>	Agave	0.5	300mm	1
AA	<i>Asplenium australasicum</i>	Bird's Nest Fern		300mm	1
BG	<i>Blechnum gibbum 'Silver Lady'</i>	Silver Lady Fern	1	300mm	11
CB	<i>Callistemon 'Great Balls of Fire'</i>	Bottle Brush	2	45L	40
CG	<i>Carissa grandiflora 'Desert Star'</i>	Natal Plum	0.4	300mm	10
CF	<i>Cyrtomium falcatum</i>	Holly Fern	0.6	300mm	17
PR	<i>Philodendron 'Rojo Congo'</i>	Rojo Congo	1	300mm	9
RE	<i>Rhapis excelsa</i>	Lady Palm	2	300mm	26
SJ	<i>Strelitzia juncea</i>	Bird of Paradise	1.5	300mm	6
VO	<i>Viburnum odoratissimum</i>	Viburnum	2.5	45L	4
ZF	<i>Zamia furfuracea</i>	Cardboard Palm	0.8	300mm	10
<b>GROUNDCOVERS</b>					
Pa-pa	<i>Pandorea pandorana</i>	Wonga Wonga Vine	climber	150mm	42
Pl-ci	<i>Plectranthus ciliatus</i>	African Spur Flower	0.3	150mm	59
Tr-aj	<i>Trachelospermum asiaticum</i>	Tricolour Star Jasmine	0.2	150mm	10
Vi-he	<i>Viola hederacea</i>	Native Violet	0.1	150mm	84
Di-si	<i>Dichondra Silver Falls</i>	Dichondra Silver Fall	0.1	100mm	28
Se-se	<i>Senecio serpens</i>	Blue Chalk Stick	0.2	100mm	45
Ro-pr	<i>Rosmarinus 'Prostrate'</i>	Climbing rosemary	0.2	100mm	52

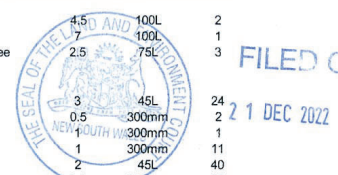

FILED C J

21 DEC 2022

DRAFT

# PLANTING PLAN

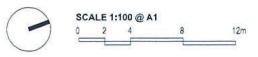

**LEGEND**

	SITE BOUNDARY		PROPOSED SHRUBS		PROPOSED GROUNDCOVERS
	EXISTING TREE RETAINED		PROPOSED TREE		

project: Capella 307 Sydney Rd, 12 Boyle St, Balgowlah  
 client: Sun Property Group  
 date: 14.08.2022  
 revision: 8  
 drawn: CS  
 checked: DMT

**TaylorBrammer**  
 TAYLOR BRAMMER LANDSCAPE ARCHITECTS PTY LTD  
 310/311/312  
 118 Victoria Road, Balgowlah, NSW, 2221  
 Sydney, Australia  
 1 81 2 3037 8455  
 48881 028 734 941

LA02

EXISTING TREES SCHEDULE

Tree ID	Botanical Name (Common Name)	Height
1	Himalayan Cedar ( <i>Cedrus deodora</i> )	6
2	Laurustinus ( <i>Viburnum tinus</i> )	4
3	Sasanqua Camellia ( <i>Camellia sasanqua</i> )	4
4	Sasanqua Camellia ( <i>Camellia sasanqua</i> )	3
5	Cripps' False Cypress ( <i>Chamaecyparis obtusa 'Crippsii'</i> )	4
6	Cripps' False Cypress ( <i>Chamaecyparis obtusa 'Crippsii'</i> )	4
7	Cripps' False Cypress ( <i>Chamaecyparis obtusa 'Crippsii'</i> )	4
8	Cripps' False Cypress ( <i>Chamaecyparis obtusa 'Crippsii'</i> )	4
9	Cripps' False Cypress ( <i>Chamaecyparis obtusa 'Crippsii'</i> )	5
10	Sasanqua Camellia ( <i>Camellia sasanqua</i> )	4
11	Japanese Camellia ( <i>Camellia japonica</i> )	2
12	Monteret Cypress ( <i>Cupressus macrocarpa 'cv'</i> )	6
13	Monteret Cypress ( <i>Cupressus macrocarpa 'cv'</i> )	7
14	Monteret Cypress ( <i>Cupressus macrocarpa 'cv'</i> )	7
15	River Peppermint ( <i>Eucalyptus elata</i> )	11
16	Canary Island Date Palm ( <i>Phoenix canariensis</i> )	11
17	Frangipani ( <i>Plumeria acutifolia</i> )	4
18	Bangalow Palm ( <i>Archontophoenix sp.</i> )	12
19	Old Man Banksia ( <i>Banksia serrata</i> )	4
20	Ponytail Palm ( <i>Beccarinnia recurvata</i> )	3
21	Tree Aloe ( <i>Aloidendrum barberae</i> )	4
22	Weeping Bottlebrush ( <i>Callistemon viminalis</i> )	5
23	Scarlet Bottlebrush ( <i>Callistemon citrinus</i> )	5
24	Australian Red Cedar ( <i>Toona ciliata</i> )	8

FILED ON  
21 DEC 2022

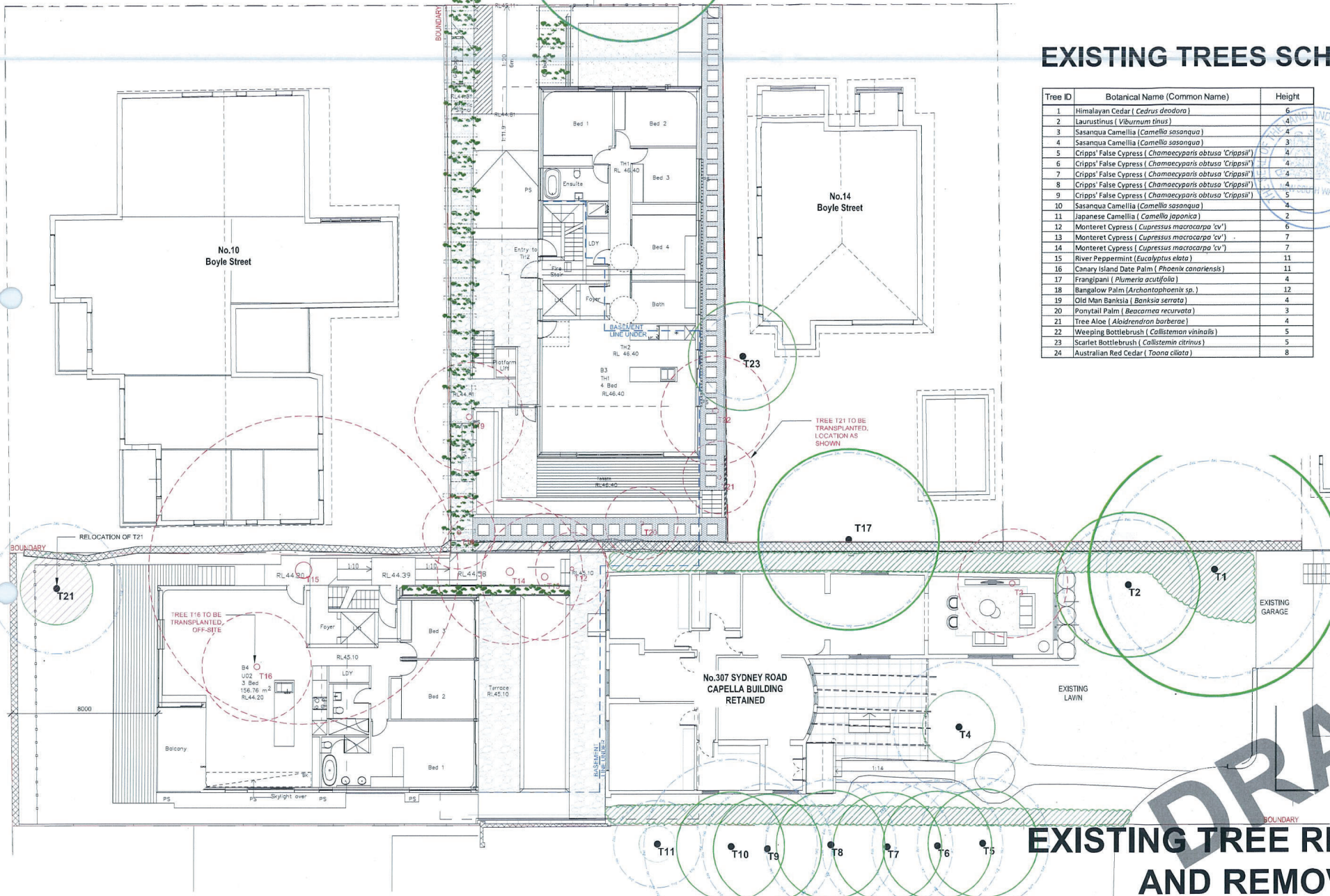
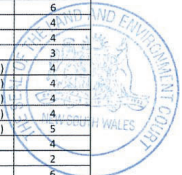

DRAFT

EXISTING TREE RETENTION AND REMOVAL PLAN

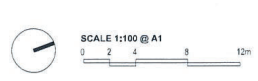

project: Capella 307 Sydney Rd, 12 Boyle St, Balgowlah  
 client: Sun Property Group  
 date: 14.06.2022  
 revision: A  
 drawn: CS  
 checked: DMT

**TaylorBrammer**  
 TAYLOR BRAMMER LANDSCAPE ARCHITECTS PTY LTD  
 218 Oxford Street, Wollak, NSW, 2025 E: sydney@taylorbrammer.com.au T: 61 2 2387 8185  
 Copyright for the new landscape architects by 1/12

LA03

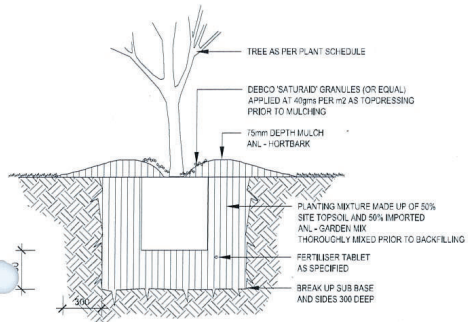

NOTE: ENSURE PLANTS ARE WATERED THOROUGHLY PRIOR TO PLANTING AND IMMEDIATELY FOLLOWING PLANTING INSTALLATION

1 TREE PLANTING  
TYPICAL SECTION 1:20

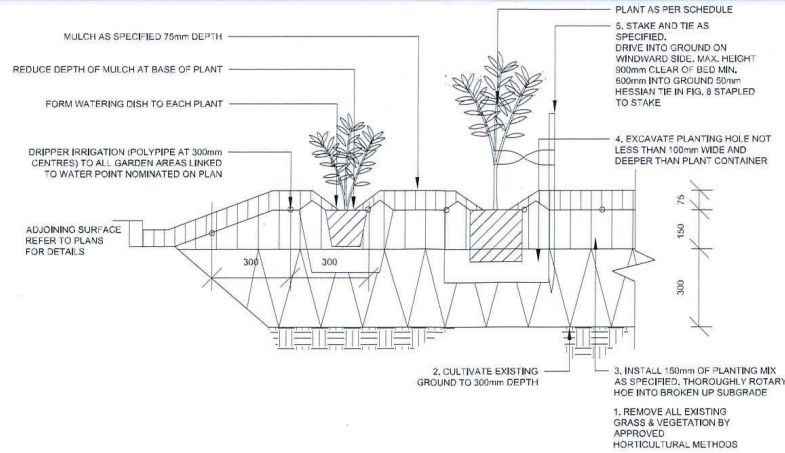

2 MASS PLANTING BED (DRIFTER IRRIGATION DETAIL)  
TYPICAL SECTION 1:10

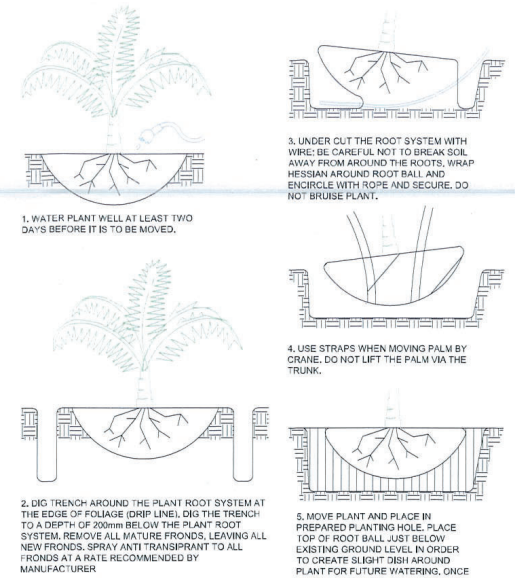

NOTE: ALL TRANSPLANTING PROCEDURES ARE TO BE COMPLETED UNDER SUPERVISION OF A CONSULTING ARBORIST

3 PALM TRANSPLANTING

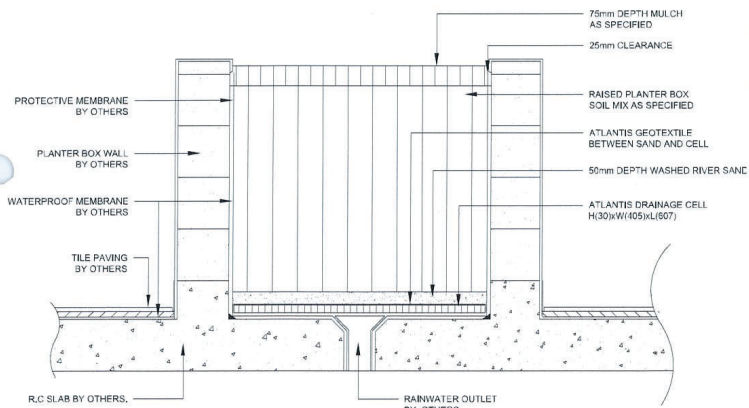

4 RAISED PLANTER BOX  
TYPICAL SECTION

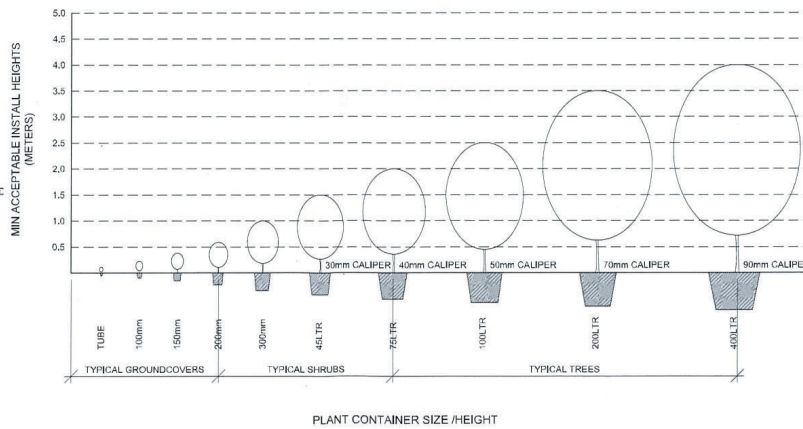

5 NEW PLANTING MINIMUM SIZES  
SECTION 1:50

GENERAL TREE SUPPLY AND QUALITY:  
FOLLOW THE GUIDANCE GIVEN IN NATSPEC GUIDE: SPECIFYING TREES - A GUIDE TO ASSESSMENT OF TREE QUALITY (CLARK R. 2003).



6 TURF  
SECTION 1:20

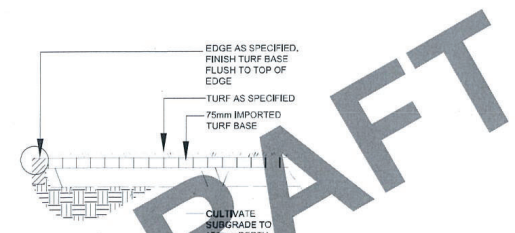

**DETAILS**

# Planting Character

## TREES

**Olive Tree (H- 4.5 m)**  
*Olea europaea*



**Crepe Myrtle (H- 7m)**  
*Lagerstroemia indica natchez*



**Pomegranate tree (H-3m)**  
*Punica granatum*

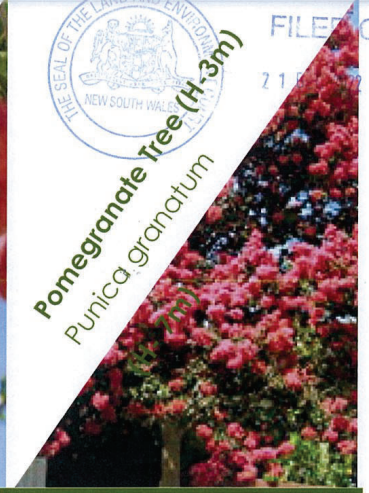

FILE NO  
2115

## SHRUBS

**Lilly Pilly (H-3 m)**  
*Acmena smithii 'Firescreen'*



**Bird's Nest Fern (H-1m)**  
*Asplenium australasicum*



**Silver Lady Fern (H- 1m)**  
*Blechnum gibbum 'Silver Lady'*



**Bottle Brush (H- 2 m)**  
*Callistemon 'Great Balls of Fire'*



**Natal Plum (H- 0.4m)**  
*Carrisa grandiflora 'Desert Star'*

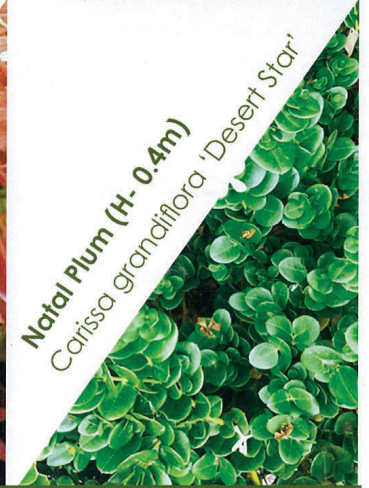

SCALE 1:100 @ A1  
0 2 4 8 12m

**LEGEND**

- SITE BOUNDARY
- PROPOSED SHRUBS
- PROPOSED TREE
- PROPOSED GROUNDCOVER
- EXISTING TREE RETAINED

project: Capella 307 Sydney Rd, 12 Boyln St, Balgowlah  
 client: Sun Property Group  
 date: 30.05.2022  
 revision: P1  
 drawn: CS  
 checked: DMT

**TaylorBrammer**  
 TAYLOR BRAMMER LANDSCAPE ARCHITECTS PTY LTD  
 SYDNEY STUDIO  
 17/18 Sydney Street, Macleay Park, NSW 2023. E: sydney@taylorbrammer.com.au T: 61 2 9387 9855  
 Copyright © Taylor Brammer Landscape Architects Pty Ltd. ADR6/18/1724/04

LA02

# Planting Character

## SHRUBS



**Holly Fern (H-0.6 m)**  
Cyrtomium falcatum



**Rojo Congo (H-1 m)**  
Philodendron 'Rojo Congo'



**Strelitzia juncea**



**Viburnum (H-2.5 m)**  
Viburnum odoratissimum



**Cardboard Palm (H-0.8m)**  
Zamia furfuracea



**Wonga Wonga Vine (climber)**  
Pandorea pandorana

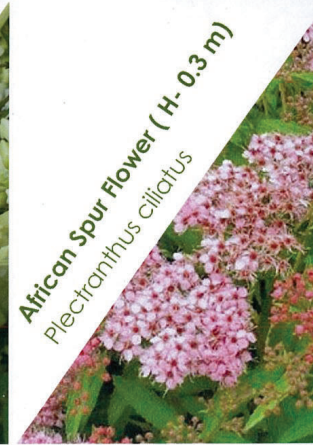

**African Spur Flower (H- 0.3 m)**  
Plectranthus ciliatus



**Tricolour Star Jasmine (H- 0.2 m)**  
Trachelospermum asiaticum



**Native Violet (H- 0.1m)**  
Viola hederacea



**Rosmarinus 'Prostrate'**  
Trailing Rosemary



**Dichora 'Silver Fall'**  
Silver Fall



**Senecio serpens**  
Blue Chalk Stick

## GROUNDCOVERS



SCALE 1:100 @ A1  
0 2 4 8 12m

### LEGEND



project: Capella 307 Sydney Rd, 12 Boyle St, Balgowlah  
client: Sun Property Group  
date: 30.05.2022  
revision: P1  
drawn: CS  
checked: DMT

**TaylorBrammer**  
TAYLOR BRAMMER LANDSCAPE ARCHITECTS PTY LTD  
310 DUNEED STREET BALGOWLAH, NSW 2155  
COPYRIGHT © TAYLOR BRAMMER LANDSCAPE ARCHITECTS PTY LTD

LA02