



John Colet School

Open Space Management Plan

Revision Schedule and Stakeholders

Revision Schedule

Date	Version No.	Changes	By:
8/2/2011	V1.0		Bursar
24/2/2013	V1.1	Updated expected enrolments for 3 years. Added Narrabeen Sports Centre as venue for sports carnival. Updated link for Wyatt reserve bookings. Move City Plan Services from document reviewers list to distribution list. Remove Warringah Council from Document Distribution list.	Bursar
16/12/13	V1.2	Updated expected enrolments for 3 years	Bursar

Stakeholders

Document Owner
Bursar

Document Reviewers
Headmaster
Teaching Staff
Sport Co-ordinator
School Executive
Board of Governors

Document Approval			
Name	Version No.	Date	Approved?
Board of Governors	V1.0	4/3/2011	YES
Board of Governors	V1.1	17/3/2013	YES
Board of Governors	V1.2		

Document Distribution
Staff
Board of Governors
Parents
City Plan Services

John Colet School Open Space Management Plan

(a) Identification of the Open Space Needs of the School (refer Council Condition 8(a))

John Colet School is an independent K-6 school in transition from a single-stream school (until 2008) to a fully double-stream school.

Infants and primary-aged children need safe outdoor space to play in with supervision at recess, lunch and after school. They also need safe and appropriate outdoor space for sports and games. Occasionally lessons are held outdoors, according to the needs of the curriculum.

The school holds an annual open day and fair on the school grounds each May.

(b) The demand for open spaces, including outdoor play areas, school sports and games (refer Council Condition 8(b))

The school expects the following numbers of students in infants and primary, over the next three years:

YEAR	Expected Numbers in INFANTS	Expected Numbers in PRIMARY	Expected Numbers – WHOLE SCHOOL
2013	97	116	213
2014	87	122	209
2015	90	132	222

The school timetables recess and play times to allow for:

- The whole school to play at recess (20 mins)
- Infants to play at early lunch (30 mins)
- Primary to play at late lunch (30 mins)

These three separate play times use all on-site facilities except Asset Zone B.

The sports program, including sport training and sport lessons, generally uses Wyatt Reserve oval according to the bookings made each year with Warringah Council and also the Eora playground on-site.

After School Care (3.30-5.30pm Monday to Friday) includes a period of outdoor play in the Eora playground.

(c) How the open space needs of the school are to be met on-site or on Wyatt Reserve or any other off-site facilities. (refer Council Condition 8(d))

A number of facilities are utilised to meet the open space needs of the school. A list of available sites follows:

On-site Facilities

Garigal Quadrangle

This is a grassed area between Shakespeare House and Colet House, used for play and outdoor learning.

Eora Playground and play structure

This is a play area west of Chisholm House that includes: a shaded play structure, a concrete handball court, grassed area for ball games, a crushed gravel area for play, and an area of light vegetation leading towards the Asset Zone B. The school has council consent to construct a covered outdoor learning area in the future.

Top House Playground

This is a bark chipped play area with play equipment and native vegetation in front of Top House.

Top House Outdoor Learning Area

This is a terraced, grassed area behind Top House used for play and outdoor learning.

Asset Zone B

This area is separated from the Eora Playground by a single rail wooden fence. It has light native vegetation that is maintained as a buffer zone for Duffy's Forest. This area is out of bounds at general play times. This area is used for learning including science and nature study.

A map of the school grounds indicates the location of the on-site facilities.

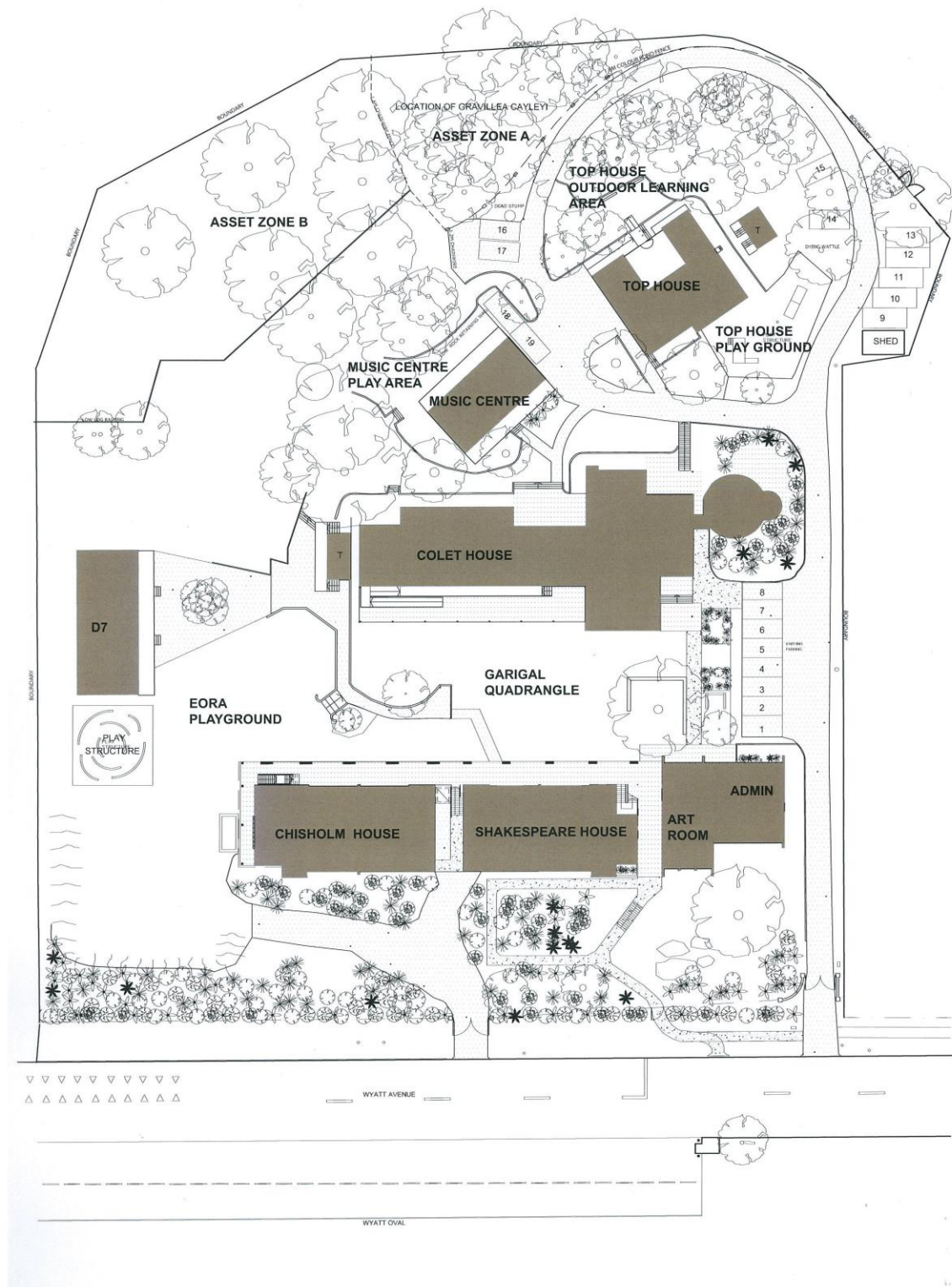

MAP OF SCHOOL GROUNDS

Off-site Facilities

Wyatt Reserve

This facility is booked each year with Warringah Council for sport lessons and sport training according to the current Council procedures. Any conditions of consent for use are followed.

Narrabeen Sports Centre

This facility is booked for the annual Sports Carnival in term 3.

Clifton Gardens

This facility is booked each year with Mosman Council for the Annual Picnic Day usually held in the last week or two of Term 4.

Other Council ovals and reserves

The school participates in inter-school sport competitions. The organisers of these competitions book sporting grounds through appropriate channels.

(d) Use of Wyatt Reserve (refer Council Condition 8(d))

Each year Warringah Council sends out to all schools and sporting bodies in the area a request to indicate which playing fields and when they would like to book. In the past this request has been received in November of the preceding year and the request is confirmed in December of the preceding year.

This process is currently under review by Council.

The school abides by the Council's conditions of use.

The current rental contract and a copy of the current confirmed booking schedule can be found in the

[..\..\Wyatt reserve - bookings and use](#)

(e) Periodic Review of Open Space Management Plan (refer Council Condition 8(e))

The school reviews its open space management plan as the need arises. The sport co-ordinator and other members of staff are involved in this review.