

DEVELOPMENT APPLICATION FOR PROPOSED RETAINING WALL AT :
6 KEMBLE PLACE, BILGOLA PLATEAU NSW 2207
LOT 68 DP 25341

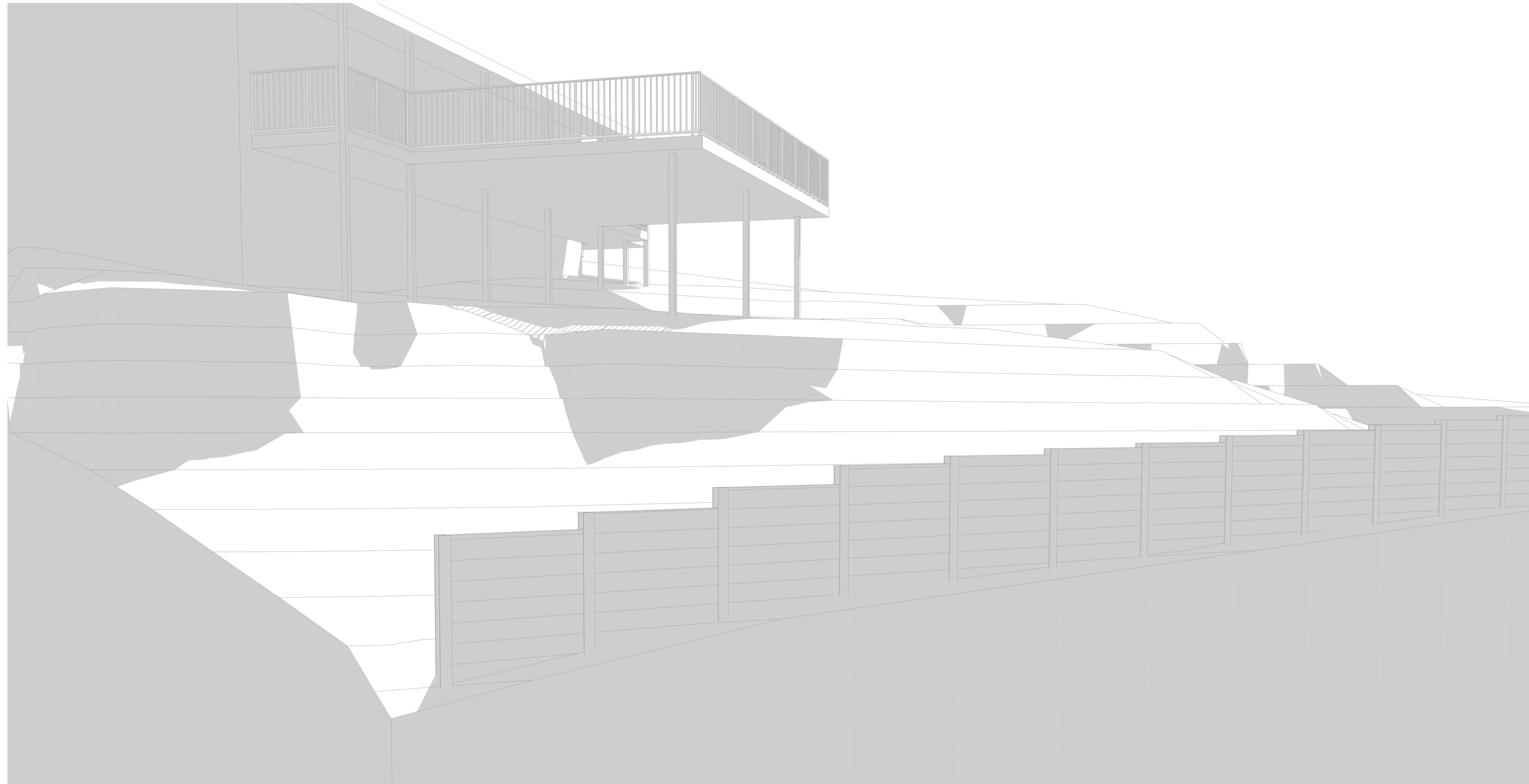

NOTES:
 USE FIGURED DIMENSIONS ONLY.
 DO NOT SCALE.
 ALL DIMENSIONS TO BE
 VERIFIED ON SITE.

Amendments:

Issue	Amendment	Date
A	DEVELOPMENT APPLICATION	22.05.2024
B	DEVELOPMENT APPLICATION	19.06.2024

CLIENT

LOT 68 DP 25341
 6 KEMBLE PLACE
 BILGOLA PLATEAU NSW 2107

**C A GROUP
 ARCHITECTS**

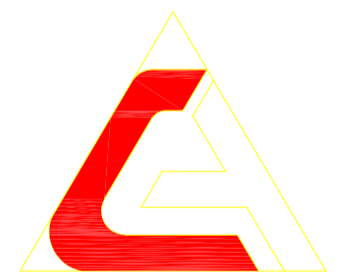

23 HENDY AVENUE
 COOGEE NSW 2034
 PHONE:0414 474 227
 FAX: 02 9664 7785

RESPONSIBLE ARCHITECT :
 DENNIS KOURTIS, REG No. 7493

PROJECT
**PROPOSED RETAINING WALL AT
 6 KEMBLE PLACE, BILGOLA
 PLATEAU NSW 2107**

TITLE
COVER PAGE

<small>SCALE</small>	<small>JOB NO.</small> 2413
<small>DATE</small> JUNE 2024	<small>DWG NO.</small> DA 0000
<small>DRAWN</small> YL	<small>REVISION</small> B

DRAWING LIST

- DA 0000 : COVER PAGE
- DA 1001 : SITE PLAN/SITE ANALYSIS PLAN
- DA 2100 : PIER AND SOLDIER PILE PLAN & ELEVATION
- DA 3100 : SECTIONS
- DA 4100 : SOUTHWEST ELEVATION

DEVELOPMENT APPLICATION

NOTES:
 USE FIGURED DIMENSIONS ONLY.
 DO NOT SCALE.
 ALL DIMENSIONS TO BE
 VERIFIED ON SITE.

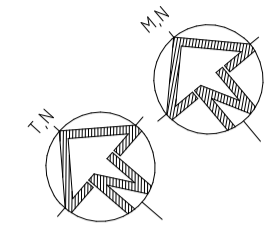

Amendments:

Issue	Amendment	Date
A	DEVELOPMENT APPLICATION	22.05.2024
B	DEVELOPMENT APPLICATION	19.06.2024

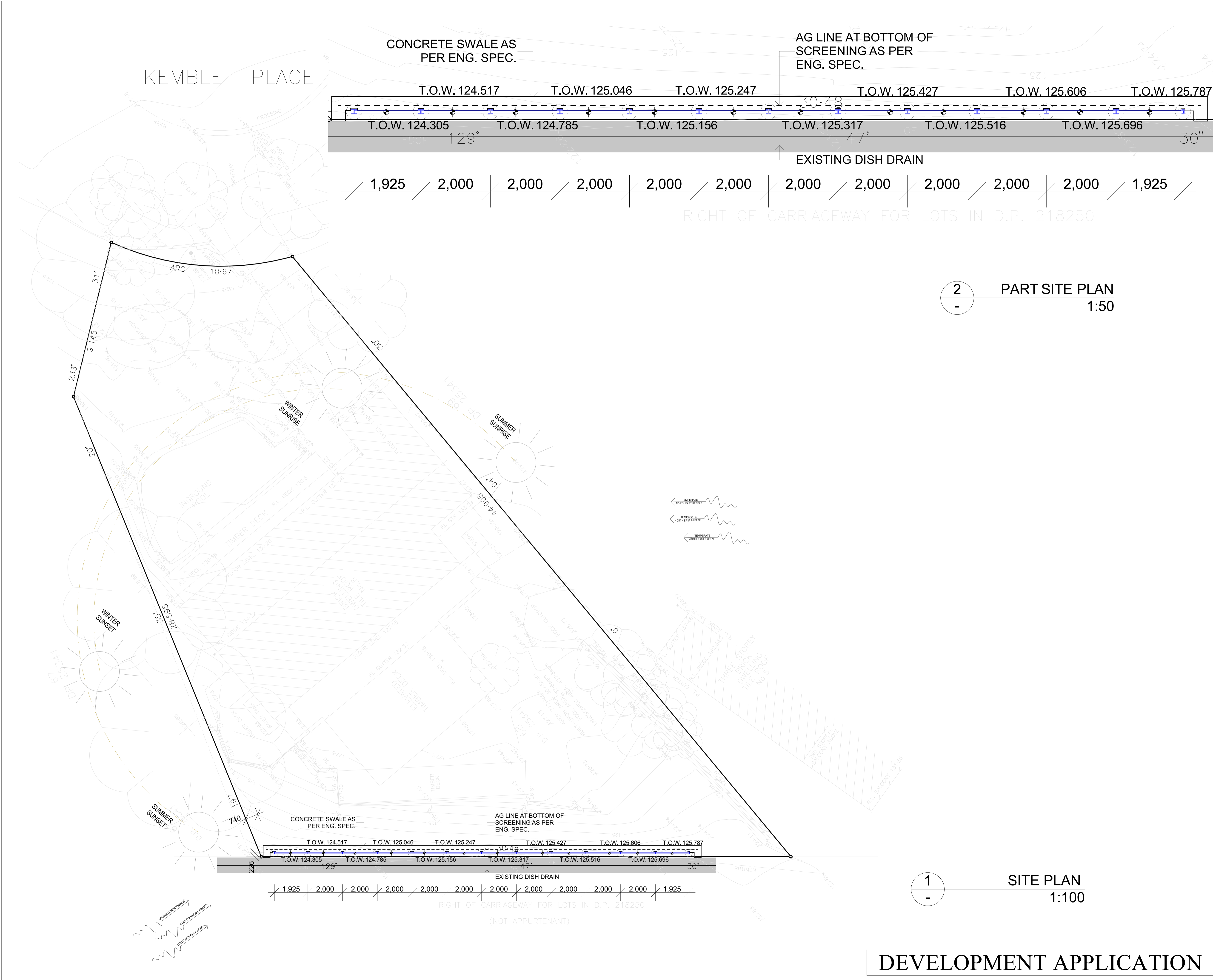

2 PART SITE PLAN
 1:50

1 SITE PLAN
 1:100

DEVELOPMENT APPLICATION

CLIENT
 LOT 68 DP 25341
 6 KEMBLE PLACE
 BILGOLA PLATEAU NSW 2107

C A GROUP ARCHITECTS

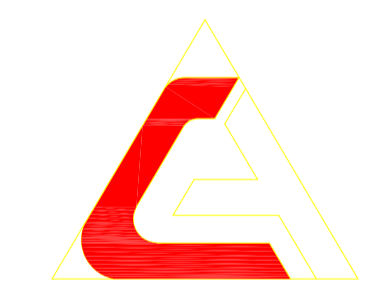

23 HENDY AVENUE
 COOGEE NSW 2034
 PHONE: 0414 474 227
 FAX: 02 9664 7785

RESPONSIBLE ARCHITECT:
 DENNIS KOURTIS, REG No. 7493

PROJECT
 PROPOSED RETAINING WALL AT
 6 KEMBLE PLACE, BILGOLA
 PLATEAU NSW 2107

TITLE
 SITE PLAN/SITE ANALYSIS PLAN

SCALE 1:100, 1:50	JOB NO. 2413
DATE JUNE 2024	DRW NO. DA 1001
DRAWN YL	REVISION B

NOTES:
 USE FIGURED DIMENSIONS ONLY.
 DO NOT SCALE.
 ALL DIMENSIONS TO BE
 VERIFIED ON SITE.

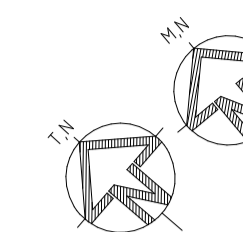

Amendments:

Issue	Amendment	Date
A	DEVELOPMENT APPLICATION	22.05.2024
B	DEVELOPMENT APPLICATION	19.06.2024

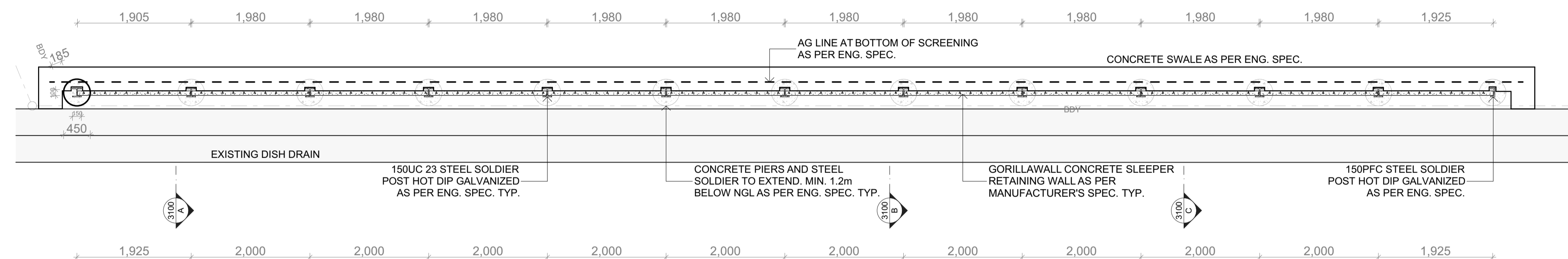

1 PIER AND SOLDIER PILE PLAN
 - 1:50

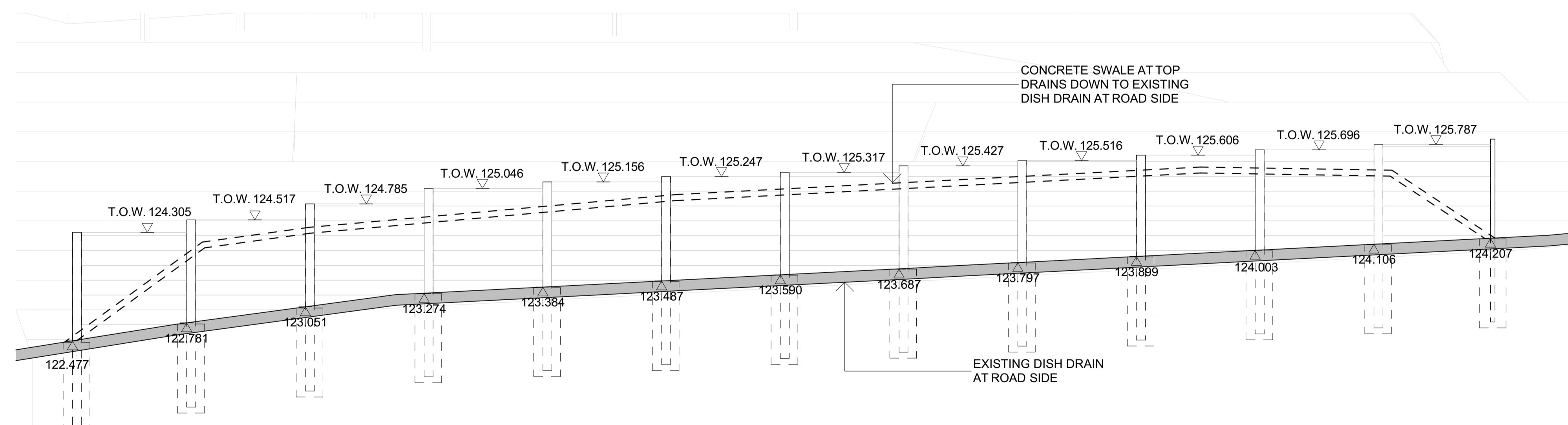

2 SOUTHWEST ELEVATION
 - 1:50

CLIENT
 LOT 68 DP 25341
 6 KEMBLE PLACE
 BILGOLA PLATEAU NSW 2107

C A GROUP ARCHITECTS



23 HENDY AVENUE
 COOGEE NSW 2034
 PHONE: 0414 474 227
 FAX: 02 9664 7785

RESPONSIBLE ARCHITECT:
 DENNIS KOURTIS, REG No. 7493

PROJECT
 PROPOSED RETAINING WALL AT
 6 KEMBLE PLACE, BILGOLA
 PLATEAU NSW 2107

TITLE
 PIER AND SOLDIER PILE PLAN &
 ELEVATION

SCALE 1:50	JOB NO. 2413
DATE JUNE 2024	DRWG NO. DA 2100
DRAWN YL	REVISION B

DEVELOPMENT APPLICATION

NOTES:
 USE FIGURED DIMENSIONS ONLY.
 DO NOT SCALE.
 ALL DIMENSIONS TO BE
 VERIFIED ON SITE.

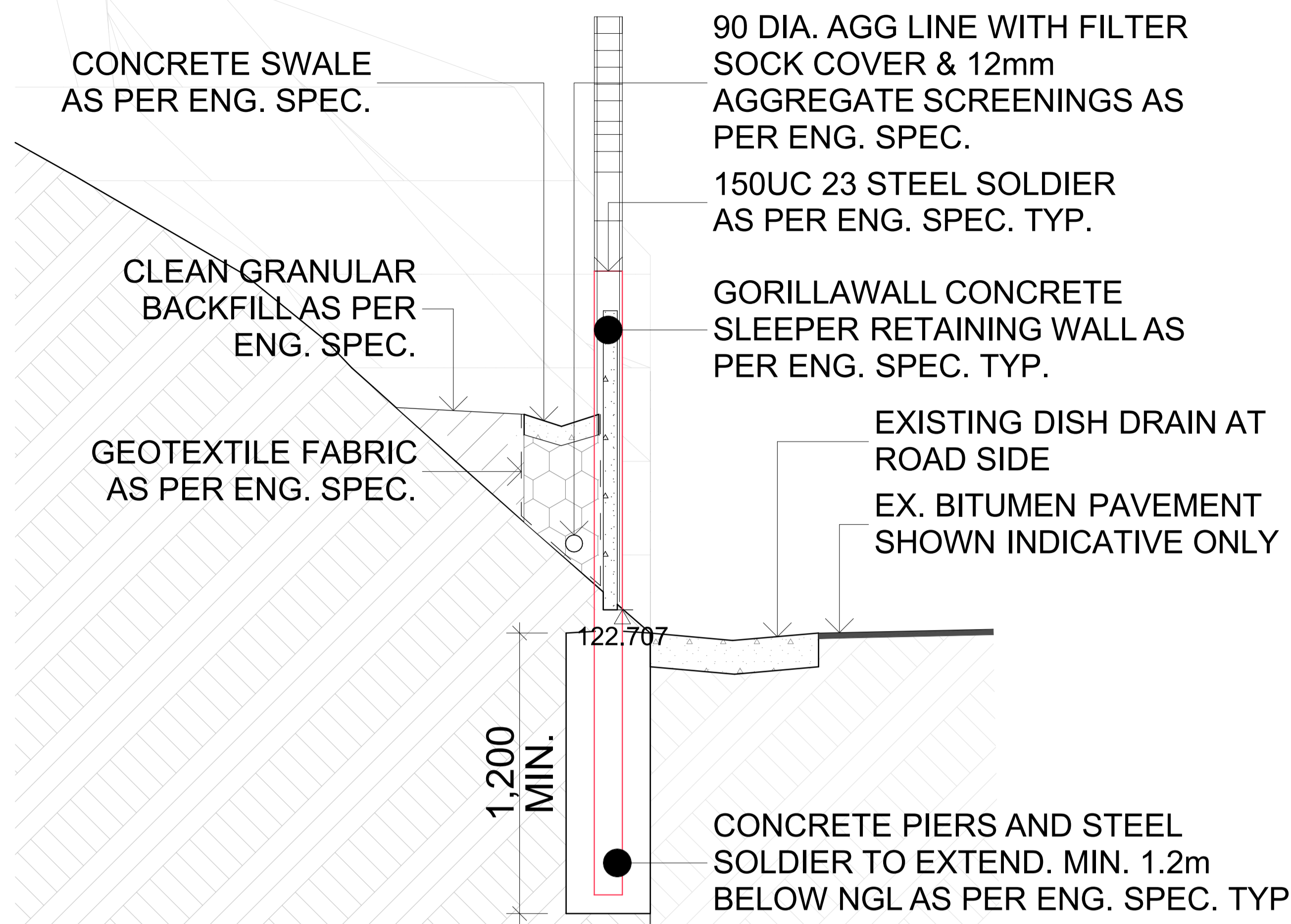

1 SECTION A
 - 1:20

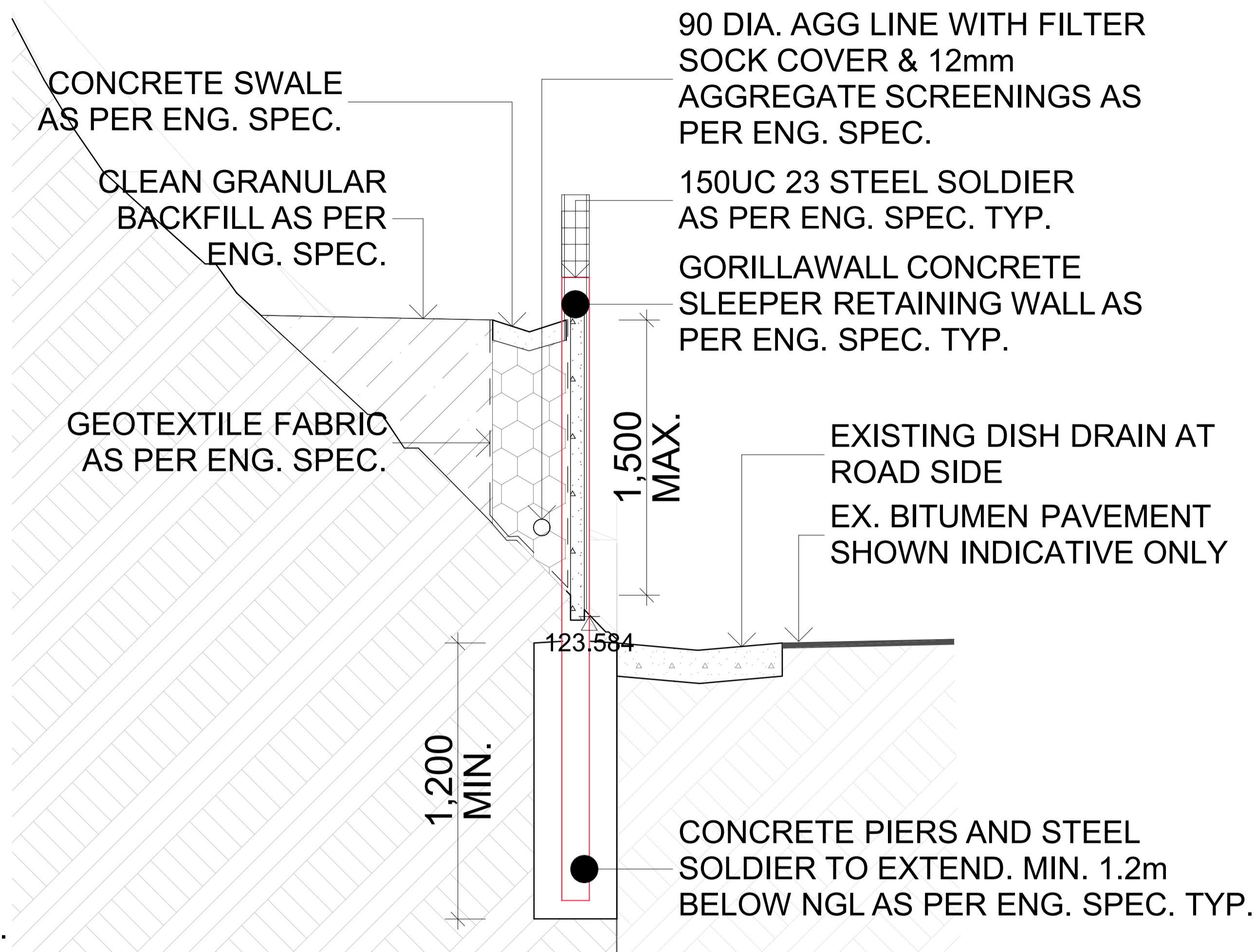

2 SECTION B
 - 1:20

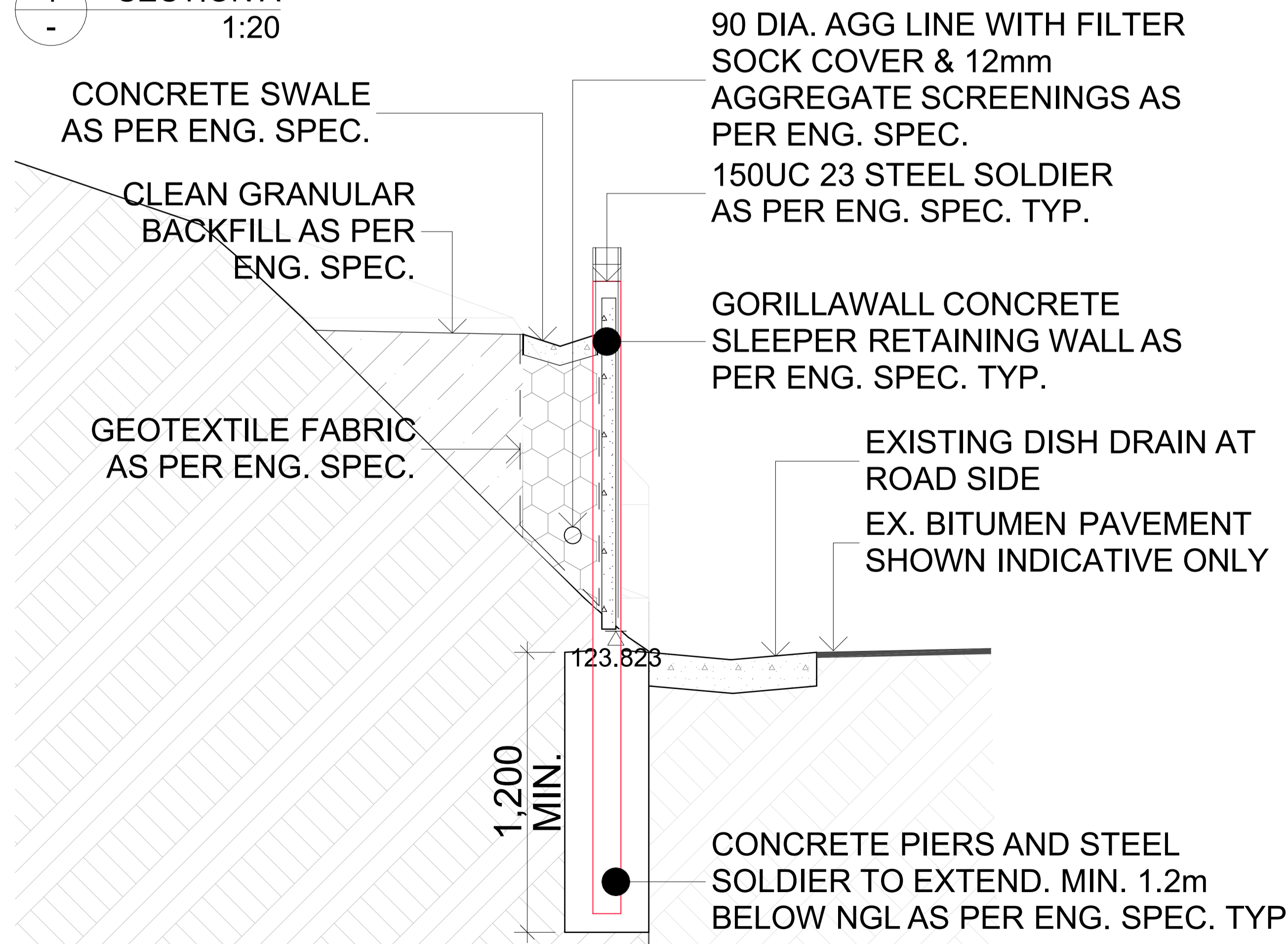

3 SECTION C
 - 1:20

DEVELOPMENT APPLICATION

Amendments:

Issue	Amendment	Date
A	DEVELOPMENT APPLICATION	22.05.2024
B	DEVELOPMENT APPLICATION	19.06.2024

CLIENT
 LOT 68 DP 25341
 6 KEMBLE PLACE
 BILGOLA PLATEAU NSW 2107

C A GROUP ARCHITECTS



23 HENDY AVENUE
 COOGEE NSW 2034
 PHONE: 0414 474 227
 FAX: 02 9664 7785

RESPONSIBLE ARCHITECT:
 DENNIS KOURTIS, REG No. 7493

PROJECT
 PROPOSED RETAINING WALL AT
 6 KEMBLE PLACE, BILGOLA
 PLATEAU NSW 2107

TITLE
 SECTIONS

SCALE 1:20	JOB NO. 2413
DATE JUNE 2024	DRWG NO. DA 3100
DRAWN YL	REVISION B

NOTES:
 USE FIGURED DIMENSIONS ONLY.
 DO NOT SCALE.
 ALL DIMENSIONS TO BE
 VERIFIED ON SITE.

Amendments:

Issue	Amendment	Date
A	DEVELOPMENT APPLICATION	22.05.2024
B	DEVELOPMENT APPLICATION	19.06.2024

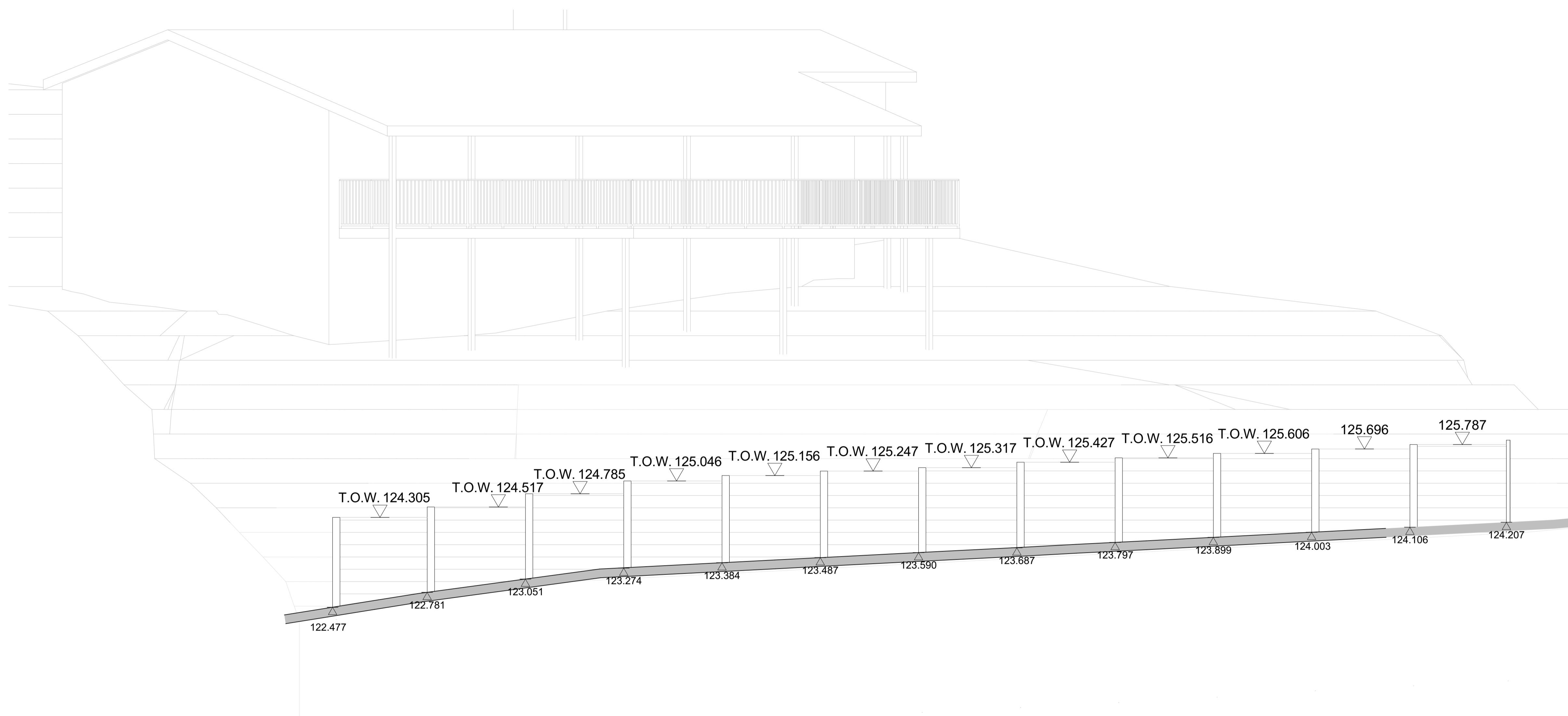

1
-
SOUTHWEST ELEVATION
1:50

CLIENT

LOT 68 DP 25341
 6 KEMBLE PLACE
 BILGOLA PLATEAU NSW 2107

**C A GROUP
 ARCHITECTS**



23 HENDY AVENUE
 COOGEE NSW 2034
 PHONE: 0414 474 227
 FAX: 02 9664 7785

RESPONSIBLE ARCHITECT:
 DENNIS KOURTIS, REG No. 7493

PROJECT
 PROPOSED RETAINING WALL AT
 6 KEMBLE PLACE, BILGOLA
 PLATEAU NSW 2107

TITLE
 SOUTHWEST ELEVATION

SCALE 1:50	JOB NO. 2413
DATE JUNE 2024	DWG NO. DA 4100
DRAWN YL	REVISION B

DEVELOPMENT APPLICATION