

NOTES:

- TREE SPREADS & HEIGHTS ARE INDICATIVE ONLY.
- ONLY VISIBLE SERVICES HAVE BEEN SHOWN. UNDERGROUND SERVICES HAVE NOT BEEN LOCATED.
- NOTIFICATION OF ALL RELEVANT AUTHORITIES SHOULD BE UNDERTAKEN BEFORE CARRYING OUT ANY CONSTRUCTION ACTIVITY OR NEAR THE SURVEYED AREA.
- THIS SURVEY HAS BEEN CARRIED OUT FOR INFORMATION PURPOSES ONLY AND SURVEY MARKS SHOULD BE PLACED IF STRUCTURES ARE TO BE ERRECTED ON OR NEAR THE BOUNDARIES. BOUNDARIES ARE NOT TO BE ESTABLISHED FROM INFORMATION SHOWN ON DRAWING.
- CONTOUR INTERVALS AND TREE COLOURS ARE INDICATIVE ONLY. SPOT LEVELS SHOULD BE ADOPTED FOR DESIGN AND CALCULATION PURPOSES. CRITICAL SPOT LEVELS SHOULD BE CONFIRMED WITH SURVEYOR.
- ORIGIN OF LEVELS: S.S.M.12810 R.L.86.236 A.H.D. (SCIMS)
- COPYRIGHT © ADAM CLERKE SURVEYORS PTY LTD 2020
- SUBJECT LAND AFFECTED BY COVENANT D970465
- THIS PLAN HAS BEEN PREPARED FOR THE EXCLUSIVE USE OF STEVEN & SARAH SEWELL
- PLAN PREPARED BY REGISTERED SURVEYOR FOR DEVELOPMENT APPLICATION PURPOSES.

*A. Clerke*  
 Adam Clerke  
 Registered surveyor No: 8490

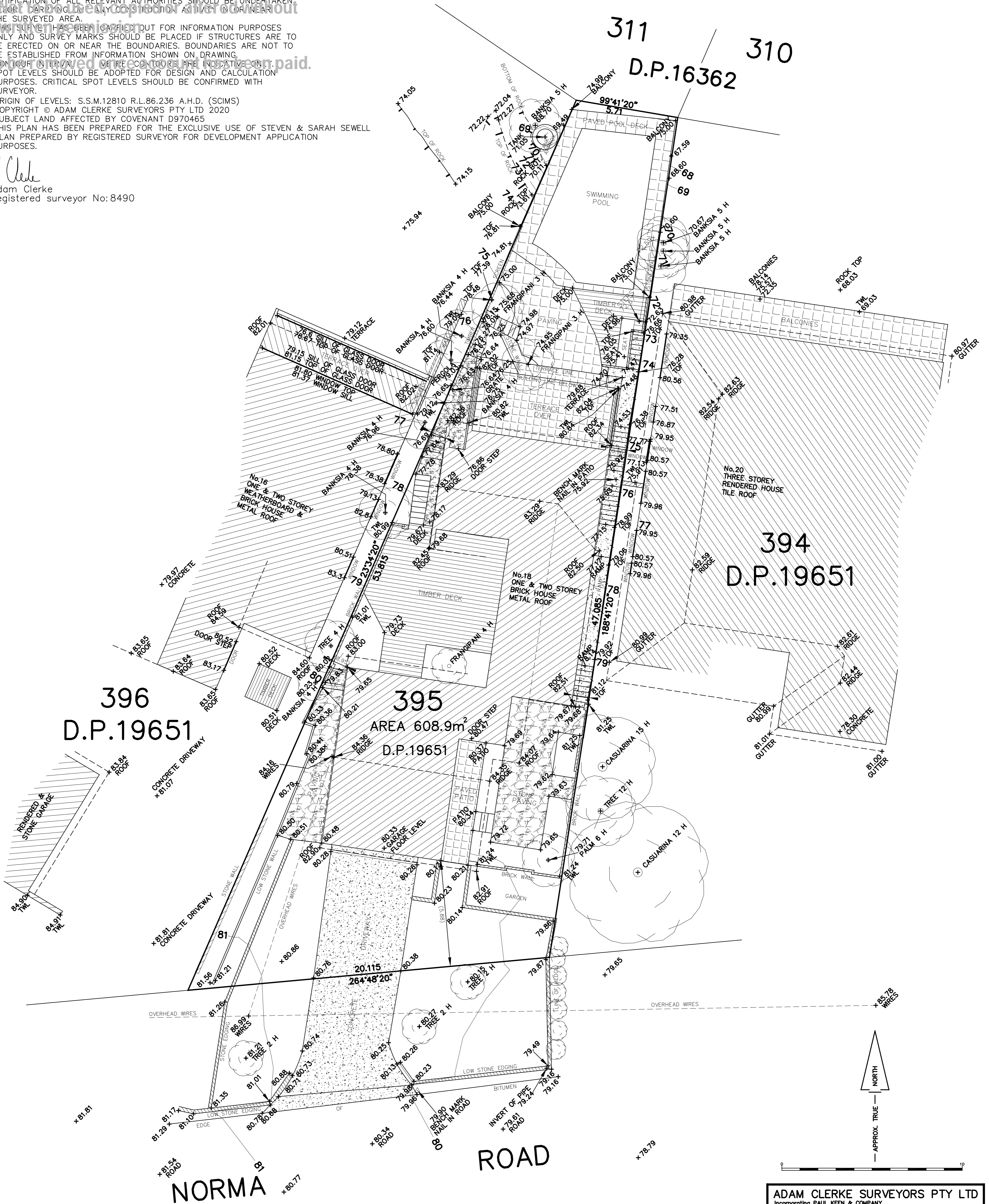

**ADAM CLERKE SURVEYORS PTY LTD**  
 Incorporating PAUL KEEN & COMPANY  
 LAND & ENGINEERING SURVEYORS  
 38 KEVIN AVENUE, AVALON 2107  
 TEL...9918 4111

copyright: Adam Clerke Surveyors Pty Ltd  
 Not to be used, copied or reproduced without written permission.

18 NORMA ROAD, PALM BEACH  
 DATE... 5/02/20 REF... 130070  
 SCALE... 1:100/A1 DATUM... A.H.D.

To be removed once 5 months has been paid.