

MGA

CROWN LAND LICENCE
No.460612

PITTWATER

THE AVENUE

D
O
R
C
E
N
T
A
L

B.M. NAIL IN TOP OF KERB
RL. 19.47

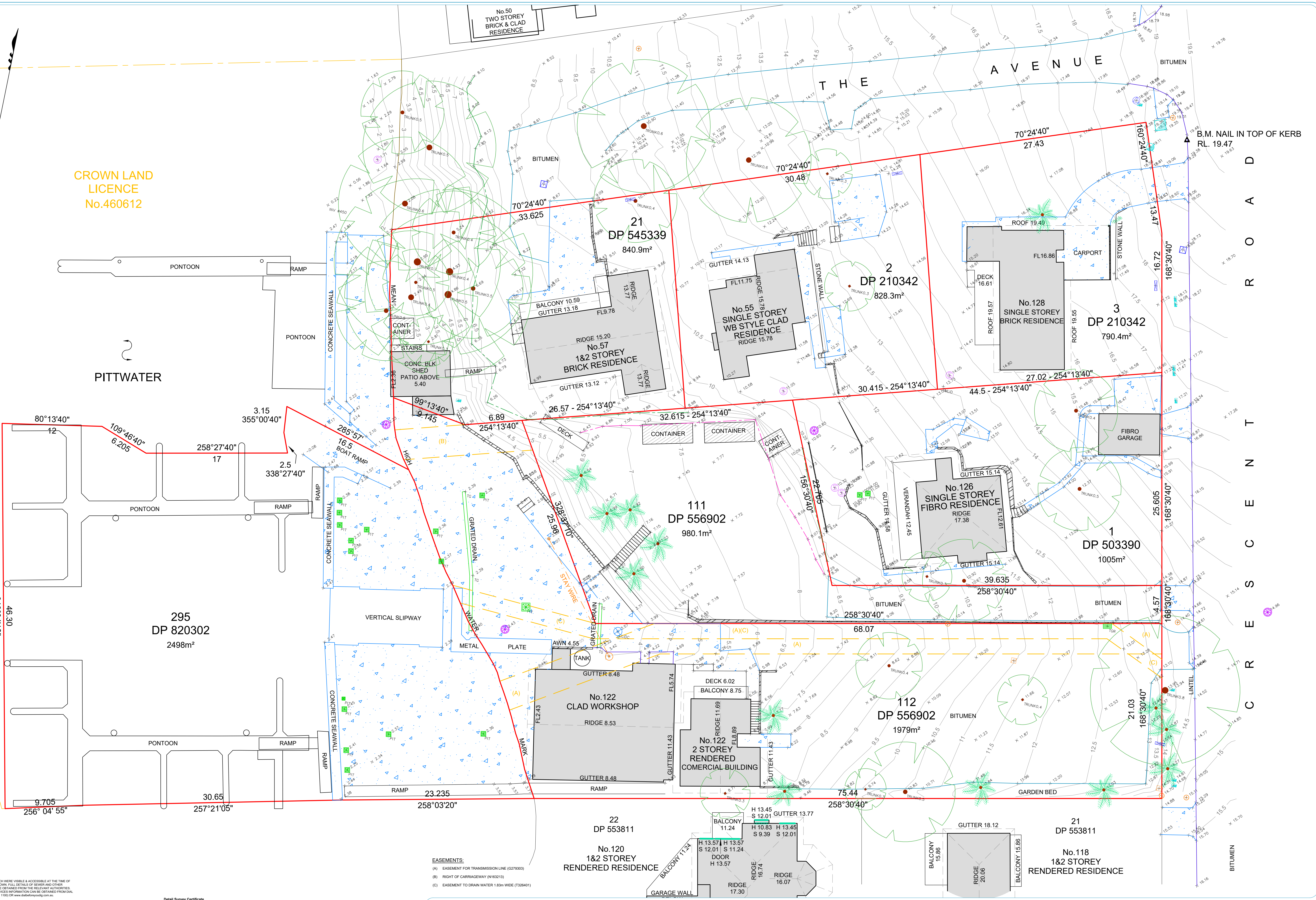

NOTES:

- ONLY SERVICES WHICH WERE VISIBLE & ACCESSIBLE AT THE TIME OF THE SURVEY ARE SHOWN. FULL DETAILS OF SERVICES AND OTHER SERVICES SHOULD BE OBTAINED FROM THE RELEVANT AUTHORITIES. UNDERGROUND SERVICES INFORMATION CAN BE OBTAINED FROM DAAL BEFORE YOU DIG (PH 150) OR www.daalbeforeyoudig.com.au
- CONTOURS ARE APPROXIMATE ONLY. PREFERENCE TO BE GIVEN TO SPOT HEIGHTS.
- MAJOR TREES SHOWN ONLY.
- DIMENSIONS AND AREA ARE SUBJECT TO SURVEY.
- PROJECT CO-ORDINATES ARE MSA2020 (ZONES)
- THIS PLAN HAS BEEN PREPARED FOR THE SOLE PURPOSE OF LOCATING A DEVELOPMENT APPLICATION WITH THE LOCAL COUNCIL. THIS PLAN IS NOT TO BE USED FOR ANY OTHER PURPOSE WITHOUT THE EXPRESS PERMISSION OF BOXALL SURVEYORS PTY LTD.

COPYRIGHT: BOXALL SURVEYORS
Boxall Surveyors Pty Ltd is a registered provider of professional services under the Professional Services Regulation 2017. Boxall Surveyors Pty Ltd is a member of the Surveyors' Institute of Australia (SIA) and the Australian Institute of Professional Surveyors (AIPs).
Boxall Surveyors Pty Ltd is a member of the Surveyors' Institute of Australia (SIA) and the Australian Institute of Professional Surveyors (AIPs).
Boxall Surveyors Pty Ltd is a member of the Surveyors' Institute of Australia (SIA) and the Australian Institute of Professional Surveyors (AIPs).

Detail Survey Certificate
I, Shawn Lachlan BEING (Geo) MSc of Boxall Surveyors, a surveyor registered under the Surveying and Spatial Information Act 2002, certify that the survey represented in this plan was made in accordance with Clause 10 of the Surveying and Spatial Information Regulation 2017 with regard to the location of the boundaries shown on this plan.
Signature: _____ Dated: 05-May-22
Surveyor Identification No: 115
Surveyor registered under the Surveying and Spatial Information Act 2002

PRINT IN COLOUR

EASEMENTS:
(A) EASEMENT FOR TRANSMISSION LINE (G279003)
(B) RIGHT OF CARRIAGEWAY (N162313)
(C) EASEMENT TO DRAIN WATER 1.83m HIGH (T264401)

DRINKING FOUNTAIN	CONCRETE LID	ELECTRICAL CABLE MARKER	GAS MARKER
FIRE HYDRANT	PT LID	ELECTRICAL PILE	GAS VALVE
HYDRANT	METAL LID	ELECTRICAL BOX	GAS METER
STOP VALVE	GRATED DRAIN	LIGHT POLE	TREE
WATER TAP	SEWER SEPTIC PIT	POWER POLE	
WATER VALVE	SEWER MAN HOLE	OPTICAL FIBRE MARKER	
WATER METER	SEWER VENT	FIBRE OPTICS BOX	
DOWN PIPE		COMMS PIT	
		COMMS PILLAR	

LOT AND DP:
LOTS 2&3 IN DP 210342
LOT 1 IN DP 503390
LOT 21 IN DP 545339
LOTS 11&112 IN DP 556902
LOT 295 IN DP 820302

CLIENT:
VERONA CO.
ADDRESS:
122-128 CRESCENT ROAD,
NEWPORT



TITLE: PLAN OF SITE DETAIL AND LEVELS		ORIGIN LEVELS: SSM43648 RL 19.333
REV	DATE	DATUM: AHD
A	05.5.2022	SURVEY: LC DATE: 04.02.2022
		DRAWN: LC DATE: 05.05.2022
		APPROVED: SL DATE: 05.05.2022
		SCALE: 1:200 SHEET 1 OF 2
		DRAWING NO: 11369-001-A
		REV: A
		SIZE: A1



NOTES:

- ONLY SERVICES WHICH WERE VISIBLE & ACCESSIBLE AT THE TIME OF THE SURVEY ARE SHOWN. FULL DETAILS OF SERVICES AND OTHER SERVICES SHOULD BE OBTAINED FROM THE RELEVANT AUTHORITIES. UNDISCOVERED SERVICES OR OBSTRUCTIONS CAN BE OBTAINED FROM DAL BEFORE YOU DIG (PH 150) OR www.dalbeforeyoudig.com.au.
- BOUNDARIES ARE APPROXIMATE ONLY. PREFERENCE TO BE GIVEN TO SPOT HEIGHTS.
- MAJOR TREES SHOWN ONLY.
- DIMENSIONS AND AREA ARE SUBJECT TO SURVEY.
- PROJECT CO-ORDINATES ARE MGA2020 (ZONE95).
- THIS PLAN HAS BEEN PREPARED FOR THE SOLE PURPOSE OF LOCATING A DEVELOPMENT APPLICATION WITH THE LOCAL COUNCIL. THIS PLAN IS NOT TO BE USED FOR ANY OTHER PURPOSE WITHOUT THE EXPRESS PERMISSION OF BOXALL SURVEYORS PTY LTD.

Copyright: Boxall Surveyors

Detail Survey Certificate

I, Sharon Lachlan BEING (GEO) MGA of Boxall Surveyors, a surveyor registered under the Surveying and Spatial Information Act 2002, certify that the survey represented in this plan was made in accordance with Clause 10 of the Surveying and Spatial Information Regulation 2004 with respect to the location of the boundaries shown on this plan.

Signature: *[Signature]* Dated: 05-May-22

Surveyor Identification No. 115
 Surveyor registered under the Surveying and Spatial Information Act 2002

PRINT IN COLOUR

EASEMENTS:

- EASEMENT FOR TRANSMISSION LINE (G228003)
- RIGHT OF CARRIAGEWAY (N162313)
- EASEMENT TO DRAIN WATER 1.83m WIDE (I236401)

LOT AND DP:

- LOTS 2&3 IN DP 210342
- LOT 1 IN DP 503390
- LOT 1 IN DP 545339
- LOTS 11&112 IN DP 556902
- LOT 295 IN DP 820302

CLIENT:
 VERONA CO.
 ADDRESS:
 122-128 CRESCENT ROAD,
 NEWPORT

boxall

Liability limited by a license approved under Professional Standards Legislation
 PO Box 519 Sutherland NSW 1499 | Suite 6/49-51 Elton Street
 02 9521 5737 | www.boxallsurveyors.com.au | ACN 114 644 058

TITLE: PLAN OF SITE DETAIL AND LEVELS WITH AERIAL IMAGERY DATED 10.02.2022

REV	DATE	REVISION DETAILS	APPROVED: SL	DATE:
A	05.5.2022	CROWN LAND LICENCE AREA ADDED (No.468612)	[Signature]	05.05.2022

ORIGIN LEVELS:	SSM43648	RL 19.333
AZIMUTH:	MGA20	DATUM: AHD
SURVEY:	LC	DATE: 04.02.2022
DRAWN:	LC	DATE: 05.05.2022
APPROVED:	SL	DATE: 05.05.2022
SCALE:	1:200	SHEET 2 OF 2
DRAWING NO:	11369-001-A	REV: A
SIZE:	A	SIZE: A1