

Flower Power Terrey Hills

Landscape Development Application Design Report

March 2024



SITE IMAGE
Landscape Architects



Landscape | Site Plan

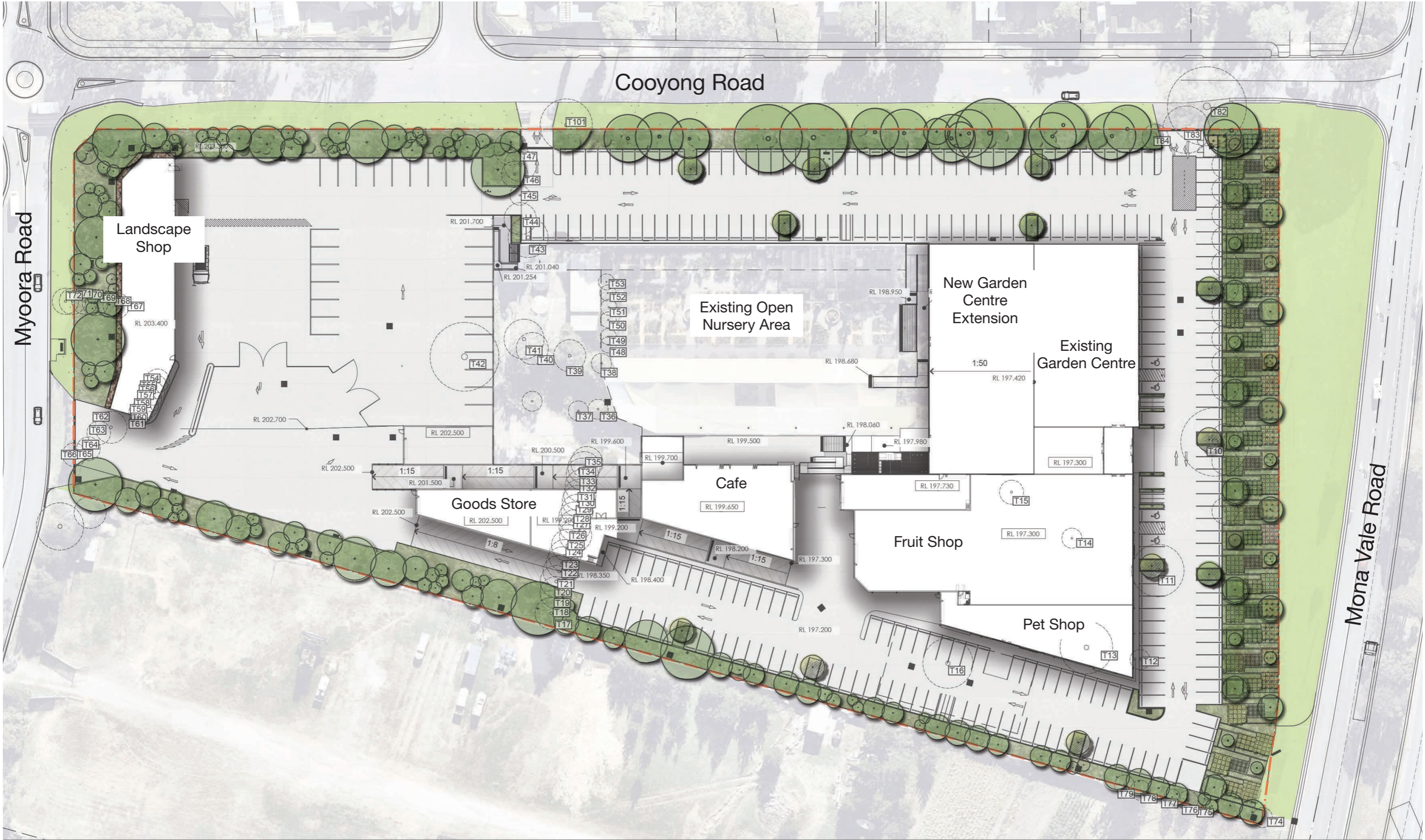

Landscape | Frontage

Mona Vale Road

Along Mona Vale Road a frontage of presentation planting is proposed. Planting will consist of a variety of native and exotic grass groundcover and shrub species in blocks. Tree planting will feature along the length of the frontage.

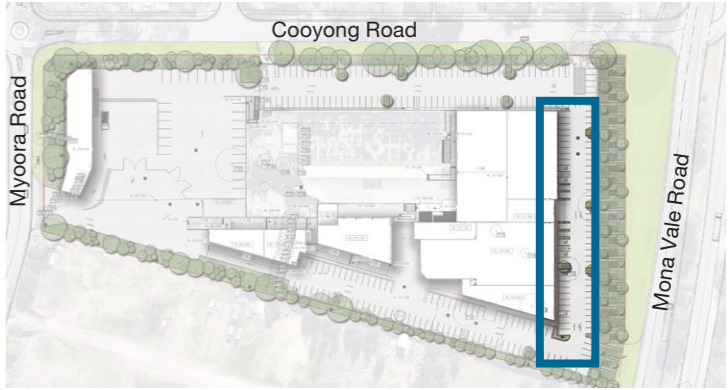

KEY PLAN



Banding and block planting of native species



Banding and block planting of native species

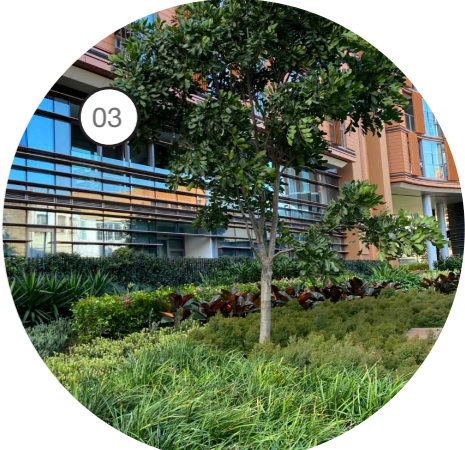

Tree planting

Landscape | Boundaries

Cooyong Rd & Southern Boundary

Planting to the boundaries shall complement existing trees. Additional tree planting will soften the frontages with mass planting of predominately native grasses groundcovers and shrubs to the understory.

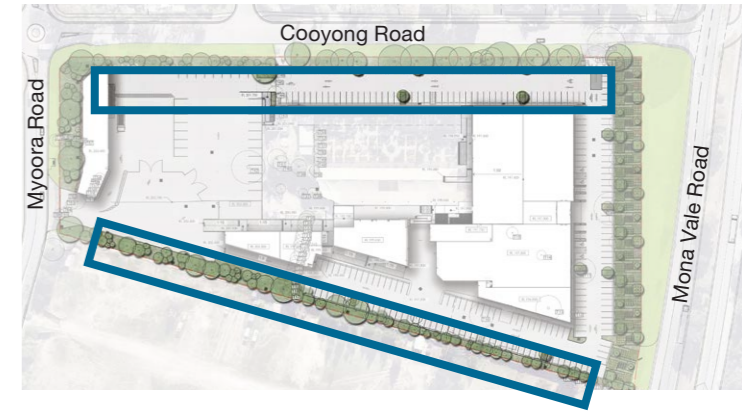

KEY PLAN

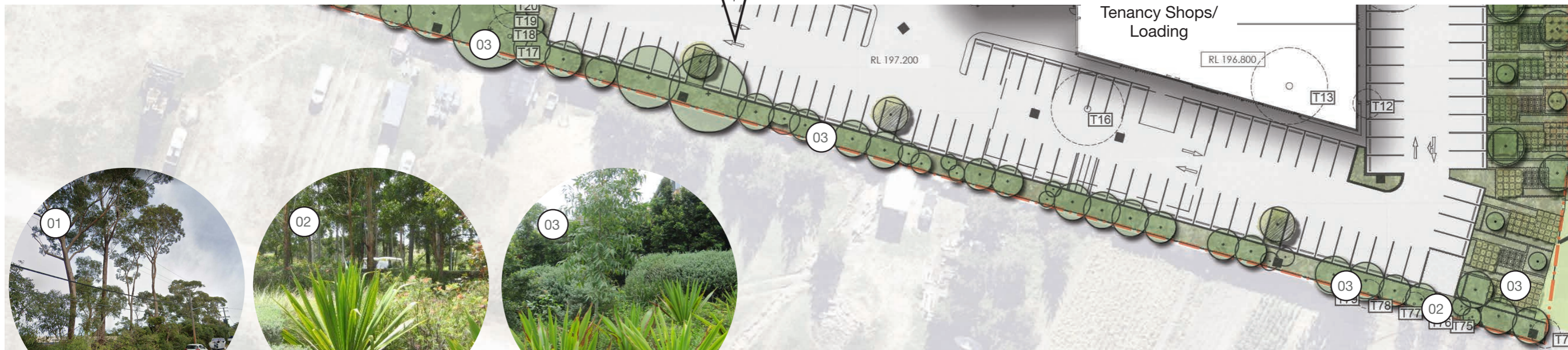
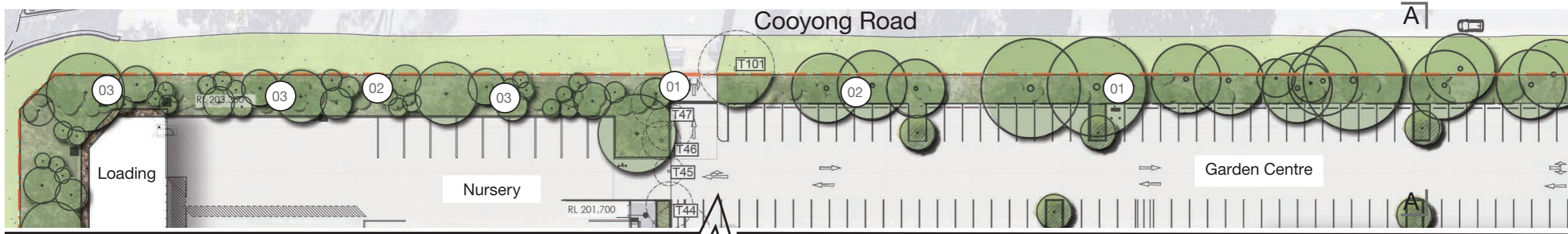

Existing Cooyong Rd trees to be retained



Proposed native grass groundcover and shrub understory planting



Additional infill tree planting to boundaries

Landscape | Cooyong Road

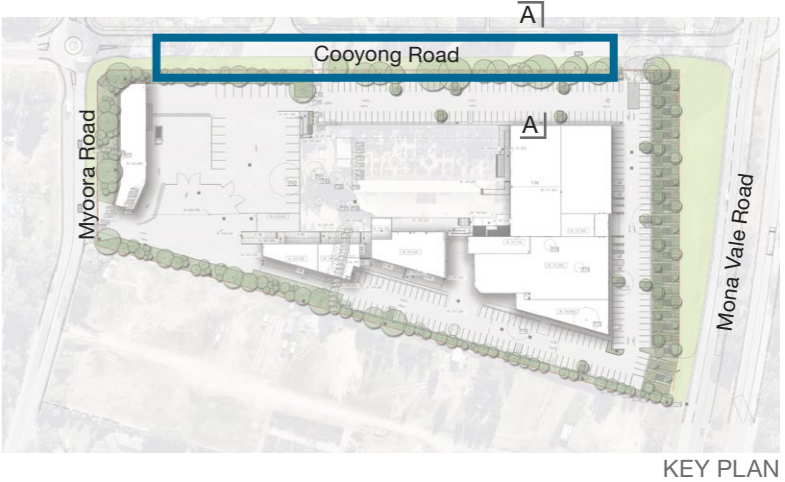

KEY PLAN

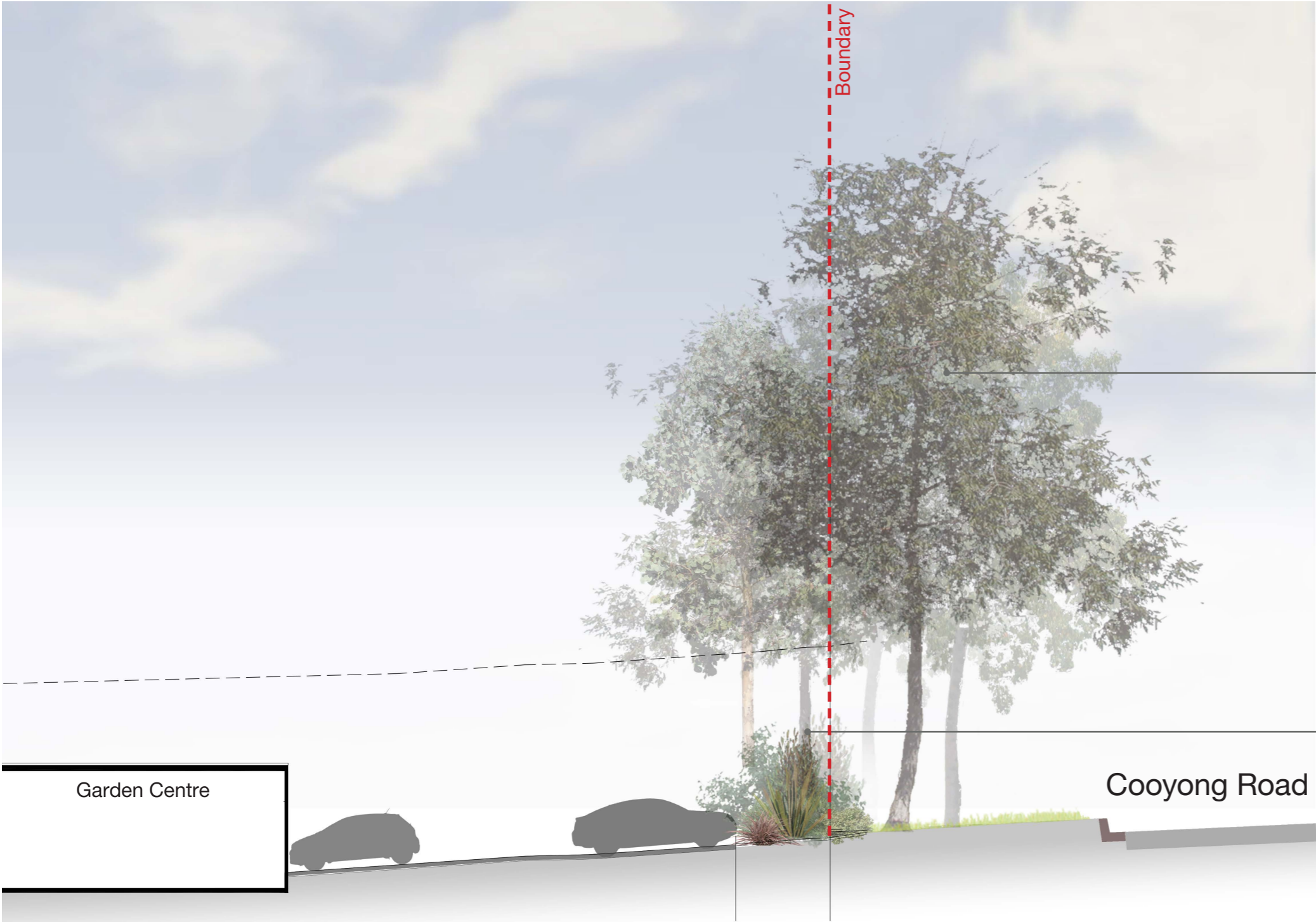

Retain and protect existing trees where possible

Mixture of native shrubs, grasses and groundcovers

Section A-A - Cooyong Rd

Landscape | Mona Vale Road

Mixture of native and exotic grasses
and groundcovers with shrubs
clustered in formalised blocks

Proposed shade trees within the
carpark planting islands with
formalised understorey planting

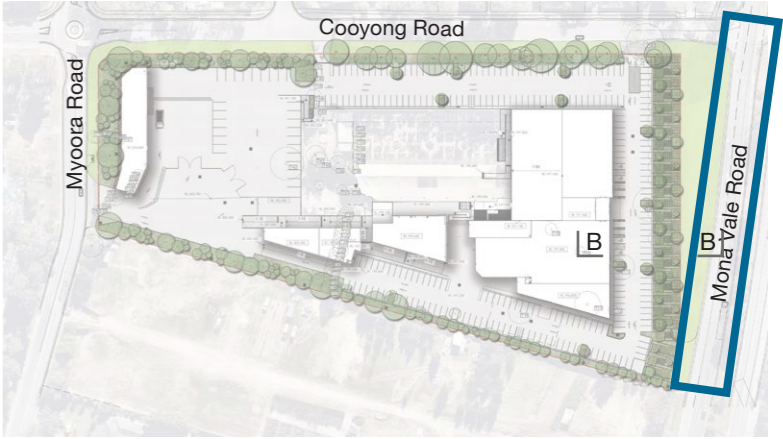

KEY PLAN



Section A-A - Mona Vale Rd

Landscape | Plant Schedule

Carpark Trees

<i>Elaeocarpus reticulatus</i>	Blueberry Ash	10 x 4	As Shown	100L
<i>Melaleuca decora</i>	White Feather Honeymyrtle	6 x 3	As Shown	100L
<i>Melaleuca quinquenervia</i>	Paperbark	12 x 6	As Shown	100L
<i>Tristania laurina</i>	Water Gum	10 x 5	As Shown	100L

Boundary Trees

<i>Angophora floribunda</i>	Rough-barked Angophora		As Shown	45L
<i>Backhousia myrtifolia</i>	Grey Myrtle		As Shown	45L
<i>Banksia integrifolia</i>	Coast Banksia		As Shown	45L
<i>Casuarina glauca</i>	Swamp She-oak		As Shown	45L
<i>Corymbia gummiifera</i>	Red Bloodwood		As Shown	45L
<i>Corymbia maculata</i>	Spotted Gum		As Shown	45L
<i>Eucalyptus haemastoma</i>	Scribbly Gum		As Shown	45L
<i>Melaleuca stypheloides</i>	Prickly-leaved Paperbark		As Shown	45L
<i>Syzygium glomulifera</i>	Turpentine		As Shown	45L
<i>Synoum glandulosum</i>	Scentless Rosewood		As Shown	45L
<i>Syzygium paniculatum</i>	Magenta Lilly Pilly		As Shown	45L
<i>Syzygium smithii</i>	Common Lilly Pilly		As Shown	45L

Shrubs and Accents

<i>Acmena smithii</i> 'Minor'	Dwarf Lilly Pilly	4 x 2	As Shown	300mm
<i>Acacia</i> 'Limelight'	Acacia Limelight	0.5 x 0.5	As Shown	300mm
<i>Doryanthes exceisa</i>	Gynea Lily	3 x 2	As Shown	200mm
<i>Loropetalum chinense Rubrum</i>	Chinese Fringe Flower	1 x 1	As Shown	200mm
<i>Melaleuca linariifolia</i> 'Claret Tops'	Honey Myrtle	1 x 1	As Shown	200mm
<i>Photinia glabra</i> 'Rubens'	Japanese Photinia	4 x 2	As Shown	300mm
<i>Phormium tenax</i>	New Zealand Flax	3 x 1.5	As Shown	200mm
<i>Philodendron Xanadu</i>	Xanadu	.8 x 1	As Shown	200mm
<i>Westringia Fruticosa</i>	Coastal Rosemary	2 x 2	As Shown	200mm
<i>Westringia</i> 'Wynyabbie Gem'	Coastal Rosemary	2 x 2	As Shown	200mm

Groundcovers / Grasses

<i>Carpobrotus glaucescens</i>	Pigface	.2 x 1	5/m2	150mm
<i>Carex appressa</i>	Tall sedge	.8 x 1	5/m2	150mm
<i>Dianella caerulea</i> 'Breeze'	Breeze Paroo Lily	.6 x .6	5/m2	150mm
<i>Hardenbergia violacea</i> 'Rosea'	Native Sarsaparilla	2 x 1	5/m2	150mm
<i>Hibbertia scandens</i>		.5 x 1	5/m2	150mm
<i>Lomandra longifolia</i>	Mat Rush	.7 x 1	5/m2	150mm
<i>Myoporum parvifolium</i> 'Yareena'	Yareena Myoporum	1.5	5/m2	150mm
<i>Poa labillardieri</i> 'Eskdale'	Tussock Grass	.6 x .6	5/m2	150mm
<i>Trachelospermum jasminoides</i>	Star Jasmine	.2 x .5	5/m2	150mm

Boundary Planting Matrix

Botanical Name	Common Name	"Mature Size (h x w)"	"Density /25m2"	Pot Size
<i>Banksia ericifolia</i>	Heath-leaved Banksia	6 x 2	7	150mm
<i>Callistemon citrinus</i>	Crimson Bottlebrush	1.8 x 1.5	7	150mm
<i>Dodonaea triquetra</i>	Common Hop-Bush	3 x 2	7	150mm
<i>Westringia fruticosa</i>	Coast Rosemary	1 x 1	7	150mm
<i>Melaleuca linearifolia</i>	Snow in Summer	4 x 4	7	150mm
<i>Dianella caerulea</i>	Blue Flax Lily	.4 x .4	10	Tube
<i>Carpobrotus glaucescens</i>	Pig Face	.2 x 1	10	Tube
<i>Hibbertia scandens</i>	Golden Guinea Flower	.2 x 1	10	Tube
<i>Lomandra longifolia</i>	Spiny-headed Mat-rush	.6 x .6	10	Tube



Cupaniopsis anacardioides



Tristania laurina



Banksia integrifolia



Acmena smithii 'Minor'



Loropetalum chinense Rubrum



Melaleuca linariifolia 'Claret Tops'



Westringia 'Wynyabbie Gem'



Carpobrotus glaucescens



Lomandra longifolia