



If you need help lodging your form, contact us	
Email	council@northernbeaches.nsw.gov.au
Phone	1300 434 434
Customer Service Centres	Manly Townhall, 1 Belgrave Street Manly NSW 2095
	Dee Why Civic Centre, 725 Pittwater Road Dee Why NSW 2099
Customer Service Centres	Mona Vale 1 Park Street Mona Vale NSW 2103
	Avalon 59A Old Barrenjoey Road Avalon Beach NSW 2107

Office use only	
Form ID	4000
TRIM Ref	C000902
Last Updated	24 November 2017
Business Unit	Parks and Recreation
Application No.	DA2018/0385
Receipt No.	10634626

Privacy Protection Notice	
Purpose of collection:	For Council to provide services to the community
Intended recipients:	Northern Beaches Council staff
Supply:	If you choose not to supply your personal information, it may result in Council being unable to provide the services you seek
Access/Correction:	Please contact Customer Service on 1300 434 434 to access or correct your personal information

RECEIVED
NORTHERN BEACHES
COUNCIL
 13 MAR 2018
MAIL ROOM

Part 1: Applicant Details

1.1 APPLICANT DETAILS	
Applicant name	KATE EVANS
Landowner(s) name	MICHAEL & KATE EVANS

1.2 ADDRESS OF PROPERTY WHERE TREE(S) LOCATED			
Address	16 APARA ST		
Suburb	FORESTVILLE	NSW	Postcode 2087
Title details (Lot/DP as shown on rates notice)	9/251817		

1.3 INSPECTION FEES (NON-REFUNDABLE)			
1 Tree	\$150		
Additional fee per tree for pruning/removal	\$45 x number of additional trees =		
On site appointment	\$85	Total	\$150

Part 2: Site Plan and Details

Please provide sufficient details to locate tree(s) including labeling the tree(s) numerically on the plan. It is recommended that you tie a marker to tree(s) once this application has been lodged.

Reason for application and outline of proposed work

WE HAVE A LARGE CHINESE ELM @ THE REAR OF OUR PROPERTY WHICH 3 YRS AGO WAS STRUCK BY LIGHTNING. 2 YRS AGO WE ENGAGED AN ARBORIST TO INSPECT THE TREE A SIGNIFICANT AMOUNT OF DEAD WOOD WAS REMOVED. SUBSEQUENTLY THE TREE HAS SHOWN SIGNIFICANT DECLINE IN THE CANOPY, AND MORE PARTS OF THE TREE ARE DEAD. WE ENGAGED THE ARBORIST THIS WEEK TO REVIEW AND HIS OPINION IS THAT THE TREE IS IN A MORTALITY SPIRAL AND SHOULD BE REMOVED, AS DEAD BRANCHES HANG OVER A LARGE YARD AREA WHERE CHILDREN PLAY. WE HAVE ALSO DISCUSSED WITH NEIGHBORS THIS APPLICATION AND THERE IS NO EXPRESSED OBJECTION TO THIS APPLICATION - THERE IS SIMILAR CONCERNS REGARDING DEAD BRANCHES OVERHANGING THEIR YARDS.

Sketch

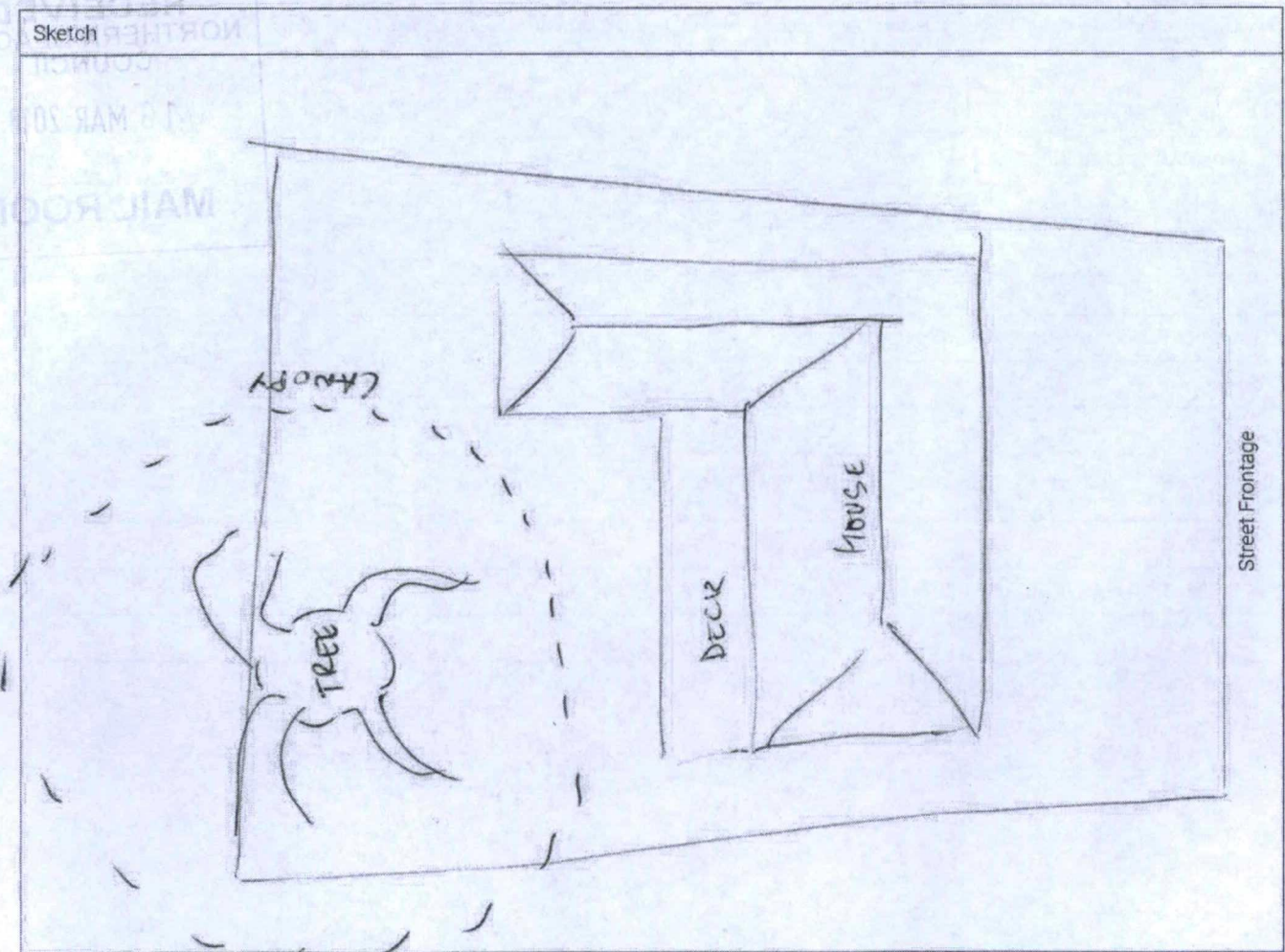

TREE AND SITE INFORMATION	
Is the tree(s) on private property? <i>(This application is only for trees on private property.)</i>	<input checked="" type="radio"/> Yes <input type="radio"/> No
Is there a dog on the property?	<input checked="" type="radio"/> Yes <input type="radio"/> No
Special arrangements required for site access	<input type="radio"/> Yes <input checked="" type="radio"/> No
If yes, please provide details	
Is there a current development application lodged for this property? <i>(Tree removal as part of a separate development application is assessed under that application and this application may not be required).</i>	<input type="radio"/> Yes <input checked="" type="radio"/> No
<ul style="list-style-type: none"> • Please note trees will not be assessed under this application process for complying development. • Applications for removal of significant trees will require an arborist's report by an independent qualified arborist. Please attach to this application. • Significant trees include local endemic trees, habitat trees, heritage listed trees or trees of large amenity and visual significance. • Replacement trees may be a condition of approval of this application. 	
Please list any supporting documents attached to your application eg. engineer's report or arborist report.	