

DATUM
MELB. 84.04

C:\06draws\12444\12444-02.JPG

CAUTION:
C:\06draws\12444\12444-03.JPG

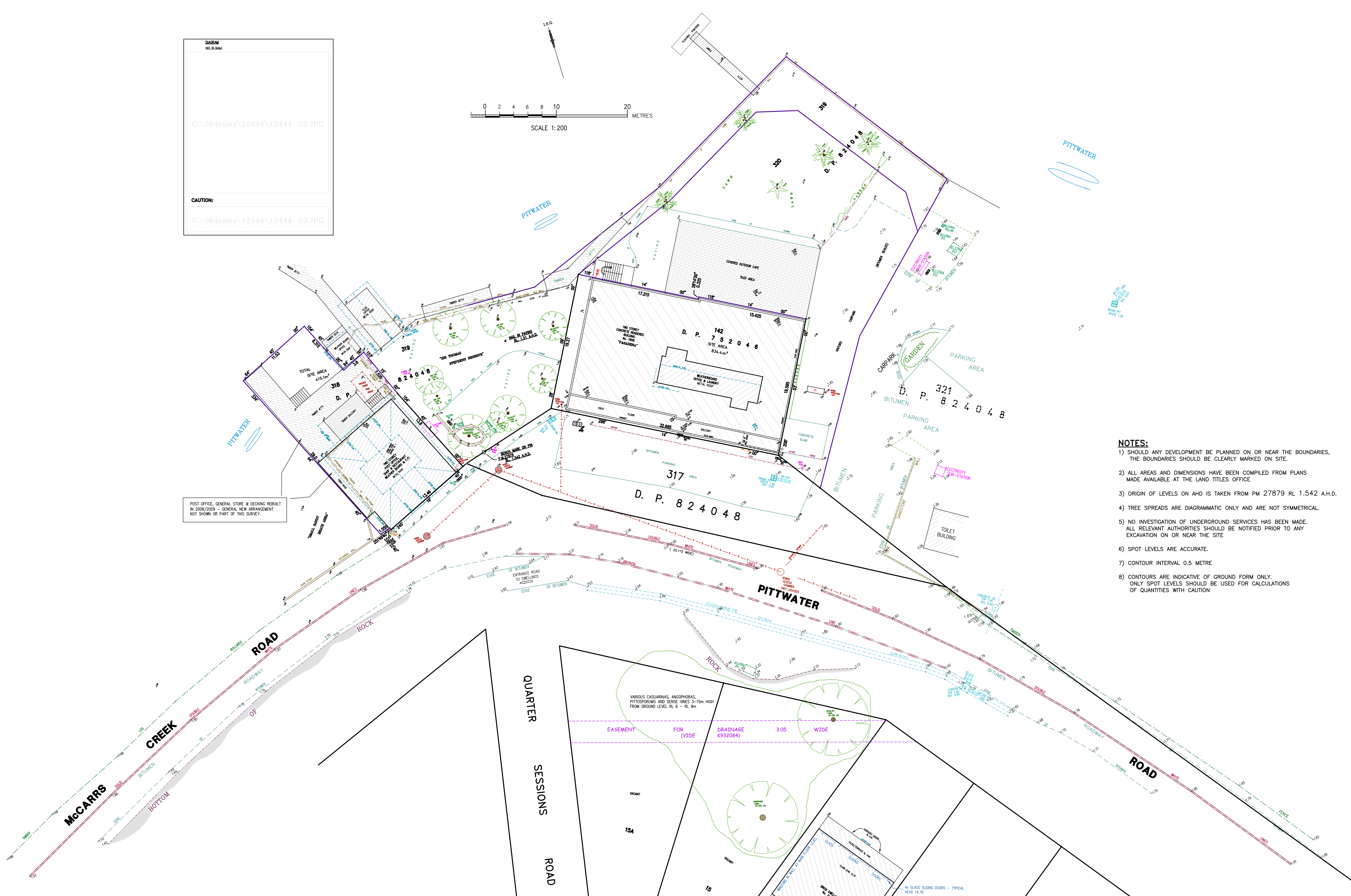
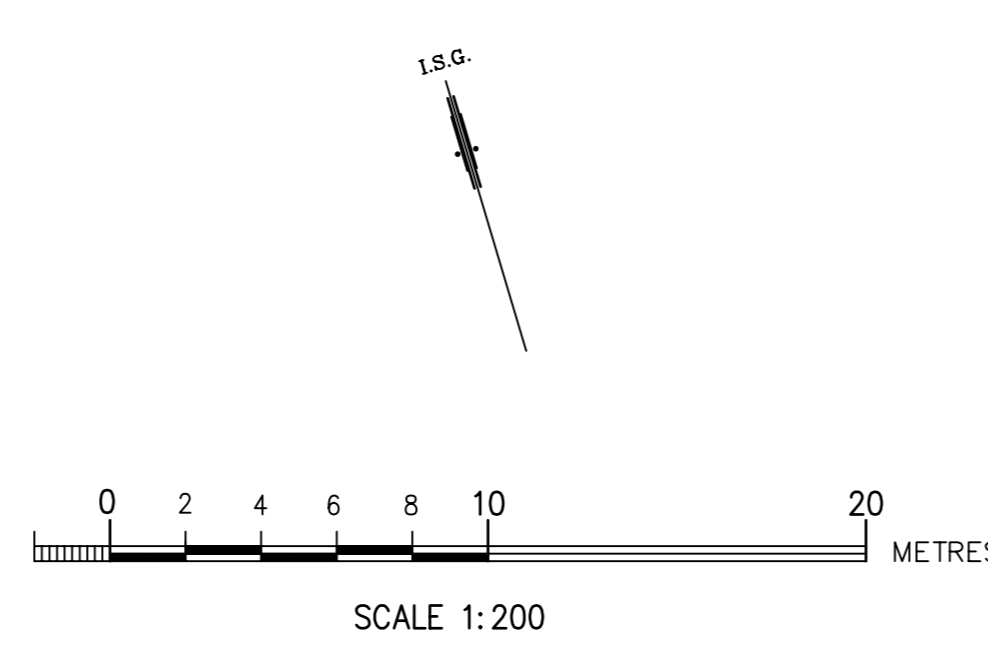

POST OFFICE, GENERAL STORE & DECKING REBALT
IN 2008/2009 - GENERAL NEW ARRANGEMENT
NOT SHOWN OR PART OF THIS SURVEY.

- NOTES:**
- 1) SHOULD ANY DEVELOPMENT BE PLANNED ON OR NEAR THE BOUNDARIES, THE BOUNDARIES SHOULD BE CLEARLY MARKED ON SITE.
 - 2) ALL AREAS AND DIMENSIONS HAVE BEEN COMPILED FROM PLANS MADE AVAILABLE AT THE LAND TITLES OFFICE
 - 3) ORIGIN OF LEVELS ON AHD IS TAKEN FROM PM 27879 RL 1.542 A.H.D.
 - 4) TREE SPREADS ARE DIAGRAMMATIC ONLY AND ARE NOT SYMMETRICAL.
 - 5) NO INVESTIGATION OF UNDERGROUND SERVICES HAS BEEN MADE. ALL RELEVANT AUTHORITIES SHOULD BE NOTIFIED PRIOR TO ANY EXCAVATION ON OR NEAR THE SITE.
 - 6) SPOT LEVELS ARE ACCURATE.
 - 7) CONTOUR INTERVAL 0.5 METRE
 - 8) CONTOURS ARE INDICATIVE OF GROUND FORM ONLY. ONLY SPOT LEVELS SHOULD BE USED FOR CALCULATIONS OF QUANTITIES WITH CAUTION

Bee & Lethbridge
Quality Surveying & Development Solutions

Bee & Lethbridge Pty Ltd
Suite 2, 14 Starkey Street,
PO Box 330, Forreville, NSW 2087
Phone: 9451 6757 Fax: 9975 3535
Email: survey@beeleth.com.au
ABN: 13 003 194 447
www.beeleth.com.au

LEGEND

TREE TOTAL 94.45 DENOTES APPROX. 0.1m DIAMETER OF TREE
TREE TOTAL 94.45 DENOTES APPROX. 5m HEIGHT OF TREE
TREE TOTAL 94.45 DENOTES APPROX. 4m SPREAD OF TREE

BOARDS SEWER

No.	DATE	SURVEYED	DRAWN	DESCRIPTION
01	12/10/09	C.L.	A.W.	NEIGHBOURING HOUSE No. 2195 AND SURROUNDINGS ADDED
02	15/07/09	R.P.	R.P.	EXTENSION OF ROAD DETAIL; AMENDED CLIENT DETAIL

PLAN SHOWING BOUNDARIES, RELATIVE HEIGHTS & PHYSICAL FEATURES OVER LOT 317, 318, 319, IN D.P. 824048 LOT 142 IN D.P. 752046 AND SURROUNDING PROPERTIES KNOWN AS No. PITTWATER ROAD, CHURCH POINT.

L.G.A.: PITTWATER

CLIENT	MR. & MRS. ROMEO	REF No.	12444
PROPERTY	CORNER PITTWATER & McCARRS CREEK ROAD, CHURCH POINT	SHEET No.	1 of 1
DATUM	A.H.D.	SCALE	1:200 @ B1
SURVEYED	C.L./M.C./M.R.	DATE	12/10/09
DRAWN	J.S.J.A.W.	DWG No.	12444B-09
		REV No.	00