

- (A) EASEMENT TO DRAIN WATER 3 WIDE (DP1291292)
- (B) EASEMENT TO DRAIN WATER 3 WIDE (DP1291292)
- (D) RIGHT OF ACCESS 1.5 WIDE (DP1291292)
- (E) EASEMENT FOR SERVICES VARIABLE WIDTH (DP1291292)
- (F) EASEMENT FOR ELECTRICITY AND OTHER PURPOSES 4.5 WIDE (DP1291292)
- (G) EASEMENT FOR ACCESS & SERVICES (PROPOSED)
- (H) EASEMENT TO DRAIN WATER (PROPOSED)
- (J) EASEMENT TO DRAIN WATER (PROPOSED)

2
DP 367690

A V E N U E

T H E

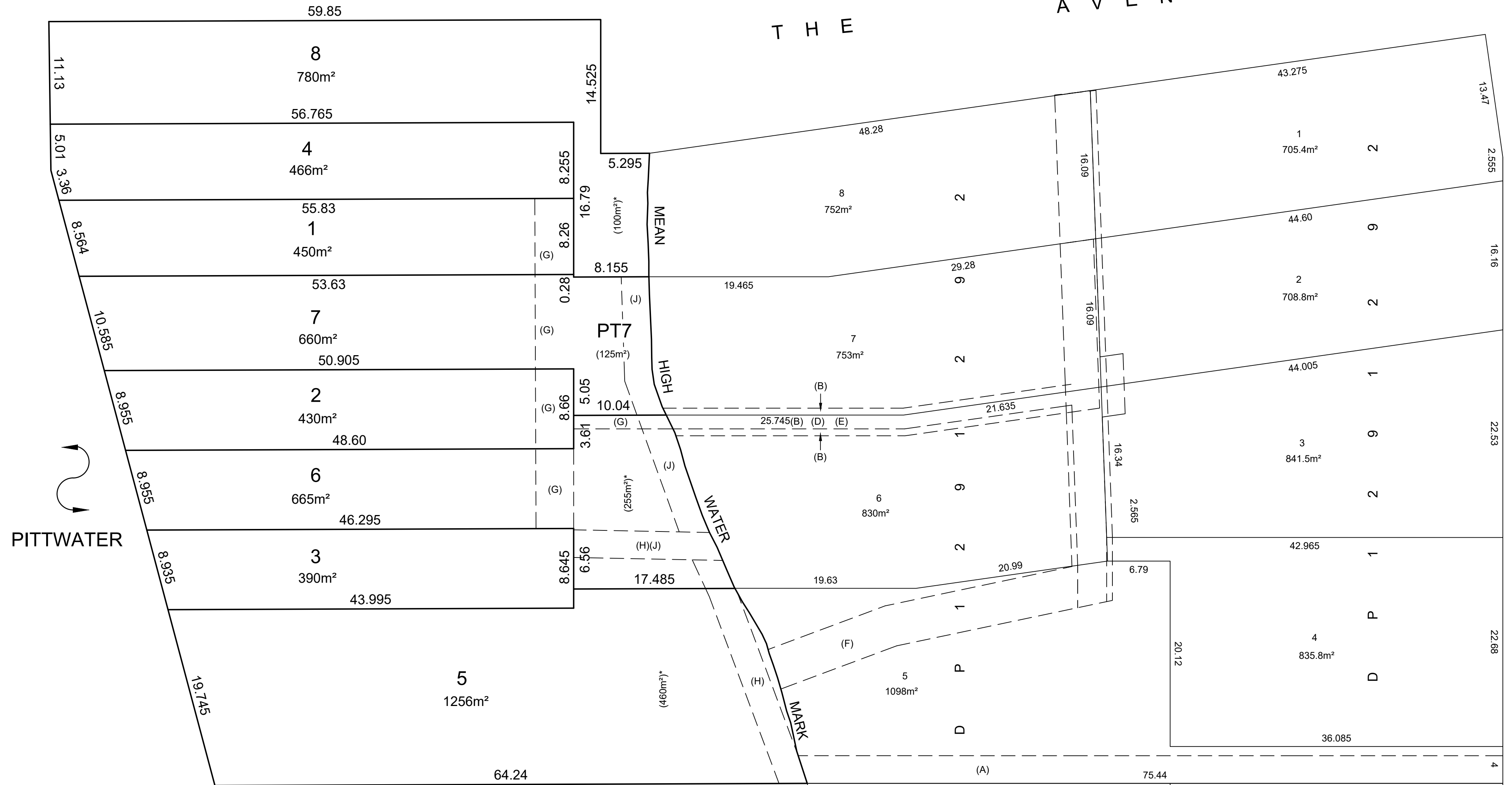

NOTES:

1. ALL DIMENSIONS & AREAS ARE SUBJECT TO FINAL SURVEY AND REGISTRATION OF A PLAN OF SURVEY WITH LRS NSW.
2. * DENOTES APPROXIMATE LEASE AREA FROM MHWM TO THE SEAWALL, THIS AREA IS INCLUDED IN THE FINAL LOT AREA OF CROWN LAND.

SURVEYOR
 Name: SHAWN LE CLERC
 Date: 2023
 Reference: 11369-008

PLAN HEADING
 PLAN OF SUBDIVISION OF LOT 295 IN DP820302
 AND CROWN LAND

L.G.A.: NORTHERN BEACHES
 Locality: NEWPORT
 Reduction Ratio: 1:300
 Lengths are in metres

REGISTERED

DRAFT

DATE: 19-09-2023
 MARINA SUBDIVISION - REV B

C R E S C E N T R O A D

22 21
 D P 5 5 3 8 1 1