

DEMOLITION UNDERCROFT PLAN  
1:200

**GENERAL DEMOLITION NOTES**

- The developer is to notify adjoining residents seven (7) working days prior to demolition in accordance with **DA Condition 5 (a)**.
- The developer is to provide the PCA with written notification for inspection prior to demolition in accordance with **DA Condition 5(b)**.
- The developer must erect a sign at the front of the property with the demolishers name, license number, contact phone number and site address.
- The developer must erect a 2.4m high temporary fence in accordance with **DA Condition 5(c)**. Access to the site must be restricted to authorised persons only and the site must be secured against unauthorised entry when work is not in progress or the site is otherwise unoccupied.
- The developer is to ensure all demolition is in accordance with AS2601, 2001 Demolition of structures.
- All demolition works are restricted to 7:00am and 5:30pm on weekdays only. No demolition work is to be carried out on Saturdays, Sundays and public holidays.
- Hazardous or intractable wastes arising from the demolition process must be removed and disposed of in accordance with the requirements of Work Cover NSW and the Department of Environment and Climate Change NSW.
- Demolition procedures must maximise the reuse and recycling of demolished materials in order to reduce the environmental impacts of waste disposal.
- During demolition, public property (footpaths, roads, reserves etc) must be clear at all times and must not be obstructed by any demolished material or vehicles as per **DA Condition 5(d)**.
- All vehicles leaving the site with demolition material must have their loads covered. All public property must be suitably protected against damage when plant and vehicles access the site in accordance with **DA Condition 5(k)**.
- The burning of any demolished material on site is not permitted and offenders will be prosecuted in accordance with **DA Condition 5(l)**.
- The developer must ensure care is taken during demolition to ensure that existing services on the site are not damaged; any damage caused to existing services must be repaired by the relevant authorities at the developers expense.
- The developer must coordinate the correct disposal of asbestos in accordance with **DA Condition 5(p)** including sub-clauses (i - v).

**NOTE:**  
Comply with the requirements for demolition outlined in the report prepared by AIRSAFE dated 9/12/14 for this project. This outlines method, precautions and testing/certification in relation Hazardous materials

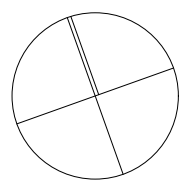

REV	DATE	DESCRIPTION
03	18/12/2024	Issue for DA
02	12/12/2024	For coordination
01	4/12/2024	DA for Coordination



McNally Architects

Studio 201, 6-8 Clarke Street,  
Crows Nest, 2065, NSW, Australia  
+61 2 9458 5565  
office@mcnallyarchitects.com.au  
www.mcnallyarchitects.com.au  
ABN 94 096 165 445  
James McNally 6744

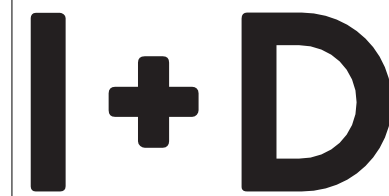

STUDIO

Studio 201, 6-8 Clarke Street,  
Crows Nest, 2065, NSW, Australia  
+61 2 9098 6922  
studio@landdstudio.com.au  
www.landdstudio.com.au  
ABN 55 631 885 964

This drawing is copyright © and shall remain the property of McNally Architects & I & D Studio. No reproduction without permission unless noted otherwise. This drawing is not for construction. do not scale from drawings, figured dimensions shall take precedence.

project		date		revision	
Anzac Village-Montgomery Centre		18/12/2024		03	
project number		client		drawing scale	
23010		RSLLC		1:200 @ A1	
drawing				drawing number	
DEMOLITION UNDERCROFT FLOOR PLAN				A005	

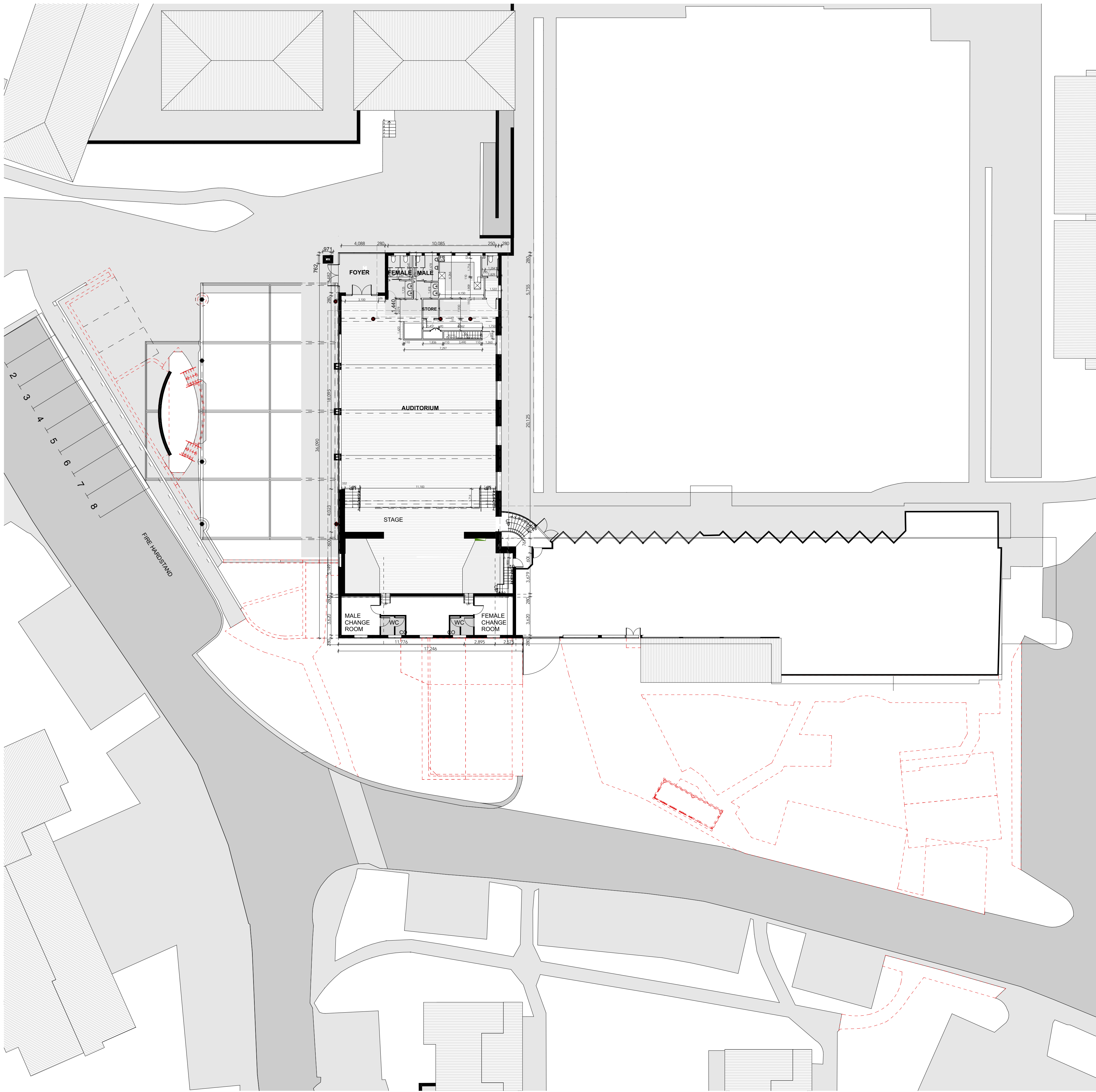

DEMOLITION GROUND FLOOR PLAN  
1:200

GENERAL DEMOLITION NOTES	
- The developer is to notify adjoining residents seven (7) working days prior to demolition in accordance with DA Condition 5 (a).	
- The developer is to provide the PCA with written notification for inspection prior to demolition in accordance with DA Condition 5(b).	
- The developer must erect a sign at the front of the property with the demolishers name, license number, contact phone number and site address.	
- The developer must erect a 2.4m high temporary fence in accordance with DA Condition 5(c). Access to the site must be restricted to authorised persons only and the site must be secured against unauthorised entry when work is not in progress or the site is otherwise unoccupied.	
- The developer is to ensure all demolition is in accordance with AS2601, 2001 Demolition of structures.	
- All demolition works are restricted to 7:00am and 5:30pm on weekdays only. No demolition work is to be carried out on Saturdays, Sundays and public holidays.	
- Hazardous or intractable wastes arising from the demolition process must be removed and disposed of in accordance with the requirements of Work Cover NSW and the Department of Environment and Climate Change NSW.	
- Demolition procedures must maximise the reuse and recycling of demolished materials in order to reduce the environmental impacts of waste disposal.	
- During demolition, public property (footpaths, roads, reserves etc) must be clear at all times and must not be obstructed by any demolished material or vehicles as per DA Condition 5(d).	
- All vehicles leaving the site with demolition material must have their loads covered. All public property must be suitably protected against damage when plant and vehicles access the site in accordance with DA Condition 5(e).	
- The burning of any demolished material on site is not permitted and offenders will be prosecuted in accordance with DA Condition 5(f).	
- The developer must ensure care is taken during demolition to ensure that existing services on the site are not damaged; any damage caused to existing services must be repaired by the relevant authorities at the developers expense.	
- The developer must coordinate the correct disposal of asbestos in accordance with DA Condition 5(g) including sub-clauses (i - v).	
<b>NOTE:</b> Comply with the requirements for demolition outlined in the report prepared by AIRSAFE dated 9/12/14 for this project. This outlines method, precautions and testing/certification in relation Hazardous materials	

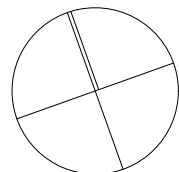

REV	DATE	DESCRIPTION
03	18/12/2024	Issue for DA
02	12/12/2024	For coordination
01	4/12/2024	DA for Coordination



McNally Architects

Studio 201, 6-8 Clarke Street,  
Crows Nest, 2065, NSW, Australia  
+61 2 9438 5565  
office@mcnallyarchitects.com.au  
www.mcnallyarchitects.com.au  
ABN 94 096 165 445  
James McNally 6744

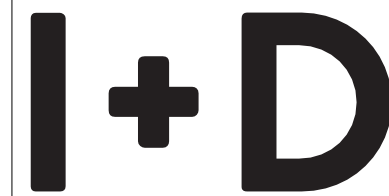

I+D STUDIO

This drawing is copyright © and shall remain the property of McNally Architects & I & D Studio. No reproduction without permission unless noted otherwise. This drawing is not for construction, do not scale from drawings, figured dimensions shall take precedence.

Studio 201, 6-8 Clarke Street,  
Crows Nest, 2065, NSW, Australia  
+61 2 9098 6922  
studio@iandstudio.com.au  
www.iandstudio.com.au  
ABN 55 631 885 964

project Anzac Village-Montgomery Centre		date 18/12/2024	revision issue 03
project number 23010	client RSLLC	drawing scale 1:200 @ A1	drawing number A006
drawing DEMOLITION GROUND FLOOR PLAN			