

BOUNDARIES OF THE SITE HAVE BEEN IDENTIFIED BY FIELD SURVEY

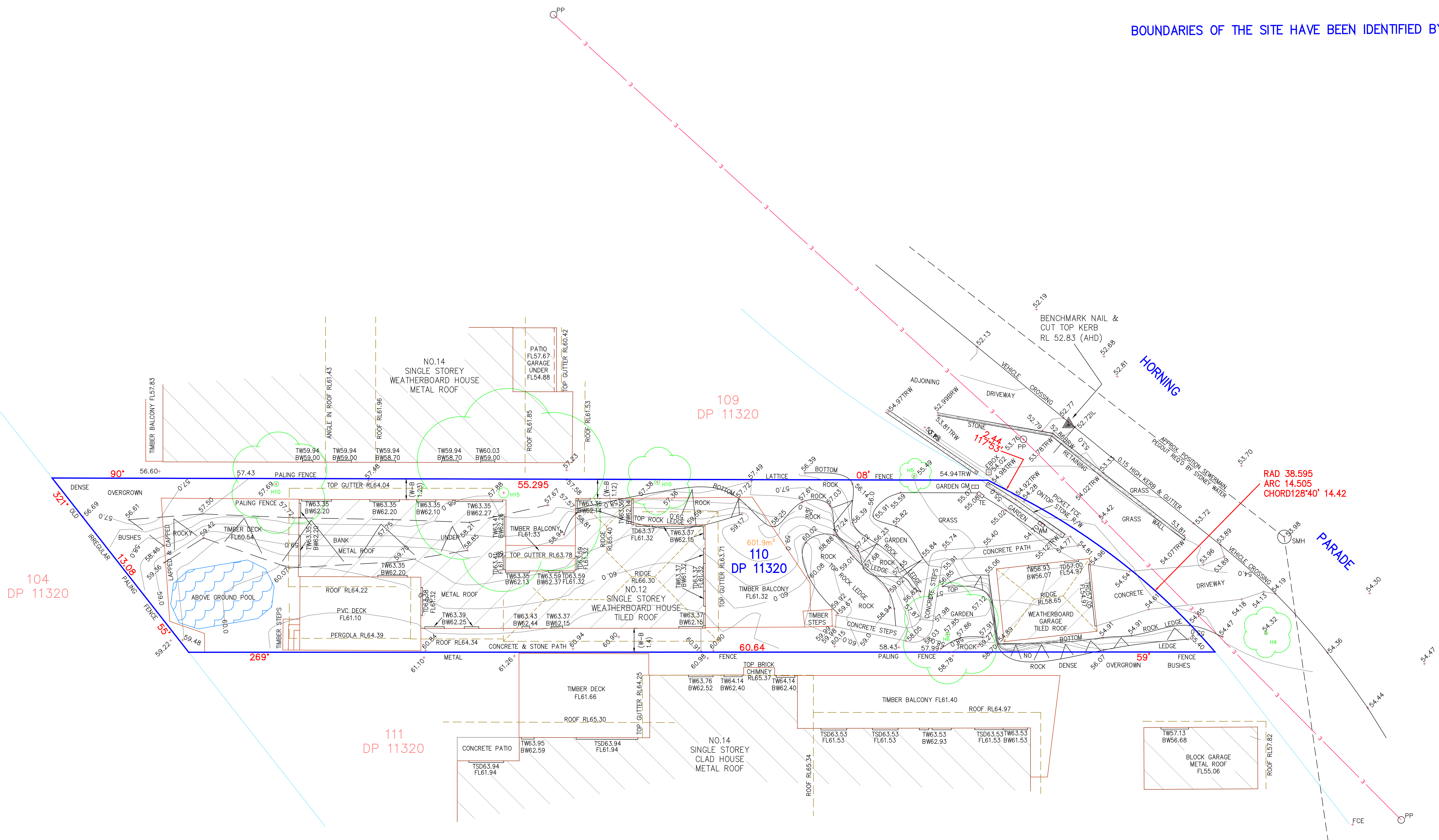

- BEARINGS & DISTANCES ARE BY FIELD SURVEY
- VISIBLE SERVICES ONLY HAVE BEEN LOCATED
- THE EXISTENCE OF UNDERGROUND SERVICES HAS NOT BEEN ESTABLISHED, IF THESE ARE CRITICAL IT IS ESSENTIAL THE APPROPRIATE AUTHORITIES BE CONTACTED FOR FURTHER DEVELOPMENT WORKS
- BEARINGS RELATE TO MAGNETIC NORTH AS SHOWN ON DP 11320
- THIS TITLE BLOCK IS AN INTEGRAL PART OF THIS DRAWING WHICH IS NOT TO BE REMOVED
- SITE AREA 601.9m² CALCULATED FROM TITLE FORMATION
- PROPOSED IMPROVEMENTS IN RELATION TO BOUNDARIES IS DIAGRAMATIC ONLY
- RIDGE & ROOF POSITIONS ARE APPROXIMATE ONLY
- CONTOUR LINES ARE APPROXIMATE ONLY, SPOT LEVELS TAKE PRECEDENCE
- NO EASEMENTS OR COVENANTS AFFECT THE LAND

PP	POWER POLE
TE	TELSTRA PIT
SMH	SEWER MAIN HOLE
EBOX	ELECTRICITY BOX
FL	FLOOR LEVEL
TW	TOP WINDOW
BW	BOTTOM WINDOW
TSD	TOP SLIDING DOOR
WM	WATER METER
GM	GAS METER
TRW	TOP RETAINING WALL
BRW	BOTTOM RETAINING WALL
R/W	RETAINING WALL
IL	INVERT LEVEL (STORMWATER)
TROCK	TOP ROCK
W-B	WALL TO BOUNDARY
-E-	OVERHEAD ELECTRICITY

David C. Jackson
Surveyor Registered Under the
Surveying & Spatial Information Act 2002
ID NO. 1365

THIS PLAN IS COPYRIGHT REPRODUCTION WITHOUT
WRITTEN CONSENT IS STRICTLY PROHIBITED

D		
C		
B		
A		
CV	AMENDMENTS	DATE:

CLIENT:

ANDREW & LISA JACKSON

LAN OF:

12 HORNING PARADE
MANLY VALE

LOT 110 IN DP 11320

JACKSON SURVEYORS Pty. Ltd.
A.C.N. 091 248 636

P.O. BOX 406, CARINGBAH NSW 149
email: jacksonsurveyor@bigpond.com
PH: (02) 9525 5501

SURVEYOR: DJ
DATUM: AHD
ORIGIN: PM 504 RL 54.431
JOB REFERENCE NO. 3019
COMPUTER REF: NO. DWG3019
RATIO: 1:100 @AO
DATE: 3-2-2021