

DEVELOPMENT APPLICATION ASSESSMENT REPORT

Application Number:	DA2021/0424
----------------------------	-------------

Responsible Officer:	Phil Lane
Land to be developed (Address):	Lot 2 DP 1241568, 888 Pittwater Road DEE WHY NSW 2099
Proposed Development:	Alterations and additions to a commercial building to include a designated supermarket pick-up area within the Level 1 car park
Zoning:	Warringah LEP2011 - Land zoned B4 Mixed Use
Development Permissible:	Yes
Existing Use Rights:	No
Consent Authority:	Northern Beaches Council
Land and Environment Court Action:	No
Owner:	Karimbla Properties (No41) Pty Ltd
Applicant:	Woolworths Limited Pty Ltd

Application Lodged:	30/04/2021
Integrated Development:	No
Designated Development:	No
State Reporting Category:	Commercial/Retail/Office
Notified:	06/05/2021 to 20/05/2021
Advertised:	Not Advertised
Submissions Received:	0
Clause 4.6 Variation:	Nil
Recommendation:	Approval

Estimated Cost of Works:	\$ 1.00
---------------------------------	---------

PROPOSED DEVELOPMENT IN DETAIL

"This application seeks approval to undertake minor works to facilitate the expansion of the existing grocery pick-up service at Woolworths Dee Why. The proposal requires minor modification and building works to facilitate a grocery storage area and four (4) additional pickup parking spaces. Existing directional signage will be refreshed to inform customers about the service and provide internal directions to the pick-up area.

The existing pick-up service comprises two (2) designated pick up spaces. The proposal increases this number to six (6) together with the grocery storage facility. The storage and service area is required to be located as close as possible to both the parking spaces and access to the supermarket for delivery of orders from the supermarket floor to the customer pick-up area in Parking Level 1.

Commercial bike parking is retained and the ten (10) racks dislocated by the grocery storage facility are to be relocated within the car park."

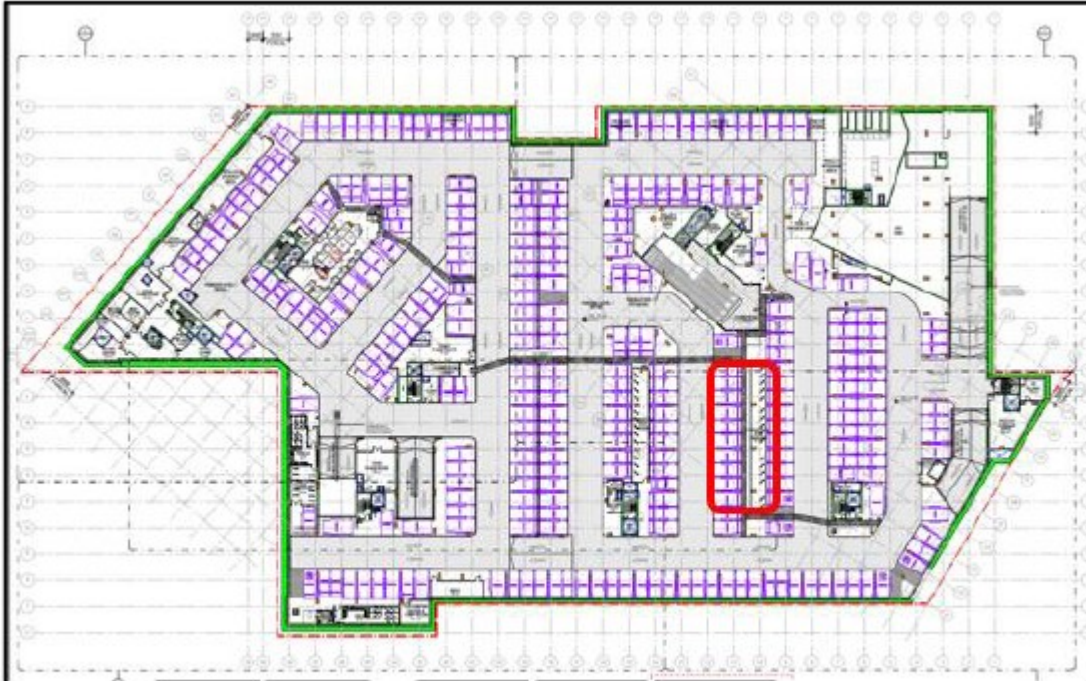

Figure 1: Location of Click and Collect storage and pick up area within Parking Level 1 (purple spaces are parking spaces allocated to Woolworths)



Figure 2: Layout of Click and Click service within Parking Level 1

ASSESSMENT INTRODUCTION

The application has been assessed in accordance with the requirements of the Environmental Planning and Assessment Act 1979 and the associated Regulations. In this regard:

- An assessment report and recommendation has been prepared (the subject of this report) taking into account all relevant provisions of the Environmental Planning and Assessment Act 1979, and the associated regulations;
- A site inspection was conducted and consideration has been given to the impacts of the

- development upon the subject site and adjoining, surrounding and nearby properties;
- Notification to adjoining and surrounding properties, advertisement (where required) and referral to relevant internal and external bodies in accordance with the Act, Regulations and relevant Development Control Plan;
- A review and consideration of all submissions made by the public and community interest groups in relation to the application;
- A review and consideration of all documentation provided with the application (up to the time of determination);
- A review and consideration of all referral comments provided by the relevant Council Officers, State Government Authorities/Agencies and Federal Government Authorities/Agencies on the proposal.

SUMMARY OF ASSESSMENT ISSUES

Assessment - Dee Why Town Centre Contributions Plan 2019

Warringah Development Control Plan - C3 Parking Facilities

Warringah Development Control Plan - C3(A) Bicycle Parking and End of Trip Facilities

SITE DESCRIPTION

Property Description:	Lot 2 DP 1241568 , 888 Pittwater Road DEE WHY NSW 2099
Detailed Site Description:	<p>The site is irregular in shape and is bound by Howard Avenue to the north, Oaks Avenue to the south and Pittwater Road to the west. The site is further bound by shared boundaries between itself and several other development sites both to the east and south-west.</p> <p>The site has a total area of 14.466m².</p> <p>The site is centrally located within the Dee Why Town Centre as defined in the Dee Why Town Centre Master Plan 2013 (DYTC Masterplan) and zoned B4 Mixed Use under the Warringah Local Environmental Plan 2011.</p> <p>The existing topography of the site slopes from west to east, with a cross-fall of approximately 4m from the highest point on the south-western corner of the Pittwater Road frontage, to the lowest point.</p>

Map:



SITE HISTORY

DA2016/0705 - for the redevelopment of the site as a Mixed Use Development was approved by the Sydney Planning Panel on 10 May 2017.

DA2019/0779 - Use of part of commercial premises as additional ancillary storage was approved on 1 October 2019

REV2019/0056 - Review of Determination of Application DA2019/0404 for two Kiosk structures and associated outdoor seating was withdrawn on 5 November 2019

DA2020/0714 - Use of premises as a car wash facility including fitout was withdrawn on 13 August 2020

ENVIRONMENTAL PLANNING AND ASSESSMENT ACT, 1979 (EPAA)

The relevant matters for consideration under the Environmental Planning and Assessment Act, 1979, are:

Section 4.15 Matters for Consideration'	Comments
Section 4.15 (1) (a)(i) – Provisions of any environmental planning instrument	See discussion on “Environmental Planning Instruments” in this report.
Section 4.15 (1) (a)(ii) – Provisions of any draft environmental planning instrument	Draft State Environmental Planning Policy (Remediation of Land) seeks to replace the existing SEPP No. 55 (Remediation of Land). Public consultation on the draft policy was completed on 13 April 2018. The subject site has been used for residential/commercial/retail purposes for an extended period of time. The proposed development retains the residential/commercial/retail uses of the site, and is not considered a contamination risk.
Section 4.15 (1) (a)(iii) –	Warringah Development Control Plan applies to this proposal.

Section 4.15 Matters for Consideration'	Comments
Provisions of any development control plan	
Section 4.15 (1) (a)(iia) – Provisions of any planning agreement	None applicable.
Section 4.15 (1) (a)(iv) – Provisions of the Environmental Planning and Assessment Regulation 2000 (EP&A Regulation 2000)	<p><u>Division 8A</u> of the EP&A Regulation 2000 requires the consent authority to consider "Prescribed conditions" of development consent. These matters have been addressed via a condition of consent.</p> <p><u>Clauses 54 and 109</u> of the EP&A Regulation 2000 allow Council to request additional information. No additional information was requested in this case.</p> <p><u>Clause 92</u> of the EP&A Regulation 2000 requires the consent authority to consider AS 2601 - 1991: The Demolition of Structures. This matter has been addressed via a condition of consent.</p> <p><u>Clause 98</u> of the EP&A Regulation 2000 requires the consent authority to consider insurance requirements under the Home Building Act 1989. This matter has been addressed via a condition of consent.</p> <p><u>Clause 98</u> of the EP&A Regulation 2000 requires the consent authority to consider the provisions of the Building Code of Australia (BCA). This matter has been addressed via a condition of consent.</p>
Section 4.15 (1) (b) – the likely impacts of the development, including environmental impacts on the natural and built environment and social and economic impacts in the locality	<p>(i) Environmental Impact The environmental impacts of the proposed development on the natural and built environment are addressed under the Warringah Development Control Plan section in this report.</p> <p>(ii) Social Impact The proposed development will not have a detrimental social impact in the locality considering the character of the proposal.</p> <p>(iii) Economic Impact The proposed development will not have a detrimental economic impact on the locality considering the nature of the existing and proposed land use.</p>
Section 4.15 (1) (c) – the suitability of the site for the development	The site is considered suitable for the proposed development.
Section 4.15 (1) (d) – any submissions made in accordance with the EPA Act or EPA Regs	See discussion on "Notification & Submissions Received" in this report.
Section 4.15 (1) (e) – the public interest	No matters have arisen in this assessment that would justify the refusal of the application in the public interest.

EXISTING USE RIGHTS

Existing Use Rights are not applicable to this application.

BUSHFIRE PRONE LAND

The site is not classified as bush fire prone land.

NOTIFICATION & SUBMISSIONS RECEIVED

The subject development application has been publicly exhibited from 06/05/2021 to 20/05/2021 in accordance with the Environmental Planning and Assessment Act 1979, Environmental Planning and Assessment Regulation 2000 and the Community Participation Plan.

As a result of the public exhibition of the application Council received no submissions.

REFERRALS

Internal Referral Body	Comments
Traffic Engineer	The application has been assessed and is a minor modification to allow the use of the existing commercial bike storage area and adjoining 6 parking spaces for the direct to car pick up style service. No objection is raised with the proposal and conditions provided to offset the removal of the bike parking

External Referral Body	Comments
Ausgrid: (SEPP Infra.)	Approval, no conditions required on this instance.

ENVIRONMENTAL PLANNING INSTRUMENTS (EPIs)*

All, Environmental Planning Instruments (SEPPs, REPs and LEPs), Development Controls Plans and Council Policies have been considered in the merit assessment of this application.

In this regard, whilst all provisions of each Environmental Planning Instruments (SEPPs, REPs and LEPs), Development Controls Plans and Council Policies have been considered in the assessment, many provisions contained within the document are not relevant or are enacting, definitions and operational provisions which the proposal is considered to be acceptable against.

As such, an assessment is provided against the controls relevant to the merit consideration of the application hereunder.

State Environmental Planning Policies (SEPPs) and State Regional Environmental Plans (SREPs)

SEPP 55 - Remediation of Land

Draft State Environmental Planning Policy (Remediation of Land) seeks to replace the existing SEPP No. 55 (Remediation of Land). Public consultation on the draft policy was completed on 13 April 2018. The subject site has been used for residential/commercial/retail purposes for an extended period of time. The proposed development retains the residential/commercial/retail uses of the site, and is not considered a contamination risk.

SEPP (Infrastructure) 2007

Ausgrid

Clause 45 of the SEPP requires the Consent Authority to consider any development application (or an application for modification of consent) for any development carried out:

- within or immediately adjacent to an easement for electricity purposes (whether or not the electricity infrastructure exists).
- immediately adjacent to an electricity substation.
- within 5.0m of an overhead power line.
- includes installation of a swimming pool any part of which is: within 30m of a structure supporting an overhead electricity transmission line and/or within 5.0m of an overhead electricity power line.

Comment:

Approval, no conditions required on this instance.

Warringah Local Environmental Plan 2011

Is the development permissible?	Yes
After consideration of the merits of the proposal, is the development consistent with:	
aims of the LEP?	Yes
zone objectives of the LEP?	Yes

Compliance Assessment

Clause	Compliance with Requirements
Part 1 Preliminary	Yes
Land Use Table	Yes
Part 4 Principal development standards	Yes
4.3 Height of buildings	Yes
Part 6 Additional Local Provisions	Yes
6.2 Earthworks	Yes
6.3 Flood planning	Yes
6.4 Development on sloping land	Yes
Part 7 Dee Why Town Centre	Yes
7.3 Objectives for development within Dee Why Town Centre	Yes
7.4 Development must be consistent with objectives for development and design excellence	Yes
7.5 Design excellence within Dee Why Town Centre	Yes
7.6 Height of buildings	Yes
7.12 Provisions promoting retail activity	Yes

Clause	Compliance with Requirements
7.13 Mobility, traffic management and parking	Yes

Warringah Development Control Plan

Compliance Assessment

Clause	Compliance with Requirements	Consistency Aims/Objectives
Part A Introduction	Yes	Yes
A.5 Objectives	Yes	Yes
Part C Siting Factors	Yes	Yes
C2 Traffic, Access and Safety	Yes	Yes
C3 Parking Facilities	Yes	Yes
C3(A) Bicycle Parking and End of Trip Facilities	Yes	Yes
C4 Stormwater	Yes	Yes
C6 Building over or adjacent to Constructed Council Drainage Easements	Yes	Yes
C7 Excavation and Landfill	Yes	Yes
C8 Demolition and Construction	Yes	Yes
C9 Waste Management	Yes	Yes
Part D Design	Yes	Yes
D3 Noise	Yes	Yes
D10 Building Colours and Materials	Yes	Yes
D14 Site Facilities	Yes	Yes
D18 Accessibility and Adaptability	Yes	Yes
D20 Safety and Security	Yes	Yes
D21 Provision and Location of Utility Services	Yes	Yes
D23 Signs	Yes	Yes
Part E The Natural Environment	Yes	Yes
E7 Development on land adjoining public open space	Yes	Yes
E10 Landslip Risk	Yes	Yes
E11 Flood Prone Land	Yes	Yes
1 Introduction	Yes	Yes
2 About the Dee Why Town Centre	Yes	Yes
3 Desired Character for the Dee Why Town Centre	Yes	Yes
4 Streetscape and Public Domain	Yes	Yes
5 Design and Architectural Diversity	Yes	Yes
6 Site amalgamation	Yes	Yes
7 Traffic and Parking	Yes	Yes
8 Car Share	Yes	Yes
9 Sustainability	Yes	Yes

Detailed Assessment

C3 Parking Facilities

The approved development provides on-site car parking for 1,035 vehicles of which 547 spaces are proposed to be allocated for non-residential uses (commercial/retail) and the remaining 488 spaces are for residents and residential visitors.

The parking numbers remain unaltered by this proposal and the pick up spaces facilitate customers who would already utilise the parking for their shopping needs as the land use is not changing (supermarket).

C3(A) Bicycle Parking and End of Trip Facilities

The approved development provides 178 bicycle parking spaces for residential units, 15 spaces for residential visitors, and 15 spaces for retail uses.

A condition has been included for bicycles spaces for the retail uses to be replaced therefore the number of spaces will remain unaltered.

THREATENED SPECIES, POPULATIONS OR ECOLOGICAL COMMUNITIES

The proposal will not significantly affect threatened species, populations or ecological communities, or their habitats.

CRIME PREVENTION THROUGH ENVIRONMENTAL DESIGN

The proposal is inconsistent with the principles of Crime Prevention Through Environmental Design.

Dee Why Town Centre Contributions Plan 2019

Not applicable for this proposed development.

CONCLUSION

The site has been inspected and the application assessed having regard to all documentation submitted by the applicant and the provisions of:

- Environmental Planning and Assessment Act 1979;
- Environmental Planning and Assessment Regulation 2000;
- All relevant and draft Environmental Planning Instruments;
- Warringah Local Environment Plan;
- Warringah Development Control Plan; and
- Codes and Policies of Council.

This assessment has taken into consideration the submitted plans, Statement of Environmental Effects, all other documentation supporting the application and public submissions, and does not result in any unreasonable impacts on surrounding, adjoining, adjacent and nearby properties subject to the conditions contained within the recommendation.

In consideration of the proposal and the merit consideration of the development, the proposal is

considered to be:

- Consistent with the objectives of the DCP
- Consistent with the zone objectives of the LEP
- Consistent with the aims of the LEP
- Consistent with the objectives of the relevant EPIs
- Consistent with the objects of the Environmental Planning and Assessment Act 1979

It is considered that the proposed development satisfies the appropriate controls and that all processes and assessments have been satisfactorily addressed.

RECOMMENDATION

THAT Council as the consent authority grant Development Consent to DA2021/0424 for Alterations and additions to a commercial building to include a designated supermarket pick-up area within the Level 1 car park on land at Lot 2 DP 1241568, 888 Pittwater Road, DEE WHY, subject to the conditions printed below:

DEVELOPMENT CONSENT OPERATIONAL CONDITIONS

1. **Approved Plans and Supporting Documentation**

The development must be carried out in compliance (except as amended by any other condition of consent) with the following:

a) Approved Plans

Architectural Plans - Endorsed with Council's stamp		
Drawing No.	Dated	Prepared By
A0012-P-P1	July 2017	Meriton
WA200a (Amend B)	10 August 2021	TRG

b) Any plans and / or documentation submitted to satisfy the Conditions of this consent.

In the event of any inconsistency between conditions of this consent and the drawings/documents referred to above, the conditions of this consent will prevail.

Reason: To ensure the work is carried out in accordance with the determination of Council and approved plans.

2. **Prescribed Conditions**

- (a) All building works must be carried out in accordance with the requirements of the Building Code of Australia (BCA).
- (b) BASIX affected development must comply with the schedule of BASIX commitments specified within the submitted BASIX Certificate (demonstrated compliance upon plans/specifications is required prior to the issue of the Construction Certificate);
- (c) A sign must be erected in a prominent position on any site on which building work, subdivision work or demolition work is being carried out:
 - (i) showing the name, address and telephone number of the Principal Certifying

Authority for the work, and

- (ii) showing the name of the principal contractor (if any) for any building work and a telephone number on which that person may be contacted outside working hours, and
- (iii) stating that unauthorised entry to the work site is prohibited.

Any such sign is to be maintained while the building work, subdivision work or demolition work is being carried out, but must be removed when the work has been completed.

- (d) Residential building work within the meaning of the Home Building Act 1989 must not be carried out unless the Principal Certifying Authority for the development to which the work relates (not being the Council) has given the Council written notice of the following information:
 - (i) in the case of work for which a principal contractor is required to be appointed:
 - A. the name and licence number of the principal contractor, and
 - B. the name of the insurer by which the work is insured under Part 6 of that Act,
 - (ii) in the case of work to be done by an owner-builder:
 - A. the name of the owner-builder, and
 - B. if the owner-builder is required to hold an owner-builder permit under that Act, the number of the owner-builder permit.

If arrangements for doing the residential building work are changed while the work is in progress so that the information notified under becomes out of date, further work must not be carried out unless the Principal Certifying Authority for the development to which the work relates (not being the Council) has given the Council written notice of the updated information.

- (e) Development that involves an excavation that extends below the level of the base of the footings of a building on adjoining land, the person having the benefit of the development consent must, at the person's own expense:
 - (i) protect and support the adjoining premises from possible damage from the excavation, and
 - (ii) where necessary, underpin the adjoining premises to prevent any such damage.
 - (iii) must, at least 7 days before excavating below the level of the base of the footings of a building on an adjoining allotment of land, give notice of intention to do so to the owner of the adjoining allotment of land and furnish particulars of the excavation to the owner of the building being erected or demolished.
 - (iv) the owner of the adjoining allotment of land is not liable for any part of the cost of work carried out for the purposes of this clause, whether carried out on the allotment of land being excavated or on the adjoining allotment of land.

In this clause, allotment of land includes a public road and any other public place.

Reason: Legislative requirement.

3. General Requirements

- (a) Unless authorised by Council:
Building construction and delivery of material hours are restricted to:
 - 7.00 am to 5.00 pm inclusive Monday to Friday,

- 8.00 am to 1.00 pm inclusive on Saturday,
- No work on Sundays and Public Holidays.

Demolition and excavation works are restricted to:

- 8.00 am to 5.00 pm Monday to Friday only.

(Excavation work includes the use of any excavation machinery and the use of jackhammers, rock breakers, excavators, loaders and the like, regardless of whether the activities disturb or alter the natural state of the existing ground stratum or are breaking up/removing materials from the site).

- (b) Should any asbestos be uncovered on site, its demolition and removal must be carried out in accordance with WorkCover requirements and the relevant Australian Standards.
- (c) At all times after the submission the Notice of Commencement to Council, a copy of the Development Consent and Construction Certificate is to remain onsite at all times until the issue of a final Occupation Certificate. The consent shall be available for perusal of any Authorised Officer.
- (d) Where demolition works have been completed and new construction works have not commenced within 4 weeks of the completion of the demolition works that area affected by the demolition works shall be fully stabilised and the site must be maintained in a safe and clean state until such time as new construction works commence.
- (e) Onsite toilet facilities (being either connected to the sewer or an accredited sewer management facility) for workers are to be provided for construction sites at a rate of 1 per 20 persons.
- (f) Prior to the release of the Construction Certificate, payment of the Long Service Levy is required. This payment can be made at Council or to the Long Services Payments Corporation. Payment is not required where the value of the works is less than \$25,000. The Long Service Levy is calculated on 0.35% of the building and construction work. The levy rate and level in which it applies is subject to legislative change. The applicable fee at the time of payment of the Long Service Levy will apply.
- (g) The applicant shall bear the cost of all works associated with the development that occurs on Council's property.
- (h) No skip bins, building materials, demolition or excavation waste of any nature, and no hoist, plant or machinery (crane, concrete pump or lift) shall be placed on Council's footpaths, roadways, parks or grass verges without Council Approval.
- (i) Demolition materials and builders' wastes are to be removed to approved waste/recycling centres.
- (j) No trees or native shrubs or understorey vegetation on public property (footpaths, roads, reserves, etc.) or on the land to be developed shall be removed or damaged during construction unless specifically approved in this consent including for the erection of any fences, hoardings or other temporary works.
- (k) Prior to the commencement of any development onsite for:
 - i) Building/s that are to be erected
 - ii) Building/s that are situated in the immediate vicinity of a public place and is dangerous to persons or property on or in the public place
 - iii) Building/s that are to be demolished
 - iv) For any work/s that is to be carried out

- v) For any work/s that is to be demolished
The person responsible for the development site is to erect or install on or around the development area such temporary structures or appliances (wholly within the development site) as are necessary to protect persons or property and to prevent unauthorised access to the site in order for the land or premises to be maintained in a safe or healthy condition. Upon completion of the development, such temporary structures or appliances are to be removed within 7 days.
- (l) A "Road Opening Permit" must be obtained from Council, and all appropriate charges paid, prior to commencement of any work on Council property. The owner/applicant shall be responsible for all public utilities and services in the area of the work, shall notify all relevant Authorities, and bear all costs associated with any repairs and/or adjustments as those Authorities may deem necessary.
- (m) The works must comply with the relevant Ausgrid Network Standards and SafeWork NSW Codes of Practice.
- (n) Requirements for new swimming pools/spas or existing swimming pools/spas affected by building works.
- (1) Child resistant fencing is to be provided to any swimming pool or lockable cover to any spa containing water and is to be consistent with the following;
- Relevant legislative requirements and relevant Australian Standards (including but not limited) to:
- (i) Swimming Pools Act 1992
 - (ii) Swimming Pools Amendment Act 2009
 - (iii) Swimming Pools Regulation 2018
 - (iv) Australian Standard AS1926 Swimming Pool Safety
 - (v) Australian Standard AS1926.1 Part 1: Safety barriers for swimming pools
 - (vi) Australian Standard AS1926.2 Part 2: Location of safety barriers for swimming pools.
- (2) A 'KEEP WATCH' pool safety and aquatic based emergency sign, issued by Royal Life Saving is to be displayed in a prominent position within the pool/spa area.
- (3) Filter backwash waters shall be conveyed to the Sydney Water sewerage system in sewered areas or managed on-site in unsewered areas in a manner that does not cause pollution, erosion or run off, is separate from the irrigation area for any wastewater system and is separate from any onsite stormwater management system.
- (4) Swimming pools and spas must be registered with the Division of Local Government.

Reason: To ensure that works do not interfere with reasonable amenity expectations of residents and the community.

CONDITIONS TO BE SATISFIED PRIOR TO THE ISSUE OF THE CONSTRUCTION CERTIFICATE

4. Car Parking Finishes

All driveways, car parking areas and pedestrian paths are to be treated in a non-slip coating. Details of treatment to these areas are to be submitted to the Certifying Authority prior to issue

of the Construction Certificate.

Reason: To provide provide a safe treatment for delineation of the pick up spaces..

5. **Compliance with Standards**

The development is required to be carried out in accordance with all relevant Australian Standards.

Details demonstrating compliance with the relevant Australian Standard are to be submitted to the Certifying Authority prior to the issue of the Construction Certificate.

Reason: To ensure the development is constructed in accordance with appropriate standards.

6. **Bike Parking relocation**

Prior to the issue of a Construction Certificate, a plan demonstrating the provision of 16 Bicycle hoops (or parking for 32 Bicycles) to replace those removed by the proposal is to be submitted to the Principal Certifying Authority.

Reason: To ensure the active transport component of the existing development is not compromised (DACTRCPC2)

7. **Waste Management Plan**

A Waste Management Plan must be prepared for this development. The Plan must be in accordance with the Development Control Plan.

Details demonstrating compliance must be provided to the Certifying Authority prior to the issue of the Construction Certificate.

Reason: To ensure that any demolition and construction waste, including excavated material, is reused, recycled or disposed of in an environmentally friendly manner.

CONDITIONS TO BE COMPLIED WITH DURING DEMOLITION AND BUILDING WORK

8. **Installation and Maintenance of Sediment Control**

Prior to any works commencing on site, including demolition, sediment and erosion controls must be installed in accordance with Landcom's 'Managing Urban Stormwater: Soils and Construction' (2004). Techniques used for erosion and sediment control on site are to be adequately maintained and monitored at all times, particularly after periods of rain, and shall remain in proper operation until all development activities have been completed and the site is sufficiently stabilised with vegetation.

Reason: To protect the surrounding environment from the effects of sedimentation and erosion from the site.

9. **Waste Management During Development**

The reuse, recycling or disposal of waste during works must be done generally in accordance with the Waste Management Plan for this development.

Details demonstrating compliance must be submitted to the Principal Certifying Authority.

Reason: To ensure demolition and construction waste is recycled or reused and to limit landfill.

CONDITIONS WHICH MUST BE COMPLIED WITH PRIOR TO THE ISSUE OF THE OCCUPATION CERTIFICATE

10. **Removal of All Temporary Structures/Material and Construction Rubbish**
Once construction has been completed all silt and sediment fences, silt, rubbish, building debris, straw bales and temporary fences are to be removed from the site.
- Details demonstrating compliance are to be submitted to the Principal Certifying Authority prior to the issue of any interim / final Occupation Certificate.
- Reason: To ensure bushland management. (DACPLF01)
11. **Waste Management Confirmation**
Prior to the issue of a Final Occupation Certificate, evidence / documentation must be submitted to the Principal Certifying Authority that all waste material from the development site arising from demolition and/or construction works has been appropriately recycled, reused or disposed of generally in accordance with the approved Waste Management Plan.
- Reason: To ensure demolition and construction waste is recycled or reused and to limit landfill.

ON-GOING CONDITIONS THAT MUST BE COMPLIED WITH AT ALL TIMES

12. **Sight lines within carparks**
The required sight lines to pedestrians and other vehicles in and around the carpark and entrance(s) are not to be obstructed by signage.
- Reason: To maintain unobstructed sight distance for motorists.

In signing this report, I declare that I do not have a Conflict of Interest.

Signed

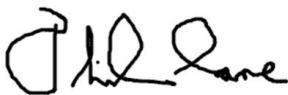

Phil Lane, Principal Planner

The application is determined on 27/05/2021, under the delegated authority of:



Rodney Piggott, Manager Development Assessments