

Legend

	Colour / Stencil Concrete
	Pebbles / Decorative Gravel Areas
	Planting Areas
	Lawn Areas
	Retaining Wall
	1800mm High Boundary Fencing

Revision Schedule

Issue:	Description:	By:	Date:
A	Submission Plan	OS	08/02/21
B	Client: R. Walls	JS	22/02/21
C	Client: Various	JS	22/02/21

Drafted:	Scale: 1:200
JS	

Sheet:	Reference:
1 of 4	LP 01

Designed by:
Julian Saw
 Diploma of Horticulture
 (Landscape Design)

- General Notes:
- See Architects drawings for site levels, setbacks and extent of cut and fill.
 - This plan shall be read in conjunction with the Hydraulic Engineers drawings.
 - All relevant Australian standards are to be adhered to.
 - Any structural items are to be installed as per the manufacturer/engineers specifications.
 - This plan is indicative only and not for construction purposes.

SITE CALCULATIONS

LOT AREA	302.5 sq m
LANDSCAPED AREA TOTAL	127 sq m 41.994%

[Click Here to View Our Plant Profiles!](#)

Client: **Mr Tomas & Mrs Huang**

Client Signatures:
 1.
 2.

Job No. **210038**

Drawing: **Landscape Plan**

Address: **Lot 14 No.14 Baz Retreat Warriewood**

Council/Lodgement: **Northern Beaches/DA**

DappleDesigns

Ph: 1 300 DAPPLE (1300 327753)
 E: info@dappledesigns.com.au
 www.dappledesigns.com.au

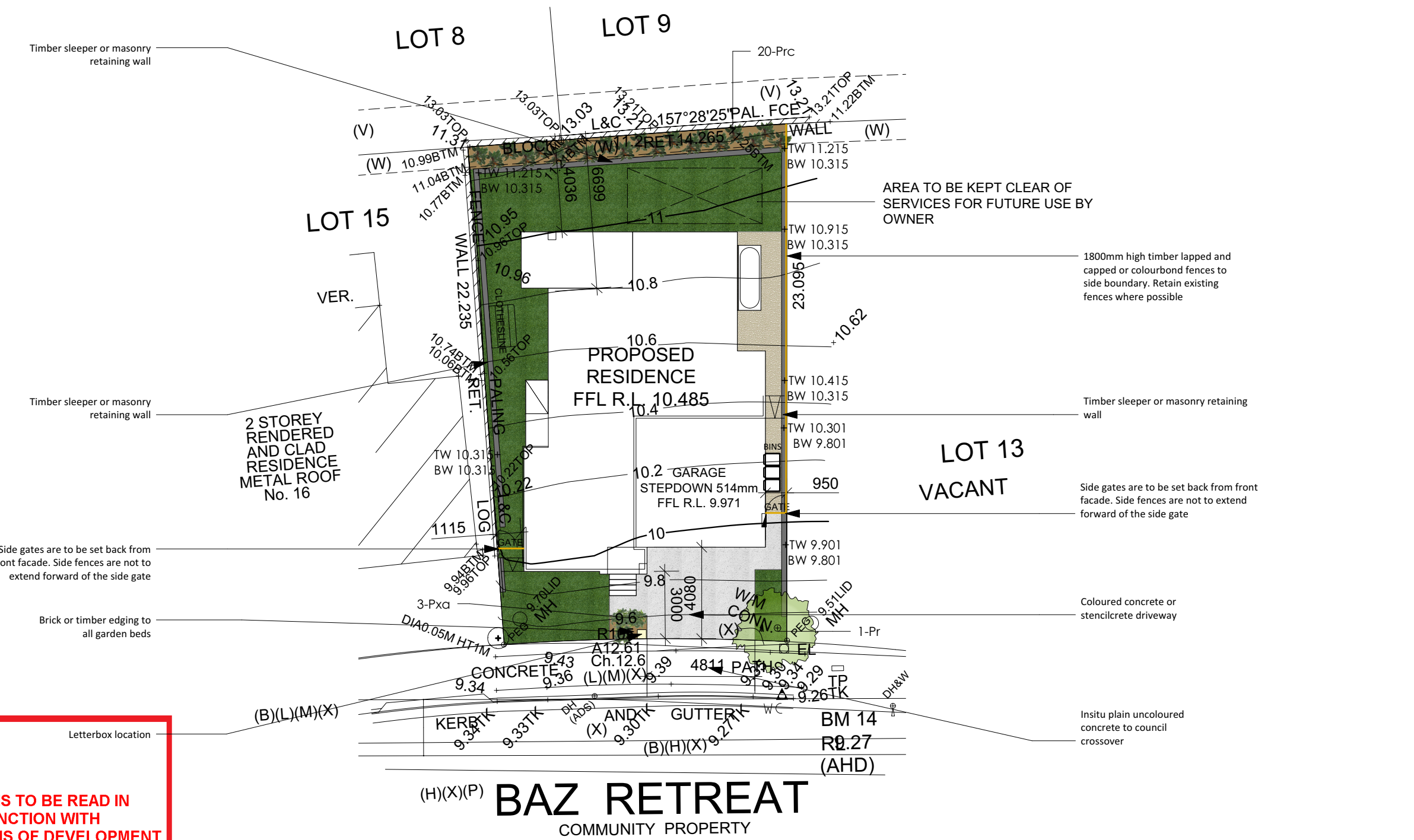

THIS PLAN IS TO BE READ IN CONJUNCTION WITH THE CONDITIONS OF DEVELOPMENT CONSENT

DA2021/0291

Any existing trees are to be protected in accordance with councils Tree Protection Detail

- (B) EASEMENT TO DRAIN WATER 2.5 WIDE (VIDE DP1206507)
- (H) EASEMENT FOR SEWERAGE PURPOSES 5 WIDE (VIDE 6390790) (APPROXIMATE POSITION ONLY)
- (L) EASEMENT FOR WATER SUPPLY PURPOSES 2.5 WIDE (VIDE 6390860)
- (M) EASEMENT FOR ACCESS AND DRAINAGE PURPOSES 2.5 WIDE (VIDE DP1206507)
- (P) EASEMENT FOR ELECTRICITY AND OTHER PURPOSES 24.5 WIDE (VIDE DP1206507)
- (V) EASEMENT TO DRAIN WATER 2 WIDE (VIDE DP 1206507)
- (W) EASEMENT FOR ACCESS, MAINTENANCE AND SUPPORT 0.9 WIDE (VIDE DP1206507)
- (X) RIGHT OF CARRIAGEWAY VARIABLE WIDTH No. 8

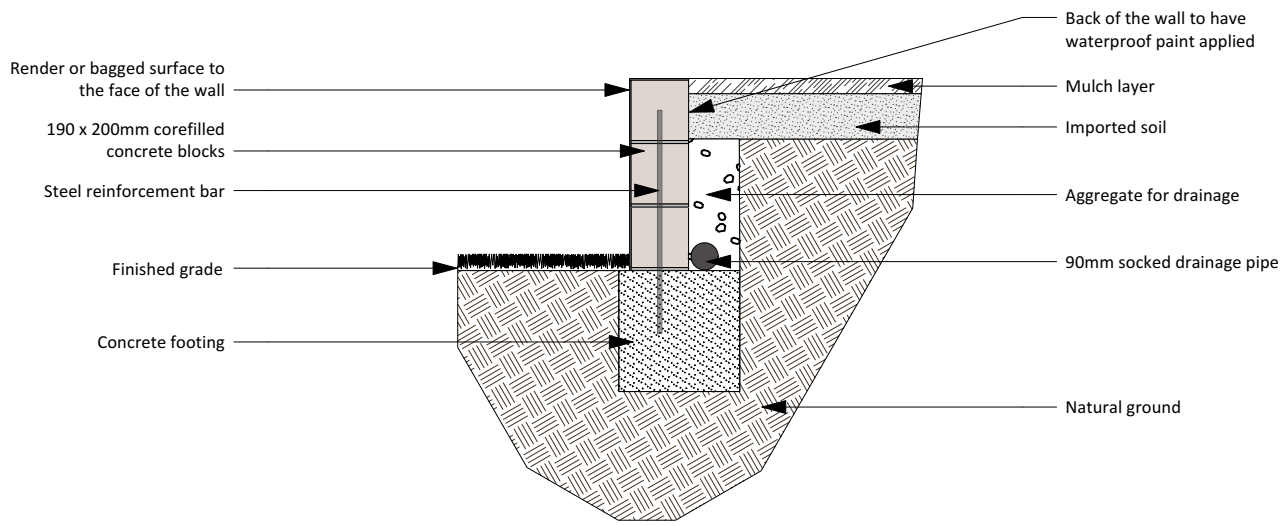

DETAILS

1. ENSURE THAT THERE IS ADEQUATE DRAINAGE BEHIND THE WALL
2. WALL IS TO BE STAIGHT
3. REFER TO PLAN FOR HEIGHTS
4. REFER TO ENGINEERS PLANS FOR WALLS OVER EXEMPT & COMPLYING DEVELOPMENT HEIGHTS

○ RENDERED/BAGGED RETAINING WALL DETAIL

SCALE 1:25

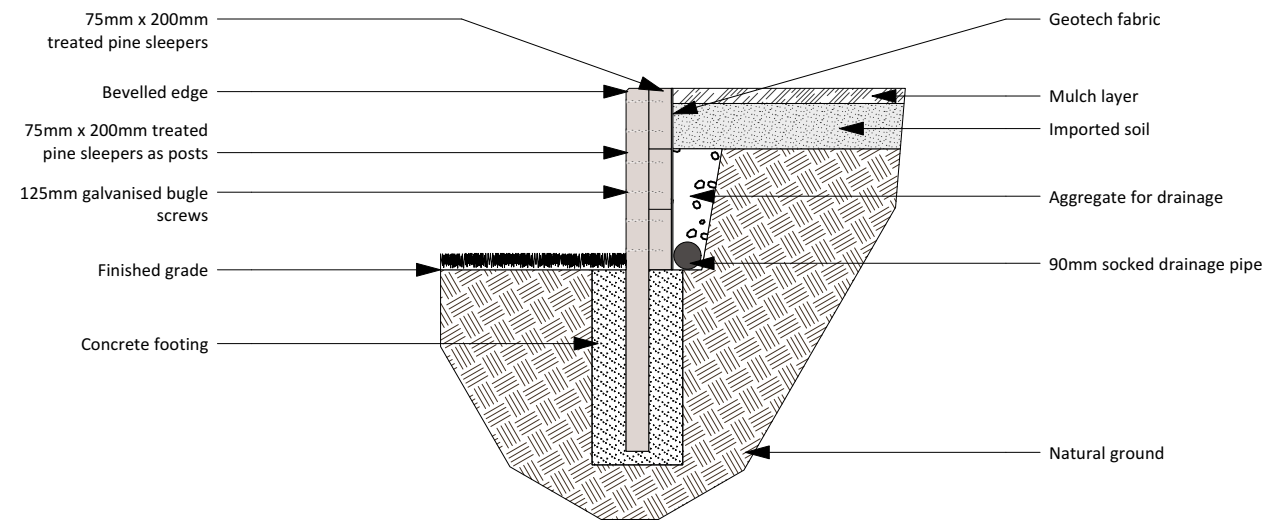

DETAILS

1. ENSURE THAT THERE IS ADEQUATE DRAINAGE BEHIND THE WALL
2. WALL IS TO BE STAIGHT OR SLIGHTLY SLANTED TOWARDS THE SOIL BEING RETAINED
3. TIMBER IS TO BE FREE OF CRACKS AND KNOTS
4. REFER TO PLAN FOR HEIGHTS
5. REFER TO ENGINEERS PLANS FOR WALLS OVER EXEMPT & COMPLYING DEVELOPMENT HEIGHTS

○ TREATED TIMBER RETAINING WALL DETAIL

SCALE 1:25

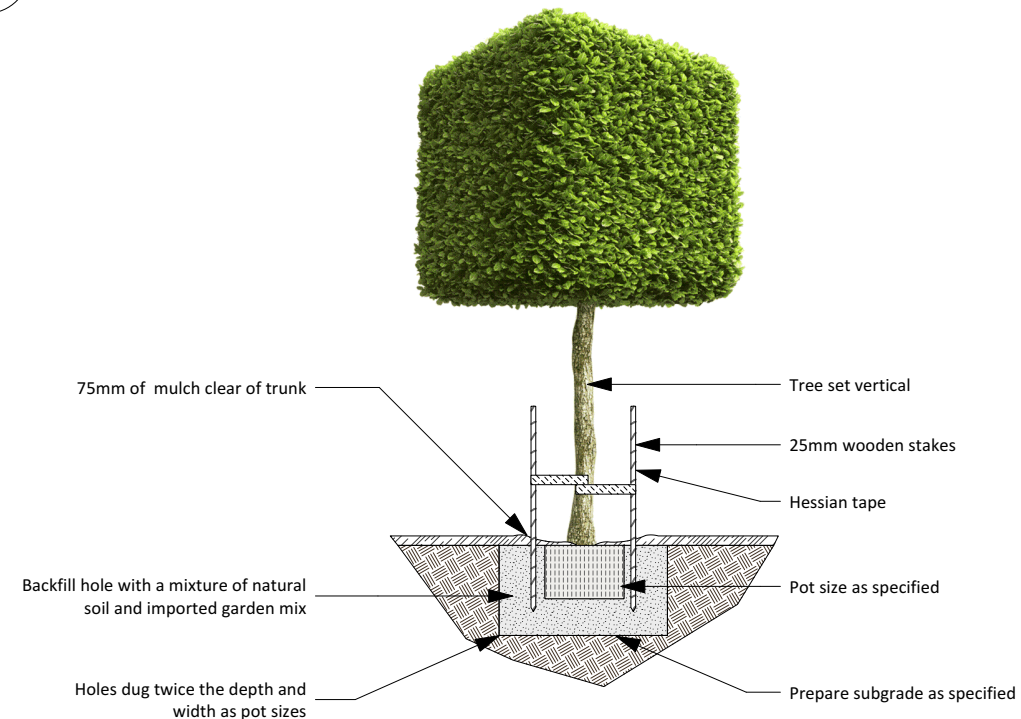

DETAILS

1. SPECIMENS ARE TO BE IN GOOD HEALTH AND FREE FROM PESTS AND DISEASES
2. WATER THROUROUGHLY AFTER PLANTING

○ TREE PLANTING DETAIL

SCALE 1:40

Revision Schedule

Issue:	Description:	By:	Date:
A	Submission Plan	OS	08/02/21
B	Client: R. Walls	JS	22/02/21
C	Client: Various	JS	22/02/21

Drafted: JS	Scale: 1:200 0 0 1 2 3 M
----------------	-----------------------------

Sheet: 3 of 4	Reference: LP 01
------------------	---------------------

Designed by:
Julian Saw
Diploma of Horticulture
(Landscape Design)

- General Notes:
1. See Architects drawings for site levels, setbacks and extent of cut and fill.
 2. This plan shall be read in conjunction with the Hydraulic Engineers drawings.
 3. All relevant Australian standards are to be adhered to.
 4. Any structural items are to be installed as per the manufacturer/engineers specifications.
 5. This plan is indicative only and not for construction purposes

SITE CALCULATIONS

LOT AREA	302.5 sq m
LANDSCAPED AREA TOTAL	127 sq m 41.994%

[Click Here to View Our Plant Profiles!](#)

Client: **Mr Tomas & Mrs Huang**

Client Signatures:

- 1.
- 2.

Job No. **210038**

Drawing: **Construction Details**

Address: **Lot 14 No.14 Baz Retreat Warriewood**

Council/Lodgement: **Northern Beaches/DA**

DappleDesigns

Ph: 1300 DAPPLE
(1300 327753)
E: info@dappledesigns.com.au
www.dappledesigns.com.au

northern beaches council

THIS PLAN IS TO BE READ IN CONJUNCTION WITH THE CONDITIONS OF DEVELOPMENT CONSENT

DA2021/0291