

FOREST

WAY

ADAMS

STREET

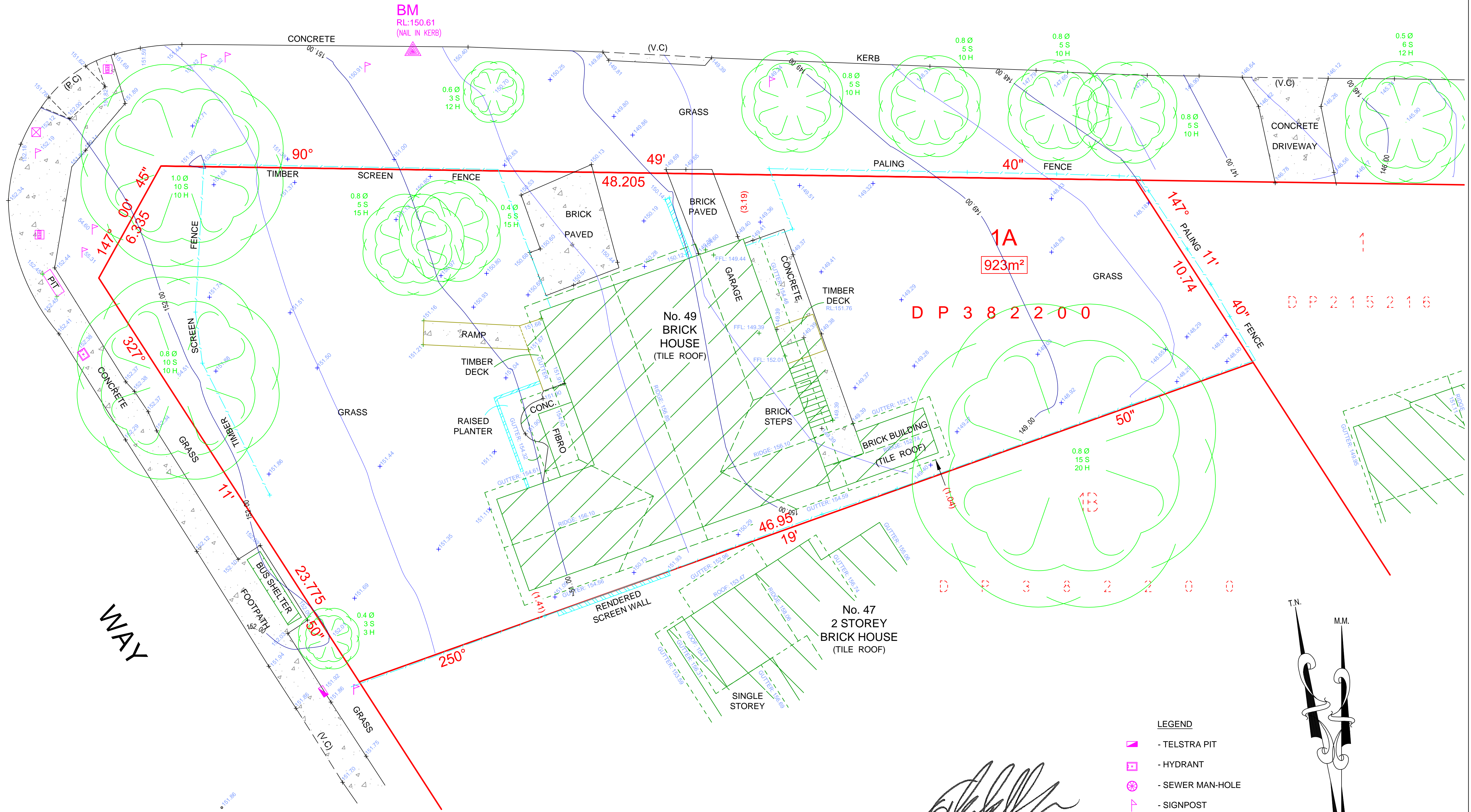

NOTES

- TREE SPREADS SHOWN 'APPROXIMATELY' ONLY
- VISIBLE SERVICES (AT TIME OF SURVEY) SHOWN ONLY
- NO SERVICE PITS ACCESSED/OPENED SHOWN AS LABELED
- BOUNDARIES BY THE TITLE DIAGRAM ONLY, (OFFSETS SHOWN BRACKETED IN RED)
- ALL PITS SHOULD BE ACCESSED, CONFIRMED AND HAVE SUBSURFACE EXTENTS MEASURED BY THE RELEVANT AUTHORITIES, PRIOR TO ADOPTION.
- ALL PIPES, CABLES & DUCTS IN THE EXCAVATION AREA SHOULD BE ACCURATELY LOCATED BY A "PIPE LOCATOR" OR BY THE RELEVANT AUTHORITY, PRIOR TO ANY EXCAVATION IS UNDERTAKEN.
- THE SUBJECT TITLE IS BURDENED BY A COVENANT (VIDE J893966)



PO BOX 3222  
REDFERN, NSW, 2016  
Ph: (02) 8065 1156  
Fax: (02) 8065 1297  
Email: survey@daw-walton.com.au

DETAIL SURVEY @  
49 FOREST WAY,  
FRENCHS FOREST NSW 2086

CLIENT: CHRISTOPHER JOHN COAPE-SMITH

JOB No: 4305-18  
REVISION.3, 30-01-20  
SHEET 1 of 1 SHEETS  
SURVEYED: 16-08-18 (JE & GM)  
DRAFTED: 24-08-18 (LJ)

SCALE: 1:100 (@A1)/ 1:200 (@A3)  
NORTH: Magnetic (by DP215216)  
DATUM: SSM14077 RL:149.808 (AHD)  
CONTOUR INT: 1.0 Maj; 0.5 Min

JOHN WALTON  
(REGISTERED SURVEYOR)  
(NSW ~ #8430)

- LEGEND
- TELSTRA PIT
  - HYDRANT
  - SEWER MAN-HOLE
  - SIGNPOST
  - TRAFFIC SIGNAL POST
  - TRAFFIC SIGNAL PIT

