

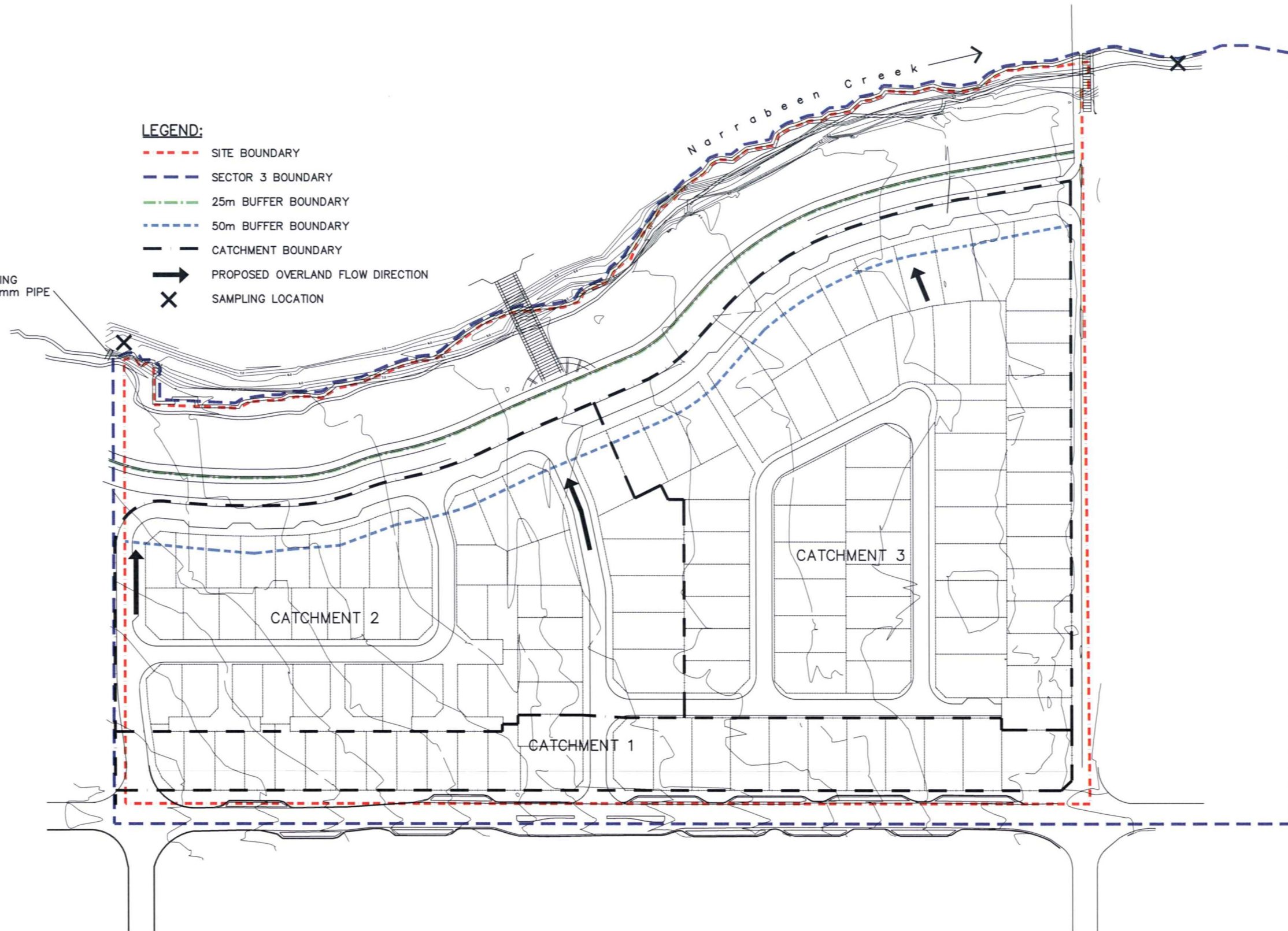

- LEGEND:**
- SITE BOUNDARY
 - SECTOR 3 BOUNDARY
 - 25m BUFFER BOUNDARY
 - 50m BUFFER BOUNDARY
 - CATCHMENT BOUNDARY
 - PROPOSED OVERLAND FLOW DIRECTION
 - X SAMPLING LOCATION

INCOMING
Ø1200mm PIPE



0 15 30 45 60 75m
1:750 (A1) 1:1500 (A3)

DRG STATUS : PRELIMINARY, NOT FOR CONSTRUCTION

						INITIALS SHOWN IN THE ADJACENT ISSUE RECORDS INDICATE THE STAGES UNDERTAKEN IN THE DRAWING APPROVAL PROCESS. DRAWINGS ARE ONLY TO BE USED WHEN APPROVED BY PATTERSON BRITTON & PARTNERS AND THEN ONLY AS NOTED FOR DRG STATUS. THE ORIGINAL SIGNATURES CAN BE FOUND ON THE REVERSE SIDE OF THE ORIGINAL OF THE DRG REGISTER/TRANSMITTAL FORM No.5.2.2. HELD BY PATTERSON BRITTON & PARTNERS	level 4 104 Mount Street North Sydney 2060 telephone (02) 9957 1619 facsimile (02) 9957 1291 email reception@pabrnt.com.au A.C.N. 003 220 228	Patterson Britton & Partners Pty Ltd consulting engineers	Client MIRVAC Project SECTOR 3 WARRIEWOOD VALLEY	Title PROPOSED CATCHMENT DETAILS	Drawing No. 5194-01 Issue C Cad File No. 5194-01 Xref.(s)
C	ISSUED FOR REZONING APPLICATION	FC	ARG	MS	24.08.05						
B	ISSUED FOR REVIEW	FC	ARG	MS	22.07.05						
A	DRAFT ISSUE	FC	ARG		14.07.05						
Issue	Details of Issue	Des'd	Drn	Chk'd	Approved	Date					