

WASTE MINIMISATION AND SORTING

THE AIM OF THIS SECTION IS TO ASSIST IN REDUCING THE AMOUNT OF MATERIAL GOING TO LANDFILL, AND TO INCREASE THE AMOUNT OF MATERIAL RECYCLED, THUS REDUCING ITS EMBODIED ENERGY AND INCREASING ITS USEFULNESS. THIS WILL ALSO RESULT IN SIGNIFICANT SAVINGS FOR THE PROJECT. WASTE MINIMISATION BEST PRACTICE SHALL BE ADHERED TO DURING THE COURSE OF THE WORKS.

1. THE BUILDER SHALL KEEP THE WORKS CLEAN AND TIDY. THE BUILDER SHALL ISSUE A DIRECTIVE TO ALL PERSONS WORKING ON THE SITE, USING AN A3 (420mm x 300mm) SIGN IN THE MOST PROMINENT POSITION AS POSSIBLE, AS FOLLOW;

'DON'T GET WASTED - GET SORTED'

EACH SUBCONTRACTOR IS RESPONSIBLE FOR THEIR WASTE AND RECYCLABLE MATERIAL IN THE APPROPRIATE CONTAINERS PROVIDED.

2. THE BUILDER SHALL PROVIDE RUBBISH CONTAINERS OR SKIPS AND REMOVE FROM THE SITE TO A SUITABLE RECYCLING STATION AS SOON AS THE CONTAINER IS FULL, IF THE MATERIAL IN NON-RECYCLABLE IT SHALL BE TAKEN TO A LICENCED LANDFILL. THE BUILDER IS RESPONSIBLE FOR PAYING ALL FEES AND CHARGES ASSOCIATED WITH DISPOSING MATERIALS NAD MUST KEEP RECEIPTS TO DOCUMENT WHERE THE MATERIAL HAS BEEN RECYCLED/DISPOSED OF. RUBBISH MUST NOT BE HEAPED ON THE GROUND OR PLACED ON THE GARDEN.

3. THE BUILDER SHALL ENSURE THAT ALL RUBBISH, WASTE AND OFFCUTS FROM EACH TRADE SUBCONTRACTOR SHALL BE PLACED BY THAT TRADE SUBCONTRACTOR INTO A CONTAINER OR SKIP BIN TO BE PROVIDED BY THE BUILDER.

ALL WASTE SHALL BE SORTED BY THE RELEVANT TRADE SUBCONTRACTORS INTO THE FOLLOWING CATAGORIES, AND DISPOSED OF AS SPECIFIED:

- FOOD SCRAPS & NON-RECYCLABLE FOOD CONTAINERS FROM WORKERS ON SITE:** - RUBBISH BIN FOR CARRYING TO EITHER AN APPROVED LOCAL TRANSFER STATION, LICENCED LANDFILL, OR FOR WEEKLY COLLECTION BY COUNCIL IN AN APPROVED BIN. (THE BUILDER SHALL ENQUIRE OF COUNCIL AS TO WHICH DAYS COLLECTIONS ARE MADE).
- PAPER, BOTTLES AND CANS FROM WORKER'S PERSONAL WASTE:** - RECYCLING CONTAINERS FOR WEEKLY COLLECTION BY COUNCIL AS ABOVE, OR TAKEN TO A LOCAL RECYCLING DEPOT IF NO PICKUP SERVICE IS AVAILABLE.
- PLASTIC PALLET WRAP:** - TO BE PLACED IN A DEDICATED AREA FOR PLASTIC RECYCLING WHERE AVAILABLE, OR PLACED IN THE GENERAL WASTE CONTAINER OR SKIP BIN IF NO OTHER OPTION EXISTS.
- STEEL PALLET STRAPS, STEEL OFF CUTS, ROOFING SHEETS, ALUMINIUM OFF CUTS ETC:** - TO BE PLACED IN A DEDICATED SKIP BIN OR CONTAINER FOR RECYCLING.
- USED PALLETS:** - SHALL BE STACKED BY TYPE IN A LOCATION ALLOWING EASY TRUCK ACCESSFOR PICKUP BY SPECIALIST CONTRACTOR. THIS SHALL BE ORGANISED BY THE BUILDER.
- MASONRY WASTE, OFF CUTS:** - SHALL BE SENT IN PURE LOADS TO THE NEAREST LOCAL CRUSHER OR OTHER APPROVED RECYCLING CENTRE.
- TIMBER OFF CUTS:** - IF NOT CHEMICALLY TREATED OR PAINTED SHALL BE SENT FOR RECYCLING EITHER BY GRINDING INTO MULCH OR BY OTHER APPROVED METHOD. TREATED TIMBER SHALL BE SENT TO A LICENCED LANDFILL.
- PLASTERBOARD OFF CUTS:** - SHALL BE STACKED IN AN UNDERCOVER LOCATION THAT ALLOWS EASY TRUCK ACCESS FOR PICKUP BY A SPECIALIST CONTRACTOR. THIS SHALL BE ORGANISED BY THE PLASTERING CONTRACTOR OR THE BUILDER.
- ALL OTHER NON-RECYCLABLE WASTE:** - SHALL BE PLACED IN A SPECIFIED CONTAINER AND TAKEN TO A LICENCED LANDFILL STATION AT REGULAR INTERVALS.

ALL DEMOLITION MATERIALS, AND WASTE AND OFF CUTS SHALL BECOME THE PROPERTY OF THE BUILDER, AND SHALL BE PLACED IN THE CORRECT CONTAINER OR SKIP BIN PROVIDED, OR REMOVED FROM THE SITE BY THE CONTRACTOR AS SOON AS PRACTICABLE.

WITH THE EXCEPTION OF METALS, MASONRY MATERIALS AND TIMBER, AD HOC RUBBISH PILES ON THE GROUND ARE NOT PERMITTED, AND ALL RUBBISH AS DEFINED ABOVE SHALL BE SORTED IN AN ENCLOSED CONTAINER OR SKIP UNTIL FULL, AND THEN REMOVED. NO SUCH CONTAINER OR SKIP BIN MAY BE STORED IN ANY PLACE THAT CONTRAVENES COUNCIL DIRECTIVES.

DEVELOPMENT APPLICATION ISSUE

CLIENT:
A. D. KEY

DRAWING TITLE:
WASTE MANAGEMENT &
MINIMISE DETAILS &
MATERIALS STORAGE

DATE: 5th February, 2020

SCALE: As Shown

DRAWN: L.K.S.

PROJECT REF: 1912 DA 13 Rev. A

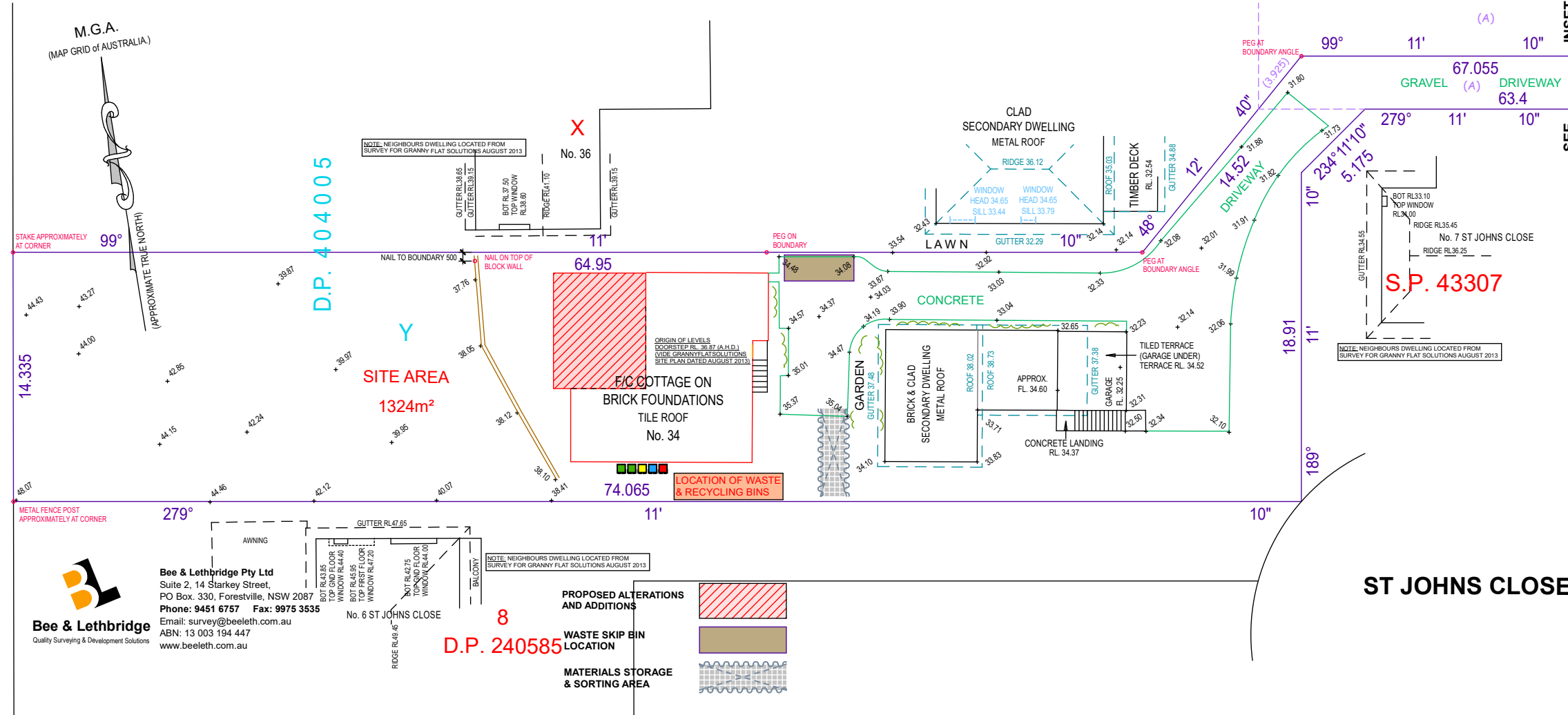
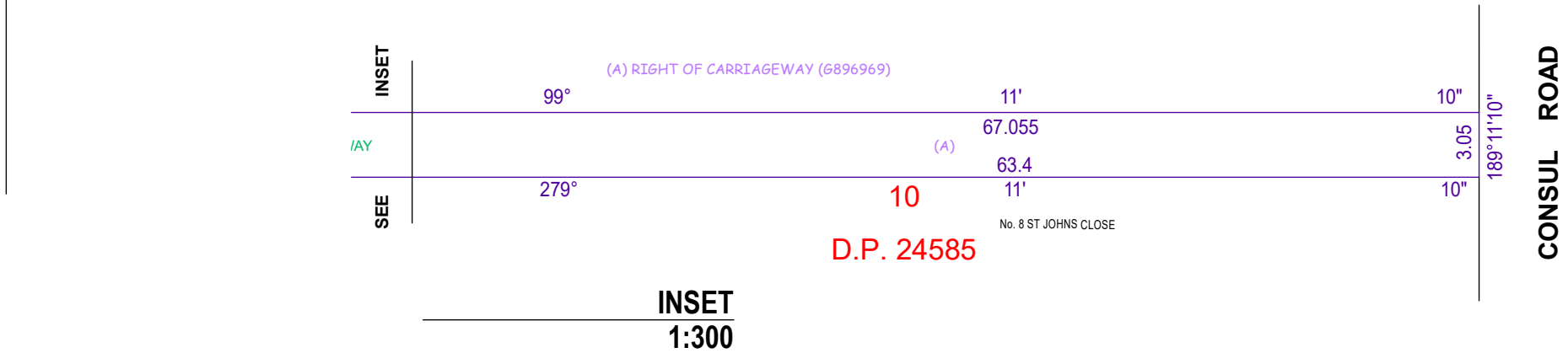

WASTE MANAGEMENT PLAN
1:300

THE BUILDER SHALL CHECK ALL DIMENSIONS AND LEVELS ON SITE PRIOR TO CONSTRUCTION. NOTIFY ANY ERRORS, DISCREPANCIES OR OMISSIONS TO THE BUILDING DESIGNER. DRAWINGS SHALL NOT BE USED FOR CONSTRUCTION PURPOSES UNTIL ISSUED FOR CONSTRUCTION. DO NOT SCALE OFF THE DRAWINGS. ALL BOUNDARIES AND CONTOURS SUBJECT TO SURVEY.

COPYRIGHT L.K.S. DESIGN AND DRAFTING
THESE DESIGNS REMAIN THE PROPERTY OF L.K.S. DESIGN & DRAFTING AND ARE SUBJECT TO THE PROVISIONS OF THE COPYRIGHT ACT AND MAY NOT BE COPIED, RETAINED OR USED IN ANY MANNER WITHOUT THE WRITTEN CONSENT OF L.K.S. DESIGN AND DRAFTING

bdca
BUILDING DESIGNERS
ASSOCIATION OF AUSTRALIA
CHARTERED ACCREDITED MEMBER
ACCREDITATION No.6120

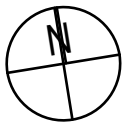

DATE	REV.	AMENDMENT
05-02-2020	A	DEVELOPMENT APPLICATION ISSUE

LKS DESIGN & DRAFTING
ABN 62343830351
ACCREDITED BUILDING DESIGNER
P.O. Box 4101, North Curl Curl, N.S.W. 2099
Mobile: 0418 662 771
Email: lks1@bigpond.net.au

PROJECT:
PROPOSED ALTERATIONS
AND ADDITIONS
34 CONSUL ROAD,
BROOKVALE, N.S.W. 2100
LOT. Y. D.P.404005

ON-GOING WASTE MANAGEMENT				Describe how you intend to ensure ongoing management of waste on-site (eg. Lease conditions, caretaker/ manager on site)
Type Of Waste To Be Generated	Expected Vol. Per Week	Proposed On-Site Storage And Treatment Facilities	Destination	
General Household Waste	80 lt / week	Council's Bin	Council's Contractor	
Glass & Metal, Paper	120 lt / alternate weeks	Council's Recycling Bin	Council's Contractor	
Garden Waste, Grass Clippings	240 lt / fortnight	Council's Bin	Council's Contractor	