

existing site habitats units

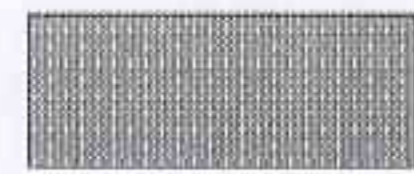

open forest bushland



disturbed vegetation



cleared areas



APZ stage 1 plan implementation - modification of vegetation

(refer specifications sheet 9)

- 1.1 The proposed allotment boundaries shall be surveyed and identified on the ground with visible pegs/stakes.
- 1.2 The proposed Bushfire Asset Protection Zones are to be surveyed and identified with visible stakes and flagging tape.
- 1.3 With the exception of Tree No. 61, all trees (including those not numbered) shall be tagged on site and are to be retained.
- 1.4 Tree No. 61 is considered to be structurally unstable and is to be removed.
- 1.5 A qualified and experienced bushland regeneration contractor who is a member of the Australian Association of Bush Regenerators shall be engaged to undertake the weed control, regeneration / revegetation works associated with this plan.
- 1.6 All trees and saplings not identified for retention and Tree No. 61 shall be removed to ground level with root systems remaining in the soil to minimise the potential for erosion.
- 1.7 All understorey shrubs with the exception of Grass Trees (Xanthorrhoea spp.) shall be removed by mechanical means leaving root systems intact.
- 1.8 All indigenous ground cover species within the existing Open Forest Bushland area shall remain.
- 1.9 Indigenous species such as Bladey Grass and Bracken within the Disturbed Vegetation area shall be removed and can be replanted as part of the Narrabeen Creek Riparian Rehabilitation program.
- 1.10 All weed vegetation debris shall be removed from within the proposed Bushfire Asset Protection Zones.
- 1.11 A 40mm layer of debris/ mulch from indigenous vegetation can be retained to minimise the potential for soil erosion.
- 1.12 Excess indigenous vegetation debris and mulch is to be removed and can be used as brushmatting or mulch within the Narrabeen Creek Riparian Rehabilitation areas.
- 1.13 Weed control is to be carried out across the proposed Bushfire Asset Protection Zone within the Open Forest Bushland areas to remove all noxious & environmental weeds using standard bush regeneration weed control techniques (refer specifications).
- 1.14 The performance measures for each management unit is to be achieved.

APZ stage 2 plan implementation - vegetation maintenance

(refer specifications sheet 9)

- 2.1 Weed control is to be carried out across the proposed Bushfire Asset Protection Zone within the Open Forest Bushland areas to remove all noxious & environmental weeds using standard bush regeneration weed control techniques after stage 1 works at minimum 2 monthly intervals during 0-6 months, at 3 monthly intervals during 6-12 months and at 6 monthly intervals during the 12-24 months and as necessary after 24 months period (refer specifications).
- 2.2 The performance measures for each management unit is to be achieved.

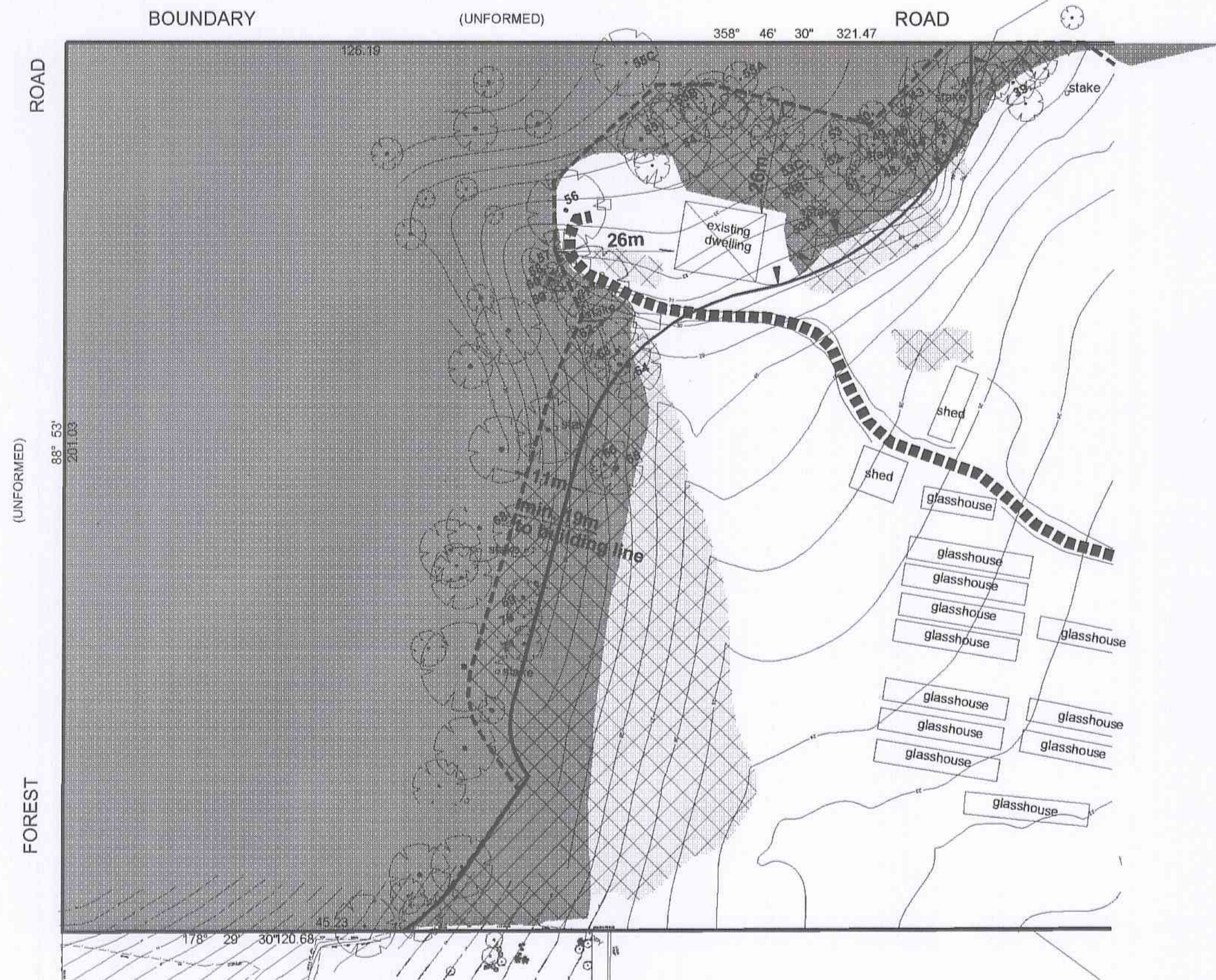

proposed management units



open forest bushland

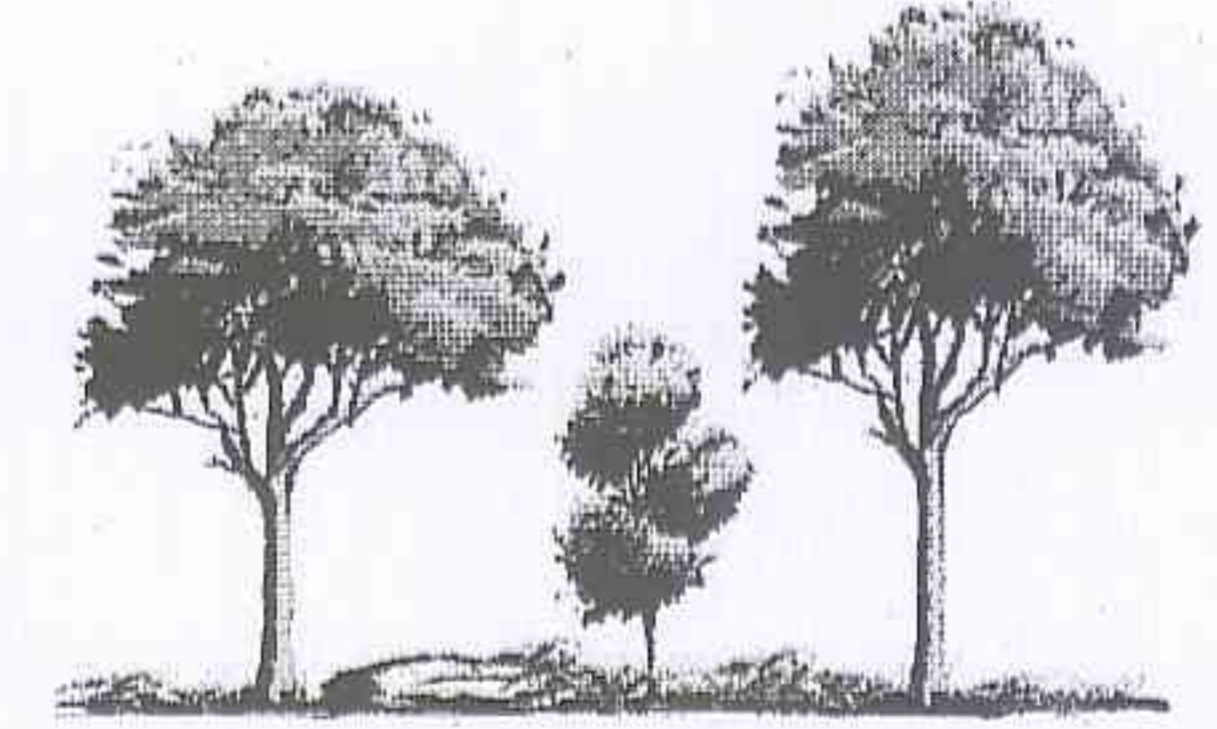
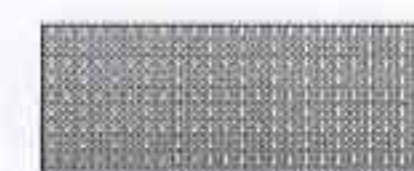

bushland asset protection zone



other cleared areas



site management performance criteria

- no physical disturbance to soil profiles, existing indigenous vegetation and habitats.
- conditions retained that encourage the natural regeneration of indigenous flora species.
- the area is to be maintained periodically so as to achieve less than 5% exotic flora & weed biomass at all times.
- there must be no evidence of active erosion & sediment deposition at all times.

site management performance criteria

- no physical disturbance to soil profiles and habitats.
- the vegetation structure is to be retained as modified open forest and trees identified on this plan are to be retained (refer sheet 4 for details on species and condition).
- with exception of Grass Trees (Xanthorrhoea spp.) all understorey / shrub vegetation is to be removed.
- indigenous ground covers are to be retained.
- conditions retained that encourage the natural regeneration of indigenous flora species.
- the area is to be maintained periodically so as to achieve less than 5% exotic flora & weed biomass at all times.
- there must be no evidence of active erosion & sediment deposition at all times.

site management performance criteria

- no physical disturbance to soil profiles and habitats.
- the area is to be maintained periodically so as to achieve less than 5% noxious & environmental weed biomass at all time
- the vegetation structure is to be retained as low grassland.
- there must be no evidence of active erosion & sediment deposition at all times.

legend

- proposed boundary
- existing vehicle access track
- limit of bushfire asset protection zones
- ⊙ existing trees to be removed (note for details on trees with reference numbers, refer sheet 4)
- ⊙ existing trees to be retained (note for details on trees with reference numbers, refer sheet 4)



prepared by
mark couston

scale at A2
1: 1000

date
12/06/09

dwg no.
vmpfb1.01

rev.
0.1

sheet of
8 9

project
vegetation management plan - proposed rezoning & subdivision 8 forest rd, warriewood

drawing title
establishment of bushfire asset protection zones