



- NOTES:**
1. ALL EROSION AND SEDIMENT CONTROL MEASURES TO BE INSPECTED AND MAINTAINED DAILY BY SITE MANAGER IN ACCORDANCE WITH COUNCIL REQUIREMENTS.
 2. ALL STOCKPILES TO BE CLEAR FROM DRAINS, GUTTERS AND FOOTPATHS.
 3. DRAINAGE IS TO BE CONNECTED TO STORMWATER SYSTEM AS SOON AS POSSIBLE.
 4. ROADS AND FOOTPATH TO BE SWEEPED DAILY AS REQUIRED BY COUNCIL.
 5. IF YOU DO NOT COMPLY WITH COUNCIL REQUIREMENTS & DOCUMENTATION, YOU MAY BE LIABLE TO PROSECUTION FROM GOVERNMENT AUTHORITIES.

LEGEND:

- UNDISTURBED VEGETATION
- SEDIMENT FENCE
- STOCK PILES
- STABILIZED SITE ACCESS
- MESH & GRAVEL INLET FILTER
- WATER DIVERSION
- STORMWATER PIT WITH SEDIMENT BARRIER

- DUST CONTROL:**
- NOTE: DURING EXCAVATION, DEMOLITION AND CONSTRUCTION, ADEQUATE MEASURES SHALL BE TAKEN TO PREVENT DUST FROM AFFECTING THE AMENITY OF THE NEIGHBORHOOD.
- THE FOLLOWING MEASURES MUST BE ADOPTED:
1. PHYSICAL BARRIERS SHALL BE ERECTED AT RIGHT ANGLES TO PREVENT WIND DIRECTION OR SHALL BE PLACED AROUND OR OVER DUST SOURCES TO PREVENT WIND OR ACTIVITY FROM GENERATING DUST.
 2. EARTHWORKS AND SCHEDULING ACTIVITIES SHALL BE MANAGED TO COINCIDE WITH THE NEXT STAGE OF DEVELOPMENT TO MINIMISE THE AMOUNT OF TIME THE SITE IS LEFT TO CUT OR EXPOSED.
 3. ALL MATERIALS SHALL BE STORED OR STOCKPILED AT THE BEST LOCATIONS.
 4. THE GROUND SURFACE SHOULD BE DAMPENED SLIGHTLY TO PREVENT DUST FROM BECOMING AIRBORNE BUT SHOULD NOT BE WET TO THE EXTENT THAT RUN-OFF OCCURS.
 5. ALL VEHICLES CARRYING SOIL OR RUBBLE TO OR FROM THE SITE SHALL AT ALL TIMES BE COVERED TO PREVENT THE ESCAPE OF DUST.
 6. ALL EQUIPMENT WHEELS SHALL BE WASHED BEFORE EXISTING THE SITE USING MANUAL OR AUTOMATED SPRAYERS AND DRIVE - THROUGH WASHING BAYS.
 7. GATES SHALL BE CLOSED BETWEEN VEHICLE MOVEMENTS SHALL BE FITTED WITH SHADE CLOTH.
 8. CLEANING OF FOOTPATHS AND ROADWAYS SHALL CARRIED OUT DAILY.
 9. ALL BUILDERS REFUSE, SPOIL AND/OR MATERIAL UNSUITABLE FOR USE IN LANDSCAPE AREAS SHALL BE REMOVED FROM SITE ON COMPLETION OF THE BUILDING WORKS.

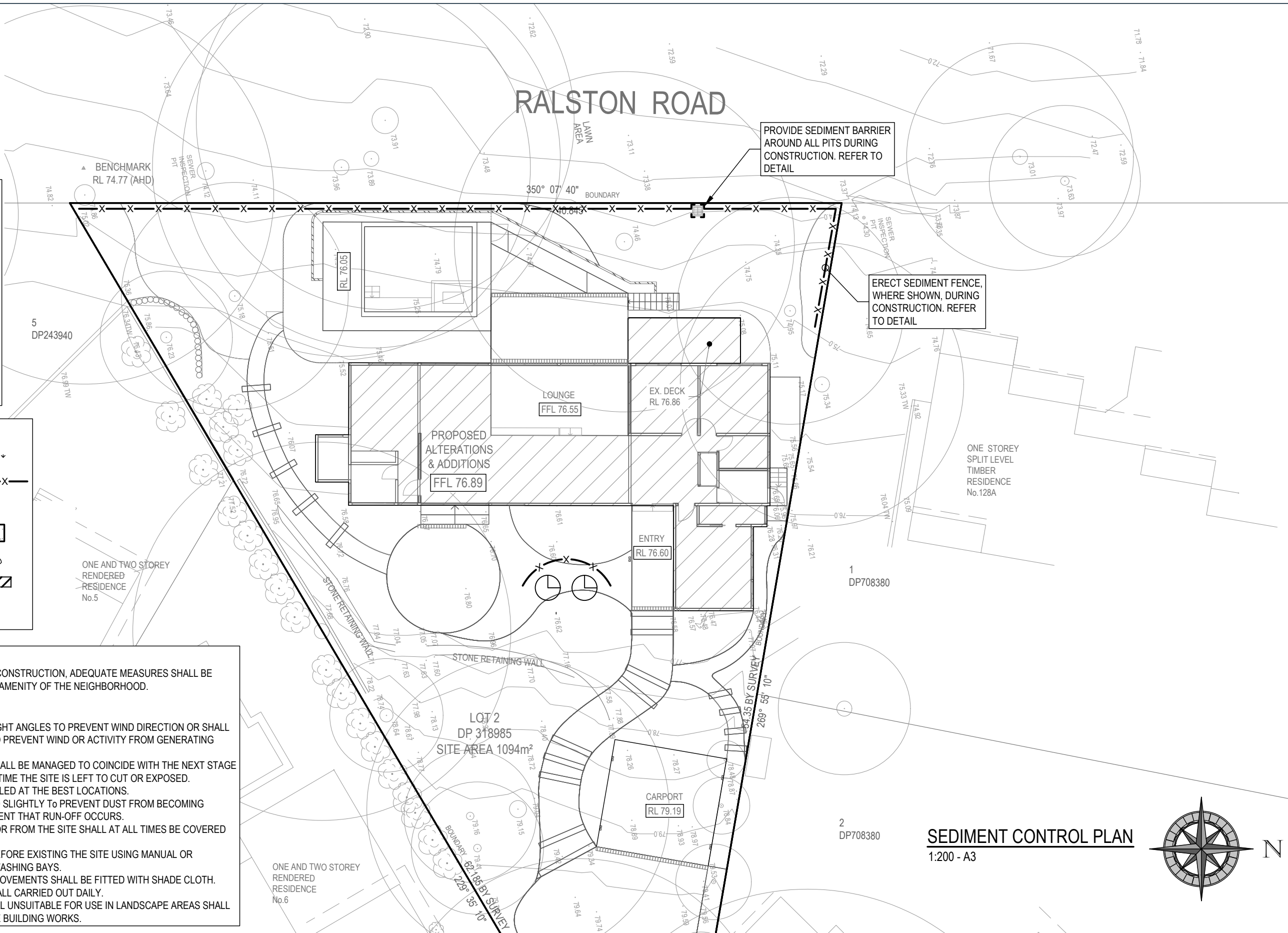

SEDIMENT CONTROL PLAN
1:200 - A3

QUANTUM ENGINEERS
Suite 1A, Level 2, 2 Rowe Street, EASTWOOD NSW 2122
02 9807 7800
admin@quantumengineers.com.au
quantumengineers.com.au

APPROVED BY
ROBERT ELTOBAGI
BE(CIVIL) MIEAust CPEng
NER (1052208) RPEQ (25464)
APEC Engineer IntPE(Aus)

CLIENT
SIMONE ZIMMERMANN

ARCHITECT
MIKE HANNA
CURVE 9

DRAWING TITLE
SEDIMENT CONTROL PLAN

PROPOSED ALTERATIONS & ADDITIONS
Lot 2, 126B PACIFIC ROAD,
PALM BEACH

REVISION	DRAWN	DESCRIPTION	DATE
A	DB	PRELIMINARY ISSUE FOR REVIEW	19.04.2024
B	DB	ISSUED FOR DA	09.05.2024

DESIGNED BY	No. IN SET
DB	7
SCALE - SIZE	REVISION
1:200 - A3	B
JOB NUMBER	DRAWING No.
230432_SW	D6

