

| | |
|----------|----------|
| SCALE | 1:100@A2 |
| DATE | 01/06/21 |
| JOB NO. | SRSP |
| DWG. NO. | DA1002 |
| ISSUE | A |

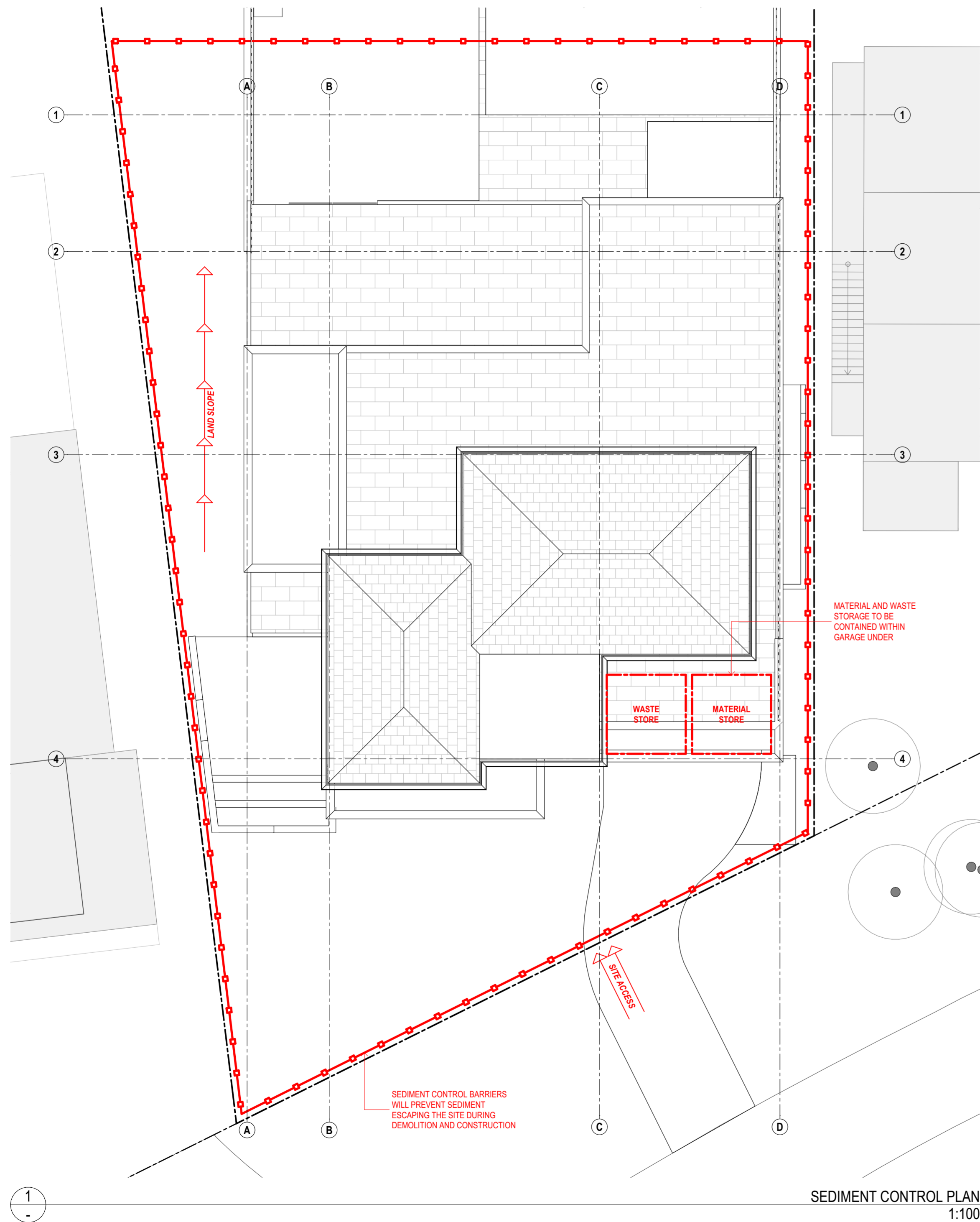

SEDIMENT CONTROL PLAN
 1:100

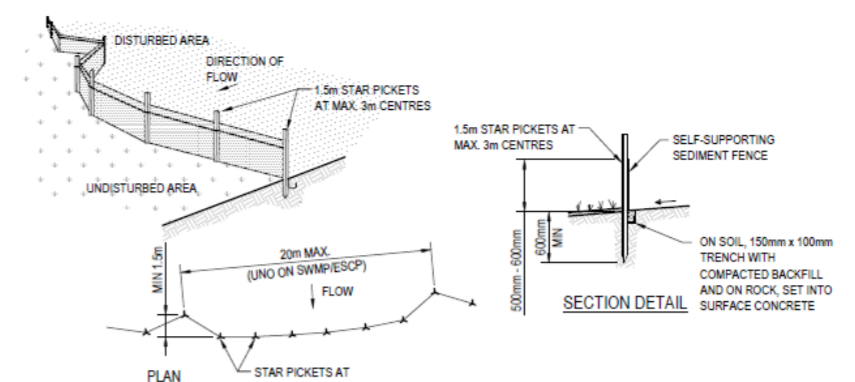

- CONSTRUCTION NOTES**
1. CONSTRUCT SEDIMENT FENCE AS CLOSE AS POSSIBLE TO PARALLEL TO THE CONTOURS OF THE SITE.
 2. DRIVE 1.5m LONG STAR PICKETS INTO GROUND, 3 METRES APART.
 3. DIG A 150mm DEEP TRENCH ALONG THE UPSLOPE LINE OF THE FENCE FOR THE BOTTOM OF THE FABRIC TO BE ENTRENCHED.
 4. BACKFILL TRENCH OVER BASE OF FABRIC.
 5. FIX SELF-SUPPORTING SEDIMENT FENCE TO UPSLOPE SIDE OF POSTS WITH WIRE TIES OR AS RECOMMENDED BY SEDIMENT FENCE MANUFACTURER.
 6. JOIN SECTIONS OF FABRIC AT A SUPPORT POST WITH A 150mm OVERLAP.

SEDIMENT CONTROL FENCE

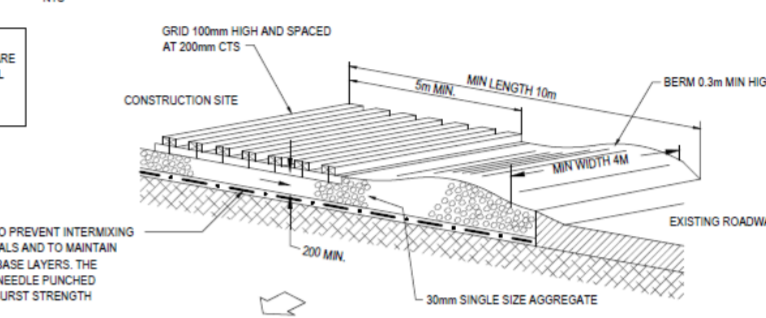

NOTE: ENSURE THAT ALL UTILITY ASSETS ARE MAINTAINED AND PROTECTED AT ALL TIMES IN THE VICINITY OF THE TEMPORARY CONSTRUCTION EXIT

GEOTEXTILE FABRIC DESIGNED TO PREVENT INTERMIXING OF SUBGRADE AND BASE MATERIALS AND TO MAINTAIN GOOD PROPERTIES OF THE SUB-BASE LAYERS. THE GEOTEXTILE MAY BE WOVEN OR NEEDLE PUNCHED PRODUCT WITH A MINIMUM CBR BURST STRENGTH (AS3706-4-90) OF 2500N.

- CONSTRUCTION NOTES**
1. STRIP TOPSOIL AND LEVEL SITE.
 2. COMPACT SUBGRADE.
 3. COVER AREA WITH NEEDLE-PUNCHED GEOTEXTILE.
 4. CONSTRUCT 200mm THICK PAD OVER GEOTEXTILE USING 30mm SINGLE SIZE AGGREGATE.
 5. CONSTRUCT HUMP IMMEDIATELY WITHIN BOUNDARY TO DIVERT WATER TO A SEDIMENT FENCE OR OTHER SEDIMENT TRAP WHERE THE SEDIMENT IS COLLECTED AND REMOVED.

MAINTENANCE NOTES
 THE EXIT SHALL BE MAINTAINED IN A CONDITION WHICH PREVENTS TRACKING OR FLOWING OF SEDIMENT OFF THE CONSTRUCTION SITE. THIS MAY REQUIRE PERIODIC TOP DRESSING WITH ADDITIONAL GRAVEL AS CONDITIONS DEMAND AND REPAIR AND/OR CLEANOUT OF ANY MEASURES USED TO TRAP SEDIMENT. ALL SEDIMENT SPILLED, DROPPED, WASHED OR TRACKED OFF THE CONSTRUCTION SITE MUST BE REMOVED IMMEDIATELY.

TEMPORARY STABILISED CONSTRUCTION EXIT

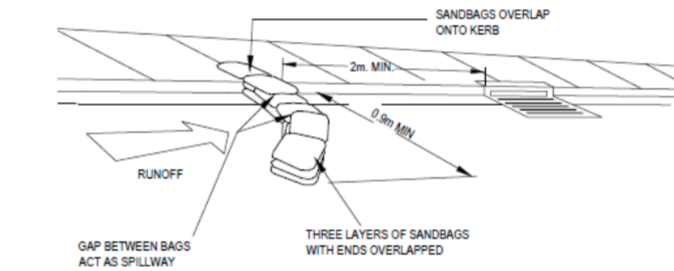

SANDBAG SEDIMENT TRAP

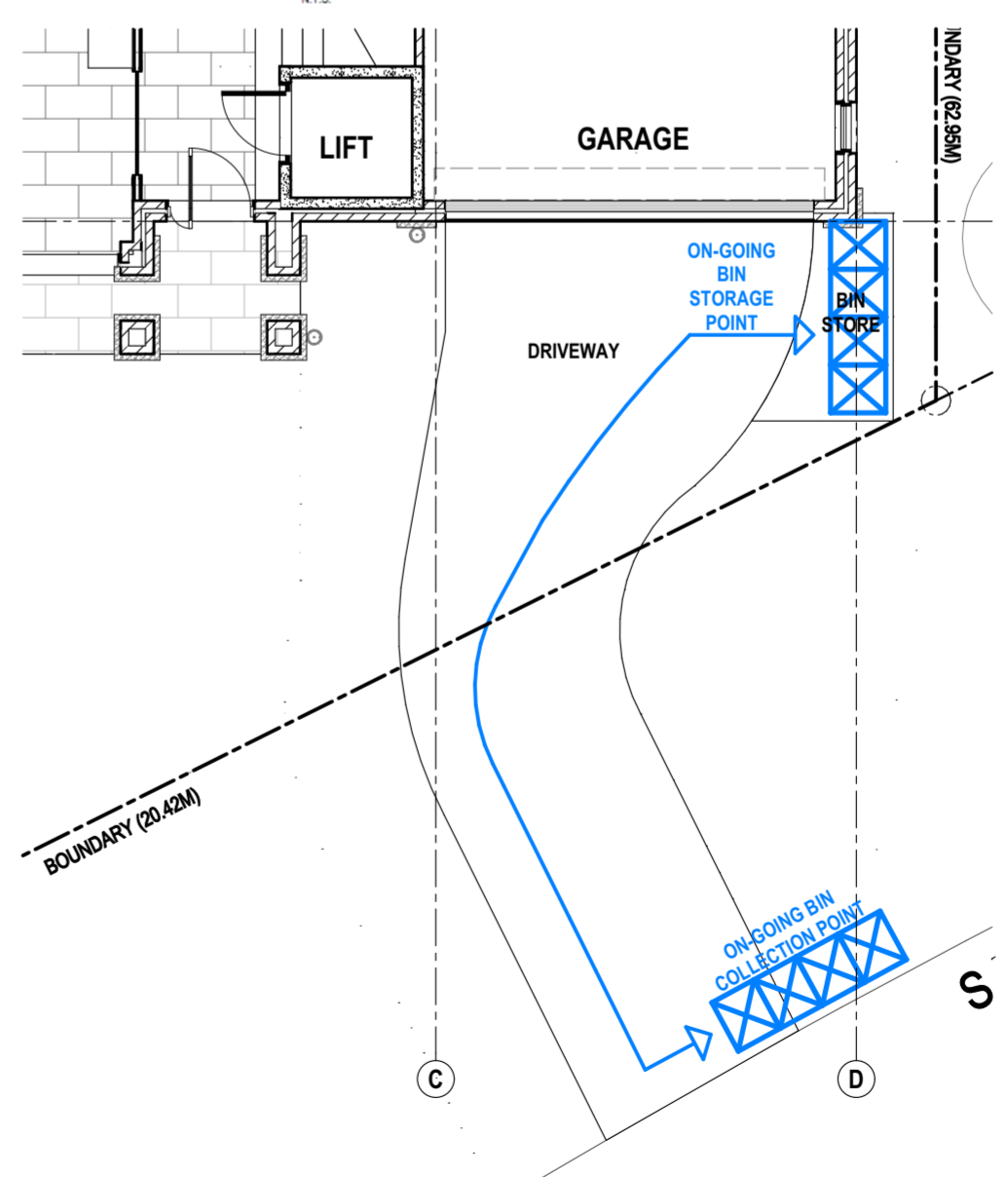

WASTE MANAGEMENT PLAN
 1:100

1

2