

**LEGEND**

- EXISTING WALLS / CORE TO BE RETAINED
- EXISTING GLAZED PARTITIONS TO BE RETAINED
- EXISTING TO BE DEMOLISHED AND MADE GOOD
- INDICATES PROPOSED MODIFICATION

FLOOR AREA (for Artisan food & beverage)

GROUND FLOOR INTERIOR - 235m<sup>2</sup>  
GROUND FLOOR EXTERIOR - 61m<sup>2</sup>  
MEZZANINE - 32m<sup>2</sup>

TOTAL FLOOR AREA - 1004m<sup>2</sup>

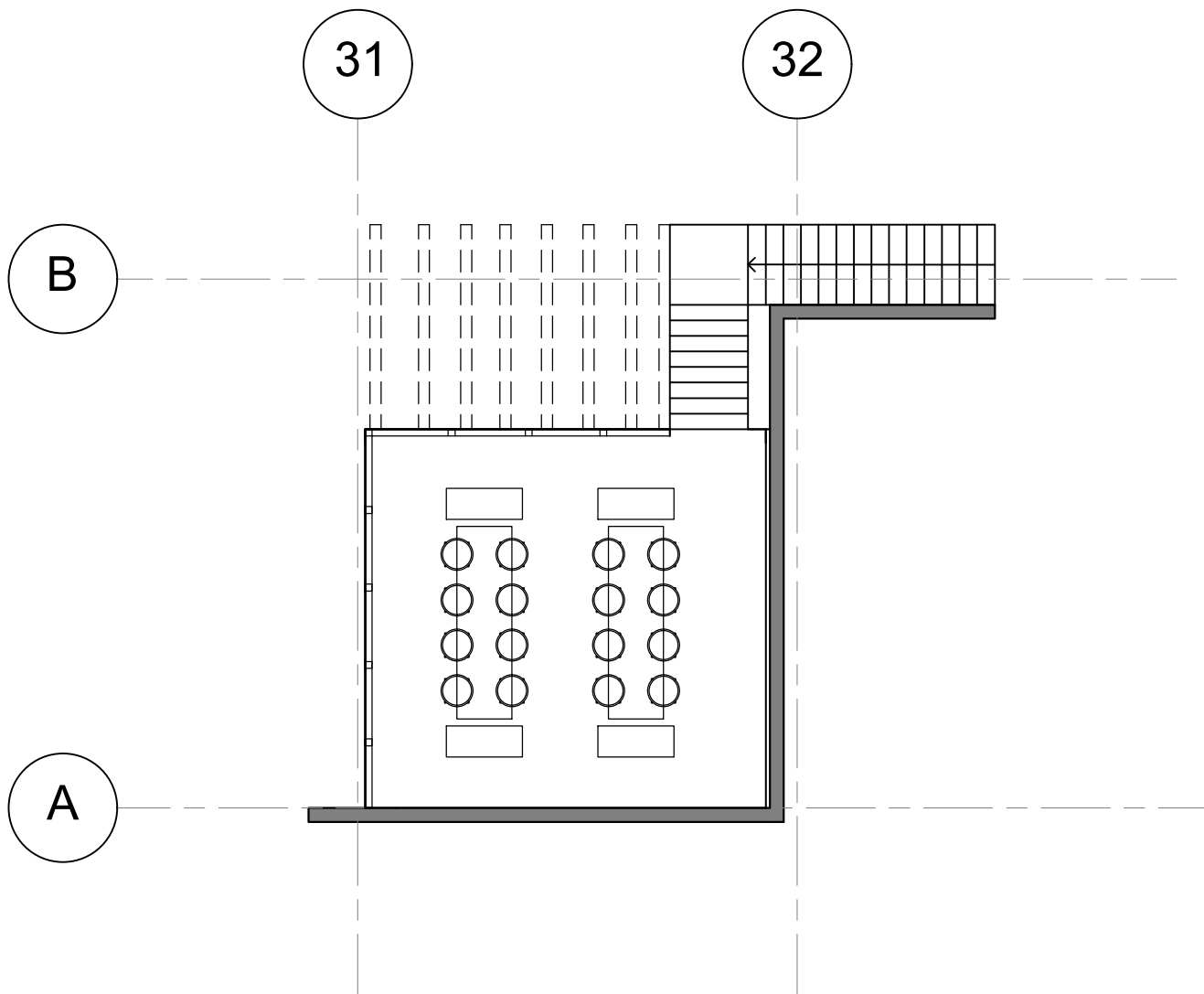

GROUND FLOOR LEVEL

INTERIOR SEATING - 99  
EXTERIOR SEATING - 56

MEZZANINE LEVEL

INTERIOR SEATING - 24

FOR COMPLIANT DEVELOPMENT CERTIFICATE

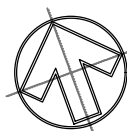

REV A - 28.09.22 - ISSUE FOR REVIEW	
REV B - 30.09.22 - KITCHEN EQUIPMENT ADDED	
REV C - 29.05.24 - FOR CDC APPLICATION	

CLIENT	4PINES BREWING
ADDRESS	4F/9-13 WINDBOURNE ROAD, BROOKVALE NSW 2100

DRAWING TITLE	PROPOSED GROUND FLOOR PLAN
REFERENCE	605 - 4PINES TRUCKBAR
SCALE	1:100@A1
DRAWN	JT
ISSUE	