

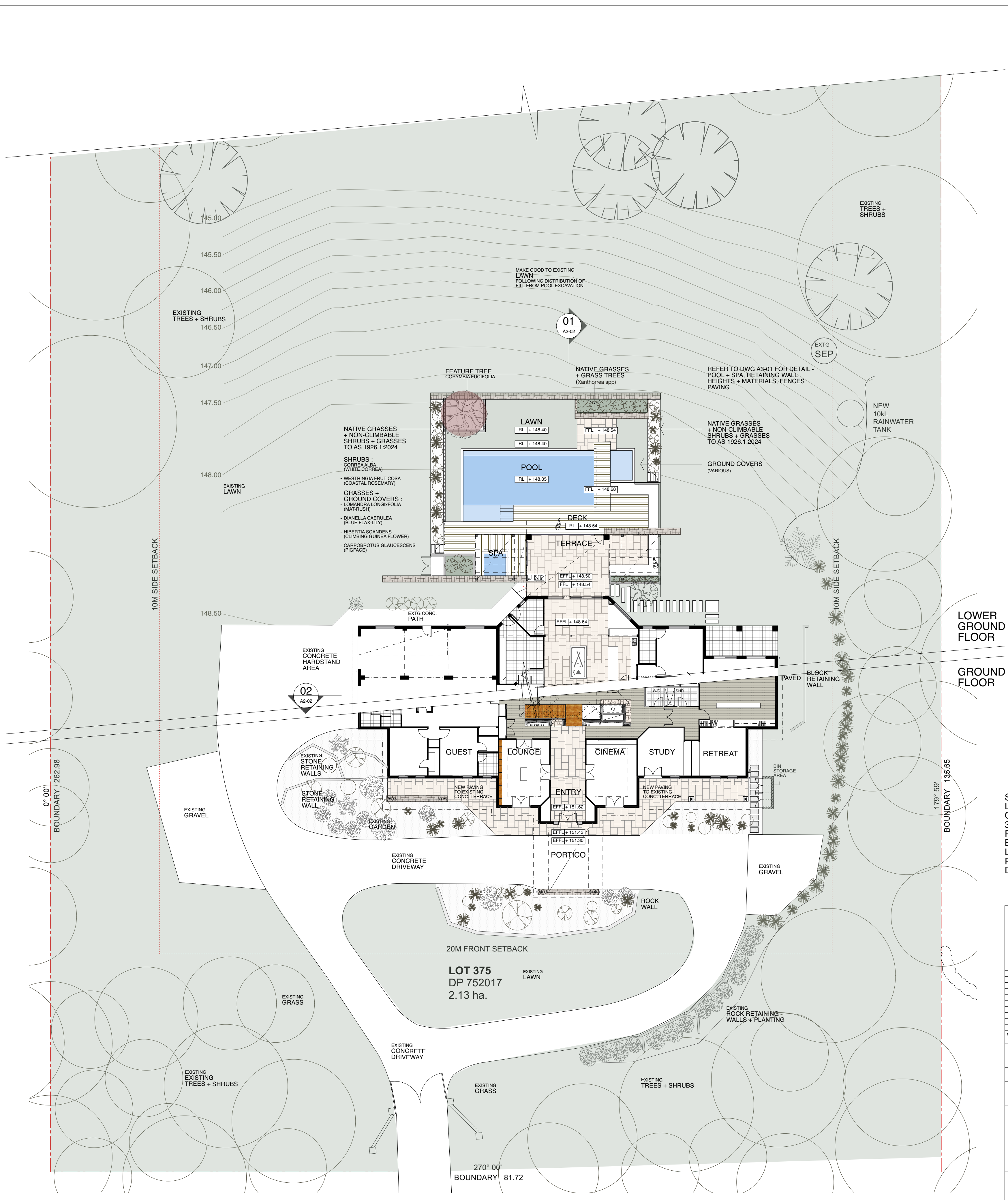

01 SITE ANALYSIS PLAN
SCALE 1:500 REF



02 LANDSCAPE CONCEPT PLAN
SCALE 1:200 REF

SITE AREA : 2.13 Ha
LANDSCAPE + SITE COVER CONTROLS:
30% SITE: 6390 m2
PROPOSED GFA : 1023m2
BUILDING AREA: 587m2
LANDSCAPE AREA: >1.9 Ha (89%)
PRIVATE OPEN SPACE: >375m2
DEEP SOIL ZONE: >1.9 Ha

LEGEND:
 AFW: ALUM. FRAMED WINDOW
 DP: DOWNSPIPE
 EFL: EXISTING FINISHED FLOOR LEVEL
 FC: FIBRE CEMENT
 HWU: HOT WATER UNIT
 MR: METAL ROOFING
 RW: RANDOM STONE WALL
 SEP: SEPTIC TANK
 SK: SKYLIGHT
 TB: TIMBER BATTENED SCREEN

NOTE:
 ALL NEW CONSTRUCTION TO COMPLY WITH AS 3699:2018 BAL 25, AND PLANNING FOR BUSHFIRE PROTECTION

Rev	Status	Date
1	FOR DA	08.11.24

Scale of:	Date
1:500	NOVEMBER 2024

PROJECT:
 6 JOALAH ROAD, DUFFYS FOREST NSW 2084
 LOT 375 DP 752017
CLIENT:
 G. CRANNAGE



Myson + Berkery Architects
 1/157 Prince Edward Ave
 Cuthberts Beach NSW 2540
 T: (02) 4448 3710
 F: (02) 4448 3745
 E: info@mysonberkery.com.au

This drawing is copyright and may not be used without written consent. Do not scale off this drawing. Use figured dimensions only. Verify all dimensions on site.