

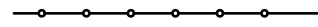



LEGEND

-  SW STORMWATER
-  TEMPORARY SEDIMENT FENCE
-  SWP STORMWATER GRATED PIT
-  GTD GRATED TRENCH DRAIN
-  PD PLANTER DRAIN

- e EXISTING
- GTD GRATED TRENCH DRAIN
- IL INVERT LEVEL
- KIP KERB INLET PIT
- RL REDUCED LEVEL

DRAWING SCHEDULE

- HDA01 SITE PLAN & LEGEND
- HDA02 POOL PAVILION FLOOR PLAN
- HDA03 ROOF PLAN
- HDA04 SEDIMENT & EROSION CONTROL PLAN
- HDA05 DETAIL SHEET

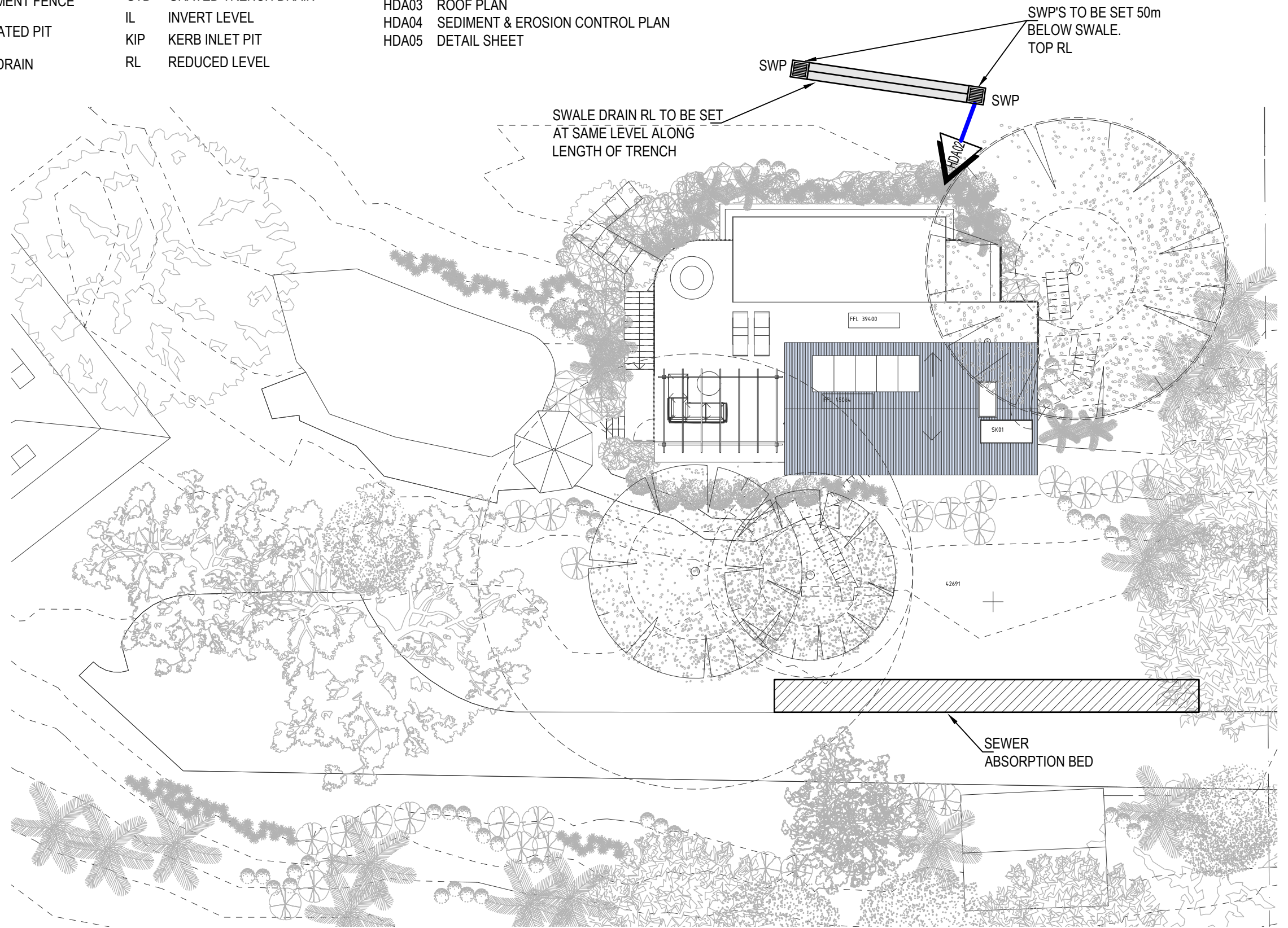

Architect		
SUZANNE GREEN INTERIOR ARCHITECTURE AND DESIGN		
Studio, 70 Queen Street Woollahra NSW 2025 +61 414 470 532 suzanne@suzannegreen.com.au		
P1	06.12.21	DEVELOPMENT APPLICATION
No	Date	Details
Amendments		

Hydraulic Consultant

INLINE
HYDRAULIC SERVICES

UNIT 19, 18 WURROOK CIRCUIT, CARINGBAH NSW 2229
PO BOX 284, GYMEA NSW 2227
PHONE No (02) 9526 1923
EMAIL : paul@inlinehs.com.au
www.inlinehydralicsservices.com.au

Project

**90 CABBAGE TREE ROAD
BAYVIEW**

for
Alex Jenkins & Paul O'Farrell



Drawing

**HYDRAULIC SERVICES
SITE PLAN & LEGEND**

Scale	1:200	Drawn	POK/PM
Date	17.11.21	Project No.	21260
Drawing No / Revision		HDA01 / P1	

Hydraulic Consultant

INLINE
HYDRAULIC SERVICES

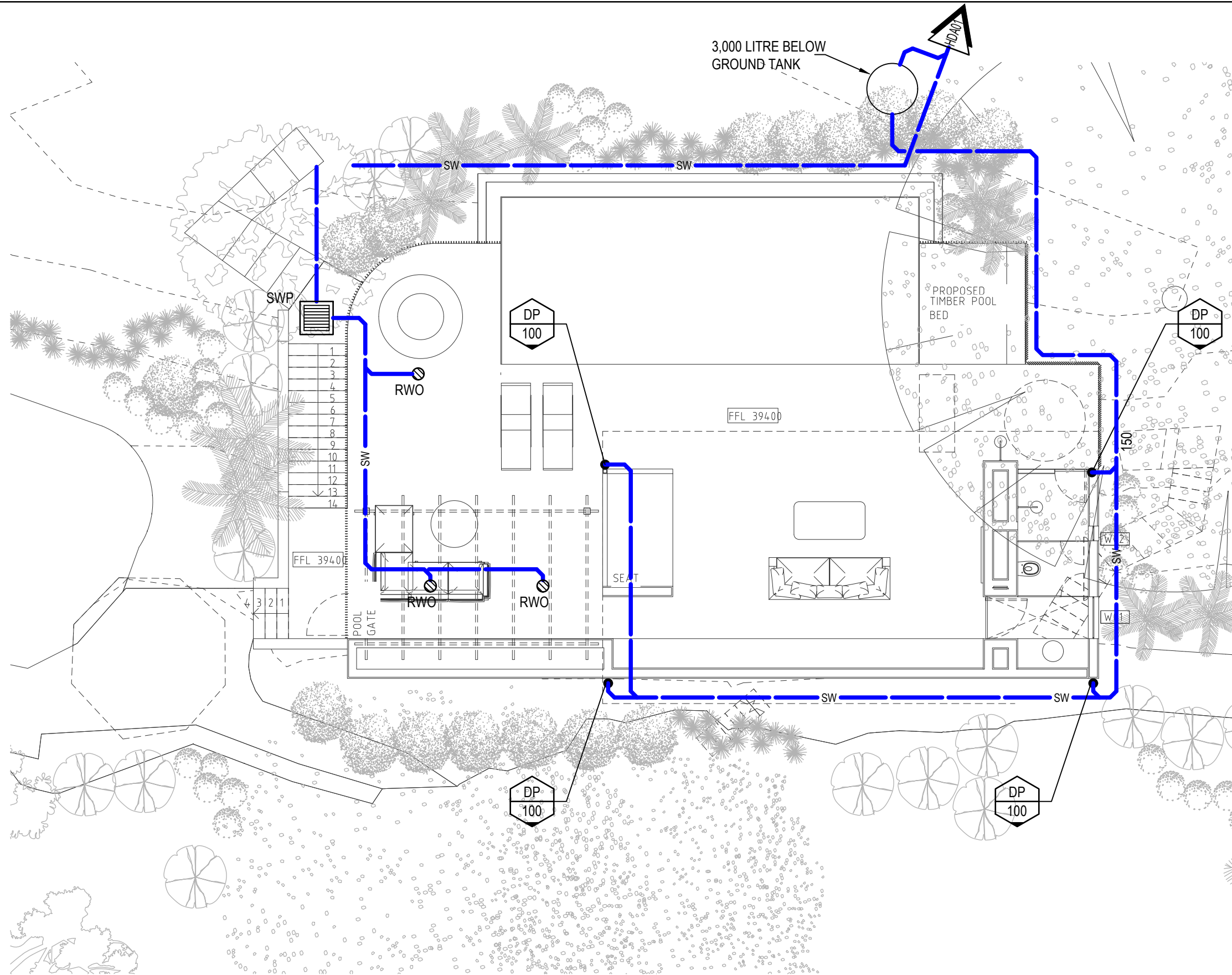

No	Date	Details
P1	06.12.21	DEVELOPMENT APPLICATION
Amendments		

Architect
**SUZANNE GREEN
 INTERIOR
 ARCHITECTURE
 AND DESIGN**
 Studio, 70 Queen Street Woollahra NSW 2025
 +61 414 470 532 suzanne@suzannegreen.com.au

Hydraulic Consultant
INLINE
 HYDRAULIC SERVICES
 UNIT 19, 18 WURROOK CIRCUIT, CARINGBAH NSW 2229
 PO BOX 284, GYMEA NSW 2227
 PHONE No (02) 9526 1923
 EMAIL : paul@inlinehs.com.au
 www.inlinehydralicsservices.com.au

Project
**90 CABBAGE TREE ROAD
 BAYVIEW**
 for
Alex Jenkins & Paul O'Farrell



Drawing **HYDRAULIC SERVICES
 POOL PAVILION FLOOR PLAN**

INLINE HYDRAULIC SERVICES	Scale	1:100	Drawn	POK/PM
	Date	17.11.21		
	Project No.	21260		
	Drawing No / Revision	HDA02	/P1	

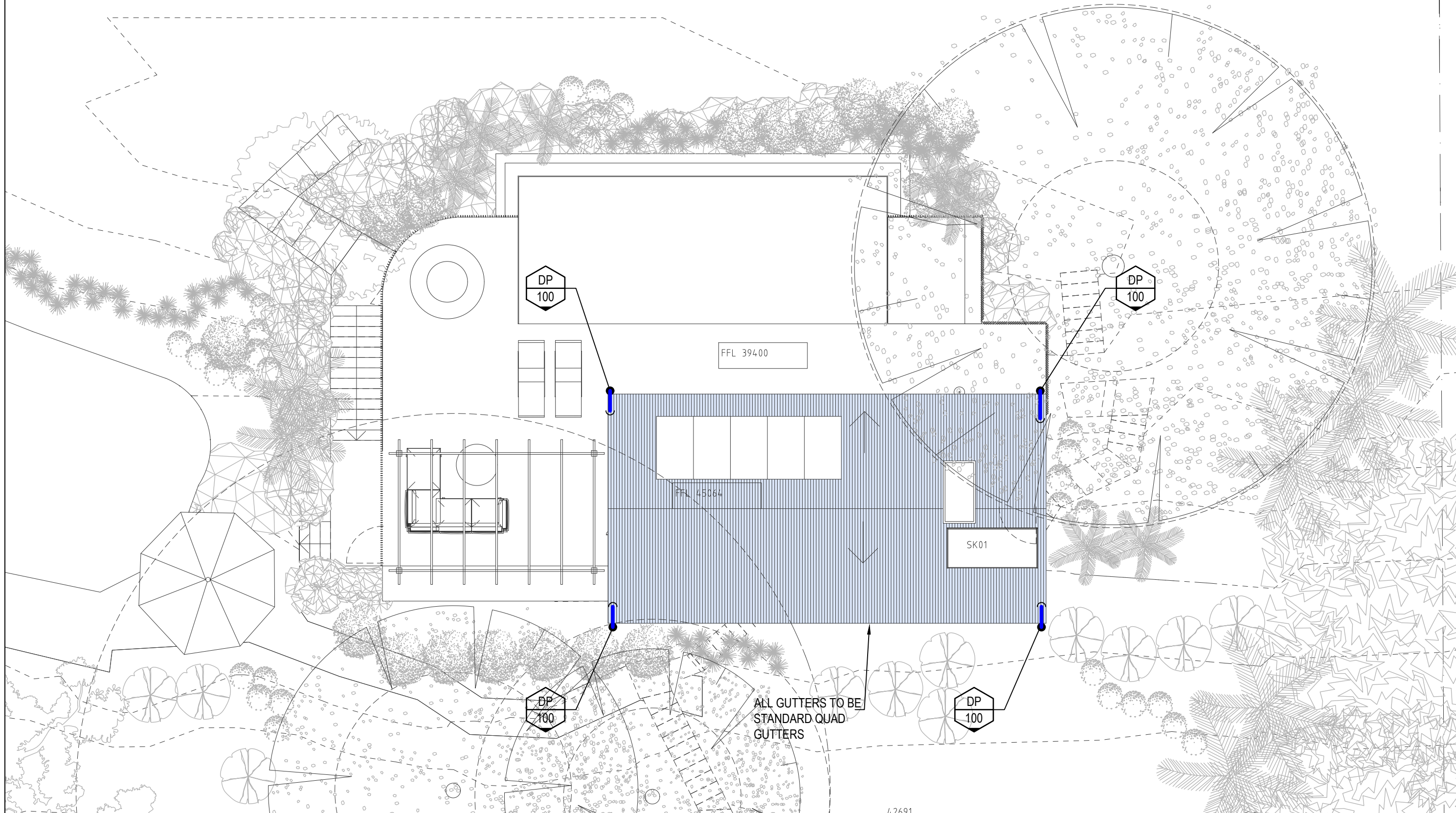

P1	06.12.21	DEVELOPMENT APPLICATION
No	Date	Details
Amendments		

Architect
**SUZANNE GREEN
 INTERIOR
 ARCHITECTURE
 AND DESIGN**
 Studio, 70 Queen Street Woollahra NSW 2025
 +61 414 470 532 suzanne@suzannegreen.com.au

Hydraulic Consultant
INLINE
 HYDRAULIC SERVICES
 UNIT 19, 18 WURROOK CIRCUIT, CARINGBAH NSW 2229
 PO BOX 284, GYMEA NSW 2227
 PHONE No (02) 9526 1923
 EMAIL : paul@inlinenhs.com.au
 www.inlinehydralicsservices.com.au

Project
**90 CABBAGE TREE ROAD
 BAYVIEW**
 for
Alex Jenkins & Paul O'Farrell

Drawing **HYDRAULIC SERVICES**
ROOF PLAN

Scale	1:100	Drawn	POK/PM
Date	17.11.21		
Project No.	21260		
Drawing No / Revision	HDA03	/P1	

SOIL & WATER MANAGEMENT NOTES

1. REFER TO DETAIL FOR CONSTRUCTION OF TEMPORARY SEDIMENT FENCE.
2. ALL PITS & PIPEWORK ASSOCIATED WITH PROPOSED DRAINAGE SYSTEMS SHALL BE KEPT FREE OF SOIL, WATER & DEBRIS FOR THE DURATION OF THE CONSTRUCTION WORKS.
3. ALL LOOSE IMPORTED FILL & EXCAVATED MATERIAL SHALL BE STOCKPILED AS FAR AS POSSIBLE FROM SEDIMENT FENCES PRIOR TO FINAL PLACEMENT, COMPACTION OR REMOVAL FROM SITE.
4. EXCESSIVE SEDIMENT BUILDUP SHALL BE AVOIDED BY REGULAR MAINTENANCE OF SEDIMENT FENCES.
5. WHERE APPLICABLE, APPROVED LANDSCAPING & REVEGETATION OF DISTURBED AREAS SHALL COMMENCE AT THE EARLIEST OPPORTUNITY AFTER COMPLETION OF EARTHWORKS OPERATIONS.

CONSTRUCTION OF SEDIMENT FENCE & ANY OTHER SEDIMENT CONTROL MEASURES SHALL BE IN ACCORDANCE WITH MANAGING URBAN STORMWATER: SOILS & CONSTRUCTION COMMONLY KNOWN AS THE 'BLUE BOOK'.

INTERNET REFERENCE:

<http://www.landcom.com.au/publications.aspx>

DESIGN PARAMETERS FOR SEDIMENT FENCE

MAX DRAINAGE AREA	=	0.6000ha
MAX SLOPE GRADIENT	=	50%
MAX SLOPE LENGTH	=	60m

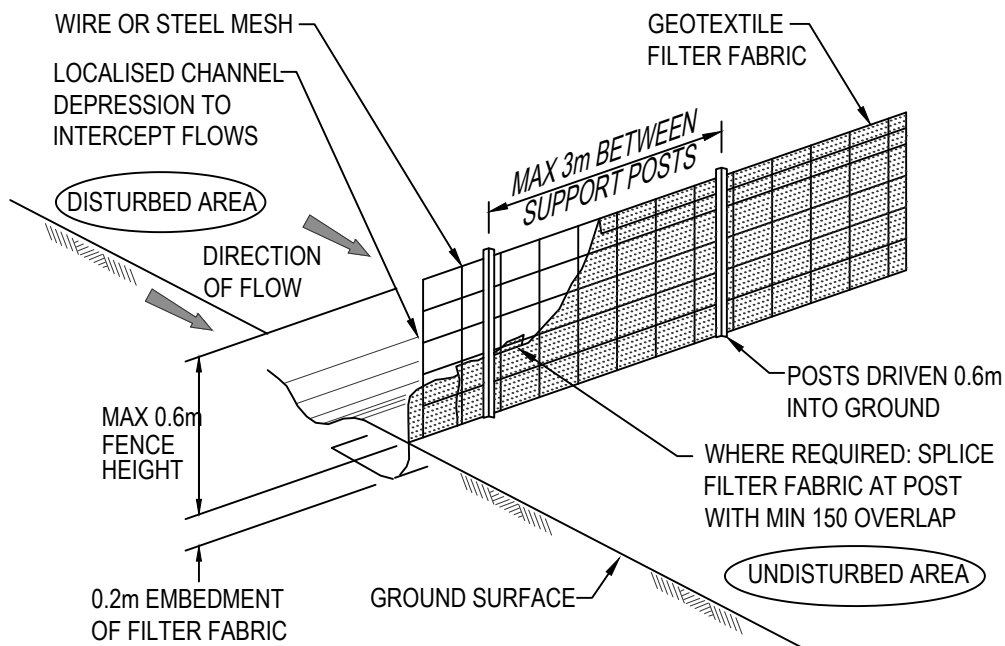

D1 TEMPORARY SEDIMENT FENCE
NOT TO SCALE

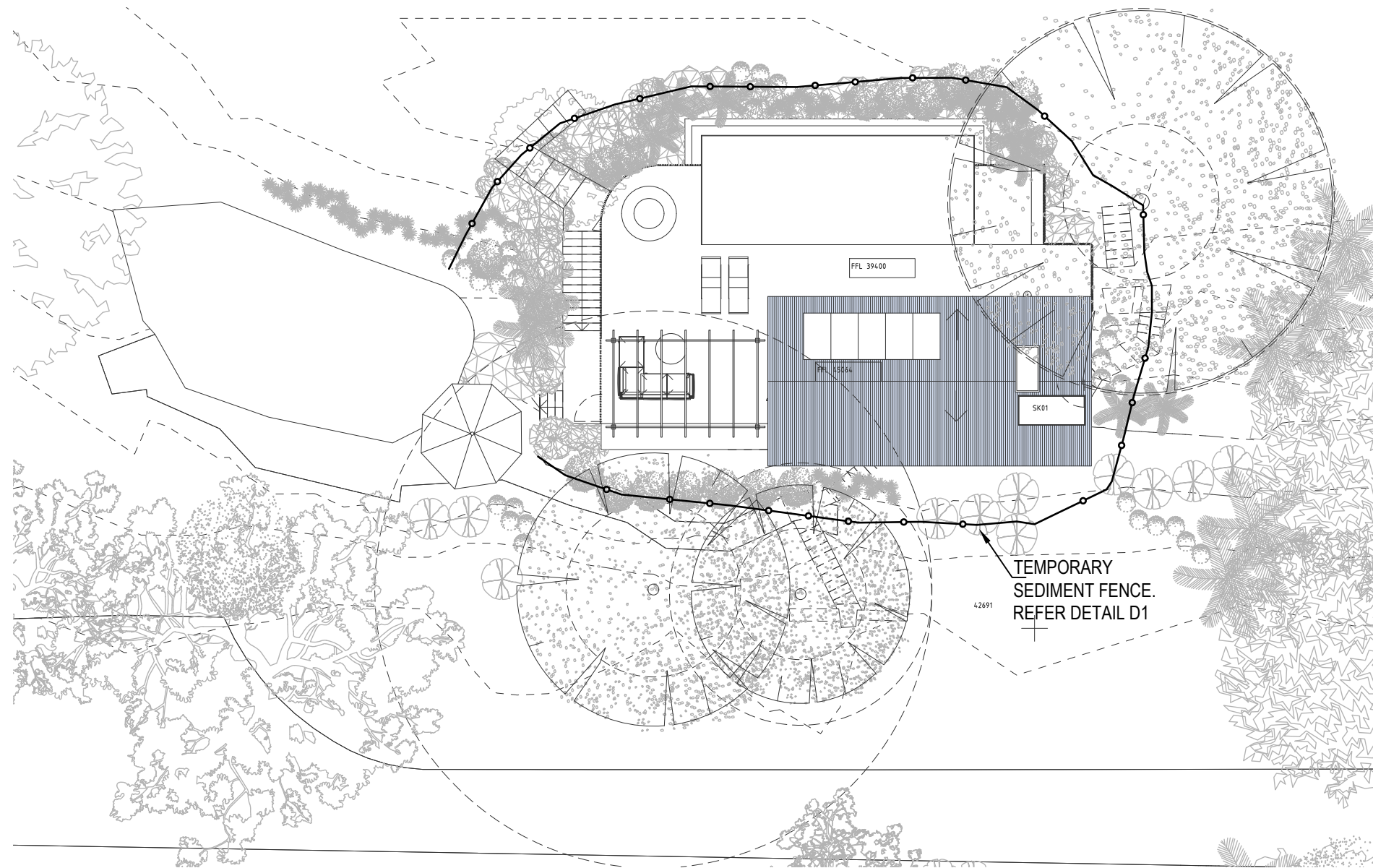
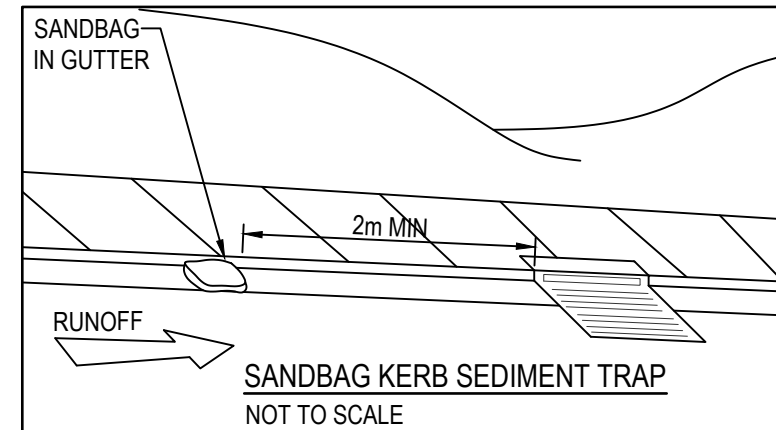
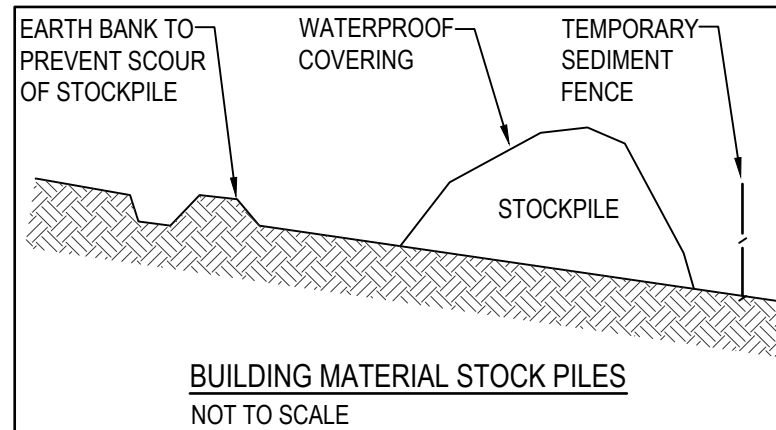

P1	06.12.21	DEVELOPMENT APPLICATION
No	Date	Details
Amendments		

Architect
**SUZANNE GREEN
INTERIOR
ARCHITECTURE
AND DESIGN**
Studio, 70 Queen Street Woollahra NSW 2025
+61 414 470 532 suzanne@suzannegreen.com.au

Hydraulic Consultant
INLINE
HYDRAULIC SERVICES
UNIT 19, 18 WURROOK CIRCUIT, CARINGBAH NSW 2229
PO BOX 284, GYMEA NSW 2227
PHONE No (02) 9526 1923
EMAIL : paul@inlinehs.com.au
www.inlinehydralicsservices.com.au

Project
**90 CABBAGE TREE ROAD
BAYVIEW**
for
Alex Jenkins & Paul O'Farrell

Drawing
**HYDRAULIC SERVICES
SEDIMENT & EROSION
CONTROL PLAN**

Scale	1:200	Drawn	POK/PM
Date	17.11.21	Project No.	21260
Drawing No / Revision		HDA04 / P1	

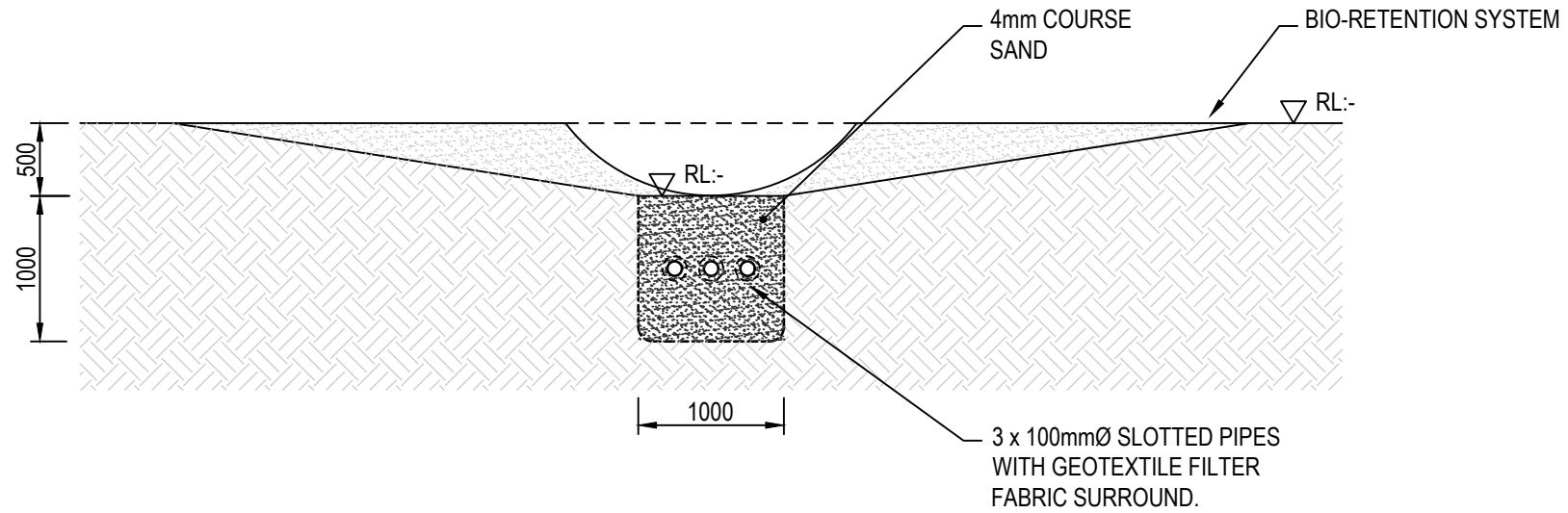

SECTION THROUGH SWALE

PROVIDE TEE FITTING ON PIPE END TO DISSIPATE ENERGY FROM HIGH VELOCITY FLOWS & ENSURE ADEQUATE CLEARANCES FOR MAINTENANCE CLEANING

ENSURE PIPE IS LAID WITH ADEQUATE SOIL COVER

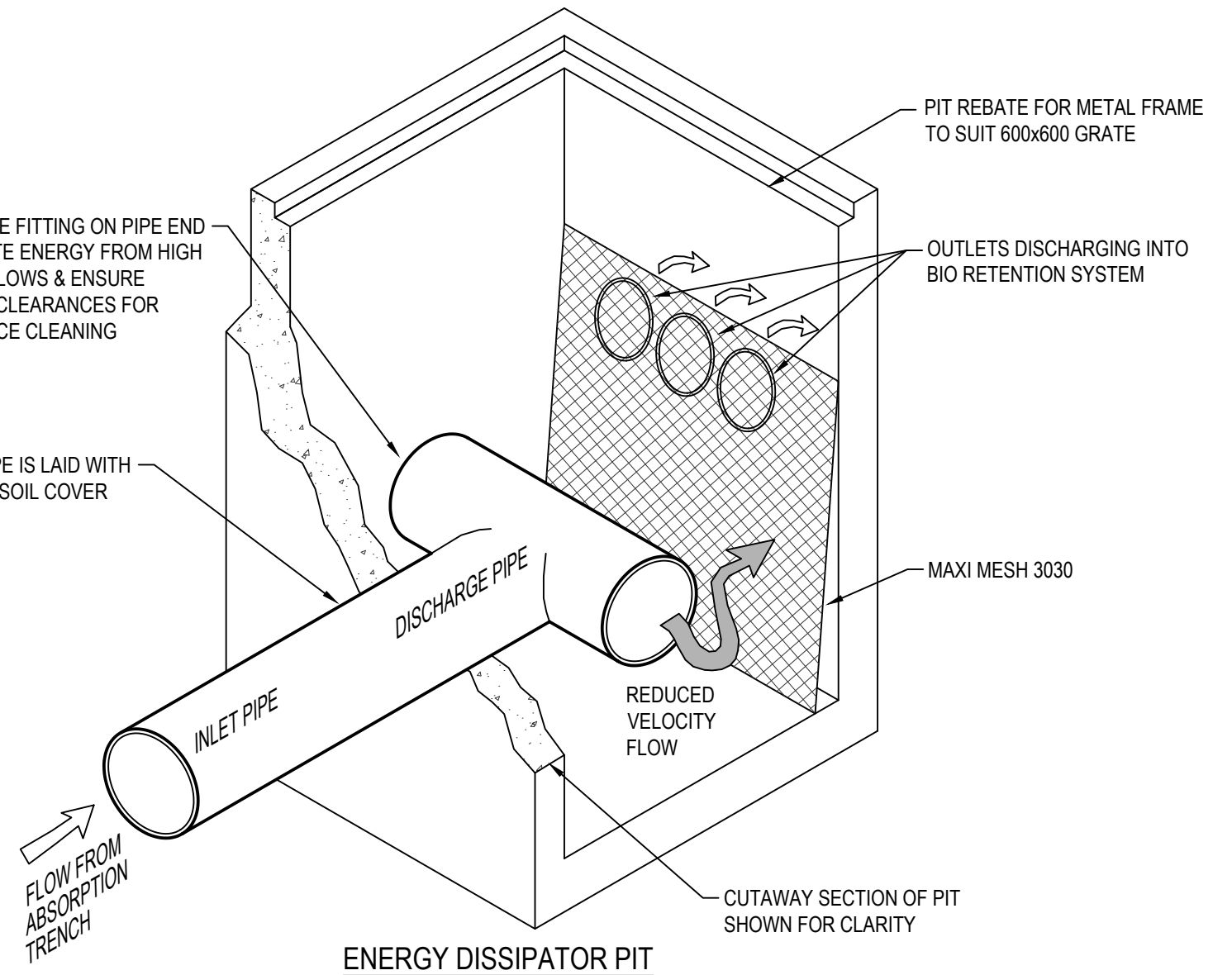

D2 BIO RETENTION SYSTEM
-- NOT TO SCALE

No	Date	Details
P1	06.12.21	DEVELOPMENT APPLICATION
Amendments		

Architect
SUZANNE GREEN INTERIOR ARCHITECTURE AND DESIGN
Studio, 70 Queen Street Woollahra NSW 2025
+61 414 470 532 suzanne@suzannegreen.com.au

Hydraulic Consultant
INLINE
HYDRAULIC SERVICES
UNIT 19, 18 WURROOK CIRCUIT, CARINGBAH NSW 2229
PO BOX 284, GYMEA NSW 2227
PHONE No (02) 9526 1923
EMAIL : pau@inlinehs.com.au
www.inlinehyddraulicservices.com.au

Project
90 CABBAGE TREE ROAD BAYVIEW
for
Alex Jenkins & Paul O'Farrell



Drawing HYDRAULIC SERVICES
DETAIL SHEET

INLINE HYDRAULIC SERVICES	Scale	NTS	Drawn	POK/PM
	Date	17.11.21		
	Project No.	21260		
	Drawing No / Revision	HDA05 / P1		