PENINSULA GARDENS RETIREMENT VILLAGE

LANDSCAPE PACKAGE

FEBRUARY 2018



Peninsula Gardens - Indicative Plant Schedule

Abbrev	Botanical Name	Common Name	Mature Height (m)	Pot Size	Qty/ Spacing
Trees					
CER for	Cercis 'Forest Pansy'	Eastern redbud	5	45L	5
WAT flo	Waterhouisia floribunda	Giant Water Gum	15-20	100L	12
EUC fic	Eucalyptus ficifolia 'Summer Beauty'	Dwarf flowering gum	5-6	55L	5
CER alb	Ceratopetalum 'Alberys red'	NSW Christmas bush	5	100L	4
HYM flav	Hymenosporum flavum	Native frangipanni	8	45L	5
ELA pri	Elaeocarpus 'Prima Donna'	Blueberry Ash	5		5
Shrubs					
PIE jap	Pieris japonica	Lily of the valley shrub	4	35L	-
PLE mon	Plectranthus 'Mona Lavender'	Mona Lavender	0.5	5L	-
CALL all	Callistemon 'All Aglow'	Bottle brush	2-2.5	25L	-
MEL sty	Melaleuca 'Claret tops'	Honey Myrtle	1-1.2	25L	-
HYD cvs	Hydrangea cvs	Hydrangeas	1.5-2	25L	-
GAR flo	Gardenia florida	Gardenia	2	45L	-
MEL lin	Melaleuca linifolia	Snow In Summer	8	25L	-
MIC fig	Michella figo	Port Wine Magnolia	3	35L	-
ELA eum	Elaeocarpus 'Eumundii'	Eumundii quandong	2	25L	-
ACM che	Acmena smithii 'Cherry pie'	Lilly Pilly	1.5	25L	-
VIB odo	Viburnum odoratissimum	Sweet Viburnum	2-4	25L	-
PRO rot	Prostanthera rotundifolia	Mint bush	1.5	25L	-
TEL spe	Telopea speciosa cvs	NSW Waratah	2-3	25L	-
Accent					
ACA mol	Acanthus mollis	Acanthus	0.75-1	140mm	6/m2
ALO mac	Alocasia macrorrhiza	Elephants Ears	1.5-2	25L	6/m2
ALP zer	Alpinia zerumbet 'Variegata'	Variegated Shell Ginger	1.5	25L	6/m2
ANI man	Anigozanthos flavidus cvs	Kangaroo Paw	0.5	25L	6/m2
DOR exc	Doryanthes excelsa	Gynea Lily	2-4	25L	6/m2
MAC com	Macrozamia communis	Burawang	2-3	25L	6/m2
PHI xan	Philodendron 'Xanadu'	Xanadu Philodendron	0.3	25L	6/m2
XAN spp.	Xanthorrhoea spp.	Grass Tree	2	35L	6/m2
Grasses					
DIA cae	Dianella caerulea 'Breeze'	Blue Flax Lily	0.6-0.7	V/cell	6/m2
DIA tas	Dianella tasmanica 'Destiny'	Variegated Flax Lily	0.35	V/cell	8/m2
LIR mus	Lilope muscari 'Evergreen Giant'	Evergreen Giant	1	V/cell	4/m2
LOM tan	Lomandra 'Tanika'	Fine Mat Rush	0.5	V/cell	8/m2
Oph nig	Ophiopogon nigrescens	Black Mondo	0.2	V/cell	8/m2
Groundcovers					
HEL lim	Heliochrysum 'Limelight'	Licorice plant	0.2	140mm	5/m2
MYO par	Myoporum parvifolium	creeping booblanina	0.5	140mm	5/m2
SCA mau	Scaevola 'Maue Clusters'	Fairy fan flower	0.5	140mm	5/m2
MEL ull	Melaleuca 'Ulladulla Beacon'	Honey Myrtle	0.5	140mm	5/m2
WAH cvs	Wahlenbergia stricta	Australian bluebell	0.5	140mm	5/m2
LEP lit	Leptospermum 'Little Lemon scents'	lemon scented tea tree	0.5	140mm	5/m2
HIB sca	Hibbertia scandens	Climbing Guinea flower	0.2	V/cell	5/m2
HAR vio	Hardenbergia 'Mini Haha'	Happy wanderer	0.2	V/cell	5/m2
TRA jas	Trachelospermum jasminoides	Star Jasmine	0.2	140mm	5/m2
VIO hed	Viola hederacea 'Monga Magic'	Native Violet	0.5	140mm	5/m2
LAM whi	Lamium 'White nancy'	Creeping lamium	0.2	140mm	5/m2
AJ	Ajuga reptans cvs	Bugle	0.2	140mm	5/m2
HOS fra	Hosta 'Fragrant bouquet'	Plantain	0.2	200mm	5/m2
HEU sha	Heuceara 'Shanghai' or similar	Alum root	0.2	200mm	5/m2
ANE hyb	Anemone x hybrida (white)	Wind flower	0.2	200mm	5/m2
RUB par	Rubus parvifolius	Native raspberry	0.2	140mm	5/m2



Endemic to Pittwater Coastal Temperate Rainforest

Abbrev	Botanical Name	Common Name	Mature Height (m)	Pot Size	Qty
Trees (min. 4 PER 30m2)					
TRI lau	Tristanopsis laurina 'Luscious'	Water Gum	7-12	100L	20
SYN glo	Syncarpha glomerata	Turpentine	10-20	100L	4
CER ape	Ceratopetalum apetalum	Coachwood	15-25	100 Lt	6
ACE sml	Acmena smithii	Lilly Pilly	10-15	100L	5
DOR sas	Doryphora sassafras	Sassafras	25-35	100L	3
CUP ana	Cupanopsis anacardioides	Tuckeroo	8-15	100L	5
ANG cos	Angophora costata	Smooth barked apple	15-25	100L	8
TOO aus	Toona australis	Red Cedar	40-60	100L	3
LIV aus	Livistona australis	Cabbage tree palm	20-25	100L	24
FIC mac	Ficus macrophylla	Moreton Bay Fig	20-25	45L	3
POL ele	Polyscias elegans	Celery wood	10-15	45L	3
SYZ leu	Syzygium luehmannii	Small leaved Lilly Pilly	3-5	45L	6
CYA aus	Cyathea australis	Soft tree fern	5-10	45L	3 / m2
CYA cun	Cyathea cunninghamii	slender tree fern	15-20	45L	3 / m2
DIC ant	Dicksonia antarctica	Rough tree fern	4-12	45L	3 / m2
Shrubs (2 PER 5m2 clumps of 3-5)					
ACA flo	Acacia floribunda	Weeping Acacia	3-8	25L	2 / 5m2
DOD tri	Dodonaea 'Purpurea'	Large-leaf Hop-Bush	3	25L	2 / 5m2
ANO gla	Anopterus glandulosus	Native Laurel	2-4	25L	2 / 5m2
AUS dul	Austrorhynchus dulcis	Midgim	1-3	25L	2 / 5m2
Ferns, Grasses (3 PER m2) & Groundcovers (5 PER m2)					
BLE car	Blechnum cartilagineum	gristle fern	0.4	V/cell	5 / m2
PRA pur	Pratia purpurescens	Matt rush	0.3	V/cell	5 / m2
ISO nod	Isolepis nodosa	Knobby club rush	0.4	V/cell	3 / m2
PTE esc	Pteridium esculentum	Austral Bracken	0.5-1	V/cell	3 / m2
COR str	Cordyline stricta	Slender palm lily	2-5	V/cell	3 / m2
PTE esc	Pteridium esculentum	Bracken Fern	0.4	V/cell	3 / m2
ADI aet	Adiantum aethiopicum	Maiden hair fern	0.3	V/cell	5 / m2
HEL gla	Helmholtzia glaberrima	Native stream lily	1-2	V/cell	3 / m2
HIB sca	Hibbertia scandens var. glabra	climbing guinea flower	0.2	V/cell	3 / m2
ASP aus	Asplenium australasicum	Crows nest fern	0.5-1.5	25L	



1 Indicative Plant Schedule

Note: Final plant quantities are subject to construction certificate.

2 Indicative Plant Imagery

Peninsula Gardens - Design Strategy & Landscape Character



1 Character Imagery

sym. studio has been commissioned by AVEO to prepare a landscape package for Peninsula Gardens. This property is situated to the East and at the base of the Ingleside escarpment, south of Pittwater waterway and west of Mona Vale Beach on the Northern Beaches of Sydney.

The existing landscape character of Central Coast Escarpment Moist forest and Coastal Warm Temperate rainforest, provide an opportunity for a unique integrated development for Peninsula gardens that is sympathetic to the sites natural qualities. with minimal built form impact on the landscape. The steeply sloping site is characterised by existing tall forest. The landscape approach maintains the surrounding existing vegetation wherever possible to maintain unique site character. Both the architectural and landscape design approach aim to touch the site as lightly as possible.

The landscape strategy looks to retain existing vegetation, restore local habitat and revegetate with endemic species. Lot layout and building footprints have been sensitively design to minimize the impact upon the existing vegetation and natural topography. Landscape planting has been kept to predominantly endemic native planting to compliment the natural setting. Exotic species will only feature within the central zone around the highly disturbed building footprints to add colour and interest.

There are three vegetation communities present on the subject site. One of these in the central western part of the site is Coastal Warm Temperate Rainforest, located along the creek gully and characterised by Lilly Pilly (*Acmena smithii*) and Coachwood (*Ceratopetalum apetalum*). This twenty metre wide riparian corridor surrounding the small unnamed 50-100m long creek (1st order stream) will be protected, with no APZ compliance treatment in this zone. The design proposes to minimise human impact on the high conservation status riparian zone, This Eco Area has minimal landscape intervention and will include restoration and revegetation of existing vegetation using Coastal Warm Temperate Rainforest species. (Refer plant schedule)

The second vegetation type is the tall open forest located in the North & North West of the site. The 'Central Coast Escarpment moist forest' is characterised by a canopy of Turpentine (*Syncarpia glomulifera*) and Forest Oaks (*Allocasuarina torulosa*), as well as scattered with tall Rough barked apple (*Angophora costata*), Eucalyptus gummifera, Eucalyptus torulosa and Eucalyptus robusta. All existing trees outside of the impact/work zone are to be protected as per Australian Standards AS4970, including those identified as of Low significance on the Arborist report due to their potential Habitat significance. All existing medium to large sized Hollow bearing trees (HBTs) (refer yellow triangles on Ecological report) will be retained to provide Fauna Habitat.

The landscape approach is to focus on revegetation/restoration to the area of the site surrounding the proposed works and to maintain habitat for local wildlife. In particular "potential habitat for threatened species, in particular foraging habitat for the Glossy-black Cockatoo and hollow bearing trees which may provide breeding habitat for a range of threatened species known to occur in the locality." (Eco Logical Australia) Succession planting will also be implemented. The existing site has large ratios of landscape areas (approximately 58%) with the new development limited to affecting approximately 21% of the sites total canopy cover. All 'High retention value' trees, as identified in the arborist report proposed for removal shall be replaced with a 2:1 ratio. The new tree planting will include endemic native species, to match the dominant native tree canopy species above. In addition to the 16 replacement trees, the planting strategy proposes a further 74 trees (refer 'Endemic to Pittwater Coastal Temperate Rainforest' plant schedule) for a total of 90 replacement trees. The majority of existing trees are mature in age with minimal new growth. This planting strategy maintains tree numbers and ensures future succession growth, once the existing site trees have reached their useful life span. The succession tree planting is proposed within the mapped Vegetation Zone. The recommendations of the Flora & Fauna Assessment by 'Eco Logical Australia' should be closely adhered to.

An indicative Bushfire Asset Protection Zone has been identified and the landscape response implements the following bush fire prevention strategies; Planting close to proposed buildings will be minimal, well spread out, with no overhanging branches, have a high moisture content and hence a low flammability and located at a distance from the buildings so as not to ignite the buildings by direct flame or radiant heat emission, all trees planted within the APZ will be smooth barked Eucalypts or Rainforest species with a high moisture content, and planted in groups, and existing trees partially cleared to avoid a continuous canopy. Flame retardant species such as *Angophora costata* will be used to reduce the risk of ember attack. (Planning for bushfire protection 2006 Appendix 5 Bushfire provisions - Landscaping and property maintenance)

Introduced landscape materials will focus on the use natural materials including stone paving, natural exposed aggregate concrete paths and timber/timber look materials that are sympathetic to the site character, durable and suitable for accessibility of elderly residents. Overall the landscape design establishes a strong outdoor character that is responsible, sustainable and low maintenance. This is achieved by retaining and enhancing the native vegetation and implementing a design approach that is sympathetic to the existing site character for the benefit of both existing wildlife as well as new senior residents.

2 Landscape Design Strategy

LANDSCAPE AREA CALCULATIONS

- Property Boundary, Area = approx 7.1 ha
- Extent of DA works boundary, Area = approx 1.3 ha
- Landscaped Area = approx 4.15 ha (58%)
- Deep Soil count = landscape area minus areas excluded = approx 4.14 ha (58%)
- Areas excluded from deep soil count (smaller than 3x3m)
- Extent of existing tree canopy = 4.76 ha
- Extent of existing tree canopy to be removed = approx 21%

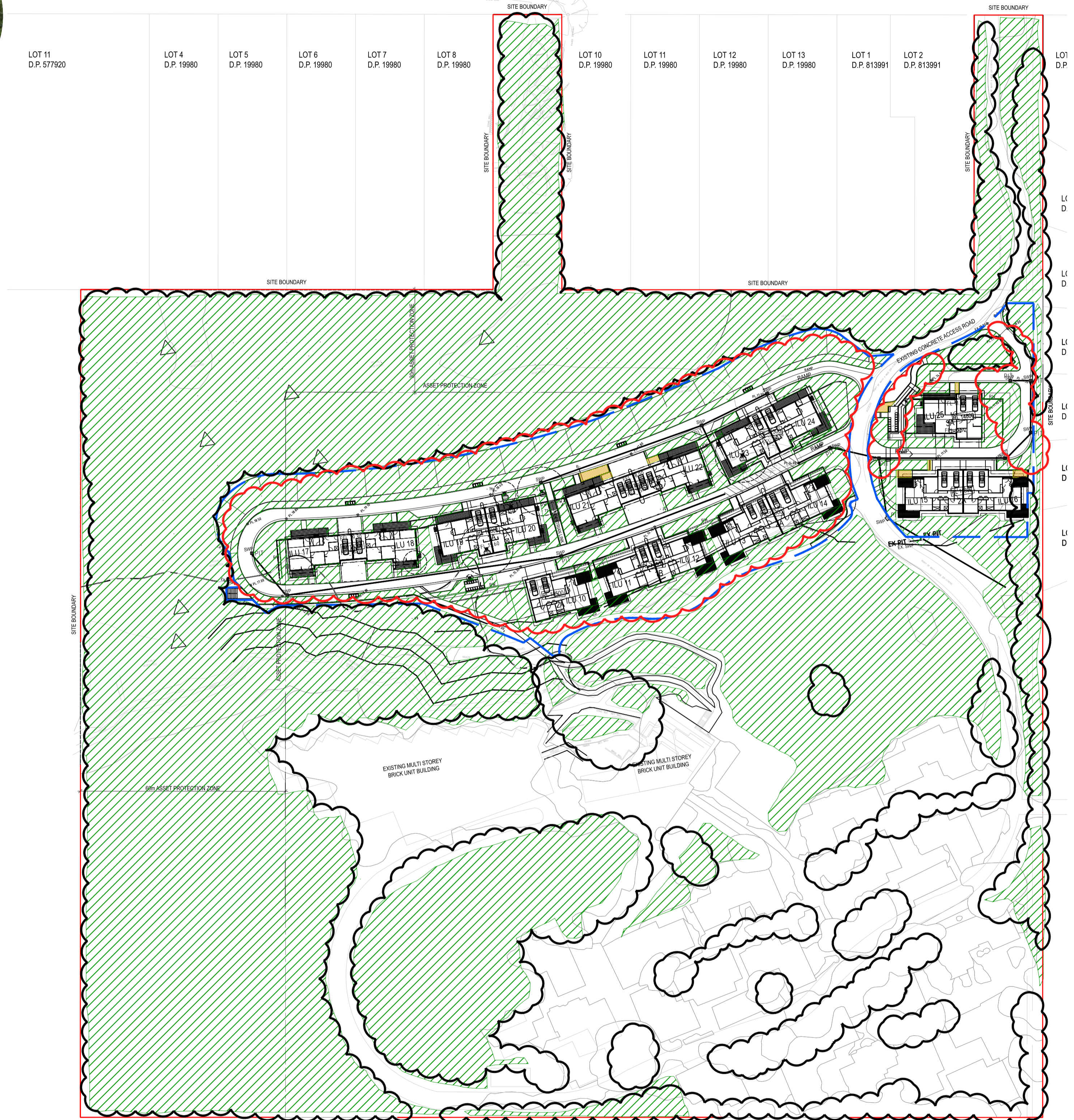

3 Landscape Area Calculations

Peninsula Gardens - Landscape Masterplan

Property Boundary	Proposed Trees	Landscape Swale	Top of Wall
Extent of existing trees to be retained & Protected (as per AS4970)	Native Groundcover Management Area	Fence/Privacy Screen	Top of Fence
Existing high value 'hollow-bearing trees to be retained	Almost Native Planting	Landscape walling	Finished Surface Level
Extent of existing tree canopy to be removed	Paving Type 1, Decking	(x.xx) Existing levels	Finished Ground Level
8 x 'High Value' Trees To Be Removed (As identified in arborist report)	Paving Type 2, Concrete	+ x.xx Proposed Levels	Finished Floor Level
	Paving Type 3, Pavers		Bottom of Bank
			Top of Bank



Peninsula Gardens - Landscape Planting Plan



- Steep northern bank native ground covers**
Telopea speciosa
Macrozamia communis
Doryanthes excelsa
- Myoporium parvifolium* *Leptospermum 'Little Lemon scents'*
Rubrus parvifolius *Melaleuca 'Ulladulla Beacon'*
Wahlenbergia stricta *Hardenbergia 'Mini Haha'*

- Stree Tree Planting**
 20 x *Tristaniopsis laurina*

- Entry Planting**
Callistemon 'All Aglow'
Melaleuca 'Claret Tops'
Austromyrtis dulcis

- Native hedge**
Acmena 'Cherry suprize'

- Endemic Rainforest trees**
 6 x *Syzigium luehmanii*
 6 x *Ceratopetalum apetalum*
 4 x *Syncarpia glomifera*
 5 x *Acmena smithii*
 3 x *Ficus macrophylla subs macrophylla*
 3 x *Polyscias elegans*
 3 x *Toona ciliata*
 5 x *Cupaniopsis ancardioides*
 3 x *Doryphora sassafras*

- Coastal Warm temperate rainforest (10m riparian buffer from creekline)**
Cyathea cooperi *Hibbertia scandens*
Anopeterus glangulosus *Lomandra spicata*
Pratia purpurescens *Dianella caerulea*















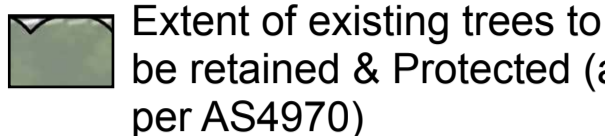



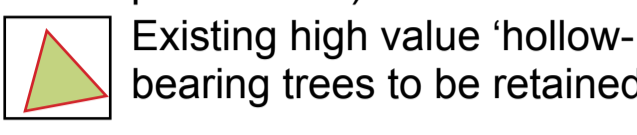

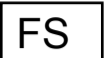
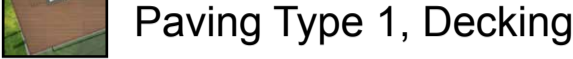
- Purple themed Exotic Shade-loving Planting**
- | | |
|--|--|
| 5 <i>Cercis 'Forest Pansy'</i>
<i>Plectranthus 'Mona Lavender'</i>
<i>Pieris japonica</i>
<i>Gardenia florida</i> | <i>Hydreangea cvs</i>
<i>Viburnum odoritissimum</i>
<i>Anemone x hybrida</i>
<i>Scaevola 'Mauve clusters'</i> |
|--|--|

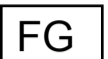
- Native planting east of road**
- 8 x *Angophora costata*
 - 5 x *Eucalyptus ficifolia*
 - 12 x *Waterhousia floribunda*
 - 5 x *Elaeocarpus 'Prima Donna'*
 - 4 x *Ceratopetalum 'Alberys red'*
 - 5 x *Hymenosporum flavum*
 - Doryanthes excelsa*

- Southern Embankment Native Fernery Planting**
- Pteridium esarclentum*
 - Cordyine stricta*
 - Dicksonia antarctica*
 - Blechnum cartilagineum*
 - Adiantum australasicum*
 - Cyathea australia*
 - Cyathea cunninghamii*

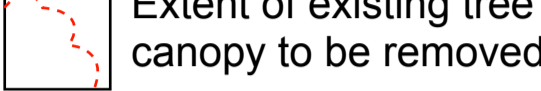
- Shade loving exotic planting between buildings**
- Acanthus mollis*
 - Hosta cvs*
 - Heucera cvs.*
 - Dianella 'Breeze'*
 - Philodendron 'Xanadu'*
 - Liriope muscari*

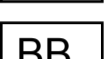
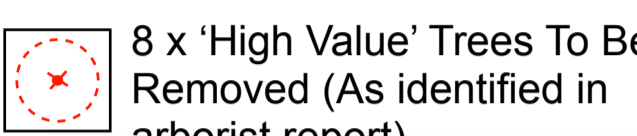
Peninsula Gardens - Typical Detail Plan & Sections

-  Property Boundary
-  Proposed Trees
-  Landscape Swale
-  TW Top of Wall
-  Extent of existing trees to be retained & Protected (as per AS4970)
-  Native Groundcover Management Area
-  Fence/Privacy Screen
-  TF Top of Fence
-  Existing high value 'hollow-bearing trees to be retained
-  Almost Native Planting
-  Landscape walling
-  FS Finished Surface Level
-  Paving Type 1, Decking
-  (x.xx) Existing levels
-  FG Finished Ground Level
-  Paving Type 2, Concrete
-  + x.xx Proposed Levels
-  FFL Finished Floor Level
-  Extent of existing tree canopy to be removed
-  Paving Type 3, Pavers
-  BB Bottom of Bank
-  8 x 'High Value' Trees To Be Removed (As identified in arborist report)
-  TB Top of Bank

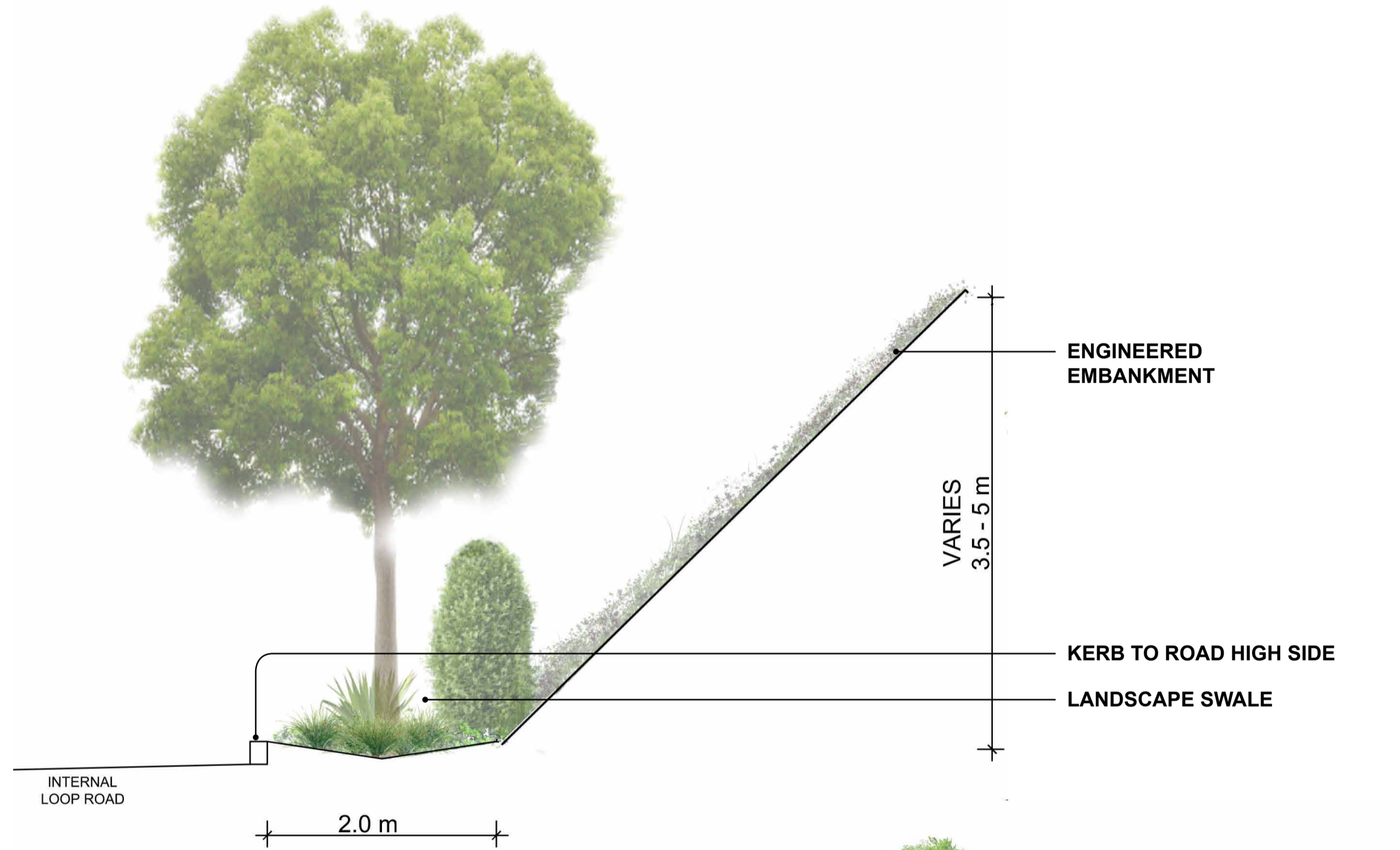

SECTION A
1:100@A1
1:200@A3

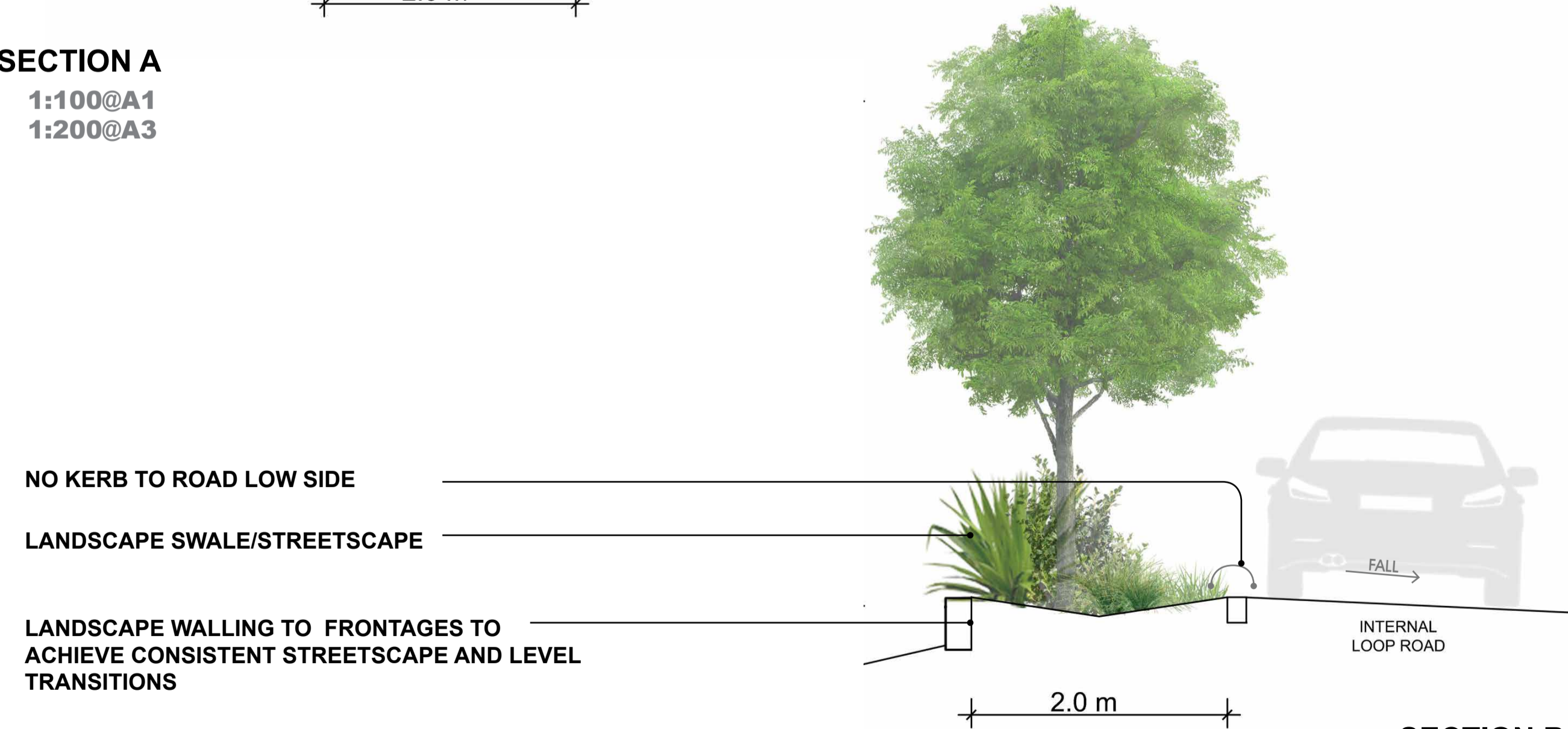

SECTION B
1:100@A1
1:200@A3

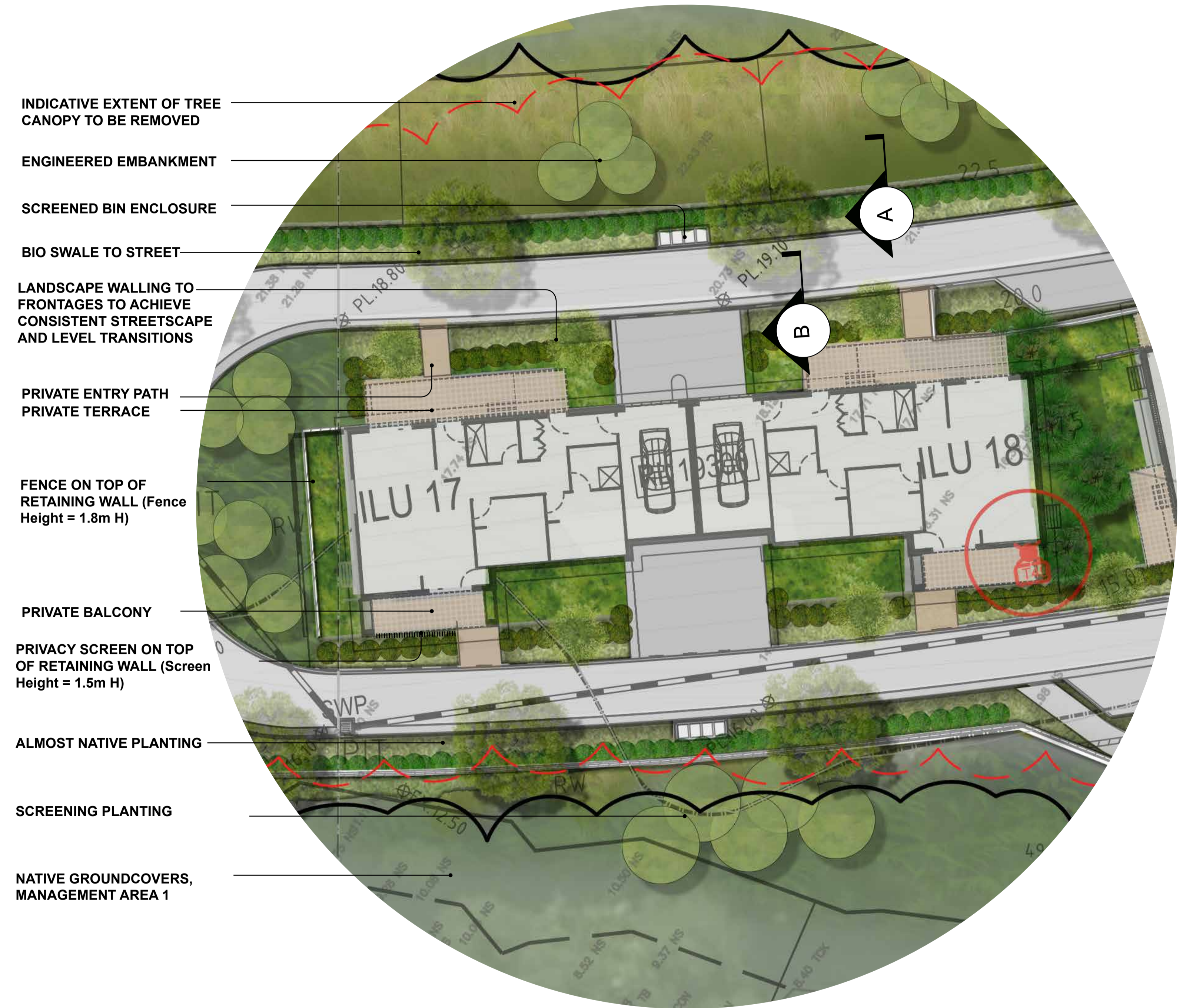

DETAIL PLAN
1:150@A1
1:300@A3

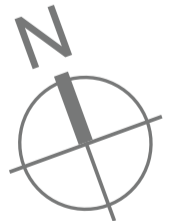

Peninsula Gardens - Typical Landscape Sections



SECTION C
1:100@A1
1:200@A3

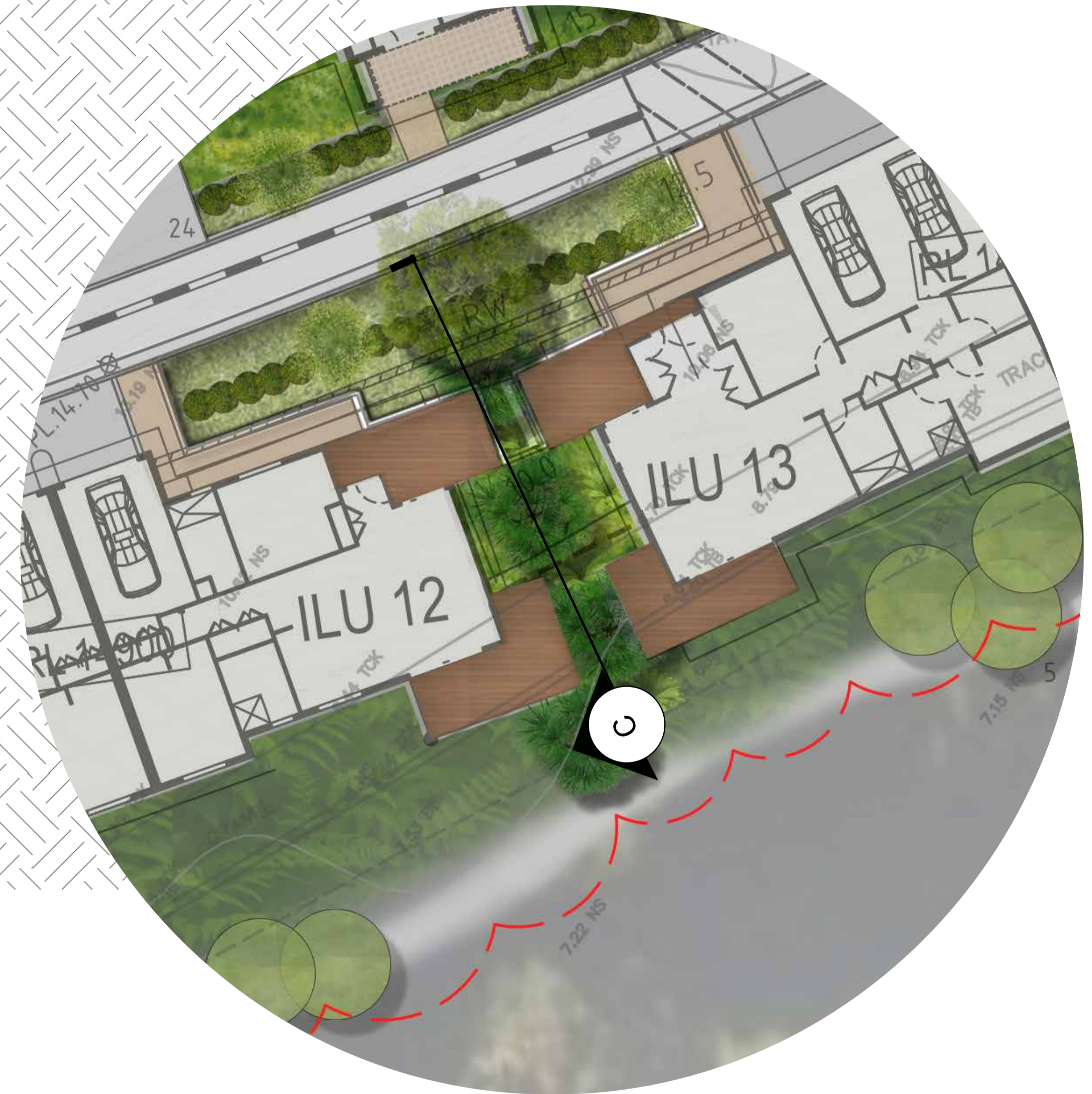

LOCATION PLAN
1:150@A1
1:300@A3

