

Property and Project Details

Complete this page and the relevant Sections that apply to your proposed development.

Property Details

Lot No: Deposited Plan (DP) No: or Strata Plan (SP) No:	13 1275411
Unit No: House No: Street: Suburb: Postcode:	1180 Barrenjoey Road, Palm Beach, NSW 2108

Project Details

Description of proposed development:	Erection of a new swimming pool and cabana structure
Structures to be demolished:	Nil

Section 1 - Demolition

This section must be completed in accordance with 'Chapter 1 – Demolition' of the Waste Management Guidelines

MATERIALS ON SITE	DESTINATION					
	<i>Evidence such as weighbridge dockets and invoices for waste disposal or recycling must be retained on site for inspection</i>					
	REUSE AND RECYCLING (MOST FAVOURABLE)			DISPOSAL (LEAST FAVOURABLE)		
Types of Waste Material	Estimated Volume (m ³) or Weight (t)	ONSITE RE-USE ✓ Specify how material will be reused on site	OFFSITE RECYCLING ✓ Recycling Outlet (RO) ✓ Waste Transport Contractor (WTC)	OFFSITE DISPOSAL ✓ Specify landfill site (LS) ✓ Specify Waste Transport Contractor (WTC)		
			WTC	RO	WTC	LS
Excavated Material	520	Sandstone used in garden walls			k i m b r i k i	
Garden Organics	10					
Bricks					OPTION NOT AVAILABLE: These materials must be re-used or separated on or off site and sent for recycling.	
Tiles						
Concrete						
Timber						
Plasterboard						
Metals						
Asbestos						
Other waste (please specify)						
Estimated Total % Recovered						

Refer to the estimation tables in 'Chapter 1 – Demolition' of the Guidelines for assistance in completing this table.

The applicant must submit a Site Plan showing the structures to be demolished and storage areas for waste and construction materials (if the development also includes construction).

WMP Checklist

Have you included the following:	Applicant Tick
A site plan showing: <ul style="list-style-type: none"> • The structures to be demolished. • Storage areas for waste to be reused, recycled, or disposed of. • Materials storage (if the development also includes construction) 	<input checked="" type="checkbox"/>
The table on the previous page, completed in accordance with 'Chapter 1 – Demolition' in the guidelines.	<input checked="" type="checkbox"/>

Section 2 – Construction

This section must be completed in accordance with 'Chapter 2 – Construction' of the Waste Management Guidelines

MATERIALS ON SITE	DESTINATION <i>Evidence such as weighbridge dockets and invoices for waste disposal or recycling must be retained on site for inspection</i>					
	REUSE AND RECYCLING (MOST FAVOURABLE)				DISPOSAL (LEAST FAVOURABLE)	
Types of Waste Material	Estimated Volume (m ³) or Weight (t)	ONSITE RE-USE ✓ Specify how material will be reused on site	OFFSITE RECYCLING ✓ Specify recycling outlet (RO) ✓ Specify Waste Transport Contractor (WTC)		OFFSITE DISPOSAL ✓ Specify landfill site (LS) ✓ Specify Waste Transport Contractor (WTC)	
* Please specify			WTC	RO	WTC	LS
Excavated Material						
Garden Organics	1		Avalon Away	Kimbriki		
Bricks	1		Avalon Away	Kimbriki	OPTION NOT AVAILABLE: These materials must be re-used or separated on or off site and sent for recycling.	
Tiles						
Concrete						
Timber*						
Plasterboard						
Metals*						
Asbestos						
Other waste*	1		Avalon Away	Kimbriki		
Estimated Total % Recovered						

Refer to the estimation tables in 'Chapter 2 – Construction' of the Guidelines for assistance in completing this table.

The applicant must submit a Site Plan showing the structures to be demolished and storage areas for waste and construction materials (if the development also includes construction).

WMP Checklist

Have you included the following:	Applicant Tick
A site plan showing: <ul style="list-style-type: none"> • The structures to be demolished. • Potential storage areas for waste to be reused, recycled, or disposed of. • Materials storage 	<input checked="" type="checkbox"/>
The table on the previous page, completed in accordance with 'Chapter 2 – Construction' in the guidelines.	<input checked="" type="checkbox"/>

Section 3 – On-going waste management for one or two dwellings

This section is to be completed in accordance with ‘Chapter 3 – On-going waste management for one or two dwellings’ of the Waste Management Guidelines.

Type of development: Swimming pool and cabana

Number of dwellings: 1

WMP Checklist

Do your architectural and landscape plans include the following:	Applicant Tick
Waste Storage Area design requirements (Chapter 3.2.)	<input checked="" type="checkbox"/>
Waste Storage Area location requirements (Chapter 3.3.)	<input checked="" type="checkbox"/>

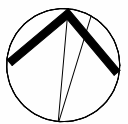
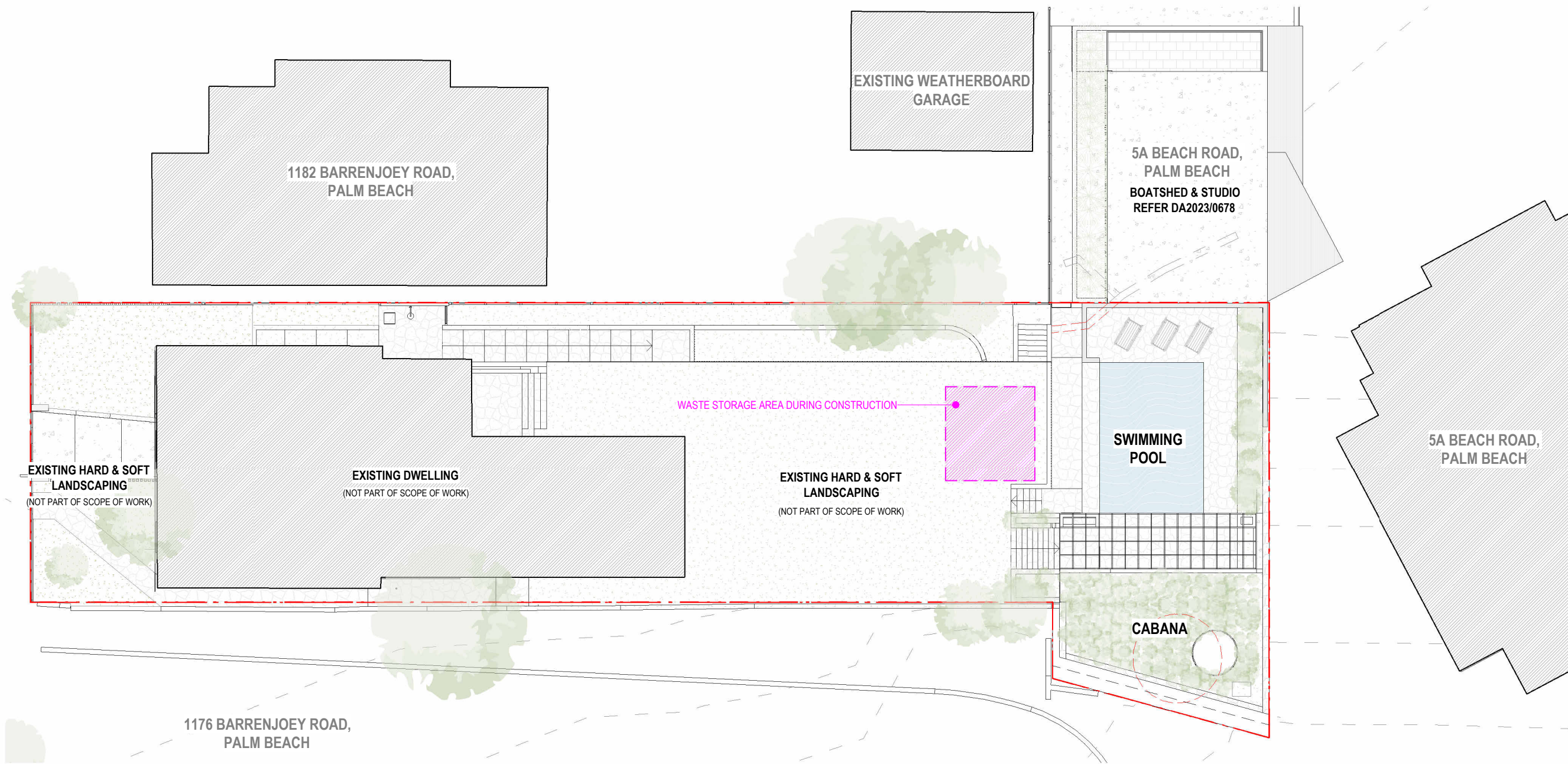

CLIENT:
JAMES & LOU MANNING

The copyright of this design remains the property of James Garvan Architecture. This design is not to be used, copied or reproduced without the authority of James Garvan. Do not scale from drawings. Confirm dimensions on site prior to the commencement of works. Where a discrepancy arises seek direction prior to proceeding with the works. Do not use this drawing for construction unless designated.
PROJECT:
1180 BARRENJOEY ROAD, PALM BEACH

PROJECT NO.:
0051
DRAWING TITLE:
WASTE MANAGEMENT PLAN

REV NO.:
9
ISSUE DATE:
20.12.23

SCALE @A3:
1 : 200
0 1 2 3 4 5 6 7 8 9 10

DRAWING NO.:
DA970

JAMES GARVAN
ARCHITECTURE
james garvan architecture pty ltd . abn 30 610 788 522 . e: james@jamesgarvan.com . www.jamesgarvan.com
ph: 0437 995 152 . nominated architect: james garvan . AIA registration: 9500 . a: po box 487 double bay 1360