

NOTE:

1. LEVELS SHOWN THUS  $\pm 0.40$  ARE BASED ON AUSTRALIAN HEIGHT DATUM
2. ORIGIN OF LEVELS - SSM 38160 R.L. 22.55 A.H.D.  
LOCATED IN THE KERB ON THE NORTHERN SIDE OF HUDSON PARADE  
OPPOSITE No.169 HUDSON PARADE
3. LEVELS SHOWN THUS ABT. 4.4 HAVE BEEN DETERMINED BY REMOTE  
METHODS AND ARE ACCURATE TO  $\pm 100\text{mm}$
4. THE NORTHERN BOUNDARY OF LOTS 7 TO 10 IN DP13760 HAVE BEEN  
DETERMINED BY A REGISTERED SURVEYOR  
IT SHOULD BE NOTED THAT IF ANY STRUCTURE IS TO BE ERECTED NEAR  
OR ON THE NORTHERN BOUNDARIES OF LOTS 7 TO 10 IN DP13760,  
THEN THE BOUNDARIES SHOULD BE MARKED.
5. CONTOURS ARE AT 0.2 METRE INTERVALS AND ARE APPROXIMATE ONLY.  
SPOT LEVELS SHOULD BE USED IN PREFERENCE TO CONTOUR VALUES.
6. BASIC LEVEL AND DETAIL SURVEY ONLY - UNLESS OTHERWISE SHOWN,  
THE POSITION OF IMPROVEMENTS ARE APPROXIMATE. THE INFORMATION  
SHOWN HEREON IS ONLY TO BE USED AT AN ACCURACY OF 1:100
7. THE DIAMETER, SPREAD AND HEIGHT OF ALL TREES ARE ESTIMATES  
ONLY. IF THEY ARE CRITICAL TO DESIGN THEN A MORE ACCURATE SURVEY  
WOULD BE REQUIRED.
8. FEATURES & LEVELS CRITICAL TO DESIGN SHOULD BE LOCATED BY A  
MORE ACCURATE SURVEY
9. ALL SET OUT WITH REGARD TO LEVELS SHOULD BE REFERRED TO THE  
BENCH MARK
10. SERVICES SHOWN ARE APPROXIMATE ONLY
11. EXISTING SERVICES MAY IMPACT ON DESIGN/CONSTRUCTION - IT IS  
ADVISED THAT A COMPREHENSIVE SERVICES SEARCH BE CARRIED OUT  
PRIOR TO COMMENCEMENT OF DESIGN/CONSTRUCTION  
REFER "DIAL BEFORE YOU DIG" DETAILS ON THIS PLAN
12. ORIGIN OF THE NORTH POINT IS THE MGA CO-ORDINATES OF SSM  
38160 & SSM 38162

— T — DENOTES APPROXIMATE POSITION OF UNDERGROUND TELECOM CABLES SCALED FROM SERVICE DIAGRAMS  
SUPPLIED FROM TELSTRA

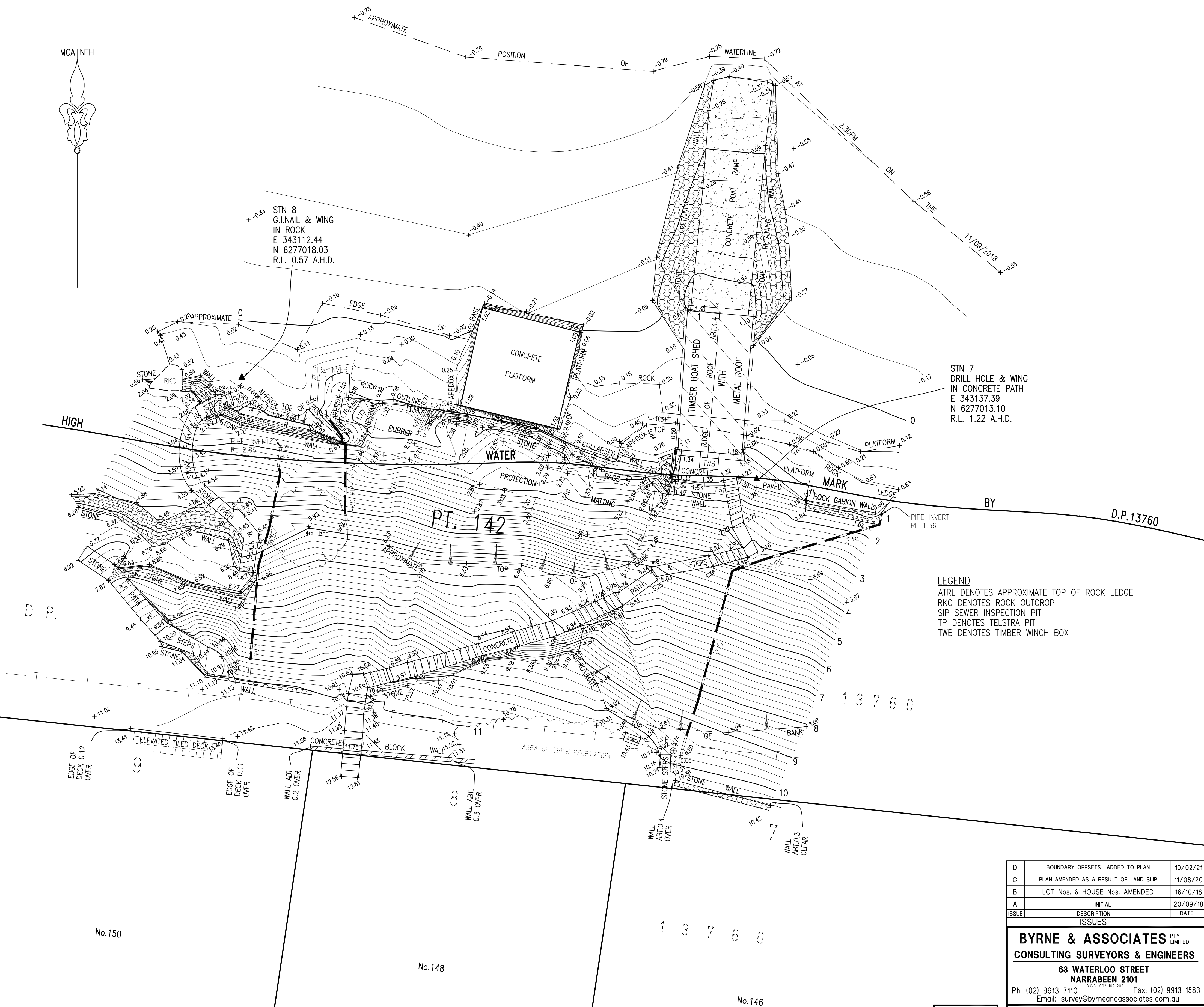

D	BOUNDARY OFFSETS ADDED TO PLAN	19/02/21
C	PLAN AMENDED AS A RESULT OF LAND SLIP	11/08/20
B	LOT Nos. & HOUSE Nos. AMENDED	16/10/18
A	INITIAL	20/09/18
ISSUE	DESCRIPTION	DATE

**BYRNE & ASSOCIATES** PTY LIMITED  
**CONSULTING SURVEYORS & ENGINEERS**  
63 WATERLOO STREET  
NARRABEEN 2101  
Ph: (02) 9913 7110 A.C.N. 502 109 202 Fax: (02) 9913 1583  
Email: survey@byrneandassociates.com.au

LEVEL & DETAIL SURVEY OVER  
PART OF LOT 142 IN D.P.13760  
BEING PART OF TAYLORS POINT  
RESERVE HUDSON PARADE,  
CLAREVILLE

Date of Survey	11/09/18	Prepared by	PBB	Date	20/09/18	Approved by		Date		R.R.	1:100
File Name	1098103.DWG	Sheet	1	Sheets	1	Plan No.	A1	1098103			



REGISTERED SURVEYOR  
REGISTRATION No.711