

# Seniors Living

1955 Pittwater Rd, Bayview, 2104

## Landscape Section 4.55

© 2021 Site Image (NSW) Pty Ltd ABN 44 801 262 380 as agent for Site Image NSW Partnership. All rights reserved. This drawing is copyright and shall not be reproduced or copied in any form or by any means (graphic, electronic or mechanical including photocopy) without the written permission of Site Image (NSW) Pty Ltd Any license, expressed or implied, to use this document for any purpose what so ever is restricted to the terms of the written agreement between Site Image (NSW) Pty Ltd and the instructing party.

The contractor shall check and verify all work on site (including work by others) before commencing the landscape installation. Any discrepancies are to be reported to the Project Manager or Landscape Architect prior to commencing work. Do not scale this drawing. Any required dimensions not shown shall be referred to the Landscape Architect for confirmation.

### Drawing Schedule

Drawing Number	Drawing Title	Scale
000	Landscape Coversheet	N/A
001	Landscape Area Plan	1:100
101	Landscape Plan - Ground Floor	1:100
201	Landscape Plan - First Floor	1:50
501	Landscape Details	As Shown
601	Landscape Sections	As Shown
901	Tree Retention Plans	As Shown

Issue	Revision Description	Drawn	Check	Date
E	Architectural Coordination	LW	NM	02.03.2023
D	Architectural Coordination	LW	NM	10.02.2023
C	Response to Comments	LH	NM	12.10.2022
B	Architectural Coordination	LW	NM	11.08.2022
A	Section 4.55	LW	NM	03.08.2022

### Legend

Plant Schedule							
Additional Trees to replace Tree no 3	Code	Botanic Name	Common Name	Mature Size	Pot Size	Density	Qty
<b>GROUND FLOOR</b>							
<b>TREES</b>							
As	Acmena Smithii	Common Lily Pilly	5 x 3	45 Ltr	As Shown	5	
Ac	Angophora costata	Sydney Red Gum	17 x 8	75 Ltr	As Shown	4	
Bi	Banksia integrifolia	Coastal Banksia	8 x 5	45 Ltr	As Shown	2	
Cm	Corymbia maculata	Spotted Gum	45 x 15	45 Ltr	As Shown	4	
Cap	Ceratopetalum apetalum	Coachwood	18 x 5	200mm	As Shown	4	
Cgu	Ceratopetalum gummiferum	NSW Christmas Bush	6 x 3	45 Ltr	As Shown	4	
Em	Eucalyptus maculata	Spotted Gum	28 x 8	300mm	As Shown	4	
Er	Elaeocarpus reticulatus	Blueberry Ash	8 x 4	45 Ltr	As Shown	5	
Ep	Eucalyptus punctata	Grey Gum	27 x 5	45 Ltr	As Shown	2	
HR	Hibiscus tiliaceus 'Rubra'	Beach hibiscus	6 x 3.5	35 Ltr	As Shown	1	
						<b>total</b>	35
<b>SHRUBS &amp; ACCENTS</b>							
Aa	Agave attenuata	Agave	1.5 x 1	300 mm	As Shown	29	
AsCS	Acmena smithii 'Cherry Surprise'	Lillypilly	2.5 x 1.5	300 mm	As Shown	15	
AsGN	Acmena smithii var minor	Acmena smithii 'Goodbye Neighbour'	3.5 x 2.5	300 mm	As Shown	42	
Asm	Acmena smithii var minor	Acmena smithii Minor	4.0 x 2.5	300 mm	As Shown	45	
Bn	Blechnum nudum	Fishbone Water Fern	0.8 x 0.45	300 mm	As Shown	0	
Br	Bauera rubioides	River Rose	0.8 x 1.6	300 mm	As Shown	23	
Bs	Banksia spinulosa	Banksia 'Cherry Candles'	0.4 x 0.8	300 mm	As Shown	83	
Ca	Correa alba	White Correa	1.2 x 1.0	300 mm	As Shown	97	
De	Doryanthes excelsa	Gymea Lily	2.5 x 1.8	300 mm	As Shown	91	
Mc	Macrozamia communis	Burrawang	2.5 x 2.8	300 mm	As Shown	17	
PX	Philodendron 'Xanadu'	Xanadu Philodendron	1.1 x 0.8	300 mm	As Shown	39	
Sr	Strelitzia reginae	Bird Of Paradise	1.2 x 1.0	300 mm	As Shown	29	
WJG	Westringia fruticosa 'Jervis Gem'	Coastal Rosemary	1.2 x 1.0	300 mm	As Shown	163	
<b>GRASSES &amp; GROUND COVERS</b>							
Cg	Carpobrotus glaucescens	Pigface	0.15 x 1.6	200 mm	As Shown	250	
DCB	Dianella caerulea 'Cassa Blue'	Spreading Flax Lily	0.45 x 0.4	200 mm	As Shown	25	
GCC	Grevillea rhytidota x juniperina 'Cherry Cluste'	Prickly Grevillea	0.5 x 0.8	200 mm	As Shown	42	
HHW	Hardenbergia violacea 'Happy Wanderer'	Hardenbergia	2.5 x 3.0	200 mm	As Shown	48	
LI	Lomandra longifolia	Spiny-headed Mat-Rush	0.8 x 1.0	200 mm	As Shown	92	
LLC	Lomandra longifolia 'Little Con'	Lomandra Little Con	0.3 x 0.3	200 mm	As Shown	65	
LIT	Lomandra longifolia 'Tanika'	Spiny-headed mat rush	0.5 x 0.8	200 mm	As Shown	251	
PBB	Phormium 'Baby Bronze'	Baby Bronze New Zealand Flax	0.75 x 0.75	200 mm	As Shown	36	
Pp	Pandorea pandorana	Wonga Wonga Vine	0.4 x 0.75	200 mm	As Shown	7	
PR	Pennisetum 'Rubrum'	Purple Fountain Grass	0.7 x 0.5	200 mm	As Shown	73	
PSB	Poa labillardieri 'Suggan Buggan'	Tussock Grass	0.9 x 0.8	200 mm	As Shown	84	
TM	Themeda australis 'Mingo'	Kangaroo Grass	0.25 x 0.55	200 mm	As Shown	169	
Vh	Viola hederacea	Native Violet	0.15 x 1.6	200 mm	As Shown	152	

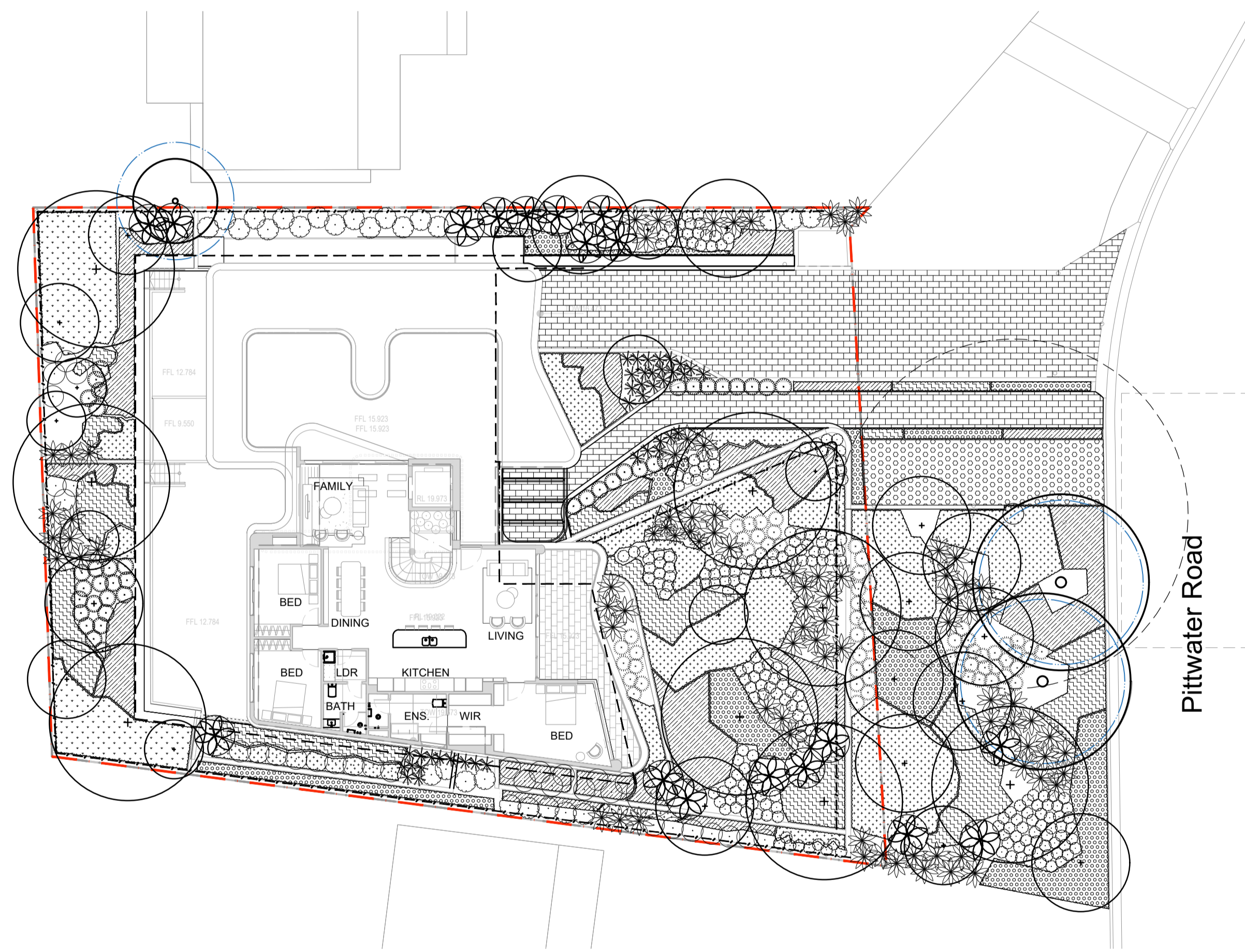

Site Plan | Scale 1:200

Client  
Cap One Developments Pty Ltd

Project  
1955 Pittwater Rd, Bayview

SITE IMAGE  
Level 1, 3-5 Baptist Street  
Redfern NSW 2016  
Australia  
Tel: (61 2) 8332 5600  
Fax: (61 2) 9698 2877  
www.siteimage.com.au  
Site Image (NSW) Pty Ltd  
ABN 44 801 262 380  
Landscape Architects

Section 4.55

Drawing Name  
Landscape Coversheet

Scale  
Job Number  
Drawing Number  
Issue  
SS22-5004  
000 E



NOT FOR CONSTRUCTION



The contractor shall check and verify all work on site (including work by others) before commencing the landscape installation. Any discrepancies are to be reported to the Project Manager or Landscape Architect prior to commencing work. Do not scale this drawing. Any required dimensions not shown shall be referred to the Landscape Architect for confirmation.

Issue	Revision Description	Drawn	Check	Date
D	Issue Updated	LW	NM	03.03.2023
C	Architectural Coordination	LW	NM	02.03.2023
B	Architectural Coordination	LW	NM	10.02.2023
A	Section 4.55	LW	NM	03.08.2022

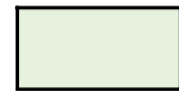
**Legend**

-  Landscape Area
-  Deep Soil Area

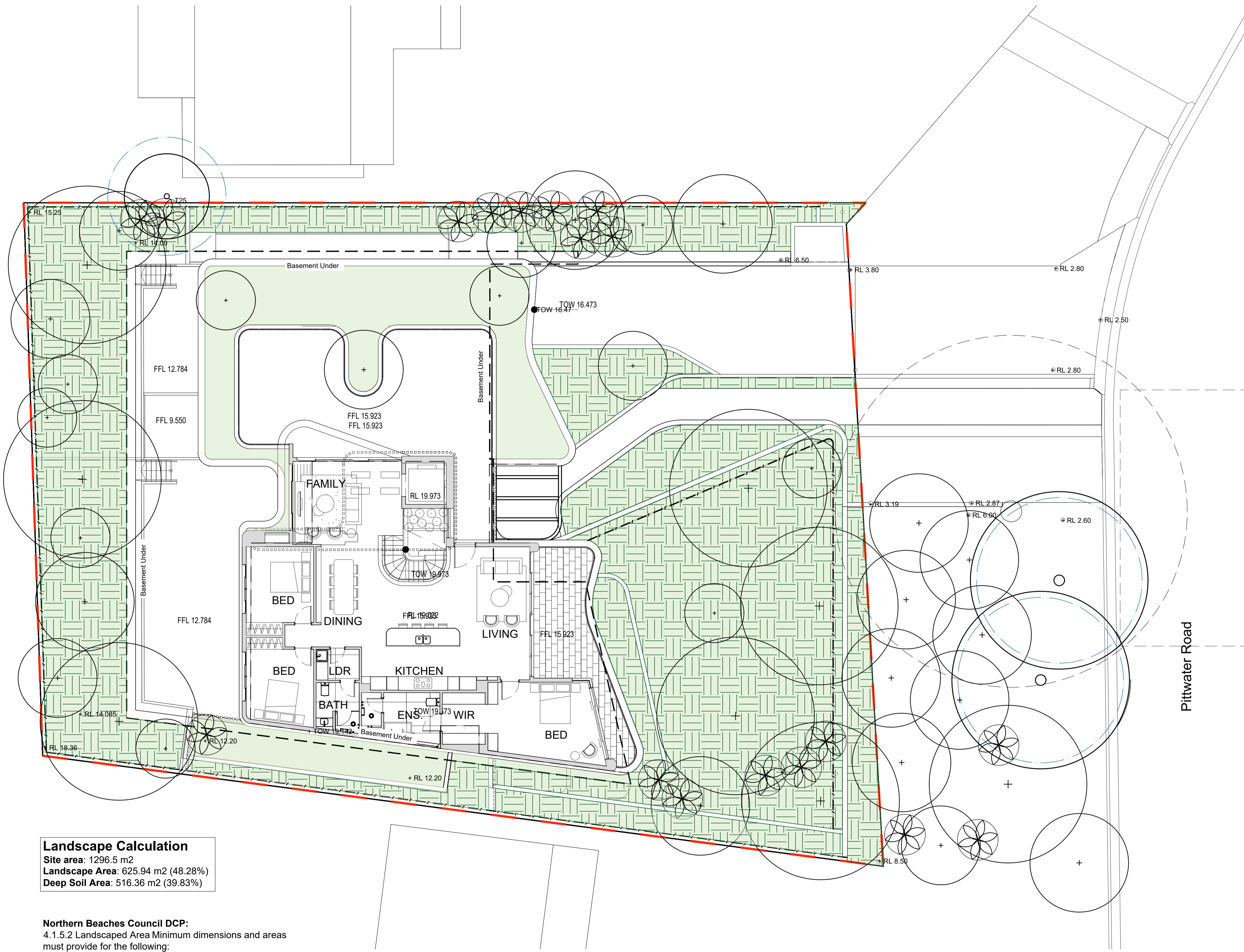

**Landscape Calculation**  
 Site area: 1296.5 m<sup>2</sup>  
 Landscape Area: 625.94 m<sup>2</sup> (48.28%)  
 Deep Soil Area: 516.36 m<sup>2</sup> (39.83%)

**Northern Beaches Council DCP:**  
 4.1.5.2 Landscaped Area Minimum dimensions and areas must provide for the following:  
 i) soil depth of at least 1m for all landscaped areas either in ground or above ground in raised planter beds; and  
 ii) a minimum horizontal dimension of 0.5m measured from the inner side of the planter bed/ box, wall or any other structure which defines the landscaped area and incorporating an appropriate drainage and irrigation regime

Client  
 Cap One Developments Pty Ltd

Project  
 1955 Pittwater Rd, Bayview

**SITE IMAGE**  
 Level 1, 3-5 Baptist Street  
 Redfern NSW 2016  
 Australia  
 Tel: (61 2) 8332 5600  
 Fax: (61 2) 9698 2877  
 www.siteimage.com.au  
 Site Image (NSW) Pty Ltd  
 ABN 44 801 262 380  
  
 Landscape Architects

Section 4.55  
 Drawing Name  
 Landscape Area Plan

Scale 1:100 @ A1  
 Job Number  
 Drawing Number  
 Issue

SS22-5004 001 D

NOT FOR CONSTRUCTION



The contractor shall check and verify all work on site (including work by others) before commencing the landscape installation. Any discrepancies are to be reported to the Project Manager or Landscape Architect prior to commencing work. Do not scale this drawing. Any required dimensions not shown shall be referred to the Landscape Architect for confirmation.

Issue	Revision Description	Drawn	Check	Date
D	Architectural Coordination	LW	NM	02.03.2023
C	Architectural Coordination	LW	NM	10.02.2023
B	Architectural Coordination	LW	NM	11.08.2022
A	Section 4.55	LW	NM	03.08.2022

- Legend**
- Site Boundary
  - Retained Tree
  - TPZ
  - Existing Tree to be Removed
  - Proposed Trees  
*(Refer Plant Schedule and Detail)*
  - Proposed Shrubs and Accents  
*(Refer Schedule and Details)*
  - Proposed Ground Cover  
*(Refer Schedule and Details)*
  - Existing Landscaping Area to be Retained
  - Proposed Paving
  - Grass Cell
  - Fence

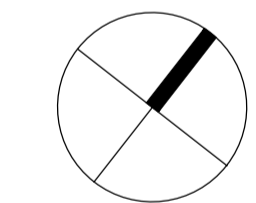

Client  
**Cap One Developments Pty Ltd**

Project  
**1955 Pittwater Rd, Bayview**

**SITE IMAGE**  
Level 1, 3-5 Baptist Street  
Redfern NSW 2016  
Australia  
Tel: (61 2) 8332 5600  
Fax: (61 2) 9698 2877  
www.siteimage.com.au  
Site Image (NSW) Pty Ltd  
ABN 44 801 262 380  
  
Landscape Architects

**Section 4.55**

Drawing Name  
**Landscape Plan  
Ground Floor**

Scale 1:100 @ A1  
Job Number  
Drawing Number  
Issue

SS22-5004 101 D

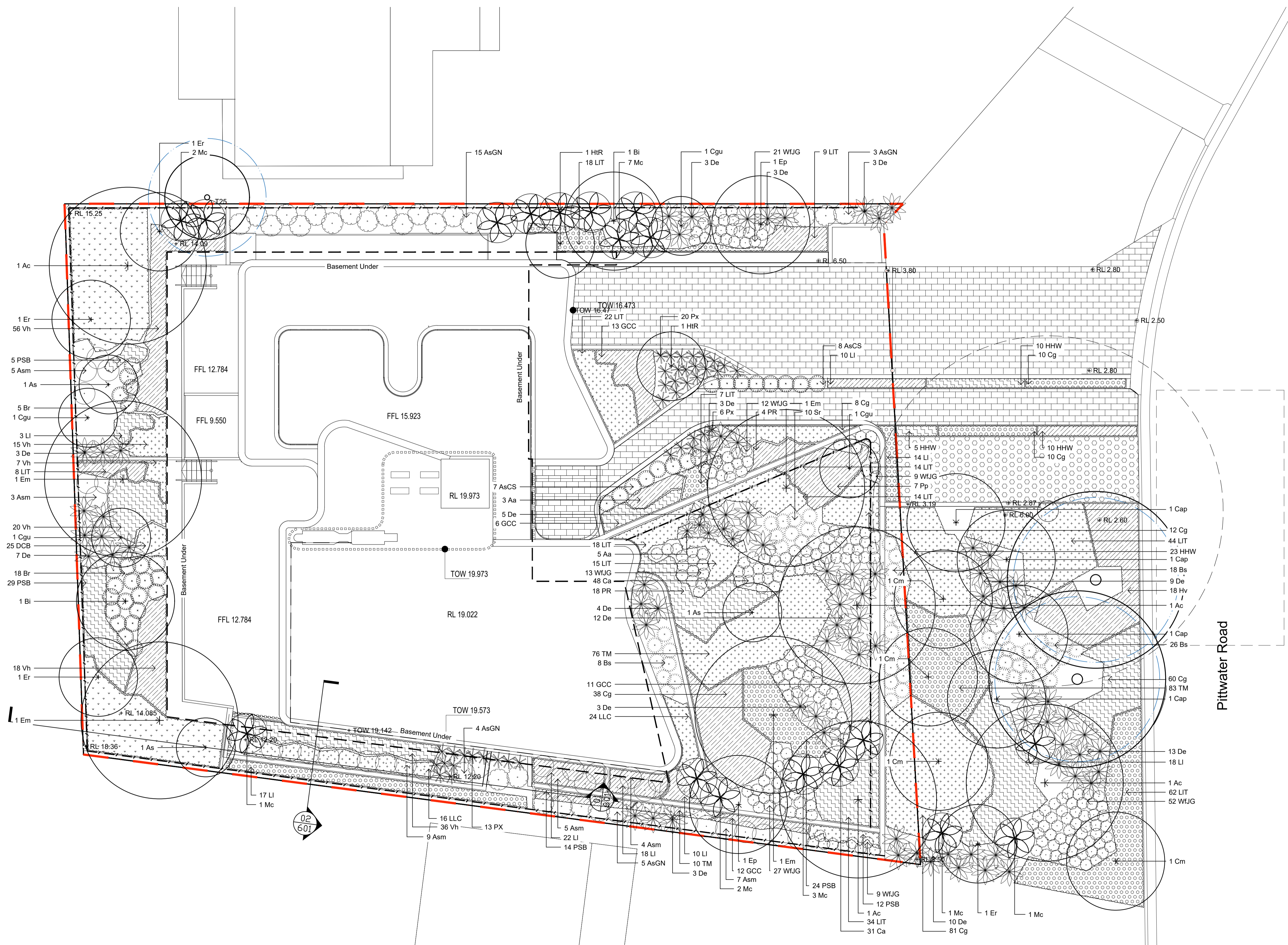

**NOT FOR CONSTRUCTION**







The contractor shall check and verify all work on site (including work by others) before commencing the landscape installation. Any discrepancies are to be reported to the Project Manager or Landscape Architect prior to commencing work. Do not scale this drawing. Any required dimensions not shown shall be referred to the Landscape Architect for confirmation.

A Section 4.55 LW NM 03.08.2022  
 Issue Revision Description Drawn Check Date

Legend

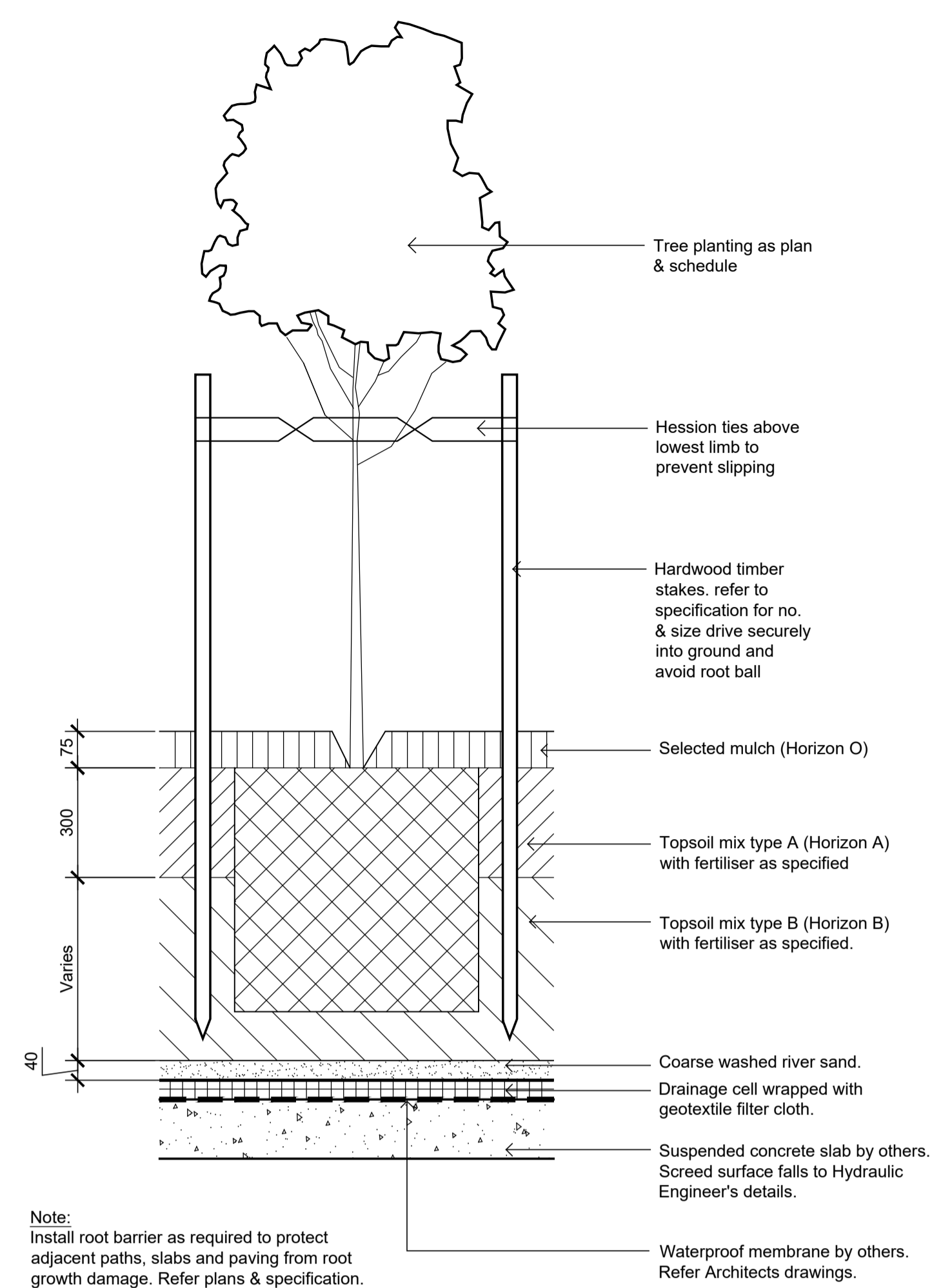
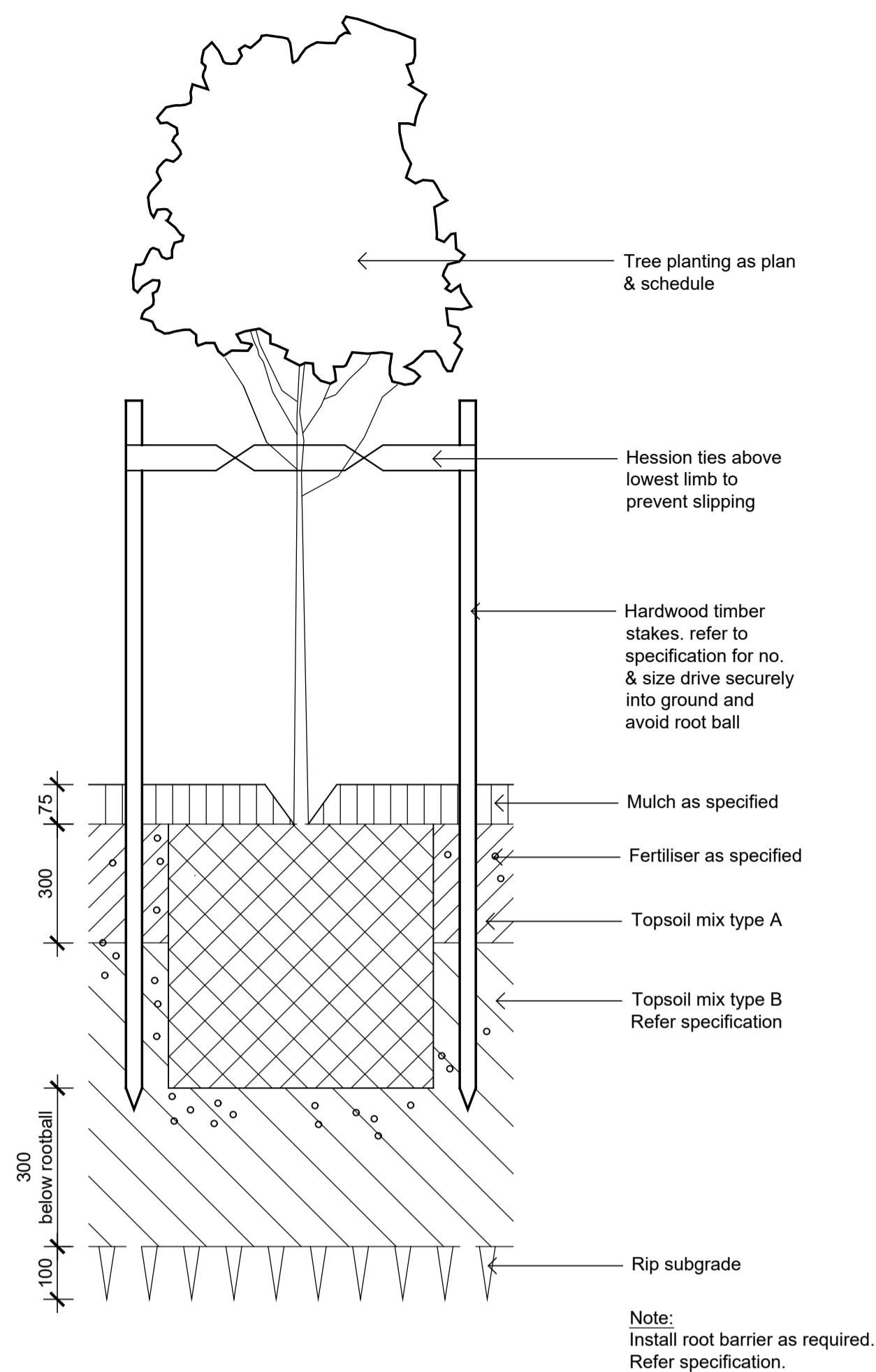

01 Detail 75-200L Tree Planting on Grade  
 501 1:10

02 Detail 75-200L Tree Planting on Structure  
 501 1:10

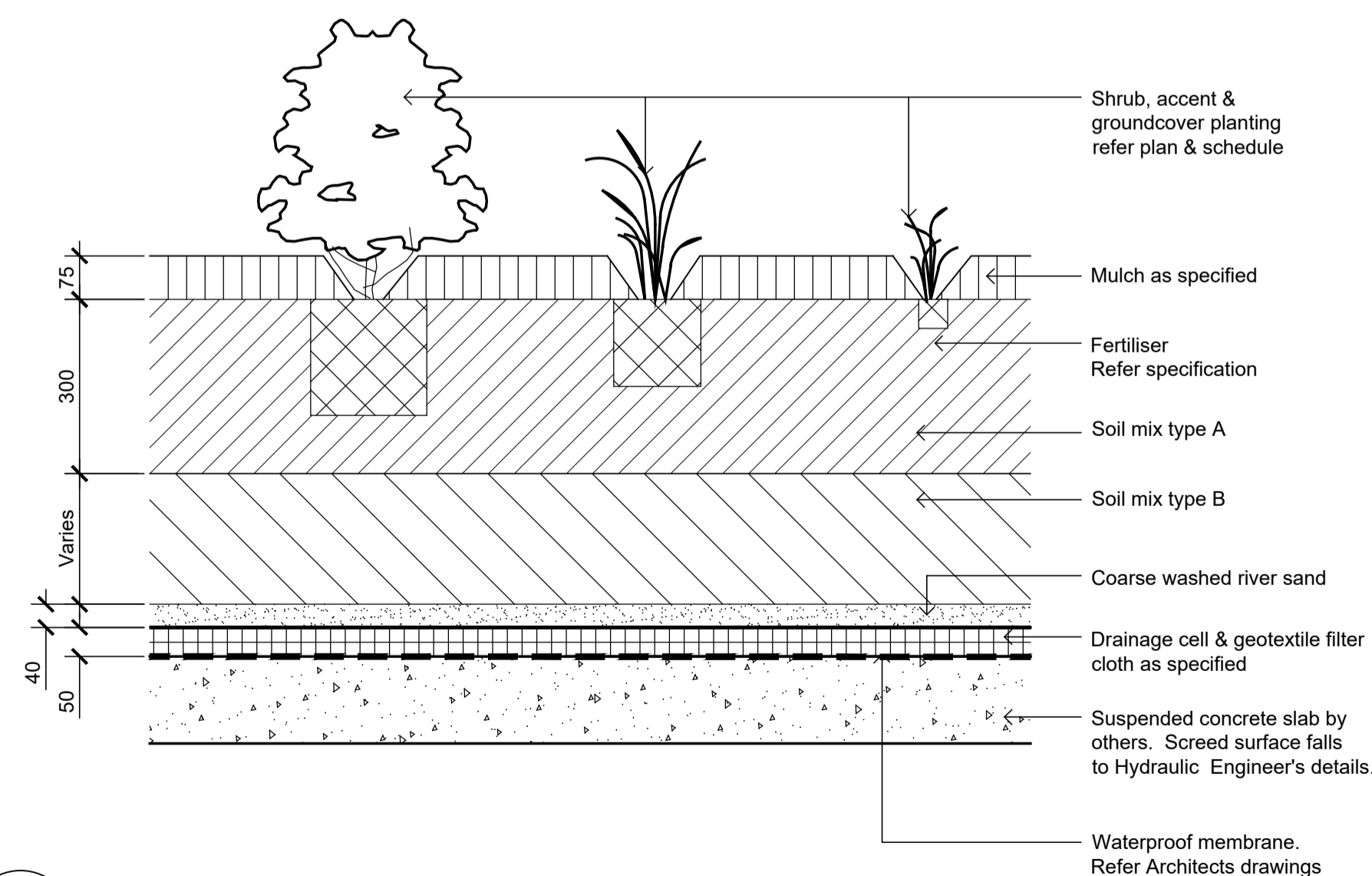
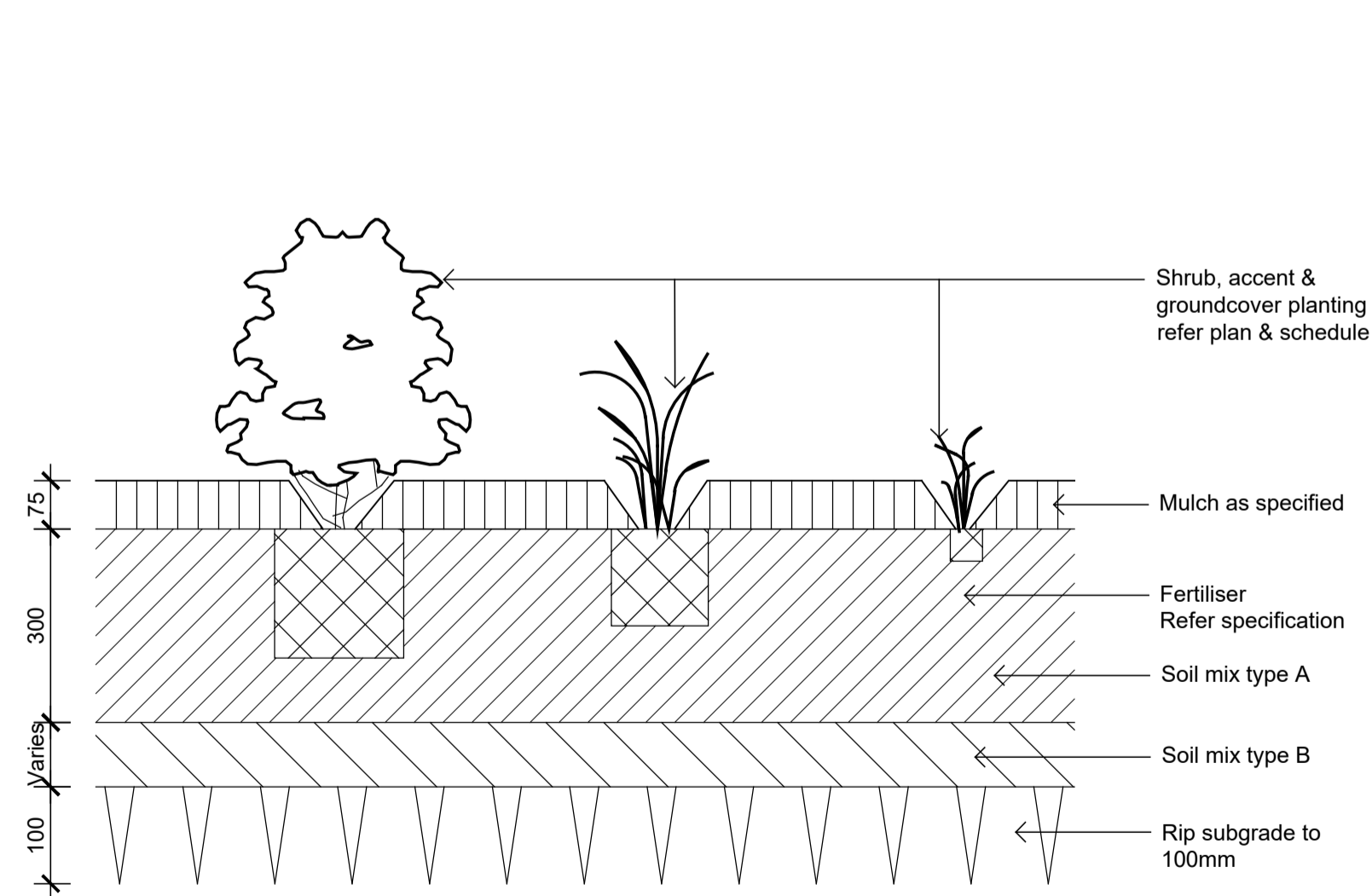

03 Detail Shrub Accent & Groundcover Planting on Grade  
 501 1:10

04 Detail Shrub Accent & Groundcover Planting on Structure  
 501 1:10

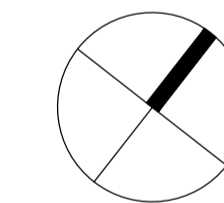

Client  
**Matt Schott**

Project  
**1955 Pittwater Rd, Bayview**

Level 1, 3-5 Baptist Street  
 Redfern NSW 2016  
 Australia  
 Tel: (61 2) 8332 5600  
 Fax: (61 2) 9698 2877  
 www.siteimage.com.au  
 Site Image (NSW) Pty Ltd  
 ABN 44 801 262 380



Section 4.55

Drawing Name  
**Landscape Details**

Scale As Shown  
 Job Number Drawing Number Issue  
**SS22-5004 501 A**

The contractor shall check and verify all work on site (including work by others) before commencing the landscape installation. Any discrepancies are to be reported to the Project Manager or Landscape Architect prior to commencing work. Do not scale this drawing. Any required dimensions not shown shall be referred to the Landscape Architect for confirmation.

C	Architectural Coordination	LW	NM	02.03.2023
B	Architectural Coordination	LW	NM	10.02.2023
A	Section 4.55	LW	NM	03.08.2022
Issue	Revision Description	Drawn	Check	Date

Legend

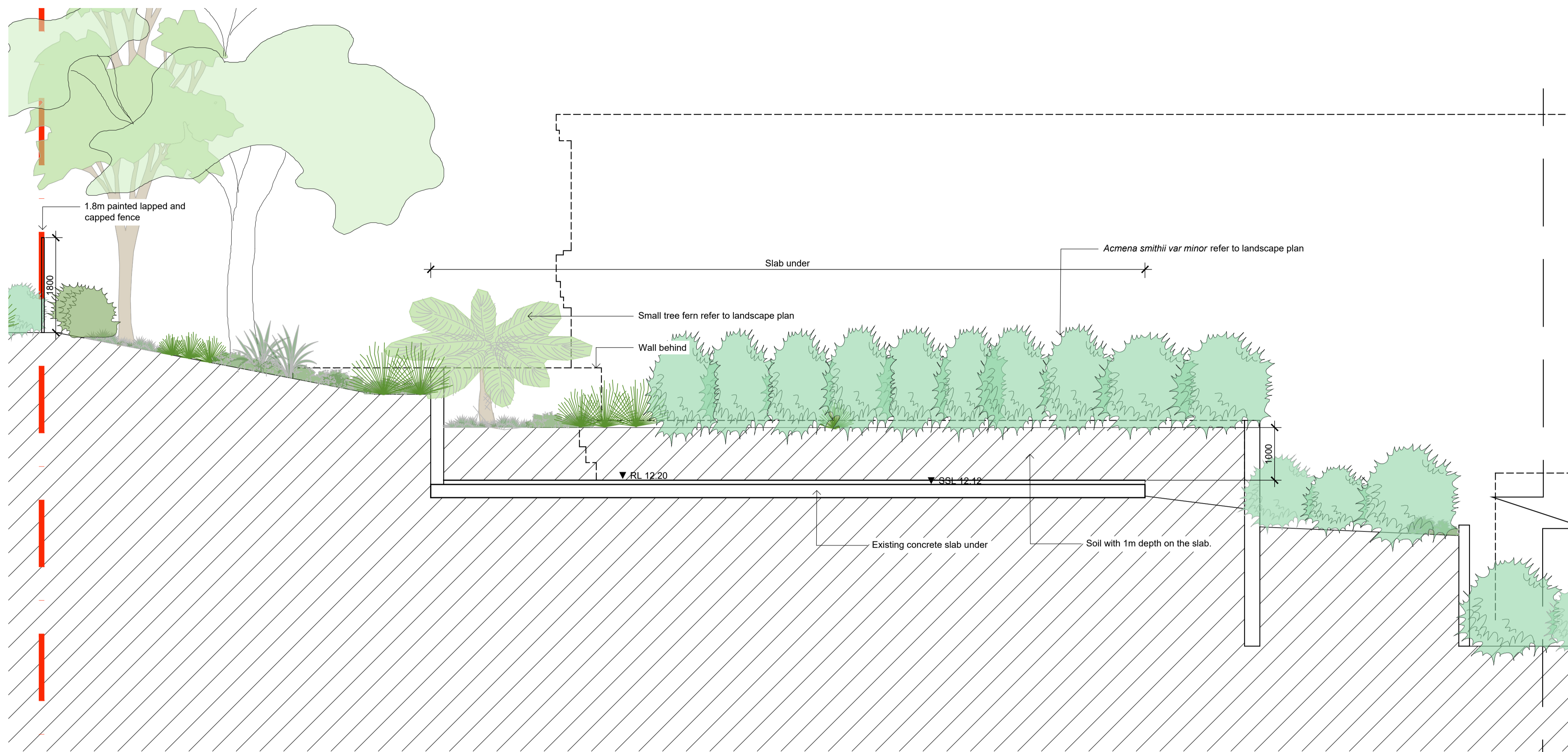

01 South Section  
601 1:50

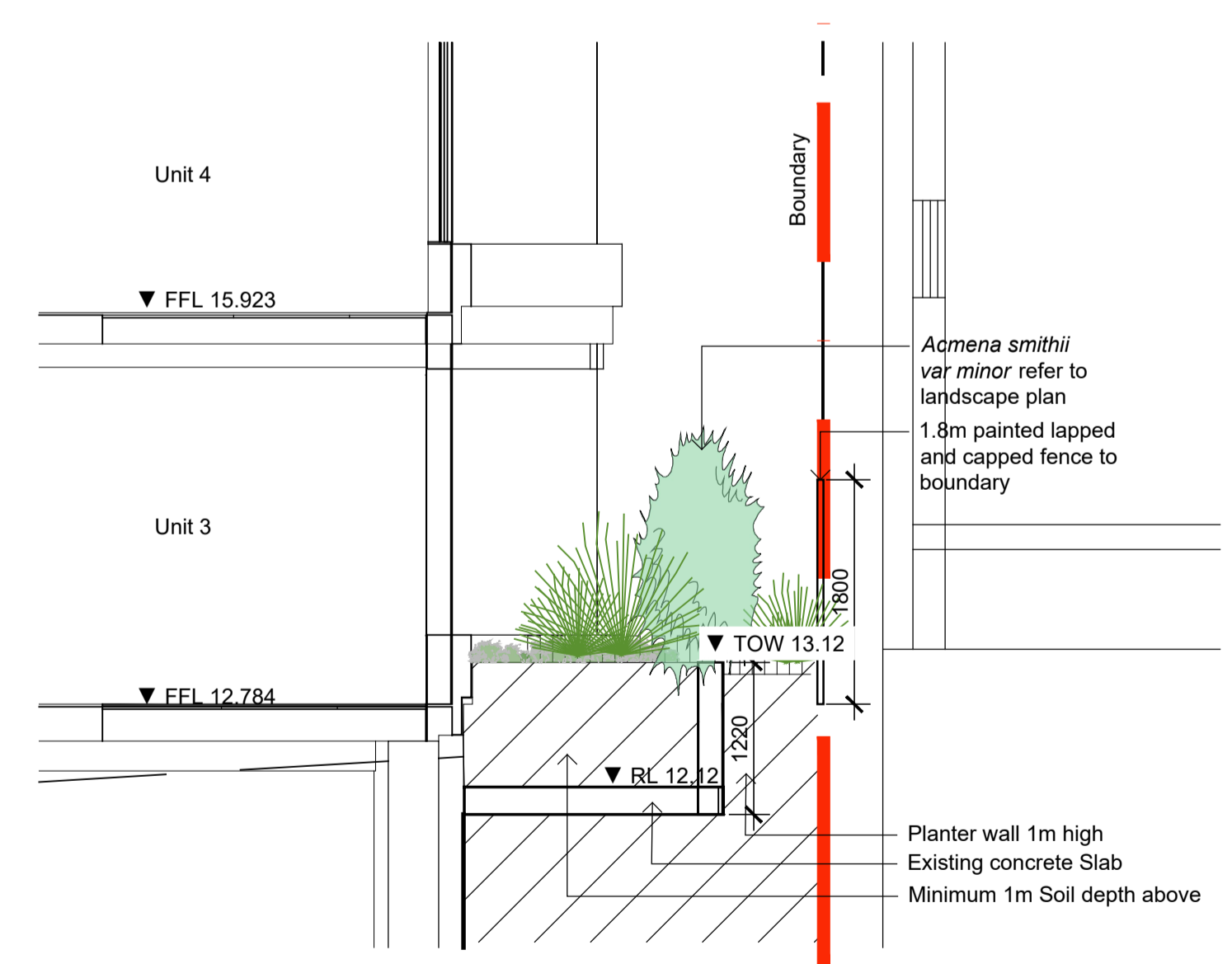

02 Detail Section  
601 1:50

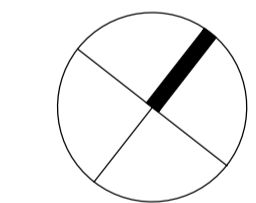

Client  
Cap One Developments Pty Ltd

Project  
1955 Pittwater Rd, Bayview

Level 1, 3-5 Baptist Street  
Redfern NSW 2016  
Australia  
Tel: (61 2) 8332 5600  
Fax: (61 2) 9698 2877  
www.siteimage.com.au  
Site Image (NSW) Pty Ltd  
ABN 44 801 262 380



Section 4.55

Drawing Name  
Landscape Sections



Scale As Shown  
Job Number SS22-5004  
Drawing Number 601  
Issue C

NOT FOR CONSTRUCTION



The contractor shall check and verify all work on site (including work by others) before commencing the landscape installation. Any discrepancies are to be reported to the Project Manager or Landscape Architect prior to commencing work. Do not scale this drawing. Any required dimensions not shown shall be referred to the Landscape Architect for confirmation.

B	Architectural Coordination	LW	NM	10.02.2023
A	Response To Comments	LH	NM	12.10.2022
Issue	Revision Description	Drawn	Check	Date

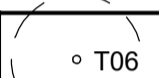
- Legend**
-  Site Boundary
  -  Retained Tree
  -  Existing Tree to be Removed

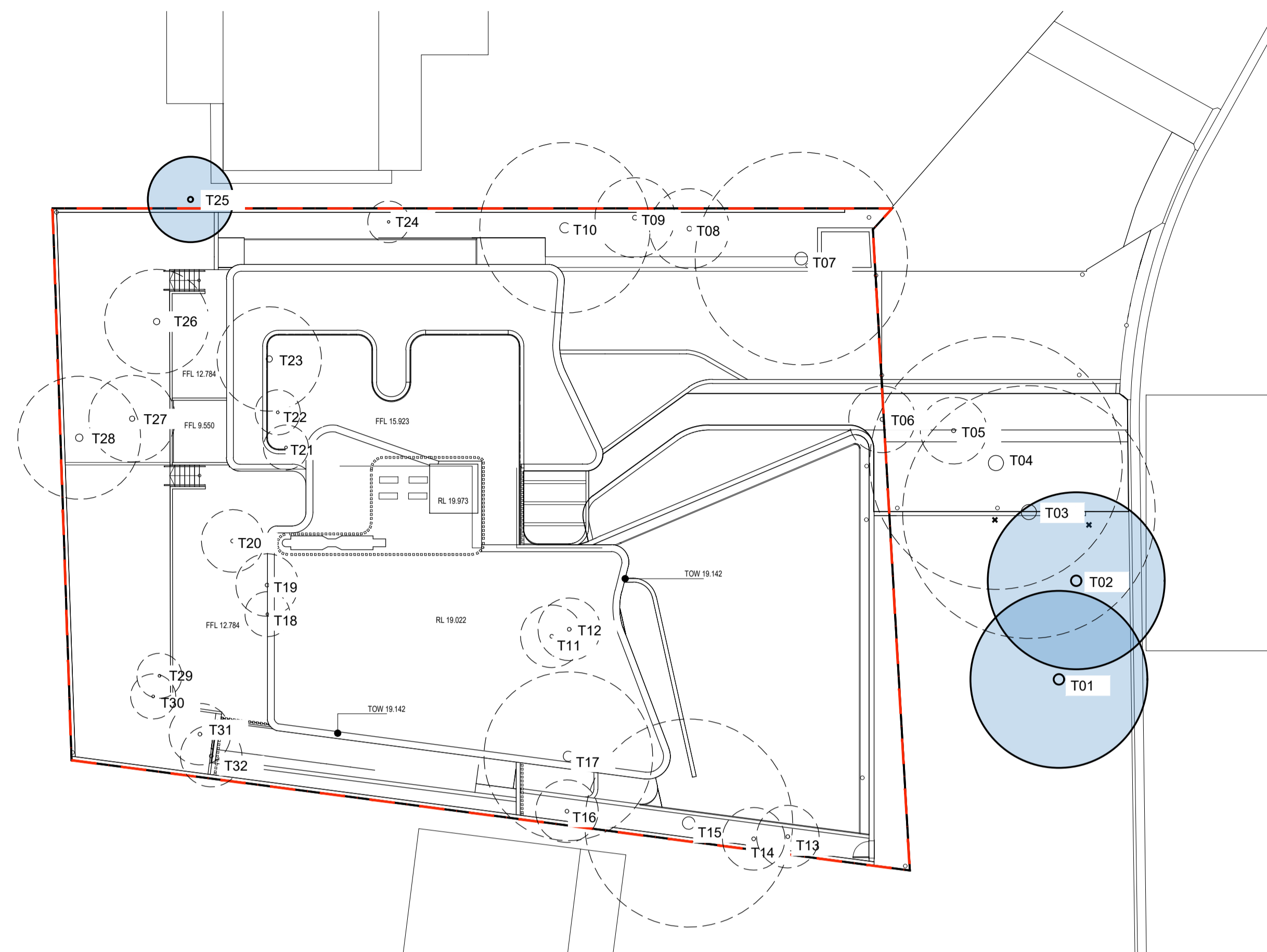
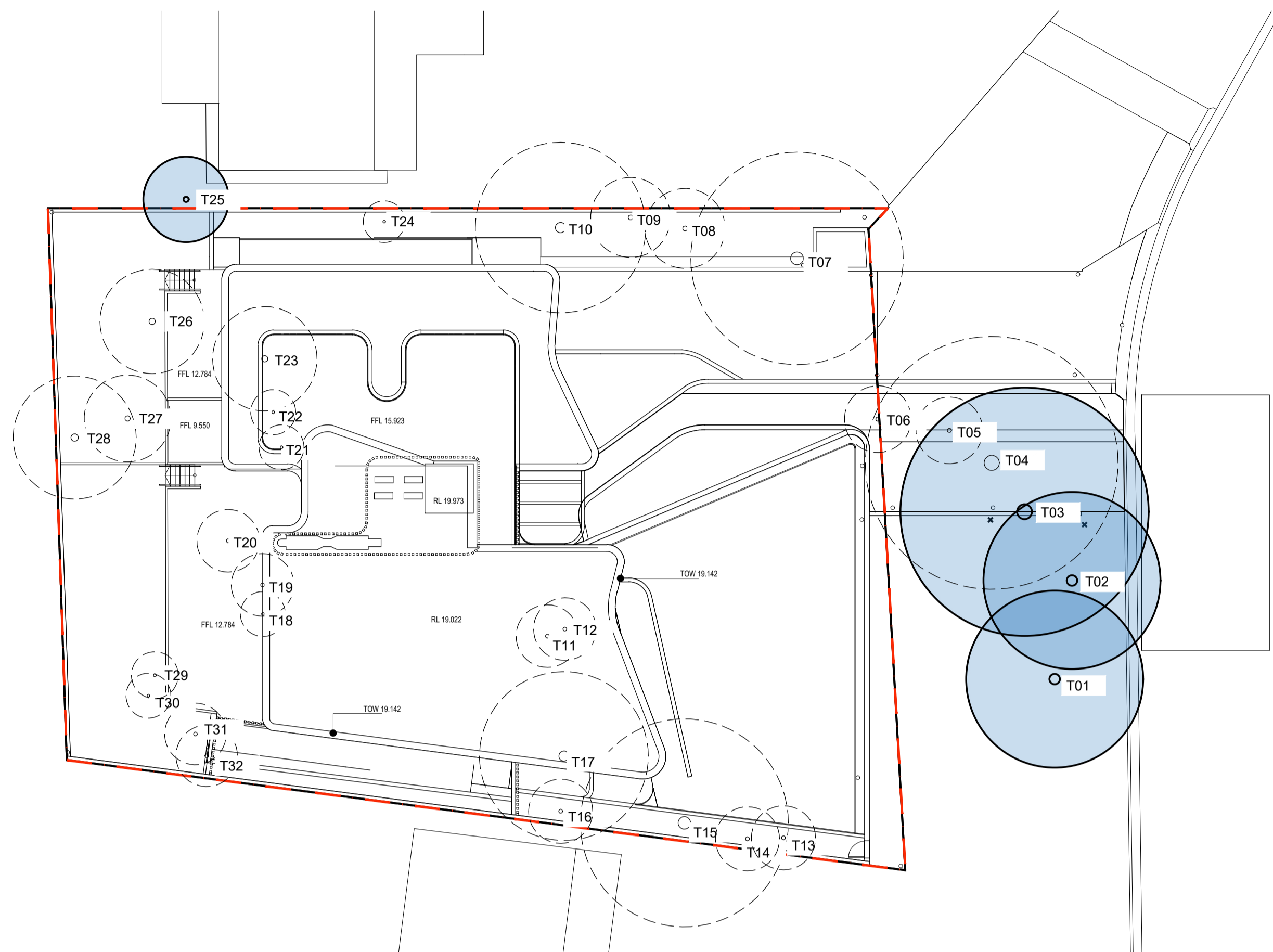

 Approved LEC Tree Removal  
1:200

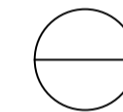
 S4.55 Plan - Current Tree Retention Plan  
1:200

LEC Approved Tree retention table		
Tree No.	Botanic Name	Size (H x W)
01	<i>Corymbia maculata</i>	9 x 9
02	<i>Corymbia maculata</i>	10 x 9
03	<i>Corymbia maculata</i>	26 x 18
25	<i>Phoenix canariensis</i>	5 x 5
Total Retained Trees: 4		

Current Retained Tree Information		
Tree No.	Botanic Name	Size (H x W)
01	<i>Corymbia maculata</i>	9 x 9
02	<i>Corymbia maculata</i>	10 x 9
25	<i>Phoenix canariensis</i>	5 x 5
Total Retained Trees: 3		

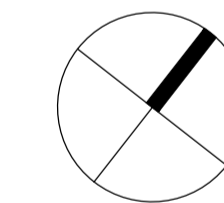

Client  
Cap One Developments Pty Ltd

Project  
1955 Pittwater Rd, Bayview

**SITE IMAGE**  
Level 1, 3-5 Baptist Street  
Redfern NSW 2016  
Australia  
Tel: (61 2) 8332 5600  
Fax: (61 2) 9698 2877  
www.siteimage.com.au  
Site Image (NSW) Pty Ltd  
ABN 44 801 262 380  
  
Landscape Architects

Section 4.55

Drawing Name  
Tree Retention Plan

Scale As Shown  
Job Number  
SS22-5004  
Drawing Number  
901  
Issue  
B