

DES 7.080 X

PROPOSED DESIGN SPOT LEVEL

EX 7.080 X

EXISTING SURFACE SPOT LEVEL
REFER SURVEY PLANS. TO BE
CONFIRMED PRIOR TO CONSTRUCTION.

CH 10.000

CHAINAGES

PROPOSED DRIVEWAY

1) PURSUANT TO THE SURVEYING AND SPATIAL INFORMATION ACT, ANY CADASTRAL REFERENCE MARKS, SURVEY PINS OR SSMs THAT ARE ON KERBS, FOOTPATHS OR SIMILAR THAT MAY BE AFFECTED BY CONSTRUCTION OR MAINTENANCE, NEED TO BE IDENTIFIED AND SURVEYED BY A REGISTERED LAND SURVEYOR BEFORE THEY ARE DESTROYED OR DISTURBED, PERSONAL FINES APPLY FOR BREACHES OF THE ACT.

1. FOR EXISTING CONTOURS AND LEVELS. REFER SURVEY PLAN. ALL LEVELS AND DIMENSIONS TO BE CONFIRMED PRIOR TO CONSTRUCTION.
2. PRIOR APPROVAL MAY BE REQUIRED WITH RELEVANT AUTHORITIES PRIOR TO RETAINING WALLS, SHORING, BATTERS & DRAINAGE IMPACTING NEIGHBORING PROPERTIES AND INFRASTRUCTURE BEYOND BOUNDARIES.
3. STORMWATER AND DRAINAGE BY OTHERS TO AS3500.
4. ALL BATTERS, RETAINING WALLS AND BULK EARTHWORKS TO FUTURE DETAILS BY OTHERS. ALL RETAINING WALLS GREATER THAN 900mm HIGH TO BE DESIGNED BY A QUALIFIED ENGINEER.
5. EXISTING DRAINAGE ACROSS NATURE STRIP & KERBS IMPACTING PROPOSED WORKS TO BE RELOCATED OR UPGRADED AS REQUIRED BY OTHERS IN AN APPROVED MANNER. REFER ARCHITECT FOR SPECIFICATIONS AND DETAILS.
6. NATURE STRIP PAVEMENT, GUTTER & FOOTWAY CROSSINGS TO COUNCIL SPECIFICATIONS.
7. CONCRETE DRIVEWAY & JOINTING PLAN BY OTHERS.
8. IMPACT OF PROPOSED WORKS ON EXISTING TREE/S. REFER ARCHITECT AND/OR ARBORIST REPORT FOR DETAILS AND SPECIFICATIONS.
9. PRIOR APPROVAL REQUIRED PRIOR TO REMOVAL OF EXISTING TREE/S REFER ARCHITECT AND/OR ARBORIST REPORT FOR SPECIFICATIONS & DETAILS.
10. CARPARKING REQUIREMENTS TO AS2890.1 BY OTHERS. REFER ARCHITECT FOR SPECIFICATIONS AND DETAILS.
11. MINIMUM DRIVEWAY WIDTHS, CLEARANCES, INCLUDING HEAD CLEARANCES TO COMPLY WITH AS2890.1 REFER ARCHITECT FOR SPECIFICATIONS & DETAILS.
12. TRAFFIC CONTROL SIGNAGE AND TRAFFIC CONTROL MEASURES BY OTHERS.
13. LINES AND MARKINGS BY OTHERS TO CONFORM TO MAIN ROADS MANUAL OF UNIFORM TRAFFIC CONTROL DEVICES.
14. REFER ARCHITECT FOR LATEST PLANS AND EXTENTS OF PROPOSED BUILDING WORKS & STRUCTURES. TO BE CONFIRMED PRIOR TO CONSTRUCTION.
15. COUNCIL APPROVAL MAY BE REQUIRED PRIOR TO COMMENCING CONSTRUCTION.
16. ANY VEHICLE PROFILE ANALYSIS SUCH AS THE B85 PROFILE IS NORMALLY UNDERTAKEN ALONG THE DETAILED LONGITUDINAL SECTIONS, WHICH HAVE GENERALLY BEEN LOCATED IN ACCORDANCE WITH COUNCIL POLICY. THIS MAY NOT NECESSARILY REPRESENT THE WORSE CASE ANALYSIS.
17. NO SWEPT PATH ANALYSIS HAS BEEN UNDERTAKEN AND/OR HAS BEEN PROVIDED FOR THIS DEVELOPMENT.
18. BARRIERS REQUIRED WHERE DRIVEWAY DROP EXCEEDS 600mm. WHEEL STOP REQUIRED WHERE DRIVEWAY DROP IS BETWEEN 150-600mm. REFER AS2890.1. REFER ARCHITECT & LANDSCAPE ARCHITECT FOR SPECIFICATIONS AND DETAILS.

 **DIAL 1100**
BEFORE YOU DIG

NO INVESTIGATION OF UNDERGROUND SERVICES
HAS BEEN MADE. ALL RELEVANT AUTHORITIES
SHOULD BE NOTIFIED PRIOR TO ANY
EXCAVATION ON OR NEAR THE SITE

DEVELOPERS & EXCAVATORS MAY BE HELD FINANCIALLY RESPONSIBLE BY THE ASSET OWNER SHOULD THEY DAMAGE UNDERGROUND NETWORKS.

CARELESS DIGGING CAN:

- CAUSE DEATH OR SERIOUS INJURY TO WORKERS AND THE GENERAL PUBLIC
- INCONVENIENCE USERS OF ELECTRICITY, GAS, WATER AND COMMUNICATIONS
- LEAD TO CRIMINAL PROSECUTION AND DAMAGES CLAIMS
- CAUSE EXPENSIVE FINANCIAL LOSSES TO BUSINESS
- CUT OFF EMERGENCY SERVICES
- DELAY PROJECT COMPLETION TIMES WHILE THE DAMAGE IS REPAIRED

MINIMISE YOUR RISK AND DIAL
BEFORE YOU DIG. - TEL. 1100

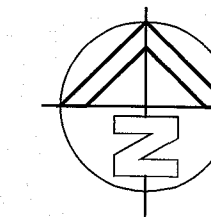

1. ALL DIMENSIONS TO BE VERIFIED
ON SITE BY BUILDER BEFORE
COMMENCING WITH WORK.

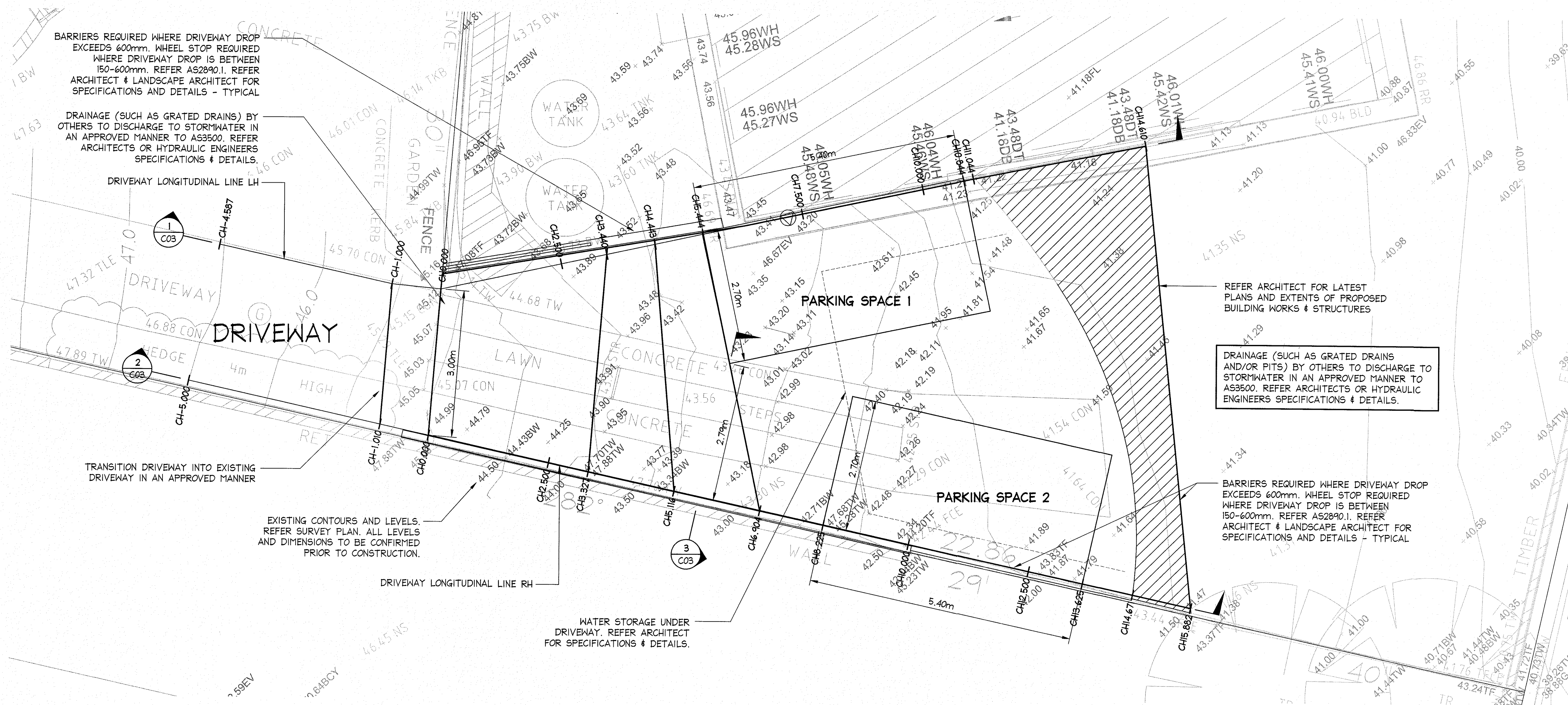

SCALE = 1 : 50

PRELIMINARY ONLY
NOT FOR
CONSTRUCTION
ISSUED FOR INFORMATION

IF IN DOUBT ASK

A1												CONSTRUCTION ISSUED FOR INFORMATION		IF IN DOUBT ASK											
												DOCUMENT CERTIFICATION		NB Consulting Engineers STRUCTURAL - CIVIL - STORMWATER - REMEDIAL A.C.N. 078 121 616 A.B.N. 24 078 121 616 Sydney: Ph: (02) 9984 7000 Fax: (02) 9984 7444 Suite 207, 30 Fisher Road Dee Why N.S.W. 2099 Gold Coast: Ph: (07) 5631 4744 Unit 8, 1728 Gold Coast Highway Burleigh Heads QLD 4220 E: nb@nbconsulting.com.au W: www.nbconsulting.com.au		Architect:		Project:		Date:		Design:		Drawn:	
03/10/2019		B		REVISED PLANS		D.K.		M.K.		Date: 3/10/19 Rick G Wray per [Signature] BE(Civil), CPENG, MIEAust, NER, RPEQ: 08293 (Director NB Consulting Engineers) The copyright of this drawing remains with Northern Beaches Consulting Engineers Pty Ltd. Trading as NB Consulting Engineers								PROPOSED DRIVEWAY AT 1 BEACH ROAD, NEWPORT		MAY 2019		D.K.		D.K.	
01/05/2019		A		PRELIMINARY ONLY - NOT FOR CONSTRUCTION - FOR INFORMATION PURPOSES ONLY		D.K.		M.K.						Client:		Drawing Title:		Job No:		Drawing No:		Issued:			
Date:		Issue:		Description:		By:		Review:						DAVID KRAJANCIC		CIVIL ACCESS PLANS		180960		C01		E			

B Consulting Engineers

1. ALL DIMENSIONS TO BE VERIFIED ON SITE BY BUILDER BEFORE COMMENCING WITH WORK.
2. FOR GENERAL NOTES REFER TO DRAWING NUMBER: COI.



PROPOSED CONTOUR LEVELS ARE
INDICATIVE ONLY. ALL LEVELS TO
BE CONFIRMED PRIOR TO
CONSTRUCTION. DO NOT SCALE.

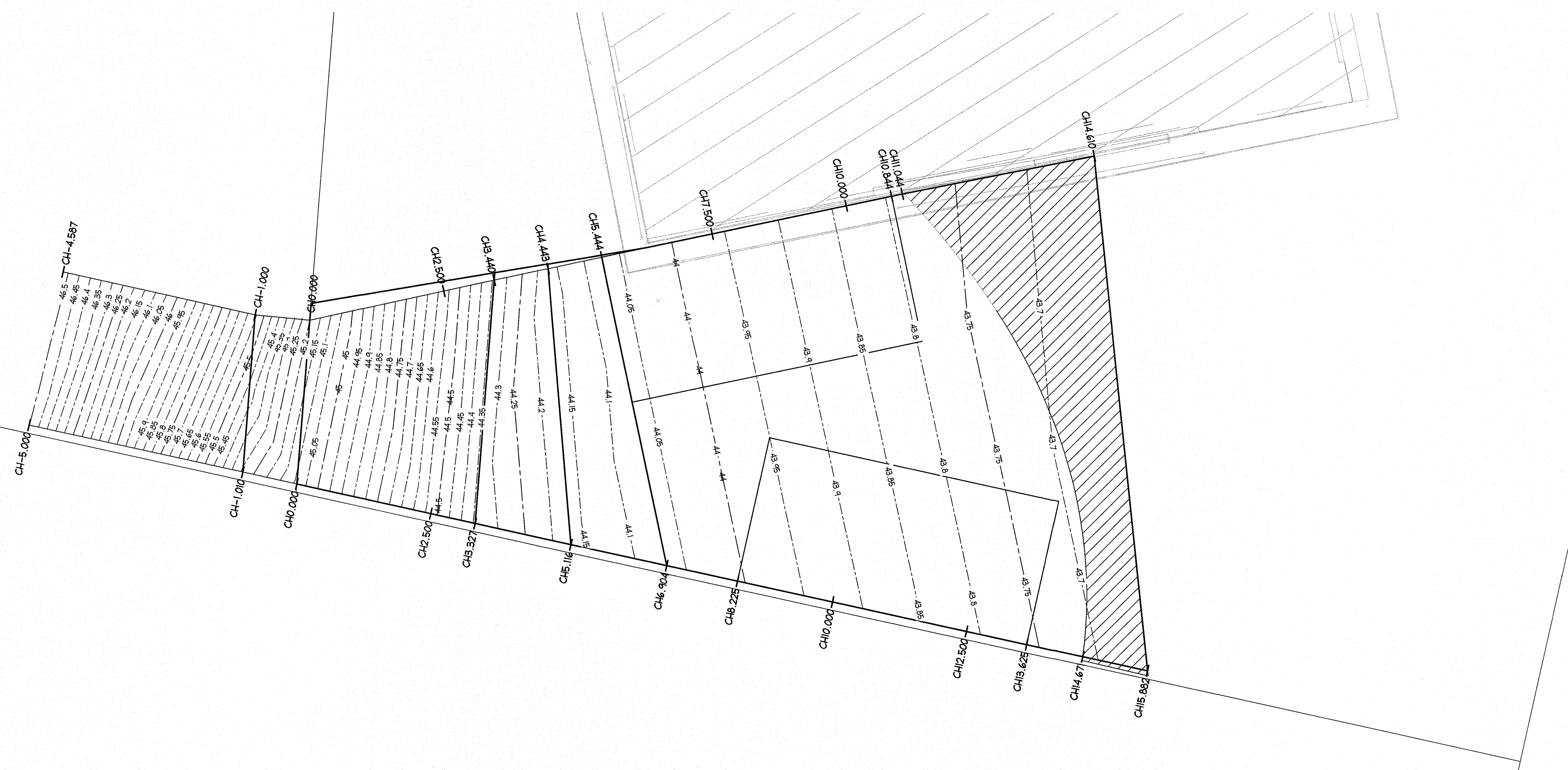
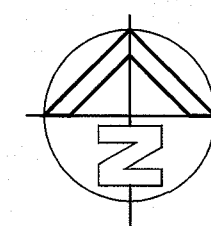

PROPOSED CONTOUR & SPOT LEVELS LAYOUT PLAN (APPROXIMATE)

NOT TO SCALE

PRELIMINARY ONLY
NOT FOR
CONSTRUCTION
ISSUED FOR INFORMATION

IF IN DOUBT ASK

[illegible]

VB Consulting Engineers

B85 PROFILE:

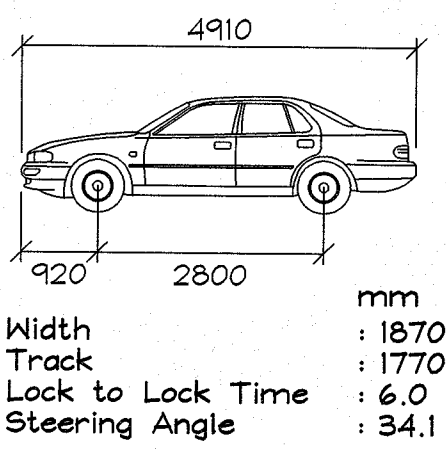

NOTES:

1. ALL DIMENSIONS TO BE VERIFIED ON SITE BY BUILDER BEFORE COMMENCING WITH WORK.
2. FOR GENERAL NOTES REFER TO DRAWING NUMBER: C01.

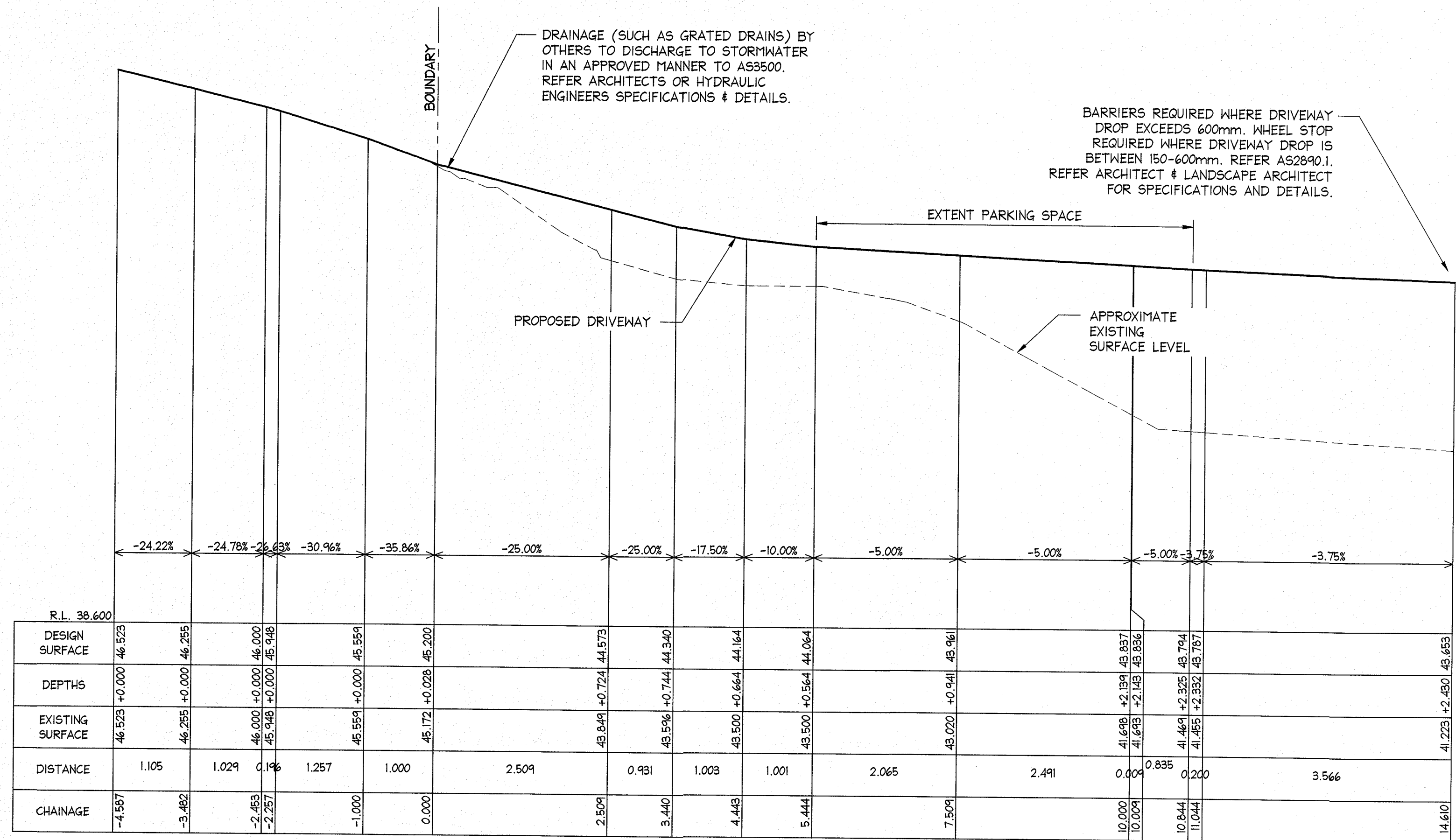

LONGITUDINAL SECTION DRIVEWAY LH
FROM CH: -4.587 TO CH: 14.610
SCALES: HORIZONTAL 1:50 VERTICAL 1:50
SECTION 1 C01

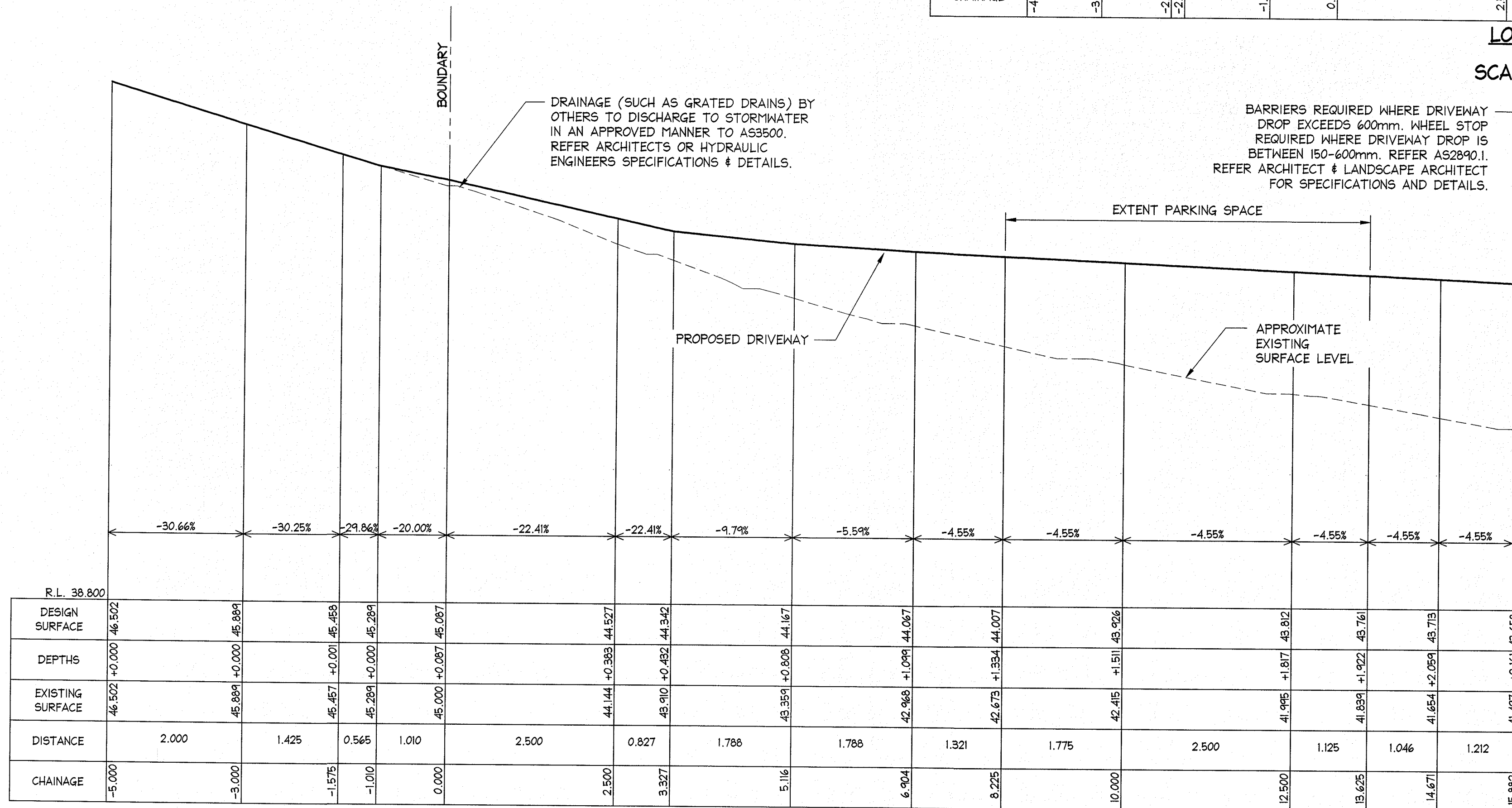

LONGITUDINAL SECTION DRIVEWAY RH
FROM CH: -5.000 TO CH: 15.882
SCALES: HORIZONTAL 1:50 VERTICAL 1:50
SECTION 2 C01

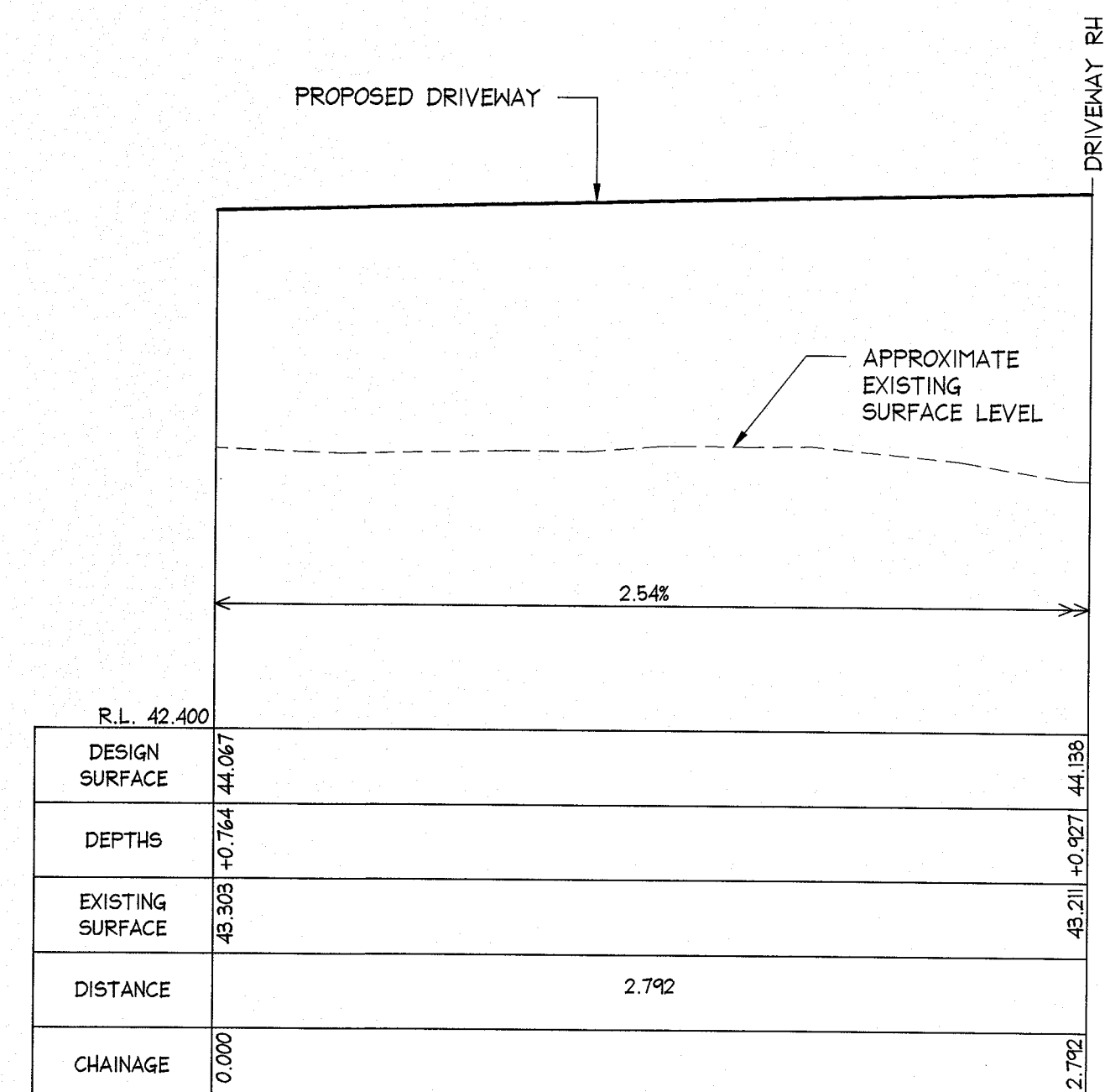

LONGITUDINAL CROSS SECTION
SCALES: HORIZONTAL 1:20 VERTICAL 1:20
SECTION 3 C01

PRELIMINARY ONLY
NOT FOR
CONSTRUCTION
ISSUED FOR INFORMATION

IF IN DOUBT ASK

AI

Date:	Issue:	Description:
03/10/2019	B	REVISED PLANS
01/05/2019	A	PRELIMINARY ONLY - NOT FOR CONSTRUCTION - FOR INFORMATION PURPOSES ONLY

DOCUMENT CERTIFICATION	
Date:	3/10/19
By:	Rick G Wray
Review:	D.K. M.W.

NB Consulting Engineers
STRUCTURAL - CIVIL - STORMWATER - REMEDIAL
A.C.N. 076 121 616 A.B.N. 24 076 121 616
Sydney: Ph: (02) 9984 7000 Fax: (02) 9984 7444
Suite 207, 30 Fisher Road Dee Why N.S.W. 2099
Gold Coast: Ph: (07) 5631 4744
Unit 5, 1726 Gold Coast Highway Burleigh Heads QLD 4220
E: nb@nbconsulting.com.au W: www.nbconsulting.com.au

Architect:
Client:
DAVID KRAJANCIC

Project:
PROPOSED DRIVEWAY
AT 1 BEACH ROAD, NEWPORT
Drawing Title:
LONGITUDINAL SECTIONS - SHEET 1

Date:	Design:	Drawn:
MAY 2019	D.K.	D.K.
Job No:	Drawing No:	Issue:
180960	C03	B

NB Consulting Engineers

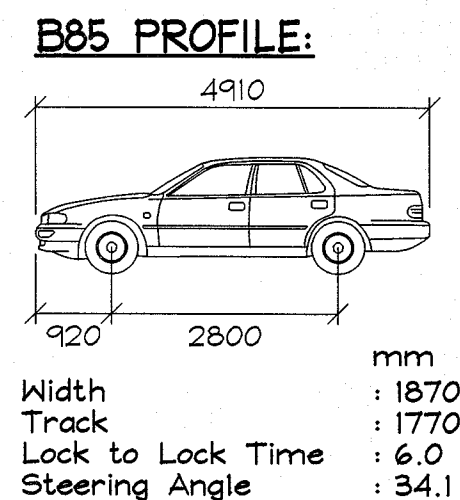

- NOTES:**
1. ALL DIMENSIONS TO BE VERIFIED ON SITE BY BUILDER BEFORE COMMENCING WITH WORK.
 2. FOR GENERAL NOTES REFER TO DRAWING NUMBER: C01.

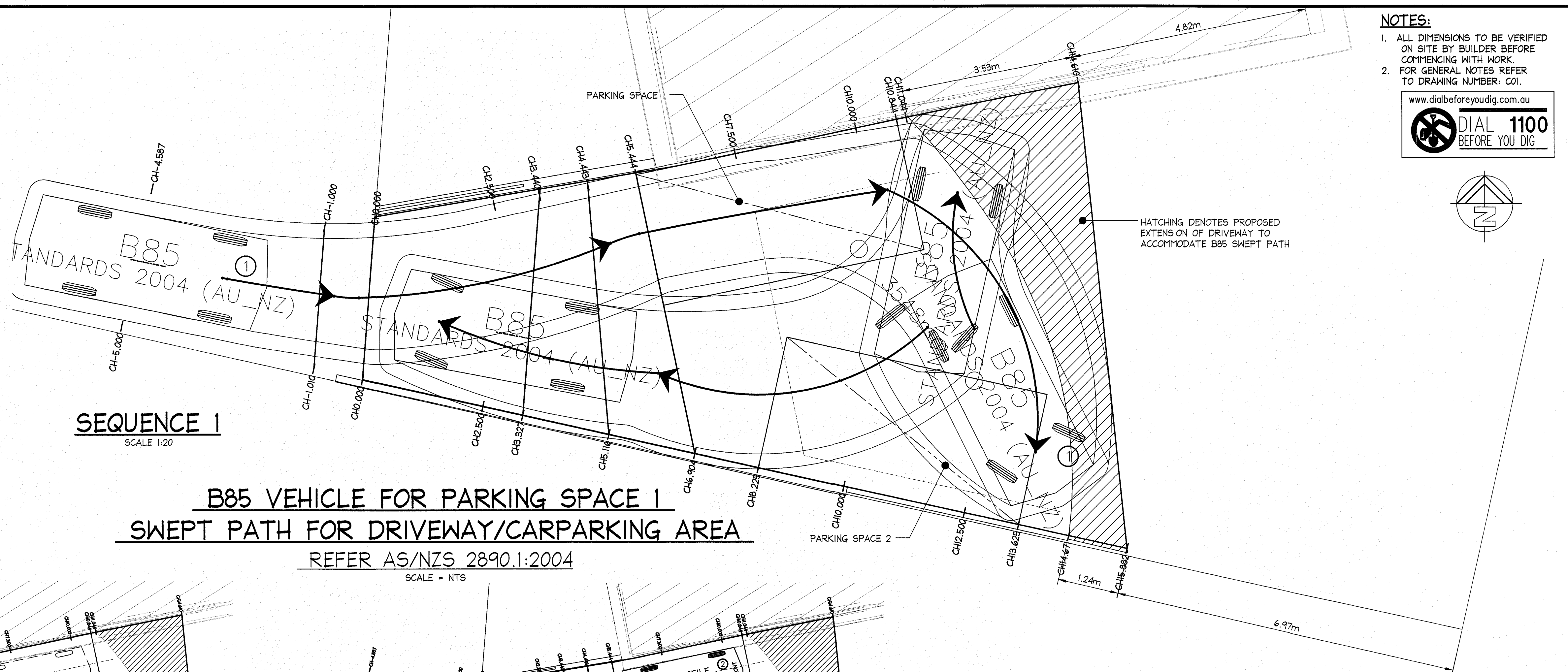
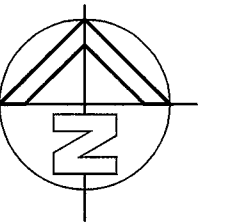

SEQUENCE 1
SCALE 1:20

**B85 VEHICLE FOR PARKING SPACE 1
SWEEP PATH FOR DRIVEWAY/CARPARKING AREA**
REFER AS/NZS 2890.1:2004
SCALE = NTS

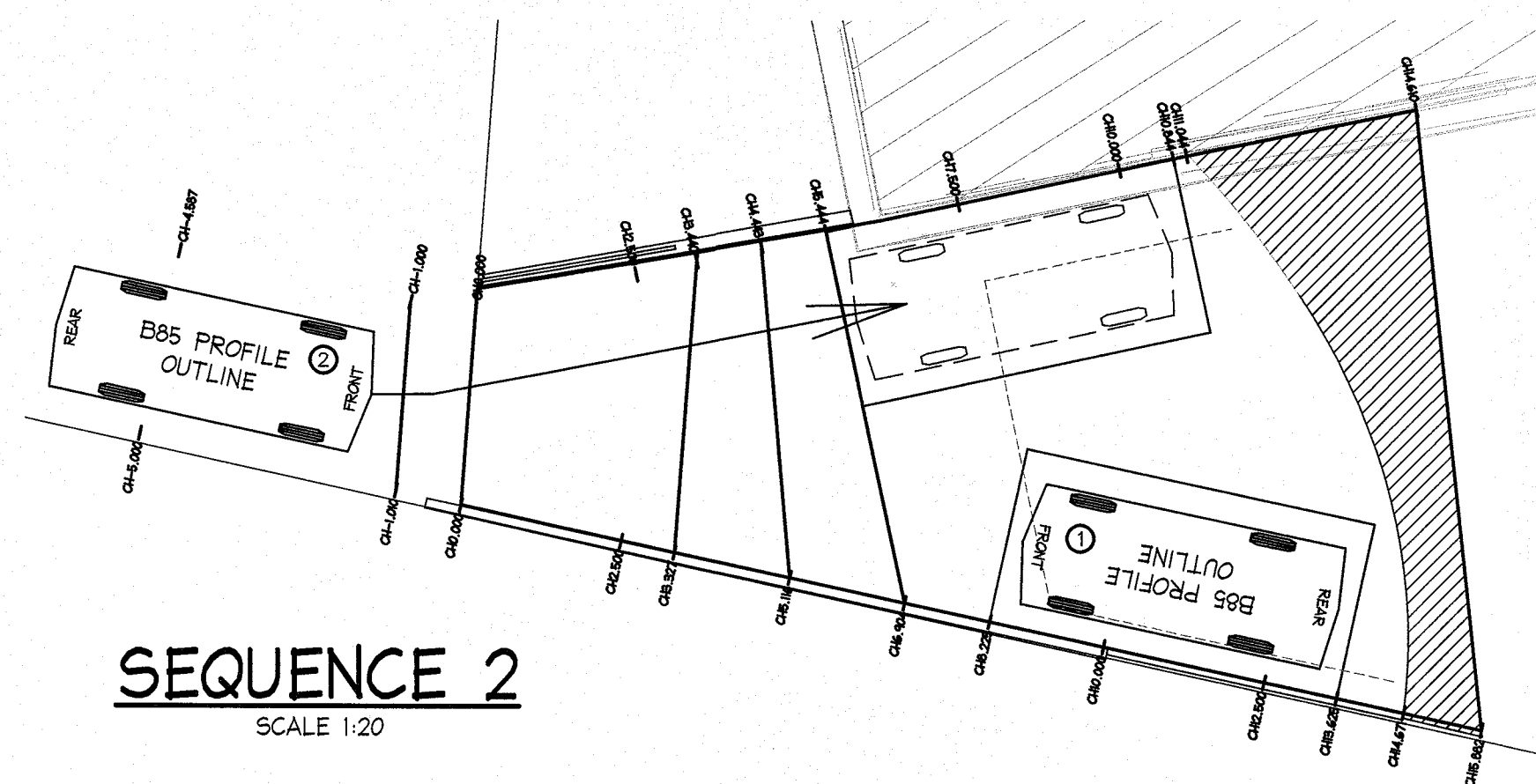

SEQUENCE 2
SCALE 1:20

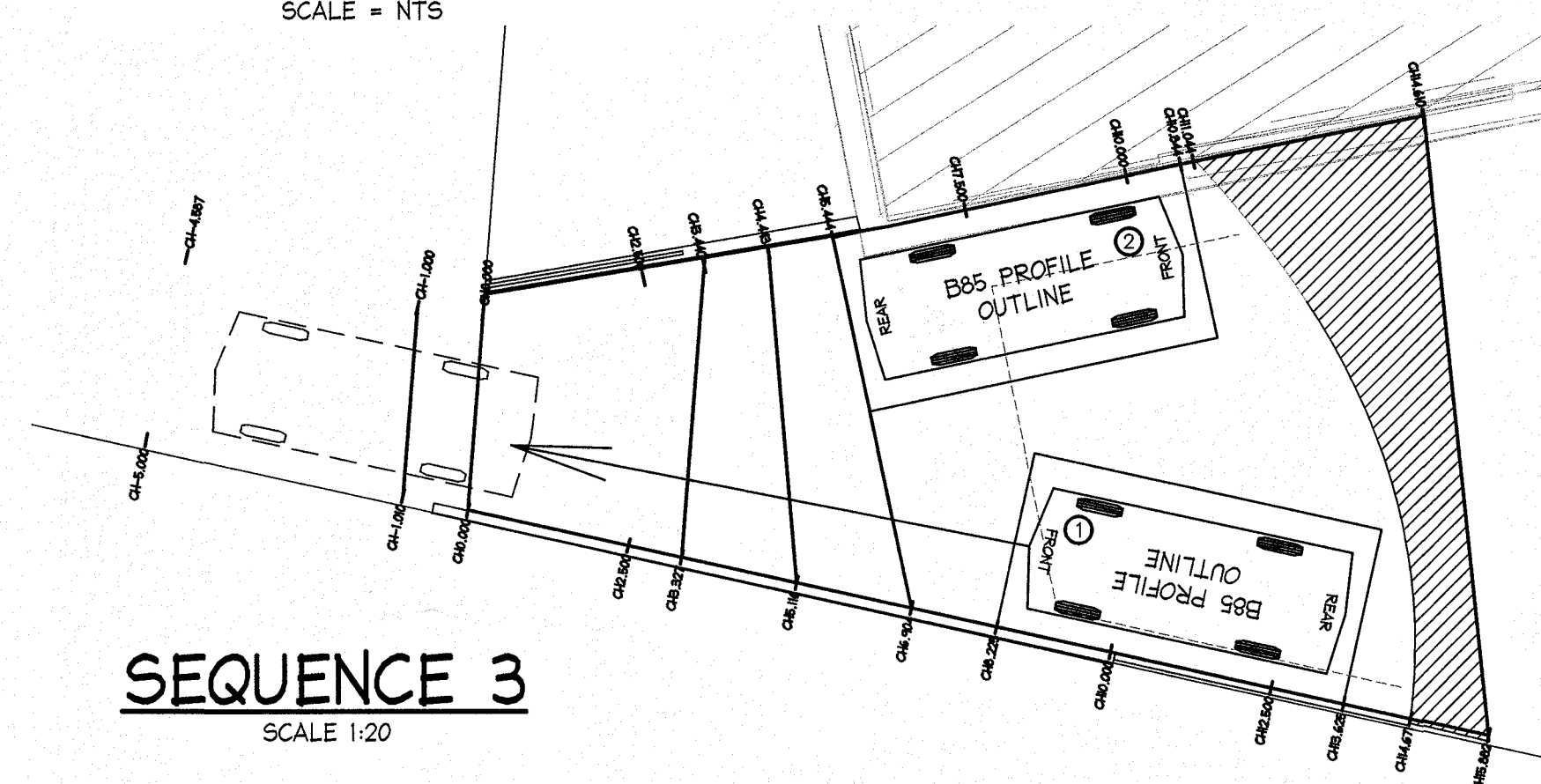

SEQUENCE 3
SCALE 1:20

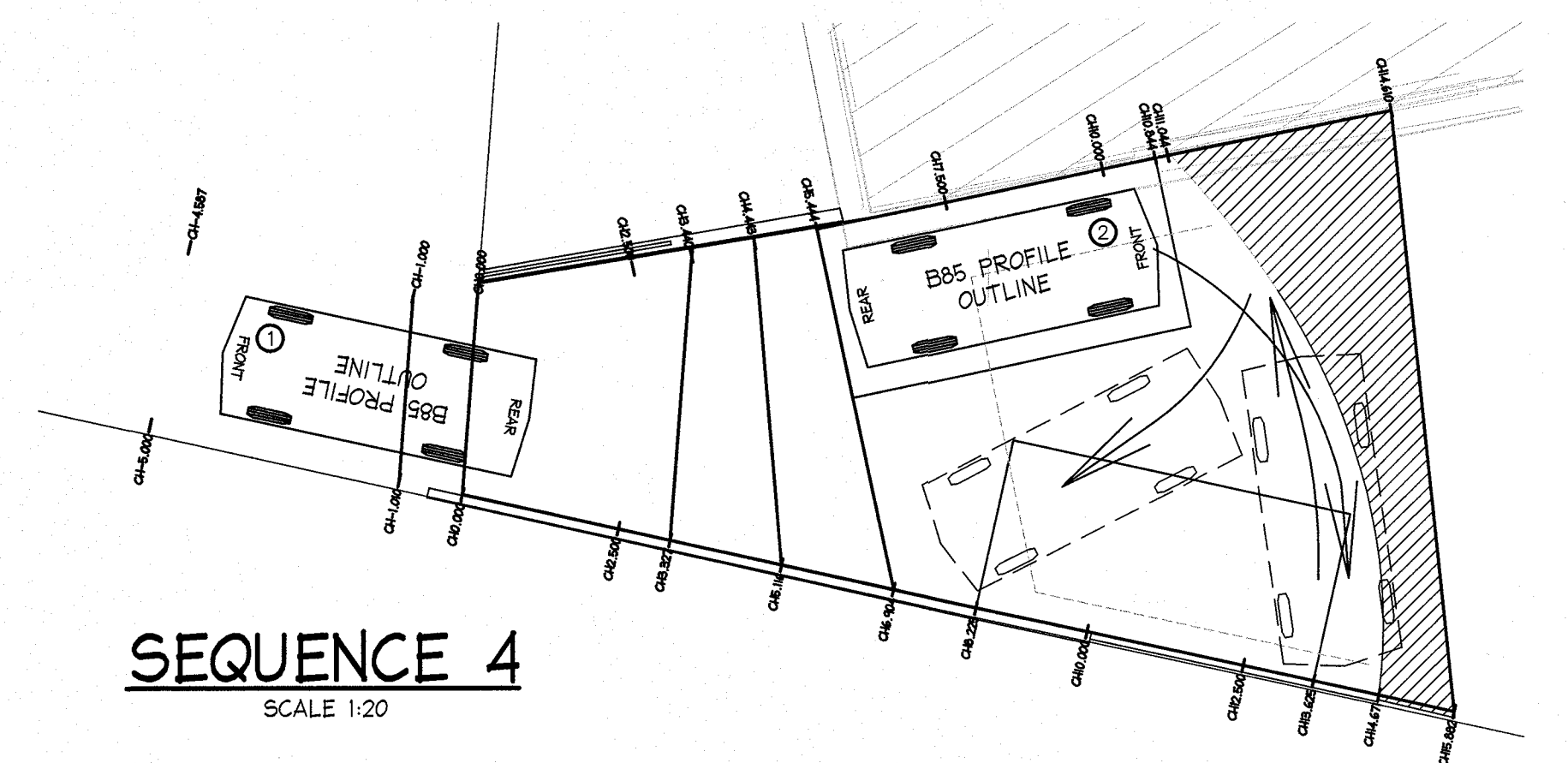

SEQUENCE 4
SCALE 1:20

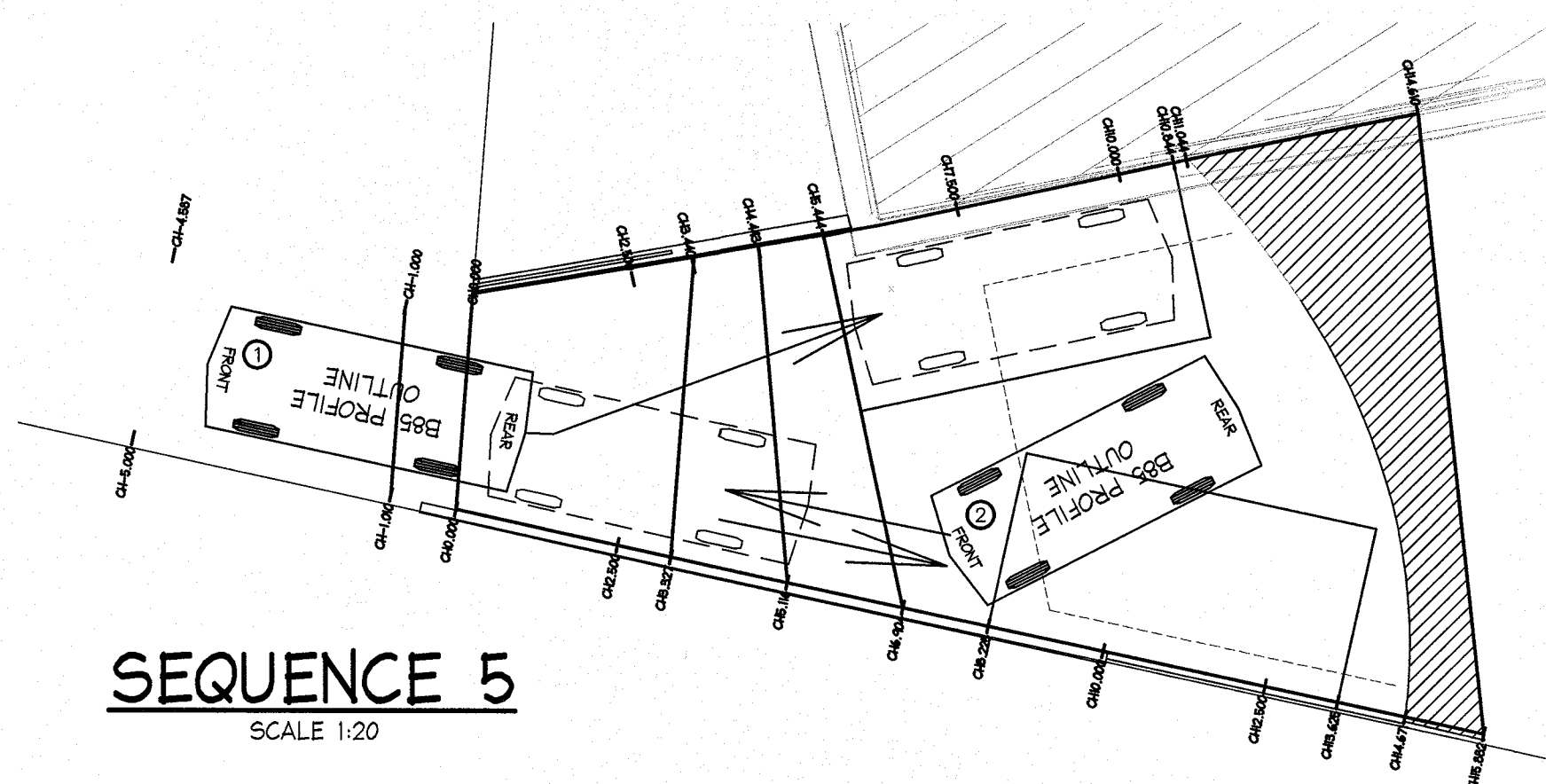

SEQUENCE 5
SCALE 1:20

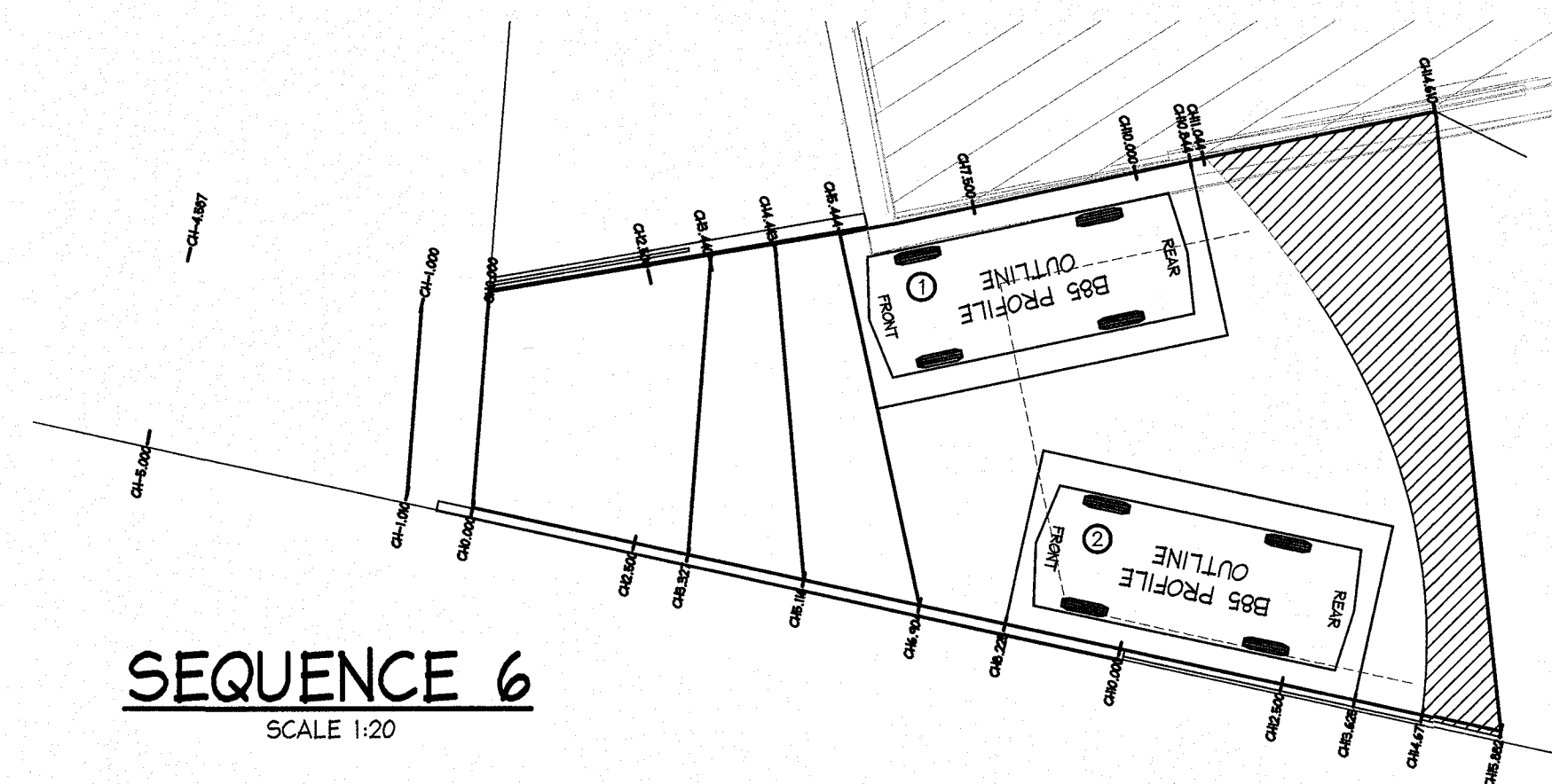

SEQUENCE 6
SCALE 1:20

PRELIMINARY ONLY
NOT FOR
CONSTRUCTION
ISSUED FOR INFORMATION

IF IN DOUBT ASK

A1			DOCUMENT CERTIFICATION			NB Consulting Engineers			Architect:			Project:			Date:			Design:			Drawn:					
			3/10/17 per Rick G Wray			STRUCTURAL - CIVIL - STORMWATER - REMEDIAL A.C.N. 076 121 616 A.B.N. 24 076 121 616						PROPOSED DRIVEWAY AT 1 BEACH ROAD, NEWPORT			MAY 2019			D.K.			D.K.					
			BE(Civil), CPEng, MIEAust., NER., RPEQ: 08293. (Director NB Consulting Engineers)			Sydney: Ph: (02) 9984 7000 Fax: (02) 9984 7444 Suite 207, 30 Fisher Road Dee Why N.S.W. 2099 Gold Coast: Ph: (07) 5631 4744 Unit 8, 1726 Gold Coast Highway Burleigh Heads QLD 4220 E: nb@nbconsulting.com.au W: www.nbconsulting.com.au																				
25/09/2019			A			PRELIMINARY ONLY - NOT FOR CONSTRUCTION - FOR INFORMATION PURPOSES ONLY			D.K.			M.M.														
Date:			Issue:			Description:			By:			Review:														
						The copyright of this drawing remains with Northern Beaches Consulting Engineers Pty Ltd. Trading as NB Consulting Engineers																				
												DAVID KRAJANCIC			B85 SWEPT PATH ANALYSIS			Job No: 180960			Drawing No: C04			Issue: A		