

SITE PLAN

Scale: 1:1000

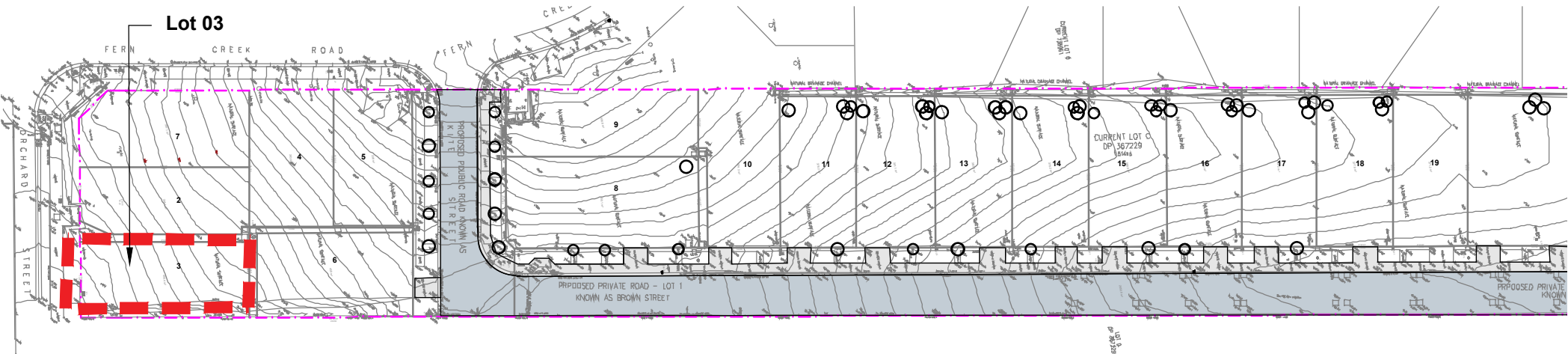

TREE SURVEY

Existing Trees based on Arborists Report by Bryce Claassens and Alex Kurath prepared on 20 September 2022

No.#	Species	Size (Ht x Sp)	Condition	Action
1	Eucalyptus spp	5x2	Good	Retain and protect
2	Eucalyptus spp	5x2	Good	Transplant
3	Syncarpia glomulifera	13x6	Fair	Remove
4	Eucalyptus haemastoma	7x8	Good	Retain and protect
5	Angophora costata	17x12	Fair	Remove

HARDSCAPE PLAN

Scale: 1:150

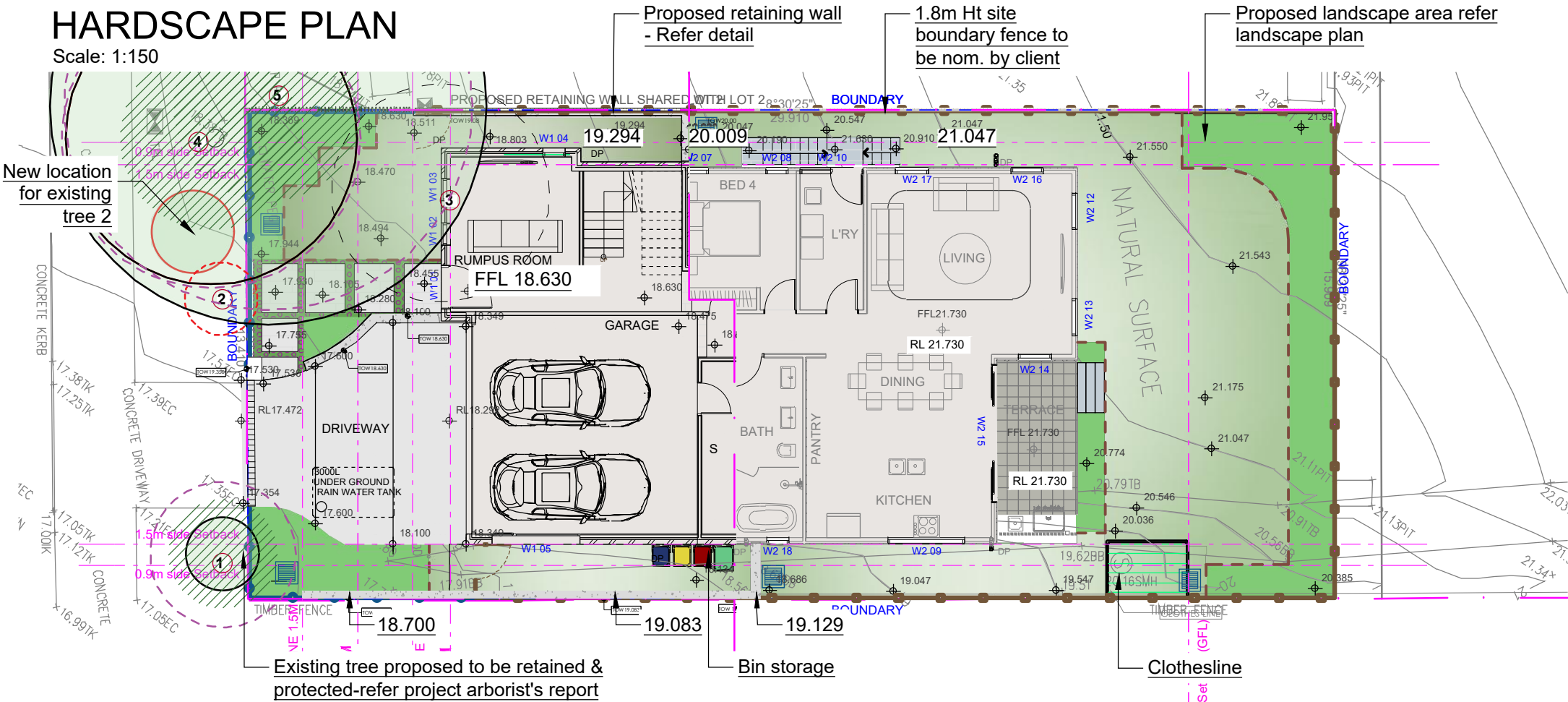

DRAWING SCHEDULE

SHEET #	DRAWING TITLE	REV.
/1	HARDSCAPE PLAN	C
/2	LANDSCAPE PLAN	C
/3	DETAILS	C
/4	SPECIFICATION	C

OTHER LANDSCAPE ITEMS

- 1.8m Gate and fence - colour and style to be nom. by client
- Front fence - colour and style to be nom. by client
- Brick Edging - refer detail
- Garden bed - refer landscape design plan
- Turf area - refer detail
- Stepping stones in groundcovers - refer detail
- Retaining / raised planter wall - refer detail
- Trees proposed to be removed and replaced with new landscaping
- Existing trees proposed to be retained and protected
- Trees Protection zone-refer project arborist's report
- Structural root zone-refer project arborist's report
- Existing tree to be transplanted
- New location of transplanted tree

LANDSCAPE CALCULATIONS

SITE AREA:	400m <sup>2</sup>
REQUIRED LANDSCAPE AREA:	140m <sup>2</sup> (35%)
PROPOSED LANDSCAPE AREA:	140m <sup>2</sup> (35%)
(COMPLIANT)	

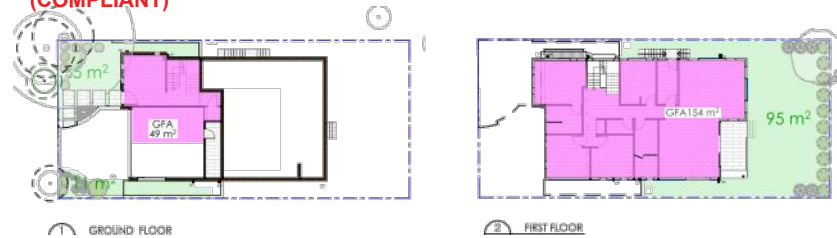

General Notes:  
Figured dimensions take preference to scale readings. Verify all dimensions on site. PDF'd plans may vary slightly in scale for that indicated on plans. Report any discrepancies to the Landscape Architect before proceeding with the work.  
Copyright Sulphurcrest Enterprises Pty Ltd Trading as CONZEPT  
(ABN: 75 623 405 630)  
This drawing is protected by copyright. All rights are reserved. Unless permitted under the Copyright Act 1968, no part of this drawing may in any form or by any means be reproduced, published, broadcast or transmitted without the prior written permission of the copyright owner.  
If the State of this drawing is not signed off For Construction it may be subject to change, alteration or amendment at the discretion of our office. If so, Concept is not liable for any loss, damage, harm or injury whether special, consequential, direct or indirect, suffered by you or any other person as a result of your use of this drawing for construction purposes.  
These plans and associated IP remain the property of Sulphurcrest Enterprises (T/A Concept) until such time as all agreed payments are made in full. We retain the right to withdraw this information from the assessment process if such payments are not made following the notification period.

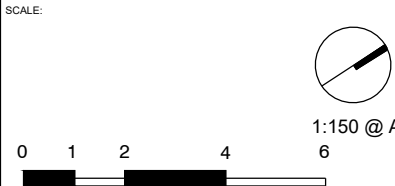

REV	DATE	NOTATION/AMENDMENT
A	26.09.2022	Preliminary plan prepared for review
B	04.10.2022	Co-ordinated with client's comments
C	13.06.2023	Co-ordinated with Architecture's updated

COUNCIL	NORTHERN BEACHES
CLIENT	SKYCORP AUSTRALIA
ARCHITECT	PTI ARCHITECTURE
STATUS / ISSUE	DA - ISSUE C



TITLE:	SITE PLAN & HARDSCAPE PLAN
PROPOSED RESIDENTIAL DEVELOPMENT LOT 3, 6 ORCHARD STREET, WARRIEWOOD	

DWG.No:	LPDA 22 - 324 /1
DATE:	JUNE 2023
DRAWN:	K.Z/J.G
CHECKED:	R.F



LEGEND & SCHEDULE

NOTES:  
1. ALL FINAL PLANT QUANTITIES INDICATED ON PLANS SHALL BE CHECKED AND VERIFIED BY SUCCESSFUL LANDSCAPE CONTRACTOR.  
2. ANY PLANT SUBSTITUTES REQUIRED DUE TO UNAVAILABILITY SHALL BE RECOMMENDED BY THE LANDSCAPE CONTRACTOR TO BEST MATCH SUBSTITUTED PLANTS AND APPROVED PRIOR TO PURCHASING BY THE LANDSCAPE ARCHITECT.  
3. WORKS CERTIFIED FOR FINAL OCCUPANCY CERTIFICATE ARE TO MATCH APPROVED LANDSCAPE PLANS.  
4. LANDSCAPE CONTRACTOR SHALL LOCATE AND AVOID SITE STORM WATER DRAINAGE SERVICES. LOCATE TREES A MINIMUM 1.25M FROM PITS.  
5. ALL PLANTING AROUND EXISTING TREES SHALL BE ADJUSTED TO AVOID DAMAGE AND CLASHING WITH SURFACE ROOTS.  
6. THE NATURE STRIP (STREET FRONTAGE) FOR THE SITE IS PUBLIC LAND AND ONLY AUTHORIZED WORKS MAY OCCUR HERE. EXISTING CONDITIONS SUCH AS STREET TREES, COUNCIL PLANTING ETC SHALL BE RETAINED AND PROTECTED DURING CONSTRUCTION, UNLESS SPECIFIC APPROVAL HAS BEEN GRANTED FOR NEW WORK IN THIS AREA.

TREES

**Botanical Name:** *Waterhouseia floribunda*  
**Common Name:** Weeping Lilly Pilly (Native)  
**Pot size:** 75LT  
**Mature H x S:** 10m x 6m  
**Qty Required:** 1

**Botanical Name:** *Elaeocarpus reticulatus*  
**Common Name:** Blueberry Ash (Native)  
**Pot size:** 75LT  
**Mature H x S:** 8-10m x 6-7m  
**Qty Required:** 2

SHRUBS AND HEDGES

**Botanical Name:** *Syzygium 'Tiny Trev'*  
**Common Name:** Dwarf Lilly Pilly (Native)  
**Pot size:** 200mm  
**Mature H x S:** 1m x 1m  
**Qty Required:** 9

**Botanical Name:** *Syzygium 'Cascade'*  
**Common Name:** Cascade Lilly Pilly (Native)  
**Pot size:** 200mm  
**Mature H x S:** 2.5m x 1.8m  
**Qty Required:** 7

**Botanical Name:** *Syzygium 'Resilience'*  
**Common Name:** Resilience Lilly Pilly (Native)  
**Pot size:** 200mm  
**Mature H x S:** 3m x 2m  
**Qty Required:** 10

ACCENT PLANTS

**Botanical Name:** *Doryanthes excelsa*  
**Common Name:** Gynea Lily (Native)  
**Pot size:** 300mm  
**Mature H x S:** 1.1m x 1m  
**Qty Required:** 2

GRASSES / GROUNDCOVERS

**Botanical Name:** *Dianella 'Little Jess'*  
**Common Name:** Little Jess Flax Lily (Native)  
**Pot size:** 140mm  
**Mature H x S:** 0.4m x 0.4m  
**Qty Required:** 37

**Botanical Name:** *Hibertia scandens*  
**Common Name:** Snake Vine (Native)  
**Pot size:** 200mm  
**Mature H x S:** 0.3m x spreading  
**Qty Required:** 5/m2 (3.8m2 total)

**Botanical Name:** *Viola hederacea*  
**Common Name:** Native Violet (Native)  
**Pot size:** 140mm  
**Mature H x S:** 0.2m x spreading  
**Qty Required:** 9/m2 (9.9m2 total)

SAMPLE IMAGES

Images are diagrammatic only, and final planting species may vary, as determined by Council Approval



Waterhouseia floribunda



Elaeocarpus reticulatus



Syzygium 'Resilience'



Syzygium 'Cascade'



Doryanthes excelsa



Syzygium 'Tiny Trev'



Hibertia scandens



Viola hederacea

Planting to front setback to include:

- 7 S. 'Tiny Trev'
- 1 Elaeocarpus
- 1 Doryanthes
- 7 Dianella

Planting to rear boundary to include:

- 1 Waterhouseia
- 5 S. 'Cascade'
- 10 S. 'Resilience'
- 9 Dianella

Stepping stones in groundcover to include:

- 9.9m2 Viola

Groundcover along alfresco to include:

- 16 Dianella

LANDSCAPE PLAN NOTES

This plan should be read in conjunction with the architectural and hydraulics plans. Work specific to these plans should be prepared in accordance to these plans, including specification and details prior to the installation of landscaping, and should not be altered or compromised during landscape construction. Elements such as drainage swales may be incorporated in garden bed areas (using non-floatable mulch) without compromising the capacity or form.

**This plan has been prepared for Development Application approval only, not for construction.**

This plan has been prepared with reference to **Northern Beaches council** Landscaping Guidelines & requirements. Planting proposed using mainly indigenous, commercially available plant species selected from local planting lists and the BASIX local plant list and from Sydney

Waters "Plant Selector"web site one-drip rated native plants (**acceptable for BASIX planting**).

The Design & location of new letter boxes shall be in accordance with Australia Post's "Requirements for Delivery of Mail to Residential Premises" published Feb '97. All noxious weeds listed in Councils weed lists & located on the site shall be continually removed & suppressed. Reinstate all boundary fencing in poor condition with Council approved 1.8m fencing to rear of building line, rake to 1m forward of BL. Pollution, sediment & erosion control devices as specified shall be in place, and maintained for the duration of the construction period. Proposed excavation near existing established trees to be supervised by arborist.

**DA** approved landscape plan's are required to be constructed as approved to obtain occupancy certificate. **Permeable areas may be indicated to achieve site coverage restrictions & should be constructed as drawn on this plan.**

DRAINAGE PITS AND DRAINAGE LINES SHOULD BE LOCATED WITHIN GARDEN AREAS TO ALLOW FOR SITE DRAINAGE WHILE MINIMISING IMPACT ON THE PROPOSED PLANTING SCHEME. WHERE POSSIBLE, PITS AND LINEWORK SHOULD BE LOCATED AT THE EDGE OF LANDSCAPE STRIPS TO AVOID PRECLUDING PLANTING CENTRALLY IN GARDEN AREAS. WHERE PITS AND LINEWORK OCCUR WITHIN GARDEN BEDS, THE LANDSCAPE CONTRACTOR SHALL TAKE ALL PRECAUTIONS TO AVOID DAMAGING STORM WATER WHEN PLANTING SHRUBS AND TREES. LANDSCAPE CONTRACTORS SHALL NOT ALTER THE FORM OF SWALES DESIGNED TO DIRECT OVERLAND FLOW.

PROPOSED LAWN OR LAWN SUBSTITUTES ALONG SIDE PASSAGE FOR COUNCIL LANDSCAPE COMPLIANCE PURPOSE.

General Notes:  
Figured dimensions take preference to scale readings. Verify all dimensions on site. PDF'd plans may vary slightly in scale for that indicated on plans. Report any discrepancies to the Landscape Architect before proceeding with the work.  
Copyright Sulphurest Enterprises Pty Ltd Trading as CONCEPT  
(ABN: 75 623 405 630)  
This drawing is protected by copyright. All rights are reserved. Unless permitted under the Copyright Act 1968, no part of this drawing may in any form or by any means be reproduced, published, broadcast or transmitted without the prior written permission of the copyright owner.  
If the Status of this drawing is not signed off For Construction it may be subject to change, alteration or amendment at the discretion of our office. If so, Concept is not liable for any loss, damage, harm or injury whether special, consequential, direct or indirect, suffered by you or any other person as a result of your use of this drawing for construction purposes.  
These plans and associated IP remain the property of Sulphurest Enterprises (EIA Concept) until such time as all agreed payments are made in full. We retain the right to withdraw this information from the assessment process if such payments are not made following the notification period.

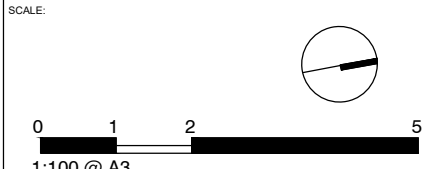

REV	DATE	NOTATION/AMENDMENT
A	26.09.2022	Preliminary plan prepared for review
B	04.10.2022	Co-ordinated with client's comments
C	13.06.2023	Co-ordinated with Architecture's updated

COUNCIL	NORTHERN BEACHES
CLIENT	SKYCORP AUSTRALIA
ARCHITECT	PTI ARCHITECTURE
STATUS / ISSUE	DA - ISSUE C



TITLE: <b>LANDSCAPE PLAN</b>		DWG.No: LPDA 22 - 324/2
PROPOSED RESIDENTIAL DEVELOPMENT <b>LOT 3, 6 ORCHARD STREET, WARRIEWOOD</b>		DATE: JUNE 2023
DRAWN: K.Z/J.G	CHECKED: R.F	





LANDSCAPE WORK SPECIFICATION

PRELIMINARIES

1.01 GENERAL

- The following general conditions should be considered prior to the commencement of landscape works:
- The landscape plans should be read in conjunction with the architectural plans, hydraulic plans, service plans and survey prepared for the proposed development.
  - All services including existing drainage should be accurately located prior to the commencement of landscape installation. Any proposed tree planting which falls close to services will be relocated on site under the instruction of the landscape architect.
  - Installation of conduit for required irrigation, electrical and other services shall be completed prior to the commencement of hardscape works and handstand pours.
  - All outdoor lighting specified by architect or client to be installed by qualified electrician
  - Anomalies that occur in these plans should be brought to our immediate attention.
  - Where an Australian Standard applies for any landscape material testing or installation technique, that standard shall be followed.

1.02 PROTECTION OF ADJACENT FINISHES

The Contractor shall take all precautions to prevent damage to all or any adjacent finishes by providing adequate protection to these areas / surfaces prior to the commencement of the Works

1.03 PROTECTION OF EXISTING TREES

Existing trees identified to be retained shall be done so in accordance with AS 4970-2009 Protection of trees on development sites as well as in accordance with the tree protection measures prepared by project arborist.

Where general works are occurring around such trees, or pruning is required, a qualified Arborist shall be engaged to oversee such works and manage tree health.  
Existing trees designated on the drawing for retention shall be protected at all times during the construction period. Any soil within the drip-line of existing trees shall be excavated and removed by hand only. No stockpiling shall occur within the root zone of existing trees to be retained.

Any roots larger in diameter than 50mm shall only be severed under instruction by a qualified arborist. Roots smaller than 50mm diameter shall be cut cleanly with a saw.

Temporary fencing shall be installed around the base of all trees to be retained prior to the commencement of landscape works. Where possible this fencing will be located around the drip line of these trees, or a minimum of 3m from the trunk. The fencing shall be maintained for the full construction period.

1.04 EROSION & POLLUTION CONTROL

The Contractor shall take all proper precautions to prevent the erosion of soil from the subject site. The contractor shall install erosion & sediment control barriers and as required by council, and maintain these barriers throughout the construction period. Note that the sediment control measures adopted should reflect the soil type and erosion characteristics of the site.

- Erosion & pollution control measures shall incorporate the following:
- Construction of a sediment trap at the vehicle access point to the subject site.
  - Sediment fencing using a geotextile filter fabric in the location indicated on the erosion control plan or as instructed on site by the landscape architect.
  - Earth banks to prevent scour of stockpiles
  - Sandbag kerb sediment traps
  - Straw bale & geotextile sediment filter.
  - Exposed banks shall be pegged with an approved Jute matting in preparation for mass planting

Refer to 'Guidelines for Erosion and Sediment Control on Building Sites' by DLWC (2000) for construction techniques

SOIL WORKS

2.01 MATERIALS

**Specified Soil Conditioner (Generally to improve site soil)**  
The specified soil conditioner for site top-soil improvement shall be an organic mix complies with **AS 4454-2012 Composts, soil conditioners and mulches**. Note that for sites where soil testing indicates toxins or extremes in pH, or soils that are extremely poor, allow to excavate and supply 300mm of imported soil mix.

**New gardens & proposed Planting**  
New garden and planting areas shall consist of a 50/50 mix of clean site soil (refer d) below) and imported soil. All mixes are to comply with **AS4419-2003 Soils for Landscaping and garden use**, & AS 4454 Composts, Soil conditioners & mulches.

**Specified Soil Mix - Turf**  
The specified soil mix for all turf areas shall be a min 75mm layer of imported soil mix consisting of 80% washed river sand (reasonably coarse), and 20% composted organic matter equivalent to mushroom compost or soil conditioner, or other approved lawn top dress.

**Site Topsoil**  
Site topsoil is to be clean and free of unwanted matter such as gravel, clay lumps, grass, weeds, tree roots, sticks, rubbish and plastics, and any deleterious materials and materials toxic to plants. The topsoil must have a pH of between 5.5 and 7. Use 100% imported soil mix when site when site topsoil runs out.

**2.02 INSTALLATION**  
Note: No level changes (Cut or Fill), soil ripping within the Tree Protection Zones of trees to be retained

**a) Testing**  
All testing is to be conducted in accordance with AS4419-2003 Soils for Landscaping and garden use Methods for testing soils for engineering purposes. Site soil shall be given a pH test prior to modifying to ensure conditions are appropriate for planting as stated above. Tests shall be taken in several areas where planting is proposed, and the pH shall be adjusted accordingly with sulphur or lime to suit.

Note that a soil test conducted by the Sydney Environmental & Soil Laboratory or approved equal shall be prepared for all commercial, industrial and multi-unit residential sites. The successful landscape contractor shall implement the recommendations of this test.

**b) Set Out of Individual Trees & Mass Planting Areas**  
All individual tree planting positions and areas designated for mass planting shall be set out with stakes or another form of marking, ready for inspection and approval. Locate all services.

**c) Establishing Subgrade Levels**  
Subgrade levels are defined as the finished base levels prior to the placement of the specified material (i.e. soil conditioner). The following subgrade levels shall apply:

- Mass Planting Beds - 300mm below existing levels with specified imported soil mix.
- Turf areas - 100mm below finished surface level.

Note that all subgrades shall consist of a relatively free draining natural material, consisting of site topsoil placed previously by the Civil Contractor. No builders waste material shall be acceptable.

**d) Subgrade Cultivation**  
Cultivate all subgrades to a minimum depth of 100mm in all planting beds and all turf areas, ensuring a thorough breakup of the subgrade into a reasonably coarse tilth. Grade subgrades to provide falls to surface and subsurface drains, prior to the placement of the final specified soil mix.

**e) Drainage Works**  
Install surface and subsurface drainage where required and as detailed on the drawing. Drain subsurface drains to outlets provided, with a minimum fall of 1:100 to outlets and / or service pits.

**f) Placement and Preparation of Specified Soil Conditioner & Mixes.**  
Trees in turf & beds - Holes shall be twice as wide as root ball and minimum 100mm deeper - backfill hole with 50/50 mix of clean site soil and imported "Organic Garden Mix" as supplied by ANL or approved equal.

- Mass Planting Beds - Install specified soil conditioner to a compacted depth of 100mm

Place the specified soil conditioner to the required compacted depth and use a rotary hoe to thoroughly mix the conditioner into the top 300mm of garden bed soil. Ensure thorough mixing and the preparation of a reasonably fine tilth and good growing medium in preparation for planting.

- Turf Areas - Install specified soil mix to a minimum compacted depth of 75mm.

Place the specified soil mix to the required compacted depth and grade to required finished soil levels, in preparation for planting and turfing.

PLANTING

3.01 MATERIALS

**a) Quality and Size of Plant Material**  
All trees supplied above a 25L container size must be grown and planted in accordance with AS 2303:2019 *Tree stock for landscape use*. Certification that trees have been grown to AS2303:2018 guidelines is to be provided upon request of Council's Tree Management Officer.

Above - Ground Assessment:  
The following plant quality assessment criteria should be followed:  
*Plant true to type, Good vigour and health, free from pest & disease, free from injury, self-supporting, good stem taper, has been pruned correctly, is apically dominant, has even crown symmetry, free from included bark & stem junctions, even trunk position in pot, good stem structure*  
Below - Ground Assessment:  
*Good root division & direction, rootball occupancy, rootball depth, height of crown, non-suckering*  
For further explanation and description of these assessment criteria, refer to AS2303:2019.  
All Plant material shall be to the type and size specified. No substitutions of plant material shall be permitted without written prior approval by the Landscape Architect. No plant shall be accepted which does not conform to the standards listed above.

**b) Stakes and Ties**  
Provide min. 3 No. Stakes and ties to all plants identified as trees in the plant schedule. Stakes shall be sound, unpainted, straight hardwood, free of knots and pointed at one end. They shall be 2200mm x 50mm x 50mm Hardwood, or approved alternative. Ties shall be 50mm wide hessian webbing material.

**c) Fertilisers**  
Fertilisers shall be approved slow release fertilisers suitable for the proposed planting types. Note that for native plants, specifically Proteaceae family plants including Grevillea species, low phosphorus fertilizers shall be used.

**d) Mulch**  
Mulch shall be an approved equal to "FOREST FINE" as supplied by ANL. Mulch shall be completely free from any soil, weeds, rubbish or other debris.

**e) Turf**  
Turf shall be soft leaf Buffalo or equivalent (unless stated otherwise), free from any weeds and other grasses, and be in a healthy growing condition.

3.02 INSTALLATION

**a) Setting Out**  
All planting set out shall be in strict accordance with the drawings, or as directed. Note that proposed tree planting located near services should be adjusted at this stage. Notify Landscape Architect for inspection for approval prior to planting.

**b) Planting**  
All plant material shall be planted as soon after delivery as possible. Planting holes for trees shall be excavated as detailed and specified. Plant containers shall be removed and discarded, and the outer roots gently teased from the soil mass. Immediately set plant in hole and backfill with specified soil mix, incorporating the approved quantity of fertiliser for each plant type. Ensure that plants are set plumb vertically and root balls set to the consolidated finished grades detailed on the drawings. Compact the backfilled soil and saturate by hand watering to expel any remaining air pockets immediately after planting.

**c) Staking and Tying**  
Staking and tying shall be in strict accordance with the drawings and shall occur immediately following plant placement and soil backfilling. All plants identified as "Trees" on the planting schedule shall be staked with a min. 3 stakes.

**d) Mulching**  
Mulch for general planter bed shall be an approved equal to "FOREST FINE" as supplied by ANL. Mulch shall be completely free from any soil, weeds, rubbish or other debris. Mulch for bio-retention/rain garden area where is required shall be non-floatable materials that could include crushed rock, gravel, coarse river sand, scoria or river pebbles. 4-7mm screenings or similar.

**e) Turfing**  
Moisten soil prior to the turf being laid. Turf shall be neatly butt jointed and true to grade to finish flush with adjacent surfaces. Incorporate a lawn fertilizer and thoroughly water in. Keep turf moist until roots have taken and sods/rolls cannot be lifted. Keep all traffic off turf until this has occurred. Allow for top dressing of all turf areas. All turf shall be rolled immediately following installation.

**f) Brick Edging**  
Where is required, the Contractor shall install brick edge as detailed on the drawings, to all mass planting beds adjoining turf or gravel mulched areas, and where required. The resultant edge shall be true to line and flush with adjacent surfaces. However, no edging shall be used within the Structural Root Zone (SRZ) of trees to be retained.

**g) Nature Strip and public domain works**  
The nature strip (street frontage) for the site is public land, and only authorized works may occur here.  
Existing Conditions such as street trees, council planting etc shall be retained and protected during construction, unless specific approval has been granted for new work in this area. Where council policy specifies a particular unit paver, material finish, pattern or treatment, it shall be the contractors responsibility to check and verify that this material & treatment is correct and current prior to undertaking construction works'

**f) Drainage pit**  
Drainage pits and drainage lines should be located within garden areas to allow for site drainage while minimising impact on the proposed planting scheme, where possible, pits and linework should be located at the edge of landscape strips to avoid precluding planting centrally in garden areas. where pits and linework occur within garden beds, the landscape contractor shall take all precautions to avoid damaging storm water when planting shrubs and trees. landscape contractors shall not alter the form of swales designed to direct overland flow.

HARDSCAPE WORKS

4.01 GENERAL

The Contractor shall undertake the installation of all hardscape works as detailed on the drawing, or where not detailed, by manufacturers specification.

- Paving - refer to typical details provided, and applicable Australian Standards. *Permeable paving may be used as a suitable means of satisfying Council permeable surface requirements, while providing a useable, hardwearing, practical surface.* In most instances, the client shall nominate the appropriate paving material to be used.

Australian Standards shall be adhered to in relation to all concrete, masonry & metal work. Some details are typical and may vary on site. All hardscape works shall be setout as per the drawings, and inspected and approved by the Landscape Architect prior to installation. All workmanship shall be of the highest standard. Any queries or problems that arise from hardscape variations should be bought to the attention of the Landscape Architect.  
Your attention is directed to any obligations or responsibilities under the Dividing Fences Act, 1991 in respect of adjoining property owner/s which may arise from this application. Any enquiries in this regard may be made to the Crown Lands on 1300 886 235.

IRRIGATION WORKS

5.01 GENERAL (PERFORMANCE SPECIFICATION)

This is a general Irrigation Performance Specification only, as a guide for projects requiring irrigation systems as part of consent requirements or building contractual arrangements.  
An automated irrigation system is recommended for the effective establishment of new gardens, and to assist with the success of planting areas on terraces, over slabs and in Communal Open Spaces.  
The inclusion of this general specification is no guarantee that an irrigation system forms part of the landscape scope of works, which will be determined by the building contract.

*New irrigation systems to planting areas shall be a Commercial Grade Irrigation System conforming to all relevant Australian standards, including AS 3500 & the Gas and Electricity (Consumer Safety) Act 2017, Workplace Health & Safety Act 2011, & the latest Sydney Water Code*

An automated drip-irrigation system is to be installed to all gardens, planters and lawn areas in accordance with the approved Irrigation Design. This system shall be designed and installed by a qualified and licensed irrigation specialist, to the highest industry standards and to maximise the efficient usage of water.  
The Installer is required to obtain all approvals necessary for the completion of works in accordance with the Laws of Australia, Laws of the State of NSW, Northern Beaches Council By-Laws and Ordinances.

**Drawings:**  
- The Landscape Contractor nominated Licensed Irrigation Specialist shall provide irrigation drawings for approval upon engagement.

**Design Requirements:**

- The irrigation system shall be installed prior to all planting works. It shall incorporate a commercially available irrigation system, with sub-surface dripper lines to irrigate all gardens, planters and lawn areas.
- It shall incorporate a suitable back flow prevention device for the scale of works, an in-line filter, check valves, and suitable high and low density poly hose fittings and PVC piping to achieve flow rates suitable for specified planting.
- The irrigation application rate shall not exceed the infiltration rate of the soil or creates run-off.
- The landscape contractor shall check the existing pressure available from the ring mains and size irrigation piping to suit. Supply shall be from local hose cock where available.
- All piping and fittings shall be buried 50mm below the finished soil levels in garden and lawn areas, and secured in position at 500mm centres with galv wire pins.
- Size of pipes shall be selected to ensure the working pressure at the end of the line does not decrease by more than 5%.

**Services Co-ordination:**

- Co-ordination required by Landscape Contractor or Project Manager to provide required conduit, pipe work and penetration through slabs and planter walls for water and power provisions.
- The Landscape Contractor shall be engaged with the Irrigation Specialist to co-ordinate with the Project Manager to identify the preferred service and conduit locations.
- Project Manager and Landscape Contractor to establish area suitable for irrigation control system with required area, power provision and water supply.

**Testing & Defects:**  
Upon completion of installation, the system shall be tested, including:

- Main Line Pressure Test: The main line is pressurised to test for leaks. All valves are shut and the pressure is taken over a determined length of time.
- Dripper Pressure Test: Measurement at flushing valves are taken and the pressure gauged to make sure it conforms to the manufacturer recommendations. The inlet pressure is then tested under the same conditions to check it does not exceed 300Kpa.
- All components are to be satisfactorily functional and operational prior to approval. Should any defect develop, or the capacity or efficiency of the system decline during the agreed maintenance system, then these faults shall be immediately rectified.

**Warranty :**  
- A full 12 month warranty shall be included to cover labour and all parts.

**Further Documentation:**  
- On request, a detailed irrigation performance specification report can be issued.

CONSOLIDATION AND MAINTENANCE

6.01 GENERAL

The consolidation and maintenance period shall be either

- 6 months beginning from the approved completion of the specified construction work (Practical Completion)
- as agreed to in the landscape contractors contractual obligations.
- or as specified by Council in the Determination.

A qualified landscape maintenance contractor shall undertake the required landscape maintenance works. Consolidation and maintenance shall mean the care and maintenance of Contracted works by accepted landscaping or horticultural practices, ensuring that all plants are in optimum growing conditions and appearance at all times, as well as rectifying any defects that become apparent in the contracted works.

- This shall include, but not be limited to, the following items where and as required:
- Watering all planting and lawn areas / irrigation maintenance.
  - Clearing litter and other debris from landscaped areas.
  - Removing weeds, pruning and general plant maintenance.
  - Replacement of damaged, stolen or unhealthy plants.
  - Make good areas of soil subsidence or erosion.
  - Topping up of mulched areas.
  - Spray / treatment for Insect and disease control.
  - Fertilizing with approved fertilizers at correct rates.
  - Mowing lawns & trimming edges each 14 days in summer or 18 days in winter
  - Adjusting ties to Stakes
  - Maintenance of all paving, retaining and hardscape elements.

On the completion of the maintenance period, the landscape works shall be inspected and at the satisfaction of the superintendent or landscape architect, the responsibility will be signed over to the client.

<div>General Notes: Figured dimensions take preference to scale readings. Verify all dimensions on site. PDF'd plans may vary slightly in Scale for that indicated on plans. Report any discrepancies to the Landscape Architect before proceeding with the work. © Copyright Sulphurcrest Enterprises Pty Ltd Trading as CONZEPT (ABN: 75 623 405 630) This drawing is protected by copyright. All rights are reserved. Unless permitted under the Copyright Act 1968, no part of this drawing may in any form or by any means be reproduced, published, broadcast or transmitted without the prior written permission of the copyright owner. If the Status of this drawing is not signed off For Construction it may be subject to change, alteration or amendment at the discretion of our office. If so, Conzept is not liable for any loss, damage, harm or injury whether special, consequential, direct or indirect, suffered by you or any other person as a result of your use of this drawing for construction purposes. These plans and associated IP remain the property of Sulphurcrest Enterprises (T/A Conzept) until such time as all agreed payments are made in full. We retain the right to withdraw this information from the assessment process if such payments are not made following the notification period.</div>		<div><div><div><div><div><div><span></span></div><div>AILA Associate</div></div></div><div><div><div><span></span></div><div>Australian Institute of Landscape Architects</div></div></div></div><div><div><div><div><div><span></span></div><div>www.dialbeforeyoudig.com.au</div></div><div><div><div><div><div><span></span></div><div>DIAL 1100</div><div>BEFORE YOU DIG</div></div></div></div></div></div></div></div></div></div>		<div>SCALE:  N. T. S</div>		<table><tr><th>REV</th><th>DATE</th><th>NOTATION/AMENDMENT</th></tr><tr><td>A</td><td>26.09.2022</td><td>Preliminary plan prepared for review</td></tr><tr><td>B</td><td>04.10.2022</td><td>Co-ordinated with client's comments</td></tr><tr><td>C</td><td>13.06.2023</td><td>Co-ordinated with Architecture's updated</td></tr><tr><td></td><td></td><td></td></tr><tr><td></td><td></td><td></td></tr><tr><td></td><td></td><td></td></tr><tr><td></td><td></td><td></td></tr><tr><td></td><td></td><td></td></tr></table>	REV	DATE	NOTATION/AMENDMENT	A	26.09.2022	Preliminary plan prepared for review	B	04.10.2022	Co-ordinated with client's comments	C	13.06.2023	Co-ordinated with Architecture's updated																<table><tr><td>COUNCIL</td><td>NORTHERN BEACHES</td></tr><tr><td>CLIENT</td><td></td></tr><tr><td></td><td>SKYCORP AUSTRALIA</td></tr><tr><td>ARCHITECT</td><td></td></tr><tr><td></td><td>PTI ARCHITECTURE</td></tr><tr><td>STATUS / ISSUE</td><td></td></tr><tr><td></td><td>DA - ISSUE C</td></tr></table>	COUNCIL	NORTHERN BEACHES	CLIENT			SKYCORP AUSTRALIA	ARCHITECT			PTI ARCHITECTURE	STATUS / ISSUE			DA - ISSUE C	<div><div><div><div><div><span></span></div><div>Conzept</div><div>Landscape Architects</div></div><div><div><div>www.conzept.net.au</div><div>enquiries@conzept.net.au</div></div><div><div>Phone: 9922 5312</div><div>Suite 101, 506 Miller St</div><div>CAMMERAY NSW 2062</div></div></div></div></div></div>	<div>TITLE: SPECIFICATIONS  PROPOSED RESIDENTIAL DEVELOPMENT LOT 3, 6 ORCHARD STREET, WARRIEWOOD</div>	<div>DWG.No:  LPDA 22 - 324/4</div> <div>DATE:  JUNE 2023</div> <div><div>DRAWN:  K.Z/J.G</div><div>CHECKED:  R.F</div></div>
REV	DATE	NOTATION/AMENDMENT																																																	
A	26.09.2022	Preliminary plan prepared for review																																																	
B	04.10.2022	Co-ordinated with client's comments																																																	
C	13.06.2023	Co-ordinated with Architecture's updated																																																	
COUNCIL	NORTHERN BEACHES																																																		
CLIENT																																																			
	SKYCORP AUSTRALIA																																																		
ARCHITECT																																																			
	PTI ARCHITECTURE																																																		
STATUS / ISSUE																																																			
	DA - ISSUE C																																																		