

Flower Power Garden Centre

Landscape Development Application

Flower Power Garden Centre, 277 Mona Vale Road, Terrey Hills, NSW

Drawing Schedule

Drawing Number	Drawing Title	Scale
000	Landscape Coversheet	N/A
001	Landscape Plan	1:500
101	Landscape Plan - 1	1:200
102	Landscape Plan - 2	1:200
103	Landscape Plan - 3	1:200
104	Landscape Plan - 4	1:200
501	Landscape Details	As Shown
502	Landscape Details	As Shown

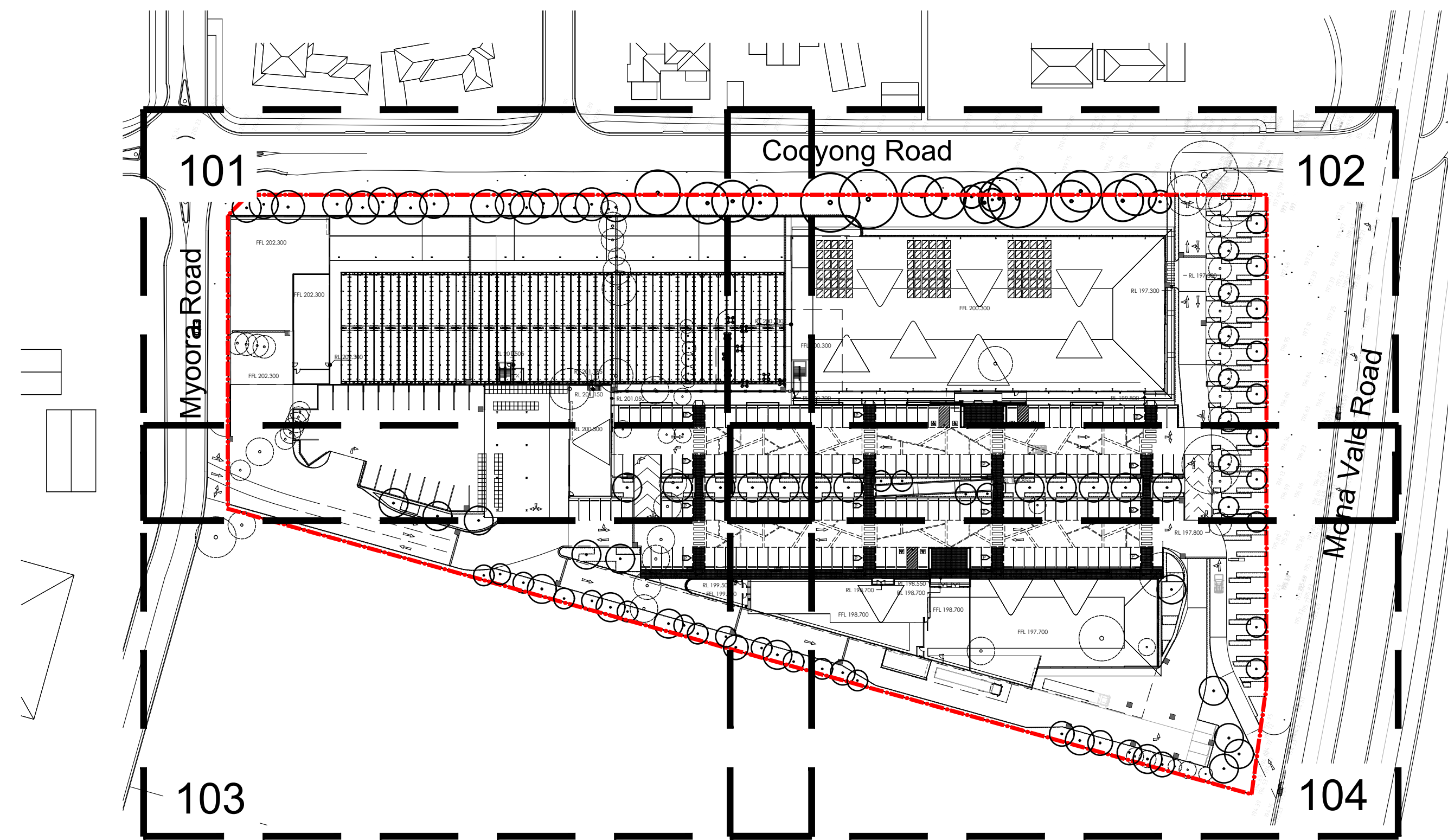

Site Plan | 1:1000

NOT FOR CONSTRUCTION

© 2021 Site Image (NSW) Pty Ltd ABN 44 801 262 380 as agent for Site Image NSW Partnership. All rights reserved. This drawing is copyright and shall not be reproduced or copied in any form or by any means (graphic, electronic or mechanical including photocopy) without the written permission of Site Image (NSW) Pty Ltd. Any license, expressed or implied, to use this document for any purpose what so ever is restricted to the terms of the written agreement between Site Image (NSW) Pty Ltd and the instructing party.

The contractor shall check and verify all work on site (including work by others) before commencing the landscape installation. Any discrepancies are to be reported to the Project Manager or Landscape Architect prior to commencing work. Do not scale this drawing. Any required dimensions not shown shall be referred to the Landscape Architect for confirmation.

Issue	Revision Description	Drawn	Check	Date
B	Architectural Coordination	LW	NM	21.02.2022
A	Preliminary	LW	NM	31.01.2022



Client
Flower Power

Project
Flower Power Garden Centre
277 Mona Vale Road
Terrey Hills, NSW

Drawing Name
Coversheet

DEVELOPMENT APPLICATION

Scale
Job Number
Drawing Number
Issue

SS21-4790 000 B

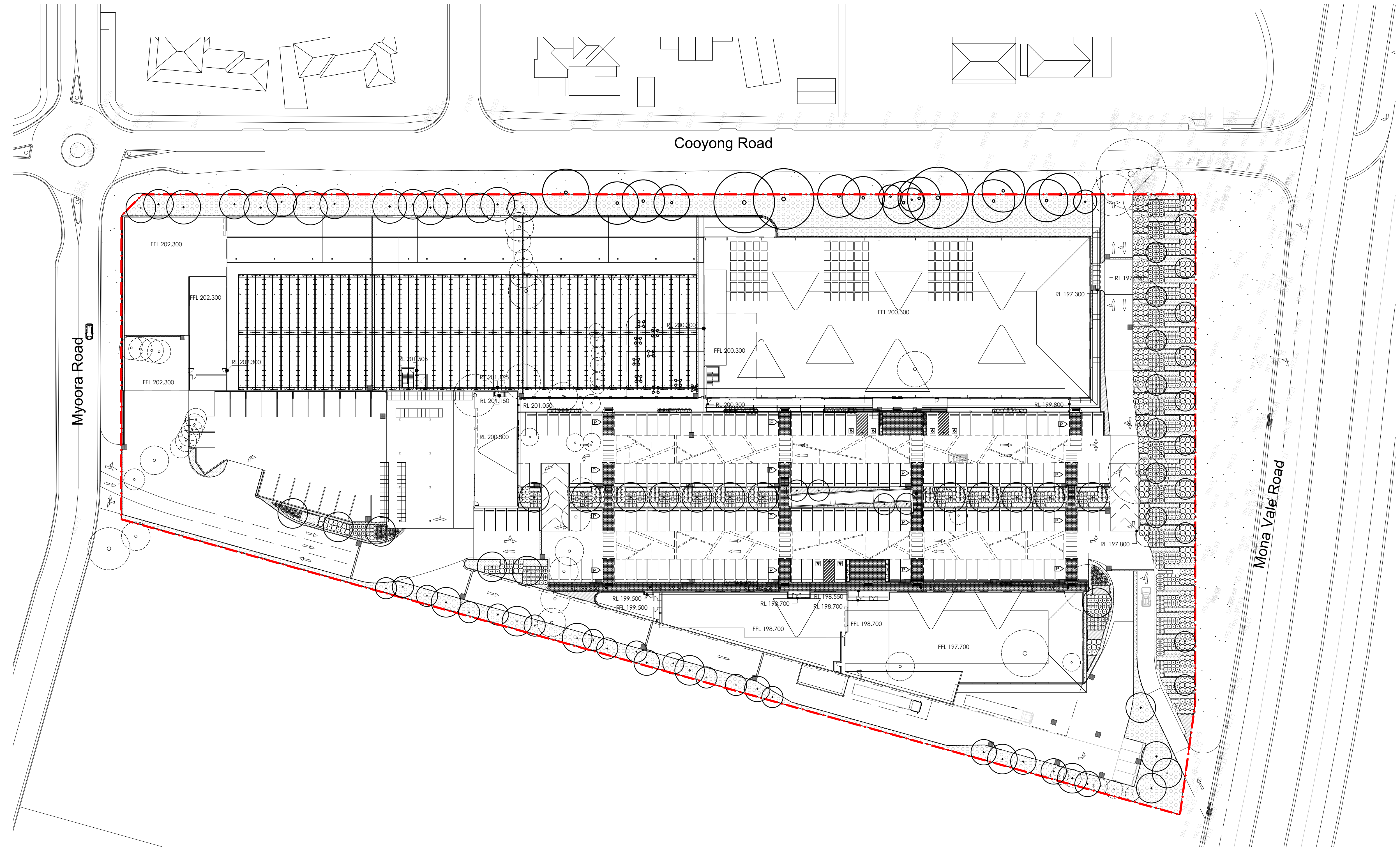

NOT FOR CONSTRUCTION

© 2021 Site Image (NSW) Pty Ltd ABN 44 801 262 380 as agent for Site Image NSW Partnership. All rights reserved. This drawing is copyright and shall not be reproduced or copied in any form or by any means (graphic, electronic or mechanical including photocopy) without the written permission of Site Image (NSW) Pty Ltd. Any license, expressed or implied, to use this document for any purpose what so ever is restricted to the terms of the written agreement between Site Image (NSW) Pty Ltd and the instructing party.

The contractor shall check and verify all work on site (including work by others) before commencing the landscape installation. Any discrepancies are to be reported to the Project Manager or Landscape Architect prior to commencing work. Do not scale this drawing. Any required dimensions not shown shall be referred to the Landscape Architect for confirmation.

Issue	Revision Description	Drawn	Check	Date
B	Architectural Coordination	LW	NM	21.02.2022
A	Preliminary	LW	NM	31.01.2022

Legend	
	Site Boundary
	Proposed Trees (Refer to Schedule and Detail)
	Existing Trees to be Retained
	Existing Trees to be Removed
	Ground Cover (Refer to Schedule and Detail)
	Boundary Planting Matrix (Refer to Schedule and Detail)
	Shrubs and Accents (Refer to Schedule and Detail)
	Turf
	Textured surface to pedestrian path (Refer to Schedule and Detail)
	Pergola Overhead (Refer to Schedule and Detail)
	Patterned texture (Refer to Schedule and Detail)

Key Plan

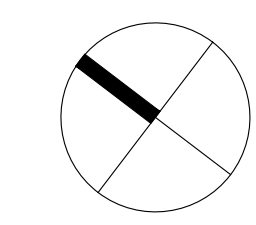

SITE IMAGE
Landscape Architects
Level 1, 3-5 Bagnall Street
Redfern NSW 2016
Australia
Tel: (61 2) 8332 5600
Fax: (61 2) 9698 2877
www.siteimage.com.au

Client
Flower Power

Project
Flower Power Garden Centre
277 Mona Vale Road
Terrey Hills, NSW

Drawing Name
Landscape Plan
Ground Floor

DEVELOPMENT APPLICATION

Scale 1:500 @ A1
Job Number
SS21-4790

0 2 5 10 15 25m
Drawing Number
001 B
Issue

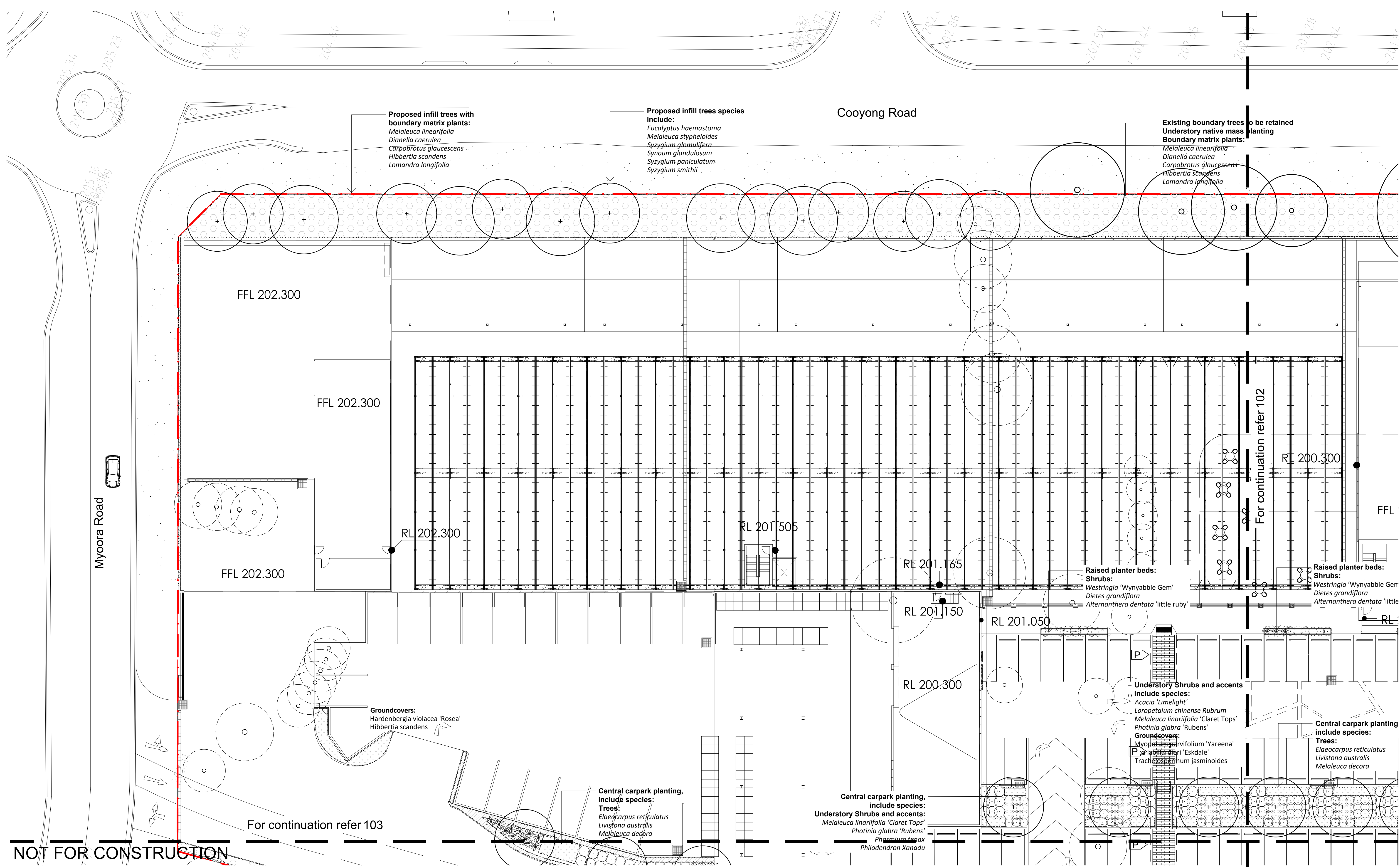

Proposed infill trees with boundary matrix plants:
Melaleuca linearifolia
Dianella caerulea
Carpobrotus glaucescens
Hibbertia scandens
Lomandra longifolia

Proposed infill trees species include:
Eucalyptus haemastoma
Melaleuca stypheloides
Syzygium glomulifera
Synoum glandulosum
Syzygium paniculatum
Syzygium smithii

Existing boundary trees to be retained
Understory native mass planting
Boundary matrix plants:
Melaleuca linearifolia
Dianella caerulea
Carpobrotus glaucescens
Hibbertia scandens
Lomandra longifolia

Raised planter beds:
Shrubs:
Westringia 'Wynabbie Gem'
Diets grandiflora
Alternanthera dentata 'little ruby'

Raised planter beds:
Shrubs:
Westringia 'Wynabbie Gem'
Diets grandiflora
Alternanthera dentata 'little ruby'

Groundcovers:
Hardenbergia violacea 'Rosea'
Hibbertia scandens

Central carpark planting, include species:
Trees:
Elaeocarpus reticulatus
Livistona australis
Melaleuca decora

Central carpark planting, include species:
Understory Shrubs and accents:
Melaleuca linearifolia 'Claret Tops'
Photinia glabra 'Rubens'
Phormium tenax
Philodendron Xanadu

Understory Shrubs and accents include species:
Acacia 'Limelight'
Loropetalum chinense Rubrum
Melaleuca linearifolia 'Claret Tops'
Photinia glabra 'Rubens'
Groundcovers:
Myoporum parvifolium 'Yareena'
Paspalum 'Eskdale'
Trachypogon jasmoides

Central carpark planting include species:
Trees:
Elaeocarpus reticulatus
Livistona australis
Melaleuca decora

For continuation refer 103

For continuation refer 102

NOT FOR CONSTRUCTION

© 2021 Site Image (NSW) Pty Ltd ABN 44 801 262 380 as agent for Site Image NSW Partnership. All rights reserved. This drawing is copyright and shall not be reproduced or copied in any form or by any means (graphic, electronic or mechanical including photocopy) without the written permission of Site Image (NSW) Pty Ltd. Any license, expressed or implied, to use this document for any purpose what so ever is restricted to the terms of the written agreement between Site Image (NSW) Pty Ltd and the instructing party.

The contractor shall check and verify all work on site (including work by others) before commencing the landscape installation. Any discrepancies are to be reported to the Project Manager or Landscape Architect prior to commencing work. Do not scale this drawing. Any required dimensions not shown shall be referred to the Landscape Architect for confirmation.

Issue	Revision Description	Drawn	Check	Date
B	Architectural Coordination	LW	NM	21.02.2022
A	Preliminary	LW	NM	31.01.2022

Legend	
	Site Boundary
	Proposed Trees (Refer to Schedule and Detail)
	Existing Trees to be Retained
	Existing Trees to be Removed
	Ground Cover (Refer to Schedule and Detail)
	Boundary Planting Matrix (Refer to Schedule and Detail)
	Shrubs and Accents (Refer to Schedule and Detail)
	Turf
	Textured surface to pedestrian path (Refer to Schedule and Detail)
	Pergola Overhead (Refer to Schedule and Detail)
	Patterned texture (Refer to Schedule and Detail)

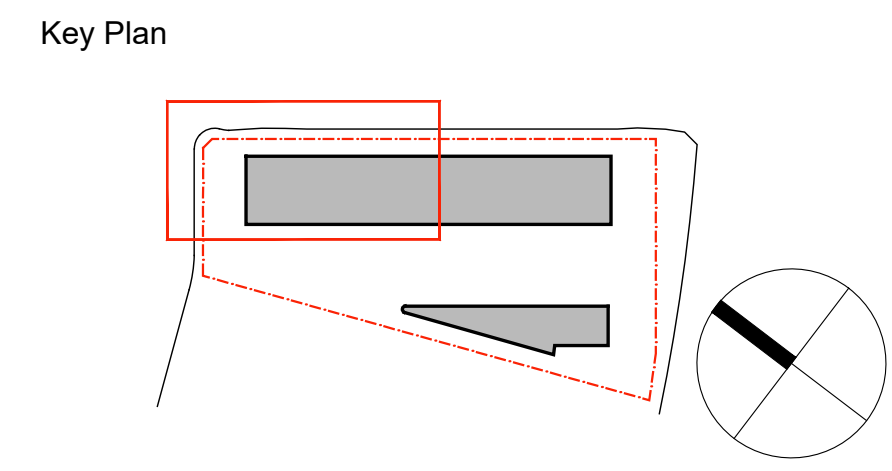

SITE IMAGE
 Landscape Architects
 Level 1, 3-5 Bagnall Street
 Redfern NSW 2016
 Australia
 Tel: (61 2) 8332 5600
 Fax: (61 2) 9698 2877
 www.siteimage.com.au

Client
Flower Power
 Project
Flower Power Garden Centre
 277 Mona Vale Road
 Terrey Hills, NSW

Drawing Name
Landscape Plan - 1
 DEVELOPMENT APPLICATION
 Scale 1:200 @ A1
 Job Number
SS21-4790
 Drawing Number
101
 Issue
B

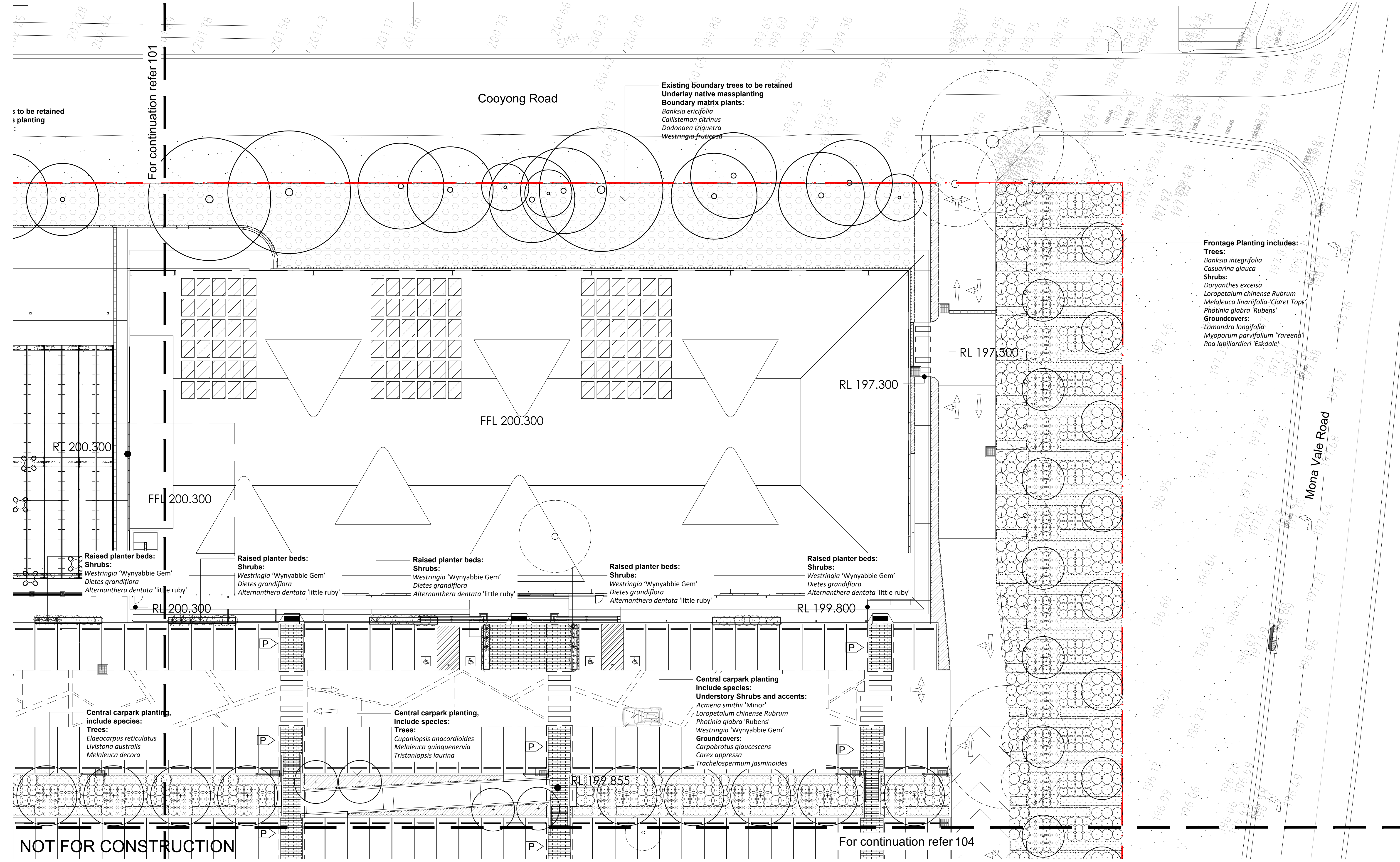

© 2021 Site Image (NSW) Pty Ltd. ABN 44 801 262 380 as agent for Site Image NSW Partnership. All rights reserved. This drawing is copyright and shall not be reproduced or copied in any form or by any means (graphic, electronic or mechanical including photology) without the written permission of Site Image (NSW) Pty Ltd. Any license, expressed or implied, to use this document for any purpose whatsoever is restricted to the terms of the written agreement between Site Image (NSW) Pty Ltd and the instructing party.

The contractor shall check and verify all work on site (including work by others) before commencing the landscape installation. Any discrepancies are to be reported to the Project Manager or Landscape Architect prior to commencing work. Do not scale this drawing. Any required dimensions not shown shall be referred to the Landscape Architect for confirmation.

Issue	Revision Description	Drawn	Check	Date
B	Architectural Coordination	LW	NM	21.02.2022
A	Preliminary	LW	NM	31.01.2022

Legend	
	Site Boundary
	Proposed Trees (Refer to Schedule and Detail)
	Existing Trees to be Retained
	Existing Trees to be Removed
	Ground Cover (Refer to Schedule and Detail)
	Boundary Planting Matrix (Refer to Schedule and Detail)
	Shrubs and Accents (Refer to Schedule and Detail)
	Turf
	Textured surface to pedestrian path (Refer to Schedule and Detail)
	Pergola Overhead (Refer to Schedule and Detail)
	Patterned texture (Refer to Schedule and Detail)

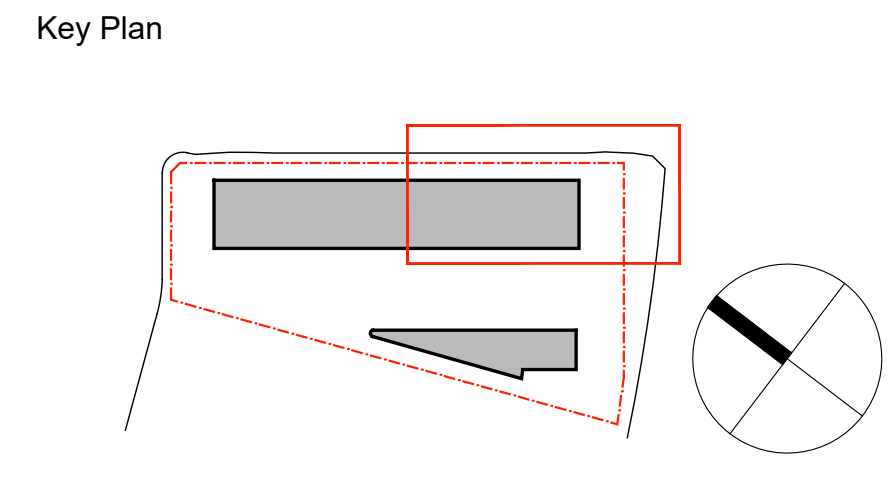

SITE IMAGE

Landscape Architects
 Level 1, 3-5 Baptist Street
 Redfern NSW 2016
 Australia
 Tel: (61 2) 8332 5600
 Fax: (61 2) 9698 2877
 www.siteimage.com.au

Client
Flower Power

Project
Flower Power Garden Centre
 277 Mona Vale Road
 Terrey Hills, NSW

Drawing Name
Landscape Plan - 2

DEVELOPMENT APPLICATION

Scale 1:200 @ A1
 Job Number
SS21-4790

Drawing Number
102 B

For continuation refer 101

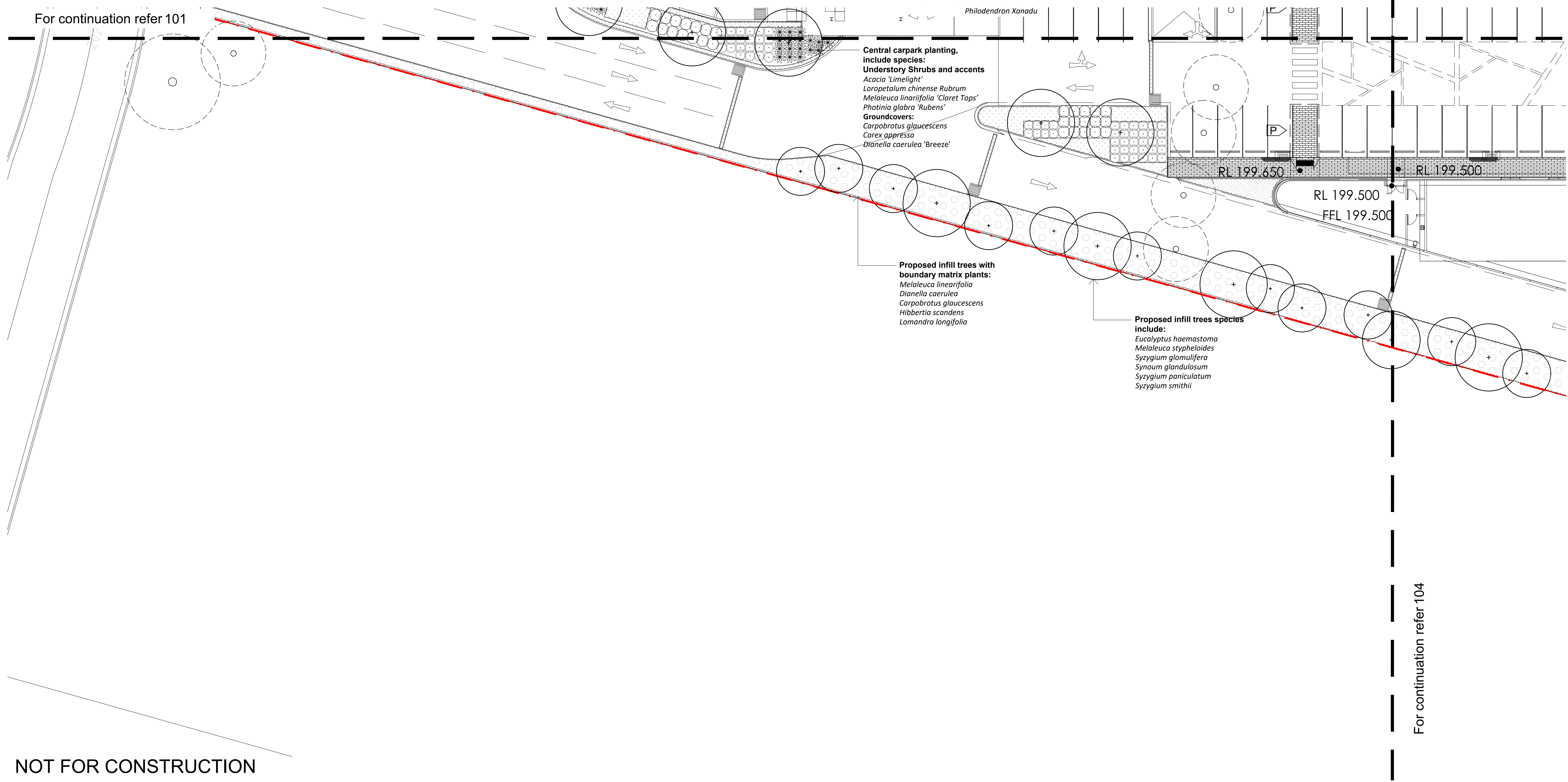

Central carpark planting, include species:
Understory Shrubs and accents
Acacia 'Limelight'
Loropetalum chinense Rubrum
Melaleuca linearifolia 'Claret Tops'
Photinia glabra 'Rubens'
Groundcovers:
Carpobrotus glaucescens
Carex appressa
Dianella caerulea 'Breeze'

Proposed infill trees with boundary matrix plants:
Melaleuca linearifolia
Dianella caerulea
Carpobrotus glaucescens
Hibbertia scandens
Lomandra longifolia

Proposed infill trees species include:
Eucalyptus haemastoma
Melaleuca stypheloides
Syzygium glomulifera
Synoum glandulosum
Syzygium paniculatum
Syzygium smithii

For continuation refer 104

NOT FOR CONSTRUCTION

© 2021 Site Image (NSW) Pty Ltd ABN 44 801 262 380 as agent for Site Image NSW Partnership. All rights reserved. This drawing is copyright and shall not be reproduced or copied in any form or by any means (graphic, electronic or mechanical including photocopy) without the written permission of Site Image (NSW) Pty Ltd. Any license, expressed or implied, to use this document for any purpose what so ever is restricted to the terms of the written agreement between Site Image (NSW) Pty Ltd and the instructing party.

The contractor shall check and verify all work on site (including work by others) before commencing the landscape installation. Any discrepancies are to be reported to the Project Manager or Landscape Architect prior to commencing work. Do not scale this drawing. Any required dimensions not shown shall be referred to the Landscape Architect for confirmation.

Legend	
	Site Boundary
	Proposed Trees (Refer to Schedule and Detail)
	Existing Trees to be Retained
	Existing Trees to be Removed
	Ground Cover (Refer to Schedule and Detail)
	Boundary Planting Matrix (Refer to Schedule and Detail)
	Shrubs and Accents (Refer to Schedule and Detail)
	Turf
	Textured surface to pedestrian path (Refer to Schedule and Detail)
	Pergola Overhead (Refer to Schedule and Detail)
	Patterned texture (Refer to Schedule and Detail)

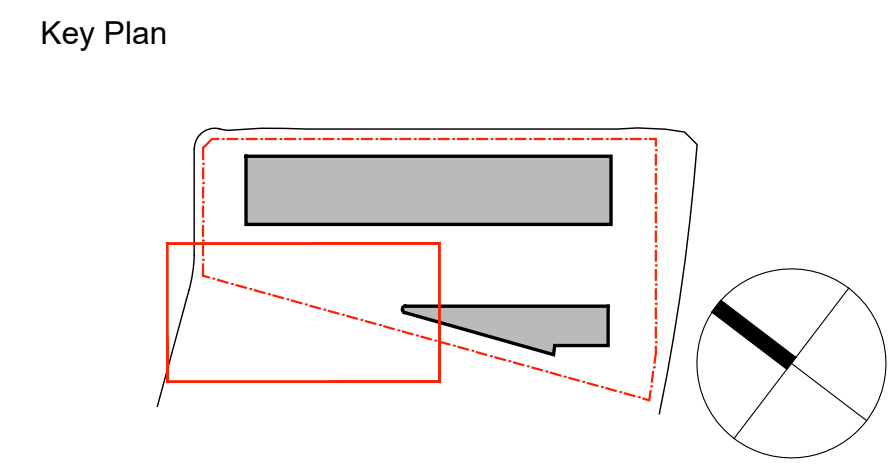

SITE IMAGE
 Landscape Architects
 Level 1, 3-5 Baptist Street
 Redfern NSW 2016
 Australia
 Tel: (61 2) 8332 5600
 Fax: (61 2) 9698 2877
 www.siteimage.com.au

Client
Flower Power
 Project
Flower Power Garden Centre
277 Mona Vale Road
Terrey Hills, NSW

Drawing Name
Landscape Plan - 3
 DEVELOPMENT APPLICATION
 Scale 1:200 @ A1
 Job Number
SS21-4790
 Drawing Number
103 B

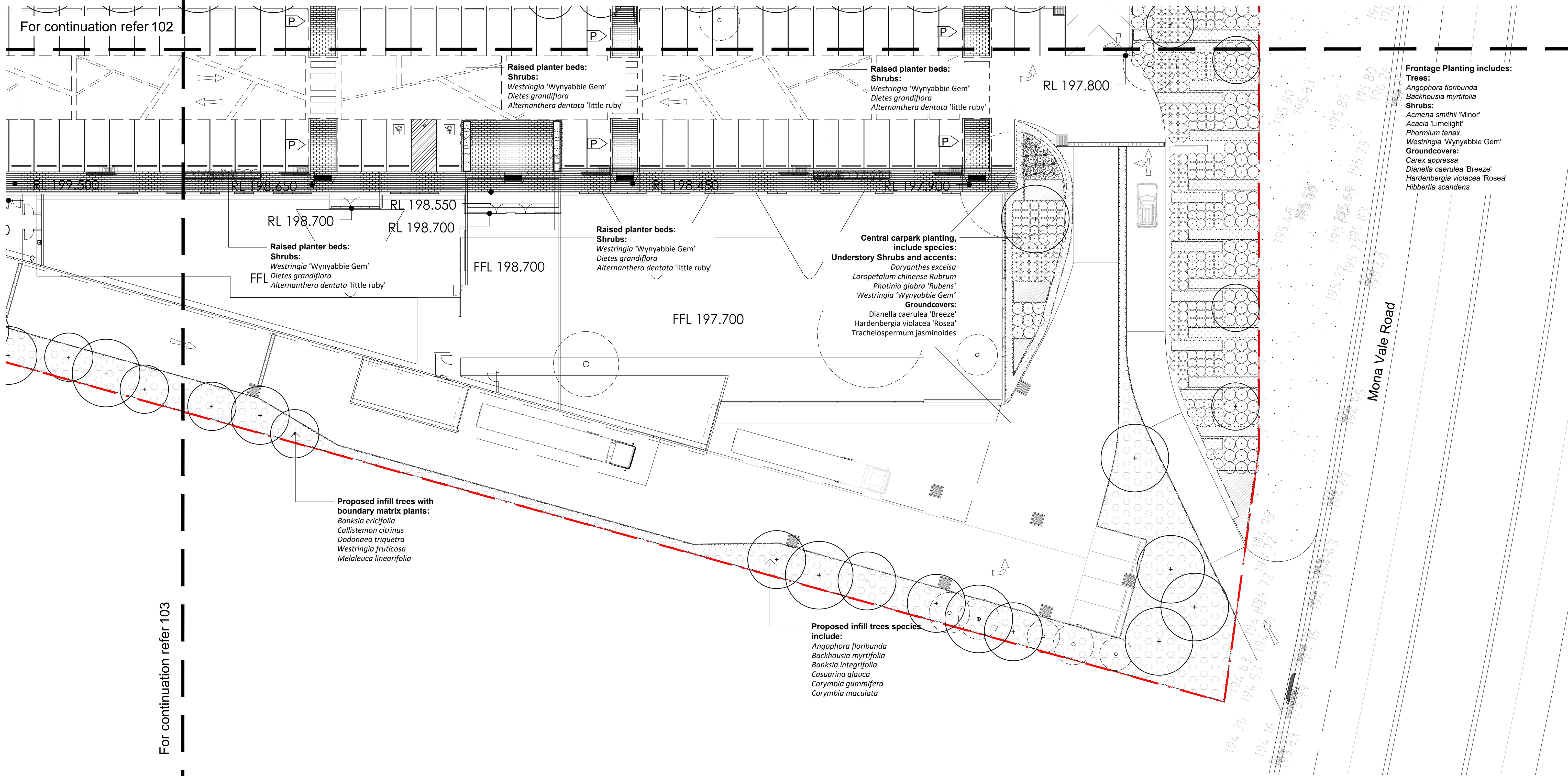

NOT FOR CONSTRUCTION

© 2021 Site Image (NSW) Pty Ltd ABN 44 801 262 380 as agent for Site Image NSW Partnership. All rights reserved. This drawing is copyright and shall not be reproduced or copied in any form or by any means (graphic, electronic or mechanical including photocopy) without the written permission of Site Image (NSW) Pty Ltd. Any license, expressed or implied, to use this document for any purpose what so ever is restricted to the terms of the written agreement between Site Image (NSW) Pty Ltd and the instructing party.

The contractor shall check and verify all work on site (including work by others) before commencing the landscape installation. Any discrepancies are to be reported to the Project Manager or Landscape Architect prior to commencing work. Do not scale this drawing. Any required dimensions not shown shall be referred to the Landscape Architect for confirmation.

B	Architectural Coordination	LW	NM	21.02.2022
A	Preliminary	LW	NM	31.01.2022
Issue	Revision Description	Drawn	Check	Date

Legend	
	Site Boundary
	Proposed Trees (Refer to Schedule and Detail)
	Existing Trees to be Retained
	Existing Trees to be Removed
	Ground Cover (Refer to Schedule and Detail)
	Boundary Planting Matrix (Refer to Schedule and Detail)
	Shrubs and Accents (Refer to Schedule and Detail)
	Turf
	Textured surface to pedestrian path (Refer to Schedule and Detail)
	Pergola Overhead (Refer to Schedule and Detail)
	Patterned texture (Refer to Schedule and Detail)

Key Plan

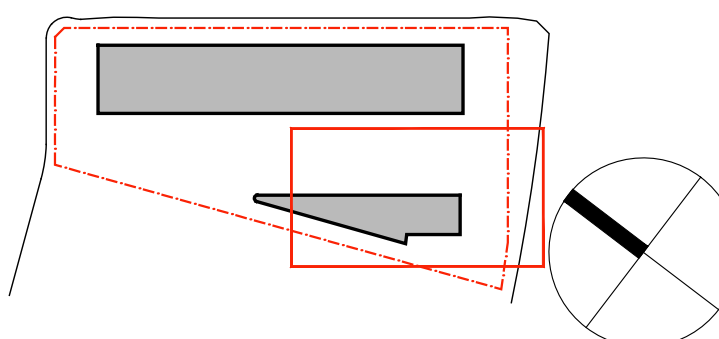

SITE IMAGE
 Landscape Architects
 Level 1, 3-5 Bagnall Street
 Redfern NSW 2016
 Australia
 Tel: (61 2) 8332 5600
 Fax: (61 2) 9698 2877
 www.siteimage.com.au

Client
Flower Power

Project
Flower Power Garden Centre
277 Mona Vale Road
Terrey Hills, NSW

Drawing Name
Landscape Plan - 4

DEVELOPMENT APPLICATION

Scale 1:200 @ A1
 Job Number
SS21-4790

0 1 2 4 6 10m
 Drawing Number
104 B
 Issue

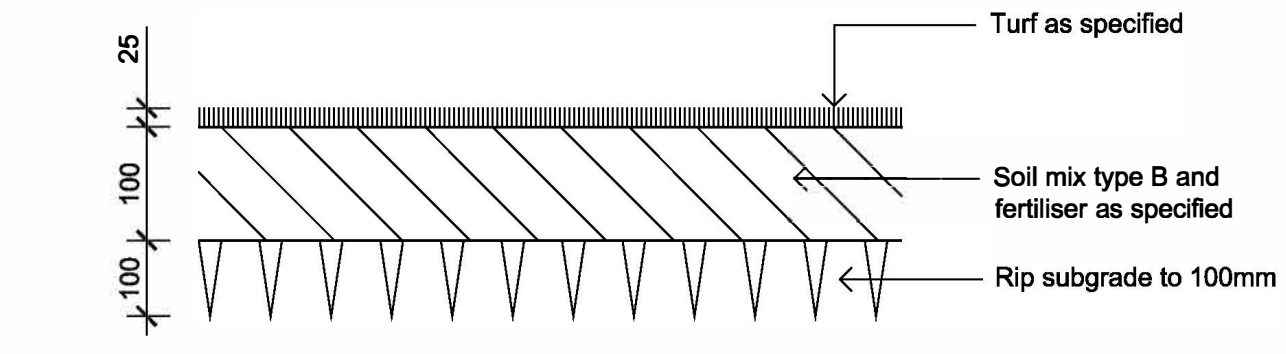

01 Detail Turf on Even Grade
501 1:10

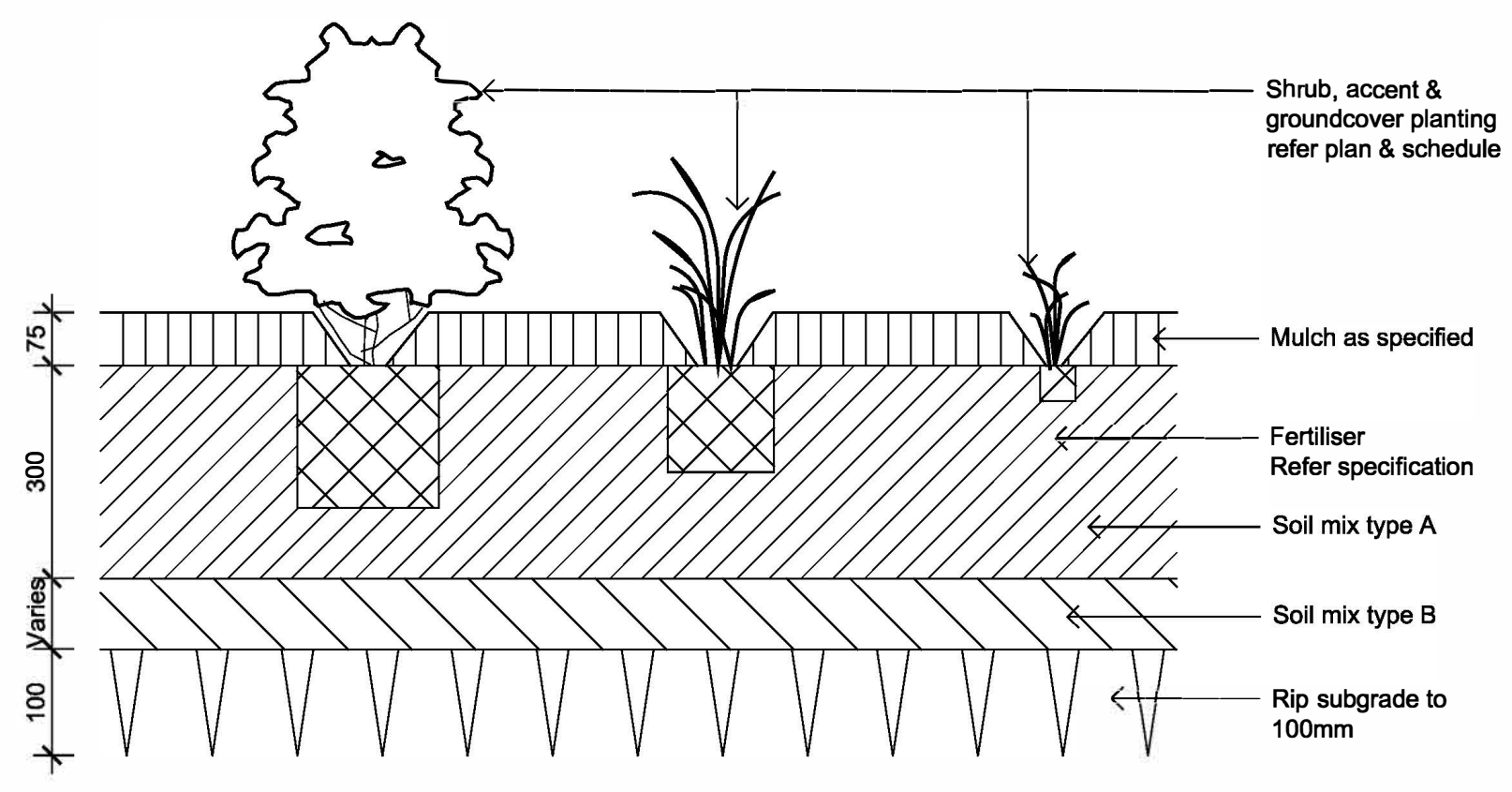

02 Detail Shrub Accent & Groundcover Planting on Grade
501 1:10

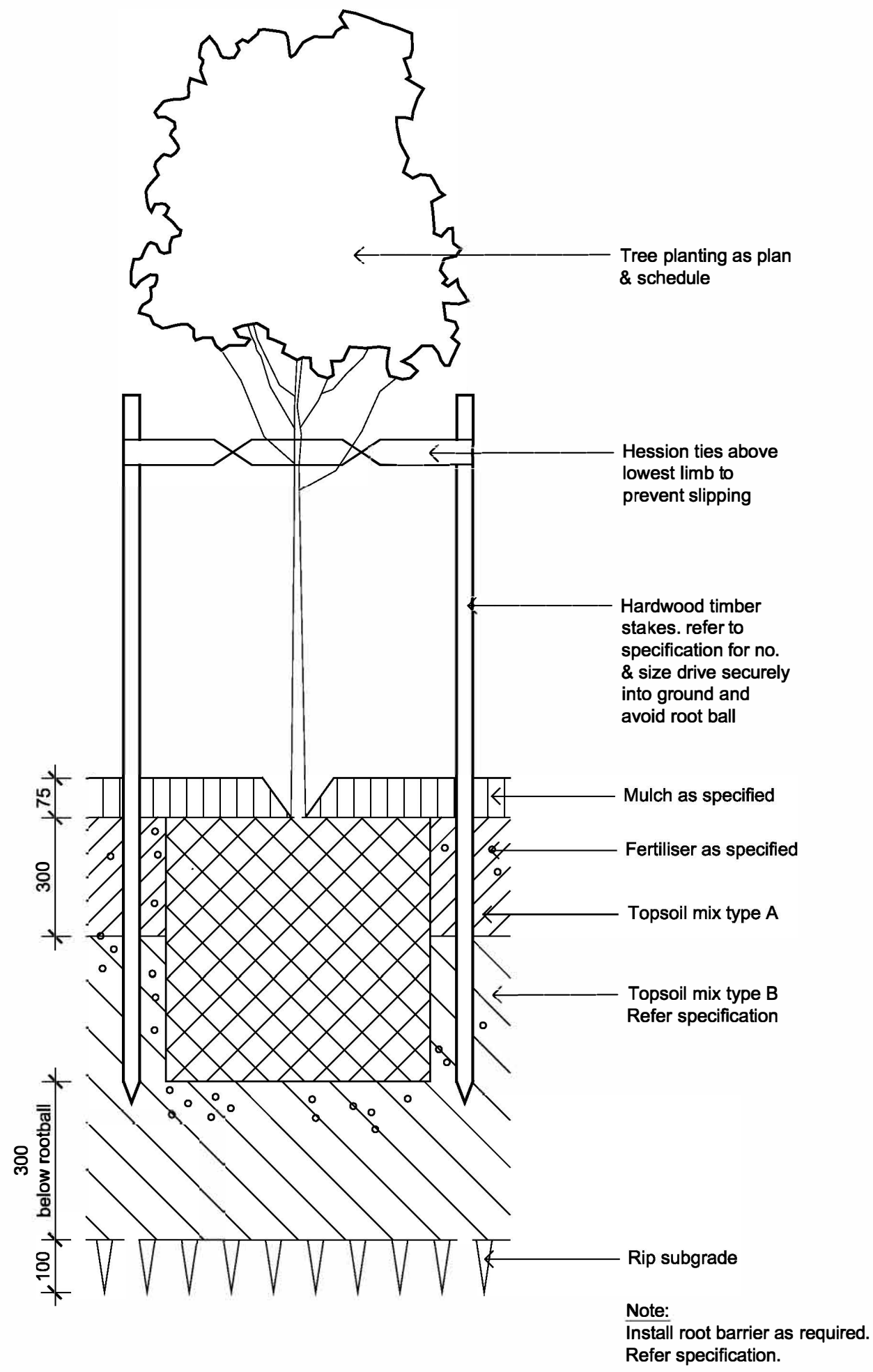

03 Detail 75-200L Tree Planting on Grade
501 1:10

Indicative Plant Schedule

Botanical Name	Common Name	Mature Size (h x w)	Spacings	Pot Size
Carpark Trees				
<i>Cupaniopsis anacardioides</i>	Tuckeroo	7 x 5	As Shown	100L
<i>Elaeocarpus reticulatus</i>	Blueberry Ash	10 x 4	As Shown	100L
<i>Livistona australis</i>	Cabbage Tree Palm	25 x 4	As Shown	100L
<i>Melaleuca decora</i>	White Feather Honeymyrtle	6 x 3	As Shown	100L
<i>Melaleuca quinquenervia</i>	Paperbark	10 x 4	As Shown	100L
<i>Tristaniopsis laurina</i>	Water Gum	10 x 5	As Shown	100L
Boundary Trees				
<i>Angophora floribunda</i>	Rough-barked Angophora		As Shown	45L
<i>Backhousia myrtifolia</i>	Grey Myrtle		As Shown	45L
<i>Bankia integrifolia</i>	Coast Banksia		As Shown	45L
<i>Casuarina glauca</i>	Swamp She-oak		As Shown	45L
<i>Corymbia gummifera</i>	Red Bloodwood		As Shown	45L
<i>Corymbia maculata</i>	Spotted Gum		As Shown	45L
<i>Eucalyptus haemastoma</i>	Scribbly Gum		As Shown	45L
<i>Melaleuca stypheloides</i>	Prickly-leaved Paperbark		As Shown	45L
<i>Syzygium glomulifera</i>	Turpentine		As Shown	45L
<i>Synoum glandulosum</i>	Scentless Rosewood		As Shown	45L
<i>Syzygium paniculatum</i>	Magenta Lilly Pilly		As Shown	45L
<i>Syzygium smithii</i>	Common Lilly Pilly		As Shown	45L
Shrubs and Accents				
<i>Acmena smithii 'Minor'</i>	Dwarf Lilly Pilly	4 x 2	As Shown	300mm
<i>Acacia 'Limelight'</i>	Acacia Limelight	0.5 x 0.5	As Shown	300mm
<i>Doryanthes exceisa</i>	Gymea Lily	3 x 2	As Shown	200mm
<i>Loropetalum chinense Rubrum</i>	Chinese Fringe Flower	1 x 1	As Shown	200mm
<i>Melaleuca linariifolia 'Claret Tops'</i>	Honey Myrtle	1 x 1	As Shown	200mm
<i>Photinia glabra 'Rubens'</i>	Japanese Photinia	4 x 2	As Shown	300mm
<i>Phomium tenax</i>	New Zealand Flax	3 x 1.5	As Shown	200mm
<i>Philodendron Xanadu</i>	Xanadu	.8 x 1	As Shown	200mm
<i>Westringia 'Wynabbie Gem'</i>	Coastal Rosemary	2 x 2	As Shown	200mm
<i>Alternanthera dentata 'little ruby'</i>	Alternanthera little ruby	.9x.4	As Shown	200mm
<i>Diets grandiflora</i>	Wild Iris	1.2x1.2	As Shown	200mm
Groundcovers / Grasses				
<i>Carpobrotus glaucescens</i>	Pigface	.2 x 1	5/m2	150mm
<i>Carex appressa</i>	Tall sedge	.8 x 1	5/m2	150mm
<i>Dianella caerulea 'Breeze'</i>	Breeze Paroo Lily	.6 x .6	5/m2	150mm
<i>Hardenbergia violacea 'Rosea'</i>	Native Sarsaparilla	2 x 1	5/m2	150mm
<i>Hibbertia scandens</i>	Guinea Flower	.5 x 1	5/m2	150mm
<i>Lomandra longifolia</i>	Mat Rush	.7 x 1	5/m2	150mm
<i>Myoporum parvifolium 'Yareena'</i>	Yareena Myoporum	1.5	5/m2	150mm
<i>Poa labillardieri 'Eskdale'</i>	Tussock Grass	.6 x .6	5/m2	150mm
<i>Trachelospermum jasminoides</i>	Star Jasmine	.2 x .5	5/m2	150mm

Boundary Planting Matrix

Botanical Name	Common Name	Mature Size (h x w)	Density /25m2	Pot Size
<i>Bankia ericifolia</i>	Heath-leaved Banksia	6 x 2	7	150mm
<i>Callistemon citrinus</i>	Crimson Bottlebrush	1.8 x 1.5	7	150mm
<i>Dodonaea triquetra</i>	Common Hop-Bush	3 x 2	7	150mm
<i>Westringia fruticosa</i>	Coast Rosemary	1 x 1	7	150mm
<i>Melaleuca linearifolia</i>	Snow in Summer	4 x 4	7	150mm
<i>Dianella caerulea</i>	Blue Flax Lily	.4 x .4	10	Tube
<i>Carpobrotus glaucescens</i>	Pig Face	.2 x 1	10	Tube

NOT FOR CONSTRUCTION

© 2021 Site Image (NSW) Pty Ltd. All rights reserved. This drawing is copyright and shall not be reproduced or copied in any form or by any means (graphic, electronic or mechanical including photocopy) without the written permission of Site Image (NSW) Pty Ltd. Any license, expressed or implied, to use this document for any purpose what so ever is restricted to the terms of the written agreement between Site Image (NSW) Pty Ltd and the instructing party.

The contractor shall check and verify all work on site (including work by others) before commencing the landscape installation. Any discrepancies are to be reported to the Project Manager or Landscape Architect prior to commencing work. Do not scale this drawing. Any required dimensions not shown shall be referred to the Landscape Architect for confirmation.

B	Architectural Coordination	LW	NM	21.02.2022
A	Preliminary	LW	NM	31.01.2022
Issue	Revision Description	Drawn	Check	Date



Client
Flower Power

Project
Flower Power Garden Centre
277 Mona Vale Road
Terrey Hills, NSW

Drawing Name
Landscape Details

DEVELOPMENT APPLICATION

Scale
Job Number
Drawing Number
Issue

SS21-4790
501 B

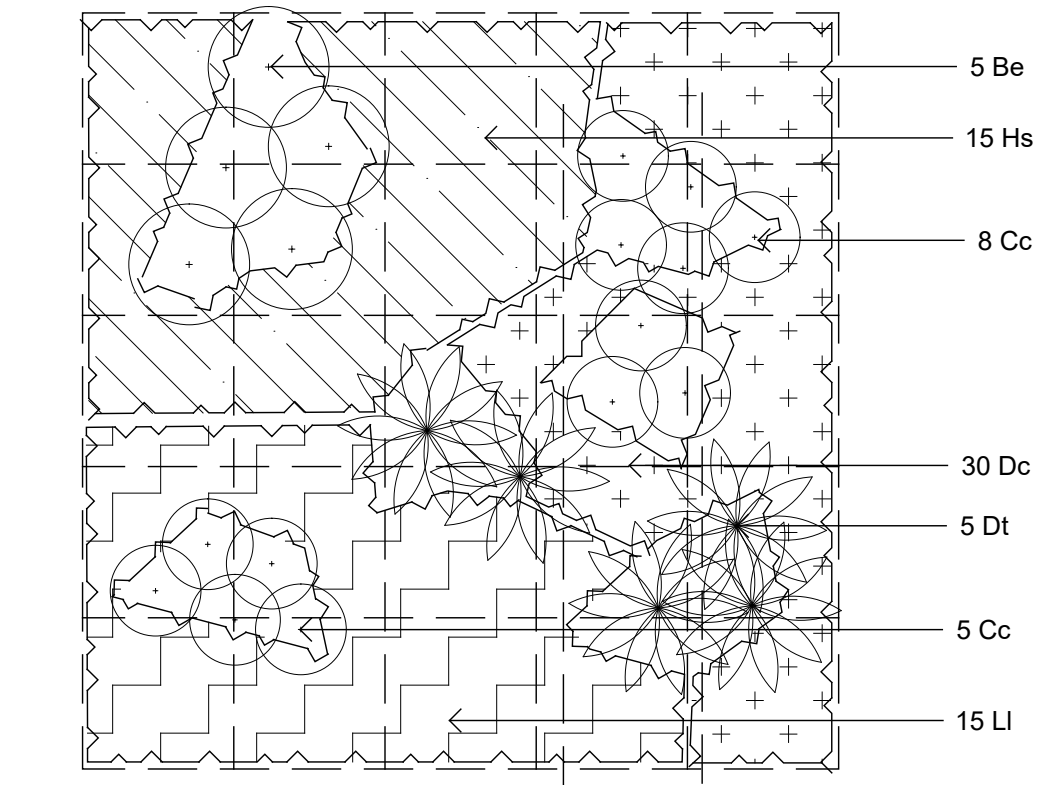

01 Boundary Planting Matrix
502 1:50

NOT FOR CONSTRUCTION

© 2021 Site Image (NSW) Pty Ltd. ABN 44 801 262 380 as agent for Site Image NSW Partnership. All rights reserved. This drawing is copyright and shall not be reproduced or copied in any form or by any means (graphic, electronic or mechanical including photocopy) without the written permission of Site Image (NSW) Pty Ltd. Any license, expressed or implied, to use this document for any purpose what so ever is restricted to the terms of the written agreement between Site Image (NSW) Pty Ltd and the instructing party.

The contractor shall check and verify all work on site (including work by others) before commencing the landscape installation. Any discrepancies are to be reported to the Project Manager or Landscape Architect prior to commencing work. Do not scale this drawing. Any required dimensions not shown shall be referred to the Landscape Architect for confirmation.

Issue	Revision Description	Drawn	Check	Date
B	Architectural Coordination	LW	NM	21.02.2022
A	Preliminary	LW	NM	31.01.2022

S I T E I M A G E



Landscape Architects

Level 1, 3-5 Baptist Street
Redfern NSW 2016
Australia

Tel: (61 2) 8332 5600
Fax: (61 2) 9698 2877
www.siteimage.com.au

Client
Flower Power

Project
Flower Power Garden Centre
277 Mona Vale Road
Terrey Hills, NSW

Drawing Name
Landscape Details

DEVELOPMENT APPLICATION

Scale
Job Number
SS21-4790

Drawing Number
502

Issue
B