

Qasar

Subsurface Utility Consultants

In field Service Report for:

14 Aquatic Drive Frenchs Forest

Report Compiled by:

Jonathan Watson

Report Compiled for:

LTS Lockley

Date:

18th October 2022

Service Location Report

Client Details

Name:	Scott Lord	Ph:	0403 120 663
Email:	Scottl@lockley.com.au		
Company:	LTS Lockley		
Position:	Registered Surveyor/ Survey Manager		

Project/ Site Details

Site Address	14 Aquatic Drive, Frenchs Forest
Description of Works	Locate Services within the area indicated within the scope provided.

Scope of Works



Scope of works indicate in yellow highlighted area

Dial Before You Dig Information

DBYD Order Number:	32859536
DBYD Date of Inquiry	6th October 2022

Plan Availability

Asset Type	Asset Owner	Plan Available Y/N	Comments
Communications	Telstra NSW Central	Y	
	NBN Co NSW/ ACT	Y	
	Optus and/or Ucomm	Y	
	TPG Telecom (NSW)	Y	
	Verizon Business (NSW)	Y	
	Vocus Communications 2	Y	
	FibreSense Pty Ltd (NSW)	Y	
Electrical	Ausgrid	Y	
Water	Sydney Water	Y	
Stormwater	Northern Beaches Council	Y	
Sewer	Sydney Water	Y	
Gas	Jemena Gas North	Y	
Other			

Note: All plans need to be available on site at all times. It is also recommended to review expiry dates on all plans prior to all excavation work.

AS 5488.1.2019 - Locating Quality Levels

Quality Level A QLA	Visualisation/ Confirmation of a Service, position and depth, by non-destructive digging (NDD) methods or points of entry to pits or manholes. Recommended Quality Level prior to construction or excavation.
Quality Level B QLB	Locating of Services using Radio Detection methods or Ground Penetrating Radar. Acceptable range of accuracy for Quality Level B is 300mm for position and 500mm in Depth.
Quality Level C QLC	Services Marked out using only surface features in the field. Such surface features include, Hydrants, Gas Markers, Pits etc. No indication of service location or depth can be attained from Quality Level C.
Quality Level D QLD	Services marked up using DBYD plans only. Offsets on plans can be used to obtain such indication of services in field but no indication of service confirmation can be given.

Note: Asset Protection is the number one priority at Qasar. It is highly recommended that Quality Level A is achieved in as many areas as practical. A clash detection methodology is highly recommended in order to reduce cost.

Locating Quality Matrix

		Electromagnetic Field		
Current		Round	Round/ Not Round	Not Round
	Good	1	2	3
	OK	2	2	3
	Poor	3	3	3

Note: During service location works, an indication of the locating quality is obtained. How to read the score within the locating spreadsheet.

- **Score = 1** – High Quality Assurance and can be fairly sure that this will fall into the Quality Level B parameters.
- **Score = 2** – Medium Quality Assurance that the locate has fallen within the Quality Level B parameters.
- **Score = 3** – Low Quality Assurance and extra is generally required to confirm Location. Unlikely to fall in the Quality Level B parameters.

Project Overview/ Report



Report and in-field Service Colours

--- White ---	Communications
--- Red/ Orange ---	Electrical
--- Blue ---	Water
--- Yellow ---	Gas
--- Green ---	Stormwater
--- Purple ---	Sewer
--- Pink ---	Unknown Service

String Label Spreadsheet

Code	Service Type	Locating Quality			Comment/s
C1	Communications	1	2	3	Multiple Cables, multiple providers - main cable bank
E1	Electrical Supply	1	2	3	Carpark lighting cable to corner of building
C2	Communications	1	2	3	Boom gate communications - note: above ground at times
E2	Electrical Supply	1	2	3	Boom gate Electrical - note: above ground at times
C3	Communications	1	2	3	Telstra Main Bank - See Note: C3 Communications String
E3	Electrical Supply	1	2	3	Electrical Supply to boom gates
C4	Communications	1	2	3	Communications to boom gates
C5	Communications	1	2	3	P100 - large copper network cable in duct
C6	Communications	1	2	3	P100 - large copper network cable in duct
C7	Communications	1	2	3	P100 - CATV and NBN in duct
C8	Communications	1	2	3	P100 - Optic Fibre in duct
C9	Communications	1	2	3	C9, C10 and C11 represent main bank - 13 ducts in bank
C10	Communications	1	2	3	C9, C10 and C11 represent main bank - 13 ducts in bank
C11	Communications	1	2	3	C9, C10 and C11 represent main bank - 13 ducts in bank
E4	Electrical Supply	1	2	3	Street Lighting
E5	Electrical Supply	1	2	3	Street Lighting
E6	Electrical Supply	1	2	3	Street Lighting
E7	Electrical Supply	1	2	3	Street Lighting
W1	Water Supply	1	2	3	Potable Water supply
W2	Water Supply	1	2	3	Fire Service - Boosters
W3	Water Supply	1	2	3	Fire Service - unknown - from valve in IP to EOT
C12	Communications	1	2	3	4 x P100 - Optic Fibre in Duct - Main Cable
C13	Communications	1	2	3	Optus - note: from pit to building, duct has gland, unable to rod
E8	Electrical Supply	1	2	3	Street Lighting
E9	Electrical Supply	1	2	3	Electrical beside potential service trench - confirmation recommended
E10	Electrical Supply	1	2	3	Located with Passive and induction - confirmation recommended

String Label Spreadsheet

Code	Service Type	Locating Quality			Comment/s
W4	Water Supply	1	2	3	Fire Service - Water Main to fire service assets
W5	Water Supply	1	2	3	Fire Service - Fire Service Assets to building
E11	Electrical Supply	1	2	3	Building Supply from Generator
E12	Electrical Supply	1	2	3	Supply from Street to Sub - Confirmation Recommended
C14	Communications	1	2	3	Nextgen - Trace Wire locate - confirmation recommended
C15	Communications	1	2	3	Nextgen - Trace Wire locate - confirmation recommended
C16	Communications	1	2	3	Southern Cross Optic Fibre - See note
C17	Communications	1	2	3	Southern Cross Optic Fibre - See note
NOTE: IT IS RECOMMENDED TO CONFIRM DEPTH AND LOCATION PRIOR TO ANY EARTHWORKS - MAJOR ASSET					
W6	Water Supply	1	2	3	20mm Tap Supply
E13	Electrical Supply	1	2	3	Garden Lighting Supply
E14	Electrical Supply	1	2	3	BBQ Supply - Poor Locate - confirmation recommended
E15	Electrical Supply	1	2	3	Garden Lighting Supply
G1	Gas Supply	1	2	3	25mm Copper Pipe - Gas Bottle Connection
W7	Water Supply	1	2	3	Water Supply to Building - Potable Water
E16	Electrical Supply	1	2	3	Garden Lighting - to Switch Board
E17	Electrical Supply	1	2	3	Garden Lighting
E18	Electrical Supply	1	2	3	Building Supply - Unknown Configuration
W8	Water Supply	1	2	3	Water Supply - Potable water to Building
C18	Communications	1	2	3	Large Communications Bank - Optic Fibre in Bank - MC
W9	Water Supply	1	2	3	250mm DICL Sydney Water Main
C19	Communications	1	2	3	Optus - 2 x Ducts - multiple cables in ducts
		1	2	3	
		1	2	3	
		1	2	3	
		1	2	3	

Project Report/ Notes

Note: C1 Communications string

C1 is a main cable bank that has high integrity assets within. There are multiple providers within this string and all due care is required within the vicinity of this asset.

IMPORTANT

SOUTHERN CROSS OPTIC FIBRE - C16 + C17

The Southern Cross Optic fibre asset is within the vicinity. This is an asset that is of National and International significance.

There are strict parameters to abide by when working in close proximity of this asset

Note: C3 Communications String

C3 represents a bank of communications including multiple cable from multiple providers. It is representing the top bank of a multiple level bank of communications.

If construction is going to be undertaken within this vicinity, there needs to be a large amount of investigation using non destructive digging methods to obtain the relevant information required to maintain the assets integrity.

Due care to be taken within the vicinity

Note: Boom Gate Communications Pit

There are multiple small conduits exiting this pit for the road sensors. It is not locatable due to the surrounding assets being more conductive and the signal dissipating without result.

Due care too be taken within the vicinity

Note: Possible service trench

There is a series of steel plates in the carpark where indicated on the over view that align with the switch room and distribution boards. It is believed to carry services such as Communications, Electrical and Water/ Fire Service.

Due to these steel plates being large and with no lifting lugs, this is unable to be confirmed. Due care to be taken during excavation.

Project Report/ Notes

Note: Major Communications Exiting Property

There are Major Communications Assts indicated going through the site and servicing the property to the rear. These Assets have not been able to be found and it is highly recommended to undertake further investigations in order to find these assets.

It is recommended to Contact the Asset Providers for more information as to the location of these assets

Dial Before You Dig Plans

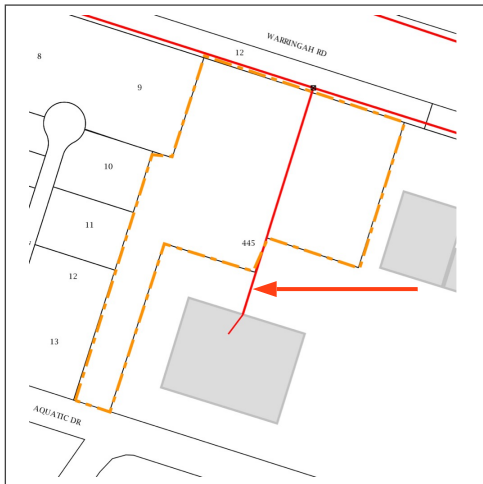

Optus Dial Before You Dig Plan

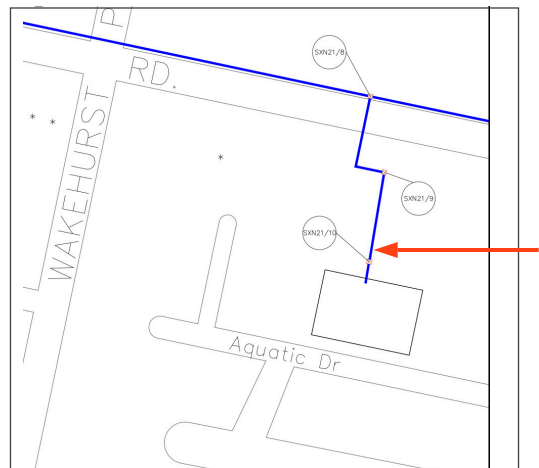

Southern Cross Fibre Dial Before You Dig Plan

Dial Before You Dig Plans



Job No 32859536

Phone: 1100
www.1100.com.au

Caller Details

Contact: Jonathan Watson
Company: Not supplied
Address: 352 Great Western Highway
Warrimoo NSW 2774

Caller Id: 3012140 **Phone:** 0400 472 818
Email: watsonjonathan74@gmail.com

Dig Site and Enquiry Details

WARNING: The map below only displays the location of the proposed dig site and does not display any asset owners' pipe or cables. The area highlighted has been used only to identify the participating asset owners, who will send information to you directly.

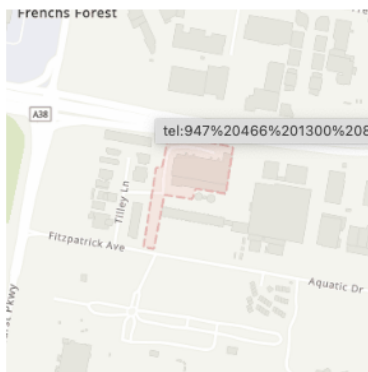

User Reference: Frenchs Forest

Working on Behalf of: Private

Enquiry Date: 06/10/2022

Start Date: 06/10/2022

End Date: 24/10/2022

Address:
14 Aquatic Drive
Frenchs Forest NSW 2086

Purpose:

Excavation

Location of Workplace:

Both

Onsite Activities:

Manual Excavation, Non-Destructive Digging

Location in Road:

Footpath, Nature Strip, Road

- Check that the location of the dig site is correct. If not you must submit a new enquiry.
- Should the scope of works change, or plan validity dates expire, you must submit a new enquiry.
- Do NOT dig without plans. Safe excavation is your responsibility. If you do not understand the plans or how to proceed safely, please contact the relevant asset owners.

Notes/Description of Works:

Not supplied

Your Responsibilities and Duty of Care

- The lodgement of an enquiry **does not authorise** the project to commence. You must obtain all necessary information from any and all likely impacted asset owners prior to excavation.
- If plans are not received within 2 working days, contact the asset owners directly & quote their Sequence No.
- ALWAYS perform an onsite inspection for the presence of assets. Should you require an onsite location, contact the asset owners directly. Please remember, plans do not detail the exact location of assets.
- Pothole to establish the exact location of all underground assets using a hand shovel, before using heavy machinery.
- Ensure you adhere to any State legislative requirements regarding Duty of Care and safe digging requirements.
- If you damage an underground asset you **MUST** advise the asset owner immediately.
- By using this service, you agree to Privacy Policy and the terms and disclaimers set out at www.1100.com.au
- For more information on safe excavation practices, visit www.1100.com.au

Asset Owner Details

The assets owners listed below have been requested to contact you with information about their asset locations within 2 working days.

Additional time should be allowed for information issued by post. It is **your responsibility** to identify the presence of any underground assets in and around your proposed dig site. Please be aware, that not all asset owners are registered with the Before You Dig service, so it is **your responsibility** to identify and contact any asset owners not listed here directly.

** Asset owners highlighted by asterisks ** require that you visit their offices to collect plans.

Asset owners highlighted with a hash # require that you call them to discuss your enquiry or to obtain plans.

Seq. No.	Authority Name	Phone	Status
216753138	Ausgrid	(02) 4951 0899	NOTIFIED
216753135	FiberSense Pty Limited (NSW)	1300 947 466	NOTIFIED
216753140	Jemena Gas North	1300 880 900	NOTIFIED
216753136	NBN Co NswAct	1800 687 626	NOTIFIED
216753134	Northern Beaches Council	0466 015 284	NOTIFIED
216753133	Optus and or Uecomm Nsw	1800 505 777	NOTIFIED
216753142	Sydney Water	13 20 92	NOTIFIED
216753137	Telstra NSW Central	1800 653 935	NOTIFIED
216753143	TPG Telecom (NSW)	1800 786 306	NOTIFIED
216753141	Verizon Business (Nsw)	(02) 8210 3243	NOTIFIED
216753139	Vocus Communications 2	1800 262 663	NOTIFIED

Lodge Your Free Enquiry Online – 24 Hours a Day, Seven Days a Week

Telstra Local Plan

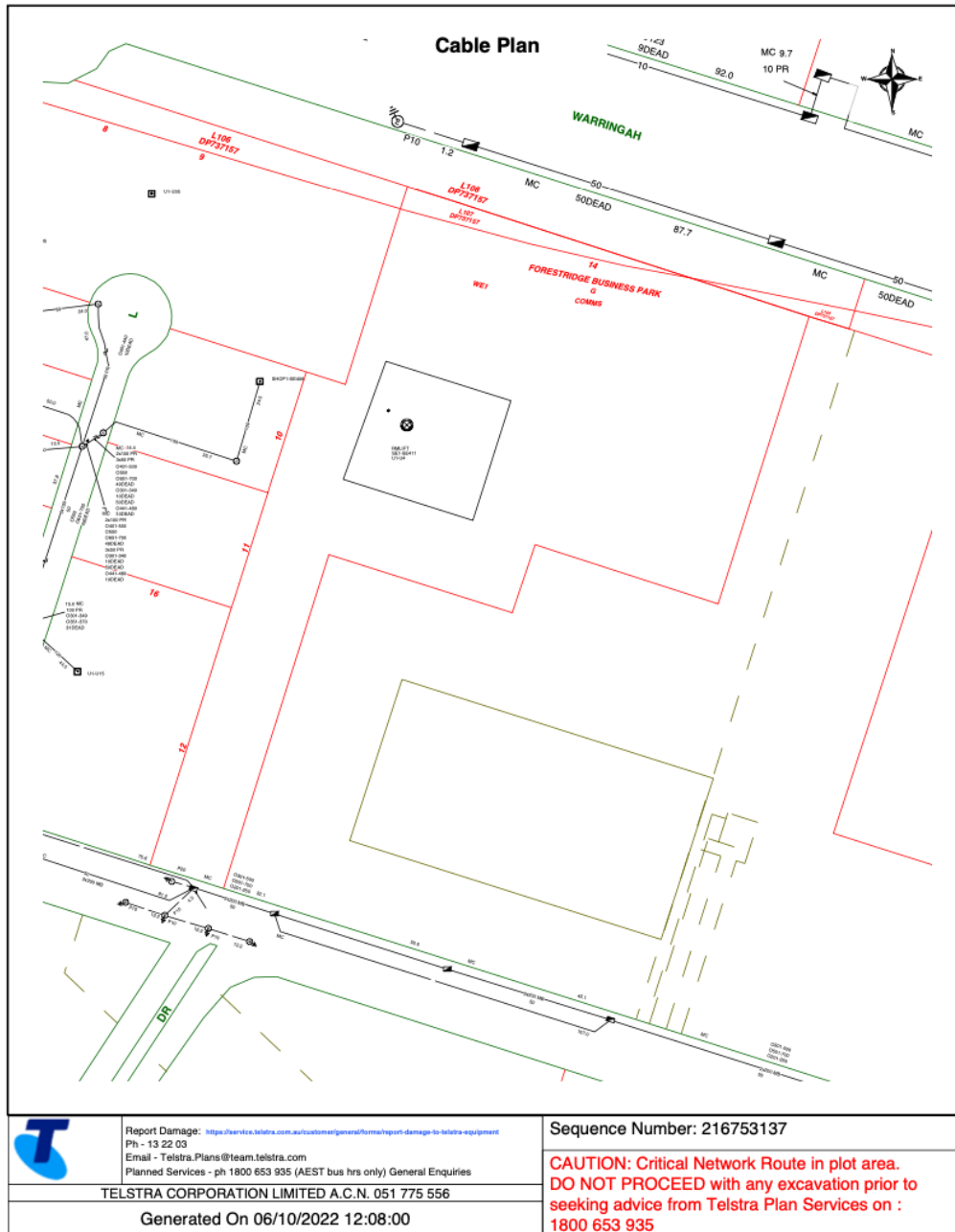

The above plan must be viewed in conjunction with the Mains Cable Plan on the following page

WARNING

Telstra plans and location information conform to Quality Level "D" of the Australian Standard AS 5488-Classification of Subsurface Utility Information. As such, Telstra supplied location information is indicative only. Spatial accuracy is not applicable to Quality Level D. Refer to AS 5488 for further details. The exact position of Telstra assets can only be validated by physically exposing it. Telstra does not warrant or hold out that its plans are accurate and accepts no responsibility for any inaccuracy. Further on site investigation is required to validate the exact location of Telstra plant prior to commencing construction work. A Certified Locating Organisation is an essential part of the process to validate the exact location of Telstra assets and to ensure the asset is protected during construction works. See the Steps- Telstra Duty of Care that was provided in the email response.

Telstra – Main Cable Plan

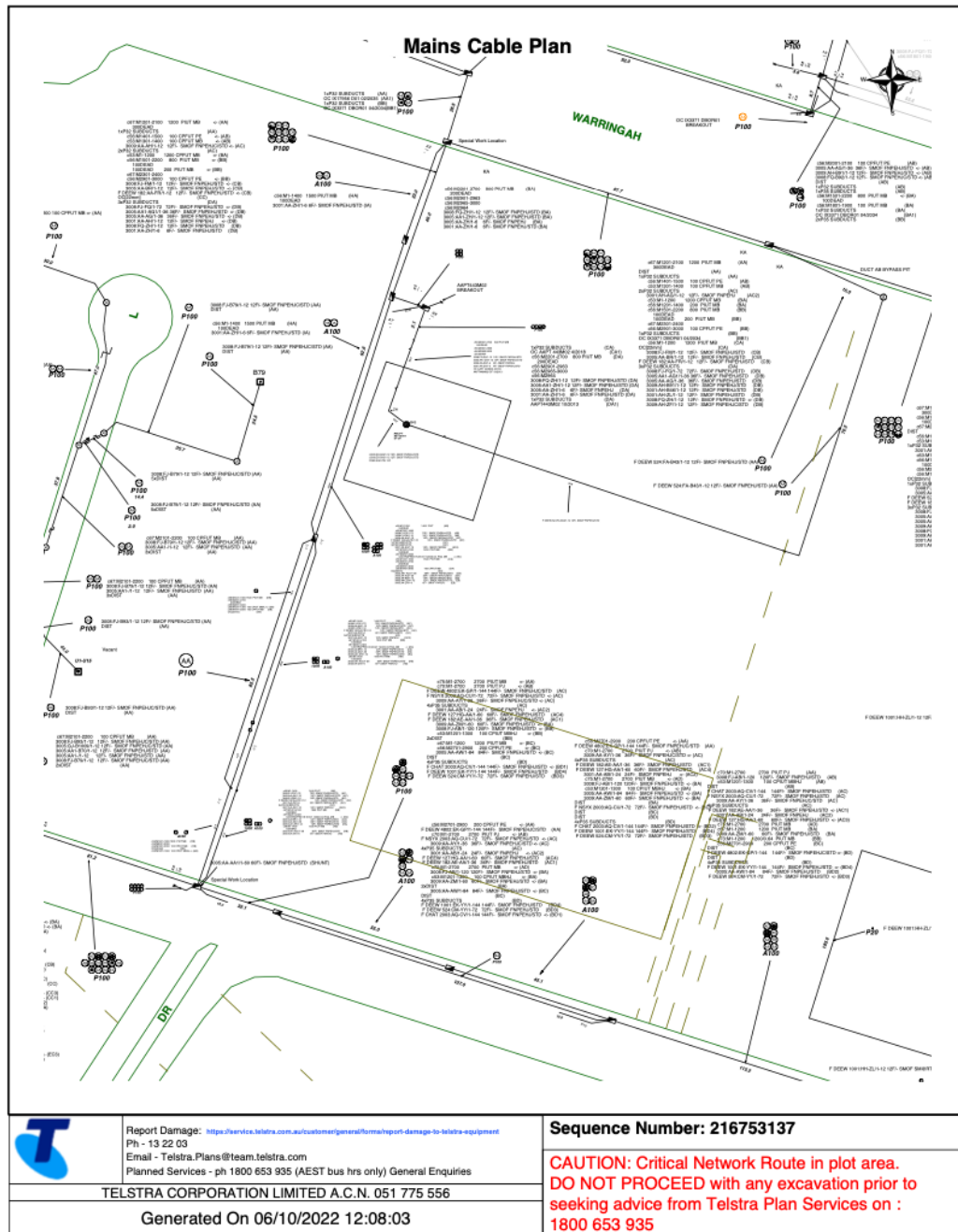

WARNING

Telstra plans and location information conform to Quality Level "D" of the Australian Standard AS 5488-Classification of Subsurface Utility Information. As such, Telstra supplied location information is indicative only. Spatial accuracy is not applicable to Quality Level D. Refer to AS 5488 for further details. The exact position of Telstra assets can only be validated by physically exposing it. Telstra does not warrant or hold out that its plans are accurate and accepts no responsibility for any inaccuracy. Further on site investigation is required to validate the exact location of Telstra plan prior to commencing construction work. A Certified Locating Organisation is an essential part of the process to validate the exact location of Telstra assets and to ensure the asset is protected during construction works.

See the Steps- Telstra Duty of Care that was provided in the email response.

NBN Co NSW/ Act

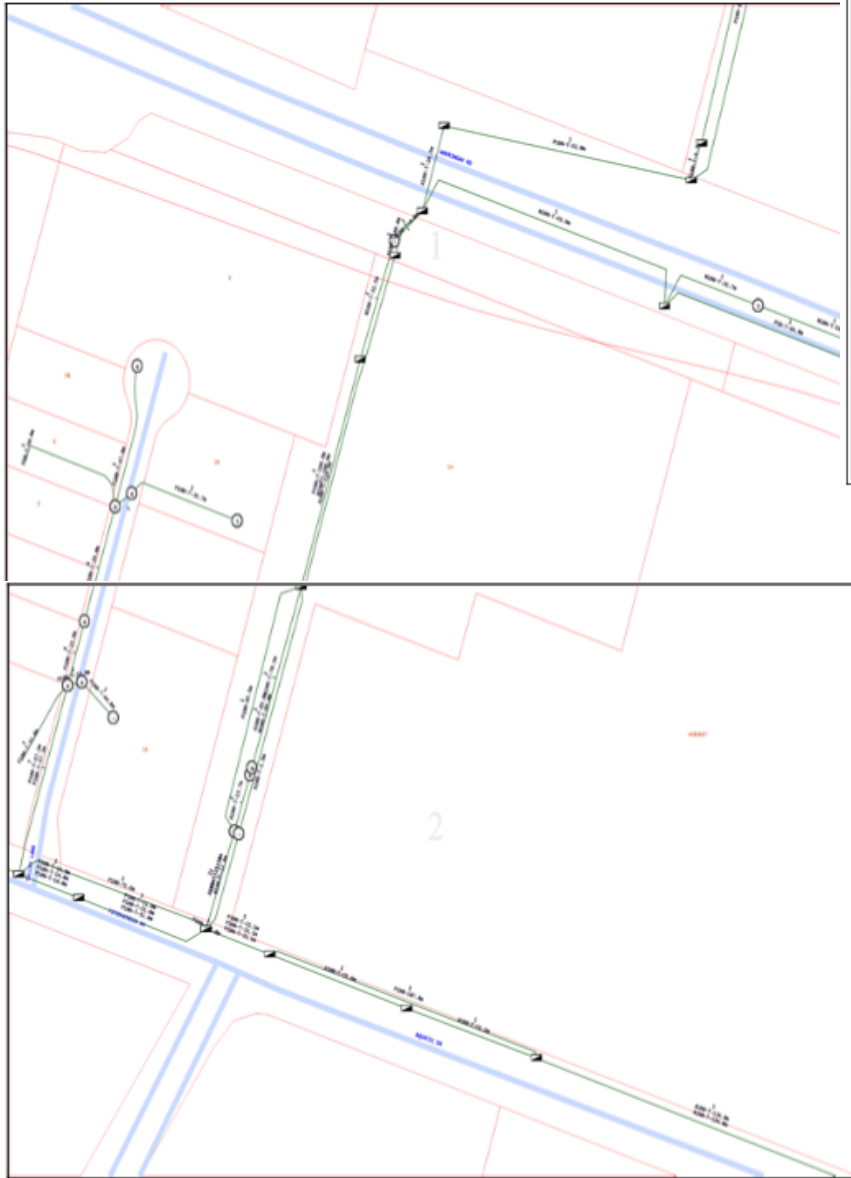

LEGEND	
	Parcel and the location
	Pit with size "5"
	Power Pit with size "25". Valid PIT Size: e.g. 2E, 5E, 6E, 8E, 9E, E, null.
	Manhole
	Pillar
	Cable count of trench is 2. One "Other size" PVC conduit (PO) owned by Telstra (-T-), between pits of sizes, "5" and "9" are 25.0m apart. One 40mm PVC conduit (P40) owned by NBN, between pits of sizes, "5" and "9" are 20.0m apart.
	2 Direct buried cables between pits of sizes, "5" and "9" are 10.0m apart.
	Trench containing any INSERVICE/CONSTRUCTED (Copper/RF/Fibre) cables.
	Trench containing only DESIGNED/PLANNED (Copper/RF/Fibre/Power) cables.
	Trench containing any INSERVICE/CONSTRUCTED (Power) cables.
	Road and the street name "Broadway ST"
	Scale 0 20 40 60 Meters 1:2000 1 cm equals 20 m

Emergency Contacts

You must immediately report any damage to the nbn™ network that you are/become aware of. Notification may be by telephone - 1800 626 329.

Optus and/or Uecomm



Tile No: 1

WARNING: This document is confidential and may also be privileged. Confidentiality nor privilege is not waived or destroyed by virtue of it being transmitted to an incorrect addressee. Unauthorised use of the contents is therefore strictly prohibited. Any information contained in this document that has been extracted from our records is believed to be accurate, but no responsibility is assumed for any error or omission. Optus Plans and information supplied are valid for 30 days from the date of issue. If this timeline has elapsed, please raise a new enquiry.

Sequence Number: 216753133

Date Generated: 06 Oct 2022



For all Optus DBYD plan enquiries –
Email: Fibre.Locations@optus.net.au
For urgent onsite assistance contact 1800 505 777
Optus Limited ACN 052 833 208



Plans generated 06 Oct 2022 by Pellicancorp TicketAccess Software | www.pellicancorp.com

TPG Telecom

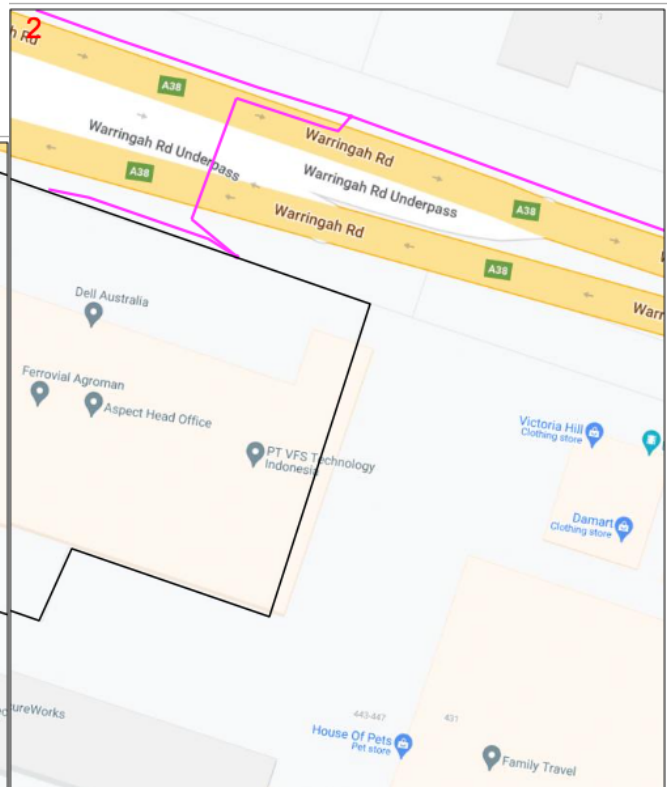
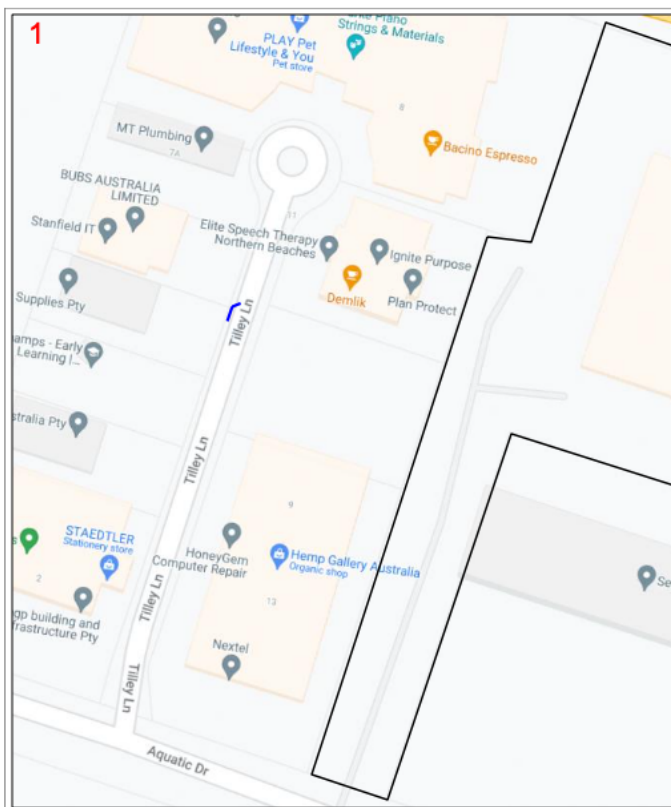
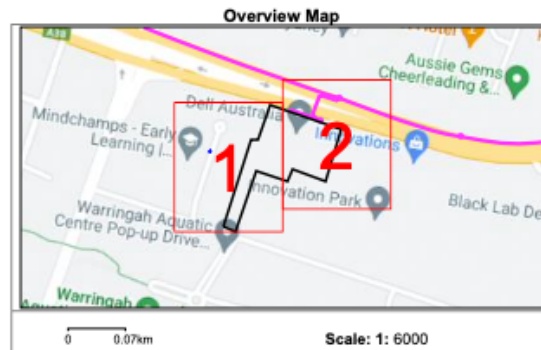

Enquiry Number: 216753143

Map Sheet: 1

Scale: 1: 750



LEGEND

BYDA Work Area	
AAPT/PowerTel Pit	TransACT Pit
AAPT/PowerTel Duct	TransACT Duct
DDA Pit	SOUL Pattinson Telecoms Pit
DDA Duct	SOUL Pattinson Telecoms Duct
Agile/Adam Pit	PIPE Networks Pit
Agile/Adam Duct	PIPE Networks Duct

Enquiry Number: 216753143

Map Sheet: 2

Scale: 1: 750

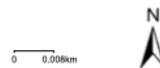

LEGEND

BYDA Work Area	
AAPT/PowerTel Pit	TransACT Pit
AAPT/PowerTel Duct	TransACT Duct
DDA Pit	SOUL Pattinson Telecoms Pit
DDA Duct	SOUL Pattinson Telecoms Duct
Agile/Adam Pit	PIPE Networks Pit
Agile/Adam Duct	PIPE Networks Duct

DISCLAIMER: No responsibility/liability is taken by TPG Telecom Limited for any inaccuracy, error, omission or action based on the information supplied in this correspondence. © 2022 TPG Telecom Limited.

Verizon Plan

Note: This Plan indicates the location of the Southern Cross Optic Fibre. This is an Optic Fibre of International Significance. It is Imperative that the appropriate action be taken if any works are undertaken within the vicinity of this asset

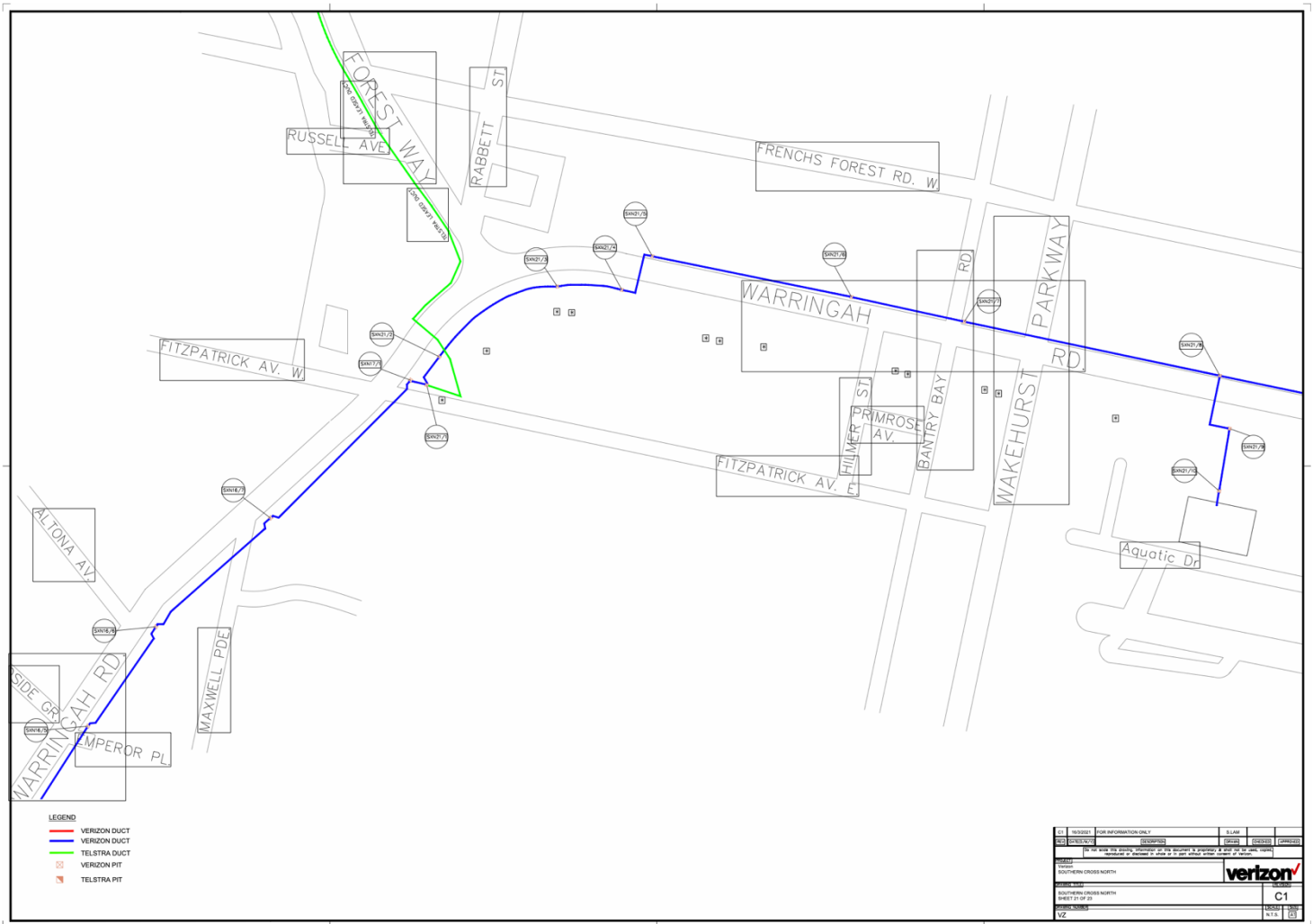

FibreSense Pty Ltd



WARNING

FiberSense DigitalAsset™ 'Sonar' monitoring is active in this area.

To:

Jonathan Watson
Not supplied

Job Number:	32859536
Sequence Number:	216753135
Activity:	Manual Excavation, Non-Destructive Digging
Location:	14 Aquatic Drive, Frenchs Forest NSW 2086
Commencement date:	06/10/2022
Completion date:	24/10/2022

Thank you for your Dial Before You Dig enquiry.

Please refer to other listed Utilities for underground asset location.

You have received this notification because an underground asset in the vicinity of your planned works is actively monitored 24x7 by the FiberSense DigitalAsset™ service on behalf of a utility-asset owner.

FiberSense requests the following information:

1. Site contact information

Name and phone number of a person who will be at the construction site:

- during working hours and,
- while the activity is being undertaken.

FiberSense will call this person as soon as we detect activity close to the asset.

Failure to provide this information may result in FiberSense dispatching field staff to site to assess the works. This could result in a call-out fee being charged.

FiberSense can be contacted via:

Email: noc@fiber-sense.com
Phone: [1300 947 466](tel:1300947466) (FiberSense NOC)

2. Details about Drilling activity

If you intend to conduct Horizontal or Vertical Drilling please provide FiberSense with the following additional information:

- Specific date(s) targeted for proposed drilling activity.
- Information in relation to the drill location, path and direction.

If you wish to know how FiberSense can reduce the risk of accidentally striking an underground asset, please contact us to find out more about our Virtual Stand-Over service.

Please note that the FiberSense DigitalAsset™ service is operated on behalf of an asset owner as an additional security measure and that FiberSense is not affiliated with Dial Before You Dig.

Vocus Communications 2

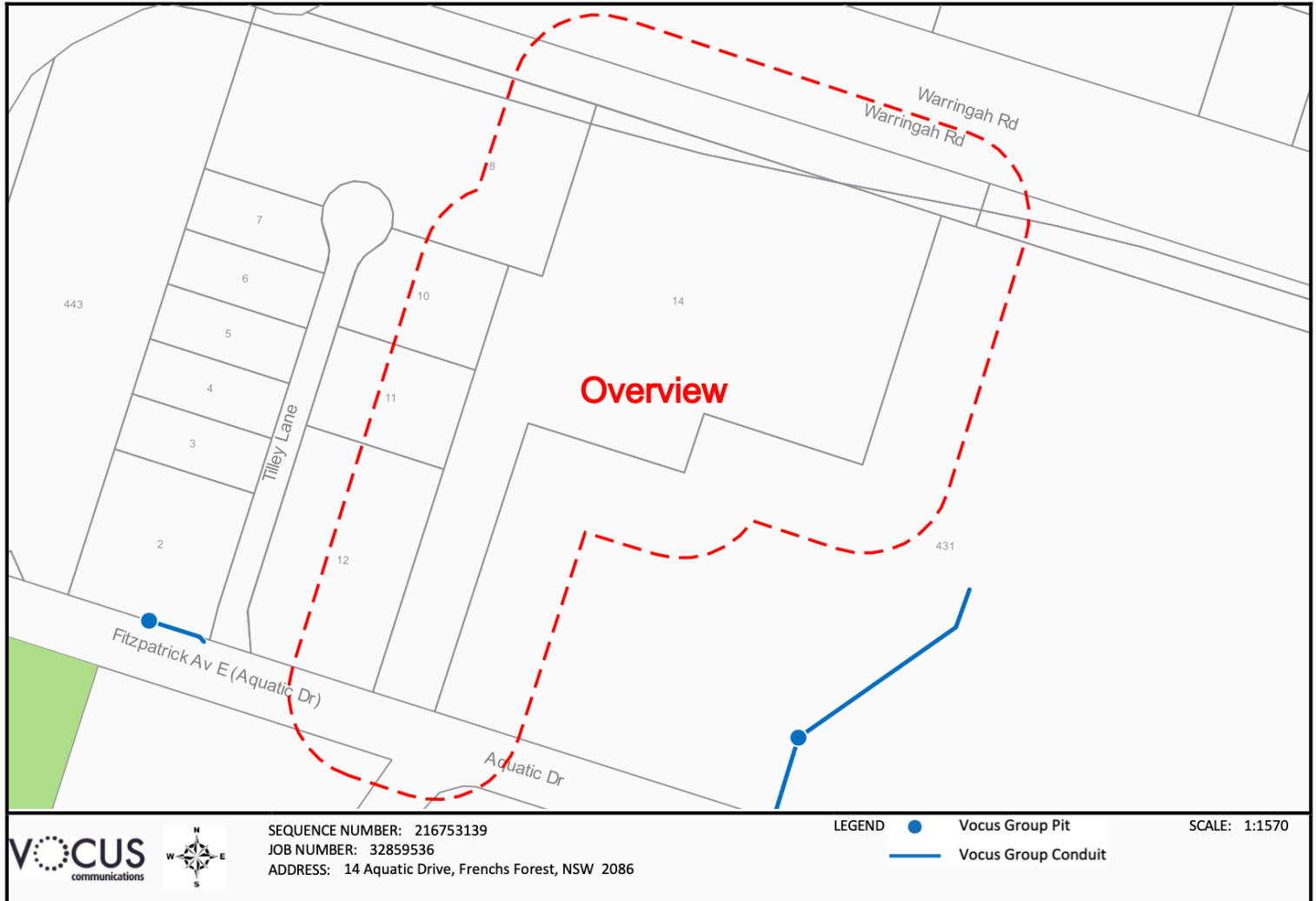

The Vocus Group includes related bodies corporate of Vocus Communications Limited ACN 084 115 499.

Ausgrid – Distribution

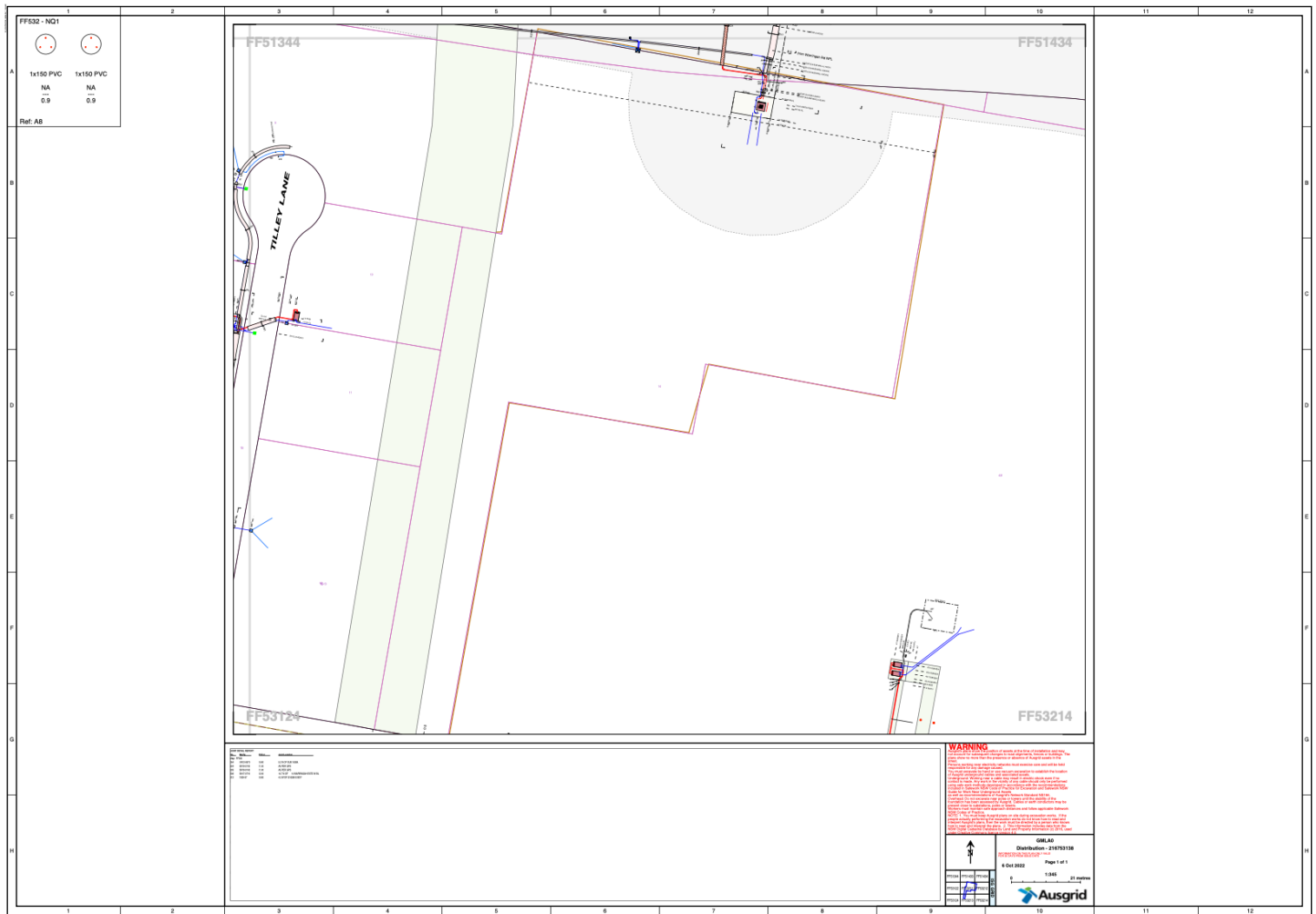

Jemena Gas - North

DBYD Authority: Jemena Gas Networks (NSW)

DBYD Location: 14 Aquatic Drive Frenchs Forest NSW, 2086

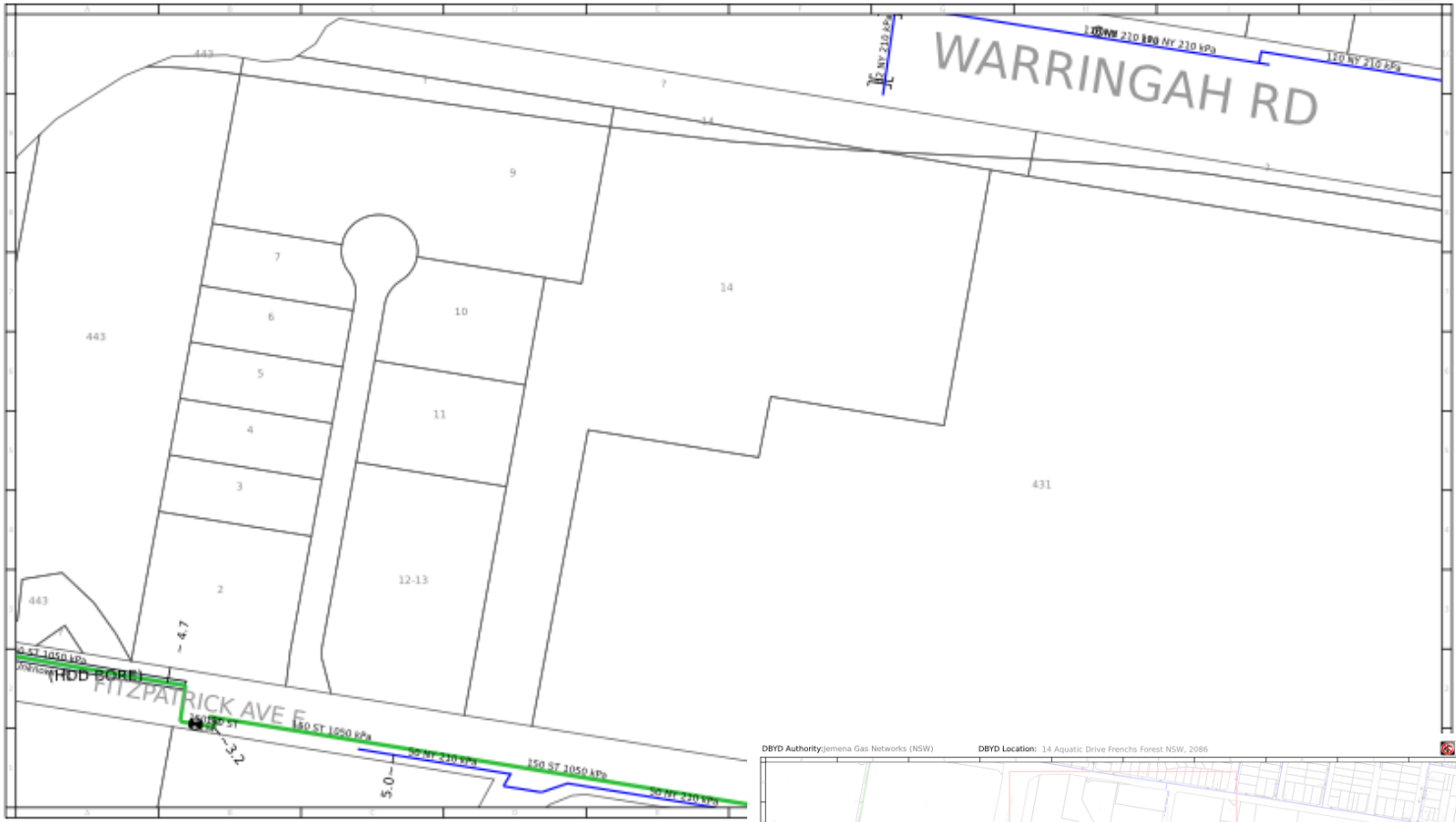

For legend details, please refer to the Coversheet attachment provided

WARNING: This is a representation of Jemena Gas Networks underground assets only and may not indicate all assets in the area. This plan is diagrammatic only, and distances scaled from this plan may not be accurate. Please read all conditions. The information contained on this plan is only valid for 28 days from the date of issue.

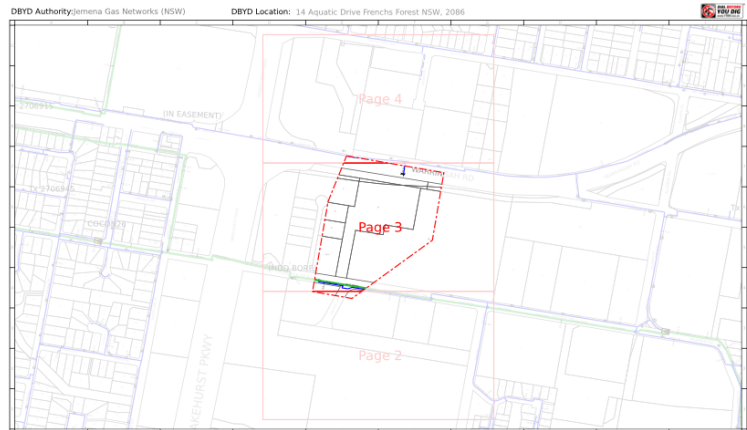

For legend details, please refer to the Coversheet attachment provided as part of this DBYD response.



Issue Date: 06/10/2022
DBYD Seq No: 216753140
DBYD Job No: 32859536
Overview Page:

WARNING: This is a representation of Jemena Gas Networks underground assets only and may not indicate all assets in the area. It must not be used for the purpose of locating assets in order to undertake any type of excavation. Please read all conditions and information on the attached information sheet. This contract is subject to these conditions. The information contained on this plan is only valid for 28 days from the date of issue.

Northern Beaches Council



Disclaimer

This plan includes information describing the location of subterranean features, which were purported to exist at the time of the survey. This information was compiled from a combination of field techniques and available data from cooperating utility authorities. Whilst all care has been taken in the preparation of this plan of survey, Qasar Subsurface Utility Consultants cannot guarantee that the plan is without flaw of any kind. Therefore, Qasar Subsurface Utility Consultants expressly disclaims all liability for errors or omissions of any kind whatsoever or from any loss, damage or other consequences, which may arise from any person relying on anything, stated on this plan. In particular, it is recommended that users satisfy themselves as to the location of subterranean features such as utilities, which may or may not be shown on this plan by deploying vacuum excavation techniques.