

WANDEARAH AVENUE

RIVIERA AVENUE

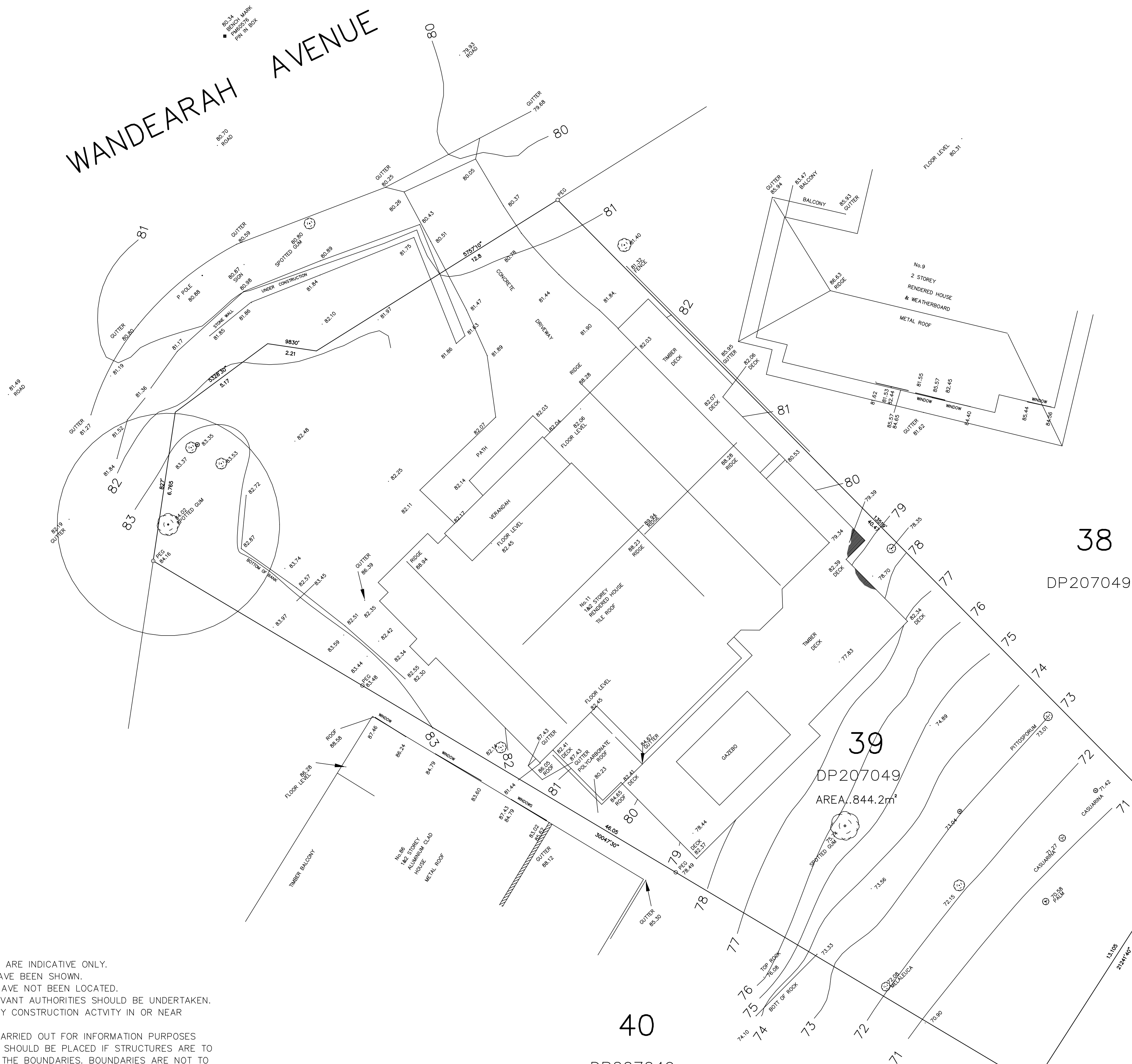

NOTES:

- TREE SPREADS & HEIGHTS ARE INDICATIVE ONLY.
- ONLY VISIBLE SERVICES HAVE BEEN SHOWN. UNDERGROUND SERVICES HAVE NOT BEEN LOCATED. NOTIFICATION OF ALL RELEVANT AUTHORITIES SHOULD BE UNDERTAKEN. BEFORE CARRYING OUT ANY CONSTRUCTION ACTIVITY IN OR NEAR THE SURVEYED AREA.
- THIS SURVEY HAS BEEN CARRIED OUT FOR INFORMATION PURPOSES ONLY AND SURVEY MARKS SHOULD BE PLACED IF STRUCTURES ARE TO BE ERECTED ON OR NEAR THE BOUNDARIES. BOUNDARIES ARE NOT TO BE ESTABLISHED FROM INFORMATION SHOWN ON DRAWING.
- CONTOUR INTERVAL - 1 METRE. CONTOURS ARE INDICATIVE ONLY. SPOT LEVELS SHOULD BE ADOPTED FOR DESIGN AND CALCULATION PURPOSES. CRITICAL SPOT LEVELS SHOULD BE CONFIRMED WITH SURVEYOR.
- ORIGIN OF LEVELS: P.M.60576 R..80.34 A.H.D. (SCIMS)
- COPYRIGHT ©

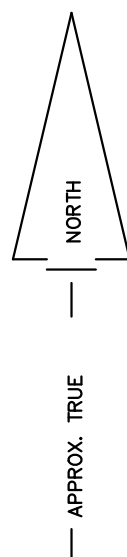

ADAM CLERKE SURVEYORS PTY LTD
Incorporating PAUL KEEN & COMPANY
LAND & ENGINEERING SURVEYORS
38 KEVIN AVENUE, AVALON 2107
TEL...9918 4111

DETAILS AND LEVELS OVER
LOT 39 IN D.P. 207049

11 WANDEARAH AVENUE, AVALON

DATE...	12/12/17	REF...	5884B
SCALE...	1:100/A1	DATUM...	A.H.D