

INVESTIGATION OF "DIAL BEFORE YOU DIG" UNDERGROUND SERVICES HAS BEEN MADE. DETECTION OF UNDERGROUND SERVICES IS NOT AN INTEGRAL PART OF THIS SURVEY. ALL RELEVANT AUTHORITIES SHOULD BE NOTIFIED PRIOR TO ANY EXCAVATION ON OR NEAR THE SITE.

DEVELOPERS & EXCAVATORS MAY BE HELD FINANCIALLY RESPONSIBLE BY THE ASSET OWNER SHOULD THEY DAMAGE UNDERGROUND NETWORKS.

CARELESS DIGGING CAN:
- CAUSE DEATH OR SERIOUS INJURY TO WORKERS AND THE GENERAL PUBLIC
- INCONVENIENCE USERS OF ELECTRICITY, GAS, WATER AND COMMUNICATIONS
- LEAD TO CRIMINAL PROSECUTION AND DAMAGES CLAIMS
- CAUSE EXPENSIVE FINANCIAL LOSSES TO BUSINESS
- OUT OF EMERGENCY SERVICES
- DELAY PROJECT COMPLETION TIMES WHILE THE DAMAGE IS REPAIRED

MINIMISE YOUR RISK AND DIAL BEFORE YOU DIG.
TEL. 1100

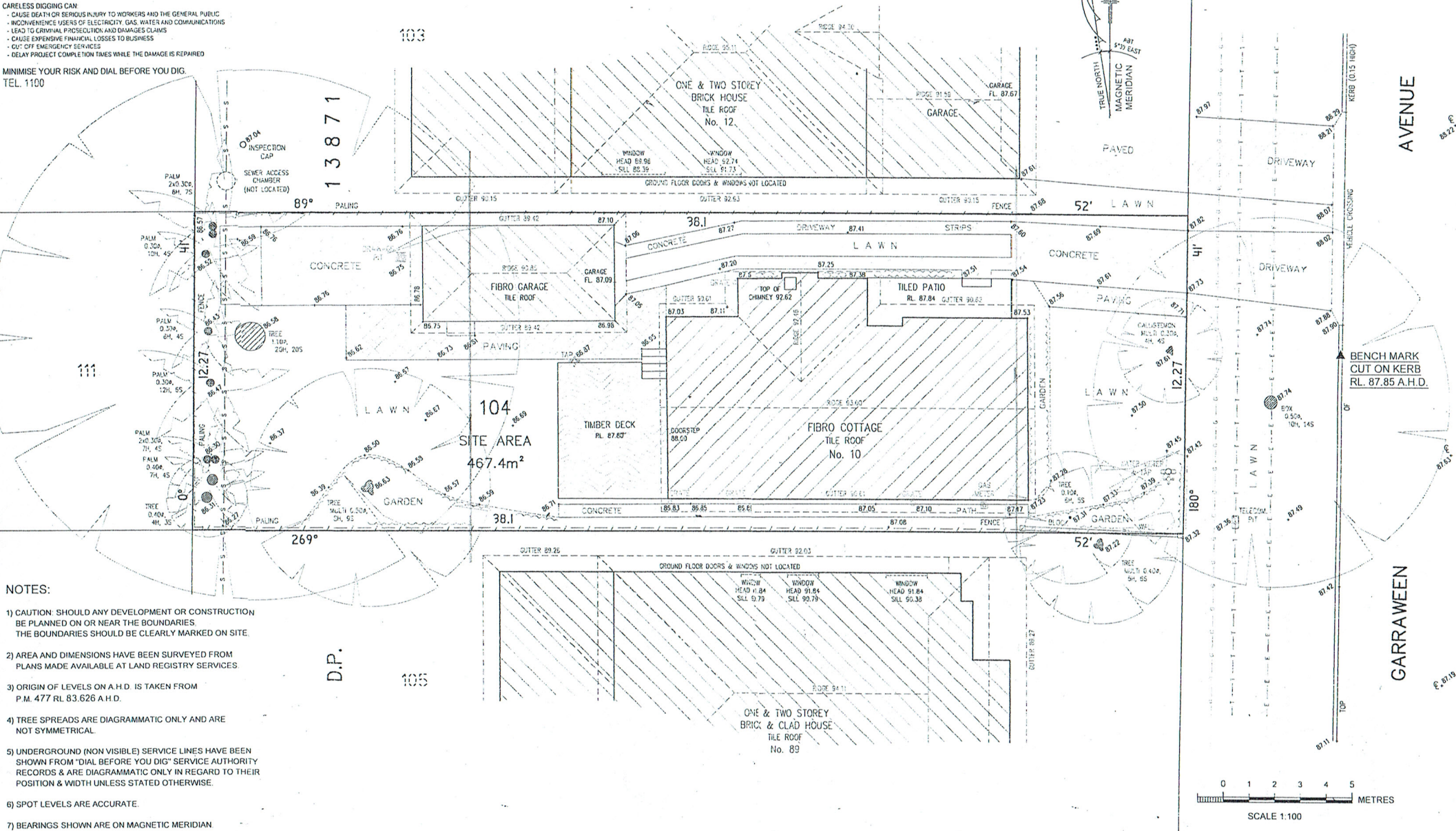

- NOTES:
- 1) CAUTION: SHOULD ANY DEVELOPMENT OR CONSTRUCTION BE PLANNED ON OR NEAR THE BOUNDARIES, THE BOUNDARIES SHOULD BE CLEARLY MARKED ON SITE.
 - 2) AREA AND DIMENSIONS HAVE BEEN SURVEYED FROM PLANS MADE AVAILABLE AT LAND REGISTRY SERVICES.
 - 3) ORIGIN OF LEVELS ON A.H.D. IS TAKEN FROM P.M. 477 RL 83.626 A.H.D.
 - 4) TREE SPREADS ARE DIAGRAMMATIC ONLY AND ARE NOT SYMMETRICAL.
 - 5) UNDERGROUND (NON VISIBLE) SERVICE LINES HAVE BEEN SHOWN FROM "DIAL BEFORE YOU DIG" SERVICE AUTHORITY RECORDS & ARE DIAGRAMMATIC ONLY IN REGARD TO THEIR POSITION & WIDTH UNLESS STATED OTHERWISE.
 - 6) SPOT LEVELS ARE ACCURATE.
 - 7) BEARINGS SHOWN ARE ON MAGNETIC MERIDIAN

Bee & Lethbridge
Quality Surveying & Development Solutions

Bee & Lethbridge Pty Ltd
Suite 2, 14 Starkey Street
PO Box 330, Forestville, NSW 2087
Phone: 9451 6757 Fax: 9975 3535
Email: survey@beeleth.com.au
ABN 13 003 194 447
www.beeleth.com.au

LEGEND

TREE
GUTTER
DENOTES APPROX. 100mm DIAMETER OF TREE
DENOTES APPROX. 5m HEIGHT OF TREE
DENOTES APPROX. 4m SPREAD OF TREE
DENOTES CENTRE LINE OF ROAD
DENOTES TOP OF GUTTER

CLAY-PIPE, PLASTIC LINES
BOARDS SEWER
TELECOMMUNICATION LINES
GAS LINES

PLAN SHOWING BOUNDARIES, RELATIVE HEIGHTS & PHYSICAL FEATURES OVER LOT 104 IN D.P. 13871
KNOWNAS No. 10 GARRARWEEN AVENUE, NORTH BALGOWLAH.
L.G.A.: NORTHERN BEACHES

CLIENT				Mr. S. PFAFFLIN		REF No	
PROPERTY				No. 10 GARRAWEEEN AVENUE, NORTH BALGOWLAH			
DATE		A.H.D.		SCALE		1:100 @ A2	
DATE		A.H.D.		DATE		06/02/2018	
SURVEYED		L.P.		DRAWN		R.M.	
SURVEYED		L.P.		DWG No		21187	
SHEET No		1 of 1		REV No		00	