

1 12A-B JOHN ST SUBDIVISION
200 1 : 200

ARCHITECTS WORK IS COPYRIGHT AND COVERED BY COPYRIGHT ACT 1968
DRAWINGS NOT TO BE SCALED. USE FIGURED DIMENSIONS ONLY. CHECK ALL DIMENSIONS ON SITE. ELECTRONIC COPIES OF DRAWINGS SHOULD BE VERIFIED AGAINST PRINTED COPIES TO ENSURE NO LOSS OF INFORMATION.



ph. 02 9918 5085
e. tim@thw.net.au
m. Suite 101 - Level 1, 60 Old Barrenjoey rd, Avalon NSW, 2107
reg# NSW 7417 - TIM WEST

SURVEY
BEE & LETHBRIDGE PTY LTD
SUITE 2, 14 STARKEY ST, FORESTVILLE, NSW, 2087
P. 9975 3535
E. SURVEY@BEELETH.COM.AU
W. BEELETH.COM.AU

STORMWATER / FLOOD
BARRENJOEY CONSULTING ENGINEERS
34 GEORGE ST, AVALON, NSW, 2107
LUCAS@BCE@BCEPOND.COM
0418 620 330

PLANNER
VAUGHAN MULLIGAN DEVELOPMENT CONSULTING
VAUGHAN MULLIGAN
8/1 KALINYA ST, NEWPORT, NSW, 2106
9999 4922

BASIX / NATHERS
SUSTAINABLE THERMAL SOLUTIONS
138 COWLES RD, MOSMAN, NSW, 2088
ENQUIRIES@SUSTAINABLETHERMALSOLUTIONS.COM.AU
0420 312 721

LANDSCAPE
A TOTAL CONCEPT
65 WEST ST, NORTH SYDNEY, NSW, 2060
DESIGN@TOTALCONCEPT.COM.AU
9957 5122

BIODIVERSITY / COASTAL
ECOLOGICAL CONSULTANTS AUSTRALIA
ECOLOGICALCA@OUTLOOK.COM
9918 4486

PROJECT
PROPOSED DWELLING
12A JOHN ST, AVALON, NSW, 2107

CLIENT
TIM DONOVAN
TDONOVAN@CITYFREEHOLDS.COM.AU

F 01/02/2021 PRELIMINARY DA
IS DATE COMMENTS

JOB NUM# 142
DRAWN BY MV
CHK. BY TW

PROJECT NAME
12A JOHN ST

DRAWING NAME
12A-B JOHN ST SUBDIVISION

PAGE SIZE
A2

SCALE
1:100

DRAWING NUMBER
A 200 -F

KEY:
PROPOSED SITE
RIPARIAN ZONE
ENCROACHMENT
OFFSET (71m²)



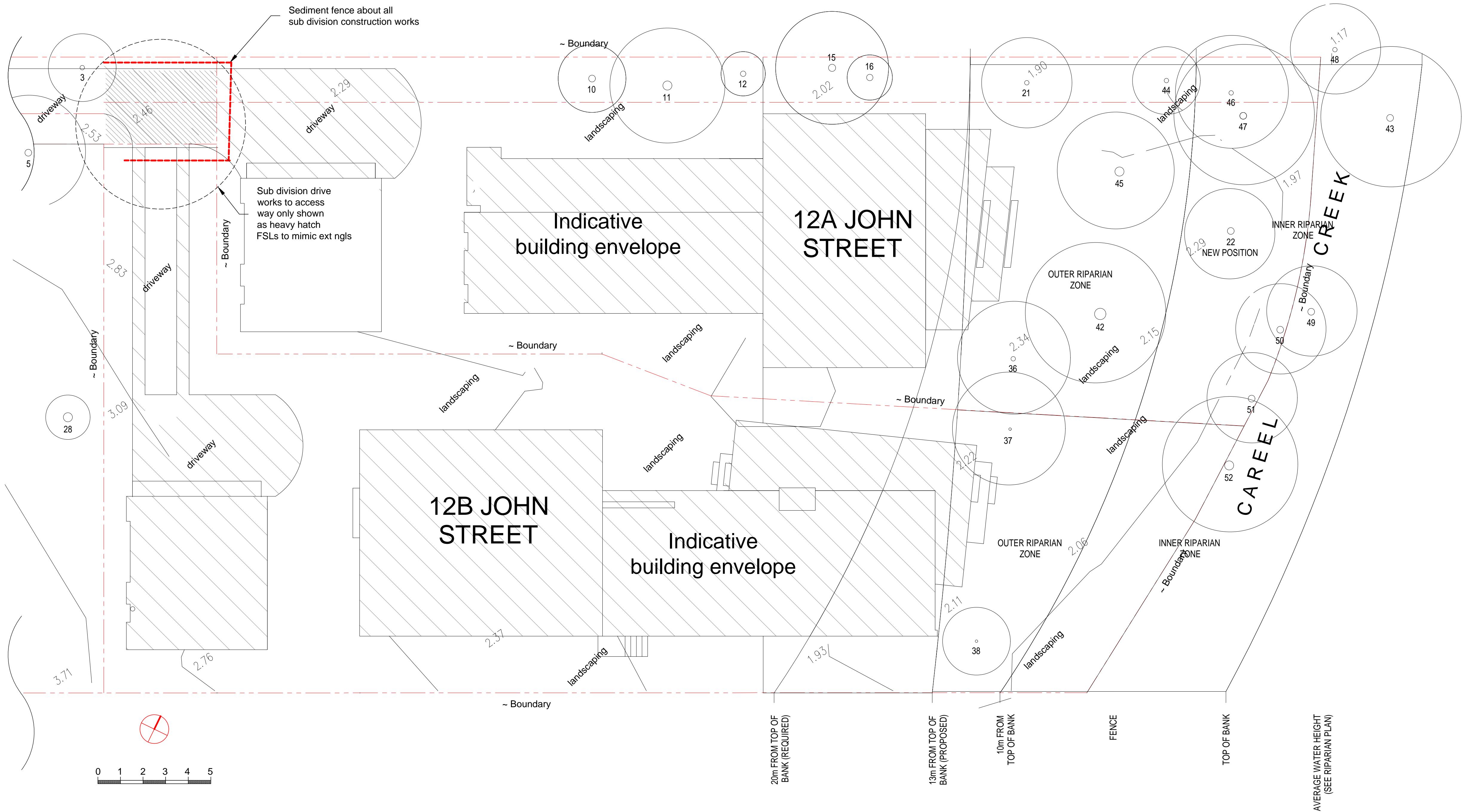

SEDIMENT & EROSION CONTROL PLAN

~ 1:100

All excavation works to be carried out in a safe building manner in accordance with NCC and industry standards etc.
Sediment and erosion control measures to be installed before any excavation works and monitored / improved continually to prevent sediment leaving the site, including immediate cleaning of spillage etc from vehicles leaving the property.
All material stock piles to be protected from rainfall and runoff at all times.

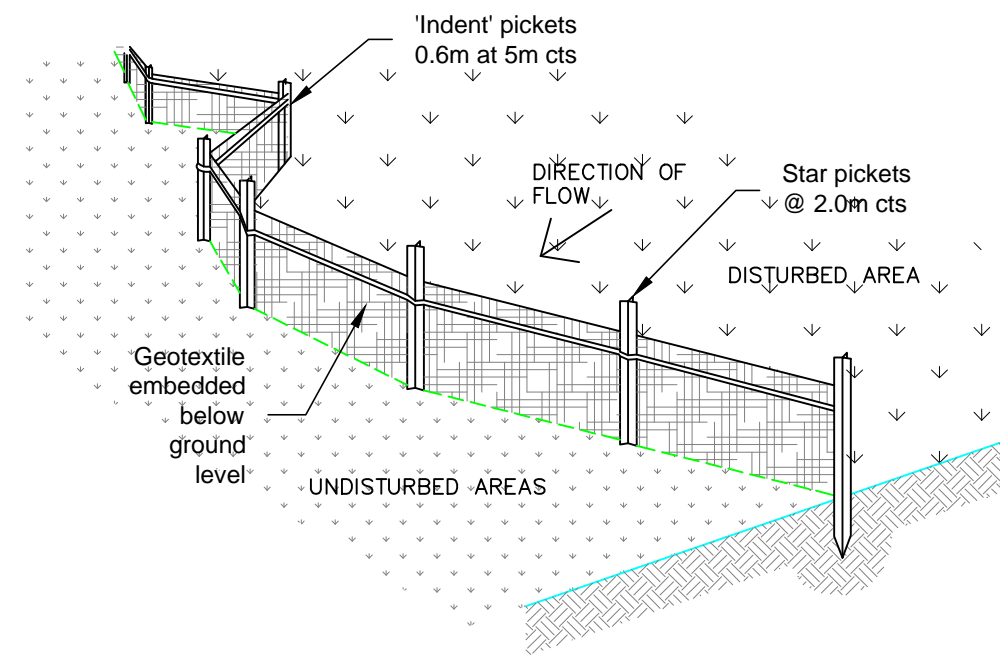

SEDIMENT FENCE

SEDIMENT FENCE CONSTRUCTION NOTES:

1. CONSTRUCT SEDIMENT FENCES AS CLOSE AS POSSIBLE TO BEING PARALLEL TO THE CONTOURS OF THE SITE, BUT WITH SMALL RETURNS AS SHOWN IN THE DRAWING TO LIMIT THE CATCHMENT AREA OF ANY ONE SECTION. THE CATCHMENT AREA SHOULD BE SMALL ENOUGH TO LIMIT WATER FLOW.
2. CUT A 150mm DEEP TRENCH ALONG THE UPSLOPE LINE OF THE FENCE FOR THE BOTTOM OF THE FABRIC TO BE ENTRENCHED.
3. DRIVE 1.5m LONG STAR PICKETS INTO GROUND @ 2.5m INTERVALS (MAX.) AT THE DOWNSLOPE EDGE OF THE TRENCH. ENSURE ANY STAR PICKETS ARE FITTED WITH SAFETY CAPS.
4. FIX SELF-SUPPORTING GEOTEXTILE TO THE UPSLOPE SIDE OF THE POSTS ENSURING IT GOES TO THE BASE OF THE TRENCH. FIX THE GEOTEXTILE WITH WIRE TIES OR AS RECOMMENDED BY THE MANUFACTURER. ONLY USE GEOTEXTILE SPECIFICALLY PRODUCED FOR SEDIMENT FENCING. THE USE OF SHADE CLOTH FOR THIS PURPOSE IS NOT SATISFACTORY.
5. JOIN SECTIONS OF FABRIC AT A SUPPORT POST WITH A 150mm OVERLAP.
6. BACKFILL THE TRENCH OVER THE BASE OF THE FABRIC AND COMPACT IT THOROUGHLY OVER THE GEOTEXTILE.

A1

ISSUE:		
Prelim	30. 09. 2019	Issued for comment
DA	07. 11. 2019	Issued for DA submission
DA - A	03. 03. 2021	general amendment

Barrenjoey Consulting Engineers pty ltd
Stormwater Structural Civil
PO Box 672
Avalon NSW 21137
M: 0418 620 330
E: lucas@bigpond.com
ABN: 13124694917
ACN: 124694917

PROJECT:

PROPOSED SUBDIVISION
12A JOHN STREET
AVALON

DRAWING :

SEDIMENT & EROSION
CONTROL PLAN

Job No : 181005 _{SUB}	Drawing No CIV1 _{DA-A}
Document Certification Barrenjoey Consulting Engineers <small>pty ltd</small> per Lucas Molloy MIEA CPEng NEER Director	

MARCH 2021

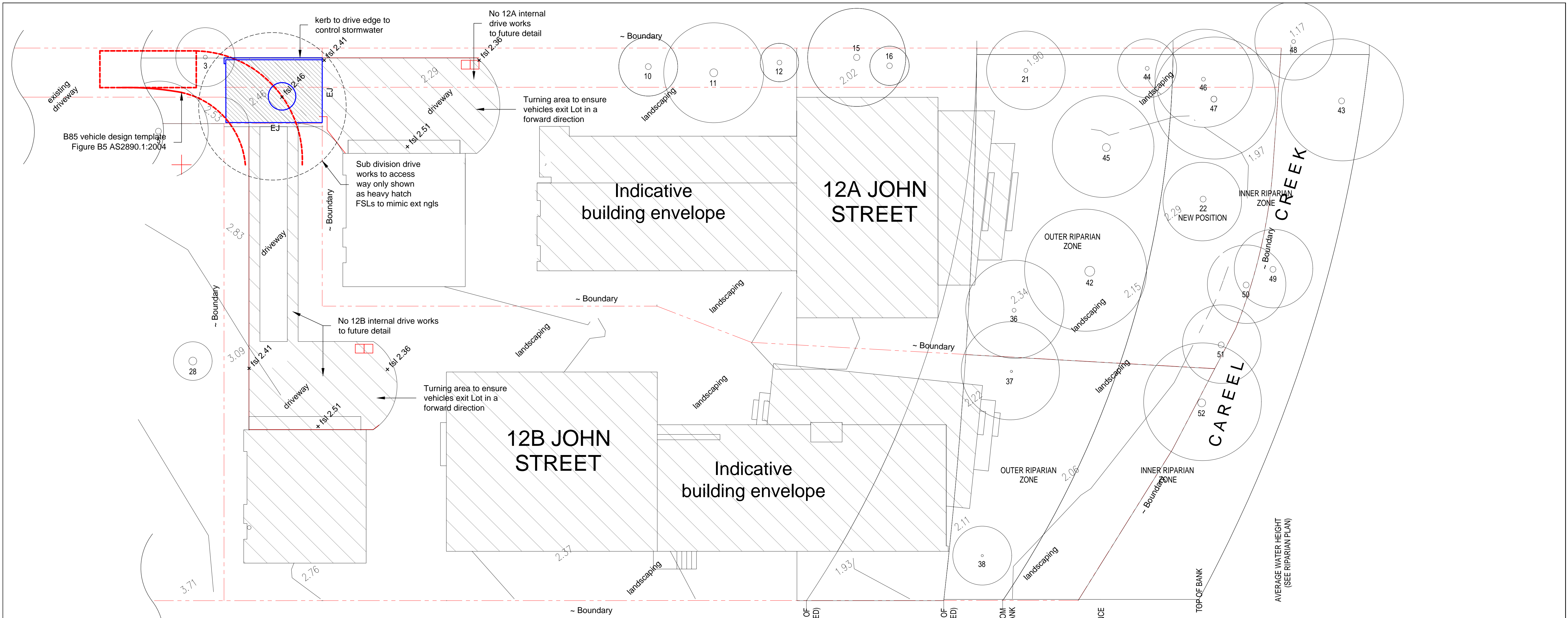

DRIVEWAY LAYOUT & SLAB PLAN

~ 1:100

- Slabs
- 130mm (all on sound stable sub grade)
 - 250x250 downturns allround
 - SL92 Top
 - 32 MPa
- EJ
- Expansion Joint
- SC
- Saw Cut

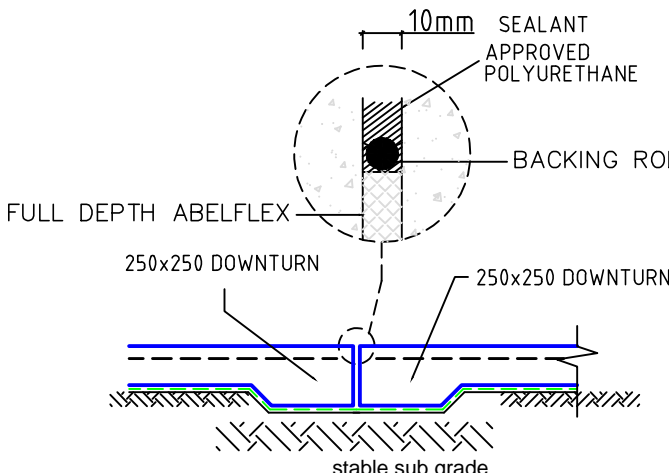

EXPANSION JOINT
DETAIL

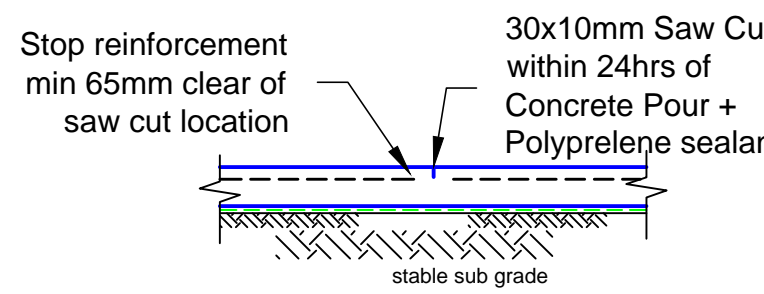

SAW CUT
DETAIL

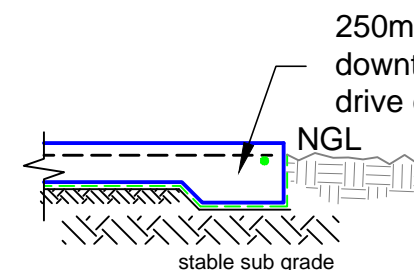

DRIVE EDGE
DETAIL

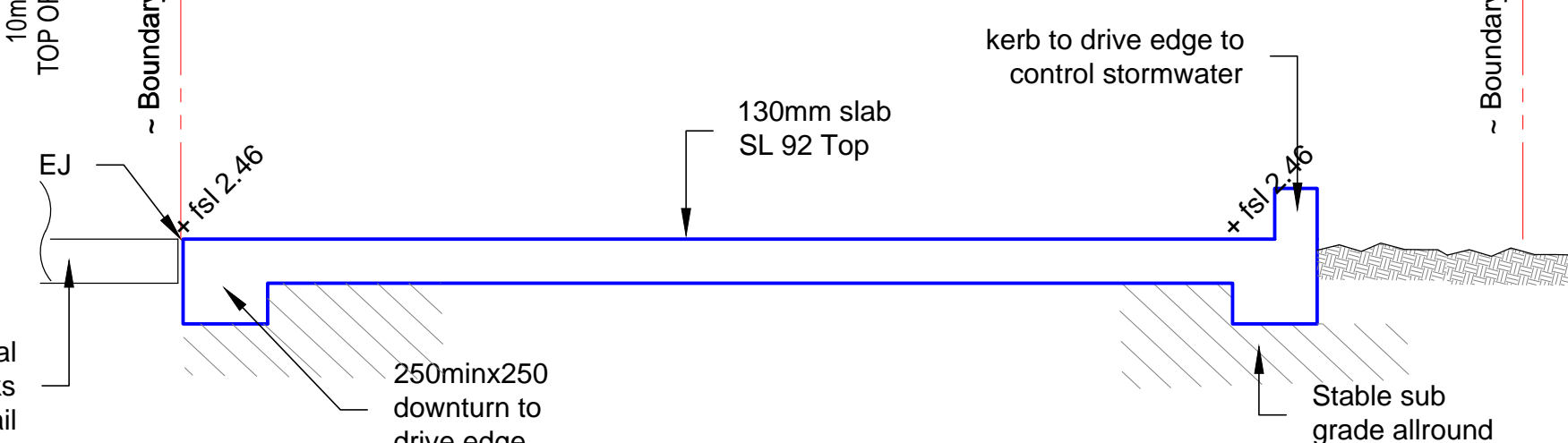

DRIVEWAY CROSS SECTION

~ 1:20

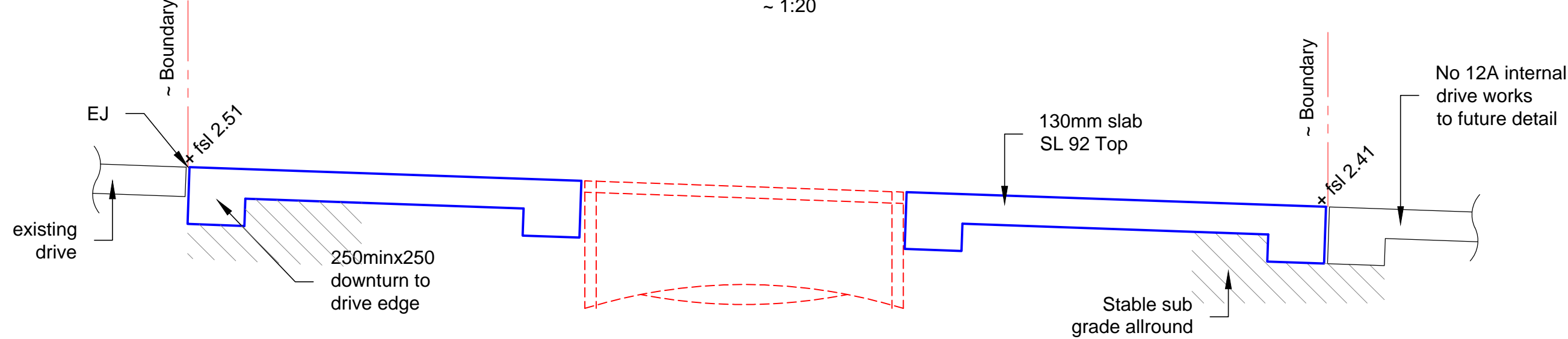

DRIVEWAY LONG SECTION

~ 1:20

ISSUE:		
Prelim	30. 09. 2019	Issued for comment
DA	07. 11. 2019	Issued for DA submission
DA - A	03. 03. 2021	general amendment

Barrenjoey Consulting Engineers Pty Ltd
Stormwater Structural Civil
PO Box 672
Avalon NSW 21137
M: 0418 620 330
E: lucas@barrenjoey.com.au
ABN: 13124694917
ACN: 124694917

PROJECT:

PROPOSED SUBDIVISION
12A JOHN STREET
AVALON

DRAWING :

DRIVEWAY LAYOUT
& SLAB PLAN / DETAILING

Job No :
181005_{SUB}
Drawing No
DV1_{DA-A}
Document Certification
Barrenjoey Consulting Engineers Pty Ltd
per
Lucas Molloy MIEA CPEng NER Director
MARCH 2021

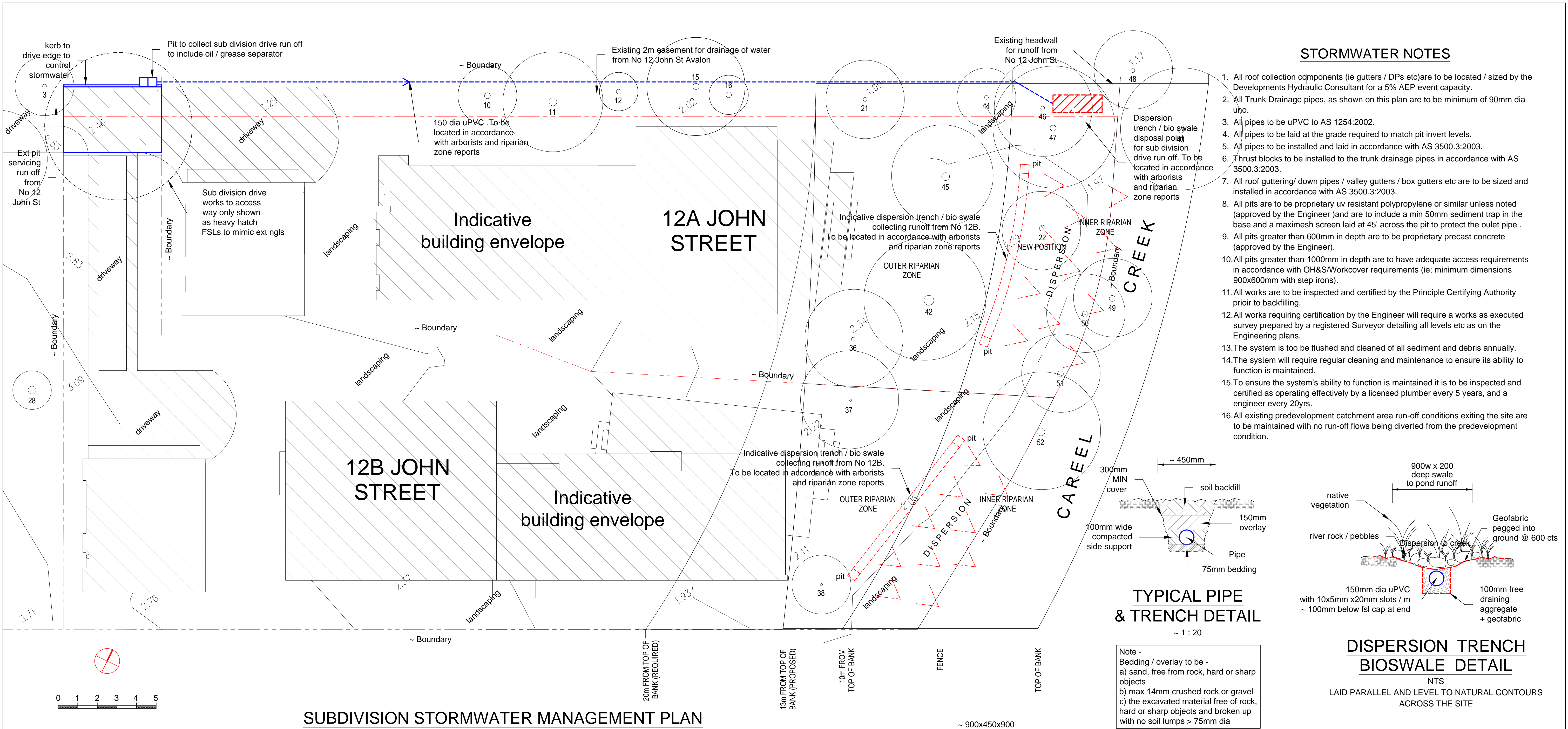

STORMWATER NOTES

- 1. All roof collection components (ie gutters / DPs etc) are to be located / sized by the Developments Hydraulic Consultant for a 5% AEP event capacity.
- 2. All Trunk Drainage pipes, as shown on this plan are to be minimum of 90mm dia uPVC.
- 3. All pipes to be uPVC to AS 1254:2002.
- 4. All pipes to be laid at the grade required to match pit invert levels.
- 5. All pipes to be installed and laid in accordance with AS 3500.3:2003.
- 6. Thrust blocks to be installed to the trunk drainage pipes in accordance with AS 3500.3:2003.
- 7. All roof guttering/ down pipes / valley gutters / box gutters etc are to be sized and installed in accordance with AS 3500.3:2003.
- 8. All pits are to be proprietary uv resistant polypropylene or similar unless noted (approved by the Engineer) and are to include a min 50mm sediment trap in the base and a maximesh screen laid at 45° across the pit to protect the outlet pipe.
- 9. All pits greater than 600mm in depth are to be proprietary precast concrete (approved by the Engineer).
- 10. All pits greater than 1000mm in depth are to have adequate access requirements in accordance with OH&S/Workcover requirements (ie; minimum dimensions 900x600mm with step irons).
- 11. All works are to be inspected and certified by the Principle Certifying Authority prior to backfilling.
- 12. All works requiring certification by the Engineer will require a works as executed survey prepared by a registered Surveyor detailing all levels etc as on the Engineering plans.
- 13. The system is to be flushed and cleaned of all sediment and debris annually.
- 14. The system will require regular cleaning and maintenance to ensure its ability to function is maintained.
- 15. To ensure the system's ability to function is maintained it is to be inspected and certified as operating effectively by a licensed plumber every 5 years, and an engineer every 20yrs.
- 16. All existing predevelopment catchment area run-off conditions exiting the site are to be maintained with no run-off flows being diverted from the predevelopment condition.

TYPICAL PIPE & TRENCH DETAIL

~ 1 : 20

DISPERSION TRENCH BIOSWALE DETAIL

NTS
LAID PARALLEL AND LEVEL TO NATURAL CONTOURS ACROSS THE SITE

SUBDIVISION STORMWATER MANAGEMENT PLAN

~ 1:100

Pittwater 21 DCP Section B5 Water Management Compliance -

- | | |
|---|---|
| B5.1 Water Management Plan | - subdivision works storm water management addressed within this plan, rainwater, grey water and waste water details all convention systems |
| B5.4 Storm Water Harvesting | - not applicable to this development / subdivision works (refer DA for residences and BASIX certificate/storage requirements) |
| B5.5 Rainwater Tanks | - not applicable to this development / subdivision works |
| B5.6 Rainwater Tanks - Water Supply | - not applicable to this development / subdivision works |
| B5.7 Storm Water Management Onsite Detention | - not applicable to this development / subdivision works (note discharge to Careel Creek) |
| B5.8 Stormwater Management - Water Quality Low Density Residential | - Primary, Secondary and Tertiary treatment systems specified |
| B5.9 Stormwater Management Water Quality Other than Low Density Residential | - Primary, Secondary and Tertiary treatment systems specified |
| B5.10 Stormwater Discharge into Public Drainage system | - not applicable to this development, discharge to Careel Creek |
| B5.11 Stormwater Discharge into Waterways and Coastal Areas | - not applicable to this development, discharge to Careel Creek |
| B5.12 Stormwater Drainage Systems and Natural Watercourses | - discharge to Careel Creek |
| B5.13 Development on Waterfront Land | - not applicable to this development / subdivision works |
| B5.14 Stormwater Drainage Easements | - not applicable to this development / subdivision works |

Detailed drainage is to be sized for Construction Certificate submission / Tender documentation by the buildings consulting hydraulic engineer to NCC and Australian Standards.
Variations to layout to be reviewed and approved by Barrenjoey Consulting Engineers before construction.

OIL / GREASE SEPERATOR PIT DETAIL

NTS
(to include service/maintenance schedule)

TYPICAL PIT DETAIL

NTS

ISSUE:			
Prelim	30. 09. 2019	Issued for comment	
DA	07. 11. 2019	Issued for DA submission	
DA- Rev A	26. 11. 2020	Revised and issued for comment	
DA- B	03. 03. 2021	general amendments	

Barrenjoey Consulting Engineers pty ltd
Stormwater Structural Civil
PO Box 672
Avalon NSW 2107
M: 0418 620 330
E: lucas@barrenjoey.com.au
ABN: 13124694917
ACN: 124694917

PROJECT:

PROPOSED SUBDIVISION
12A JOHN STREET
AVALON

DRAWING :

STORMWATER MANAGEMENT
& ASSETS PLAN

Job No : 181005 _{SUB}	Drawing No SW1 _{DA - B}
Document Certification Barrenjoey Consulting Engineers pty ltd per Lucas Molloy MIEA CPEng NER Director	