

(X) - BENEFITED BY:  
 - RIGHT OF CARRIAGEWAY VAR. WIDTH (DP1017487)  
 - EASEMENT FOR SERVICES VAR. WIDTH (DP1017487)  
 - EASEMENT TO DRAIN WATER VAR. WIDTH (DP1017487)  
 - RESTRICTION ON THE USE OF LAND NO. 10, 11, 12, 13 & 14 - DP1017487  
 - POSITIVE COVENANT (AE658038)

(Y) COVENANT (A885883)

THE BOUNDARY OF LOT 12 DENOTED 'A'-'B'-'C'-'D'-'E'-'F'-'G' HAS BEEN COMPILED AND NOT SURVEYED.

EASEMENTS  
 [A] - RIGHT OF ACCESS 3.5 AND 9.6 WIDE  
 [B] - EASEMENT FOR UNDERGROUND SERVICES 1 WIDE  
 [C] - RESTRICTED AREA WITHIN EASEMENT [A] 7.3 WIDE

EXISTING EASEMENTS  
 [D] - RIGHT OF CARRIAGEWAY VAR WIDTH (DP1017487)  
 [E] - RIGHT OF ACCESS VAR WIDTH (DP1017487)  
 [F] - EASEMENT TO PERMIT ENCRANCHING STRUCTURE TO REMAIN VAR WIDTH (DP1017487)  
 [G] - RIGHT OF CARRIAGEWAY VAR WIDTH (DP1017487)  
 [H] - RIGHT OF ACCESS VAR WIDTH (DP1017487)  
 [J] - EASEMENT FOR USE OF INCLINATOR VAR WIDTH (DP1017487)  
 [K] - RESTRICTION ON THE USE OF LAND (DP1017487)  
 [L] - RESTRICTION ON THE USE OF LAND (DP1017487)  
 [M] - RESTRICTION ON THE USE OF LAND (DP1017487)

COORDINATE SCHEDULE						
MARK	M.G.A. CO-ORDINATES		CLASS	PU	METHOD	STATE
	EASTING	NORTHING				
SSM 38193	344230.759	6281661.169	B	-	SCIMS	FOUND
PM 11657	344202.127	6281798.741	B	-	SCIMS	FOUND
PM 40338	344306.073	6281763.768	B	0.02	SCIMS	FOUND
DATE OF SCIMS CO-ORDINATES: 21/8/2020 MGA ZONE: 56 MGA DATUM: GDA2020 COMBINED SCALE FACTOR 0.999895						

SURVEYOR  
 Name: William Hamer  
 Date: 28/8/2020  
 Reference: 170598-3

PLAN OF SUBDIVISION OF LOT 1 DP668492  
 LOTS A & C DP341607, LOT 21 DP1017487  
 & LOT 1 DP 1127631

LGA: NORTHERN BEACHES  
 Locality: PALM BEACH  
 Reduction Ratio: 1:400  
 Lengths are in metres.

Registered  
  
 30/03/2022

**DP 1275411**

10	20	30	40	50	60	70	80	90	100	110	120	130	140	150
----	----	----	----	----	----	----	----	----	-----	-----	-----	-----	-----	-----

**NOTE:**

BOUNDARIES HAVE BEEN DETERMINED BY SURVEY ON 06/04/2016.  
 PRIOR TO ANY CONSTRUCTION WORK, SURVEY MARKS SHOULD BE PLACED TO DEFINE THE PROPERTY BOUNDARIES.  
 SERVICES SHOWN ARE INDICATIVE ONLY. POSITIONS ARE BASED ON SURFACE INDICATOR(S) LOCATED DURING FIELD SURVEY. CONFIRMATION OF THE EXACT POSITION SHOULD BE MADE PRIOR TO ANY EXCAVATION WORK. OTHER SERVICES MAY EXIST WHICH ARE NOT SHOWN.  
 LEVELS ARE BASED ON AUSTRALIAN HEIGHT DATUM (AHD) USING PM 40338 WITH RL 3.244 (AHD).  
 RIDGE & GUTTER HEIGHTS HAVE BEEN OBTAINED BY INDIRECT METHOD AND ARE ACCURATE TO ± 0.05m.  
 CONTOURS SHOWN DEPICT THE TOPOGRAPHY. EXCEPT AT SPOT LEVELS SHOWN THEY DO NOT REPRESENT THE EXACT LEVEL AT ANY PARTICULAR POINT. THE SPOT LEVELS ARE TRUE FOR THEIR POSITION, AND ARE INTENDED TO BE USEFUL TO REPRESENT THE GENERAL TERRAIN. CARE SHOULD BE TAKEN IF EXTRAPOLATING.  
 AB88883 COVENANT BY FOLIO 11127631

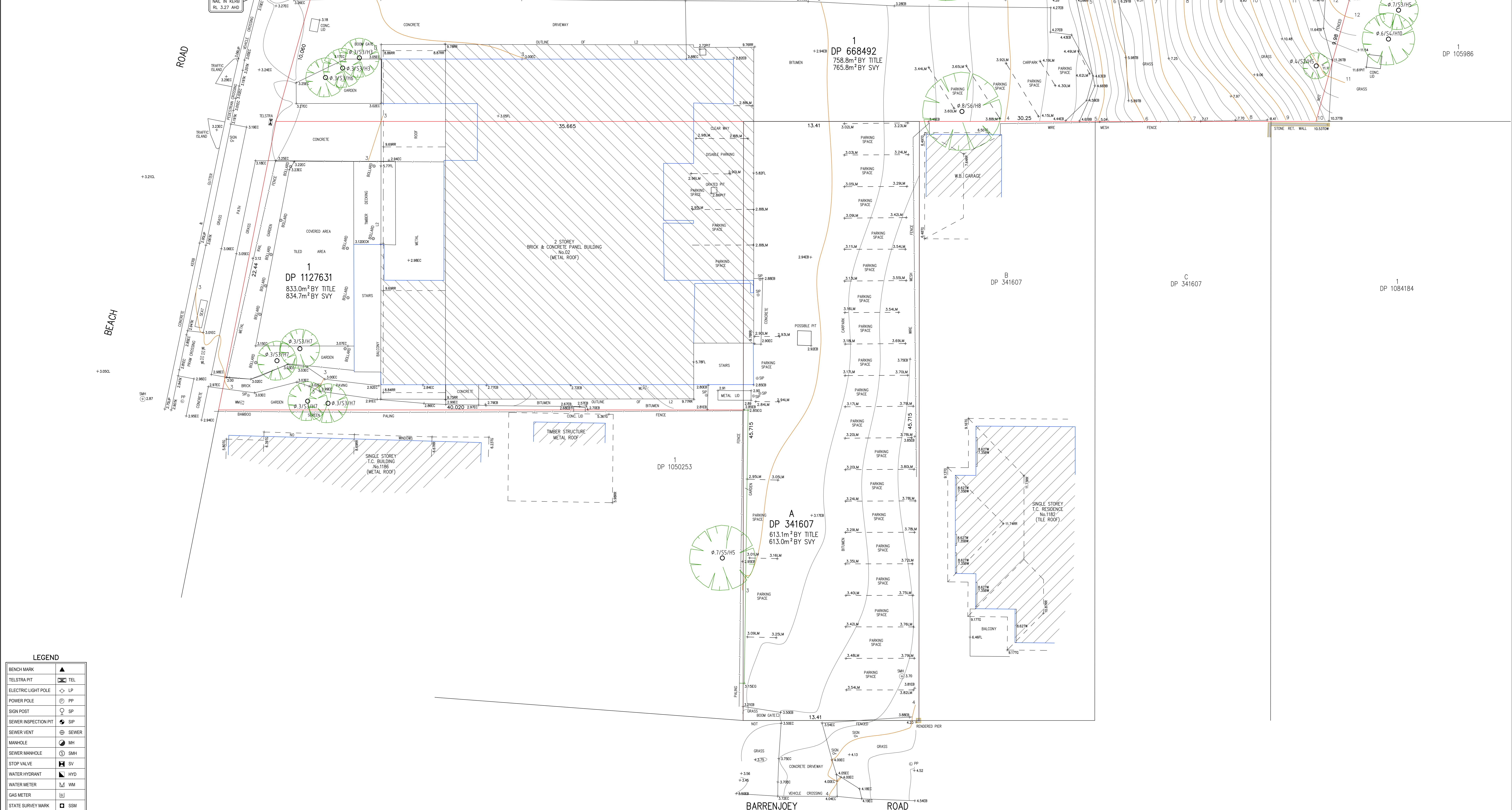
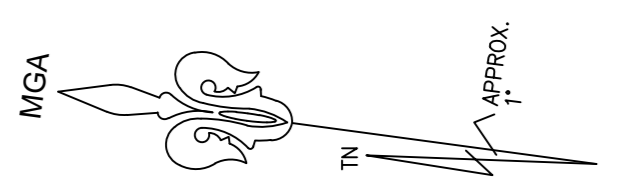

**LEGEND**

BENCH MARK	▲
TELSTRA PIT	TEL
ELECTRIC LIGHT POLE	LP
POWER POLE	PP
SIGN POST	SP
SEWER INSPECTION PIT	SIP
SEWER VENT	SEWER
MANHOLE	MH
SEWER MANHOLE	SMH
STOP VALVE	SV
WATER HYDRANT	HYD
WATER METER	WM
GAS METER	GM
STATE SURVEY MARK	SSM

**NOTE:**  
 INFORMATION CONTAINED IN THIS PLAN IS THE COPYRIGHT OF TOTAL SURVEYING SOLUTIONS. THE USE OR DUPLICATION WITHOUT THE WRITTEN CONSENT OF TOTAL SURVEYING SOLUTIONS CONSTITUTES AN INFRINGEMENT OF COPYRIGHT.

REVISION No.	REVISION DATE:	COMMENT:
A	18/04/17	BOLLARDS AT FRONT ADDED

**LEGEND:**

EC - EDGE OF CONCRETE	FL - FLOOR LEVEL
TK - TOP OF KERB	DT - DOOR TOP
TW - TOP OF WINDOW	T.C. - TIMBER CLAD
BW - BOTTOM OF WINDOW	EB - EDGE OF BITUMEN
TG - TOP OF GUTTER	TB - TOP OF BANK
RR - ROOF RIDGE	W.B. - WEATHER BOARD
LM - LINE MARKING	WL - WATER LID
EG - EDGE OF GARDEN	Ø.4/S/10/H16 - DIAMETER/SPREAD/HEIGHT

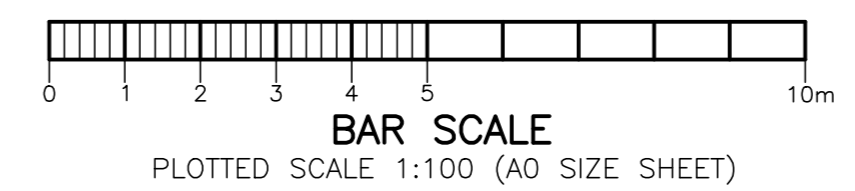

<b>PLAN SHOWING DETAIL &amp; LEVELS OVER LOT 1 IN DP6688492, LOT 1 IN DP1127631 &amp; LOT A IN DP341607</b> CLIENT: PALM BEACH GOLF CLUB PROJECT: PALM BEACH ADDRESS: 2 PALM BEACH ROAD, PALM BEACH	JOB No.: 190245 PLAN No.: 190245_A DATE: 07/02/2019 DRAWN: DF CHK: GS	LGA: NORTHERN BEACHES DATUM: AHD SCALE: 1:100@A0 CONT. INTERVAL: 0.25m SHEET 1 OF 1
--	---	---

**TSS TOTAL SURVEYING SOLUTIONS**  
 ARTARMON | CAMDEN | MANLY VALE