

SITE AREA 687.9 sqm

EXISTING IMPERVIOUS AREA 227.7 sqm 33%

EXISTING NATURAL LANDSCAPED AREA 460.2 sqm 67%

SITE AREA 687.9 sqm

PROPOSED IMPERVIOUS AREA 288.8 sqm 42%

PROPOSED NATURAL LANDSCAPED AREA 399.1 sqm 58%

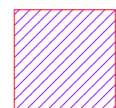
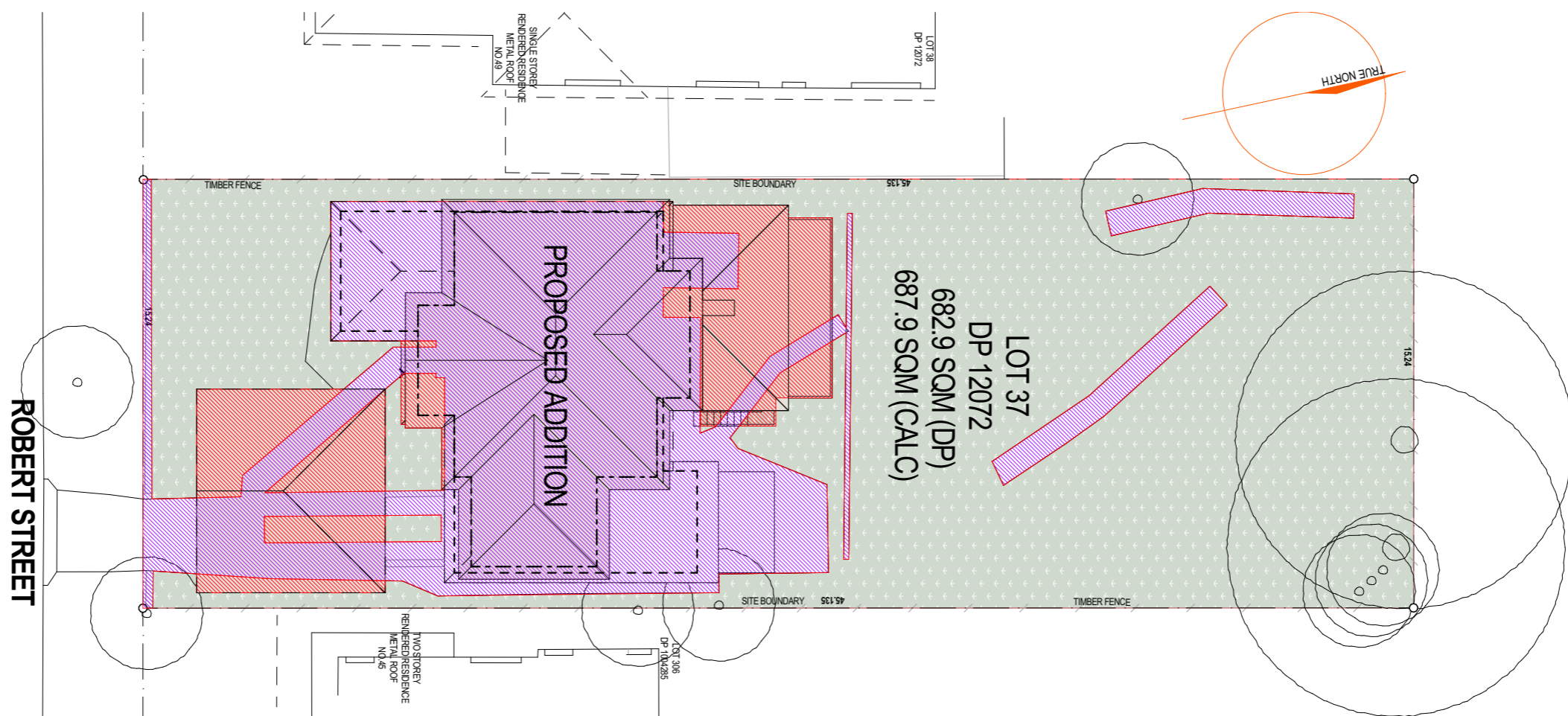

IMPERVIOUS AREA



NATURAL LANDSCAPED AREA



AREA DIFFERENCE: 61.08 sqm 9%



**ADD-STYLE**  
HOME ADDITIONS  
Upstairs Specialists

5/319 CONDOMINE ST MANLY VALE 2093 P: (02) 9907 9055 E: info@addstyle.com.au

Proposed Additions at:  
47 Robert Street, Freshwater NSW 2096

DRAWING TITLE IMPERVIOUS AND NATURAL LANDSCAPED AREA CALCULATION PLAN  
SCALE 1:200 DRAWN BY KK CHECKED BY GK

DRAWING NO. 4533 DA 1  
ISSUE A

NO.	REVISION	DATE	BY
A	For Council	18/03/25	GK