

Ground floor landscape plan 1:100 @ A1

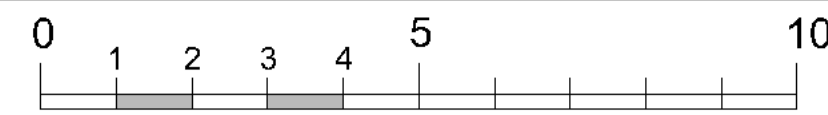

Note: Refer to development plan of management for ongoing maintenance program for green wall.

Concealed irrigation connection point set into wall behind green wall facade system.

See sheet 2 for Green wall installation details.

Green wall to ground levels wall here. (Refer to Architects West Elevation. See also Green wall details and Green wall species list on planting schedule, sheet 2)

Dashed line indicates awning above

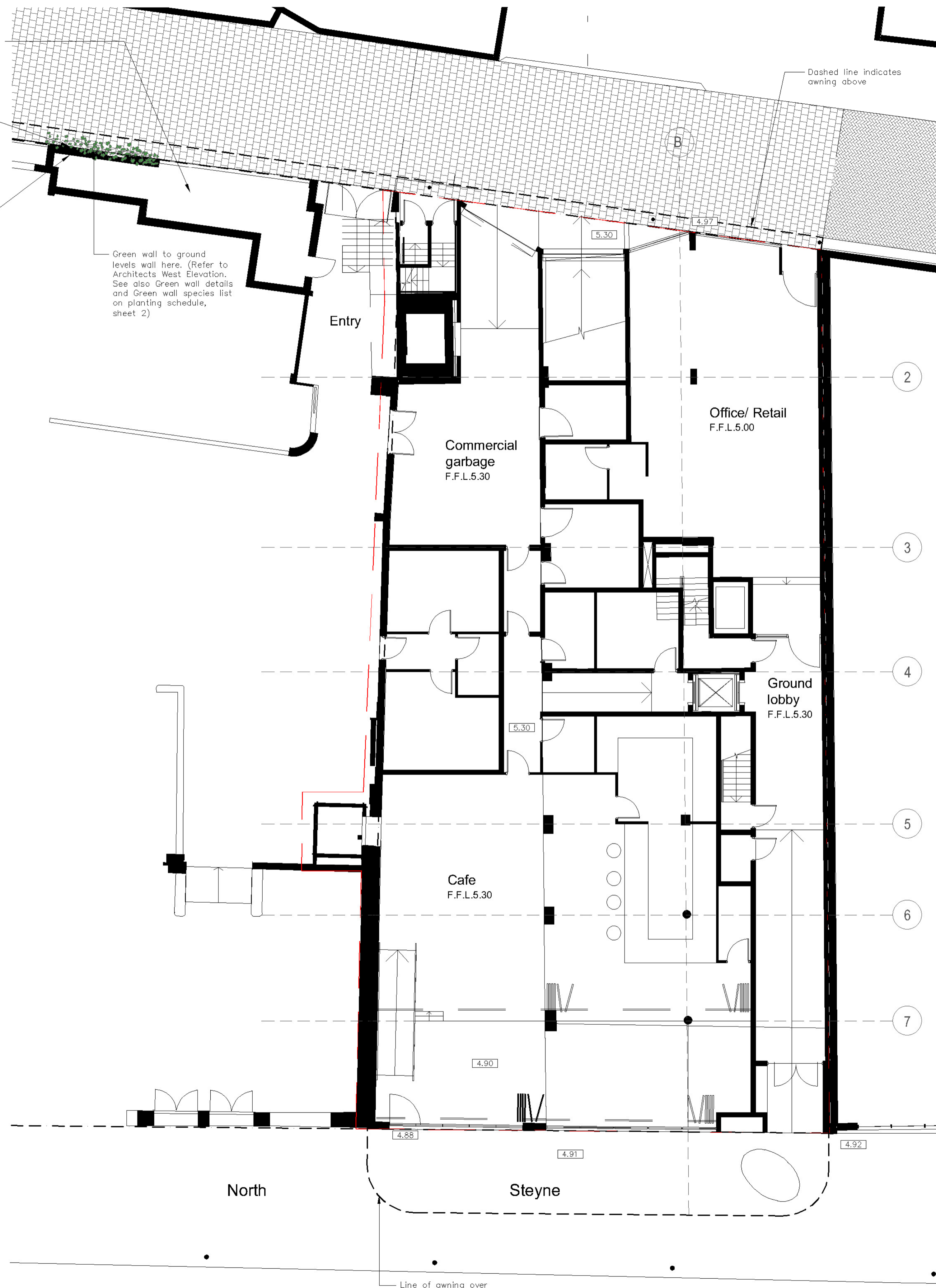

North

Steyne

Line of awning over

Indicative planting images All levels

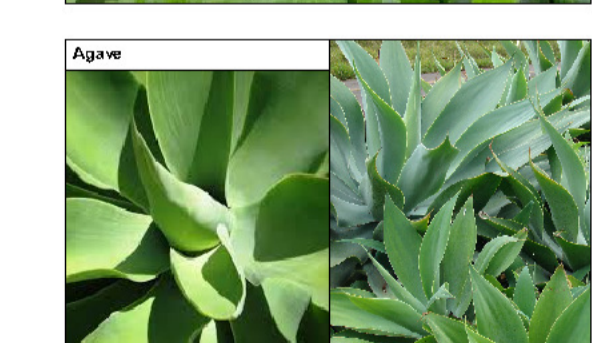
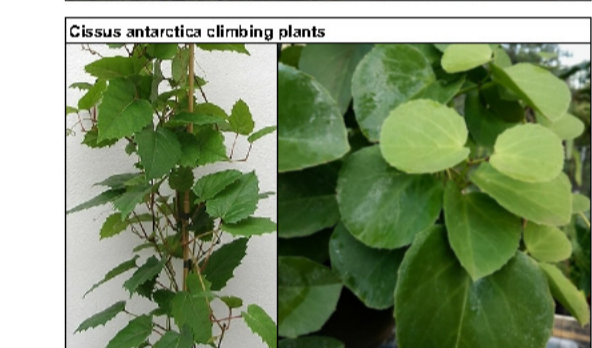

Drawing schedule

- Sheet 1: Ground floor plan
- Sheet 2: First floor plan & Green wall detail
- Sheet 3: Level 2 & 3 floor plan
- Sheet 4: Level 4 & Details / notes
- Sheet 5: Section AA-CC

AMENDMENTS

C	RFI RESPONSE
B	FOR DA ISSUE
A	FOR REVIEW



PAUL SCRIVENER

LANDSCAPE
PO Box 4050, ACT 2602
ABN: 16 949 100 279
PHONE: 02 9907 8011
WWW.SCRIVENER-DESIGN.COM
EMAIL: PAUL@SCRIVENER-DESIGN.COM

PROJECT: PROPOSED APARTMENTS,
19-23 THE CORSO,
MANLY, NSW

DWG: LANDSCAPE SITE PLAN -
GROUND FLOOR

DATE: 6.4.22 SCALE: 1:100 @A1

JOB REF: 22/2363 SHEET No: 1 OF 5

BUILDER MUST VERIFY ALL DIMENSIONS OF THE SITE BEFORE WORK COMMENCES.
FIGURED DIMENSIONS SHOULD BE USED IN PREFERENCE TO THOSE SCALED OFF.
COPYRIGHT IS THE PROPERTY OF PAUL SCRIVENER LANDSCAPE, A.B.N. 16 949 100 279.
THE CONCEPTS, DESIGN, DETAILS AND INFORMATION DESCRIBED IN THE DRAWING ARE COPYRIGHT, OTHER THAN FOR THE PURPOSE PRESCRIBED UNDER THE COPYRIGHT ACT, NO PART OF IT MAY IN ANY FORM OR BY ANY MEANS BE USED OR REPRODUCED WITHOUT PRIOR WRITTEN PERMISSION.

1 OF 5
ISSUE-C

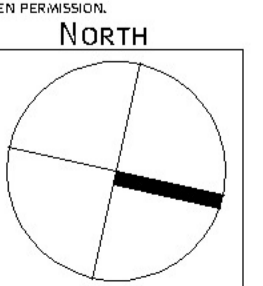



Typical Green wall Images



Elmich - Wall mounted green wall system (See Sheet 1)

Planting Media
Suitable for most green wall plants using different planting media.

Safety
Anti-lift arms prevent inadvertent dislodgment of trays.

Universal Mounting
Able to install on different mounting frames with 6-point anchoring system.

Baffle Plate
Distributes irrigation across the Tray and prevents media spillage.

Planting Density
Allows different vertical and horizontal spacing for varied planting options.

Drainage
Excess water flows into underlying trays or is discharged through drainage pipe.

VGP Tray Plug
Prevents water from draining out of VGP Tray. Available separately.

Projects

Indoor and Outdoor Green Walls

Planting schedule

Symbol	Botanical name	Common name	Cont. size	Staking	Mature height	No req.
Groundcovers/Climbers						
CGT	Casuarina glauca 'Cousin It'	Cousin It Groundcover (hybrid groundcover)	200mm	nil	0.15M	0
CRG	Carpobrotus glaucescens	Pigface (very hardy salt wind tolerant trailing groundcover)	140mm	nil	0.3M	0
CWH	Carpobrotus rossii 'White Hot'	White Pigface (very hardy salt wind tolerant trailing groundcover)	140mm	nil	0.3M	0
CSS	Cissus Antarctica	Kangaroo Vine (on vertical cables at each western balcony)	300mm	vertical cables	3-4.0M	0
DIR	Dichondra repens	Kidney weed (native carpet groundcover)	tubes	nil	0.1M	0
GAZ	Gazania tomentosa	Orange Flowering Daisy (low hardy coastal groundcover)	150mm	nil	0.3M	0
GRI	Gazania rigens	Yellow Flowering Daisy (low hardy coastal groundcover)	150mm	nil	0.3M	0
HIS	Hibbertia scandens	Guinea Flower (flowering climber / groundcover)	200mm	nil	0.3M	0
HVM	Hardenbergia violacea 'Meema'	Meema Purple Coral Pea (purple flower native groundcover)	200mm	nil	0.4M	0
MYP	Myoprum parvifolium	Creeping Boobiala (native cascading groundcover)	150mm	nil	0.2M	0
SCA	Scaevola aemula	Fan Flower (flowering cascading groundcover)	150mm	nil	0.3M	0
TJA	Trachelospermum asiaticum	Flatmat Star Jasmine (F101 Ozbreed hybrid groundcover)	200mm	nil	0.2M	0
WFG	Westringia fruticosa 'Grey Box'	Ozbreed Grey Box® (Trimmed as topiary ball)	200mm	nil	0.4-0.6M	0
WFM	Westringia fruticosa 'Mundi'	Coastal Rosemary Groundcover (flowering groundcover)	150mm	nil	0.3M	0
Green wall species						
ADR	Alternanthera 'Little Ruby'	Purple Little ruby	140mm	nil	0.3-0.4M	0
BLC	Blechnum cartilagineum	Bracken Fern	140mm	nil	0.5M	0
BLS	Blechnum nudum 'Silver Lady'	Silver Lady Fern	140mm	nil	0.5M	0
COR(M)	Cordylina spp. Mini	Selected Dwarf Cordylina (Shade tolerant bright foliage)	140mm	nil	0.3-0.4M	0
DCR	Dianella 'Tasred'	Tasred Flax Lily	140mm	nil	0.35M	0
DIC	Dianella caerulea	Blue Flax Lily	140mm	nil	0.35M	0
DIT	Dianellatamanica 'Blaze'	Purple Flax Lily	140mm	nil	0.35M	0
LJR	Liriope 'Just right'	Just Right Turf Lily	140mm	nil	0.3M	0
NDO	Nandina domestica 'Obsession'	Nandina 'Seika' PBR Dwarf Nandina	140mm	nil	0.5M	0
PLP	Philodendron 'Little Phil'	Dwarf Philodendron	140mm	nil	0.35M	0
SMW	Spathiphyllum wallisii 'Bonito'	Dwarf Peace Lily	140mm	nil	0.3M	0

Planting schedule species to be sourced from local nurseries supplying plants of local provenance wherever possible. Landscape contractor is to check plant numbers on plan against the schedule prior to submitting tender price. Contact landscape architect if any number discrepancies are found. Council compliance controls require that any substitution of species variety or container size MUST be confirmed with landscape architect to ensure a compliance certificate can be issued that meets the specific development consent conditions of the project.

Legend

- Cascading groundcovers
- Green wall planting system
- Tiled balcony
- Plant symbol (See schedule this sheet)
- Mixed salt & wind tolerant low planting & groundcover

AMENDMENTS

C	RFI RESPONSE
B	FOR DA ISSUE
A	FOR REVIEW



PAUL SCRIVENER
LANDSCAPE
PO Box 4050, ACT 2602
ABN: 16 949 100 279
PHONE: 02 9907 8011
WWW.SCRIVENER-DESIGN.COM
EMAIL: PAUL@SCRIVENER-DESIGN.COM

PROJECT: PROPOSED APARTMENTS, 19-23 THE CORSO, MANLY, NSW

DWG: LANDSCAPE SITE PLAN - LEVEL 1

DATE: 6.4.22 SCALE: 1:100 @A1

JOB REF: 22/2363 SHEET No: 2 of 4

BUILDER MUST VERIFY ALL DIMENSIONS OF THE SITE BEFORE WORK COMMENCES. FIGURED DIMENSIONS SHOULD BE USED IN PREFERENCE TO THOSE SCALED OFF. COPYRIGHT IS THE PROPERTY OF PAUL SCRIVENER LANDSCAPE. A.B.N. 16 949 100 279. THE CONCEPTS, DESIGN DETAILS AND INFORMATION DESCRIBED IN THE DRAWING ARE COPYRIGHT. OTHER THAN FOR THE PURPOSE DESCRIBED UNDER THE COPYRIGHT ACT, NO PART OF IT MAY IN ANY FORM OR BY ANY MEANS BE USED OR REPRODUCED WITHOUT PRIOR WRITTEN PERMISSION.

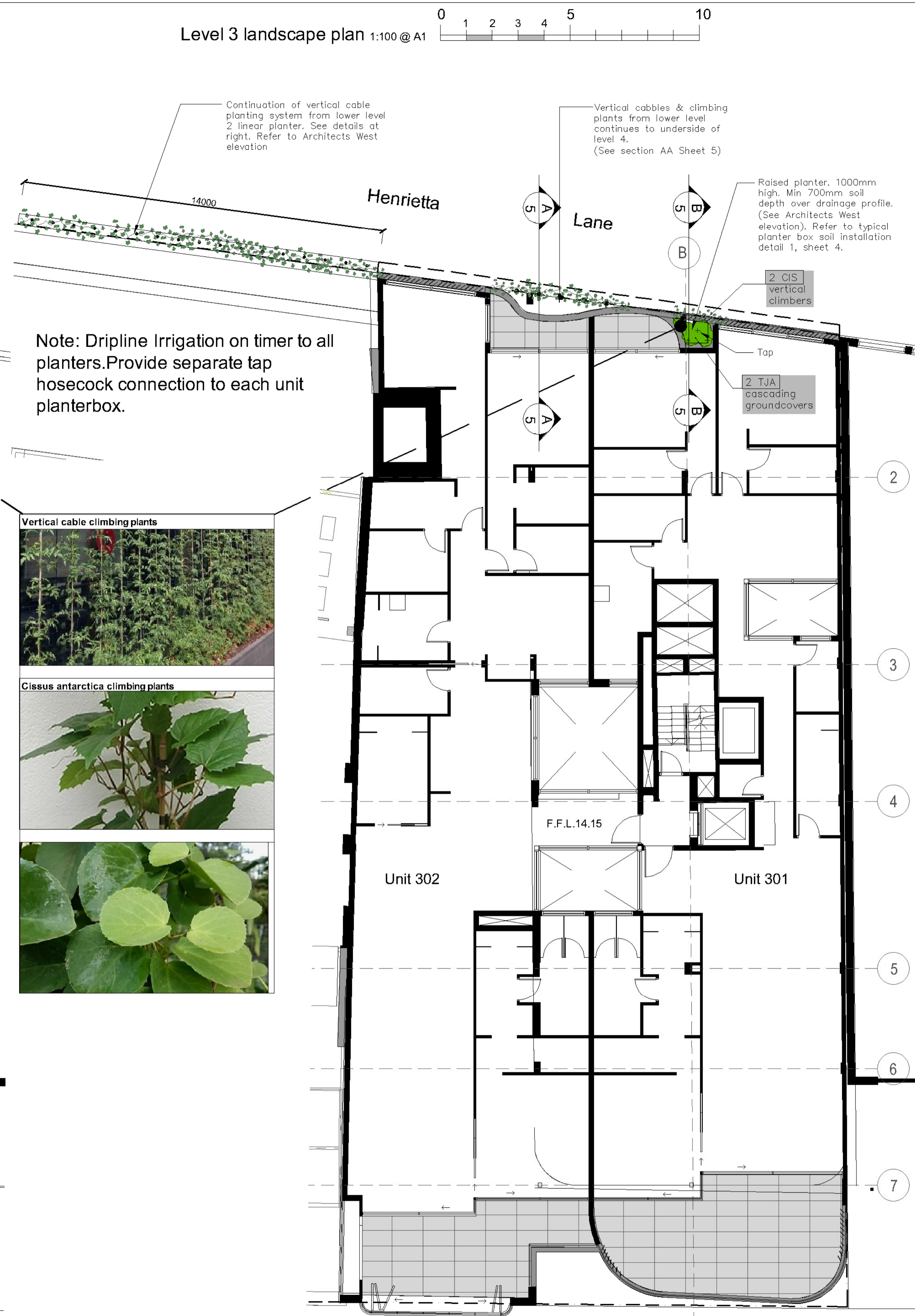

Note: Dripline Irrigation on timer to all planters. Provide separate tap hosecock connection to each unit planterbox.



Legend

- Cascading groundcovers
- Vertical cable planting system
- Tiled balcony
- Plant symbol (See schedule sheet 2)

AMENDMENTS

C	RFI RESPONSE
B	FOR DA ISSUE
A	FOR REVIEW

PAUL SCRIVENER
 LANDSCAPE
 PO Box 4050, ACT 2602
 ABN: 16 949 100 279
 PHONE: 02 9907 8011
 WWW.SCRIVENER-DESIGN.COM
 EMAIL: PAUL@SCRIVENER-DESIGN.COM

PROJECT: PROPOSED APARTMENTS, 19-23 THE CORSO, MANLY, NSW

DWG: LANDSCAPE SITE PLAN - LEVEL 2 AND 3
 DATE: 6.4.22 SCALE: 1:100 @A1
 JOB REF: 22/2363 SHEET No: 3 OF 5

BUILDER MUST VERIFY ALL DIMENSIONS OF THE SITE BEFORE WORK COMMENCES.
 THE CONCEPTS, DESIGN, DETAILS AND INFORMATION DESCRIBED IN THE DRAWING ARE COPYRIGHT, OTHER THAN FOR THE PURPOSES PRESCRIBED UNDER THE COPYRIGHT ACT, NO PART OF IT MAY IN ANY FORM OR BY ANY MEANS BE USED OR REPRODUCED WITHOUT PRIOR WRITTEN PERMISSION.

3 OF 5
 ISSUE-C

Level 4 landscape plan 1:100 @ A1

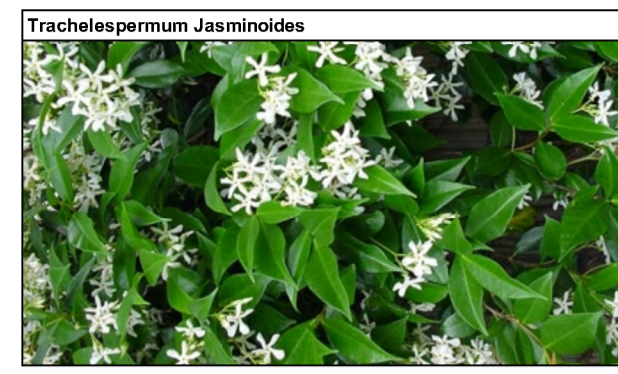
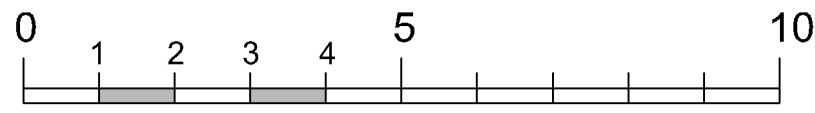

Trachelospermum Jasminoides
Cascading groundcover planting of Trachelospermum 'Asaticum' & Myoporum yareena



3 AGV

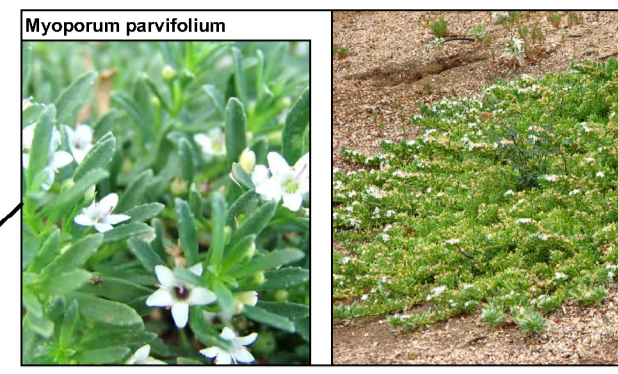

Myoporum parvifolium



Detail 1. All Levels

On structure planter typical soil installation detail n.t.s

For soil & irrigation methodology only Structural & drainage to relevant Engineers details

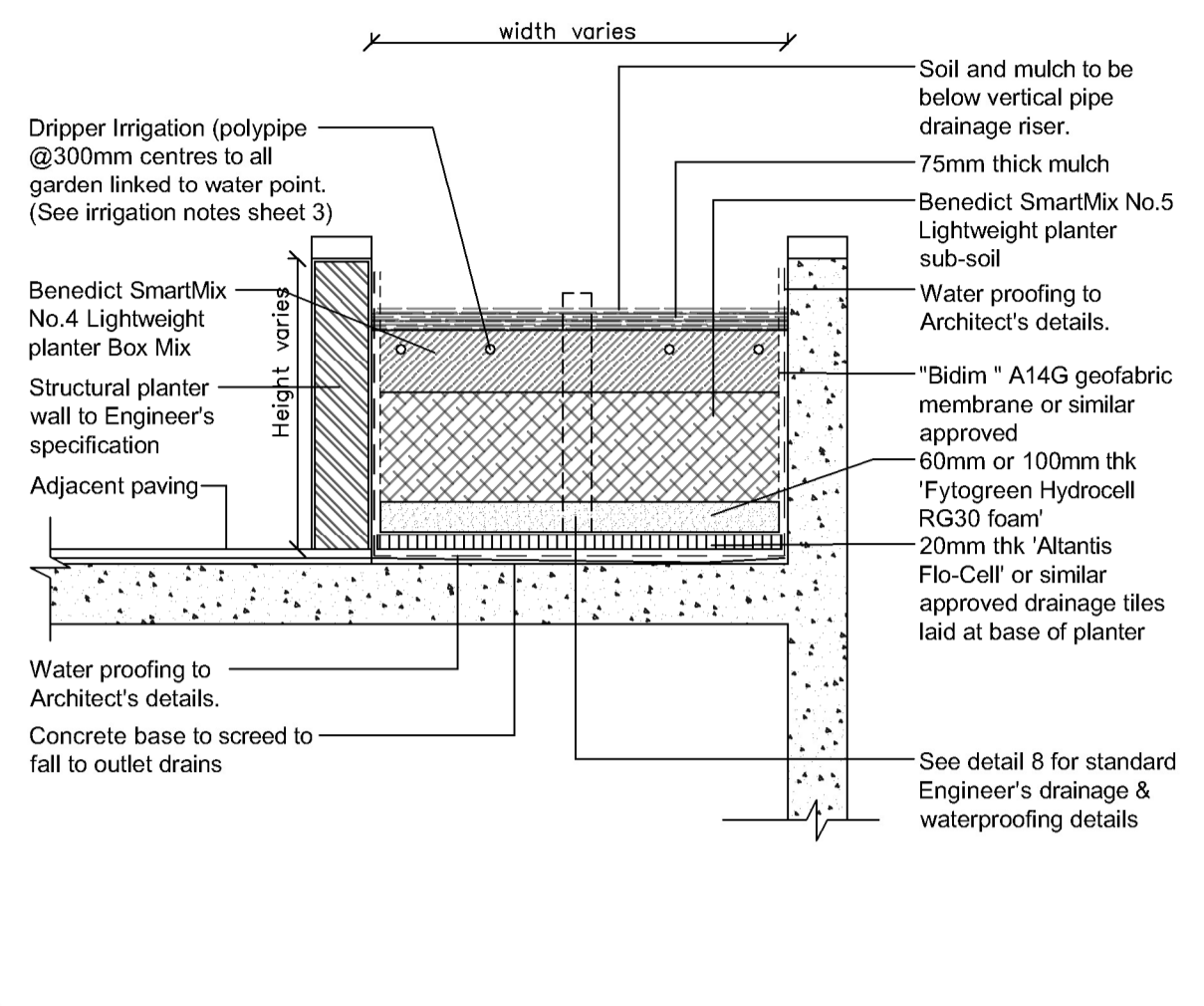

Detail 2.

Vertical climbers on cables (Levels 1-3)



Maintenance schedule

The Landscape Contractor shall maintain the contract areas by accepted horticultural practices as well as rectifying any defects that become apparent in the works under normal use. The Landscape Contractor shall maintain the works and make good all defects for a period of twenty six (26) weeks after the date of practical completion. Practical completion of the landscape works shall include but not be limited to the replacement of plants which have failed or been damaged or stolen during work under the contract. Landscape maintenance shall include but not be limited to the following: watering, rubbish removal, spraying and wiping leaf surfaces, replacing failed plants, maintaining mulch, pruning, insect and disease control, cleaning of surrounding areas. Mow the nature strip turf when it is established at regular intervals to maintain an average height of 50mm.

- After the completion of the defects period noted above the owners corporation of the residence are responsible for the ongoing maintenance and viability of the gardens and ongoing maintenance shall include the following:
 - Regular hand watering of gardens if installed drip line irrigation system is turned off. Irrigation to be installed and maintained as per manufacturers specifications including regular checks for function of system, to check for leaks and to ensure general good working operation. Regular maintenance of the irrigation system battery timers (where required) for isolated planter beds in common areas. Battery timers for private terraces are the responsibility of the individual unit owners.
 - Mulch is to be regularly topped up every 6 months to ensure an even 75mm coverage in all garden beds
 - Regular pruning of plants is to be undertaken to ensure continued uniform growth of canopy and foliage of trees and shrubs. Removal of vegetation over the long term (if and when required) as the garden matures. Subject to the relevant council applications
 - Regular assessment of plants for evidence of insect attack or disease. Appropriate pest oil, white oil of industry standard safe to use pest spray is to be employed if required
 - Garden/lawn edging to be inspected regularly after practical completion to ensure it is maintained in good order. Replace where required if defective sections are discovered
 - All garden refuse, rubbish and associated items that arise from the regular garden maintenance procedures are to be collected and stored in appropriate general waste or green waste containers as is appropriate. Excess waste unable to be stored in Council waste containers is to be removed from the site in a timely manner.

General construction notes

- Site preparation**
Any existing trees and vegetation to be retained shall be preserved and protected from damage of any sort during the execution of landscape work. In particular, root systems of existing plants must not be disturbed if possible. Any nearby site works should be carried carefully using hand tools. To ensure the survival and growth of existing trees during landscaping works, protect by fencing or armoring where necessary. Trees shall not be removed or lopped unless specific written approval to do so is given or is indicated on plan. Storage of materials, mixing of materials, vehicle parking, disposal of liquids, machinery repairs and refueling, site office and sheds, and the lighting of fires shall not occur within three (3) metres of any existing trees. Do not stockpile soil, rubble or other debris cleared from the site, or building materials, within the dripline of existing trees. Vehicular access shall not be permitted within three (3) metres of any tree.
 - Soil preparation**
All proposed planting areas to be deep ripped to 200mm (where possible) and clay soils to be treated with clay breaker. Apply at least 200mm depth good quality garden soil mix to all garden planting areas. To comply with AS 4419 Turfed areas to be Soft leaf Buffalo or Soft Leaf Buffalo to be laid over 150mm good quality turf underlay over existing soil which is to be deep ripped to 200mm depth prior to installation. To be worked in with rotary hoe except where tree root damage would otherwise occur. In such situations care to be taken to hand cultivate in any area where existing tree roots exist to preserve health of trees and to comply with the requirements of the Arborist's report. Where planting is to occur in existing soil profiles ensure soil conditioners and compost worked into the top 200mm profile. To comply with AS 4454:1999.
 - New plantings**
Newly planted trees and large shrubs should be secured to stakes with hessian ties to prevent rocking by wind. Planting holes for plant material should be large enough in size to take root ball with additional space to take back filling of good quality planting mix. (Please note mature heights of planting as shown on planting schedule can vary due to site conditions, locations in constricted deep soil or over slab planters and so forth) Also shallow soils in certain locations may affect planting heights. Nominated heights for plantings in raised planters over slabs are nominated as less than their normal expected heights in acknowledgement of the contained soil environment. For other deep soil trees heights are subject to particular site conditions, and intended hedging or pruning for functional requirements such as available planting width, intended access under branches and solar access.
 - Raised planter soil installation methodology**
All slab areas to be waterproofed and 'Atlantis' drainage cell installed with geotextile fabric or similar approved. Refer Engineer's details for ALL structural and installation details. All waterproofing as per Architects specification. All raised gardens to have the following soils:
 - Benedict's Smart Mix no. 4 Lightweight Planter Mix (or approved equivalent) to min. 400mm depth over Benedict's Smart Mix. No. 5 light weight base layer where raised planter depth are required for planters greater 700mm or greater. To comply with min 650mm soil depth as per condition # 22. To comply with AS 4419 and AS 3743
 - All common area raised planters and over slab areas to have automatic dripline irrigation system. (see separate irrigation notes)
 - Landscape contractor to install all planter box fill material and plant material after other site works are completed to ensure no deterioration of waterproof membrane behind external walls.
- Note:** Hold point requirements for raised planting over slab.
Confirmation of waterproofing with certificate by qualified installer that it meets the specified requirements. Inspection of drains by the stormwater engineer prior to drainage and soil installation. Landscape consultant to confirm correct soil and drainage layers have been installed. Landscape consultant to confirm that irrigation has been installed in all common areas landscape areas (excluding drainage detention zone)
- Mulching**
All planting areas to be mulched with a minimum 75mm thick cover of recycled hard wood chip mulch and then all plant areas to be thoroughly soaked with water. To comply with AS 4454
 - Fertiliser**
All planting areas to be fertilised with 9 month 'NPK' slow release fertiliser.
 - Staking**
To those plants indicated on the planting schedules provide: hardwood stakes as nominated and driven into ground to a depth able to achieve rigid support.
 - Lawn edging**
All ground level garden beds adjacent to site boundary to finish flush with all footpath, driveway or kerb levels.
 - Turfing**
Turfed nature strip areas to be Soft leaf Buffalo to be laid over 100mm good quality turf underlay over existing soil which is to be deep ripped to 200mm depth prior to installation.
 - Structural**
All structural details whatsoever to Engineer's details.

Irrigation notes

Automatic drip line watering system to be selected. To extend to ALL common area garden and landscape zones in the development including both the deep soil and raised planter wall areas and including all raised planter boxes over slab on all levels. (All lawn areas to be excluded).

Water supply tap hosecocks and water supply conduit to be coordinated by Hydraulic and Structural Engineer's details. Dripline supply system only to be incorporated.

Prior to approval by the project manager and prior to installation the Contractor responsible for the irrigation installation is to provide an irrigation design to meet the following requirements.

Generally: Supply an automatic drip line irrigation system. To include all piping to solenoids either PVC lines and/or class 12 pressure pipe or low density, rubber modified polypropylene reticulation as required to provide water supply to the nominated areas. To be coordinated with Hydraulic engineers plans. To include all bends, junctions, ends, ball valves, solenoids and all other ancillary equipment. Backwash valve: An approved backwash prevention valve is to be located at the primary water source for top up valves to rainwater tanks (where applicable).

Ensure rain sensor is installed for common area garden zones connected to timers

Root inhibiting system, Driplines to be 'Netafim Techline AS XR' drip tubing or approved equivalent

Automatic Controller: For all common area landscape areas provide automatic 2 week timer with hourly multi-cycle operation for each zone as noted on the irrigation areas plan on sheet. Battery timers to isolated planter boxes to private terraces.

Performance: It shall be the Landscape Contractor's responsibility to ensure and guarantee satisfactory operation of the irrigation system. The system is to be fit for the purpose and should utilize sufficient solenoids to provide for the varying watering requirements of landscape areas to allow all plants and lawn areas to thrive and attain long term viability.

Testing: After the system has been installed to the satisfaction of the project manager, the installation shall be tested under working conditions. Acceptance of the installed plant and equipment shall be subject to these being satisfactory.

Warranty: A twelve month warranty is to be provided in writing by the Landscape Contractor, which shall commit the Landscape Contractor to rectify the system (the items they have installed) to the satisfaction of the project manager or nominated representative. This will apply should any fault develop, or the capacity or efficiency fall below that guaranteed, or should the discharge or pressure be inadequate, or should defects develop in the filter unit or control heads, or any blockages that may develop in the system.

Approvals: The Landscape Contractor is to liaise as necessary, to ensure that the irrigation system conforms with all Water Board, Council and Australian standards (AS)

Legend

- Cascading groundcovers
- Tiled balcony
- Plant symbol (See schedule sheet 2)

AMENDMENTS

C	RFI RESPONSE
B	FOR DA ISSUE
A	FOR REVIEW



PAUL SCRIVENER
LANDSCAPE
PO Box 4050, ACT 2602
ABN: 16 949 100 279

PHONE: 02 9907 8011
WWW.SCRIVENER-DESIGN.COM
EMAIL: PAUL@SCRIVENER-DESIGN.COM

PROJECT: PROPOSED APARTMENTS,
19-23 THE CORSO,
MANLY, NSW

DWG: LANDSCAPE SITE PLAN -
LEVEL 4

DATE: 6.4.22 SCALE: 1:100 @A1

JOB REF: 22/2363 SHEET NO: 4 OF 5

BUILDER MUST VERIFY ALL DIMENSIONS OF THE SITE BEFORE WORK COMMENCES. FIGURED DIMENSIONS SHOULD BE USED IN PREFERENCE TO UNDETAILED OFF-DRAWING DIMENSIONS.
COPYRIGHT IS THE PROPERTY OF PAUL SCRIVENER LANDSCAPE. A.B.N. 16 949 100 279.
THE CONCEPTS, DESIGN, DETAILS AND INFORMATION DESCRIBED IN THE DRAWING ARE COPYRIGHT. OTHER THAN FOR THE PURPOSES DESCRIBED UNDER THE COPYRIGHT ACT, NO PART OF IT MAY IN ANY FORM OR BY ANY MEANS BE USED OR REPRODUCED WITHOUT PRIOR WRITTEN PERMISSION.

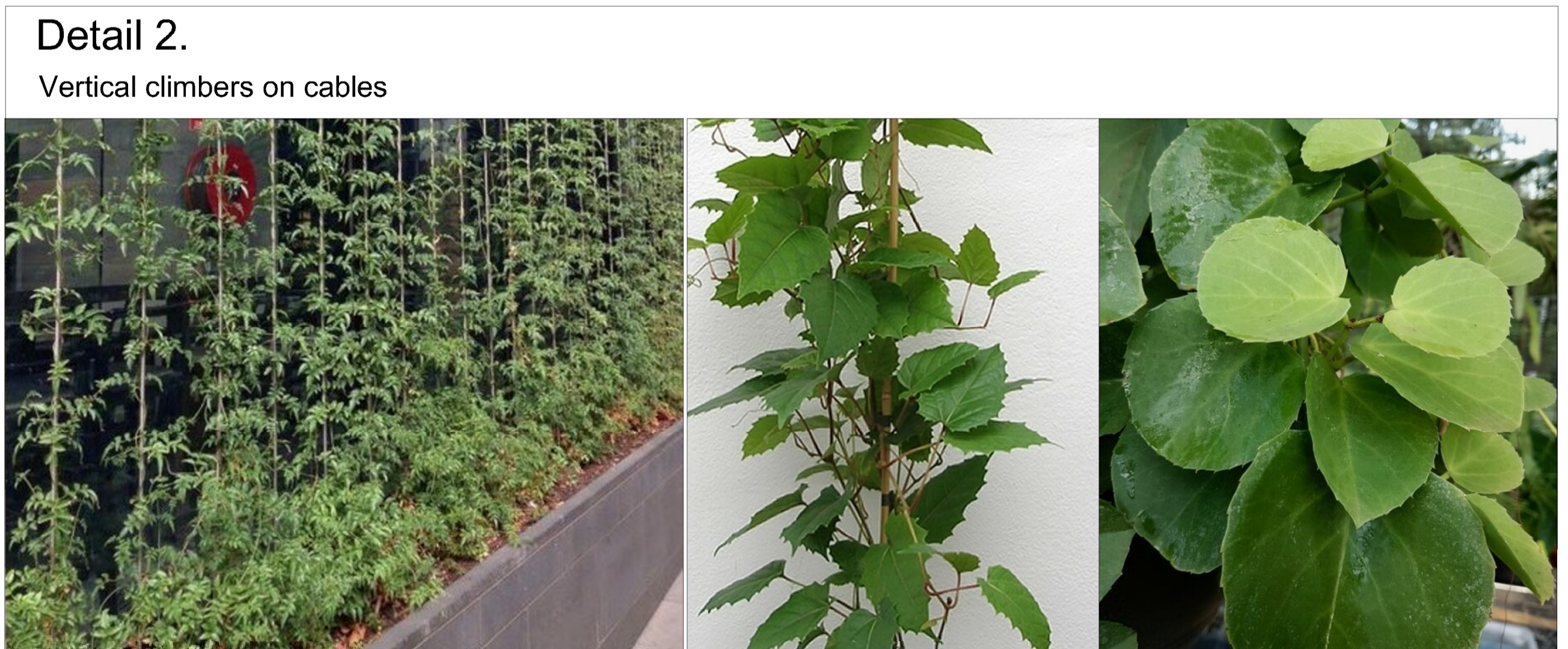
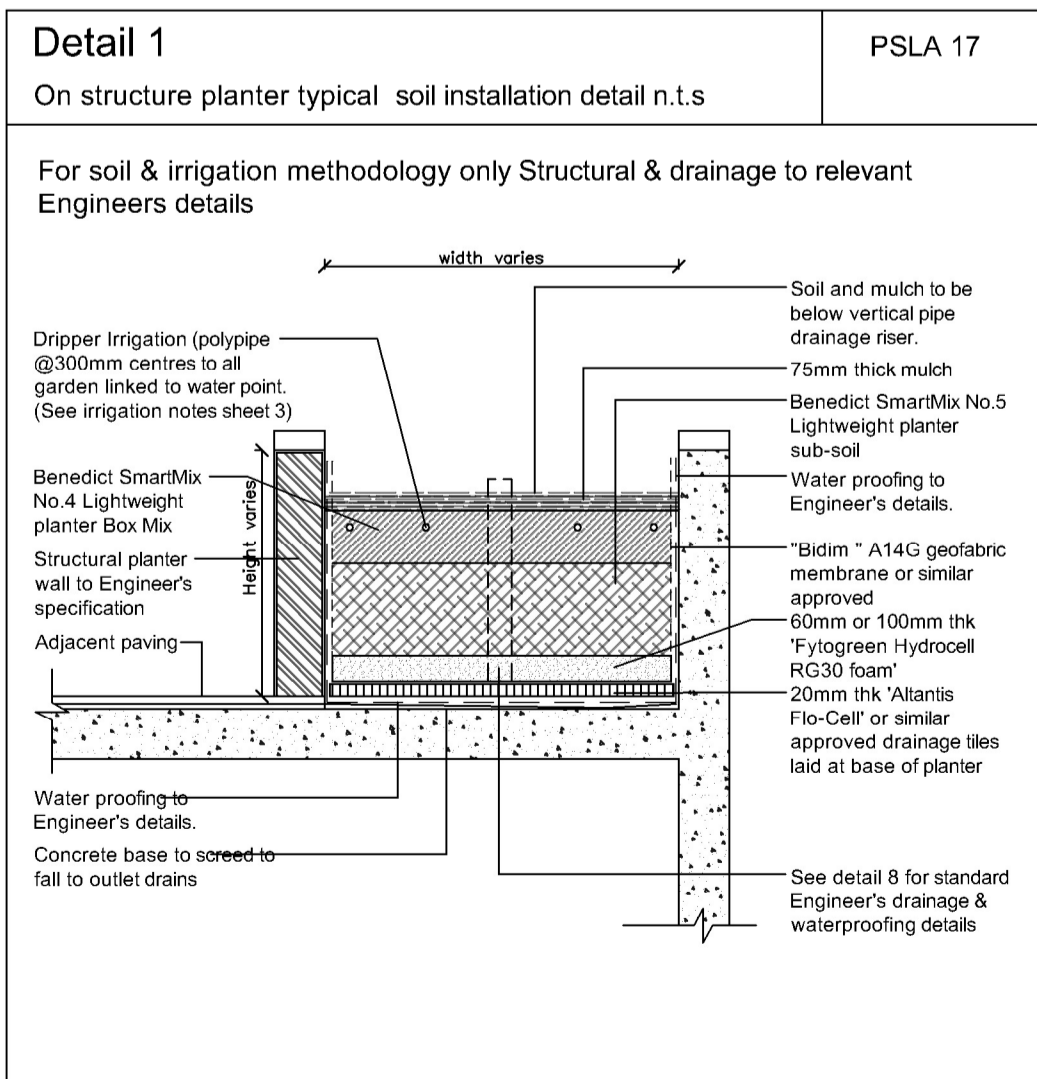
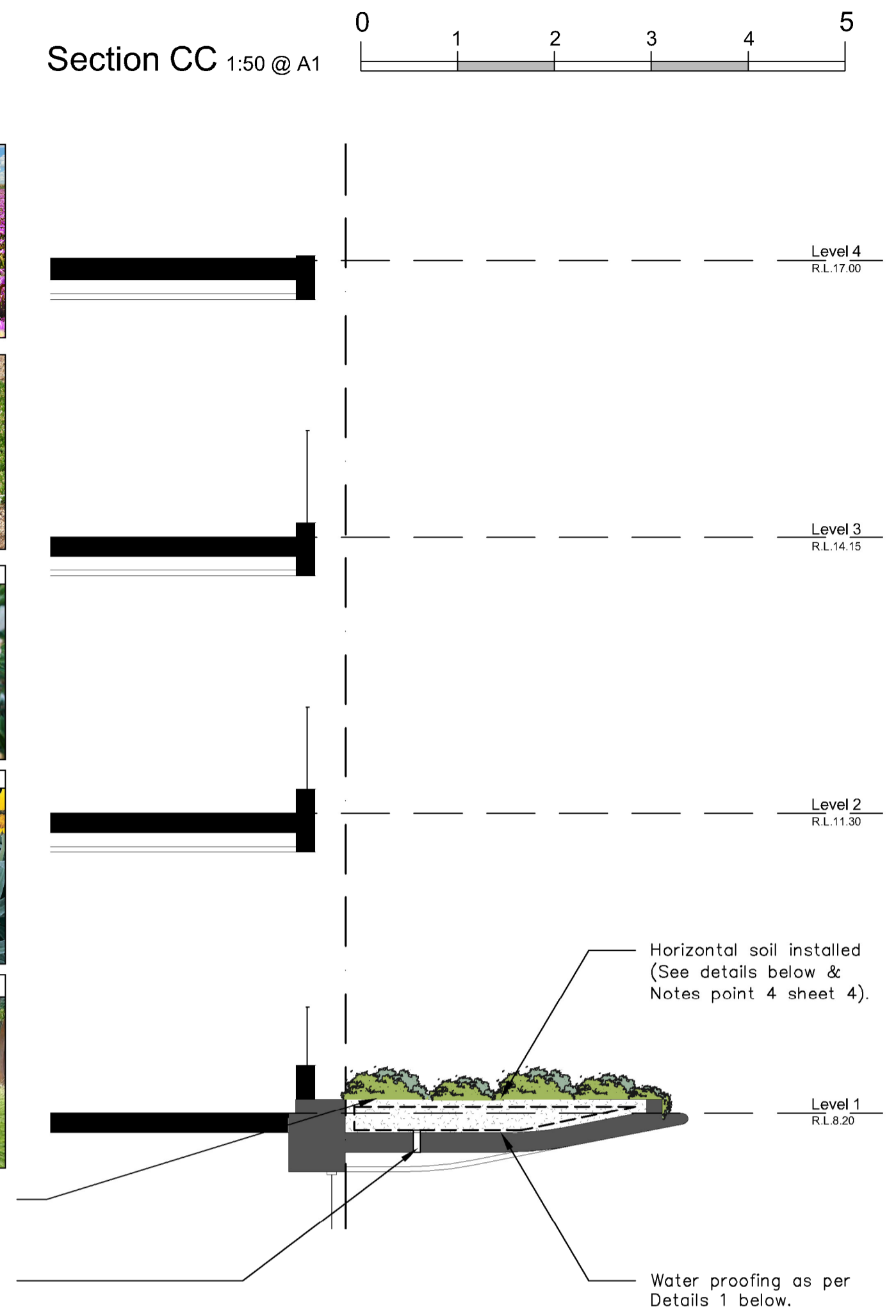
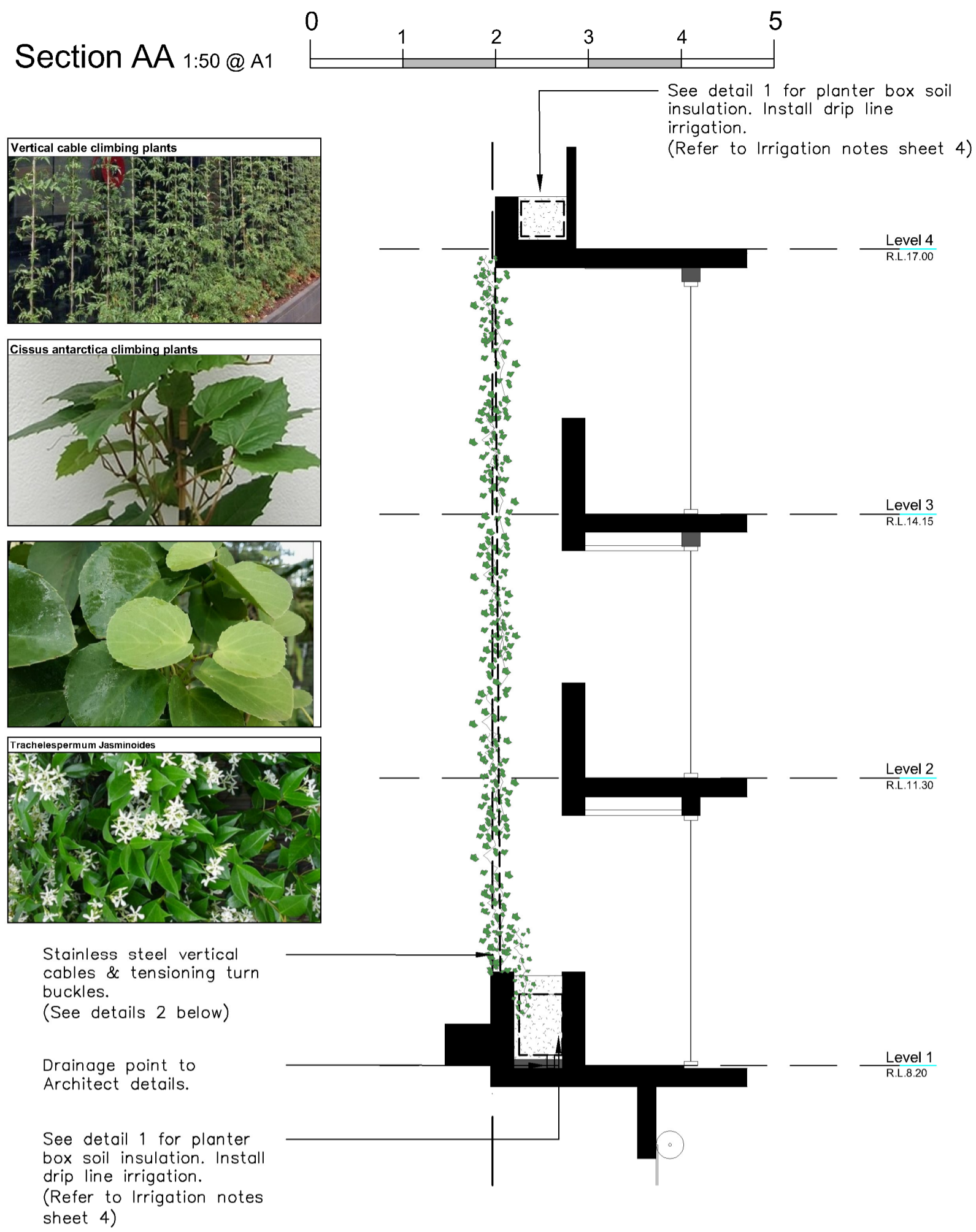

AMENDMENTS

C	RFI RESPONSE
B	FOR DA ISSUE
A	FOR REVIEW



PAUL SCRIVENER
 LANDSCAPE
 PO Box 4050. ACT 2602
 ABN: 16 949 100 279
 PHONE: 02 9907 8011
 WWW.SCRIVENER-DESIGN.COM
 EMAIL: PAUL@SCRIVENER-DESIGN.COM

PROJECT: PROPOSED APARTMENTS,
 19-23 THE CORSO,
 MANLY, NSW

DWG: SECTIONS AA, BB AND CC
 DATE: 6.4.22 SCALE: 1:50 @A1
 JOB REF: 22/2363 SHEET No: 5 OF 5

BUILDER MUST VERIFY ALL DIMENSIONS OF THE SITE BEFORE WORK COMMENCES.
 THE CONCEPTS, DESIGN, DETAILS AND INFORMATION DESCRIBED IN THE DRAWING ARE COPYRIGHT. OTHER THAN FOR THE PURPOSE PRESCRIBED UNDER THE COPYRIGHT ACT, NO PART OF IT MAY IN ANY FORM OR BY ANY MEANS BE USED OR REPRODUCED WITHOUT PRIOR WRITTEN PERMISSION.