

PROJECT: SUBDIVISION WORKS
 PLANSET: SUBDIVISION, DRIVEWAY AND DRAINAGE WORKS
 CLIENT: CARISTE PTY LTD

DRAWING LIST		
DWG NO.	REV	DWG TITLE
GENERAL		
PS02-A000	C	COVERSHEET
PS02-A010	B	GENERAL NOTES
PS02-A050	C	GENERAL LAYOUT PLAN
PS02-A400	C	SUBDIVISION PLAN (LAYOUT 02)
CONSTRUCTION MANAGEMENT WORKS		
PS02-B300	C	SEDIMENT & EROSION CONTROL PLAN (LAYOUT 01)
PS02-B310	B	SEDIMENT & EROSION CONTROL DETAILS
PS02-B500	C	DEMOLITION PLAN (LAYOUT 01)
EARTHWORKS		
PS02-C100	C	EARTHWORKS PLAN (LAYOUT 01)
PS02-C600	C	EARTHWORKS CUT & FILL PLAN (LAYOUT 01)
ROADWORK		
PS02-D100	C	DRIVEWAY PLAN (LAYOUT 01)
PS02-D200	B	MC01 LONGITUDINAL SECTION
PS02-D201	B	NC01 TYPICAL SECTIONS
PS02-D600	B	DRIVEWAY CROSS SECTIONS - SHEET 1
PS02-D601	B	DRIVEWAY CROSS SECTIONS - SHEET 2
PS02-DZ00	C	SWEPT PATH PLAN (LAYOUT 01)
WATER MANAGEMENT PLANS		
PS02-E200	C	DRAINAGE PLAN (LAYOUT 01)
PS02-E500	C	ON-SITE DETENTION PLAN (LAYOUT 01)
LANDSCAPE		
PS02-F300	C	TREE PLAN (LAYOUT 02)
UTILITIES AND SERVICES		
PS02-H200	C	SEWER & WATER PLAN (LAYOUT 01)



LOCALITY PLAN
N.T.S.

PITTWATER COUNCIL
 62 HILLSIDE ROAD, NEWPORT, NSW
 LOT 1 DP408800

DEVELOPMENT APPLICATION

REV	DESCRIPTION	DATE	DRAWN	DESIGNED	CHECKED	APPRVD	SCALE	GRID	DATUM	PROJECT MANAGER	CLIENT	DRAWING TITLE
C	FOR DA SUBMISSION	07/07/2016	RK	TH	TH	GT		N/A	N/A	GT	CARISTE PTY LTD	COVERSHEET
B	FOR CLIENT REVIEW	03/06/2016	RK	TH	TH	GT						
A	FOR CLIENT REVIEW	04/03/2016	RK	TH	TH	GT						
DISCLAIMER & COPYRIGHT This plan must not be used for construction unless signed as approved by principal certifying authority. All measurements in millimetres unless otherwise specified. This drawing must not be reproduced in whole or part without prior written consent of Martens & Associates Pty Ltd. (C) Copyright Martens & Associates Pty Ltd								PROJECT NAME/PLANSET TITLE SUBDIVISION WORKS SUBDIVISION, DRIVEWAY AND DRAINAGE WORKS 62 HILLSIDE ROAD, NEWPORT NSW LOT 1 DP408800		Consulting Engineers Environment Water Geotechnical Civil		DRAWING TITLE COVERSHEET
PROJECT NO. P1203617			PLANSET NO. PS02		RELEASE NO. R03		DRAWING NO. PS02-A000		REVISION C		Suite 201, 20 George St, Hornsby, NSW 2077 Australia Phone: (02) 9476 9999 Fax: (02) 9476 8767 Email: mail@martens.com.au Internet: www.martens.com.au	

GENERAL NOTES

- 1 THIS PLAN IS FOR DEVELOPMENT APPLICATION PURPOSE AND NOT FOR CONSTRUCTION. DESIGN TO BE REVIEWED AND UPDATED FOR CONSTRUCTION CERTIFICATE.
- 2 ALL WORK TO BE CARRIED OUT IN ACCORDANCE WITH, AND THESE NOTES ARE TO BE READ IN CONJUNCTION WITH THE RELEVANT AUSTRALIAN STANDARDS, COUNCIL SPECIFICATIONS, AND ALL PROJECT CONSULTANT'S PLANS AND REPORTS.
- 3 INTERNAL SURVEY INFORMATION SHOWN BASED ON SURVEY INFORMATION PROVIDED BY ADAM CLERKE SURVEYORS PTY LTD (REF 9499P, 30/10/2015).
- 4 EXTERNAL SITE BOUNDARY BASED ON INFORMATION PROVIDED BY ADAM CLERKE SURVEYORS PTY LTD (REF 9499P, 30/10/2015).
- 5 LEVELS ARE TO AUSTRALIAN HEIGHT DATUM (AHD).

DEVELOPMENT APPLICATION

REV	DESCRIPTION	DATE	DRAWN	DESIGNED	CHECKED	APPRVD	SCALE
B	FOR CLIENT REVIEW	03/06/2016	RK	TH	TH	GT	
A	FOR CLIENT REVIEW	04/03/2016	RK	TH	TH	GT	

GRID	DATUM	PROJECT MANAGER	CLIENT
N/A	N/A	GT	CARISTE PTY LTD

DISCLAIMER & COPYRIGHT
 This plan must not be used for construction unless signed as approved by principal certifying authority.
 All measurements in millimetres unless otherwise specified.
 This drawing must not be reproduced in whole or part without prior written consent of Martens & Associates Pty Ltd.
 (C) Copyright Martens & Associates Pty Ltd

PROJECT NAME/PLANSET TITLE
SUBDIVISION WORKS
 SUBDIVISION, DRIVEWAY AND DRAINAGE WORKS
 62 HILLSIDE ROAD, NEWPORT NSW
 LOT 1 DP408800



Consulting Engineers
 Environment
 Water
 Geotechnical
 Civil

Suite 201, 20 George St, Hornsby, NSW 2077 Australia Phone: (02) 9476 9999 Fax: (02) 9476 8767
 Email: mail@martens.com.au Internet: www.martens.com.au

DRAWING TITLE				
GENERAL NOTES				
PROJECT NO.	PLANSET NO.	RELEASE NO.	DRAWING NO.	REVISION
P1203617	PS02	R03	PS02-A010	B

PRINTED: 01/01/2016 USER: P:\A3 LANDSCAPE\A17_A3 LANDSCAPE (A17C_02.0.01)

A17_A3 LANDSCAPE (A17C_02.0.01)

DRAWING ID: P1203617-PS02-R03-A010

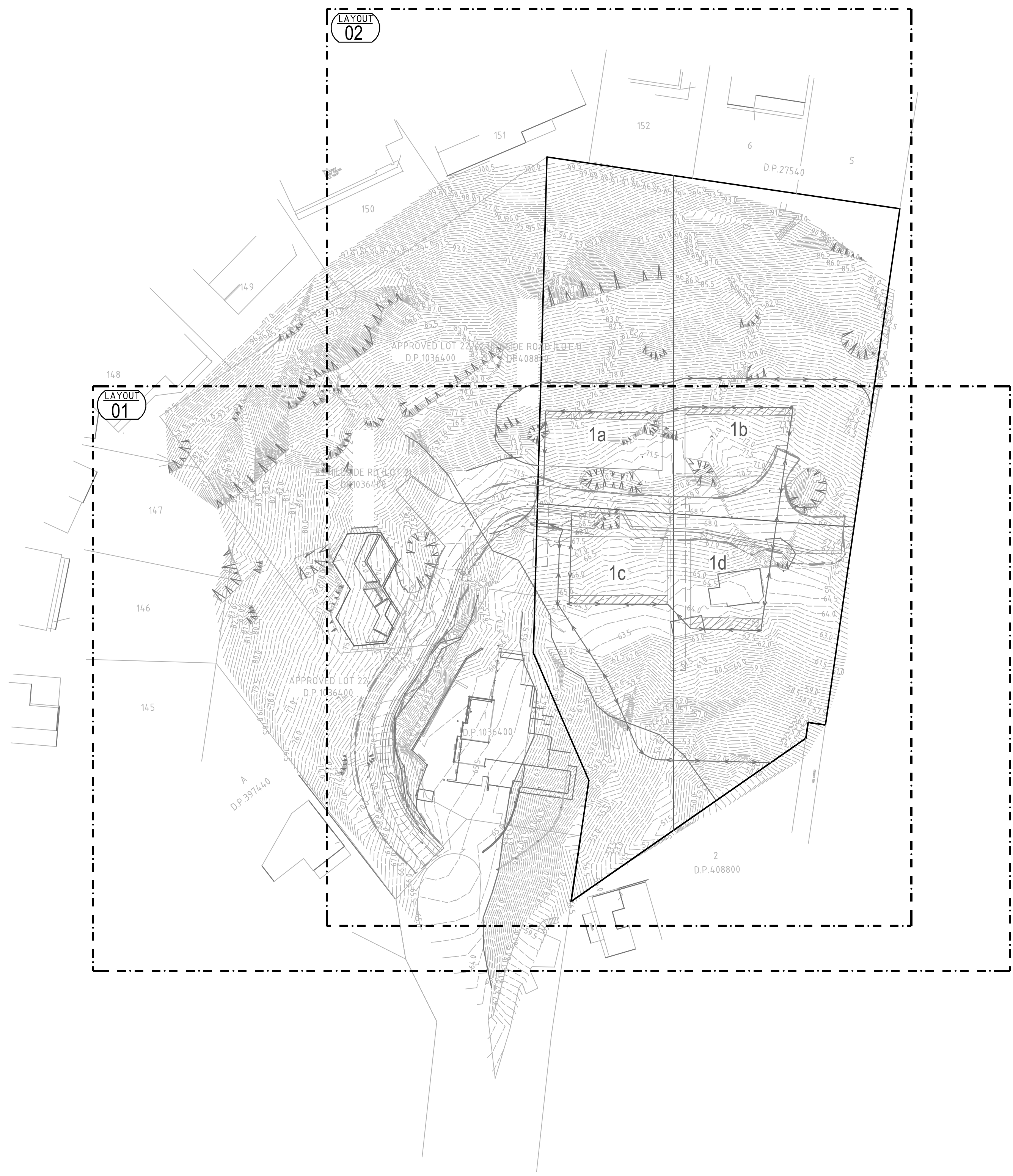

KEY	
EXISTING CONTOURS	-----
SHEET LAYOUT	- - - - -
SITE BOUNDARY	—————

PRINTED: 10/01/2016 USER: P1203617-PS02-R03-A050

REV	DESCRIPTION	DATE	DRAWN	DESIGNED	CHECKED	APPRVD
C	FOR DA SUBMISSION	07/07/2016	RK	TH	TH	GT
B	FOR CLIENT REVIEW	03/06/2016	RK	TH	TH	GT
A	FOR CLIENT REVIEW	04/03/2016	RK	TH	TH	GT

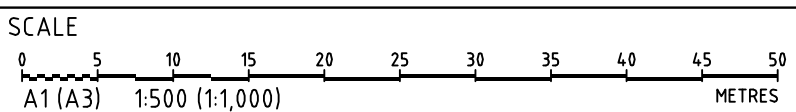

GRID	MGA	DATUM	PROJECT MANAGER	CLIENT
	mAH	GT		
DISCLAIMER & COPYRIGHT This plan must not be used for construction unless signed as approved by principal certifying authority. All measurements in millimetres unless otherwise specified. This drawing must not be reproduced in whole or part without prior written consent of Martens & Associates Pty Ltd. (C) Copyright Martens & Associates Pty Ltd				

PROJECT NAME/PLANSET TITLE
CARISTE PTY LTD
SUBDIVISION WORKS
SUBDIVISION, DRIVEWAY AND DRAINAGE WORKS
62 HILLSIDE ROAD, NEWPORT NSW LOT 1 DP408800



Consulting Engineers
Environment
Water
Geotechnical
Civil

Suite 201, 20 George St, Hornsby, NSW 2077 Australia Phone: (02) 9476 9999 Fax: (02) 9476 8767
Email: mail@martens.com.au Internet: www.martens.com.au

DEVELOPMENT APPLICATION

DRAWING TITLE				
GENERAL LAYOUT PLAN				
PROJECT NO.	PLANSET NO.	RELEASE NO.	DRAWING NO.	REVISION
P1203617	PS02	R03	PS02-A050	C

DRAWING ID: P1203617-PS02-R03-A050

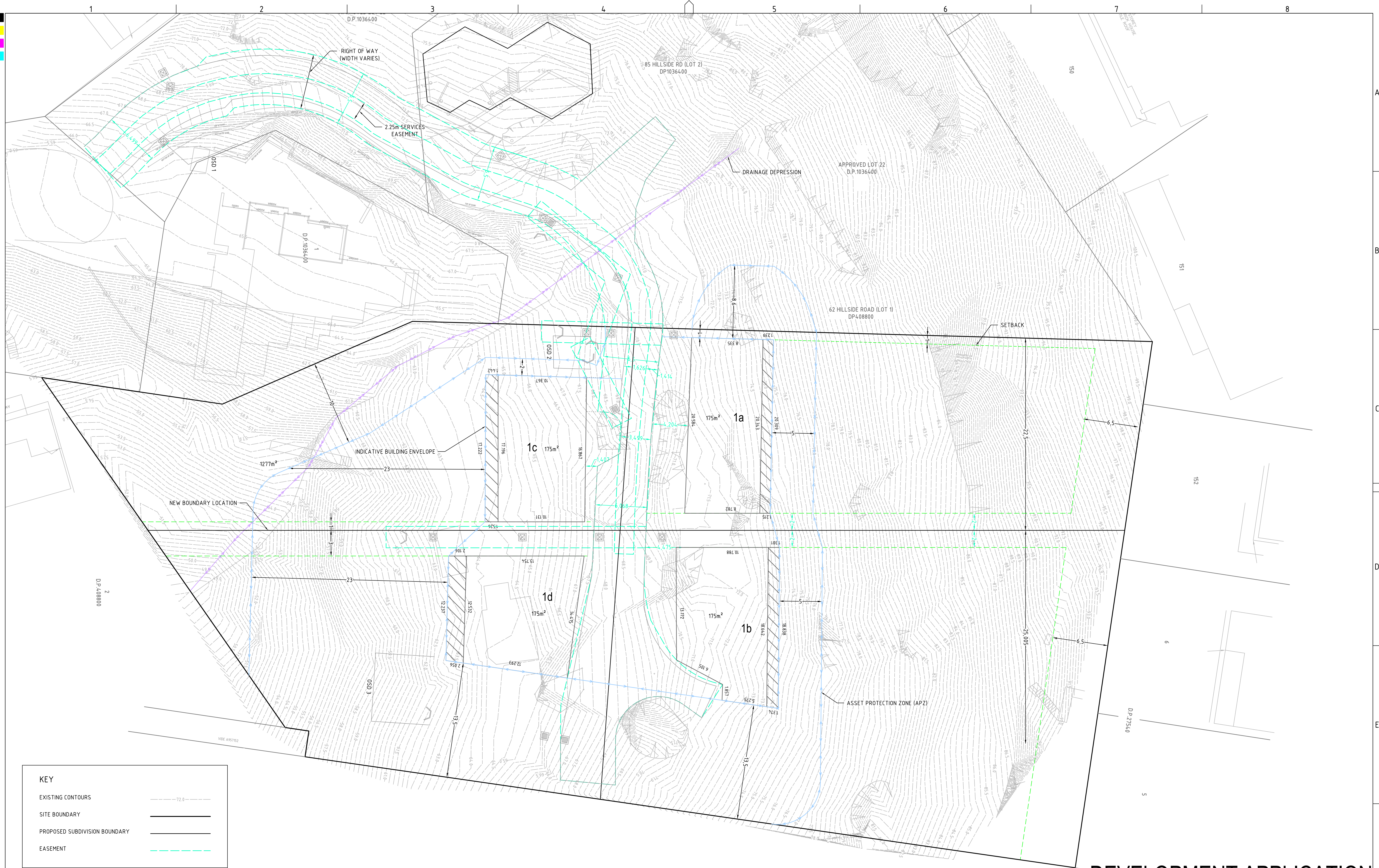

KEY	
EXISTING CONTOURS	--- 72.0 ---
SITE BOUNDARY	—————
PROPOSED SUBDIVISION BOUNDARY	—————
EASEMENT	- - - - -

DEVELOPMENT APPLICATION

REV	DESCRIPTION	DATE	DRAWN	DESIGNED	CHECKED	APPRVD
C	FOR DA SUBMISSION	07/07/2016	RK	TH	TH	GT
B	FOR CLIENT REVIEW	03/06/2016	RK	TH	TH	GT
A	FOR CLIENT REVIEW	04/03/2016	RK	TH	TH	GT

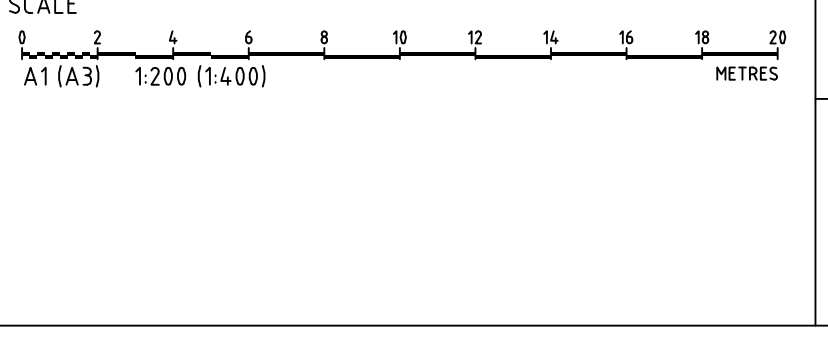

GRID	DATUM	PROJECT MANAGER	CLIENT
MGA	mAHD	GT	CARISTE PTY LTD

DISCLAIMER & COPYRIGHT
 This plan must not be used for construction unless signed as approved by principal certifying authority.
 All measurements in millimetres unless otherwise specified.
 This drawing must not be reproduced in whole or part without prior written consent of Martens & Associates Pty Ltd.
 (C) Copyright Martens & Associates Pty Ltd

PROJECT NAME/PLANSSET TITLE
SUBDIVISION WORKS
 SUBDIVISION, DRIVEWAY AND DRAINAGE WORKS
 62 HILLSIDE ROAD, NEWPORT NSW
 LOT 1 DP408800

martens
 & Associates Pty Ltd

Consulting Engineers
 Environment
 Water
 Geotechnical
 Civil

Suite 201, 20 George St, Hornsby, NSW 2077 Australia Phone: (02) 9476 9999 Fax: (02) 9476 8767
 Email: mail@martens.com.au Internet: www.martens.com.au

DRAWING TITLE				
TOWN PLANNING PLAN (LAYOUT 02)				
PROJECT NO.	PLANSSET NO.	RELEASE NO.	DRAWING NO.	REVISION
P1203617	PS02	R03	PS02-A400	C

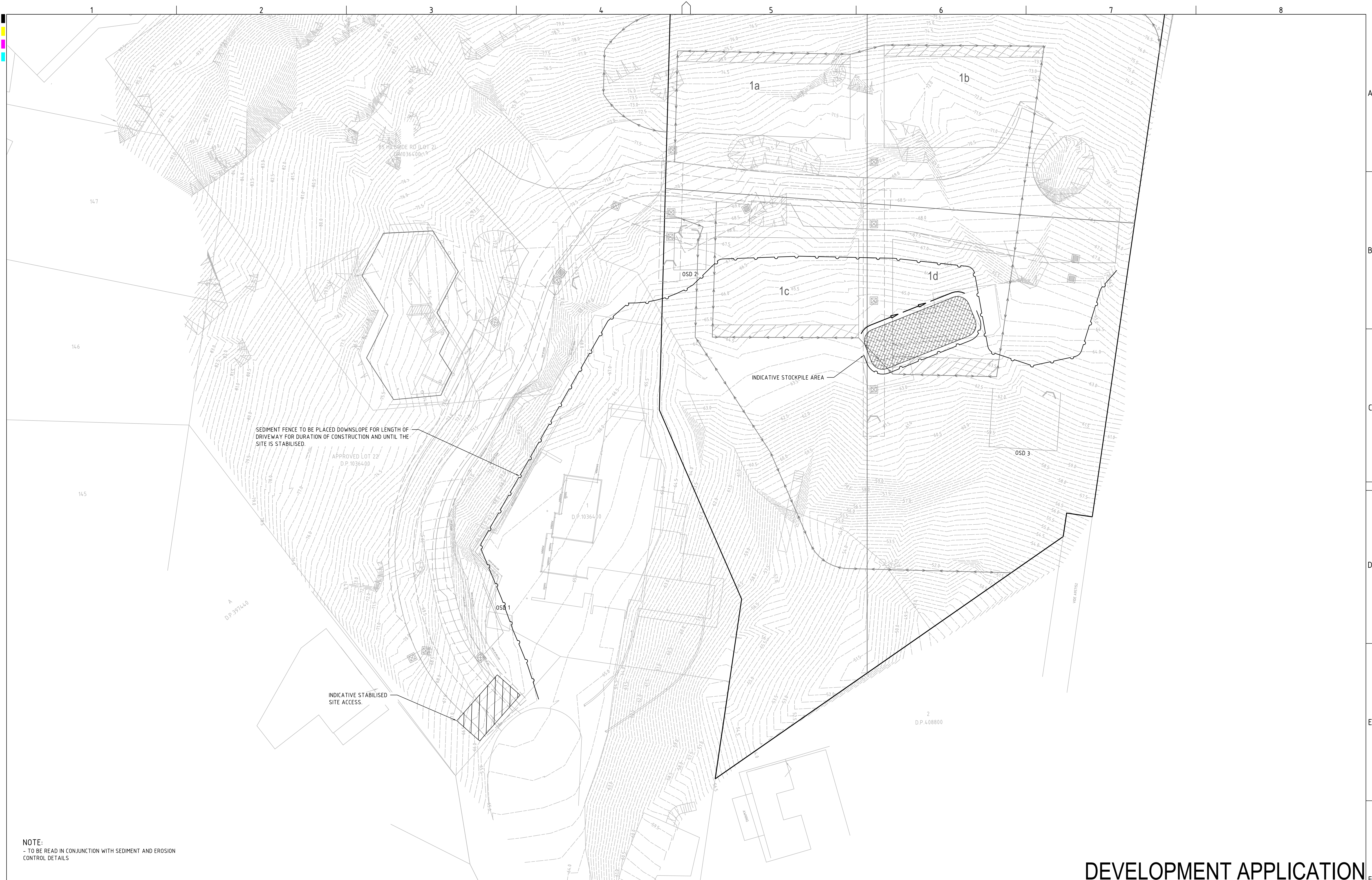

NOTE:
- TO BE READ IN CONJUNCTION WITH SEDIMENT AND EROSION CONTROL DETAILS

REV	DESCRIPTION	DATE	DRAWN	DESIGNED	CHECKED	APPRVD
C	FOR DA SUBMISSION	07/07/2016	RK	TH	TH	GT
B	FOR CLIENT REVIEW	03/06/2016	RK	TH	TH	GT
A	FOR CLIENT REVIEW	04/03/2016	RK	TH	TH	GT

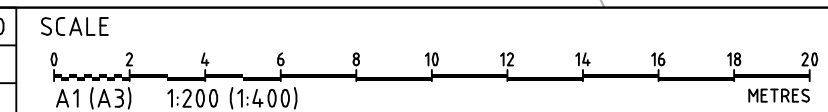

GRID
MGA
DATUM
mAHD
PROJECT MANAGER
GT
CLIENT
CARISTE PTY LTD
PROJECT NAME/PLANSSET TITLE
SUBDIVISION WORKS
SUBDIVISION, DRIVEWAY AND DRAINAGE WORKS
62 HILLSIDE ROAD, NEWPORT NSW
LOT 1 DP408800
DISCLAIMER & COPYRIGHT
This plan must not be used for construction unless signed as approved by principal certifying authority.
All measurements in millimetres unless otherwise specified.
This drawing must not be reproduced in whole or part without prior written consent of Martens & Associates Pty Ltd.
(C) Copyright Martens & Associates Pty Ltd

GRID
MGA
DATUM
mAHD
PROJECT MANAGER
GT
CLIENT
CARISTE PTY LTD
PROJECT NAME/PLANSSET TITLE
SUBDIVISION WORKS
SUBDIVISION, DRIVEWAY AND DRAINAGE WORKS
62 HILLSIDE ROAD, NEWPORT NSW
LOT 1 DP408800

martens & Associates Pty Ltd
Consulting Engineers
Environment
Water
Geotechnical
Civil
Suite 201, 20 George St, Hornsby, NSW 2077 Australia Phone: (02) 9476 9999 Fax: (02) 9476 8767
Email: mail@martens.com.au Internet: www.martens.com.au

DRAWING TITLE SEDIMENT AND EROSION CONTROL PLAN (LAYOUT 01)				
PROJECT NO. P1203617	PLANSSET NO. PS02	RELEASE NO. R03	DRAWING NO. PS02-B300	REVISION C

DEVELOPMENT APPLICATION

STABILISED ACCESS POINT

TYPE II SAP

THE TYPE II SAP DESIGN IS MORE DEFINED IN THAT IT REQUIRES AN AREA OF BALLAST WITHIN THE SITE COMBINED WITH A SHAKER PAD, ADJACENT TO THE SHAKER PAD AND IN THE PUBLIC WAY IS A TEMPORARY (CONCRETE) VEHICULAR CROSSING. (SEE DIAGRAM)

STABILISED ACCESS POINT - TYPE 2

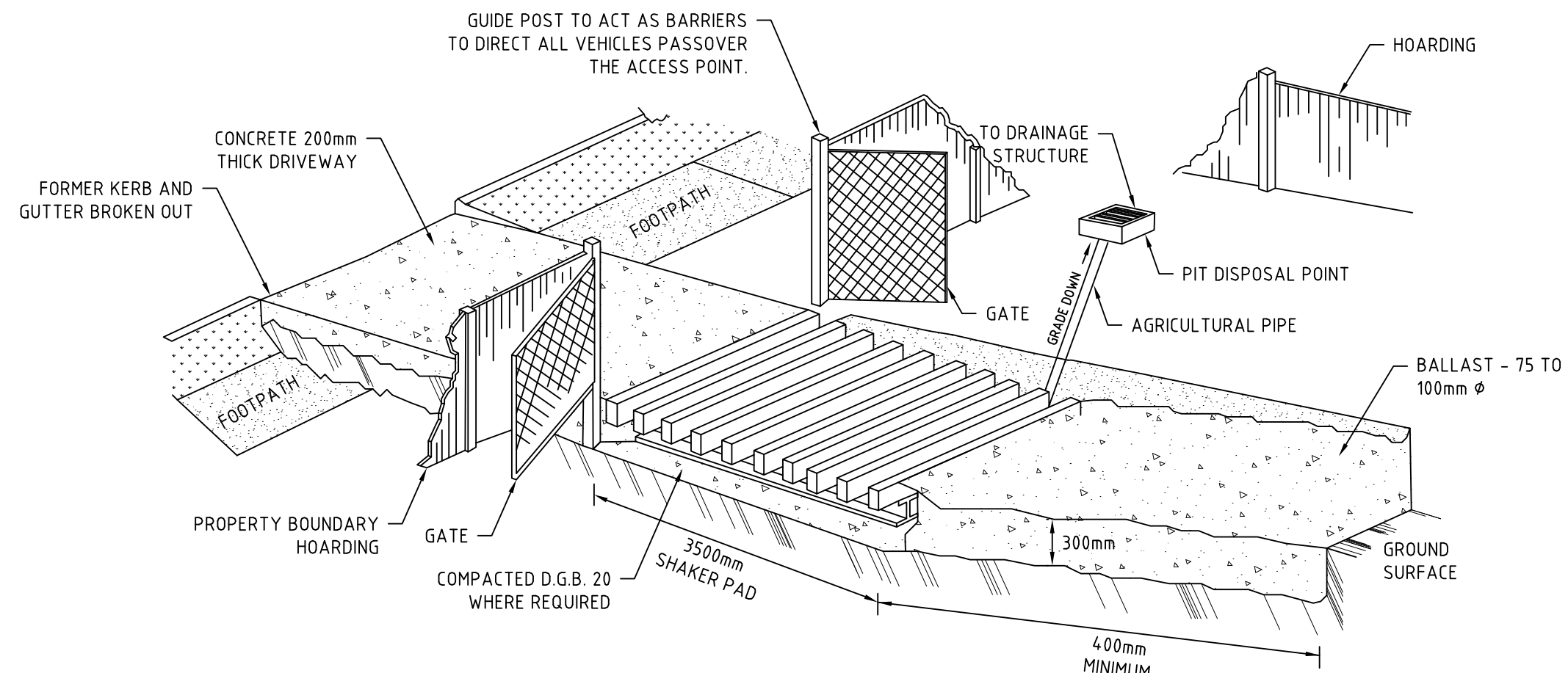

IN BOTH TYPE I AND TYPE II SAP'S, THE TEMPORARY VEHICULAR CROSSING MUST:

- CONNECT TO AN EXISTING GUTTER LAYBACK (WHERE THE KERB AND GUTTER EXIST). IF A GUTTER LAYBACK DOES NOT EXIST THEN THE CONNECTION MUST BE MADE TO THE GUTTER BY REMOVING THE ADJACENT KERB SECTION ONLY.
- CONNECT TO A DISH CROSSING (WHERE KERB AND GUTTER DOES NOT EXIST). IF A DISH CROSSING DOES NOT EXIST, THEN IT MUST BE CONSTRUCTED IN ACCORDANCE WITH DETAILS CONTAINED IN COUNCIL'S ISSUED FOOTPATH CROSSING LEVELS.

IT SHOULD BE NOTED THAT THESE TYPES OF SAPS ARE CONSIDERED TO BE APPLICABLE FOR THE MAJORITY OF ACTIVITIES HOWEVER SOME SITES MAY REQUIRE SPECIAL CONSIDERATION.

SHAKER PAD (CATTLE GRID)

A CORRECTLY DESIGNED AND INSTALLED SHAKER PAD WILL ASSIST IN PREVENTING SEDIMENT TRANSFER FROM A SITE. ANY STABILISED ACCESS POINT (SAP) CAN BE DESIGNED WITH A SHAKER PAD (COMPULSORY IN TYPE II SAP'S)

SHAKER PADS CAN BE DESIGNED AND CONSTRUCTED TO ENABLE RE-USE ON FUTURE PROJECTS.

THE SHAKER PAD:

- MUST BE DESIGNED AND CERTIFIED BY A PRACTISING STRUCTURAL ENGINEER. THE CERTIFIED DESIGN SHOULD BE SUBMITTED WITH THE RELEVANT APPLICATION.
- CAN BE CONSTRUCTED FROM ANY SUITABLE MATERIAL.
- MUST BE LOCATED ON A SUITABLY PREPARED AND COMPACTED SUB-GRADE/BASE MATERIAL.
- MUST BE SITUATED SUCH THAT THE RUNGS OF THE SHAKER PAD ARE LEVEL WITH THE ADJOINING NATURAL SURFACE.
- MUST BE A MINIMUM OF 3.5m IN LENGTH.
- MUST BE A MINIMUM OF 3.5m IN WIDTH.
- MUST HAVE CLEAR SPACING BETWEEN RUNGS OF 200 - 250mm.
- RUNGS MUST HAVE A MAXIMUM WIDTH (BEARING AREA) OF 75mm.
- MUST HAVE A MINIMUM CLEAR DEPTH OF 300mm IE FROM THE TOP OF THE RUNG TO THE FINISHED SUB-GRADE/BASE LEVEL.

THE SHAKER PAD MUST BE PROVIDED WITH SUITABLE BARRIERS AT THE SIDES TO ENSURE THAT ALL TYERS OF VEHICLES LEAVING THE SITE TRAVERSE THE DEVICE.

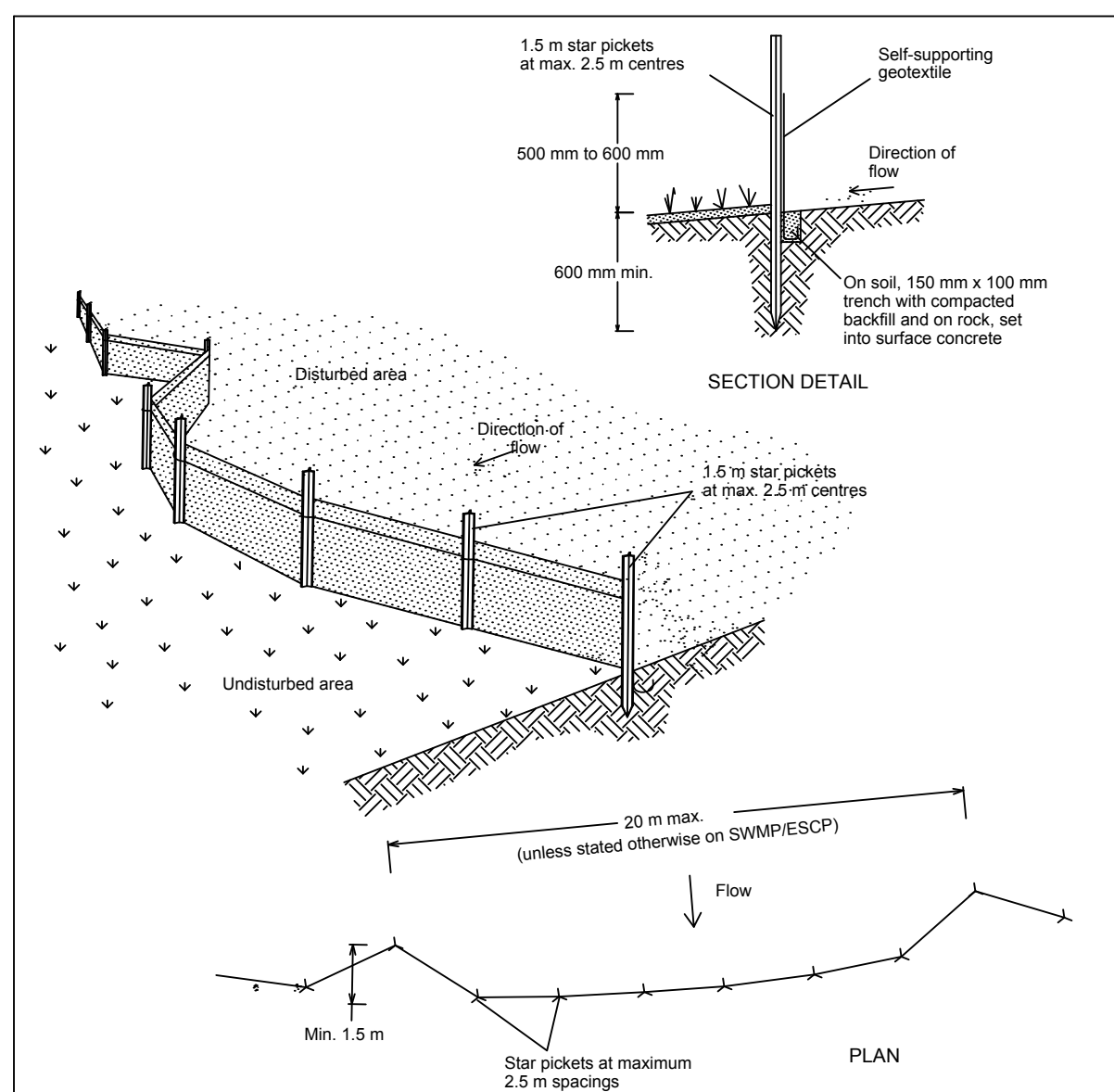
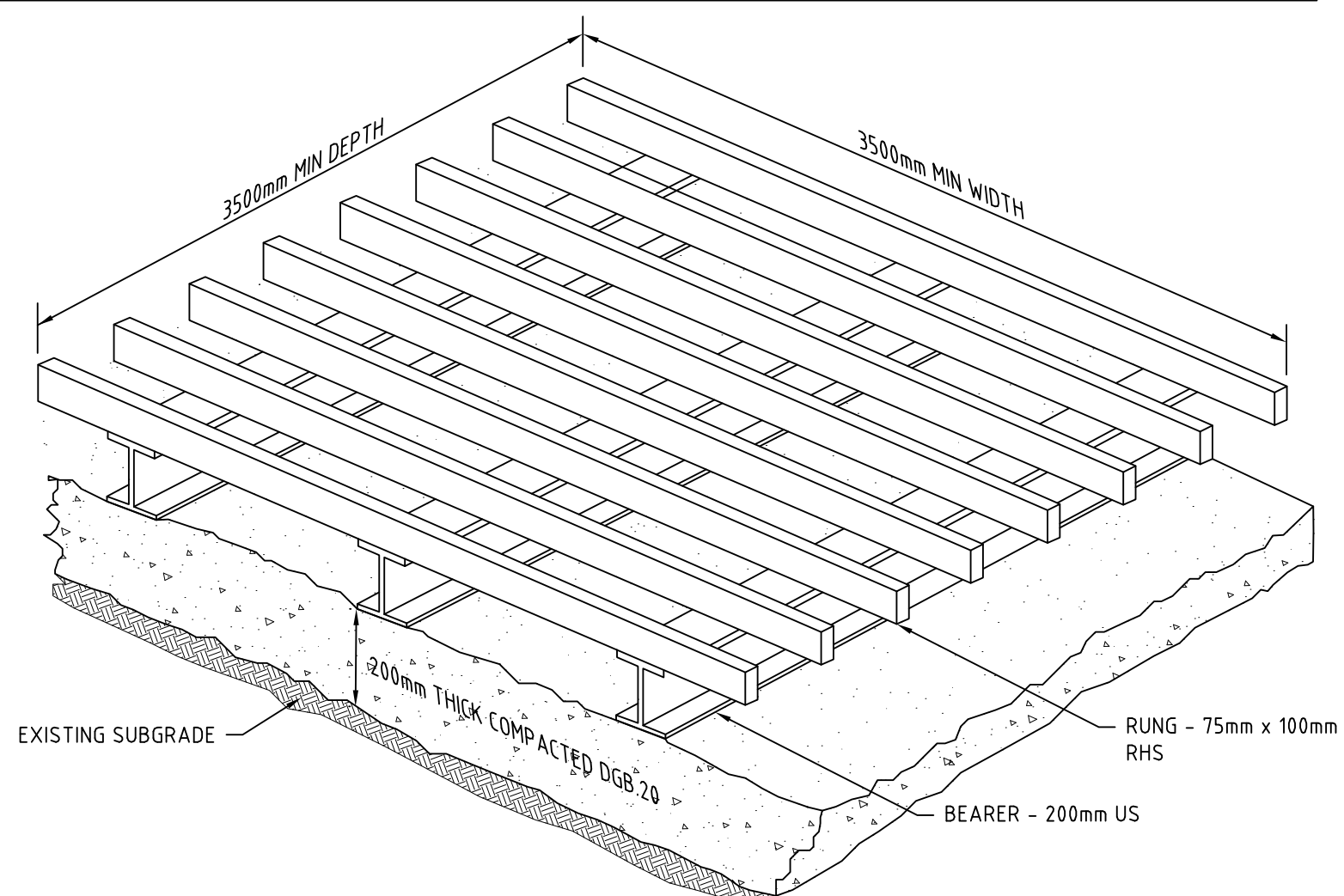

Construction Notes

- Construct sediment fences as close as possible to being parallel to the contours of the site, but with small returns as shown in the drawing to limit the catchment area of any one section. The catchment area should be small enough to limit water flow if concentrated at one point to 50 litres per second in the design storm event, usually the 10-year event.
- Cut a 150-mm deep trench along the upslope line of the fence for the bottom of the fabric to be entrenched.
- Drive 1.5 metre long star pickets into ground at 2.5 metre intervals (max) at the downslope edge of the trench. Ensure any star pickets are fitted with safety caps.
- Fix self-supporting geotextile to the upslope side of the posts ensuring it goes to the base of the trench. Fix the geotextile with wire ties or as recommended by the manufacturer. Only use geotextile specifically produced for sediment fencing. The use of shade cloth for this purpose is not satisfactory.
- Join sections of fabric at a support post with a 150-mm overlap.
- Backfill the trench over the base of the fabric and compact it thoroughly over the geotextile.

SEDIMENT FENCE

SD 6-8

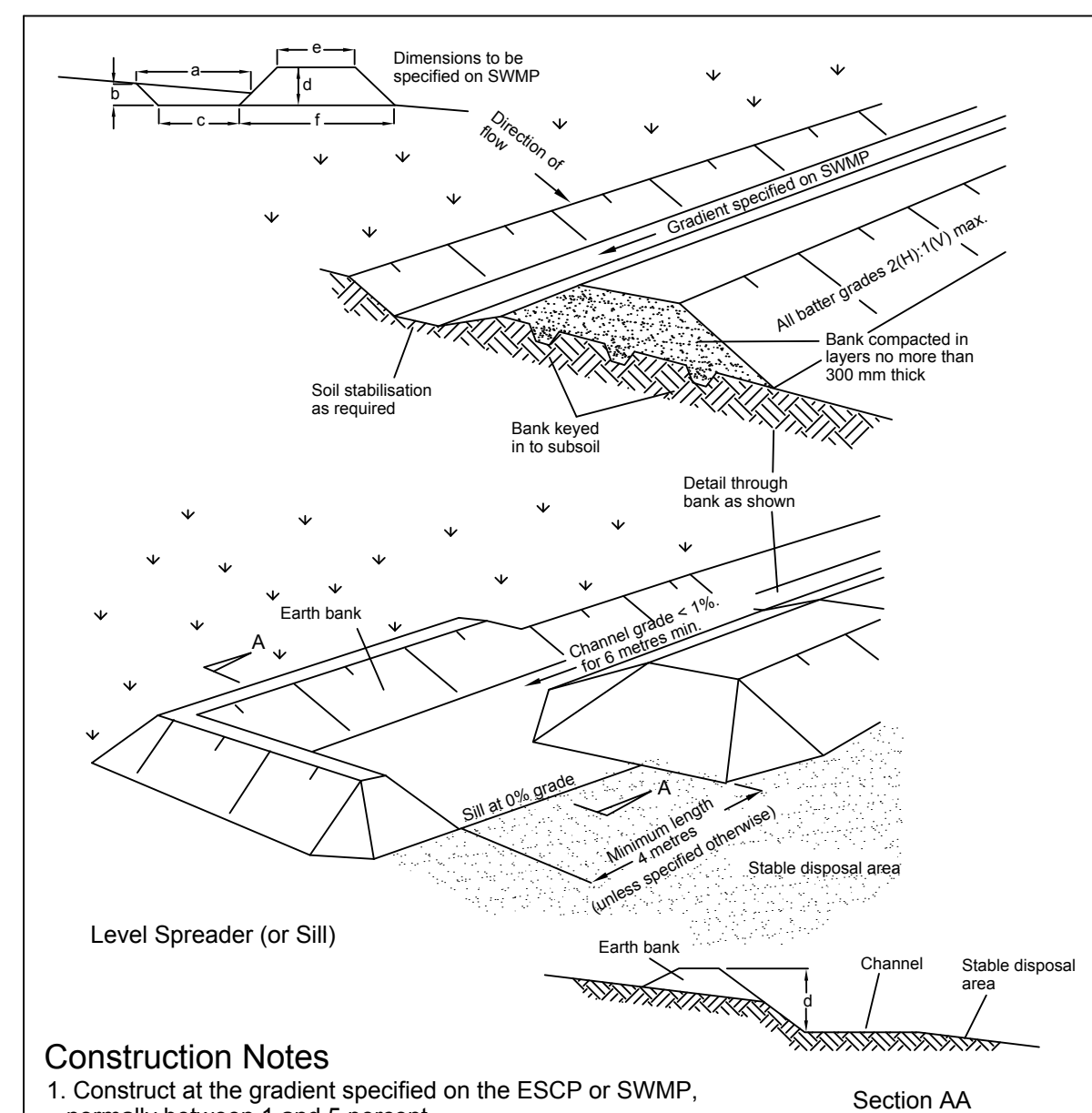

Construction Notes

- Construct at the gradient specified on the ESCP or SWMP, normally between 1 and 5 percent.
- Avoid removing trees and shrubs if possible - work around them.
- Ensure the structures are free of projections or other irregularities that could impede water flow.
- Build the drains with circular, parabolic or trapezoidal cross sections, not V-shaped, at the dimensions shown on the SWMP.
- Ensure the banks are properly compacted to prevent failure.
- Complete permanent or temporary stabilisation within 10 days of construction following Table 5.2 in Landcom (2004).
- Where discharging to erodible lands, ensure they outlet through a properly constructed level spreader.
- Construct the level spreader at the gradient specified on the ESCP or SWMP, normally less than 1 percent or level.
- Where possible, ensure they discharge waters onto either stabilised or undisturbed disposal sites within the same subcatchment area from which the water originated. Approval might be required to discharge into other subcatchments.

EARTH BANK (HIGH FLOWS)

SD 5-6

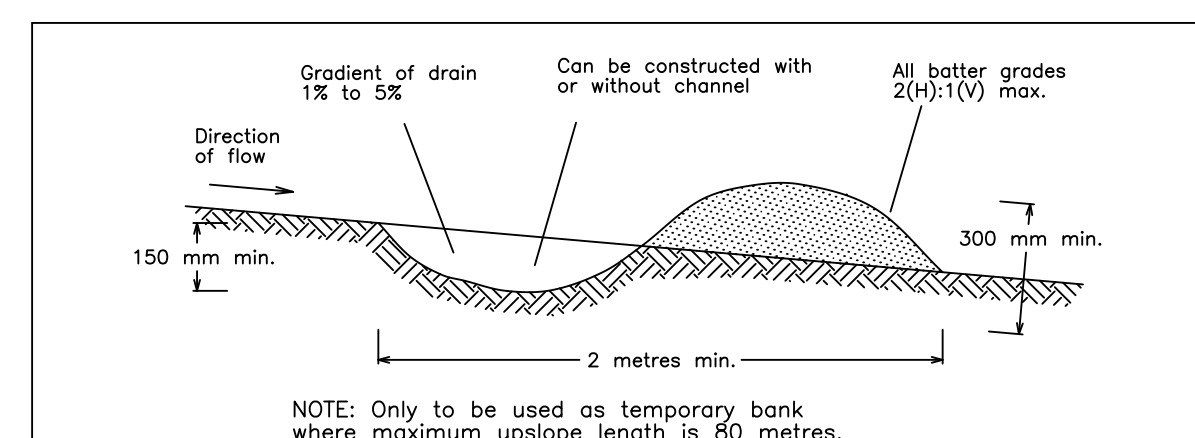

Construction Notes

- Build with gradients between 1 percent and 5 percent.
- Avoid removing trees and shrubs if possible - work around them.
- Ensure the structures are free of projections or other irregularities that could impede water flow.
- Build the drains with circular, parabolic or trapezoidal cross sections, not V shaped.
- Ensure the banks are properly compacted to prevent failure.
- Complete permanent or temporary stabilisation within 10 days of construction.

EARTH BANK (LOW FLOW)

SD 5-5

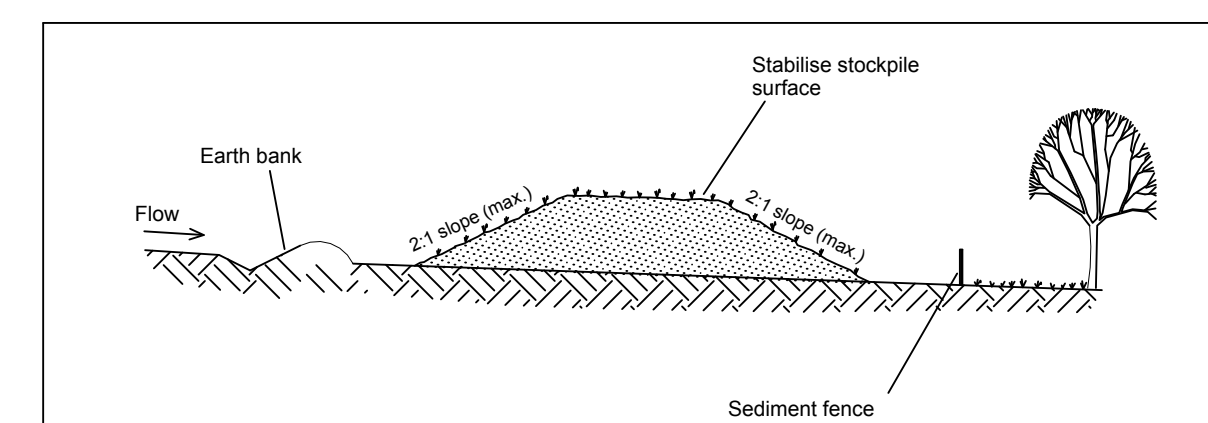

Construction Notes

- Place stockpiles more than 2 (preferably 5) metres from existing vegetation, concentrated water flow, roads and hazard areas.
- Construct on the contour as low, flat, elongated mounds.
- Where there is sufficient area, topsoil stockpiles shall be less than 2 metres in height.
- Where they are to be in place for more than 10 days, stabilise following the approved ESCP or SWMP to reduce the C-factor to less than 0.10.
- Construct earth banks (Standard Drawing 5-5) on the upslope side to divert water around stockpiles and sediment fences (Standard Drawing 6-8) 1 to 2 metres downslope.

STOCKPILES

SD 4-1

DEVELOPMENT APPLICATION

REV	DESCRIPTION	DATE	DRAWN	DESIGNED	CHECKED	APPRVD	SCALE
B	FOR CLIENT REVIEW	03/06/2016	RK	TH	TH	GT	
A	FOR CLIENT REVIEW	04/03/2016	RK	TH	TH	GT	

GRID	DATUM	PROJECT MANAGER	CLIENT
N/A	N/A	GT	

DISCLAIMER & COPYRIGHT	PROJECT NAME/PLANSET TITLE
This plan must not be used for construction unless signed as approved by principal certifying authority. All measurements in millimetres unless otherwise specified. This drawing must not be reproduced in whole or part without prior written consent of Martens & Associates Pty Ltd. (C) Copyright Martens & Associates Pty Ltd	CARISTE PTY LTD SUBDIVISION WORKS SUBDIVISION, DRIVEWAY AND DRAINAGE WORKS 62 HILLSIDE ROAD, NEWPORT NSW LOT 1 DP498800

martens
& Associates Pty Ltd

Consulting Engineers
Environment
Water
Geotechnical
Civil

Suite 201, 20 George St, Hornsby, NSW 2077 Australia Phone: (02) 9476 9999 Fax: (02) 9476 8767
Email: mail@martens.com.au Internet: www.martens.com.au

DRAWING TITLE				
SEDIMENT AND EROSION CONTROL DETAILS				
PROJECT NO.	PLANSET NO.	RELEASE NO.	DRAWING NO.	REVISION
P1203617	PS02	R03	PS02-B310	B

DRAWING ID: P1203617-PS02-R03-B310

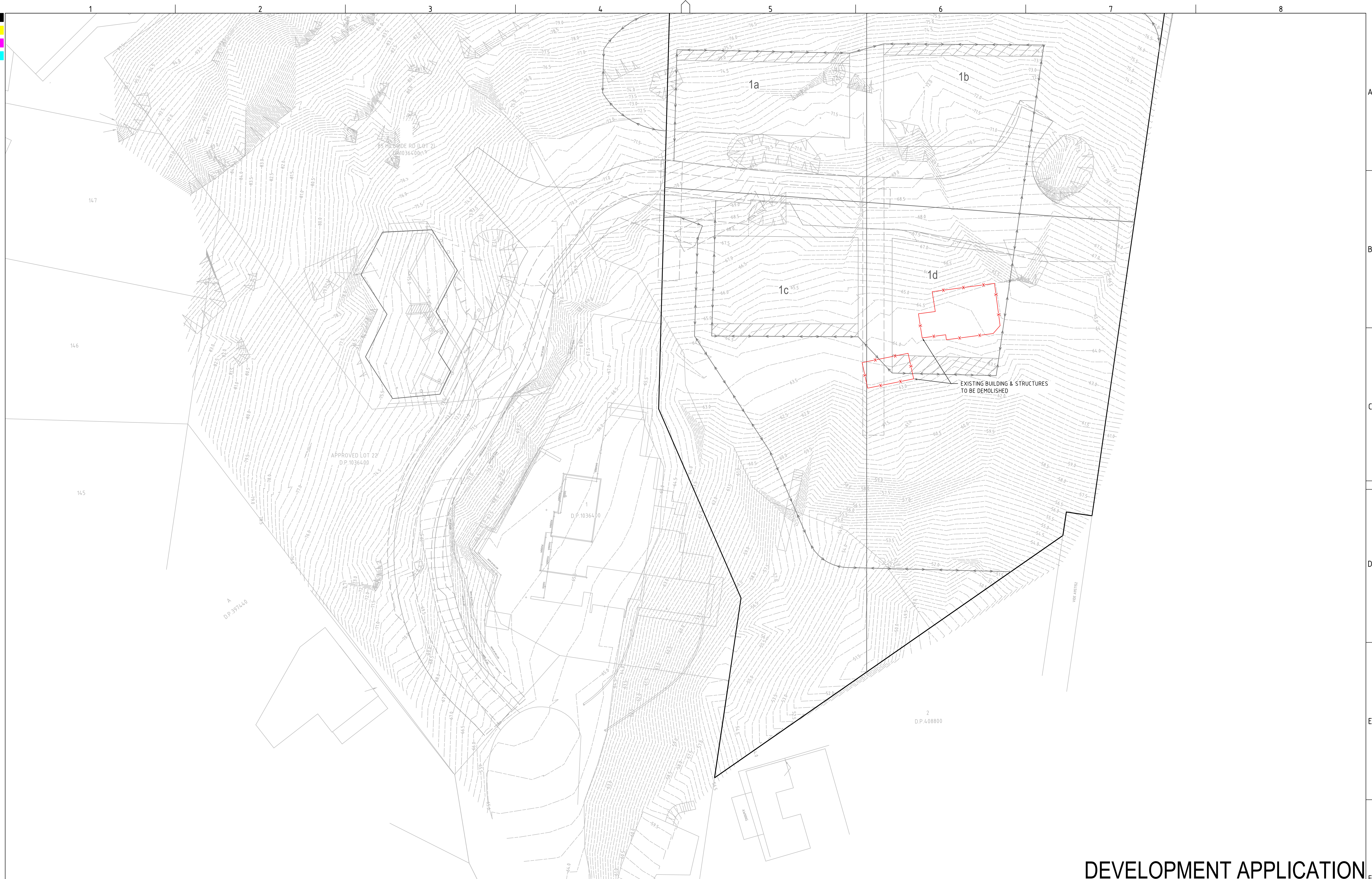

DEVELOPMENT APPLICATION

REV	DESCRIPTION	DATE	DRAWN	DESIGNED	CHECKED	APPRVD
C	FOR DA SUBMISSION	07/07/2016	RK	TH	TH	GT
B	FOR CLIENT REVIEW	03/06/2016	RK	TH	TH	GT
A	FOR CLIENT REVIEW	04/03/2016	RK	TH	TH	GT

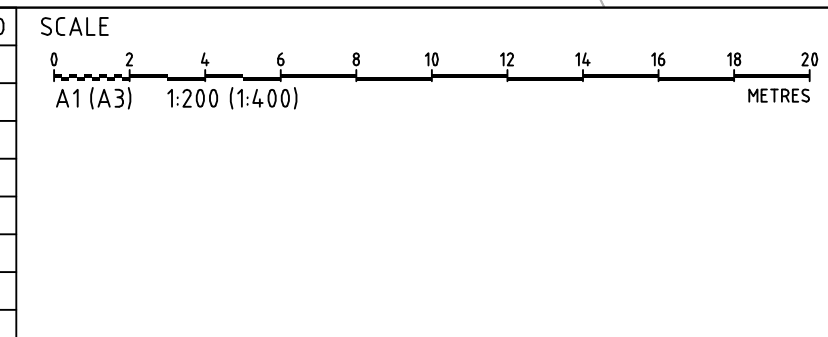

GRID MGA DATUM mAHD PROJECT MANAGER GT CLIENT

DISCLAIMER & COPYRIGHT
 This plan must not be used for construction unless signed as approved by principal certifying authority.
 All measurements in millimetres unless otherwise specified.
 This drawing must not be reproduced in whole or part without prior written consent of Martens & Associates Pty Ltd.
 (C) Copyright Martens & Associates Pty Ltd

CARISTE PTY LTD
SUBDIVISION WORKS
 SUBDIVISION, DRIVEWAY AND DRAINAGE WORKS
 62 HILLSIDE ROAD, NEWPORT NSW
 LOT 1 DP408800

martens & Associates Pty Ltd
 Consulting Engineers
 Environment Water Geotechnical Civil
 Suite 201, 20 George St, Hornsby, NSW 2077 Australia Phone: (02) 9476 9999 Fax: (02) 9476 8787
 Email: mail@martens.com.au Internet: www.martens.com.au

DRAWING TITLE				
DEMOLITION PLAN (LAYOUT 01)				
PROJECT NO.	PLANSET NO.	RELEASE NO.	DRAWING NO.	REVISION
P1203617	PS02	R03	PS02-B500	C

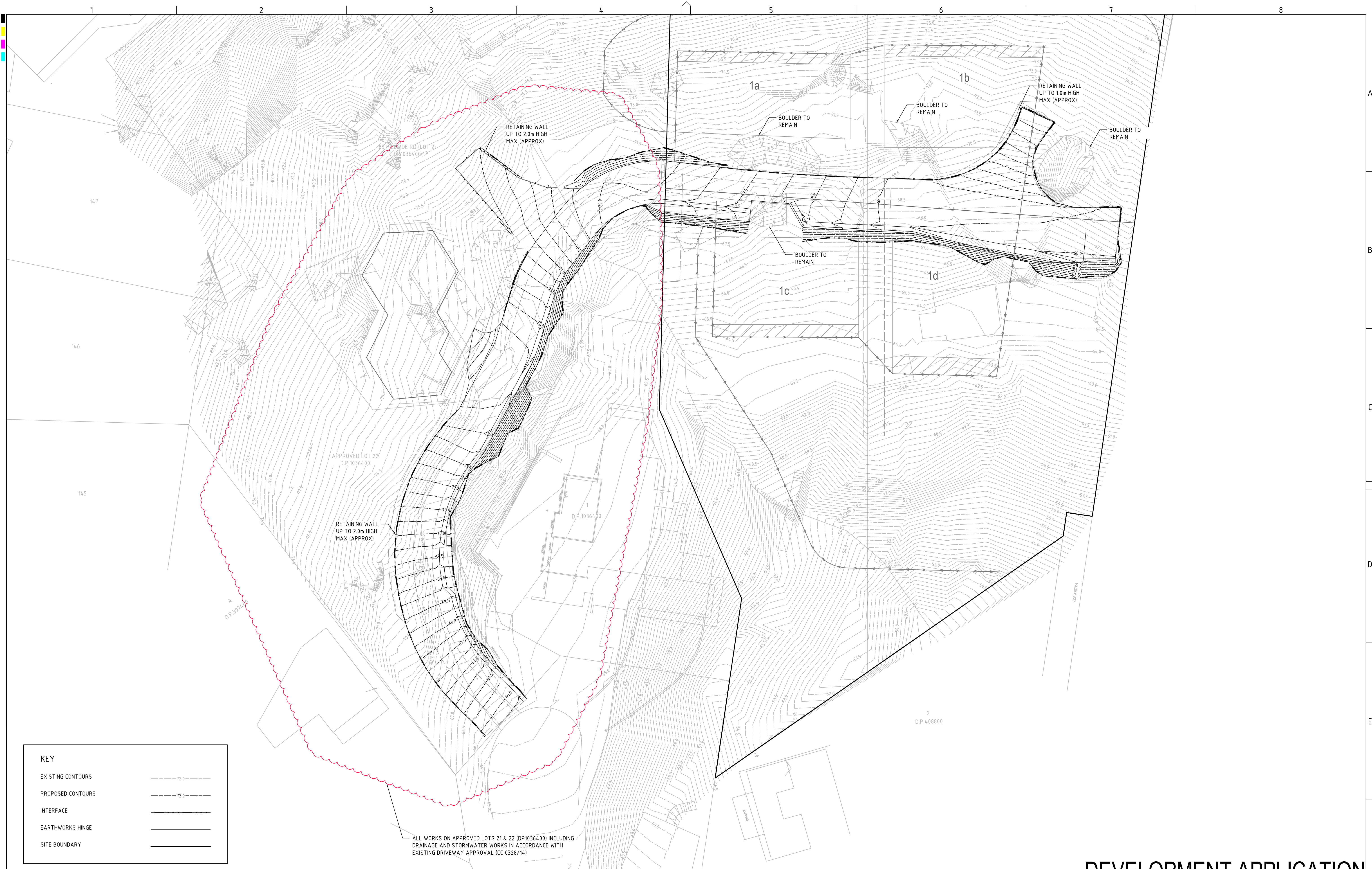

KEY	
EXISTING CONTOURS	--- 72.0 ---
PROPOSED CONTOURS	--- 72.0 ---
INTERFACE	— — — — —
EARTHWORKS HINGE	— — — — —
SITE BOUNDARY	— — — — —

ALL WORKS ON APPROVED LOTS 21 & 22 (DP1036400) INCLUDING DRAINAGE AND STORMWATER WORKS IN ACCORDANCE WITH EXISTING DRIVEWAY APPROVAL (CC 0328/14)

DEVELOPMENT APPLICATION

REV	DESCRIPTION	DATE	DRAWN	DESIGNED	CHECKED	APPRVD
C	FOR DA SUBMISSION	07/07/2016	RK	TH	TH	GT
B	FOR CLIENT REVIEW	03/06/2016	RK	TH	TH	GT
A	FOR CLIENT REVIEW	04/03/2016	RK	TH	TH	GT

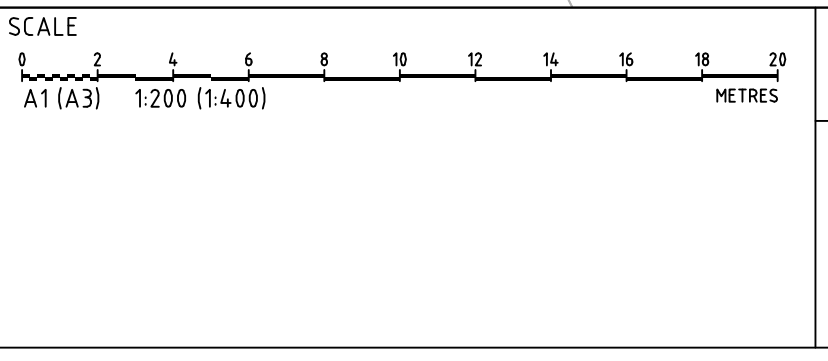

GRID MGA DATUM mAHD PROJECT MANAGER GT CLIENT

DISCLAIMER & COPYRIGHT
 This plan must not be used for construction unless signed as approved by principal certifying authority.
 All measurements in millimetres unless otherwise specified.
 This drawing must not be reproduced in whole or part without prior written consent of Martens & Associates Pty Ltd.
 (C) Copyright Martens & Associates Pty Ltd

CARISTE PTY LTD
SUBDIVISION WORKS
 SUBDIVISION, DRIVEWAY AND DRAINAGE WORKS
 62 HILLSIDE ROAD, NEWPORT NSW
 LOT 1 DP408800

martens & Associates Pty Ltd
 Consulting Engineers
 Environment Water Geotechnical Civil
 Suite 201, 20 George St, Hornsby, NSW 2077 Australia Phone: (02) 9476 9999 Fax: (02) 9476 8767
 Email: mail@martens.com.au Internet: www.martens.com.au

DRAWING TITLE				
EARTHWORKS PLAN (LAYOUT 01)				
PROJECT NO.	PLANSET NO.	RELEASE NO.	DRAWING NO.	REVISION
P1203617	PS02	R03	PS02-C100	C

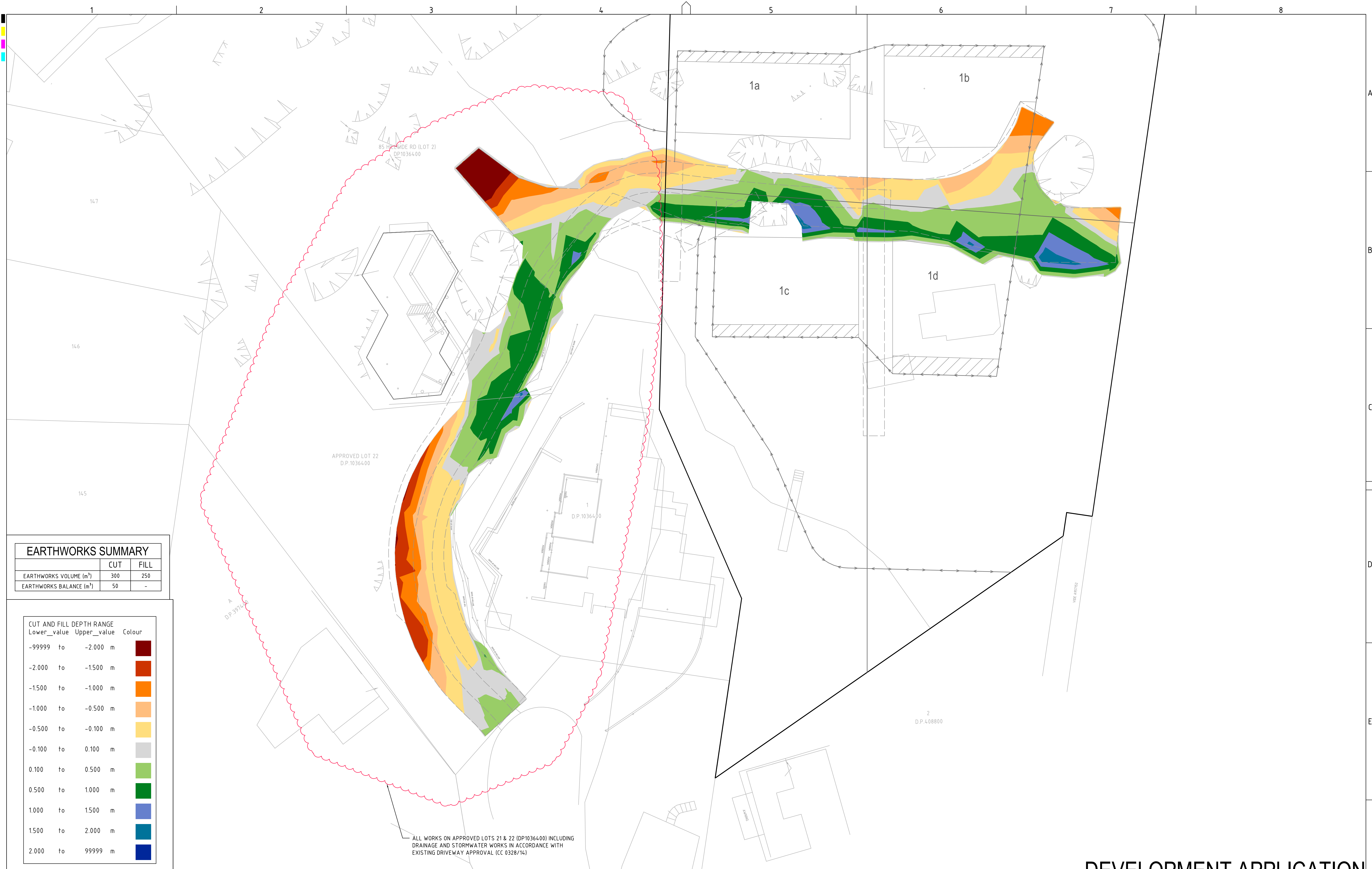

EARTHWORKS SUMMARY		
	CUT	FILL
EARTHWORKS VOLUME (m³)	300	250
EARTHWORKS BALANCE (m³)	50	-

CUT AND FILL DEPTH RANGE			Colour
Lower_value	Upper_value		
-99999	to -2.000	m	Dark Red
-2.000	to -1.500	m	Red
-1.500	to -1.000	m	Orange
-1.000	to -0.500	m	Light Orange
-0.500	to -0.100	m	Yellow
-0.100	to 0.100	m	Light Grey
0.100	to 0.500	m	Light Green
0.500	to 1.000	m	Green
1.000	to 1.500	m	Dark Green
1.500	to 2.000	m	Blue
2.000	to 99999	m	Dark Blue

REV	DESCRIPTION	DATE	DRAWN	DESIGNED	CHECKED	APPRVD
C	FOR DA SUBMISSION	07/07/2016	RK	TH	TH	GT
B	FOR CLIENT REVIEW	03/06/2016	RK	TH	TH	GT
A	FOR CLIENT REVIEW	04/03/2016	RK	TH	TH	GT

ALL WORKS ON APPROVED LOTS 21 & 22 (DP1036400) INCLUDING DRAINAGE AND STORMWATER WORKS IN ACCORDANCE WITH EXISTING DRIVEWAY APPROVAL (CC 0328/14)

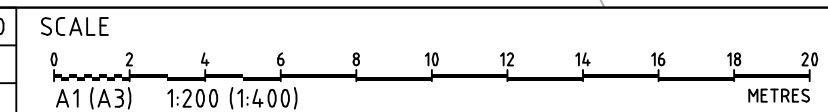

GRID MGA DATUM mAHD PROJECT MANAGER GT CLIENT

CARISTE PTY LTD
SUBDIVISION WORKS
SUBDIVISION, DRIVEWAY AND DRAINAGE WORKS



Consulting Engineers
Environment
Water
Geotechnical
Civil

DEVELOPMENT APPLICATION

DRAWING TITLE				
EARTHWORKS CUT & FILL PLAN (LAYOUT 01)				
PROJECT NO.	PLANSET NO.	RELEASE NO.	DRAWING NO.	REVISION
P1203617	PS02	R03	PS02-C600	C

PRINTED: 11:58:34 AM 07/07/2016