

PLAN SCALE 1:100
MODIFICATIONS SECTION 96
JULY 2016

- SCHEDULE OF AMENDMENTS TO APPROVED APPLICATION AUG 2015 S96 NO282/14/595/1
1. RELOCATION OF THE SPA TO THE WEST SIDE OF THE POOL FROM THE NORTH SIDE.
 2. RELOCATION OF ACCESS TO THE LOWER SITE LEVELS TO THE NORTH SIDE OF THE POOL FROM THE SOUTH SIDE AND ASSOCIATED LANDSCAPE WORKS.
 3. REDUCTION OF GLASS EDGES TO THE POOL: NOW EAST SIDE ONLY.
 4. POOL INCREASED IN LENGTH FROM 6700 TO 6800mm AND MOVED 900mm TO EAST. OVERALL WIDTH AT EASTERN END INCREASED TO 3000mm.

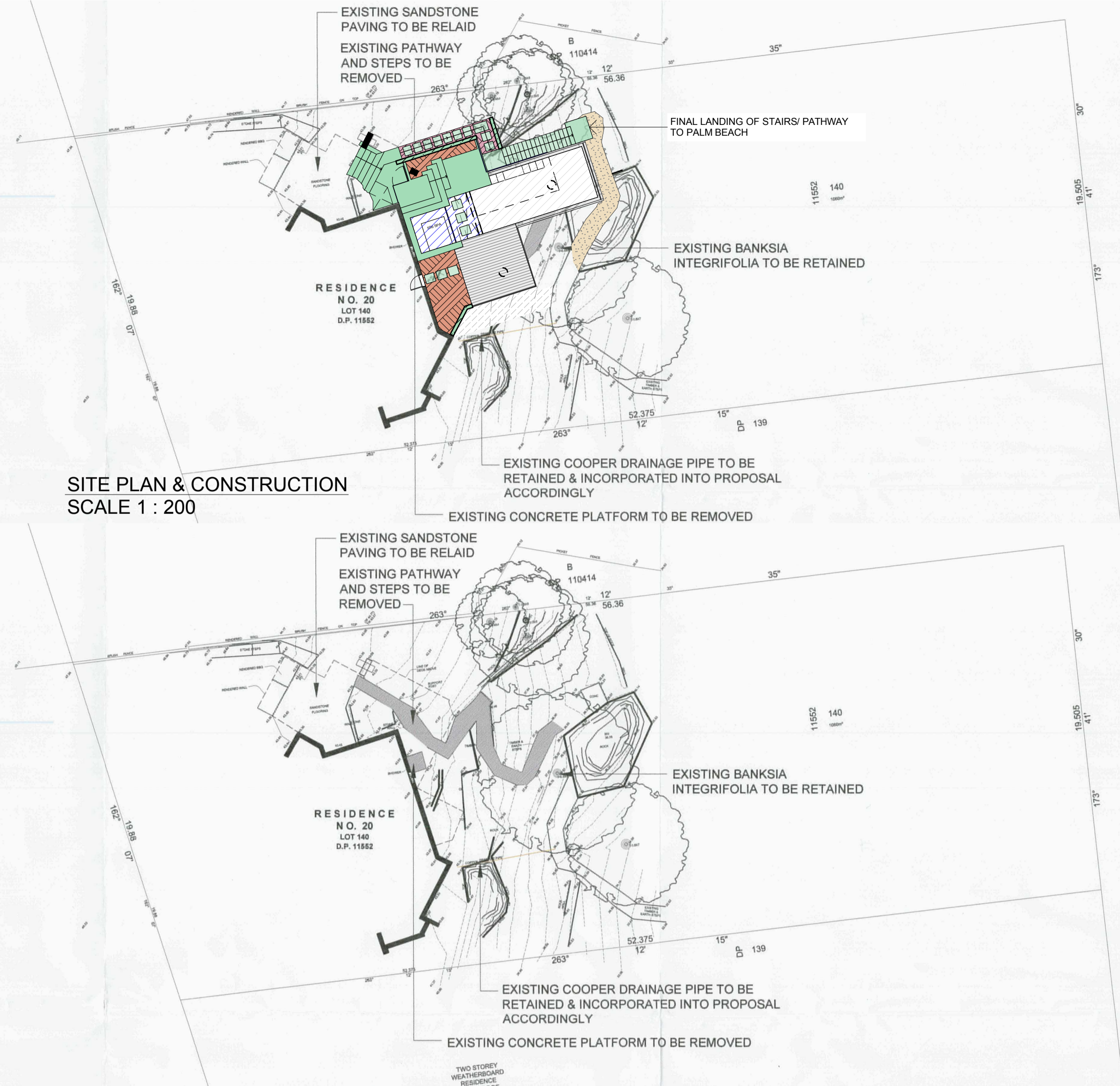

SITE PLAN & DEMOLITION SCALE 1:200

AREA CALCULATIONS
MODIFICATIONS SECTION 96, JULY 2016

	Area (M ²)	Percentage (%)
TOTAL AREA	1060 M ²	100 %
EXISTING HARD & BUILT UPON	328 M ²	30.94 %
EXISTING SOFT LANDSCAPE	732 M ²	69.06 %
PROPOSED HARD & BUILT UPON	374 M ²	35.28 %
PROPOSED SOFT LANDSCAPE	686 M ²	64.72 %

LEGEND:

	BENCHMARK R. L. 43.08
	EXISTING SPOT LEVEL/ PROPOSED SPOT LEVEL
	PROPOSED SPOT LEVEL TOP OF GLASS & TOP OF BALUSTRADE
	EXISTING TREE TO BE RETAINED
	LINE OF ROOF OVER
	LINE OF WALL UNDER
	EXISTING WALLING TO BE RETAINED (TW=TOP OF WALL)
	PROPOSED MASONRY WALLING (TW=TOP OF WALL)
	SPLATTER RENDERED + PAINT 200 BLOCK WALL (TOW = TOP OF WALL)
	PROPOSED RANDOM SANDSTONE PAVED AREA
	TIMBER DECKING ON STEEL SUPPORT FRAME
	GARDEN AREA
	MULCHED PATHWAY
	POOL FENCING
	PROPOSED SAFETY BALUSTRADE (NOM. 1000MM HIGH)
	WATER
	REMOVED PARTS OF DA
	EXTENT OF PROPOSED WORKS (FOREGROUND)
	EXTENT OF PROPOSED WORKS (BACKGROUND)
	NEW ACCESS PATHWAY TO PALM BEACH
	GREYSCALE = NO CHANGES FROM APPROVED APPLICATION AUG 2015.S96 NO282/14/595/1

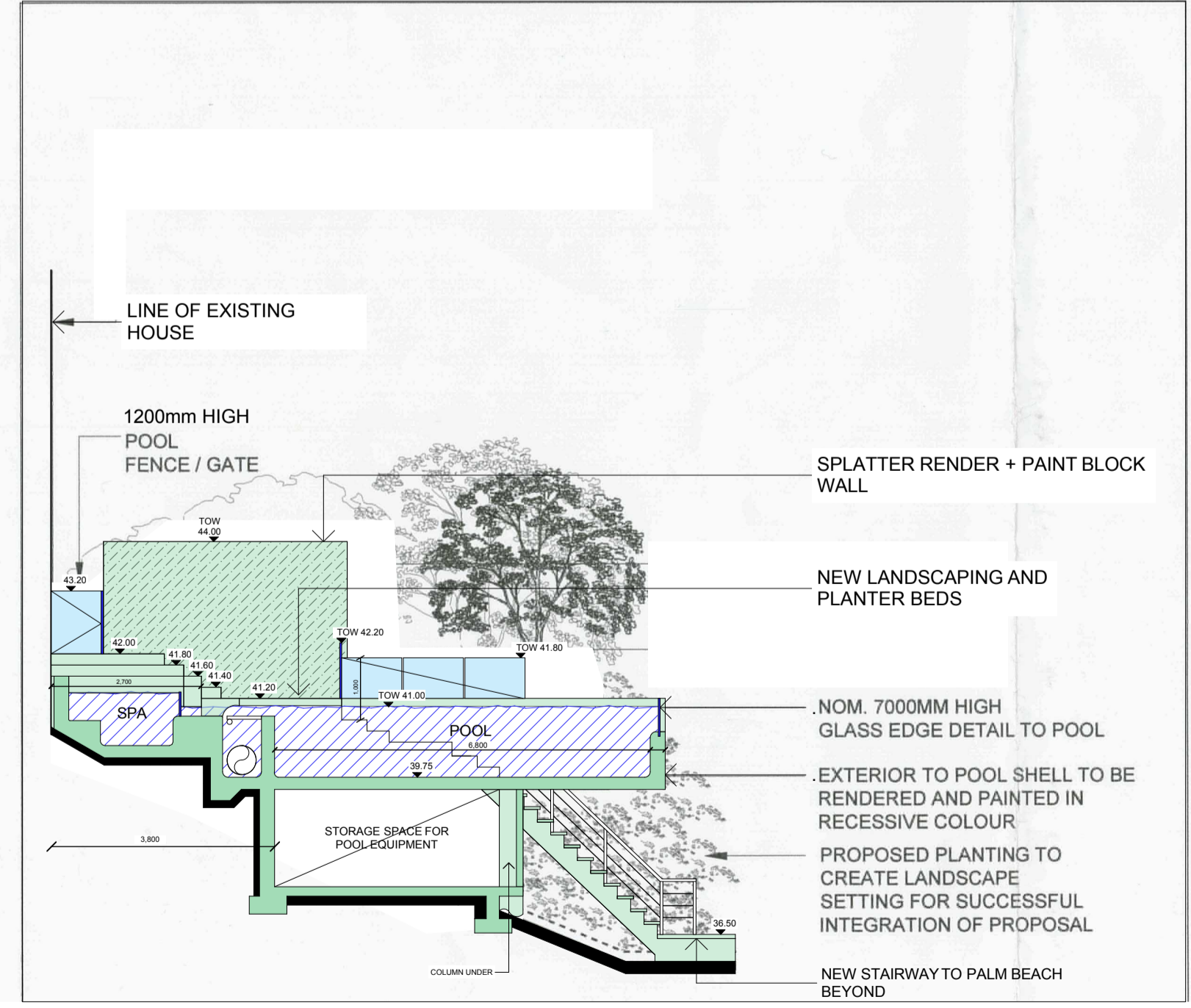

SECTION A-A SCALE 1 : 100
(DIAGRAMATIC ONLY)

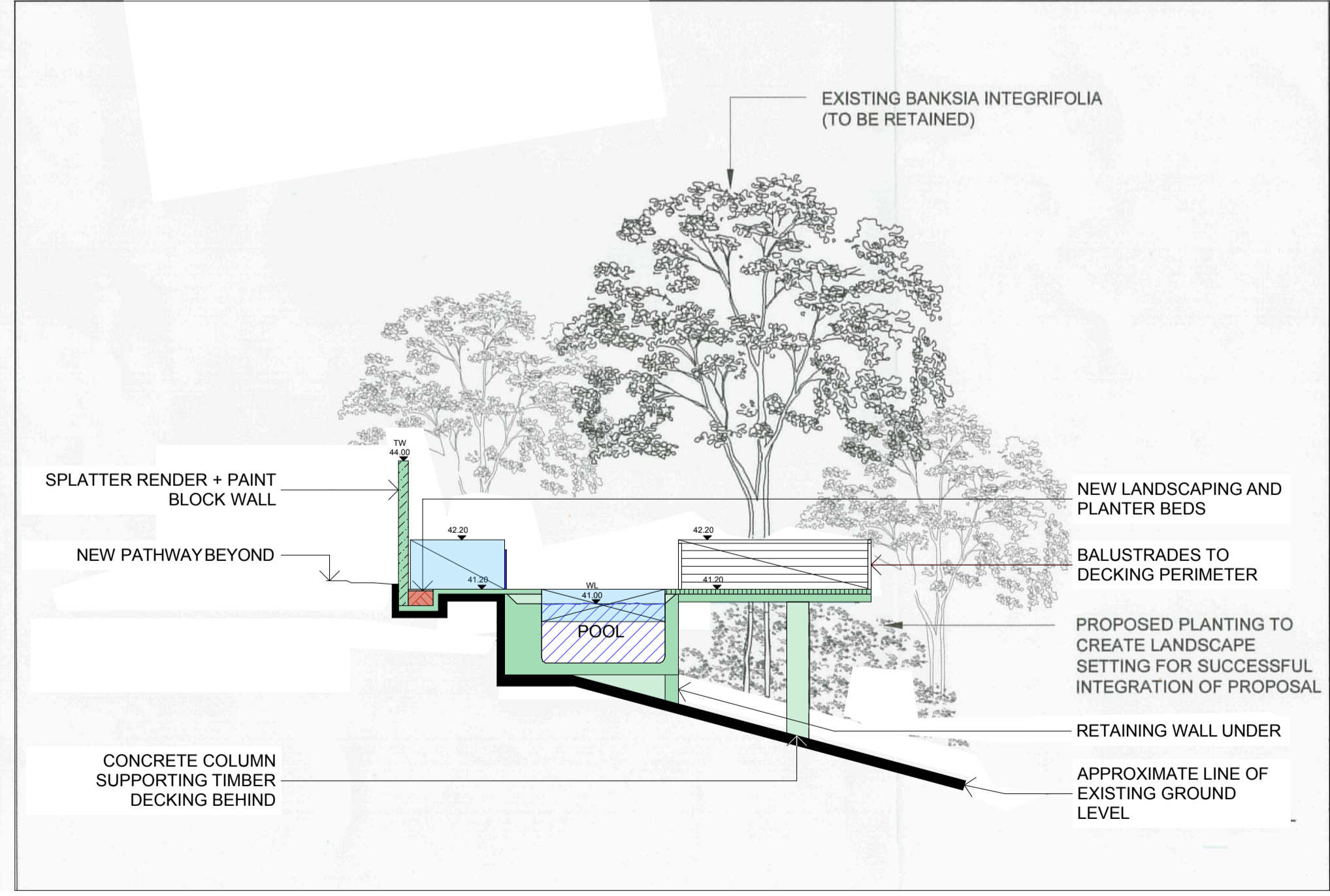

SECTION B-B SCALE 1 : 100
(DIAGRAMATIC ONLY)

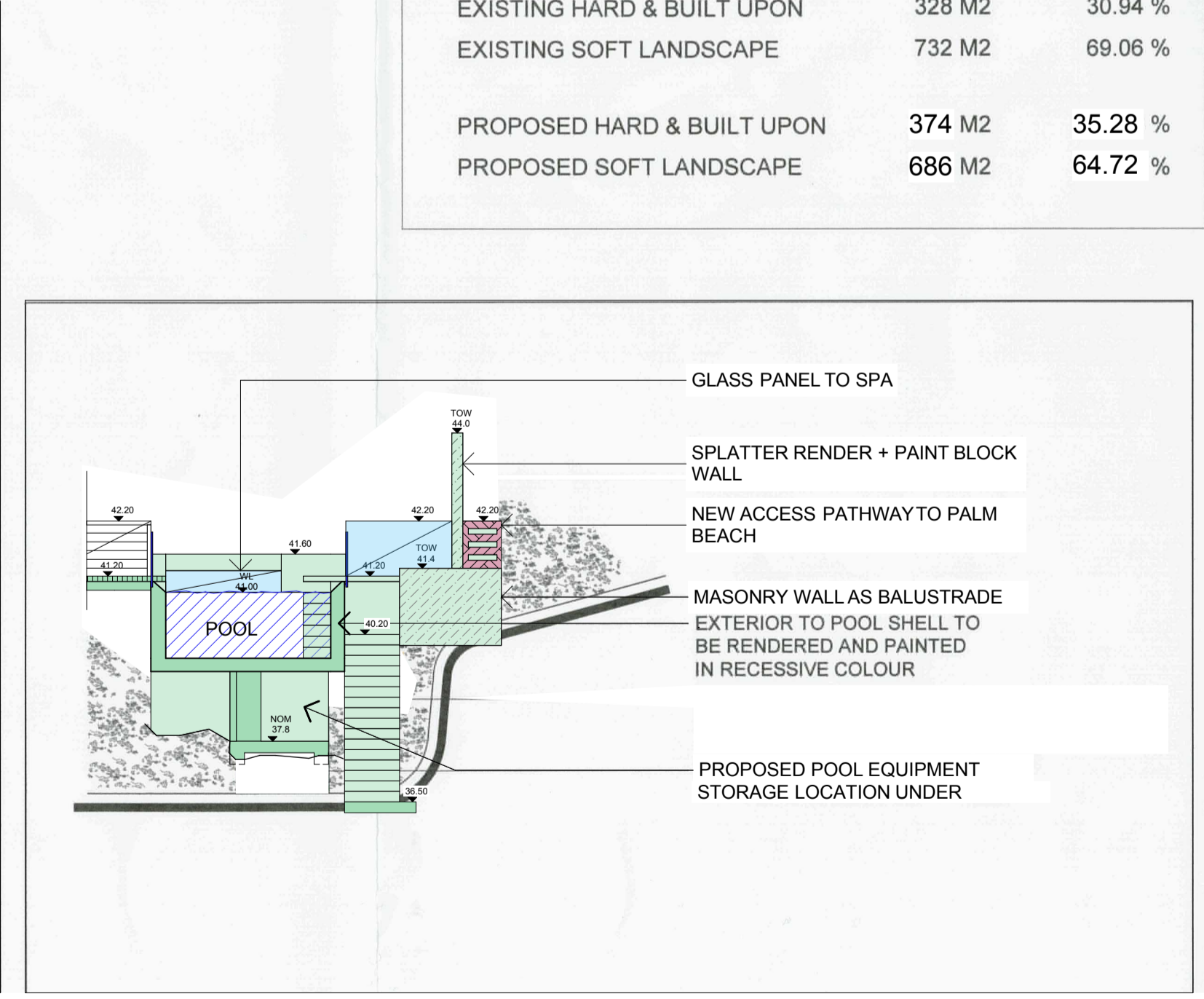

SECTION C-C SCALE 1 : 100
(DIAGRAMATIC ONLY)

REV	DESCRIPTION OF CHANGE	DRAWN	CHECK	DATE	REV	DESCRIPTION OF CHANGE	DRAWN	CHECK	DATE
A	CONSTRUCTION DOCUMENTATION SET	KK	JD	15/07/16					
B	FL AND MATERIAL AMENDMENTS	KK	JD	26/08/16					
C	SCHEDULE OF CHANGES UPDATED	KK	JD	21/09/16					
D	FURTHER DIMENSIONS REQUESTED	KK	JD	07/10/16					

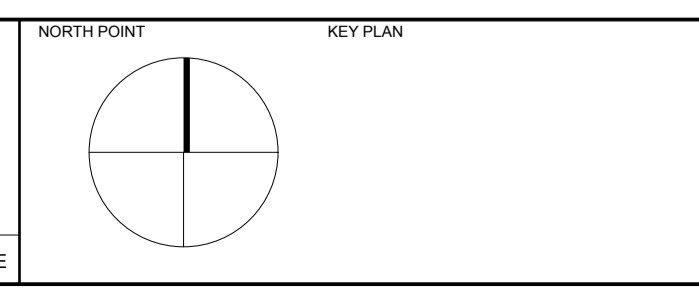

CLIENT	ARCHITECTS	PROJECT	DRAWING TITLE:
MR JOHN AND MRS JENNIFER DAUBNEY	RICE DAUBNEY	POOL AND SPA CONSTRUCTION DOCUMENTATION	MASTERPLAN

CLIENT	ARCHITECTS	PROJECT	DRAWING TITLE:
20 Sunrise Road, Palm Beach, NSW, 2108	RICE DAUBNEY	POOL AND SPA CONSTRUCTION DOCUMENTATION	MASTERPLAN

CLIENT	ARCHITECTS	PROJECT	DRAWING TITLE:
20 Sunrise Road, Palm Beach, NSW, 2108	RICE DAUBNEY	POOL AND SPA CONSTRUCTION DOCUMENTATION	MASTERPLAN

CLIENT	ARCHITECTS	PROJECT	DRAWING TITLE:
20 Sunrise Road, Palm Beach, NSW, 2108	RICE DAUBNEY	POOL AND SPA CONSTRUCTION DOCUMENTATION	MASTERPLAN

CLIENT	ARCHITECTS	PROJECT	DRAWING TITLE:
20 Sunrise Road, Palm Beach, NSW, 2108	RICE DAUBNEY	POOL AND SPA CONSTRUCTION DOCUMENTATION	MASTERPLAN

SCALE:	DRAWN:	CHECKED:
AS SHOWN	KK	JD
PROJECT NUMBER:	DRAWING NUMBER:	ISSUE:
N/A	S-96 05	D

THIS DOCUMENT IS THE COPYRIGHT OF THE RICE DAUBNEY GROUP (NSW) PTY. LTD. ALL INFORMATION ILLUSTRATED ON THIS DOCUMENT IS TO BE CHECKED AND VERIFIED ON SITE. IN THE EVENT OF DISCREPANCIES REFER TO ARCHITECT PRIOR TO COMMENCEMENT OF THE WORK. DO NOT SCALE DRAWINGS MANUALLY OR ELECTRONICALLY.