

# POOL & LANDSCAPE DA PLAN

13 Churchill Crescent, Allambie Heights, NSW, 2100

## Drawing List

Sheet No.	Sheet Name	Sheet Size	Rev. No.	Rev. Date	Project No.
L-01	SITE PLANS	A3	D	24/5/24	DF_2023
L-02	POOL PLAN	A3	D	24/5/24	DF_2023
L-03	LANDSCAPE AREA CALCULATION	A3	D	24/5/24	DF_2023
L-04	SEDIMENT & SOIL EROSION PLAN	A3	D	24/5/24	DF_2023
L-05	WASTE MANAGEMENT PLAN	A3	D	24/5/24	DF_2023
L-06	POOL FENCING NOTES	A3	D	24/5/24	DF_2023
L-07	SECTIONS A - B	A3	D	24/5/24	DF_2023
L-08	SECTIONS C & D	A3	D	24/5/24	DF_2023
L-09	ELEVATION E & F	A3	D	24/5/24	DF_2023
L-10	MATERIALS PALETTE & PLANTING SCHEDULE	A3	D	24/5/24	DF_2023

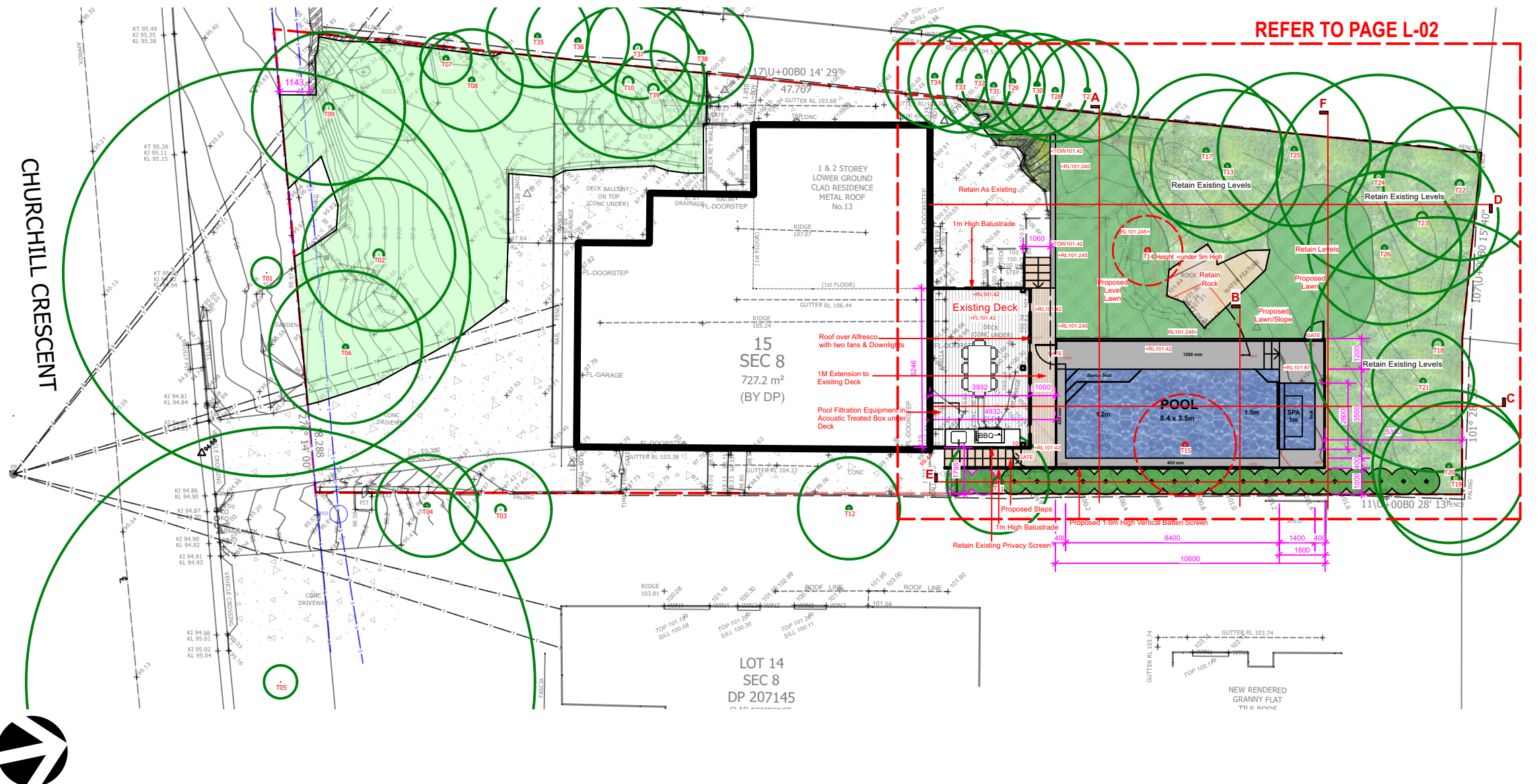

## LEGEND

- LANDSCAPE AREAS
- PROPOSED POOL
- PROPOSED POOL COPING

All building work must be carried out in compliance with the National Construction Code (NCC)

Building Work - Compliance with the Building Code of Australia  
All building work must be carried out in compliance with the provisions of the Building Code of Australia.

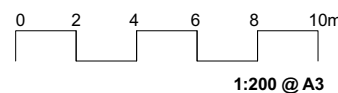

ISSUE	DATE	COMMENT
D	24/5/24	For DA Approval

**GENERAL NOTES**  
All work to be carried out in accordance with the Building Code of Australia, all Local and State Government Ordinances, relevant Australian Standards, Local Authorities Regulations and all other relevant Authorities concerned.  
All structural work and site drainage to be subject to Engineer's details or certification where required by Council. This shall include r.c. slabs and footings, r.c. and steel beams & columns, wind bracing to AS 1170 and AS4025, anchor rods or bolts, tie downs, fixings etc., driveway slabs and drainage to Council's satisfaction. All timbers to be in accordance with SAA Timber Structure Code AS1720 and SAA Timber Framing Code AS 1684. All work to be carried out in a professional and workman- shiplike manner according to the plans and specification.  
**NOTE**  
Do not scale off the drawings unless otherwise stated and use figured dimensions in preference.  
All dimensions are to be checked and verified on site before the commencement of any work, all dimensions and levels are subject to final survey and set-out. No responsibility will be accepted by Sitedesign for any variations in design, builder's method of construction or materials used, deviation from specification without permission or accepted work practices resulting in inferior construction. Locate and protect all services prior to construction.  
**COPYRIGHT CLAUSE**  
This drawing and design is the property of Sitedesign and should not be reproduced either in part or whole without the written consent of this firm.

**SITEDESIGN + STUDIOS**  
creating places to live in and enjoy

**SYDNEY NORTH STUDIO**  
PO Box 265  
SEAFORTH NSW 2092  
0417685846  
p 1300 22 44 55  
info@sdstudios.com.au  
www.sdstudios.com.au

Project	Proposed Swimming Pool	
Address	13 Churchill Crescent, Allambie Heights, NSW, 2100	
Drawing Title	SITE PLANS	
Date	26/04/24	
Scale	1:200@A3	
Drawing No.	DF_2023	

Page  
**L-01**