

LOT 30
DP 24644

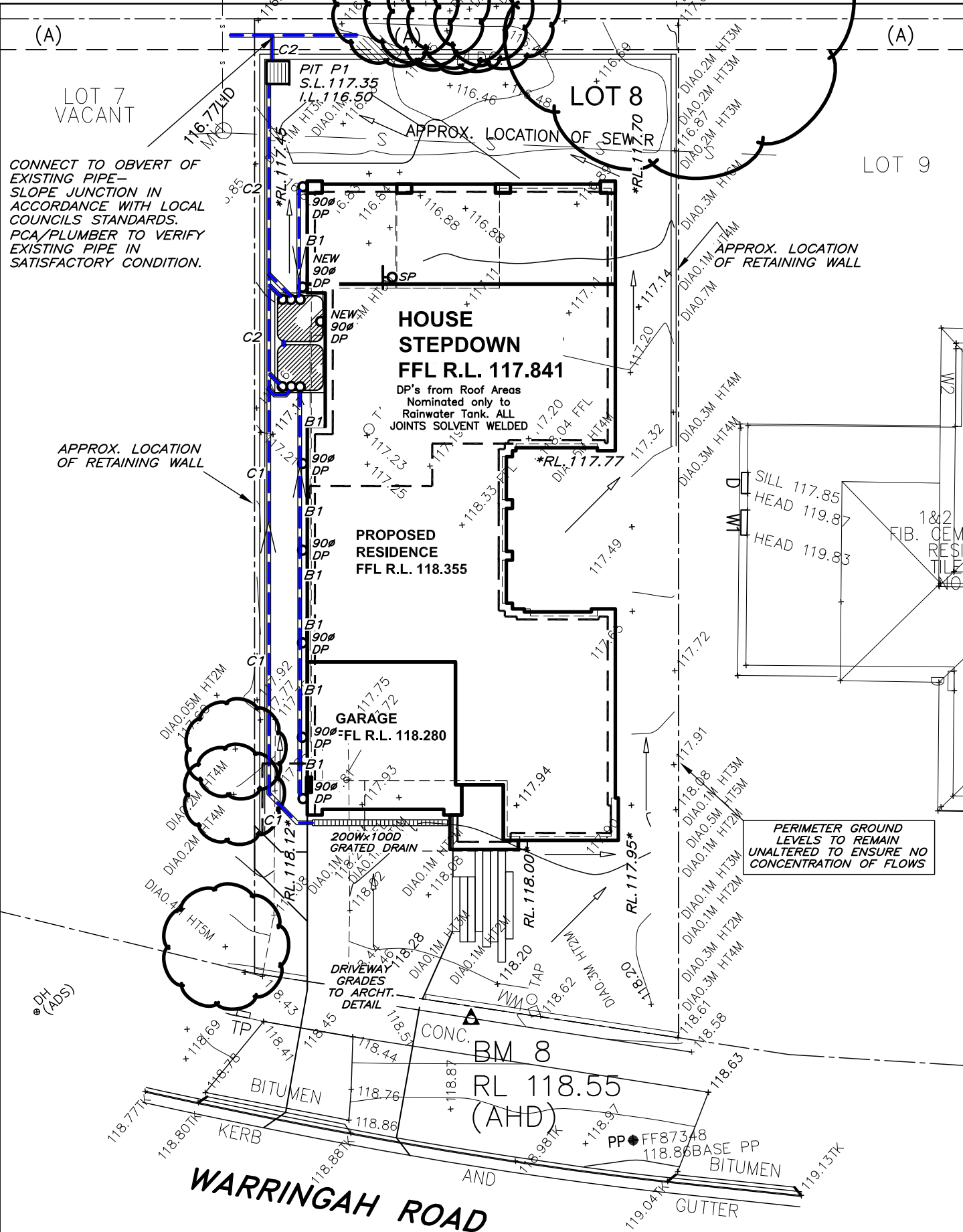

QUAD 100Dia. Overflow pipes to Pit P1. Outlet to be mosquito proofed. All exposed pipework to be painted to withstand external elements.(Location shown generic only)

Max. Overflow
RL.119.76m

ORIFICE
IL.118.60

IL.117.00

2x7110 L SQUARE TANKS
(1800W X 2020H)

6900L for Basix and EFFECTIVE 6530L for OSD
USE 2 x 7110L Dual Rainwater tank/s, to
manufacturer's and Sydney Water's specifications.

Mosquito proof strainer
or cover – regular
cleaning/maintenance
by owner essential

Internal submersible
or external pumps
to supply garden
taps and internal
re-use per Basix
assessment.
Location as per
architecturals.

Leaf Gutter Guard or
Downpipe Guard
recommended.

1000
MIN

Charged pipes
shown

INLET LEVEL
OF CHARGED
LINES TO BE
A MINIMUM OF
1400mm
BELOW ALL
CONNECTED
GUTTERS.

First flush water
diverter at tank
as req'd by
L.G.A. F/F

I.O. – Cleaning
eye to all
charged
pipelines for
maintenance of
charged system.

RAINWATER TANK

TANK DETAILS SHOWN ARE A SUGGESTED CONFIGURATION ONLY. ANY MODIFICATIONS TO TANK VOLUME OR INLET AND OUTLET LEVELS MUST BE APPROVED BY ENGINEER PRIOR TO COMMENCEMENT OF CONSTRUCTION. TANK SHAPE, & DEVICES SHOWN ARE DIAGRAMMATIC ONLY. MINIMUM OF 450 CLEARANCE (UNLESS L.G.A. REQUIRES LARGER SETBACK) TO SIDE BOUNDARIES MUST BE MAINTAINED. CLIENT IS RESPONSIBLE TO ENSURE COMPLIANCE WITH THIS IN THE INSTALLED STATE.

Charged stormwater lines from Roof Areas ONLY to rainwater tank.

All joints to be solvent welded. All exposed pipework to be painted to withstand external elements.

First flush water diverter at tank to comply with Sydney Water and council DCP's. An approved switch system similar to 'Rainbank' to be used via mains. Pumps to manuf. specs.

Rain Tank to be installed and maintained to manufacturers specifications and to comply with all Sydney Water Guidelines.

Client to be responsible for maintenance system of charged pipelines. Debris accumulation significantly affects systems performance. Maintenance program essential.

Structural details for tank base by manufacturer or others.

WHSA HAZARD IDENTIFICATION:

INSTALLATION OF RAIN TANKS: PLUMBER/SITE SUPERVISOR TO ASSESS ACCESS SUITABILITY PRIOR OR POST SLAB CONSTRUCTION. INSTALLATION OF TANKS TO BE CARRIED OUT FOLLOWING SWMS OF TANK SUPPLIER AND PLUMBER. APPROPRIATE GLOVES TO BE WORN AT ALL TIMES WHILE HANDLING TANKS.

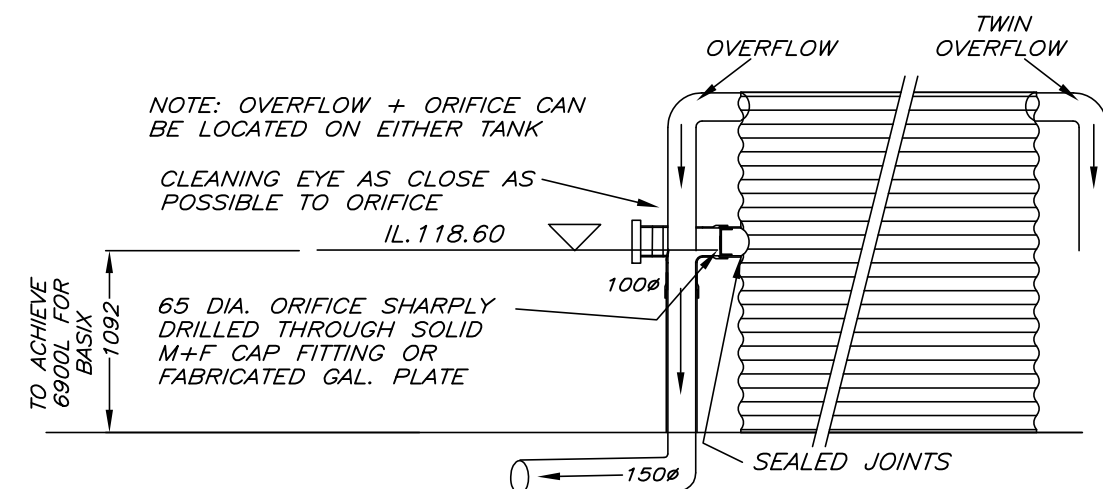

THIS IS AN
**ON-SITE STORMWATER
DETENTION SYSTEM**
REQUIRED BY YOUR LOCAL COUNCIL

IT IS AN OFFENSE TO REDUCE THE VOLUME OR TO INTERFERE WITH THE ORIFICE PLATE THAT CONTROLS THE OUTFLOW

THE BASE OF THE OUTLET CONTROL PIT AND DEBRIS SCREEN MUST BE CLEANED OF DEBRIS AND SEDIMENT ON A REGULAR BASIS BY THE OWNER.

THIS PLATE MUST NOT BE REMOVED

Signage to be provided
adjacent tanks

Size: 110 mm x 80mm

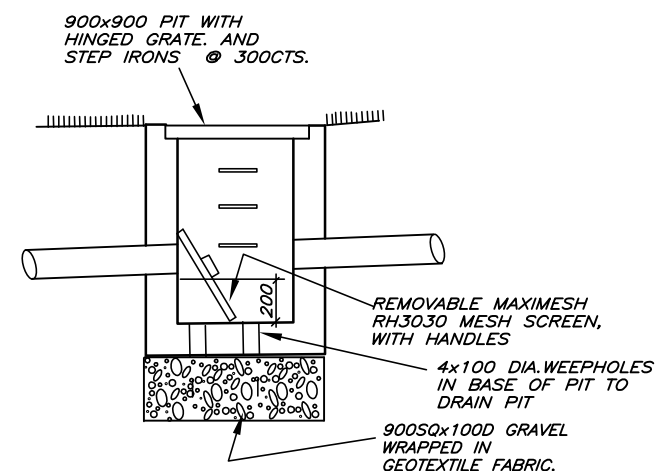

SILT ARRESTOR PIT – P1

WHSA
ALL NEARBY SERVICES TO BE LOCATED PRIOR EXCAVATIONS.
ALL PIPES TO BE CUT FLUSH WITH PIT WALLS AND SPARGED.
PITS EXCEEDING 600mm IN DEPTH TO HAVE LOCK DOWN MECHANISM.
SAFETY GEAR TO BE WORN AT ALL TIMES. INCLUDING FOOTWEAR, CLOTHING AND GLOVES AS PER SWMS.

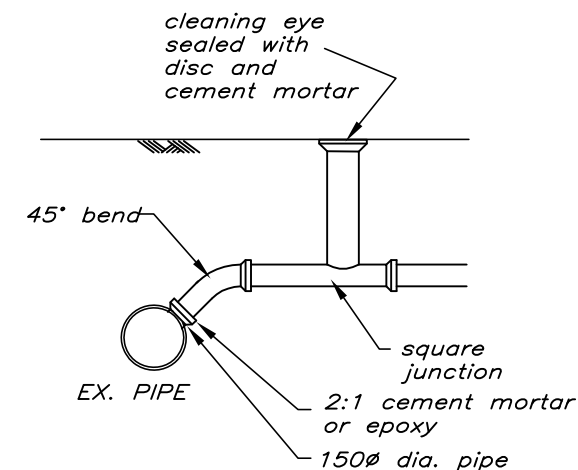

SLOPE JUNCTION CONNECTION

THIS DRAWING IS DIAGRAMMATIC ONLY & NOT TO BE SCALED. IT IS NOT A PART 4A CERT. REFER TO ARCHITECTS DRAWINGS FOR DIMENSIONS. COPYRIGHT IN THIS DRAWING IS THE PROPERTY OF IBRAHIM STORMWATER CONSULTANTS AND THE DRAWING SHALL NOT BE REPRODUCED OR COPIED, WHOLE OR IN PART, IN ANY FORM WITHOUT THE PRIOR WRITTEN APPROVAL OF IBRAHIM STORMWATER CONSULTANTS

BUILDER/CLIENT TO ENSURE THAT ALL SAFETY MEASURES ARE TAKEN DURING CONSTRUCTION, INCLUDING BUT NOT LIMITED TO, SAFETY FENCING, SIGNAGE, OBTAINING STRUCTURAL AND GEOTECHNICAL ADVICE WHERE EXCAVATIONS ARE NEAR STRUCTURES OR SERVICES, SAFETY MEASURES RECOMMENDED BY PRODUCT SUPPLIERS ETC.

REVISIONS	

ISSUE	PRINTS	ISSUED TO	DATE
1	EMAIL	BUILDER/CLIENT	14-8-19

SCALE (A3) 1:200, 100 u.n.o.
SCALE BAR – 1m INTERVALS
DATE AUG. 2019
DRAWN M.I.
DESIGNED M.I.
APPROVED



IBRAHIM STORMWATER CONSULTANTS
CONSULTING CIVIL ENGINEERS

P.O. BOX 400 CHERRYBROOK NSW 2126
TELEPHONE: (02) 9980 5515 FAX: (02) 9980 6114
www.stormwater.net.au email: mail@stormwater.net.au

PROJECT
**PROPOSED RESIDENCE
AT 600 WARRINGAH ROAD
FORESTVILLE
FOR CALRENDON HOMES**

THIS DRAWING
**STORMWATER
DETAILS SH.1**
BUILDER
CLARENDON HOMES

JOB NUMBER
C9167-00313
SHEET No.
2 of 2
REVISION