

40 Pine Street
Manly
NSW 2095

WASTE MANAGEMENT PLAN

8 December 2021

1/ CONSTRUCTION WASTE MANAGEMENT

The site is undeveloped and will therefore not require removal of demolition materials. All waste generated by construction activity will be removed daily and transported to Kimbriki Waste Facility for re-sale, recycling or landfill. If an item can be safely transported without packaging material then it must be removed for recycling by sub-contractors prior to delivery to site.

2/ ONGOING WASTE MANAGEMENT

An enclosed waste and recycling bin store is located on the south side deck. The store is clad in timber to match the house, and has a roof and walls to conceal the bins from view from the public path behind the house.

The bin store is sized to contain the standard Northern Beaches Council red general rubbish bin, a 240L yellow glass and plastic recycling bin, a 240L blue paper recycling bin and a 240L green vegetation recycling bin.

Due to the small size of the proposed house, it is not envisioned that a lot of waste, recycling or green waste would be created each week. As such it is unlikely bins would be too full or heavy.

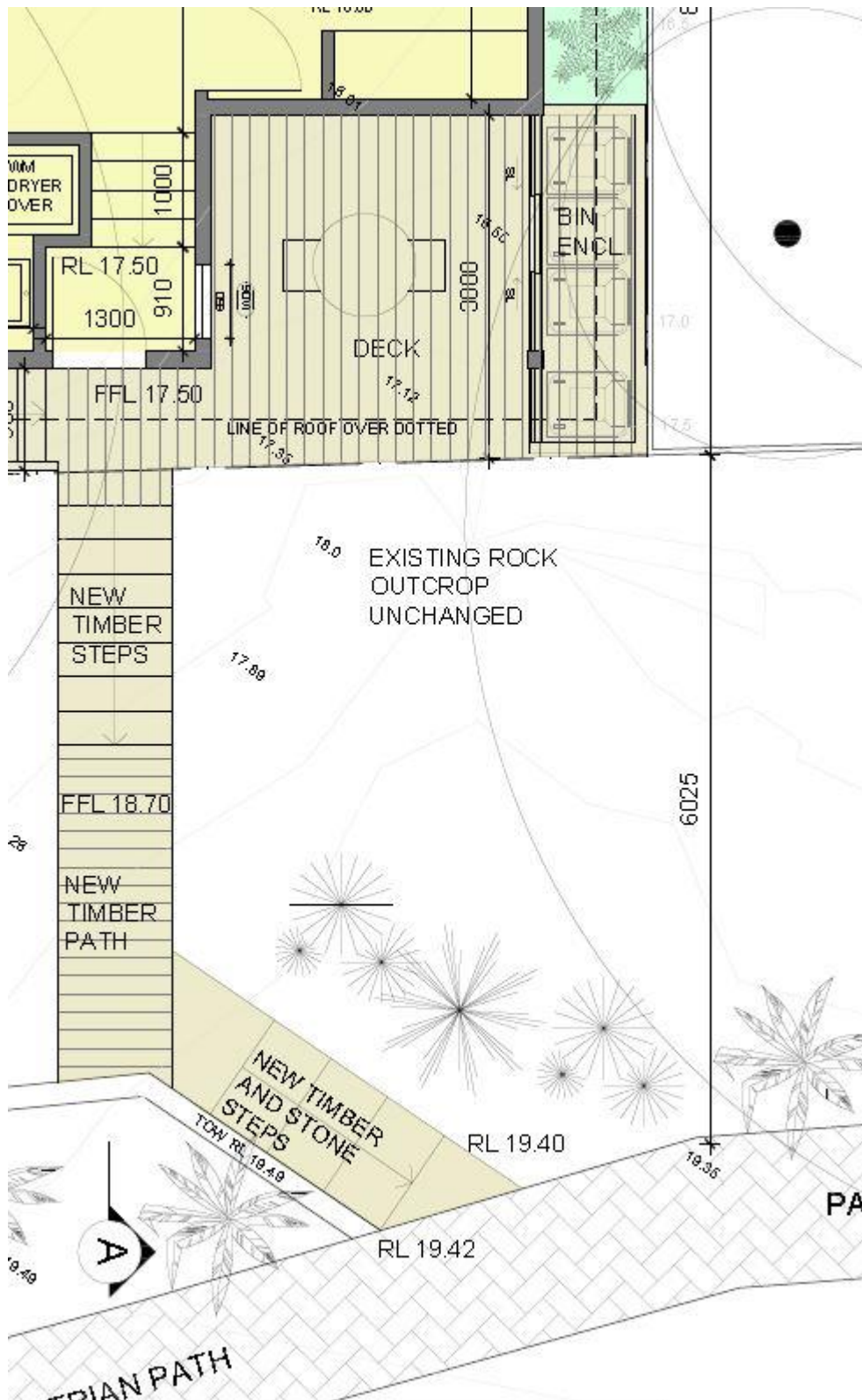

Fig 1: Enclosed bin store (4 x 240L bins) on south side deck of house

Bins would be moved by the occupant up the 8 steps from the house to the public path to the south, then up the 8 concrete steps and ramped pedestrian path to the kerb at Kangaroo St for council collection.



Fig 2: Bins moved up pedestrian path for kerb collection at Kangaroo St

If at any period the bins were heavy then a stair climbing trolley like the one below would be used.



CargoMaster C120

CE The CargoMaster C120 corresponds to the Guidelines 2006/42/EG of the European Community.

50
STEPS / MINUTE

120
KG LIFTING CAPACITY

21
KG WEIGHT

Technical data

Lifting capacity	120 kg
Steps' edge braking system	✓
Battery display	✓
Climbing speed	19 - 50 Steps / Minute
Range with one charge of the battery ⁽¹⁾	25 floors / corresponds to approx. 375 steps
Height Width Depth	1066 - 1614 mm 493 mm 293 mm
Batteries DC motor	2 x 12 V / 5 Ah 24 V
Weight battery pack	4.1 kg
Total weight	21.4 kg (depending on the handle version)

(1) at an average load of 75 kg

MATERIALS Handling *Working with ease.*

MADE IN GERMANY

Phone: 1300 25 84 07
Email: sales@materialshandling.com.au
Visit: www.materialshandling.com.au

Fig 3: Stair climbing trolley if required for heavy bins

Alternatively a bin moving contractor could be employed to move the bins from the bin store on the deck up to Kangaroo St for council collection in the same manner as the neighbouring strata titled apartment buildings utilise a contractor to move their bins onto the footpath.

A confirmation of available service and quote from My Bins contractors is shown below

Hi James,

Thanks for sending through your quote request with myBins. I have outlined a everything for you below.

Bin Placement

2 Bins weekly

Bins out Tuesdays = \$9+gst per visit

Bins in Wednesdays = \$9+gst per visit

Total weekly cost = \$18+gst per week

Total monthly cost = \$78+gst per month

If you would like to go ahead with this quote then all we would need from you are the below details please,

Bin breakdown (Red, yellow, blue, green)

Onsite contact details

Any access information like keys or garage buzzers

Location of the bins

If you do have any questions please don't hesitate to reach out.

Regards,

myBins

Katy Horvath
Office Manager | myBins

M 0450 455 581 | P 1300 692 467

E katy@mybins.com.au

U10D, 1 Campbell Parade, 2093, Manly Vale
www.mybins.com.au



The content of this email is confidential and intended for the recipient specified in message only. It is strictly forbidden to share any part of this message with any third party, without a written consent of the sender. If you received this message by mistake, please reply to this message and follow with its deletion, so that we can ensure such a mistake does not occur in the future.