

No.	TREE TYPE	DIAMETER	HEIGHT	SPREAD	No.	TREE TYPE	DIAMETER	HEIGHT	SPREAD	No.	TREE TYPE	DIAMETER	HEIGHT	SPREAD
1	PALM	2x0.40	7	5	21	FERN	0.30	10	8	41	PALM	0.30	7	4
2	PALM	2x0.40	7	5	22	TREE	0.60	16	10	42	PALM	0.30	7	4
3	PALM	0.20	4	4	23	TREE	0.50	16	6	43	PALM	0.30	6	4
4	EUCALYPT	0.70	18	15	24	MELALEUCA	0.50	13	6	44	PINE	0.40	10	8
5	TREE	0.40 MULTI	10	8	25	EUCALYPT	0.30	7	7	45	PINE	0.40	10	8
6	EUCALYPT	0.60	18	10	26	TREE	0.30	5	5	46	PINE	0.30	10	8
7	MELALEUCA	0.40	12	8	27	TREE	0.40	14	7	47	PINE	0.50	10	8
8	MELALEUCA	0.40	12	8	28	TREE	0.40	14	7	48	PINE	0.20	6	4
9	EUCALYPT	0.70	20	14	29	TREE	0.40	14	7	49	PINE	0.50	12	8
10	EUCALYPT	0.50	20	12	30	TREE	0.40	14	7	50	PALM	0.20	5	4
11	TREE	0.40	18	8	31	TREE	0.40	14	7	51	PALM	0.20	7	4
12	TREE	0.70	20	18	32	TREE	0.70	18	14	52	EUCALYPT	0.90	20	15
13	EUCALYPT	0.80	18	16	33	TREE	0.60	18	10	53	TREE	0.40	12	7
14	JACARANDA	0.30	7	7	34	JACARANDA	0.80 MULTI	12	12	54	TREE	0.50	20	10
15	TREE	0.40	12	15	35	PALM	0.30	8	4	55	PALM	0.30	9	4
16	TREE	0.30	8	8	36	PALM	0.30	8	4	56	4xPALMS	0.30	8	4
17	TREE	0.30	8	6	37	PALM	0.30	8	4	57	FERN	0.20	5	3
18	TREE	2x0.40	8	8	38	PALM	0.30	7	4	58	FERN	0.20	5	3
19	TREE	0.40	8	8	39	PALM	0.30	7	4	59	TREE	0.40 MULTI	4	6
20	FERN	0.30	10	8	40	PALM	0.30	5	4					

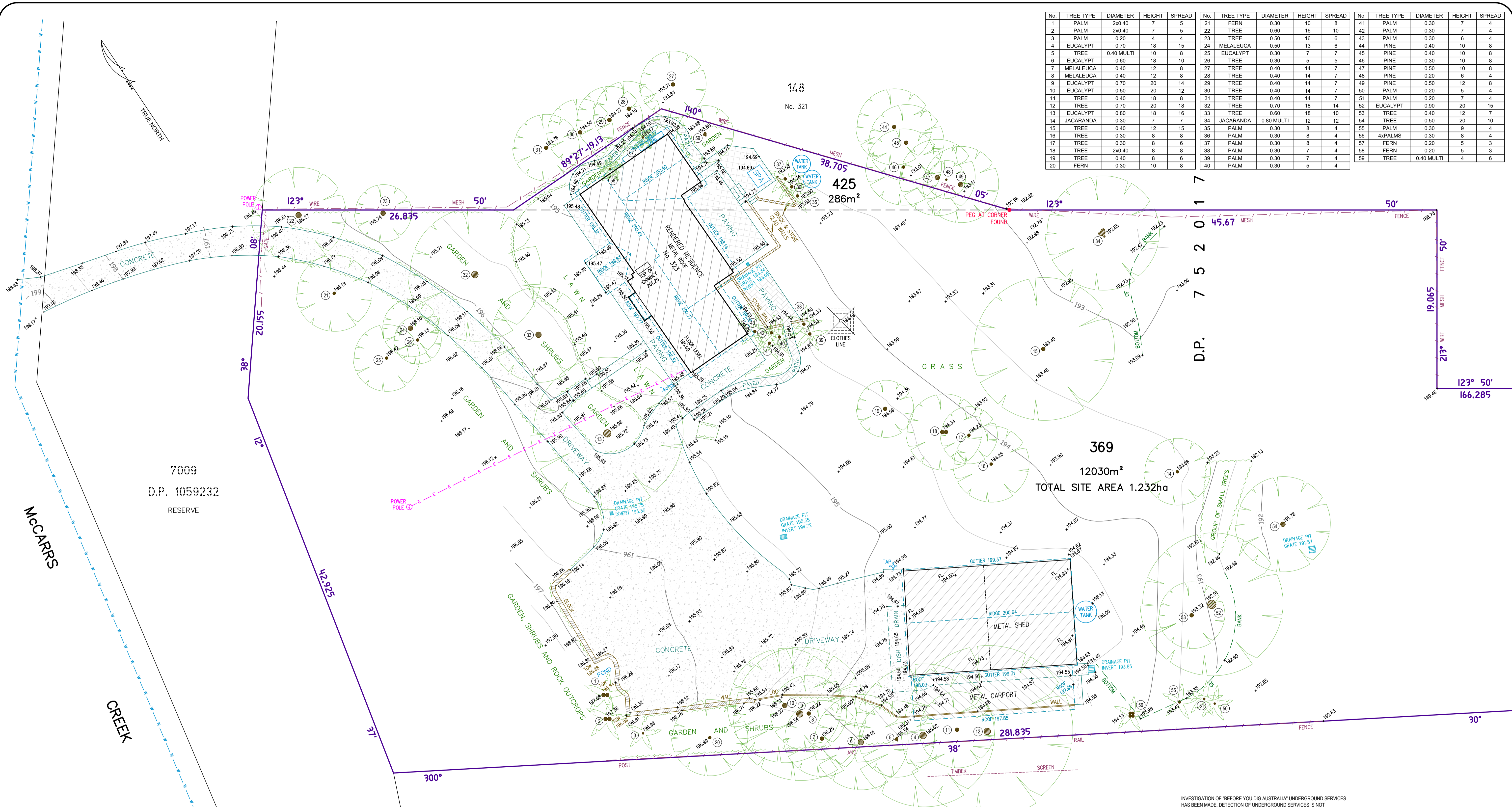

NOTES:

- 1) A BOUNDARY IDENTIFICATION HAS BEEN UNDERTAKEN.
- 2) OFFSET DIMENSIONS TO BOUNDARIES HEREON MUST NOT BE USED FOR CONSTRUCTION.
- 3) CAUTION: SHOULD ANY DEVELOPMENT OR CONSTRUCTION BE PLANNED ON OR NEAR THE BOUNDARIES, THE BOUNDARIES SHOULD BE CLEARLY MARKED ON SITE.
- 4) ORIGIN OF LEVELS ON A.H.D. IS TAKEN FROM S.S.M. 35450 RL 201.465 A.H.D.
- 5) TREE SPREADS ARE DIAGRAMMATIC ONLY AND ARE NOT SYMMETRICAL.
- 6) UNDERGROUND (NON VISIBLE) SERVICE LINES HAVE BEEN SHOWN FROM "BEFORE YOU DIG AUSTRALIA" SERVICE AUTHORITY RECORDS & ARE DIAGRAMMATIC ONLY IN REGARD TO THEIR POSITION & WIDTH UNLESS STATED OTHERWISE.
- 7) BEARINGS SHOWN ARE ON TRUE NORTH.
- 8) CONTOUR INTERVAL 0.5 METRE.
- 9) CONTOURS ARE INDICATIVE OF GROUND FORM ONLY. ONLY SPOT LEVELS SHOULD BE USED FOR CALCULATIONS OF QUANTITIES WITH CAUTION.

INVESTIGATION OF "BEFORE YOU DIG AUSTRALIA" UNDERGROUND SERVICES HAS BEEN MADE. DETECTION OF UNDERGROUND SERVICES IS NOT AN INTEGRAL PART OF THIS SURVEY. ALL RELEVANT AUTHORITIES SHOULD BE NOTIFIED PRIOR TO ANY EXCAVATION ON OR NEAR THE SITE.

DEVELOPERS & EXCAVATORS MAY BE HELD FINANCIALLY RESPONSIBLE BY THE ASSET OWNER SHOULD THEY DAMAGE UNDERGROUND NETWORKS.

CARELESS DIGGING CAN:

- CAUSE DEATH OR SERIOUS INJURY TO WORKERS AND THE GENERAL PUBLIC
- INCONVENIENCE USERS OF ELECTRICITY, GAS, WATER AND COMMUNICATIONS
- LEAD TO CRIMINAL PROSECUTION AND DAMAGES CLAIMS
- CAUSE EXPENSIVE FINANCIAL LOSSES TO BUSINESS
- CUT OFF EMERGENCY SERVICES
- DELAY PROJECT COMPLETION TIMES WHILE THE DAMAGE IS REPAIRED

MINIMISE YOUR RISK AND CHECK BEFORE YOU DIG AUSTRALIA.
WWW.BYDA.COM.AU

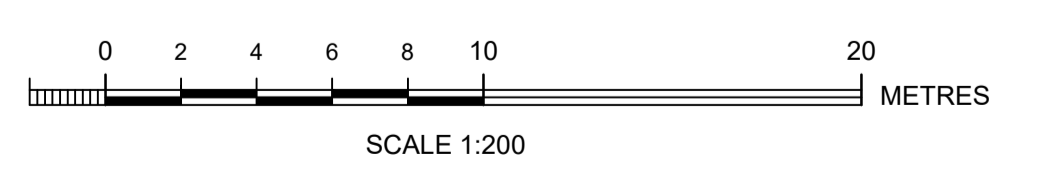

Bee & Lethbridge
Quality Surveying & Development Solutions

Bee & Lethbridge Pty Ltd
Suite 2, 14 Starkey Street,
PO Box 330, Forestville, NSW 2087
Phone: 9451 6757
Email: survey@beeeth.com.au
ABN: 13 003 194 447
www.beeeth.com.au

LEGEND

(Symbol) TREE & POINT NUMBER (SEE TABLE)

(Symbol) GUTTER TOW DENOTES TOP OF GUTTER

(Symbol) DENOTES TOP OF WALL

(Symbol) WATER LINES

Copland C. Lethbridge

COPLAND C. LETHBRIDGE
REGISTERED SURVEYOR N.S.W.
IDENTIFICATION No. SU001470

PLAN SHOWING BOUNDARIES, RELATIVE HEIGHTS & PHYSICAL FEATURES OVER PART OF LOT 369 & LOT 425 IN D.P. 752017 KNOWN AS No. 323 McCARRS CREEK ROAD, TERREY HILLS.

L.G.A.: NORTHERN BEACHES

CLIENT	SKUNSH PTY LTD	REF No.	22049
PROPERTY	No. 323 McCARRS CREEK ROAD, TERREY HILLS	SHEET No.	1 of 1
DATUM	A.H.D.	SCALE	1:200 @ A1
SURVEYED	C.L./S.S./D.B.	DATE	03/11/2023
		DWG No.	22049A
		REV No.	00