

ROAD

HILL TOP

NOTE:
THIS DETAIL SURVEY IS NOT A "LAND SURVEY" AS DEFINED BY THE SURVEYING AND SPATIAL INFORMATION ACT, 2002. IF ANY CONSTRUCTION OR DESIGN WORK, WHICH RELIES ON CRITICAL SETBACKS FROM THE STREET OR BOUNDARIES IS PLANNED, IT WOULD BE IMPERATIVE TO CARRY OUT FURTHER SURVEY WORK TO DETERMINE THE BOUNDARY DIMENSIONS.

SERVICES SHOWN ARE INDICATIVE ONLY. POSITIONS ARE BASED ON SURFACE INDICATOR(S) LOCATED DURING FIELD SURVEY. CONFIRMATION OF THE EXACT POSITION SHOULD BE MADE PRIOR TO ANY EXCAVATION WORK. OTHER SERVICES MAY EXIST WHICH ARE NOT SHOWN.

LEVELS ARE BASED ON AUSTRALIAN HEIGHT DATUM (AHD) USING SSM 38101 WITH RL 34.4 (AHD).

RIDGE & GUTTER HEIGHTS HAVE BEEN OBTAINED BY INDIRECT METHOD AND ARE ACCURATE TO ± 0.05m.

CONTOURS SHOWN DEPICT THE TOPOGRAPHY. EXCEPT AT SPOT LEVELS SHOWN THEY DO NOT REPRESENT THE EXACT LEVEL AT ANY PARTICULAR POINT. THE SPOT LEVELS ARE TRUE FOR THEIR POSITION, AND ARE INTENDED TO BE USEFUL TO REPRESENT THE GENERAL TERRAIN. CARE SHOULD BE TAKEN IF EXTRAPOLATING.

CONTOUR INTERVAL 0.25m.

J993941 RIGHT OF WAY AFFECTING THE LAND SHOWN AS VARIABLE WIDTH IN THE PLAN WITH J993941
K242827 RIGHT OF CARRIAGEWAY AFFECTING THE PART OF THE LAND WITHIN DESCRIBED SHOWN AS VARIABLE WIDTH IN THE PLAN WITH J993941
K242827 RIGHT OF CARRIAGEWAY APPURTENANT TO THE LAND ABOVE DESCRIBED AFFECTING THE LAND SHOWN AS VARIABLE WIDTH WITHIN LOTS 1 & 3 IN THE PLAN J993941

- LEGEND
- EC - EDGE OF CONCRETE
 - DS - DOOR STEP
 - WT - TOP OF WINDOW
 - WB - BOTTOM OF WINDOW
 - TG - TOP OF GUTTER
 - RR - ROOF RIDGE
 - FL - FLOOR LEVEL
 - WM - WATER METER
 - SV - STOP VALVE
 - SIP - SEWER INSPECTION PIT
 - PP - POWER POLE
 - BM - BENCHMARK
 - Ø.4/S10/H16 - DIAMETER/SPREAD/HEIGHT

BENCH MARK	▲
TELSTRA PIT	TEL
ELECTRIC LIGHT POLE	LP
POWER POLE	PP
SIGN POST	SP
SEWER INSPECTION PIT	SIP
SEWER VENT	SEWER
MANHOLE	MH
SEWER MANHOLE	SMH
STOP VALVE	SV
WATER HYDRANT	HYD
WATER METER	WM
GAS METER	G
STATE SURVEY MARK	SSM

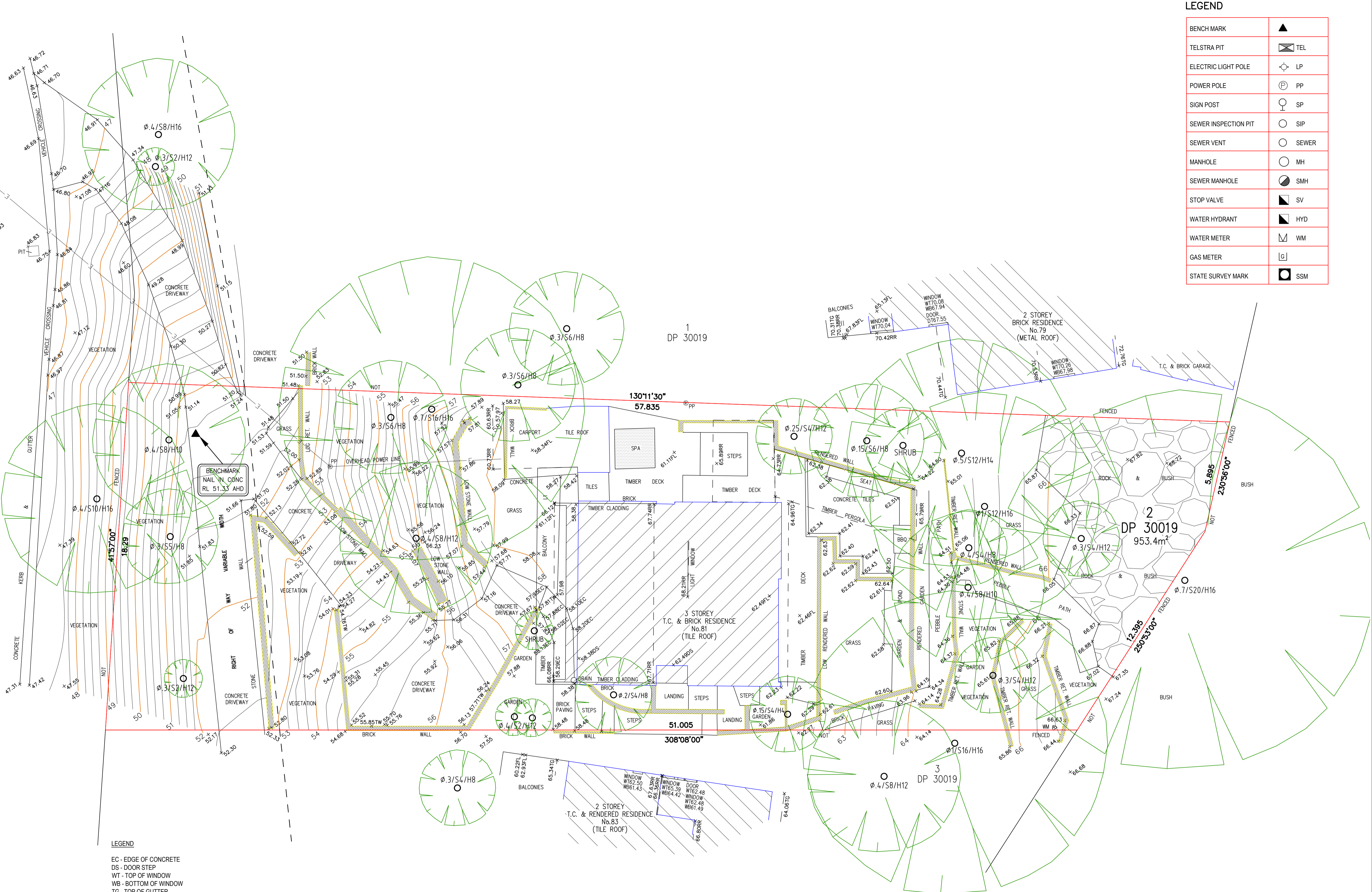

TOTAL SURVEYING SOLUTIONS

SUITE 5 / 21 ELIZABETH STREET, CAMDEN NSW 2570
Ph. (02) 4655 4035 Fax. (02) 46 55 7094 Email: tss@totalsurveying.com.au

NOTE:
INFORMATION CONTAINED IN THIS PLAN IS THE COPYRIGHT OF TOTAL SURVEYING SOLUTIONS. THE USE OR DUPLICATION WITHOUT THE WRITTEN CONSENT OF TOTAL SURVEYING SOLUTIONS CONSTITUTES AN INFRINGEMENT OF COPYRIGHT.

DRAWING: PLAN SHOWING DETAIL & LEVELS OVER LOT 2 IN DP30019

CLIENT: J.D. EVANS & COMPANY PTY LTD

PROJECT: AVALON BEACH

ADDRESS: 81 HILLTOP ROAD, AVALON

JOB No.: 160784

PLAN No.: 160784_B

DATE: 01.07.16

DRAWN: DF

CHK: GS

LGA: NORTHERN BEACHES

DATUM: AHD

SCALE: 1:100@A1

CONT. INTERVAL: 0.25m

SHEET 1 OF 1

REVISION No.

REVISION DATE:

COMMENT:

TREE REMOVED FROM SURVEY.

