

ADAM CLERKE SURVEYORS PTY LTD

Incorporating **PAUL KEEN & COMPANY**

LAND & ENGINEERING SURVEYORS

A.Clerke BSurv (Hons) USQ. Reg'd Surv.M.I.S.Aust.

P.O.BOX 175,
NEWPORT 2106.

TEL: 9918 4111

Mob: 0414400088

EMAIL: adam@adamclerkesurvey.com.au

ABN 24 126 037 045

DATE: 18th May 2020

REF: 4502N

SURVEY REPORT

Brooke Stuart
c/o gvArchitecture
Suite 315,
30-40 Harcourt Parade,
Rosebery. NSW. 2018.

Ref: No.190 Barrenjoey Road, Newport.

In accordance with your instructions we have made a survey of part of the land comprised in Computer Folios 1/1203970, being Lot 1 in Deposited Plan 1203970, situated at Newport, in the Local Government Area of Northern Beaches, Parish of Narrabeen, County of Cumberland and report as follows:-

The land has a frontage of 18.04 metres to Barrenjoey Road and the dimensions of the boundaries are shown on the accompanying sketch.

Our survey was limited to locating the visible location and reduced heights of the two and three storeys rendered and weatherboard house with metal roof, as shown on the attached sketch.

The land is subject to reservations and conditions contained in the crown grant(s).

This survey has been carried out for building location purposes only and survey marks should be placed if structures are to be erected on or near the boundaries. Boundaries are not to be established from information shown on sketch.



Adam Clerke.

ADAM CLERKE SURVEYORS PTY LTD

Incorporating PAUL KEEN & COMPANY
LAND & ENGINEERING SURVEYORS
 Adam Clerke BSURV (Hons) USQ (REG'D SURV. M.I.S.AUST.)

P.O.BOX 175
 NEWPORT 2106.

TEL: 9918-4111
 MOB: 0414400088
 E-MAIL: adam@adamclerkesurvey.com.au

SURVEY REPORT

DATE: 18th May 20
 REF: 4502N

THIS IS THE SKETCH REFERRED TO IN
 AND TO ACCOMPANY OUR REPORT OF
 EVEN DATE OVER PROPERTY KNOWN AS
 No.190 BARRENJOEY ROAD, NEWPORT.

A Clerke
 Adam Clerke

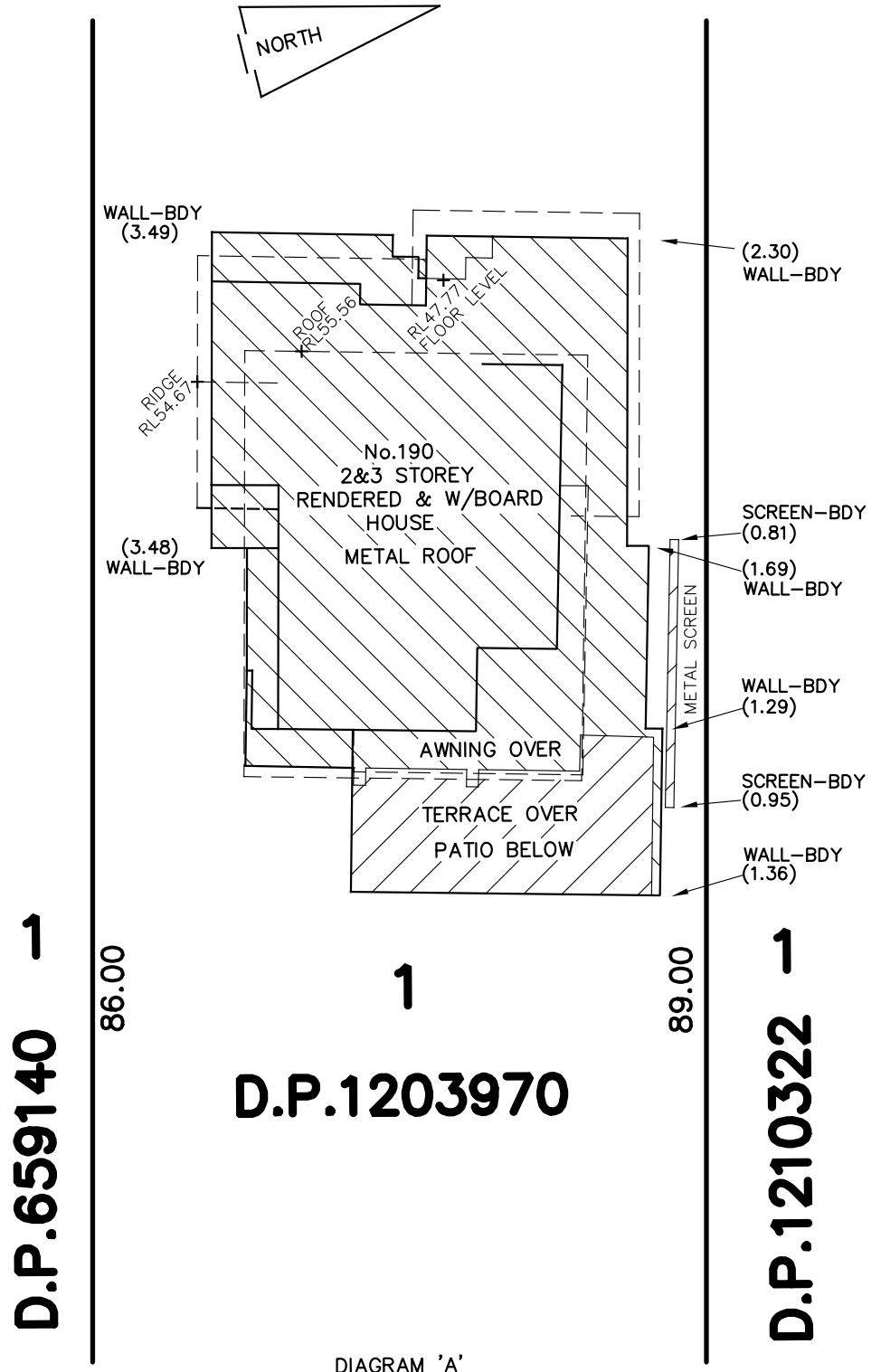
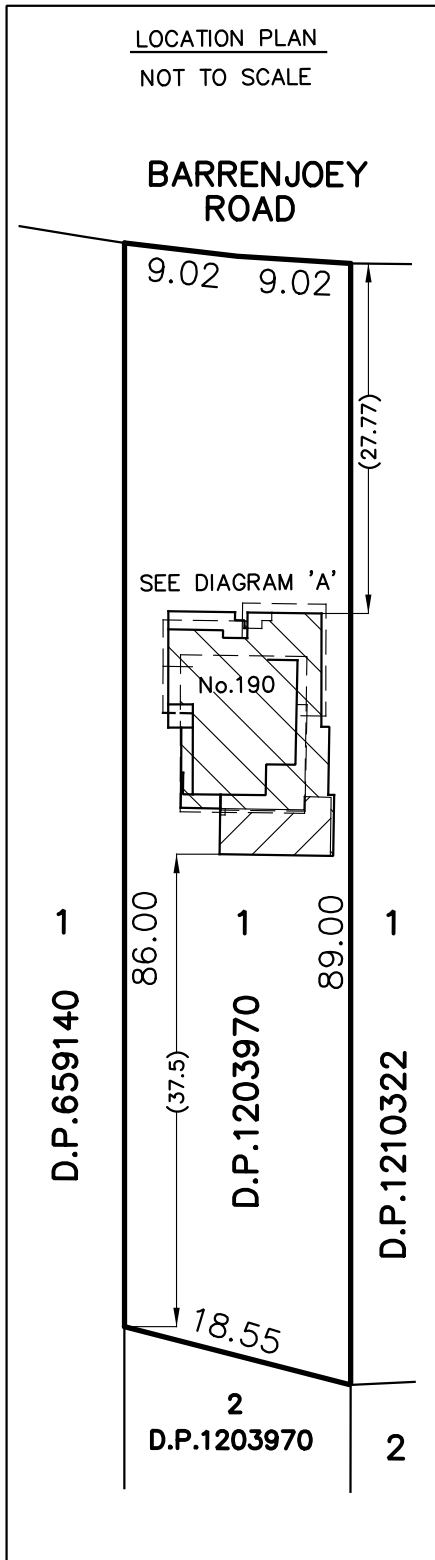

DIAGRAM 'A'