

1 Updated Clause 4.6 variation request – Height of Buildings

Proposed dwelling house

20 Beatty Street, Balgowlah Heights

1.1 Introduction

This updated clause 4.6 variation request has been prepared having regard to Revision D plans prepared by BJB Architects.

This clause 4.6 variation has been prepared with respect to a proposed new dwelling at 55 Bower Street, Manly, having regard to the Land and Environment Court judgements in the matters of *Wehbe v Pittwater Council* [2007] NSWLEC 827 (*Wehbe*) at [42] – [48], *Four2Five Pty Ltd v Ashfield Council* [2015] NSWCA 248, *Initial Action Pty Ltd v Woollahra Municipal Council* [2018] NSWLEC 118, *Baron Corporation Pty Limited v Council of the City of Sydney* [2019] NSWLEC 61, and *RebelMH Neutral Bay Pty Limited v North Sydney Council* [2019] NSWCA 130.

1.2 Manly Local Environmental Plan 2013 (MLEP 2013)

1.2.1 Clause 4.3 – Height of Buildings

Pursuant to Clause 4.3 of MLEP 2013, the height of buildings on the subject land is not to exceed 8.5m. The objectives of this control are as follows:

- (a) *to provide for building heights and roof forms that are consistent with the topographic landscape, prevailing building height and desired future streetscape character in the locality,*
- (b) *to control the bulk and scale of buildings,*
- (c) *to minimise disruption to the following:*
 - (i) *views to nearby residential development from public spaces (including the harbour and foreshores),*
 - (ii) *views from nearby residential development to public spaces (including the harbour and foreshores),*
 - (iii) *views between public spaces (including the harbour and foreshores),*
- (d) *to provide solar access to public and private open spaces and maintain adequate sunlight access to private open spaces and to habitable rooms of adjacent dwellings,*
- (e) *to ensure the height and bulk of any proposed building or structure in a recreation or environmental protection zone has regard to existing vegetation and topography and any other aspect that might conflict with bushland and surrounding land uses.*

Building height is defined as follows:

building height (or **height of building**) means the vertical distance between ground level (existing) and the highest point of the building, including plant and lift overruns, but excluding communication devices, antennae, satellite dishes, masts, flagpoles, chimneys, flues and the like

Ground level existing is defined as follows:

ground level (existing) means the existing level of a site at any point.

We note that Council has adopted the interpretation of ground level (existing) as that established in the matter of *Merman Investments Pty Ltd v Woollahra Municipal Council* [2021] NSWLEC 1582 where at paragraphs 73 and 74 O'Neill C found:

73. *The existing level of the site at a point beneath the existing building is the level of the land at that point. I agree with Mr McIntyre that the ground level (existing) within the footprint of the existing building is the extant excavated ground level on the site and the proposal exceeds the height of buildings development standard in those locations where the vertical distance, measured from the excavated ground level within the footprint of the existing building, to the highest point of the proposal directly above, is greater than 10.5m. The maximum exceedance is 2.01m at the north-eastern corner of the Level 3 balcony awning.*

74. *The prior excavation of the site within the footprint of the existing building, which distorts the height of buildings development standard plane overlaid above the site when compared to the topography of the hill, can properly be described as an environmental planning ground within the meaning of cl 4.6(3)(b) of LEP 2014.*

Whilst the vast majority of the proposed development is maintained at or below the 8.5m height plane, an area at the north-eastern end of the building protrudes above the height plane, with a maximum building height of 9.737m. The non-compliance is limited to an area located above an area of historical excavation. The non-compliance is representative of a maximum 1.237m or 14.5% variation of the 8.5m building height prescribed. The extent of non-compliance is demonstrated in the following images.

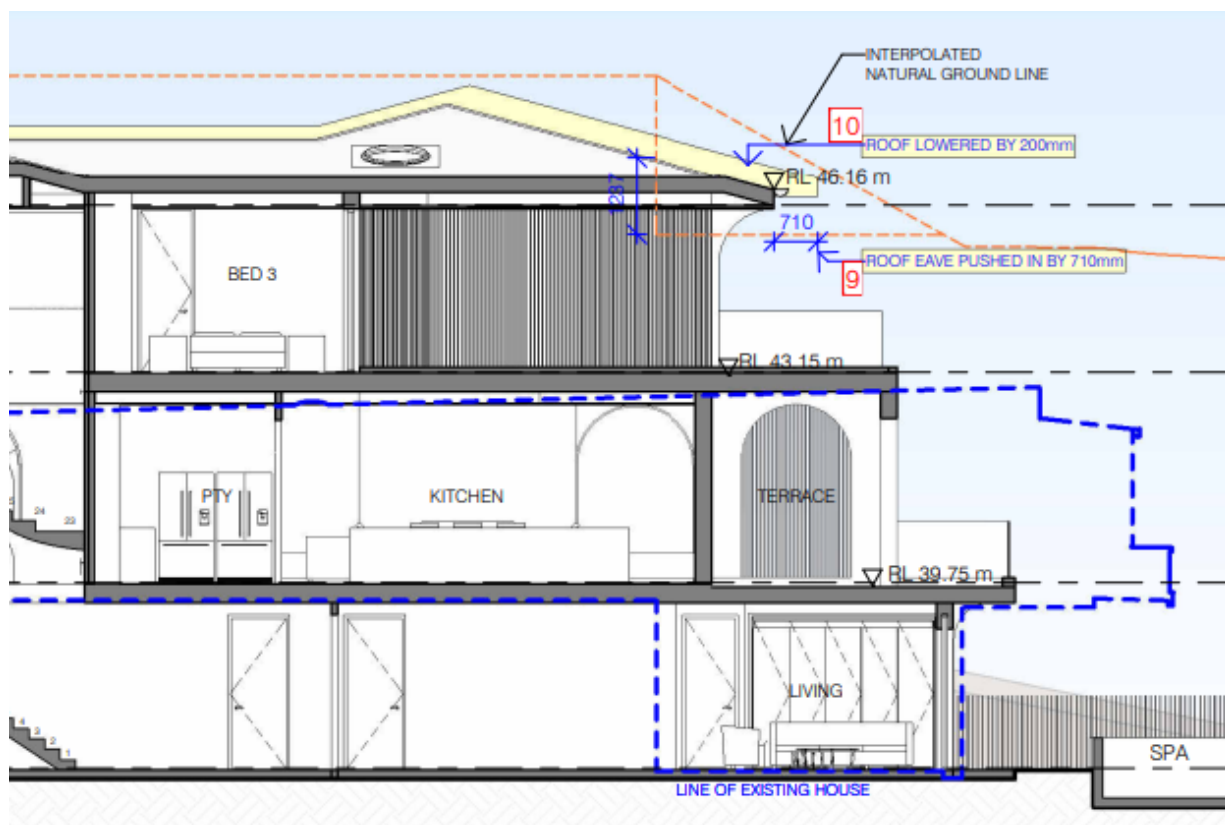

Figure 1 Plan extract showing building height breach in section

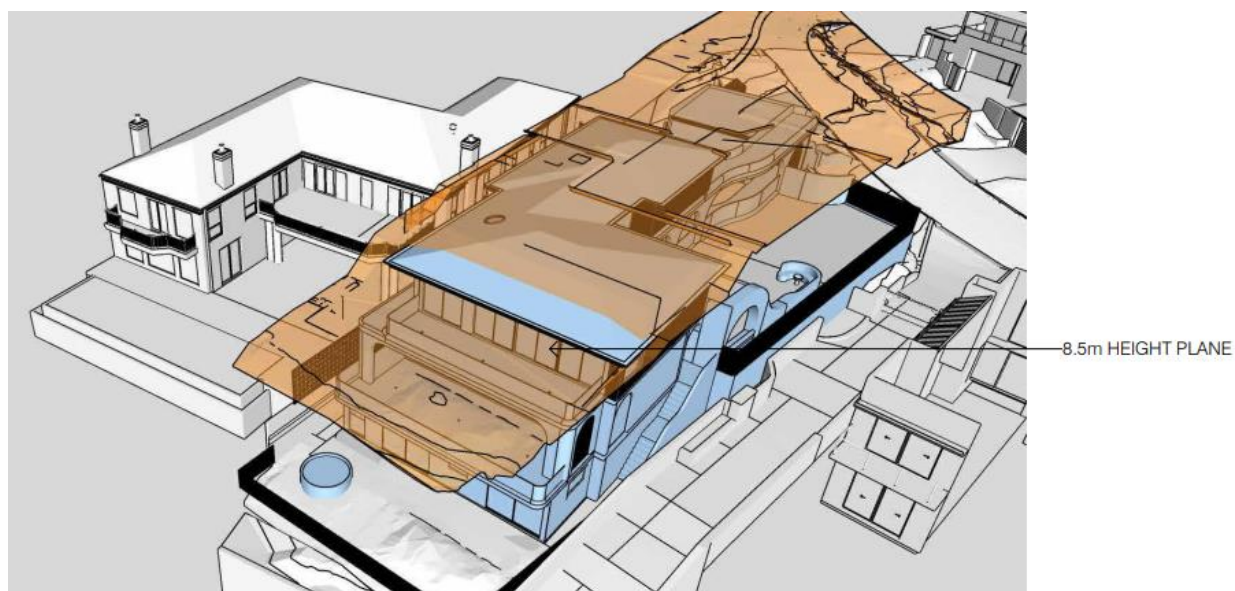

Figure 2 Height blanket diagram (ground level existing)

1.2.2 Clause 4.6 – Exceptions to Development Standards

Clause 4.6(1) of MLEP 2013 provides:

The objectives of this clause are:

- (a) *to provide an appropriate degree of flexibility in applying certain development standards to particular development, and*
- (b) *to achieve better outcomes for and from development by allowing flexibility in particular circumstances.*

The decision of Chief Justice Preston in *Initial Action Pty Ltd v Woollahra Municipal Council* [2018] NSWLEC 118 (“*Initial Action*”) provides guidance in respect of the operation of clause 4.6 subject to the clarification by the NSW Court of Appeal in *RebelMH Neutral Bay Pty Limited v North Sydney Council* [2019] NSWCA 130 at [1], [4] & [51] where the Court confirmed that properly construed, a consent authority has to be satisfied that an applicant’s written request has in fact demonstrated the matters required to be demonstrated by clause 4.6(3).

Initial Action involved an appeal pursuant to s56A of the Land & Environment Court Act 1979 against the decision of a Commissioner. At [90] of *Initial Action* the Court held that:

“In any event, cl 4.6 does not give substantive effect to the objectives of the clause in cl 4.6(1)(a) or (b). There is no provision that requires compliance with the objectives of the clause. In particular, neither cl 4.6(3) nor (4) expressly or impliedly requires that development that contravenes a development standard “achieve better outcomes for and from development”. If objective (b) was the source of the Commissioner’s test that non-compliant development should achieve a better environmental planning outcome for the site relative to a compliant development, the Commissioner was mistaken. Clause 4.6 does not impose that test.”

The legal consequence of the decision in *Initial Action* is that clause 4.6(1) is not an operational provision and that the remaining clauses of clause 4.6 constitute the operational provisions.

Clause 4.6(2) of MLEP 2013 provides:

Development consent may, subject to this clause, be granted for development even though the development would contravene a development standard imposed by this or any other environmental planning instrument. However, this clause does not apply to a development standard that is expressly excluded from the operation of this clause.

This clause applies to the building height development standard in clause 4.3 of MLEP 2013.

Clause 4.6(3) of MLEP 2013 provides:

Development consent must not be granted for development that contravenes a development standard unless the consent authority has considered a written request from the applicant that seeks to justify the contravention of the development standard by demonstrating:

- (a) *that compliance with the development standard is unreasonable or unnecessary in the circumstances of the case, and*

- (b) *that there are sufficient environmental planning grounds to justify contravening the development standard.*

The proposed development does not comply with the building height development standard at clause 4.3 of MLEP 2013 which specifies a building height of 8.5m. However, strict compliance is considered to be unreasonable or unnecessary in the circumstances of this case and there are considered to be sufficient environmental planning grounds to justify contravening the development standard.

The relevant arguments are set out later in this written request.

1.3 Relevant Case Law

In *Initial Action* the Court summarised the legal requirements of clause 4.6 and confirmed the continuing relevance of previous case law at [13] to [29]. In particular, the Court confirmed that the five common ways of establishing that compliance with a development standard might be unreasonable and unnecessary as identified in *Wehbe v Pittwater Council* (2007) 156 LGERA 446; [2007] NSWLEC 827 continue to apply as follows:

The first and most commonly invoked way is to establish that compliance with the development standard is unreasonable or unnecessary because the objectives of the development standard are achieved notwithstanding non-compliance with the standard: Wehbe v Pittwater Council at [42] and [43].

A second way is to establish that the underlying objective or purpose is not relevant to the development with the consequence that compliance is unnecessary: Wehbe v Pittwater Council at [45].

A third way is to establish that the underlying objective or purpose would be defeated or thwarted if compliance was required with the consequence that compliance is unreasonable: Wehbe v Pittwater Council at [46].

A fourth way is to establish that the development standard has been virtually abandoned or destroyed by the Council's own decisions in granting development consents that depart from the standard and hence compliance with the standard is unnecessary and unreasonable: Wehbe v Pittwater Council at [47].

A fifth way is to establish that the zoning of the particular land on which the development is proposed to be carried out was unreasonable or inappropriate so that the development standard, which was appropriate for that zoning, was also unreasonable or unnecessary as it applied to that land and that compliance with the standard in the circumstances of the case would also be unreasonable or unnecessary: Wehbe v Pittwater Council at [48]. However, this fifth way of establishing that compliance with the development standard is unreasonable or unnecessary is limited, as explained in Wehbe v Pittwater Council at [49]-[51]. The power under cl 4.6 to dispense with compliance with the development standard is not a general planning power to determine the appropriateness of the development standard for the zoning or to effect general planning changes as an alternative to the strategic planning powers in Part 3 of the EPA Act.

These five ways are not exhaustive of the ways in which an applicant might demonstrate that compliance with a development standard is unreasonable or unnecessary; they are merely the most commonly invoked ways. An applicant does not need to establish all of the ways. It may be sufficient to establish only one way, although if more ways are applicable, an applicant can demonstrate that compliance is unreasonable or unnecessary in more than one way.

The relevant steps identified in *Initial Action* (and the case law referred to in *Initial Action*) can be summarised as follows:

1. Is clause 4.3 of MLEP 2013 a development standard?
2. Is the consent authority satisfied that this written request adequately addresses the matters required by clause 4.6(3) by demonstrating that:
 - (a) compliance is unreasonable or unnecessary; and
 - (b) there are sufficient environmental planning grounds to justify contravening the development standard.

1.4 Request for variation

1.4.1 Is clause 4.3 of MLEP 2013 a development standard?

The definition of “development standard” at clause 1.4 of the EP&A Act includes a provision of an environmental planning instrument or the regulations in relation to the carrying out of development, being provisions by or under which requirements are specified or standards are fixed in respect of any aspect of that development, including, but without limiting the generality of the foregoing, requirements or standards in respect of:

- (c) *the character, location, siting, bulk, scale, shape, size, height, density, design or external appearance of a building or work,*

Clause 4.3 of MLEP 2013 prescribes a height limit for development on the site. Accordingly, clause 4.3 of MLEP 2013 is a development standard.

1.4.2 Clause 4.6(3)(a) – Whether compliance with the development standard is unreasonable or unnecessary

The common approach for an applicant to demonstrate that compliance with a development standard is unreasonable or unnecessary are set out in *Wehbe v Pittwater Council* [2007] NSWLEC 827.

The first approach is relevant in this instance, being that compliance with the development standard is unreasonable and unnecessary because the objectives of the development standard are achieved notwithstanding non-compliance with the standard.

Consistency with objectives of the building height development standard

An assessment as to the consistency of the proposal when assessed against the objectives of the standard is as follows:

- (a) *to provide for building heights and roof forms that are consistent with the topographic landscape, prevailing building height and desired future streetscape character in the locality,*

Comment: The building height of the proposed development is consistent with that of surrounding development and development within the visual catchment of the site. The non-compliance occurs as a result of historical excavation in a minor area of the site, which is not representative of the topographic landscape of the locality. In this respect, it is noted that the proposed development is otherwise compliant with the height plane, excluding the anomaly of the ground plane created by the existing excavation.

The non-compliance with the height plane when measured to existing ground level does not detract from consistency with this objective.

- (b) *to control the bulk and scale of buildings,*

Comment: The proposed development is well articulated with a bulk and scale that is commensurate with surrounding and nearby development. The development has been designed to step down the slope of the site and is responsive to the natural topography of the site. Non-compliance with the 8.5m height plane is limited to a minor portion of the development that does not contribute to excessive bulk and scale.

Consistent with the conclusions reached by Senior Commissioner Roseth in the matter of *Project Venture Developments v Pittwater Council (2005) NSW LEC 191*, I have formed the considered opinion that most observers would not find the proposed development by virtue of its bulk and scale offensive, jarring or unsympathetic in a streetscape context nor having regard to the built form characteristics of development within the visual catchment of the site.

This objective is achieved notwithstanding the building height breaching elements proposed.

- (c) *to minimise disruption to the following:*
- (i) *views to nearby residential development from public spaces (including the harbour and foreshores),*
 - (ii) *views from nearby residential development to public spaces (including the harbour and foreshores),*
 - (iii) *views between public spaces (including the harbour and foreshores),*

Comment: Having inspected the site and its immediate surrounds to identify potential view lines across the site I am satisfied that the building height breaching elements will not result in the disruption of public or private views to the extent that a view sharing outcome is not maintained. This objective is achieved notwithstanding the building height breaching elements proposed.

- (d) *to provide solar access to public and private open spaces and maintain adequate sunlight access to private open spaces and to habitable rooms of adjacent dwellings,*

Comment: Notwithstanding the building height non-compliant element of the development compliant solar access is maintained to adjacent dwellings. This objective is achieved notwithstanding the building height breaching elements proposed.

- (e) *to ensure the height and bulk of any proposed building or structure in a recreation or environmental protection zone has regard to existing vegetation and topography and any other aspect that might conflict with bushland and surrounding land uses.*

Comment: The height of the proposed development does not result in any adverse impacts upon existing vegetation or topography. This objective is achieved notwithstanding the building height breaching elements proposed.

The non-compliant development, as it relates to building height, demonstrates consistency with objectives of the zone and the building height development standard objectives. Adopting the first option in *Wehbe*, strict compliance with the height of buildings standard has been demonstrated to be unreasonable and unnecessary in the circumstances of this application.

1.4.3 Clause 4.6(4)(b) – Are there sufficient environmental planning grounds to justify contravening the development standard?

In *Initial Action* the Court found at [23]-[25] that:

As to the second matter required by cl 4.6(3)(b), the grounds relied on by the applicant in the written request under cl 4.6 must be “environmental planning grounds” by their nature: see Four2Five Pty Ltd v Ashfield Council [2015] NSWLEC 90 at [26]. The adjectival phrase “environmental planning” is not defined, but would refer to grounds that relate to the subject matter, scope and purpose of the EPA Act, including the objects in s 1.3 of the EPA Act.

The environmental planning grounds relied on in the written request under cl 4.6 must be “sufficient”. There are two respects in which the written request needs to be “sufficient”. First, the environmental planning grounds advanced in the written request must be sufficient “to justify contravening the development standard”. The focus of cl 4.6(3)(b) is on the aspect or element of the development that contravenes the development standard, not on the development as a whole, and why that contravention is justified on environmental planning grounds.

The environmental planning grounds advanced in the written request must justify the contravention of the development standard, not simply promote the benefits of carrying out the development as a whole: see Four2Five Pty Ltd v Ashfield Council [2015] NSWCA 248 at [15]. Second, the written request must demonstrate that there are sufficient environmental planning grounds to justify contravening the development standard so as to enable the consent authority to be satisfied under cl 4.6(4)(a)(i) that the written request has adequately addressed this matter: see Four2Five Pty Ltd v Ashfield Council [2015] NSWLEC 90 at [31].

Sufficient environmental planning grounds

Ground 1 - Topography of the land

The portion of the site over which the building height breach occurs is steeply sloping with the topography contributing towards the extent of the building height breach proposed.

Ground 2 - Contextually responsive building design

Despite non-compliance with the 8.5m building height development standard, the proposed development is consistent and compatible with the height of surrounding development.

Council's acceptance of the proposed height variation will ensure the orderly and economic development of the site, in so far as it will ensure conformity with the scale and character established by other existing development within the visual catchment of the site, consistent with Objective 1.3(c) of the EP&A Act.

The proposed development has been sensitively designed to respond to both the location of the site and also the form and massing of adjoining development. The building is of high design quality with the variation facilitating a height that provides for contextual built form compatibility, consistent with Objective 1.3(g) of the Act.

Ground 3 – Existing Excavation

The proposed height breach is a direct consequence of existing excavation. As demonstrated on the Height Plane Diagram at Figure 3 on the following page, the proposed development is compliant with 8.5m height plane when measured to existing ground levels along the perimeter of the building and when the area of existing excavation is excluded.

Consistent with the findings of Commissioner O'Neill in *Merman Investments Pty Ltd v Woollahra Municipal Council* [2021] NSWLEC 1582, prior excavation within the building footprint that distorts the height of buildings development standard plane can be properly described as an environmental planning ground within the meaning of clause 4.6(3)(b) of the LEP.

Overall, there are sufficient environmental planning grounds to justify contravening the development standard.

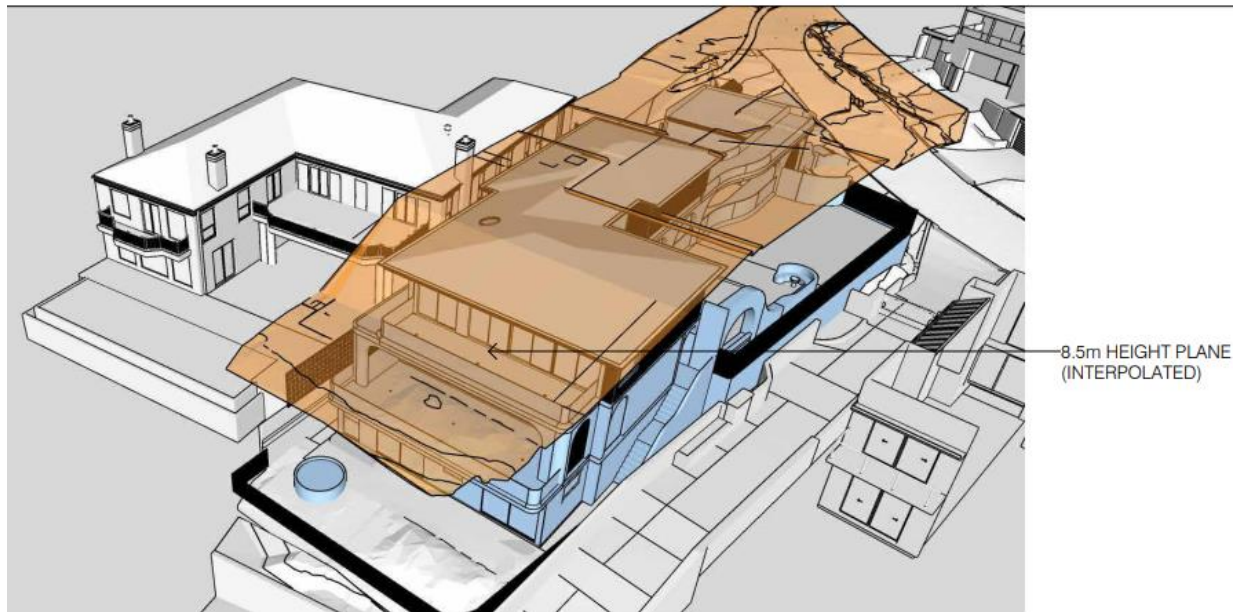

**Figure 3: Height Plane Diagram based on assumed natural ground level
(excluding existing excavation)**

1.5 Conclusion

Pursuant to clause 4.6(4)(a) of MLEP 2013, the consent authority can be satisfied that this written request has adequately addressed the matters required to be demonstrated by subclause (3) being:

- (a) *that compliance with the development standard is unreasonable or unnecessary in the circumstances of the case, and*
- (b) *that there are sufficient environmental planning grounds to justify contravening the development standard.*

As such, I have formed the highly considered opinion that there is no statutory or environmental planning impediment to the granting of a building height variation in this instance.

Boston Blyth Fleming Pty Limited

Greg Boston

B Urb & Reg Plan (UNE) MPIA

Director

26.9.24