

IMPORTANT NOTE
THIS PLAN WAS PREPARED FOR A PROPOSED SUBDIVISION TO ACCOMPANY A SUBDIVISION APPLICATION TO COUNCIL AND SHOULD NOT BE USED FOR ANY OTHER PURPOSE. THE DIMENSIONS, AREAS AND TOTAL NUMBER OF LOTS SHOWN HEREON ARE SUBJECT TO FIELD SURVEY AND ALSO TO THE REQUIREMENTS UNDER ANY RELEVANT LEGISLATION. IN PARTICULAR, NO RELIANCE SHOULD BE PLACED ON THE INFORMATION ON THIS PLAN FOR ANY FINANCIAL DEALINGS INVOLVING THE LAND. ANY UTILITY INFORMATION SHOWN HEREON SHOULD NOT BE RELIED UPON FOR ANY PURPOSE. A FULL DIAL BEFORE YOU DIG SEARCH MUST BE MADE BY CONTACTING DBYD ON PH.1100 OR WWW.1100.COM.AU.
THIS NOTE IS AN INTEGRAL PART OF THIS PLAN.

- (A) RIGHT OF CARRIAGEWAY & EASEMENT TO DRAIN WATER 4.865 WIDE (D.P.263921) (E) PROPOSED EASEMENT TO DRAIN WATER 1.2 WIDE
(B) RIGHT OF CARRIAGEWAY, EASEMENT TO DRAIN WATER & EASEMENT FOR SERVICES 5 WIDE (D.P.263921)
(C) EASEMENT OF CARRIAGEWAY, EASEMENT TO DRAIN WATER & EASEMENT FOR SERVICE 5 WIDE AND VARIABLE WIDTH (D.P.263921)
(D) EASEMENT TO DRAIN WATER 0.9 WIDE (D.P.263921)

CONTINUED BELOW

CONTINUED ABOVE

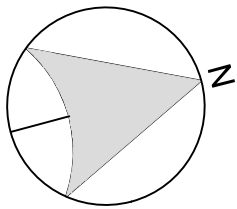

BUNGAN HEAD ROAD

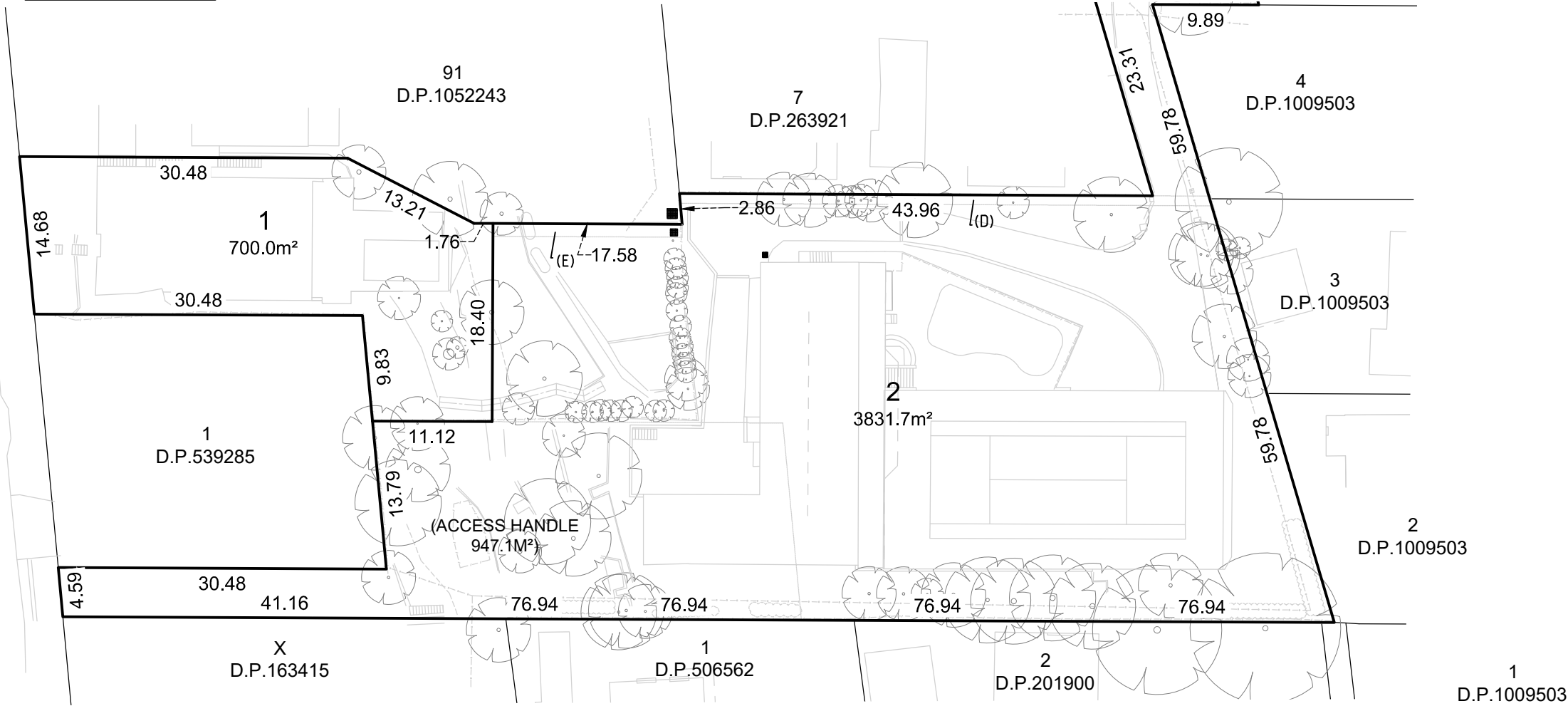

A	FIRST ISSUE	SN	18.12.19
No.	AMENDMENT DESCRIPTION	BY	DATE



Sydney
9/4 Central Avenue, Thornleigh N.S.W. 2120
Phone 02 9875 4500

Postal
PO BOX 22, Thornleigh N.S.W. 2120
mepstead@mepstead.com.au
www.mepstead.com.au

Designed: SN	Scale: VARIOUS
Drawn: SN	Datum: MGA
Checked: SN	Date: DEC 2019
L.G.A: NORTHERN BEACHES	A3

Principal: **ROYLE**
Project: **PLAN OF PROPOSED SUBDIVISION OVER LOT 1 IN DP634714 & LOT92 IN DP1052243 KNOWN AS No.7 BUSHRANGERS HILL, NEWPORT**

Drg. No. 5800_SUB1_A
Sheet No. 1 of 1 sheets
Our Ref: **5800**