

NOVEMBER 9th, 2019.

Ms Rebecca Englund
Principal Planner
Northern Beaches Council

Via email: Rebecca.Englund@northernbeaches.nsw.gov.au

Dear Ms Englund,

RE: Mod2019/0485 – 3 Riverview Road, Avalon Beach NSW 2017

I refer to my online submission emailed on 22 October in relation to Mod2019/0485. My concerns were based on the lack of any detail regarding the design for us to assess rather than a fundamental objection to the principle of the cabana.

However, I have since met with the proponent of the DA and our discussions translated into further design development of the cabana and our boundary interface. I confirm that I am now satisfied that the design is acceptable to me and attach the drawings provided to me to this correspondence.

The proponent has advised that Smart Design Studio will now formally lodge these additional plans with you in response to my submission and I only ask that you please check that they are consistent.

Thank you for the opportunity to participate in this process.

Yours faithfully,



Jill Johnson

LINE OF 1.8M BOUNDARY FENCE

TALL TREE PLANTINGS BEHIND
1.8M BOUNDARY FENCE

'STAR JASMINE' CLIMBERS TO BACK OF ART WALL
& TEMPORARY LATTICE SCREEN UNTIL LANDSCAPE
PLANTINGS MATURES

TIMBER CLAD POOL CABANA WITH GLASS ROOF

GLAZED POOL FENCING & BALUSTRADING
1.2M ABOVE POOL TERRACE

RL 15.16

ART WALL

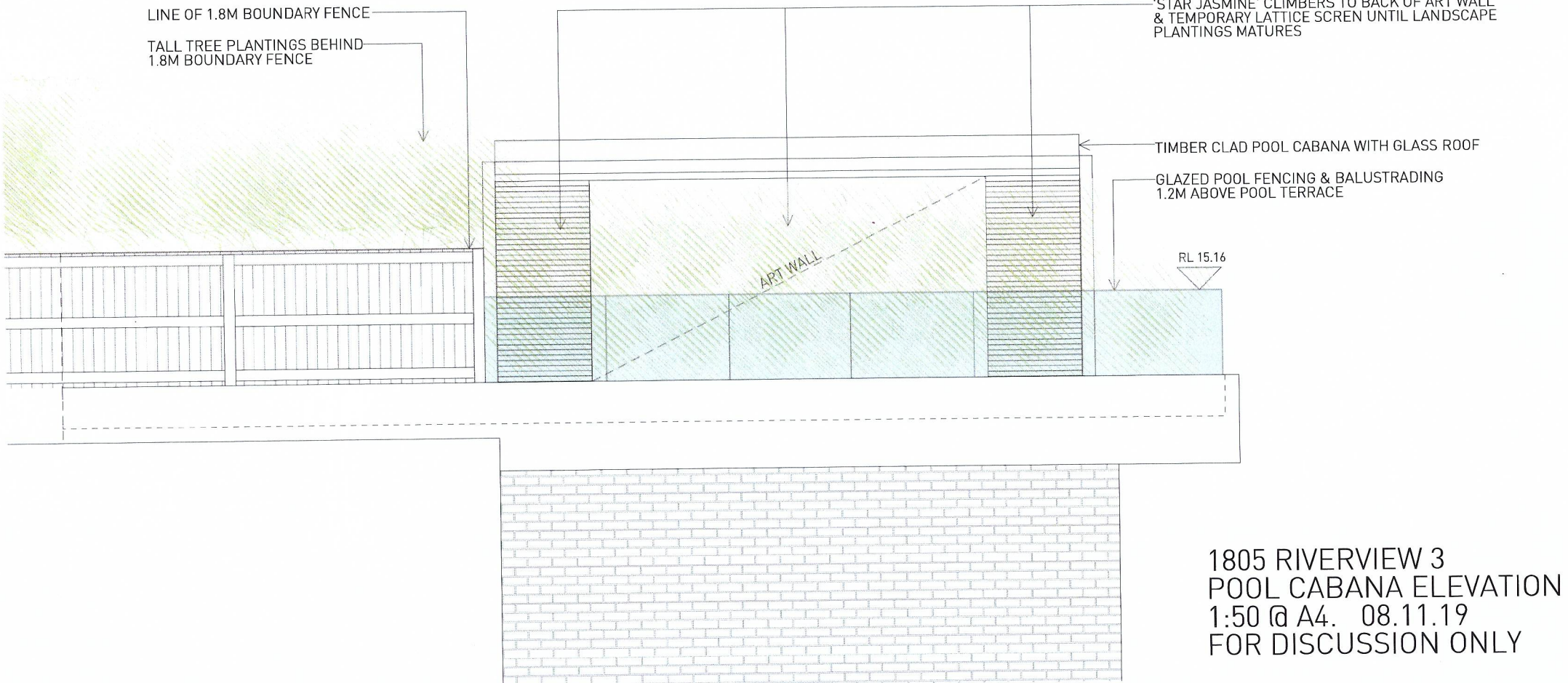

1805 RIVERVIEW 3
POOL CABANA ELEVATION
1:50 @ A4. 08.11.19
FOR DISCUSSION ONLY

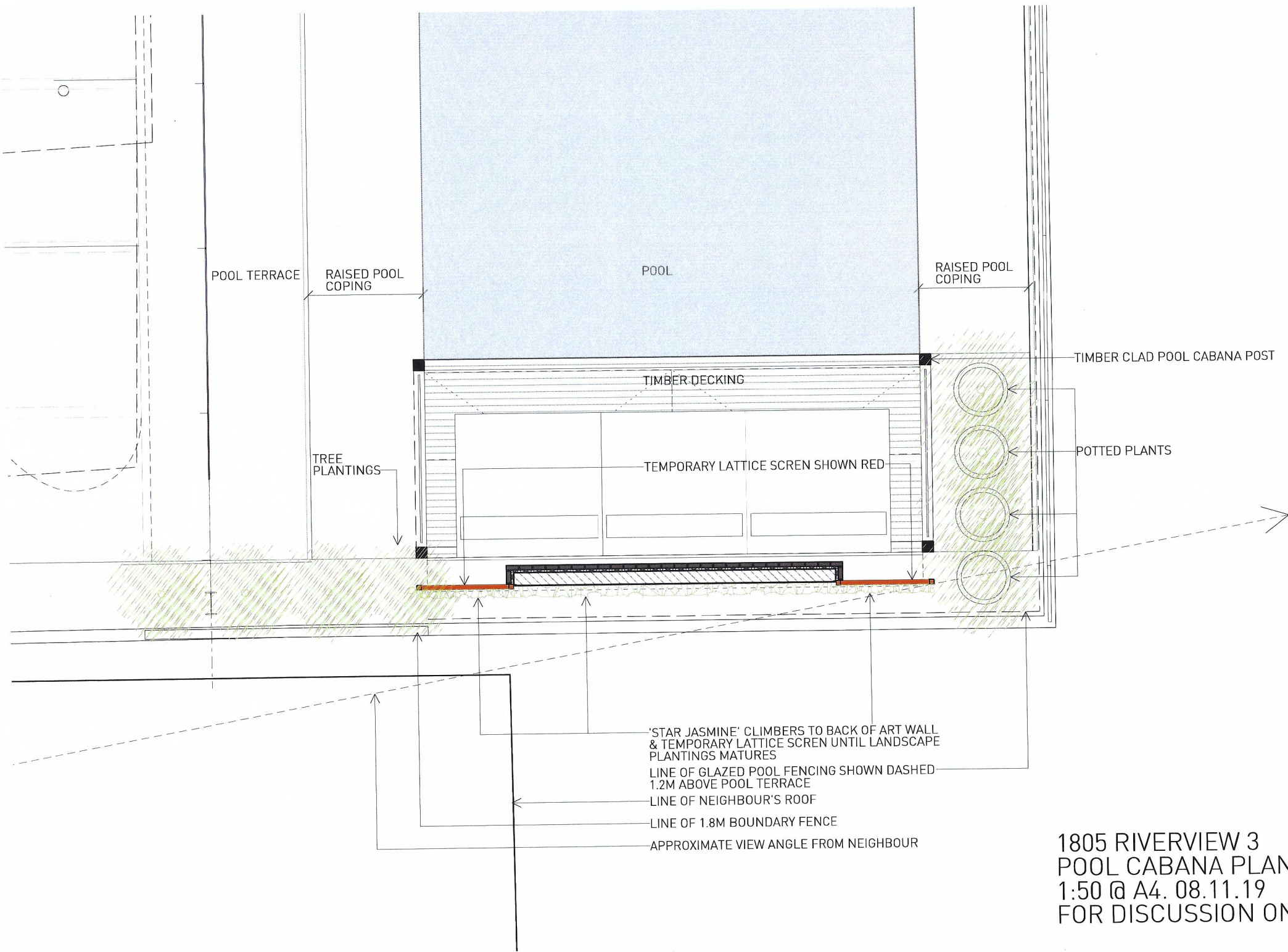

1805 RIVERVIEW 3
 POOL CABANA PLAN
 1:50 @ A4. 08.11.19
 FOR DISCUSSION ONLY

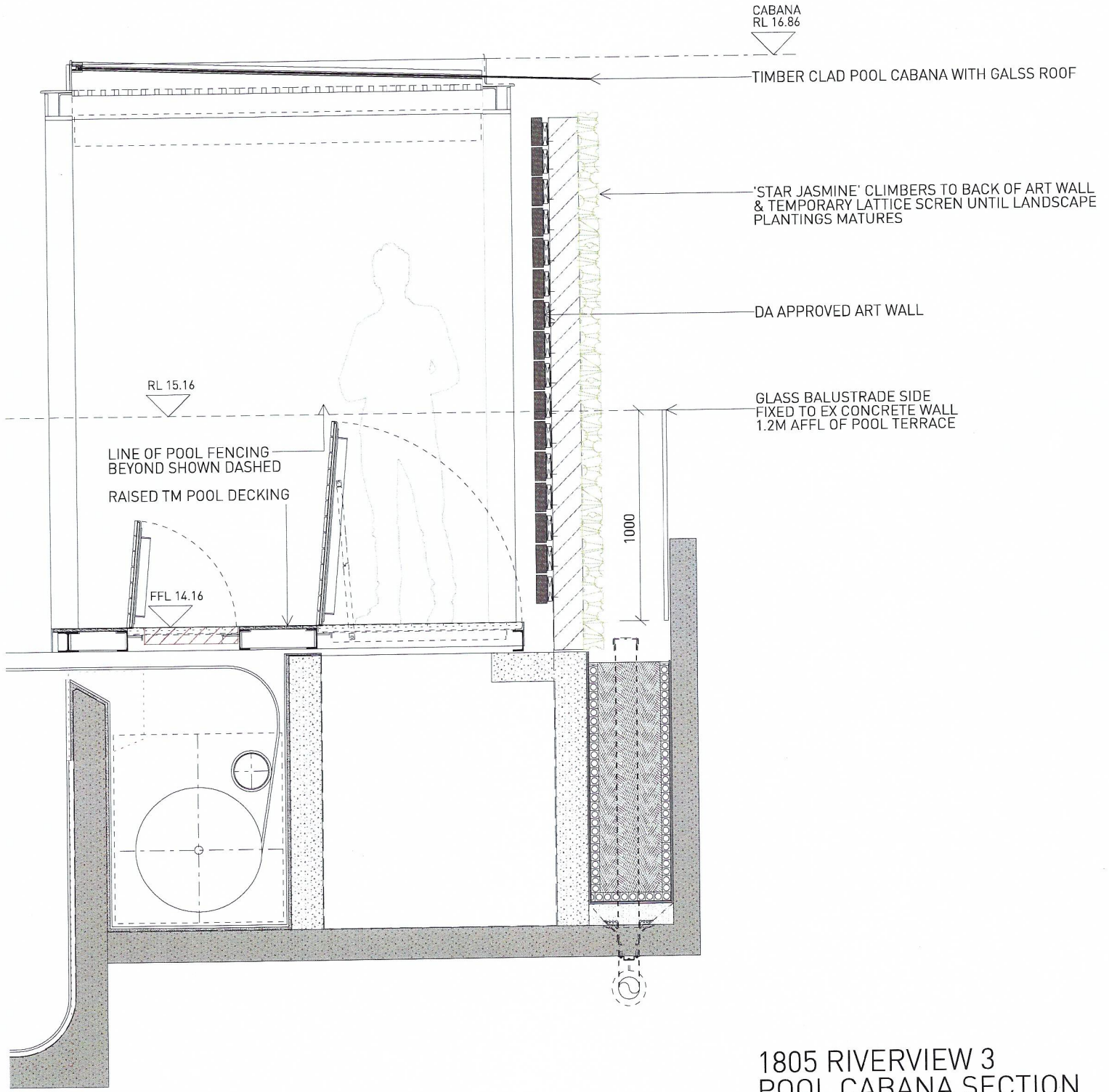

1805 RIVERVIEW 3
 POOL CABANA SECTION
 1:25 @ A4. 08.11.19
 FOR DISCUSSION ONLY